



ADDENDUM TO FINAL STATUS SURVEY REPORT

IRT CORPORATION; SMN 1405

This report covers the final measurements related to the filling of the activated neutron storage tube in Room 111. Measurements were made just prior to the back-filling operation and upon completion of the operation. The following types of measurements were made:

1. Removable beta/gamma and alpha contamination.
Instruments 4 and 5 respectively.
2. Direct beta/gamma and alpha scans.
Instruments 1 and 2 respectively.
3. Direct/beta gamma.
Instrument 7.
4. Direct dose rate at 1 meter above floor level and floor level.
Instrument 8.

The figure of Room 111 shows the locations where measurements were made. The location of the backfilled area is shown in the upper left. The cut-off tube is shown as a broken circle. A direct measurement with the HP210/scalar unit, instrument 7 above the tube at floor level prior to the removal of the concrete around the tube and the back-fill gave a count rate no greater than the average room background as measured at 1 meter above ground, approximately 35 cpm. The shielded background of the detection system is 25 cpm. The same is true for the microR dose rate measurement, approximately 16 microR/hr. The wipe survey showed results consistent with the earlier wipe survey previously reported, nothing above MDA. The wipe area again covered a minimum of 1 ft² randomly selected in the areas shown in the figure. Direct beta/gamma measurements were consistent with previously reported data, approximately 57 cpm as in the unaffected areas. The direct dose rate measurements ranged from 14 to 16 microR/hr both at floor level and 1 meter above floor level. The survey results are given in the following table.

FINAL SURVEY 3030 CALLAN ROAD—JANUARY 26, 1994

LOCATION	SCANNING		REMOVABLE		DIRECT	DOSE RATE	
	DPM/100 CM(EXP+2)		DPM/100 CM(EXP+2)		CPM	MICRO/HR	
AREA	BETA/GAMMA	ALPHA	BETA/GAMMA	ALPHA	BETA/GAMMA	FLOOR	@1 METER
1	<MDA	<MDA	<0.3	<0.05	49	14	16
2	<MDA	<MDA	<0.3	<0.05	52	16	15
3	<MDA	<MDA	<0.3	<0.05	56	17	16
4	<MDA	<MDA	<0.3	<0.05	54	16	16
5	<MDA	<MDA	<0.3	<0.05	50	16	15
6	<MDA	<MDA	<0.3	<0.05	57	14	15
7	<MDA	<MDA	<0.3	<0.05	57	15	14
8	<MDA	<MDA	<0.3	<0.05	51	16	16
9	<MDA	<MDA	<0.3	<0.05	59	15	14
10	<MDA	<MDA	<0.3	<0.05	50	16	15

CORPORATE HEADQUARTERS
 4000 HWY CORNELL DRIVE WEST SAN DIEGO CA 92111
 (619) 444-4141 (800) 834-1184
 FAX (619) 622-7888

MAILING ADDRESS
 P.O. BOX 35317, SAN DIEGO, CA 92186-5317

940207011B 940127
 PDR ADCK 07001359
 C PDR

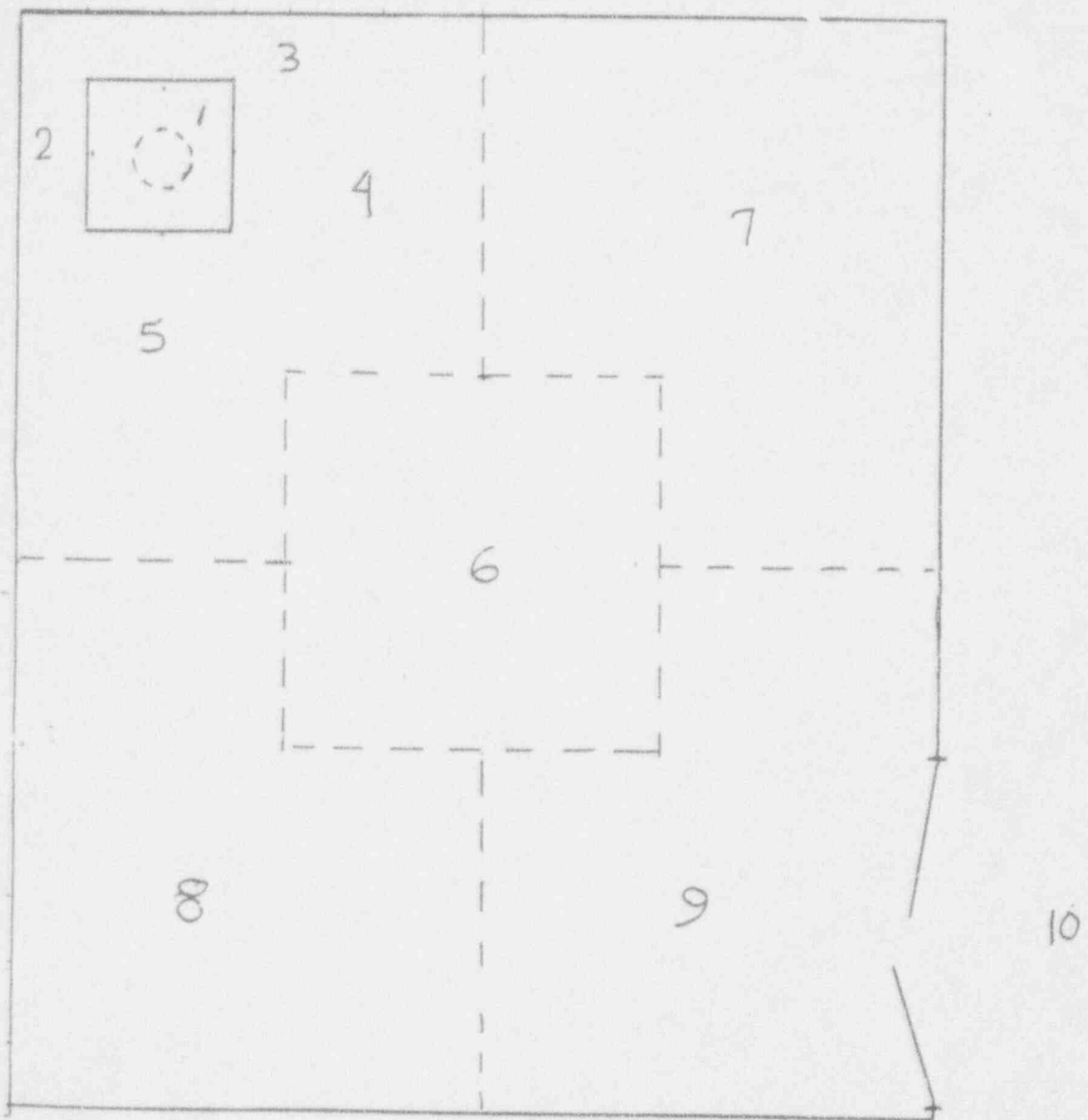

SOURCE STORAGE ROOM - III

MLC
1/26/99



ADDENDUM TO FINAL STATUS SURVEY REPORT

IRT CORPORATION; SMN 1405

This report covers the final measurements related to the filling of the activated neutron storage tube in Room 111. Measurements were made just prior to the back-filling operation and upon completion of the operation. The following types of measurements were made:

1. Removable beta/gamma and alpha contamination.
Instruments 4 and 5 respectively.
2. Direct beta/gamma and alpha scans.
Instruments 1 and 2 respectively.
3. Direct/beta gamma.
Instrument 7.
4. Direct dose rate at 1 meter above floor level and floor level.
Instrument 8.

The figure of Room 111 shows the locations where measurements were made. The location of the backfilled area is shown in the upper left. The cut-off tube is shown as a broken circle. A direct measurement with the HP210/scalar unit, instrument 7 above the tube at floor level prior to the removal of the concrete around the tube and the back-fill gave a count rate no greater than the average room background as measured at 1 meter above ground, approximately 35 cpm. The shielded background of the detection system is 25 cpm. The same is true for the microR dose rate measurement, approximately 16 microR/hr. The wipe survey showed results consistent with the earlier wipe survey previously reported, nothing above MDA. The wipe area again covered a minimum of 1 ft² randomly selected in the areas shown in the figure. Direct beta/gamma measurements were consistent with previously reported data, approximately 57 cpm as in the unaffected areas. The direct dose rate measurements ranged from 14 to 16 microR/hr both at floor level and 1 meter above floor level. The survey results are given in the following table.

FINAL SURVEY 3000 CALLAN ROAD- JANUARY 26, 1994

LOCATION	SCANNING		REMOVABLE		DIRECT CPM	DOSE RATE	
	DPM/100 CM (EXP+2)		DPM/100 CM (EXP+2)			FLOOR	@1 METER
AREA	BETA/GAMMA	ALPHA	BETA/GAMMA	ALPHA	BETA/GAMMA	FLOOR	@1 METER
1	<MDA	<MDA	<0.3	<0.05	49	14	16
2	<MDA	<MDA	<0.3	<0.05	52	6	15
3	<MDA	<MDA	<0.3	<0.05	56	17	15
4	<MDA	<MDA	<0.3	<0.05	54	16	16
5	<MDA	<MDA	<0.3	<0.05	60	16	16
6	<MDA	<MDA	<0.3	<0.05	57	14	15
7	<MDA	<MDA	<0.3	<0.05	57	15	14
8	<MDA	<MDA	<0.3	<0.05	51	15	16
9	<MDA	<MDA	<0.3	<0.05	59	15	14
10	<MDA	<MDA	<0.3	<0.05	60	16	15

CORPORATE HEADQUARTERS
WEST WOODBINE REGIONAL COURT WEST SAN DIEGO CA 92117
PHONE 434-4141 (RDS) 4-2822
FAX 434-622-9898

MAILING ADDRESS
P.O. BOX 95312 SAN DIEGO CA 92186-4312

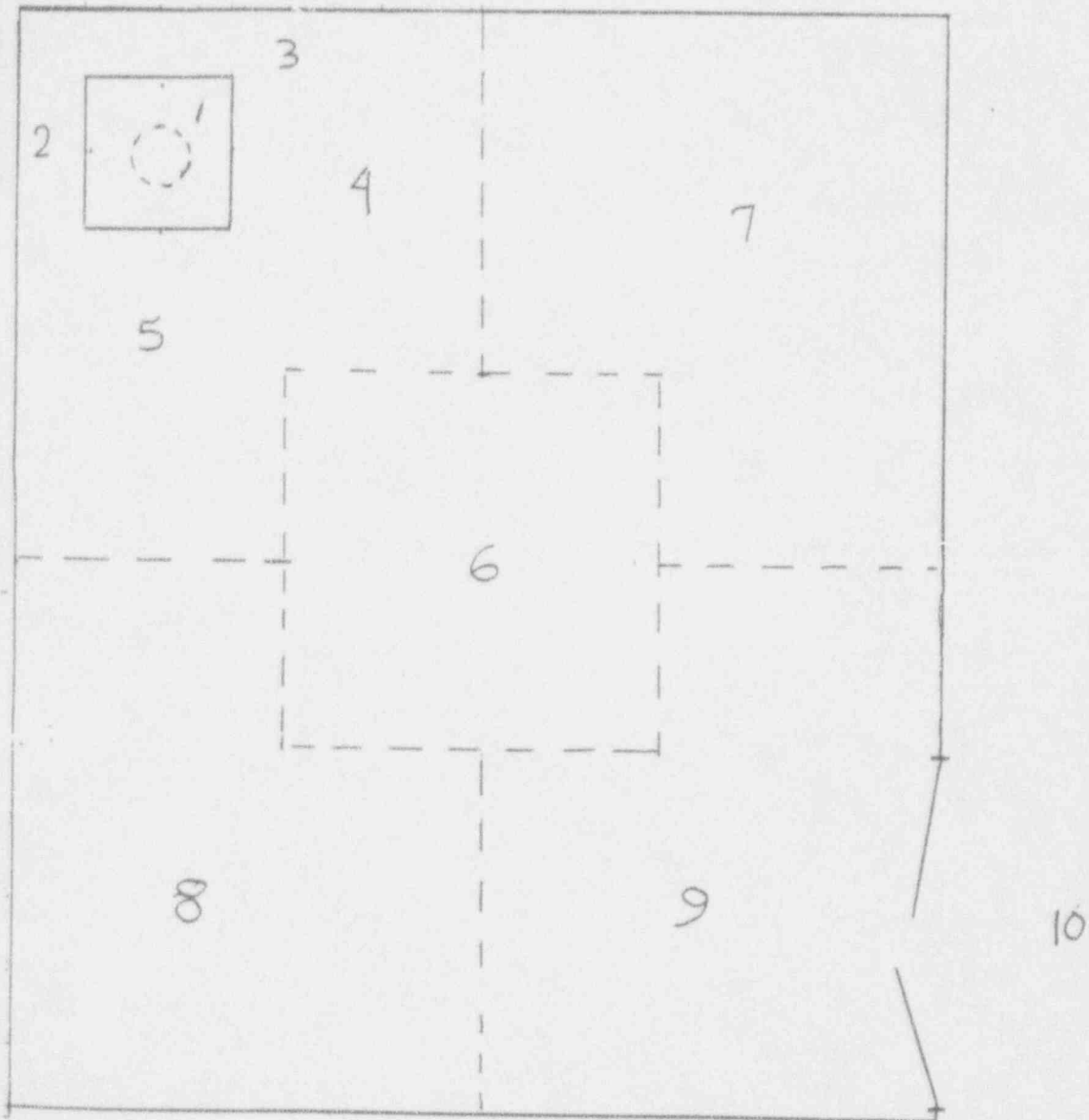

SOURCE STORAGE ROOM - III

MLC
1/26/99



ADDENDUM TO FINAL STATUS SURVEY REPORT

IRT CORPORATION; SMN 1405

This report covers the final measurements related to the filling of the activated neutron storage tube in Room 111. Measurements were made just prior to the back-filling operation and upon completion of the operation. The following types of measurements were made:

1. Removable beta/gamma and alpha contamination.
Instruments 4 and 5 respectively.
2. Direct beta/gamma and alpha scans.
Instruments 1 and 2 respectively.
3. Direct/beta gamma.
Instrument 7.
4. Direct dose rate at 1 meter above floor level and floor level.
Instrument 8.

The figure of Room 111 shows the locations where measurements were made. The location of the backfilled area is shown in the upper left. The cut-off tube is shown as a broken circle. A direct measurement with the HP210/scalar unit, instrument 7 above the tube at floor level prior to the removal of the concrete around the tube and the back-fill gave a count rate no greater than the average room background as measured at 1 meter above ground, approximately 35 cpm. The shielded background of the detection system is 25 cpm. The same is true for the microR dose rate measurement, approximately 16 microR/hr. The wipe survey showed results consistent with the earlier wipe survey previously reported, nothing above MDA. The wipe area again covered a minimum of 1 ft² randomly selected in the areas shown in the figure. Direct beta/gamma measurements were consistent with previously reported data, approximately 57 cpm as in the unaffected areas. The direct dose rate measurements ranged from 14 to 16 microR/hr both at floor level and 1 meter above floor level. The survey results are given in the following table.

FINAL SURVEY 3090 CALLAN ROAD—JANUARY 26, 1994

LOCATION	SCANNING		REMOVABLE		DIRECT	DOSE RATE	
	DPM/100 CM (EXP+3)		DPM/100 CM (EXP+2)		CFM	FLOOR	@1 METER
AREA	BETA/GAMMA	ALPHA	BETA/GAMMA	ALPHA	BETA/GAMMA		
1	<MDA	<MDA	<0.3	<0.05	49	14	16
2	<MDA	<MDA	<0.3	<0.05	52	16	15
3	<MDA	<MDA	<0.3	<0.05	56	17	15
4	<MDA	<MDA	<0.3	<0.05	64	16	16
5	<MDA	<MDA	<0.3	<0.05	50	16	16
6	<MDA	<MDA	<0.3	<0.05	57	14	15
7	<MDA	<MDA	<0.3	<0.05	57	15	14
8	<MDA	<MDA	<0.3	<0.05	51	16	16
9	<MDA	<MDA	<0.3	<0.05	59	15	14
10	<MDA	<MDA	<0.3	<0.05	50	16	15

CORPORATE HEADQUARTERS
 3090 CALLAN COURT WEST SAN DIEGO, CA 92108
 (619) 594-4441 (619) 594-4491
 FAX (619) 594-2885

MAILING ADDRESS
 P.O. BOX 85117 SAN DIEGO, CA 92186-1117

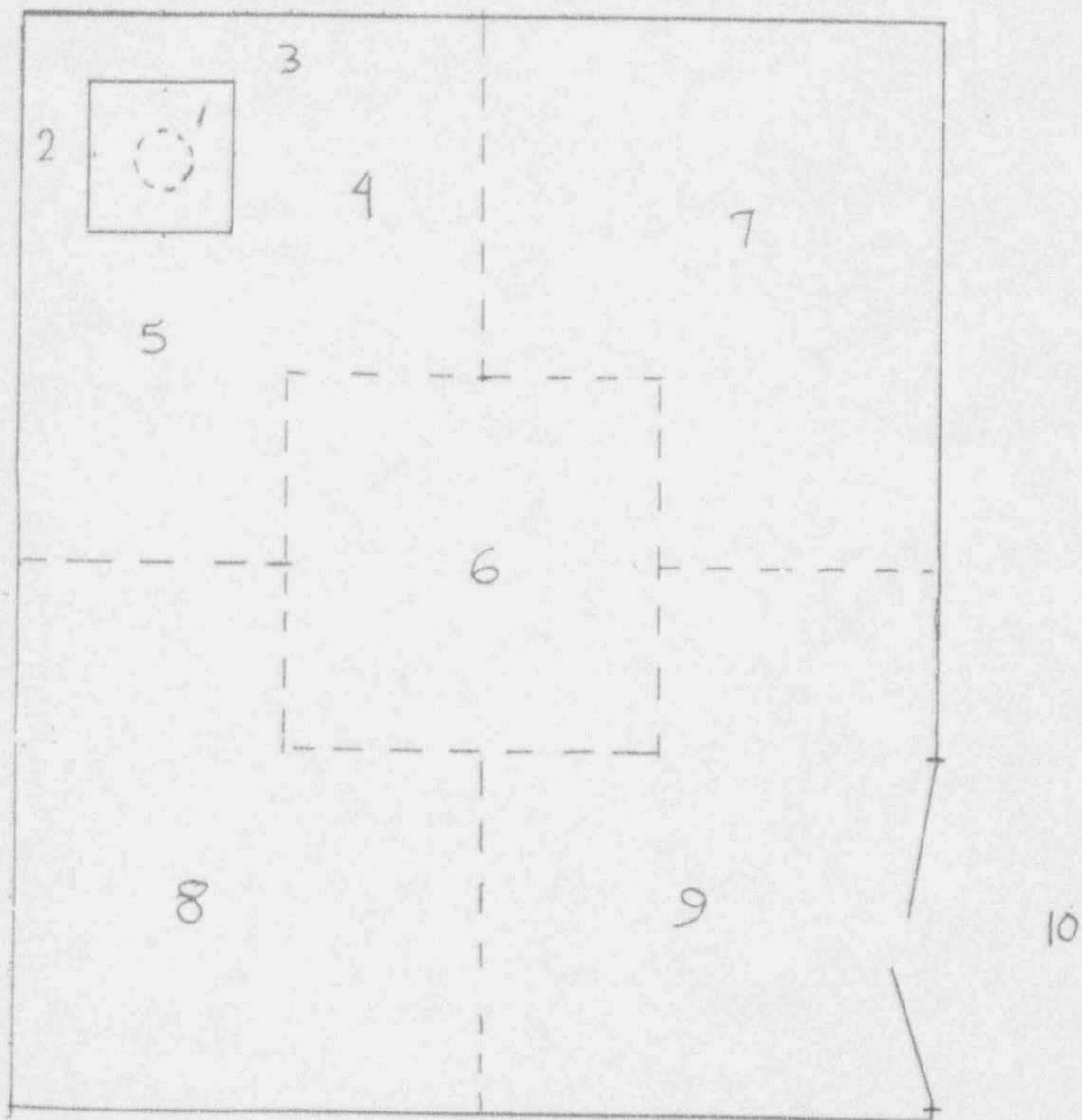

SOURCE STORAGE ROOM - III

MLC
1/26/94