

PUBLIC

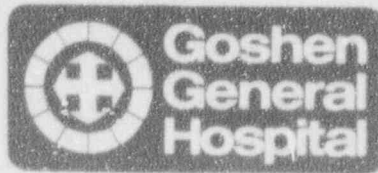

13-18845-01
030-14254

December 20, 1993

Colleen Casey
Nuclear Materials Licensing Branch
U.S. Nuclear Regulatory Commission
Region III
799 Roosevelt Road
Glen Ellyn, Illinois 60137

Dear Ms. Casey:

Enclosed please find the GM Meter Survey dated 12/20/93. I appreciate your phone call this morning, letting me know what I was lacking for this Close-out Survey. Your fast reply was very welcome to myself and Goshen General Hospital. I am faxing a copy of this letter to you as requested. Also, if you could send us a copy of the results/Amendment #9, we would be grateful.

Please call me if you have any questions. Again many thanks.

FAX 219-535-2786

Sincerely,

Gregory L Miller
Gregory L. Miller, CNMT

Ref: Control # 96100

9401110098 931220
PDR ADOCK 03014254
C PDR

100051

RECEIVED

JAN 03 1994

REGION III

JAN 03 1994
11 ML
30 DT



Nuclear Medicine GM Meter Survey

December 20, 1993

A = Imaging Room

- 10 Floor 0.03 mR/hr
- 11 South Wall 0.03 mR/hr
- 12 West Wall & Bathroom 0.03 mR/hr
- 13 North Wall & Doorway 0.03 mR/hr
- 14 East Wall & Doorway 0.03 mR/hr

B = Hot Lab

- 3 Sink 0.03 mR/hr
- 4 West Wall & Doorway 0.03 mR/hr
- 5 East Wall / Cabinet Doors 0.03 mR/hr
- 6 Waste Storage Cabinet 0.03 mR/hr
- 7 Counter Top (Dose Prep) 0.03 mR/hr
- 8 Inside Cabinets 0.03 mR/hr
- 9 Floor 0.03 mR/hr
- 15 Refrigerator & Front 0.03 mR/hr

C = Fume Hood

- 1 Walls Inside of Hood & Window Face 0.03 mR/hr
- 2 Counter Surface of Hood 0.03 mR/hr

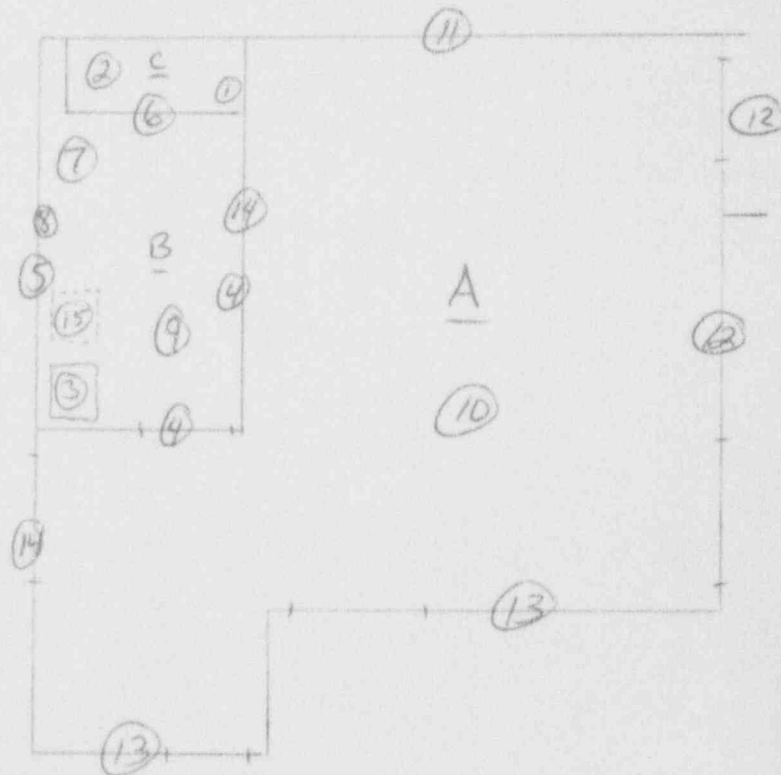

Background = 0.03 mR/hr *LM*

GM Meter = Bicron 2000
Setting = x0.1
Probe Shield Open
Calibration Date: 4/5/93

Gregory L Miller
Gregory L. Miller, CNMT