



CHARLES CENTER • P.O. BOX 1475 • BALTIMORE, MARYLAND 21203

ELECTRIC ENGINEERING
DEPARTMENT

January 4, 1981

Office of Nuclear Reactor Regulation
U. S. Nuclear Regulatory Commission
Washington, D. C. 20555

Attn: Mr. Robert A. Clark, Chief
Operating Reactors Branch #3
Division of Licensing

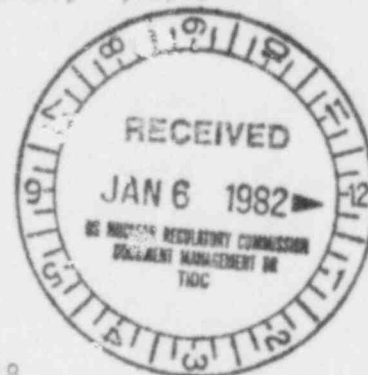

Subject: Calvert Cliffs Nuclear Power Plant
Units Nos. 1 & 2; Dockets Nos. 50-317 & 50-318
Spent Fuel Pool Modification: Supplementary Information

Reference: (a) BG&E letter dated 11/24/81 from Lundvall to Clark,
Request for Amendment.

Gentlemen:

Reference (a) requested an amendment to allow increased spent fuel storage capacity at Calvert Cliffs. The following information is pertinent to that request.

The original structural analysis for the spent fuel pool was performed by Bechtel. Those calculations have been reviewed again by Bechtel and it has been determined that the rack capacity increase to 1830 is acceptable, see Enclosure (1).

The cask area and the trough area, as shown on Enclosure (2), will be raised in spent fuel pool number 2 to the same elevation as the existing pool floor. These raised areas will meet the compression capacity of the existing pool floor and all seismic Class I requirements. The areas will be raised by the use of a free-standing structural steel insert that will be compatible with the pool environment. The additional forces added by the inserts during a seismic event should not affect the integrity of the racks or their contents due to the conservative structural design of the racks. The integrity of the pool liner plate will be maintained.

If you have any questions or require additional information concerning this request, please contact the undersigned.

Very truly yours,

R. C. L. Olson
Principal Engineer

8201070126 820104
PDR ADOCK 05000317
P PDR

Aool
5/11

RCLO/smn

Enclosures: (1) Bechtel letter dated 12/3/81 from Ventura to Ash,
Spent Fuel Pool, Storage Capacity.
(2) Plan for Fuel Storage Rack Arrangement, NES
Document No. 81A0701 page 6 of 29.

cc: J. A. Biddison, Esquire
G. F. Trowbridge, Esquire
Messrs. D. H. Jaff:
R. E. Architzel

Bechtel Power Corporation

Engineers — Constructors

15740 Shady Grove Road
Gaithersburg, Maryland 20877
301-258-3000



December 3, 1981

Mr. R. F. Ash
Chief Nuclear Engineer
Baltimore Gas and Electric Company
Gas and Electric Building
Baltimore, Maryland 21203

Dear Mr. Ash:

Calvert Cliffs Nuclear Power Plant
Units No. 1 and 2
Baltimore Gas and Electric Company
Bechtel Job No. 11865
Spent Fuel Pool, Storage Capacity
Bechtel File No.: 0684/4130
CC-A4197

Pursuant to a telephone request by your Mr. R. Olson regarding the spent fuel rack storage capacity, spent fuel pool area, we have reviewed the calculations and determined that rack capacity increase to 1830 is acceptable.

If you have any additional questions, please contact us.

Very truly yours,

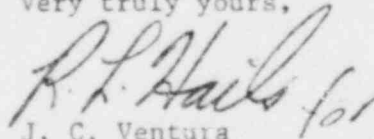
J. C. Ventura
Project Engineer

SD/smf

cc: Mr. A. R. Thornton, BG&E
Mr. D. T. Ward, BG&E
Mr. L. A. Sundquist, BG&E
Mr. L. B. Russell (Jobsite), BG&E
✓ Mr. R. Olson, BG&E

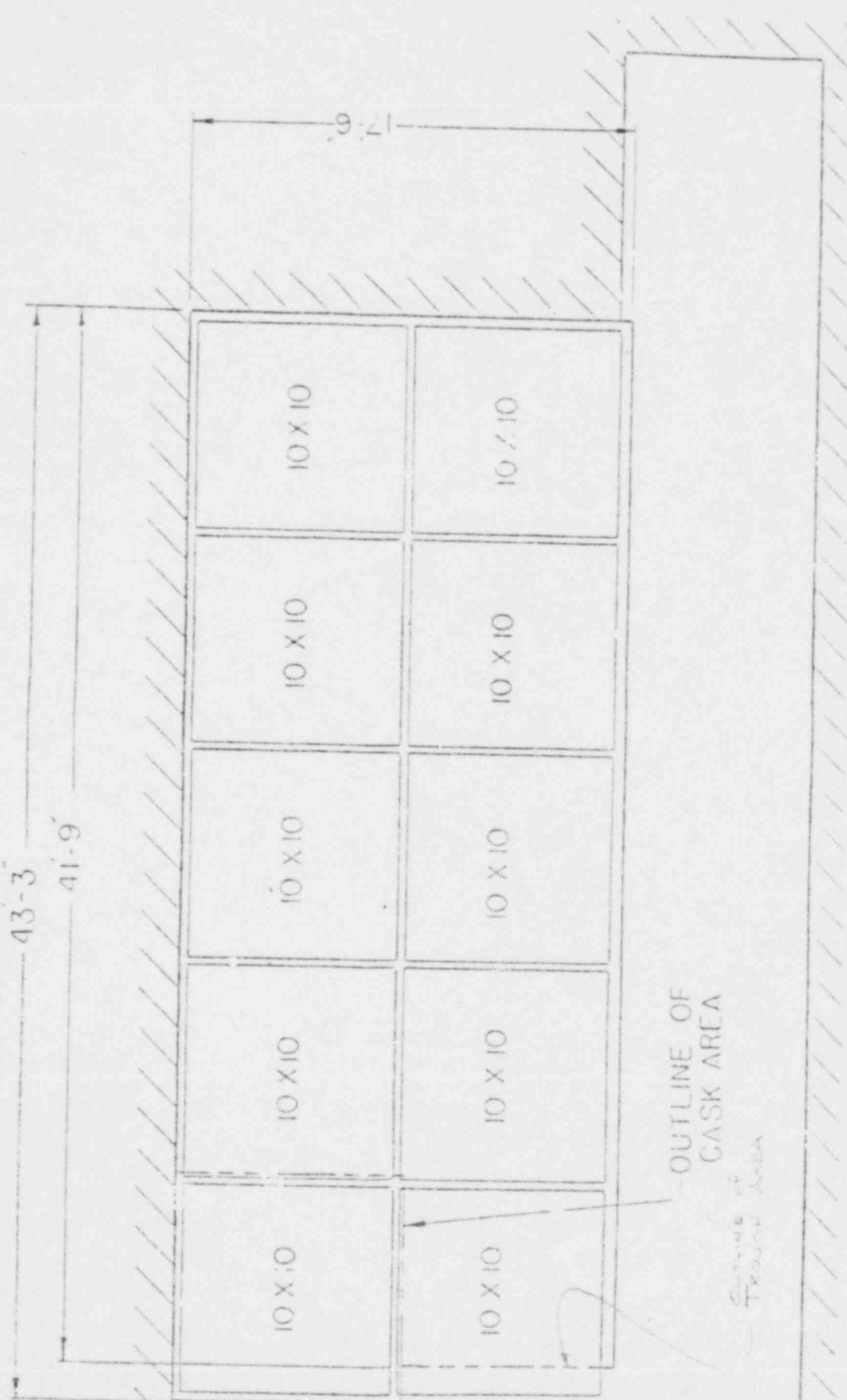

PLAN
 FUEL STORAGE RACK ARRANGEMENT (1000 CELLS)
 (SOUTHERN POOL)

Figure 2-1