



Westinghouse
Electric Corporation

Water Reactor
Divisions

Nuclear Technology Division
Box 355
Pittsburgh Pennsylvania 15230

Director of Nuclear Reactor Regulation
Attn: Mr. B. J. Youngblood, Chief
Licensing Branch Number 1
Division of Licensing
U. S. Nuclear Regulatory Commission
Phillips Building
7920 Norfolk Avenue
Bethesda, Maryland 20014

November 25, 1981
CAW-81-86

SUBJECT: Slides from the Model D-3 Steam Generator Vibration Review Meeting
of November 20, 1981 (Proprietary)

REF: Letter Application for Withholding Proprietary Information from
Public Disclosure, Parker to Youngblood, December 1981

Dear Mr. Youngblood:

The proprietary material for which withholding is being requested by Duke Power Company is proprietary to Westinghouse and withholding is requested pursuant to the provisions of paragraph (b)(1) of Section 2.790 of the Commission's regulations. Withholding from public disclosure is requested with respect to the subject information which is further identified in the affidavit accompanying this application.

The undersigned has reviewed the information sought to be withheld and is authorized to apply for its withholding on behalf of Westinghouse, WRD, notification of which was sent to the Secretary of the Commission on April 19, 1976.

The original affidavit accompanying this application sets forth the basis on which the information may be withheld from public disclosure by the Commission and addresses with specificity the considerations listed in paragraph (b)(4) of Section 2.790 of the Commission's regulations.

Accordingly, this letter authorizes the use of the proprietary information and affidavit CAW-81-86 by the Duke Power Company for McGuire Unit 1.

Correspondence with respect to this application for withholding or the accompanying affidavit should reference CAW-81-86 and be addressed to the undersigned.

Very truly yours,

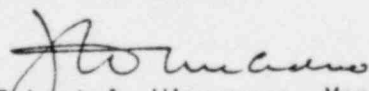
Robert A. Wiesemann, Manager
Regulatory & Legislative Affairs

/bek
Enclosure

cc: E. C. Shomaker, Esq.
Office of the Executive Legal Director, NRC

8112040443 811130
PDR ADOCK 05000369
P PDR

AFFIDAVIT

COMMONWEALTH OF PENNSYLVANIA:

SS

COUNTY OF ALLEGHENY:

Before me, the undersigned authority, personally appeared E. P. Rahe, Jr., who, being by me duly sworn according to law, deposes and says that he is authorized to execute this Affidavit on behalf of Westinghouse Electric Corporation ("Westinghouse") and that the averments of fact set forth in this Affidavit are true and correct to the best of his knowledge, information, and belief:

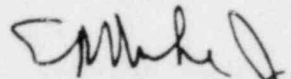

E. P. Rahe, Jr., Manager
Nuclear Safety Department

Sworn to and subscribed
before me this 25 day
of November 1981.

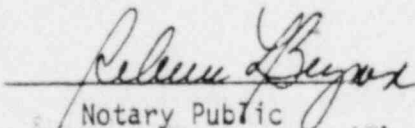

Notary Public

My Comm. Expires Apr. 15, 1982
Notary Public, Allegheny County, Pa.

- (1) I am Manager, Nuclear Safety Department, in the Nuclear Technology Division, of Westinghouse Electric Corporation and as such, I have been specifically delegated the function of reviewing the proprietary information sought to be withheld from public disclosure in connection with nuclear power plant licensing or rulemaking proceedings, and am authorized to apply for its withholding on behalf of the Westinghouse Water Reactor Divisions.
- (2) I am making this Affidavit in conformance with the provisions of 10CFR Section 2.790 of the Commission's regulations and in conjunction with the Westinghouse application for withholding accompanying this Affidavit.
- (3) I have personal knowledge of the criteria and procedures utilized by Westinghouse Nuclear Energy Systems in designating information as a trade secret, privileged or as confidential commercial or financial information.
- (4) Pursuant to the provisions of paragraph (b)(4) of Section 2.790 of the Commission's regulations, the following is furnished for consideration by the Commission in determining whether the information sought to be withheld from public disclosure should be withheld.
 - (i) The information sought to be withheld from public disclosure is owned and has been held in confidence by Westinghouse.

- (ii) The information is of a type customarily held in confidence by Westinghouse and not customarily disclosed to the public. Westinghouse has a rational basis for determining the types of information customarily held in confidence by it and, in that connection, utilizes a system to determine when and whether to hold certain types of information in confidence. The application of that system and the substance of that system constitutes Westinghouse policy and provides the rational basis required.

Under that system, information is held in confidence if it falls in one or more of several types, the release of which might result in the loss of an existing or potential competitive advantage, as follows:

- (a) The information reveals the distinguishing aspects of a process (or component, structure, tool, method, etc.) where prevention of its use by any of Westinghouse's competitors without license from Westinghouse constitutes a competitive economic advantage over other companies.
- (b) It consists of supporting data, including test data, relative to a process (or component, structure, tool, method, etc.), the application of which data secures a competitive economic advantage, e.g., by optimization or improved marketability.

- (c) Its use by a competitor would reduce his expenditure of resources or improve his competitive position in the design, manufacture, shipment, installation, assurance of quality, or licensing a similar product.
- (d) It reveals cost or price information, production capacities, budget levels, or commercial strategies of Westinghouse, its customers or suppliers.
- (e) It reveals aspects of past, present, or future Westinghouse or customer funded development plans and programs of potential commercial value to Westinghouse.
- (f) It contains patentable ideas, for which patent protection may be desirable.
- (g) It is not the property of Westinghouse, but must be treated as proprietary by Westinghouse according to agreements with the owner.

There are sound policy reasons behind the Westinghouse system which include the following:

- (a) The use of such information by Westinghouse gives Westinghouse a competitive advantage over its competitors. It is, therefore, withheld from disclosure to protect the Westinghouse competitive position.

- (b) It is information which is marketable in many ways. The extent to which such information is available to competitors diminishes the Westinghouse ability to sell products and services involving the use of the information.
- (c) Use by our competitor would put Westinghouse at a competitive disadvantage by reducing his expenditure of resources at our expense.
- (d) Each component of proprietary information pertinent to a particular competitive advantage is potentially as valuable as the total competitive advantage. If competitors acquire components of proprietary information, any one component may be the key to the entire puzzle, thereby depriving Westinghouse of a competitive advantage.
- (e) Unrestricted disclosure would jeopardize the position of prominence of Westinghouse in the world market, and thereby give a market advantage to the competition in those countries.
- (f) The Westinghouse capacity to invest corporate assets in research and development depends upon the success in obtaining and maintaining a competitive advantage.

- (iii) The information is being transmitted to the Commission in confidence and, under the provisions of 10CFR Section 2.790, it is to be received in confidence by the Commission.

- (iv) The information sought to be protected is not available in public sources or available information has not been previously employed in the same original manner or method to the best of our knowledge and belief.

- (v) The proprietary information sought to be withheld in this submittal is that which is appropriately marked in Model D-3 Steam Generator Presentation Slides for the McGuire Unit 1 being transmitted by the Duke Power Company letter Application for Withholding Proprietary Information from Public Disclosure, Parker to Youngblood, December 1981. The proprietary information as submitted is expected to be applicable in other licensee and applicant submittals in response to certain NRC requirements for justification of the steam generator design and operation.

This information is part of that which will enable Westinghouse to:

- (a) Provide documentation of the analyses, method and testing for product design and operation.

- (b) Assist the customer to obtain NRC approval.

Further this information has substantial commercial value as follows:

- (a) Westinghouse plans to sell similar information to its customers for purposes of meeting NRC requirements for licensing documentation.
- (b) Westinghouse can sell support and defense of the technology to its customers in the licensing process.

Public disclosure of this information is likely to cause substantial harm to the competitive position of Westinghouse because it would enhance the ability of competitors to provide similar analytical documentation and licensing defense services for commercial power reactors without commensurate expenses. Also, public disclosure of the information would enable others to use the information to meet NRC requirements for licensing documentation without purchasing the right to use the information.

The development of the technology described in part by the information is the result of applying the results of many years of experience in an intensive Westinghouse effort and the expenditure of a considerable sum of money.

In order for competitors of Westinghouse to duplicate this information, similar technical programs would have to be performed and a significant manpower effort, having the requisite talent and experience, would have to be expended for system design software development.

Further the deponent sayeth not.

WESTINGHOUSE PROPRIETARY CLASS 3

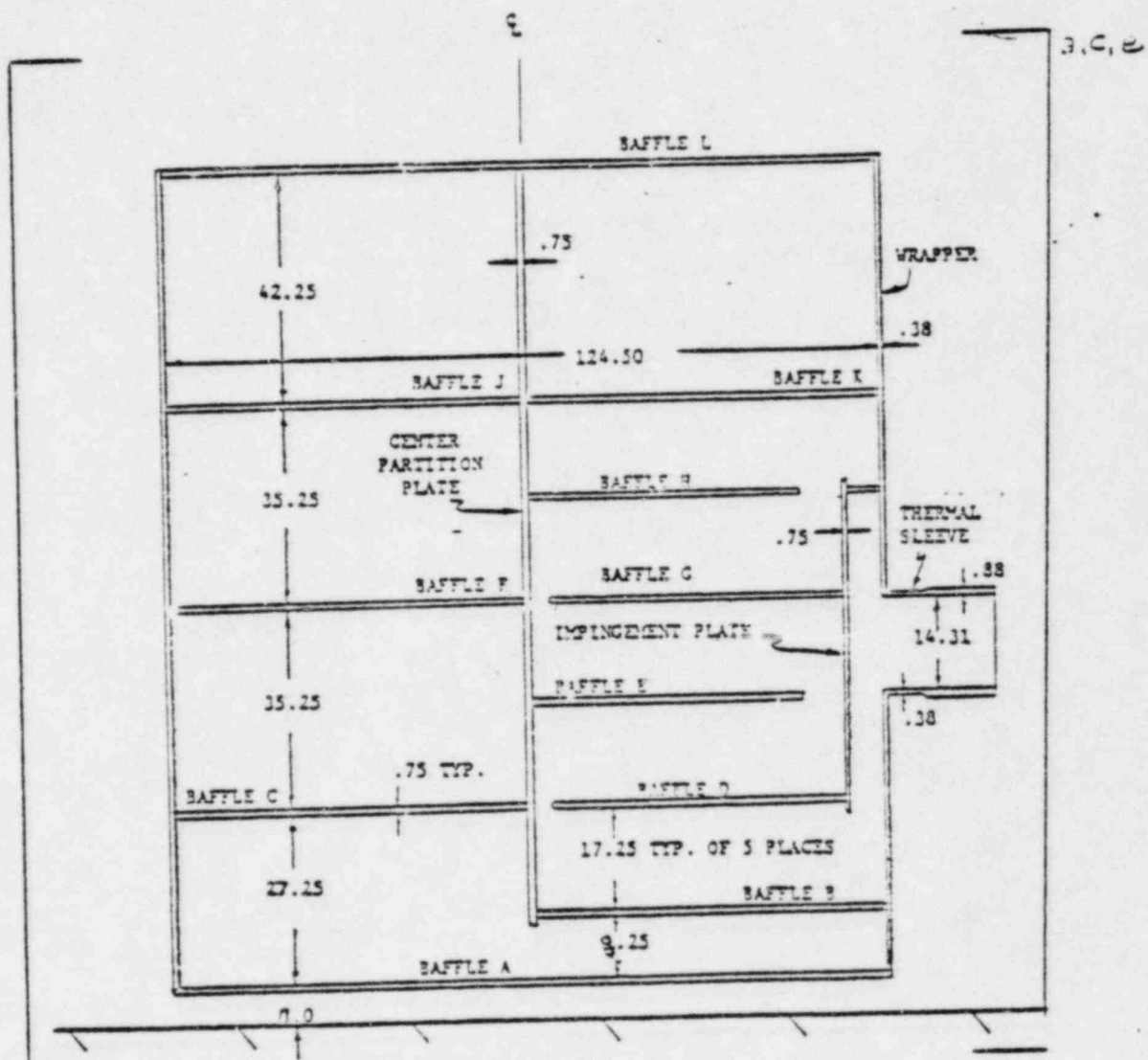

MODEL D5

WESTINGHOUSE PROPRIETARY

WESTINGHOUSE PROPRIETARY CLASS 2

3, 4, 5

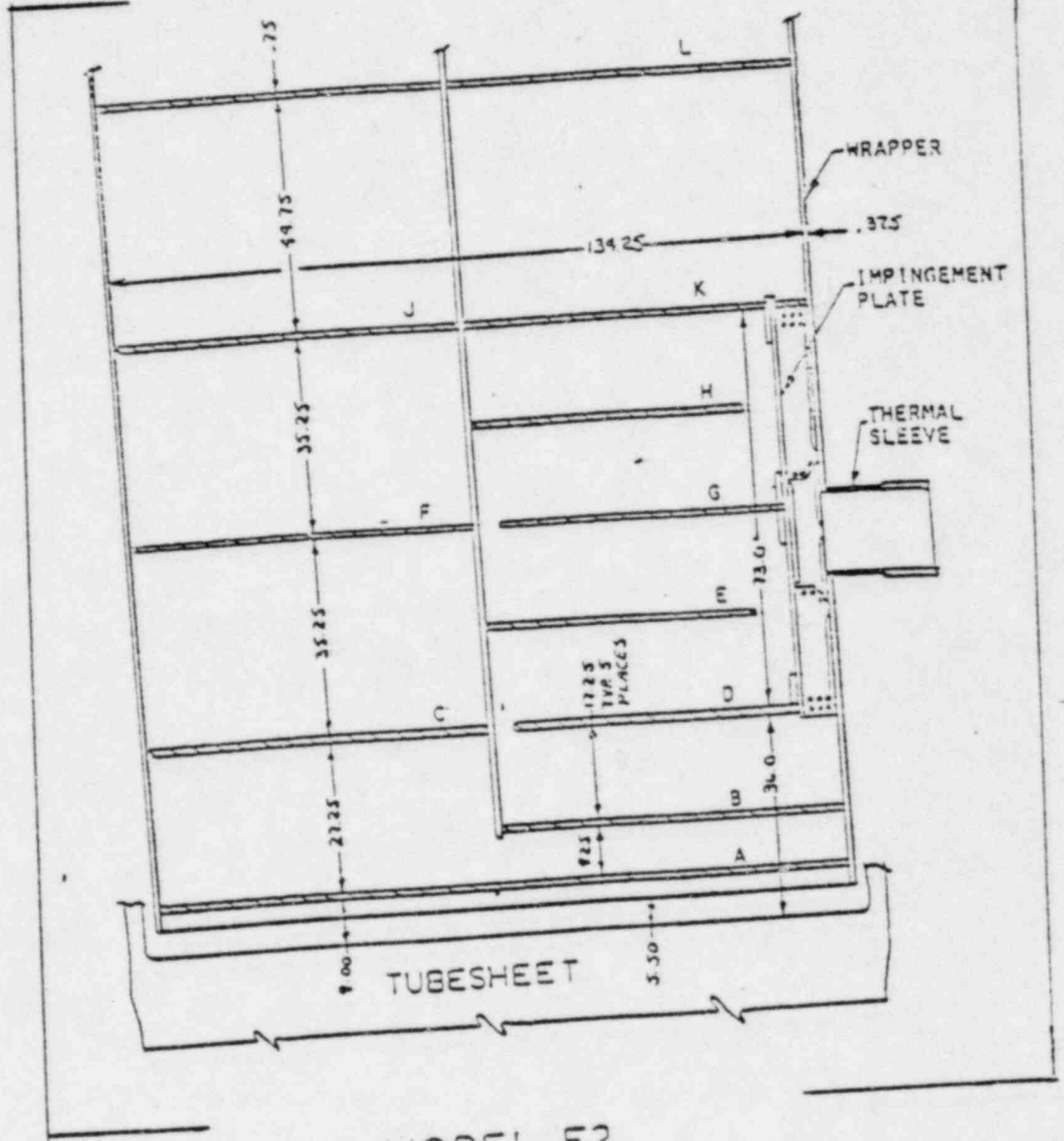

MODEL E2
PREHEATER INTERNALS

WESTINGHOUSE PROPRIETARY

STEAM GENERATOR PARAMETERS

	MODEL	MW/GEN	T_H	T_C	P_S	T_{FW}	STEAM FLOW $\times 10^{-6}$	T_S
MCGUIRE 1	D-2	856	617.3	558.8	1000	440	3.79	544.6
RINGHALS 3	D-3	928	612.6	543.1	877	430	4.02	528.9
ALMARAZ 1	D-3	899	619.9	556.4	987	435	3.94	543.0
KRSKO 1	D-4	941	616.1	549.7	920	430	4.09	534.6

WESTINGHOUSE PROPRIETARY CLASS 1

3, 5, 6

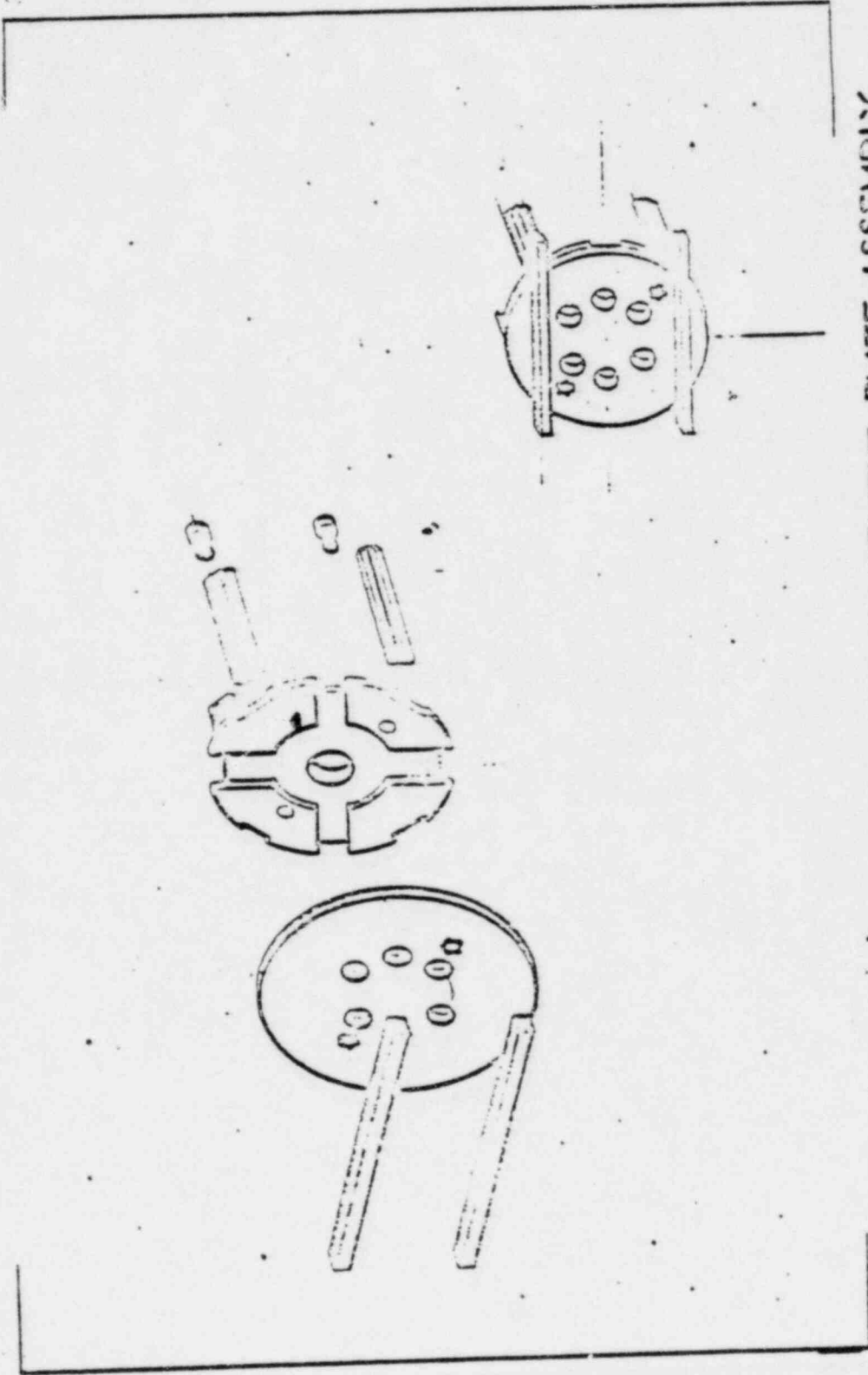

IMPINGEMENT PLATE ASSEMBLY
MODEL D2

a, c, e

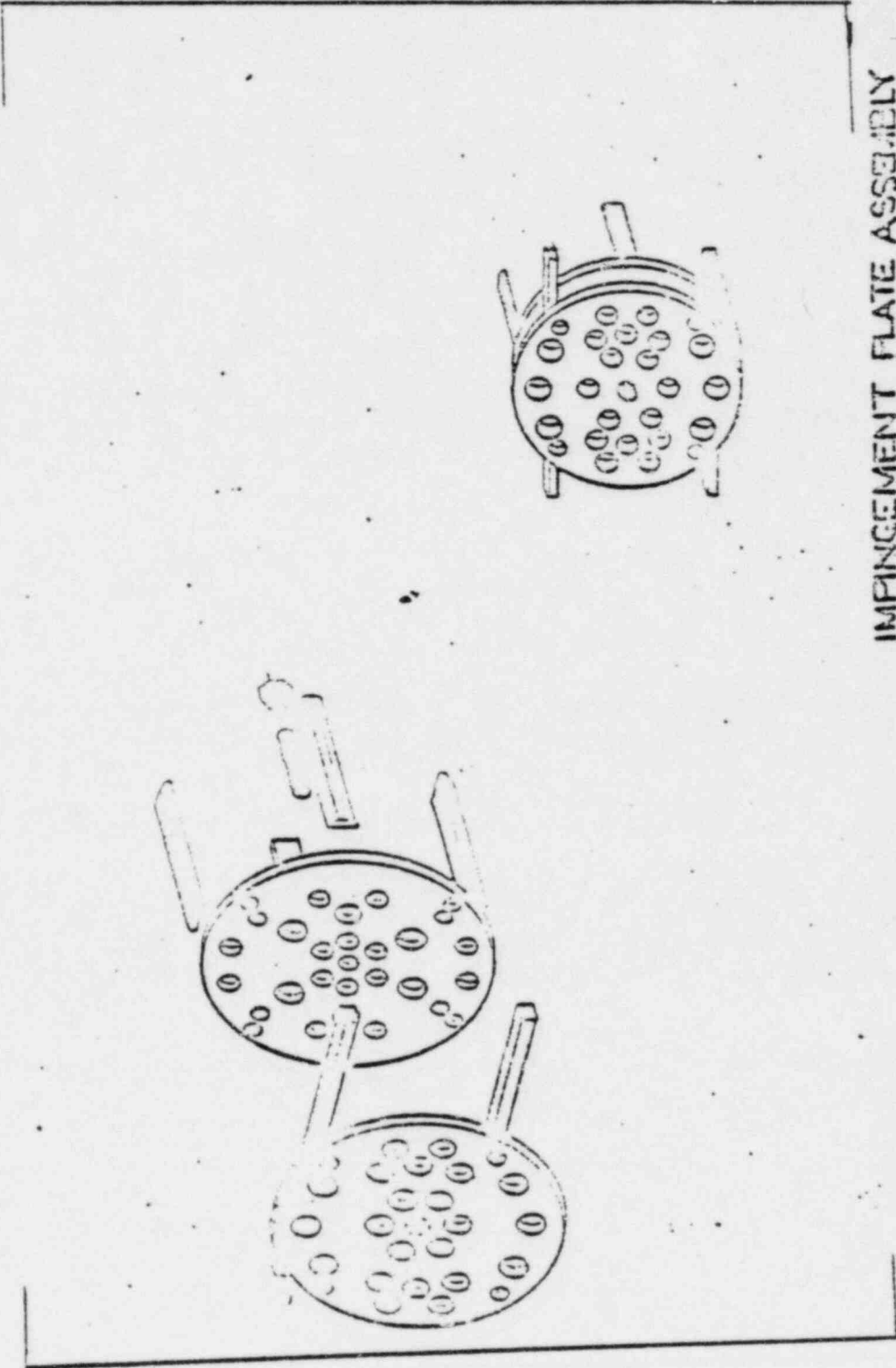

IMPINGEMENT PLATE ASSEMBLY
MODEL D3

WESTINGHOUSE PROPRIETARY

IMPINGEMENT PLATE ASSEMBLY
MODEL 100

WESTINGHOUSE PROPRIETARY

a, c, e

