

Ponce I & M Engineering Laboratory, Inc.

San Cristobal Ave. No. 8 Road No. 506,
Coto Laurel Ward, Ponce, Puerto Rico

anna 4/16

SOIL & MATERIALS TESTING

Tels. (809) 848-2075 - 848-2085

23 de marzo de 1989

Nuclear Regulatory Commission
Region II
101 Marietta St., N.W.
Atlanta, GA 30323

Subject: Relocation of Devices
Under Licence No. 52-24908-01
Docket No. 031-29953

Gentlemen:

Please be informed that the devices under the licence above mentioned (Moisture/Density Gauge (2)) were relocated at the new physical address as follows:

Ponce I & M Engineering Laboratory, Inc.
San Cristobal Avenue Num. 3
P.O. Box 515
Coto Laurel, P.R. 00644-0515

Also, we are including the SKETCHES showing the correct location of the Gauges off hours in our building and the exit from P.R. 52 road.

If any other information is required, please contact us under your best convenience.

Cordially yours,

Ing. Jose Luis Trizarry, P.E.

Log	<i>Am-3-II</i>
Transmitter	
Enclosure No.	<i>095</i>
Amount	<i>600</i>
Fee Category	<i>3P</i>
Type of Fee	<i>And</i>
Date Check Recd.	<i>5/10/89</i>
Date Completed	<i>5/11/89</i>
	<i>Murawski</i>

9002060126 890522
REG2 LIC30
52-24908-01 PDR

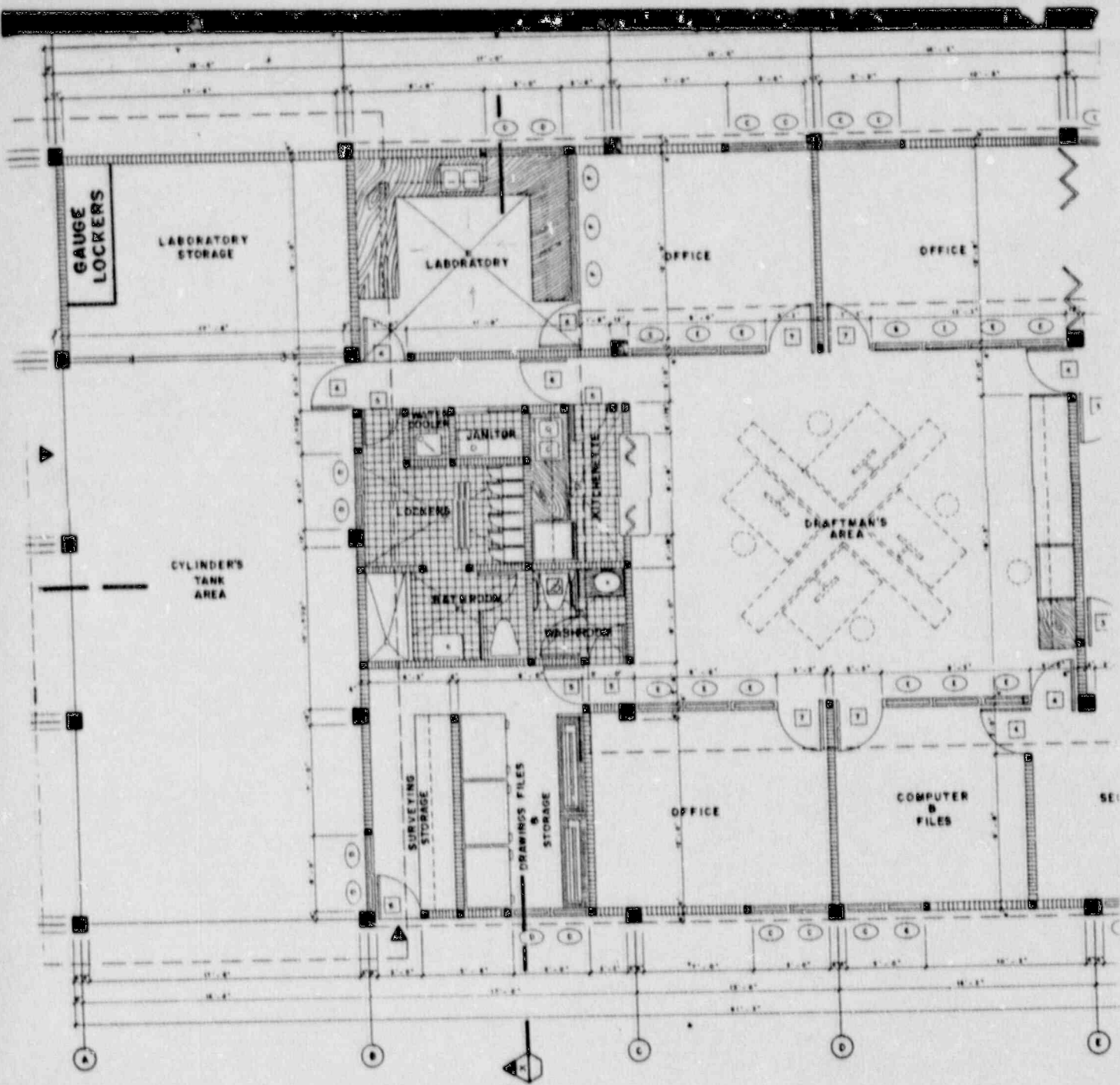

FLOOR PLAN

PONCE I & M ENGINEERING LABORATORY INC.

THIS IS TO INFORM TO ALL OUR CLIENTS AND FRIENDS OUR NEW ADDRESS AND TELEPHONES;
EFFECTIVE FEBRUARY 1989.

POSTAL ADDRESS :

BOX 515
COTO LAUREL, P.R. 00644-0515

TELEPHONES:

(809) 848-2075, 848-2085

OFFICE ADDRESS:

SAN CRISTOBAL AVENUE NO. 3, ROAD NO. 506,
SAN CRISTOBAL HOSPITAL ENTRANCE,
COTO LAUREL WARD, PONCE, P. R.

RAMON MONTERO, P. E.
GEOTECHNICAL ENGINEER

LOCATION MAP

