

Beebe Hospital

OF SUSSEX COUNTY, INC.

LEWES, DELAWARE 19958

TELEPHONE (302) 645-3300

JAMES A. BALL
ADMINISTRATOR

030-13331

August 2, 1988

John Glenn, Ph.D.
Materials Licensing Section B
U.S. Nuclear Regulatory Commission
475 Allendale Rd.
King of Prussia, PA 19406

Dear Dr. Glenn,

Please amend our NRC byproduct material license 07-17792-01 to include a nuclear medicine department change of location. Enclosed is our new floor plan layout. We have our acceptable calculations, checked by our consultant radiation physicist, Walter L. Robinson, M.S., to support the use of Xe-133 in our new suite on file in our "ALARA Binder". Our rooms are kept under negative pressure differential, and we will follow the Model Programs of Appendix O as follows: 10.13.1, (0.1), (0.2), (0.3), 10.13.3, 10.13.4, and (0.4).

We will also perform a close-out survey and wipe test of our old facility prior to relinquishing it to alternative use.

If you have any questions concerning this amendment, please contact our consultant radiation physicist at (717) 291-9813.

Sincerely,

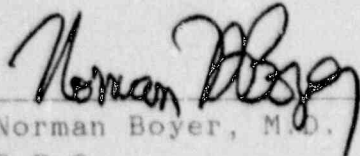
Norman Boyer, M.D.
R.S.O.

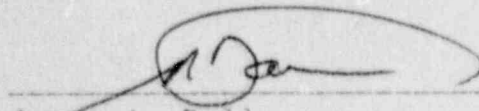
James A. Ball
Administrator

Log	Oct 15
Remitter	
Check No.	2452
Amount	\$120
Fee Category	2C
Type of Fee	A.M.D.
Date Check Rec'd.	10/13/88
Date Completed	10/3/88
By:	J. Kimberly

109509

9001170198 8B1104
REG1 LIC30
07-17792-01 PDR

"OFFICIAL RECORD COPY" ML 10

AUG 31 1988

- A. GENERATOR
- B. KIT PREPARATION AREA
- C. DOSE CALIBRATOR
- D. HOT LAB SINK
- E. HOT LAB FLOOR
- F. IMAGING ROOM FLOOR
- G. INJECTION AREA
- H. LEAD LINED TRASH CAN (UNDERCOUNTER)
- I. WIPE TEST METER
- J. SURVEY METER (HOT LAB)
- K. EXIT GM MONITOR
- L. BATHROOM (IN IMAGING ROOM)
- M. BATHROOM (OUTSIDE IMAGINGROOM)
- N. XENALERT & XENON TRAP
- O. IMAGING ROOM DOORWAY
- P. HOT LABDOORWAY
- Q. IMAGING ROOM FLOOR

BATH ROOM (W)

BLOOD GAS

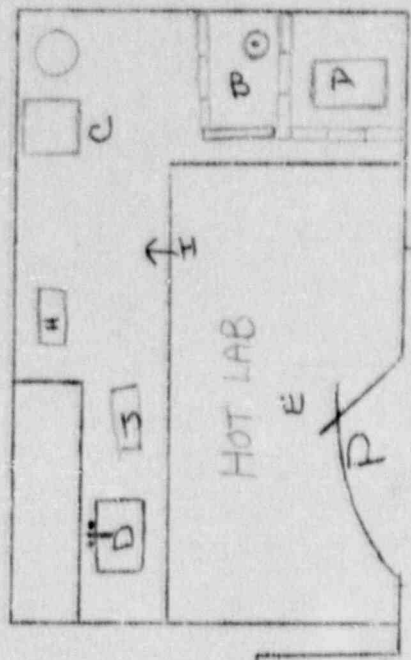

BATH ROOM (U)

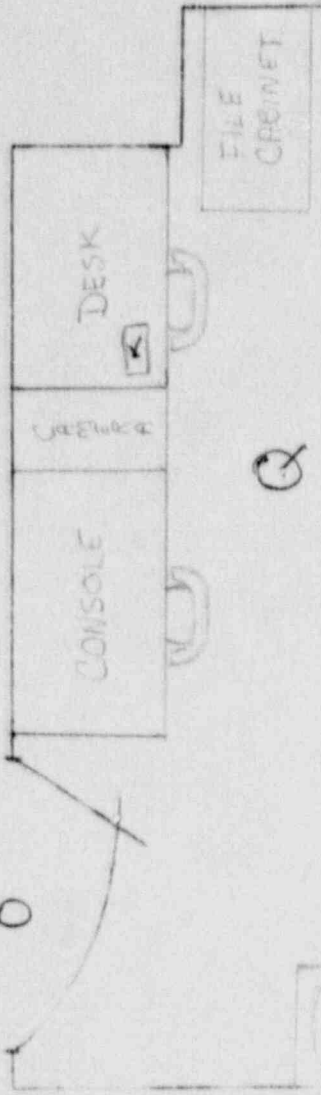

IMAGING ROOM

F

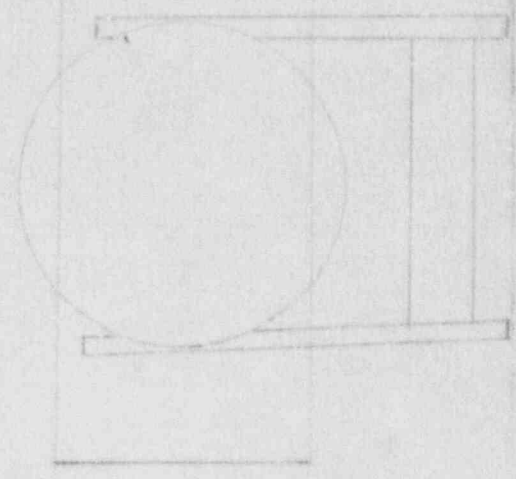

O

G

N

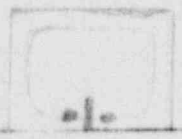

(FOR LFMS USE)
INFORMATION FROM LTS

BETWEEN:

LICENSE FEE MANAGEMENT BRANCH, ARM
AND
REGIONAL LICENSING SECTIONS

PROGRAM CODE: 02120
STATUS CODE: 1
FEE CATEGORY: 7C
EXP. DATE: 19880131
FEE COMMENTS:

Renewal was 108327

LICENSE FEE TRANSMITTAL

A. REGION 7

1. APPLICATION ATTACHED

APPLICANT/LICENSEE: BEFBE HOSPITAL OF SUSSEX CTY., INC.
RECEIVED DATE: 880531
DOCKET NO: 3013331
CONTROL NO.: 109509
LICENSE NO.: 07-17792-01
ACTION TYPE: AMENDMENT

2. FEE ATTACHED

AMOUNT: \$120.00
CHECK NO.: 2452

3. COMMENTS

SIGNED [Signature]
DATE 88/09/16

B. LICENSE FEE MANAGEMENT BRANCH (CHECK WHEN MILESTONE 03 IS ENTERED 14)

1. FEE CATEGORY AND AMOUNT: 7C \$120

2. CORRECT FEE PAID. APPLICATION MAY BE PROCESSED FOR:

AMENDMENT ✓
RENEWAL _____
LICENSE _____

3. OTHER _____

SIGNED [Signature]
DATE 10/3/88