

APPLICATION FOR MATERIAL LICENSE

INSTRUCTIONS: SEE THE APPROPRIATE LICENSE APPLICATION GUIDE FOR DETAILED INSTRUCTIONS FOR COMPLETING APPLICATION. SEND TWO COPIES OF THE ENTIRE COMPLETED APPLICATION TO THE NRC OFFICE SPECIFIED BELOW.

FEDERAL AGENCIES FILE APPLICATIONS WITH:

U.S. NUCLEAR REGULATORY COMMISSION
DIVISION OF FUEL CYCLE AND MATERIAL SAFETY, NMSS
WASHINGTON, DC 20555

ALL OTHER PERSONS FILE APPLICATIONS AS FOLLOWS, IF YOU ARE LOCATED IN:

CONNECTICUT, DELAWARE, DISTRICT OF COLUMBIA, MAINE, MARYLAND, MASSACHUSETTS, NEW HAMPSHIRE, NEW JERSEY, NEW YORK, PENNELVANIA, RHODE ISLAND, OR VERMONT, SEND APPLICATIONS TO:

U.S. NUCLEAR REGULATORY COMMISSION, REGION I
NUCLEAR MATERIAL SECTION B
631 PARK AVENUE
KING OF PRUSSIA, PA 19406

ALABAMA, FLORIDA, GEORGIA, KENTUCKY, MISSISSIPPI, NORTH CAROLINA, PUERTO RICO, SOUTH CAROLINA, TENNESSEE, VIRGINIA, VIRGIN ISLANDS, OR WEST VIRGINIA, SEND APPLICATIONS TO:

U.S. NUCLEAR REGULATORY COMMISSION, REGION II
MATERIAL RADIATION PROTECTION SECTION
101 MARIETTA STREET, SUITE 2900
ATLANTA, GA 30323

IF YOU ARE LOCATED IN:

ILLINOIS, INDIANA, IOWA, MICHIGAN, MINNESOTA, MISSOURI, OHIO, OR WISCONSIN, SEND APPLICATIONS TO:

U.S. NUCLEAR REGULATORY COMMISSION, REGION III
MATERIALS LICENSING SECTION
799 ROOSEVELT ROAD
GLEN ELLYN, IL 60137

ARKANSAS, COLORADO, IDAHO, KANSAS, LOUISIANA, MONTANA, NEBRASKA, NEW MEXICO, NORTH DAKOTA, OKLAHOMA, SOUTH DAKOTA, TEXAS, UTAH, OR WYOMING, SEND APPLICATIONS TO:

U.S. NUCLEAR REGULATORY COMMISSION, REGION IV
MATERIAL RADIATION PROTECTION SECTION
811 RYAN PLAZA DRIVE, SUITE 1000
ARLINGTON, TX 76011

ALASKA, ARIZONA, CALIFORNIA, HAWAII, NEVADA, OREGON, WASHINGTON, AND U.S. TERRITORIES AND POSSESSIONS IN THE PACIFIC, SEND APPLICATIONS TO:

U.S. NUCLEAR REGULATORY COMMISSION, REGION V
MATERIAL RADIATION PROTECTION SECTION
1450 MARIA LANE, SUITE 210
WALNUT CREEK, CA 94596

PERSONS LOCATED IN AGREEMENT STATES SEND APPLICATIONS TO THE U.S. NUCLEAR REGULATORY COMMISSION ONLY IF THEY WISH TO POSSESS AND USE LICENSED MATERIAL IN STATES SUBJECT TO U.S. NUCLEAR REGULATORY COMMISSION JURISDICTION.

1. THIS IS AN APPLICATION FOR (Check appropriate item)

- A. NEW LICENSE
 B. AMENDMENT TO LICENSE NUMBER _____
 C. RENEWAL OF LICENSE NUMBER _____

2. NAME AND MAILING ADDRESS OF APPLICANT (Include Zip Code)

Puerto Rican Cement Co. Inc.
P. O. Box 1349
Ponce, P.R. 00735

3. ADDRESS(ES) WHERE LICENSED MATERIAL WILL BE USED OR POSSESSED.

Puerto Rican Cement Co. Inc.
State Road #10 Km 9.1
Ponce, P.R.

4. NAME OF PERSON TO BE CONTACTED ABOUT THIS APPLICATION

Manuel Charlin

TELEPHONE NUMBER

(809) 842-3000

SUBMIT ITEMS 5 THROUGH 11 ON 8 1/2 x 11" PAPER. THE TYPE AND SCOPE OF INFORMATION TO BE PROVIDED IS DESCRIBED IN THE LICENSE APPLICATION GUIDE.

5. RADIOACTIVE MATERIAL
a. Element and mass number, b. chemical and/or physical form, and c. maximum amount which will be possessed at any one time.

6. PURPOSE(S) FOR WHICH LICENSED MATERIAL WILL BE USED.

7. INDIVIDUAL(S) RESPONSIBLE FOR RADIATION SAFETY PROGRAM AND THEIR TRAINING AND EXPERIENCE.

8. TRAINING FOR INDIVIDUALS WORKING IN OR FREQUENTING RESTRICTED AREAS.

9. FACILITIES AND EQUIPMENT.

10. RADIATION SAFETY PROGRAM

11. WASTE MANAGEMENT.

12. LICENSEE FEES (See 10 CFR 170 and Section 170.31)

FEE CATEGORY 3P AMOUNT ENCLOSED \$ 230.00

13. CERTIFICATION. (Must be completed by applicant) THE APPLICANT UNDERSTANDS THAT ALL STATEMENTS AND REPRESENTATIONS MADE IN THIS APPLICATION ARE BINDING UPON THE APPLICANT.

THE APPLICANT AND ANY OFFICIAL EXECUTING THIS CERTIFICATION ON BEHALF OF THE APPLICANT, NAMED IN ITEM 2, CERTIFY THAT THIS APPLICATION IS PREPARED IN CONFORMITY WITH TITLE 10, CODE OF FEDERAL REGULATIONS, PARTS 30, 32, 33, 34, 35, AND 40 AND THAT ALL INFORMATION CONTAINED HEREIN, IS TRUE AND CORRECT TO THE BEST OF THEIR KNOWLEDGE AND BELIEF.

WARNING: 18 U.S.C. SECTION 1001 ACT OF JUNE 25, 1948, 62 STAT. 749 MAKES IT A CRIMINAL OFFENSE TO MAKE A WILLFULLY FALSE STATEMENT OR REPRESENTATION TO ANY DEPARTMENT OR AGENCY OF THE UNITED STATES AS TO ANY MATTER WITHIN ITS JURISDICTION.

SIGNATURE - CERTIFYING OFFICER

Jose J. Suarez, Jr.

TYPED/PRINTED NAME

Jose J. Suarez, Jr.

TITLE

Exec. V.P. Operations

DATE

7/19/89

14. ANNUAL RECEIPTS

< \$250K	\$1M - 3.5M
\$250K - 500K	\$3.5M - 7M
\$500K - 750K	\$7M - 10M
\$750K - 1M	> \$10M

b. NUMBER OF EMPLOYEES (Total for entire facility excluding outside contractors)

c. NUMBER OF BEDS

d. WOULD YOU BE WILLING TO FURNISH COST INFORMATION (Dollar and/or 1099 hours) ON THE ECONOMIC IMPACT OF CURRENT NRC REGULATIONS OR ANY FUTURE PROPOSED NRC REGULATIONS THAT MAY AFFECT YOU? (NRC regulations permit it to protect confidential commercial or financial - proprietary - information furnished to the agency in confidence)

YES

NO

FOR NRC USE ONLY

TYPE OF FEE	FEE LOG	FEE CATEGORY	COMMENTS
App	Jul-5-II	3P	
AMOUNT RECEIVED	CHECK NUMBER		
\$230	53827		

APPROVED BY

M. Meser

DATE

7/28/89

9001160296 890825

REG2 LIC30

52-25063-01

PDR

PUERTO RICAN CEMENT CO., INC.
APPLICATION FOR MATERIAL LICENSE

ITEM 5- RADIO ACTIVE MATERIAL

- (A) CS-137
- (B) SEALED SOURCES
- (C) Maximum amount which will be possessed at any one time: 4000 Millicuries. For use in two (2) Kay-Ray Model 4800F Gamma Single Point Level System with the the following components:

- Model 7063 PS Gamma Source housing (6 in. x 10 deg.)
 - Model 7700-2000 Gamma Source - 2000 Millicuries of CS-137 in each sealed source.
 - Model 7353A detector electronics.

These Kay-Ray devices have been evaluated and approved for licensing purposes and authorized for distribution under a license issued by the Nuclear Regulatory Commission or an Agreement State.

ITEM 6 PURPOSE FOR WHICH LICENSED MATERIAL WILL BE USED.

- (A) To measure level in rotary kiln preheater vessels.

PUERTO RICAN CEMENT CO., INC.
APPLICATION FOR MATERIAL LICENSE

ITEM 7 INDIVIDUALS RESPONSIBLE FOR RADIATION SAFETY PROGRAM
AND THEIR TRAINING AND EXPERIENCE.

Name	Position	Training
1.Hector Pages	Shift Superintendent	None
2.Hiran Garastazu	" "	None
3.Raul Vega	" "	None
4.Enrique Rivera	" "	None
5.Florentino Perez	" "	None
6.Abilio Pabey	" "	None
7.Angel Rodriguez	Safety Supervisor	None
8. Pedro Rodriguez, EE	Electrical Dept Head.	None
9. Carlos Perez, EE	Electrical Engineer	None
10.Ramon Santiago	Instrument Supervisor	None
11.Santiago Alvarez	Asst. Plant Manager	None
12.Elwin Perez	Chemical Engineer	None
13.Jose Santiago	Kiln Supervisor	None
14.Manuel Charlin	Instrument Supervisor	(see below)

Ohmart Training course in the use and applications of Nuclear gauges including the safe handling of Radioactive isotopes.

The Ohmart Corp. Cincinnati, Ohio 4/15/66
Managed three Ohmart Density Gauges for approximately 15 years until sources returned to Ohmart for disposal.

PUERTO RICAN CEMENT CO., INC.
APPLICATION FOR MATERIAL LICENSE

ITEM 7 (Continued) INDIVIDUALS RESPONSIBLE FOR RADIATION
SAFETY PROGRAM AND THEIR TRAINING & EXPERIENCE

At the time of start-up a representative of the manufacturer will provide any specific training necessary for the safe operation of the system. Radiation protection procedures have previously been devised and submitted. As the scope of this license does not include handling of the device containing Radioactive materials, further formal training is not indicated.

It is further understood that the gauges will not be operated until the training has been received and that records of the training received will be maintained for at least 5 years after the training has been completed for each named individual.

ITEM 8 TRAINING FOR INDIVIDUALS WORKING IN OR FREQUENTING
RESTRICTED AREAS.

The devices covered by this license application will not be installed in restricted areas however any and all employees who will for any reason have occasion to operate any of these devices will attend the training program and receive the necessary instruction to be given at the time of installation.

PUERTO RICAN CEMENT CO., INC.
APPLICATION FOR MATERIAL LICENSE

ITEM 9-FACILITIES AND EQUIPMENT

(1) The enclosed sketches give the specifics of the installation. All equipment will be located and mounted in accordance with the recommendations of the manufacturer.

(2) Environmental conditions:

Temperature - Ambient to approximately 250 degs. F.

Atmosphere - Normal urban tropical, non-corrosive.

Vibration - Little to none

(3) Since the ambient temperature of the source housing will NOT exceed 400 degrees F. No cooling system will be required.

(4) Maintenance of gauges: Initial Radiation survey, servicing, maintenance, relocation and repair of source housing will be performed by Kay-Ray.

(5) Emergency Procedure: The enclosed procedure will be followed in the event of damage to the source housing.

ITEM 10- RADIATION SAFETY PROGRAM

10-1 Radiation safety program services will be carried out by the Kay-Ray Inc. of 1400 Business Center Drive Mt. Prospect, IL 60056. Telephone (312) 803-5100.
License Number 12-11134-01.

10-2 Personnel monitoring devices are not necessary. For supporting documentation see the description of the radioactive protection program.

EXHIBIT A

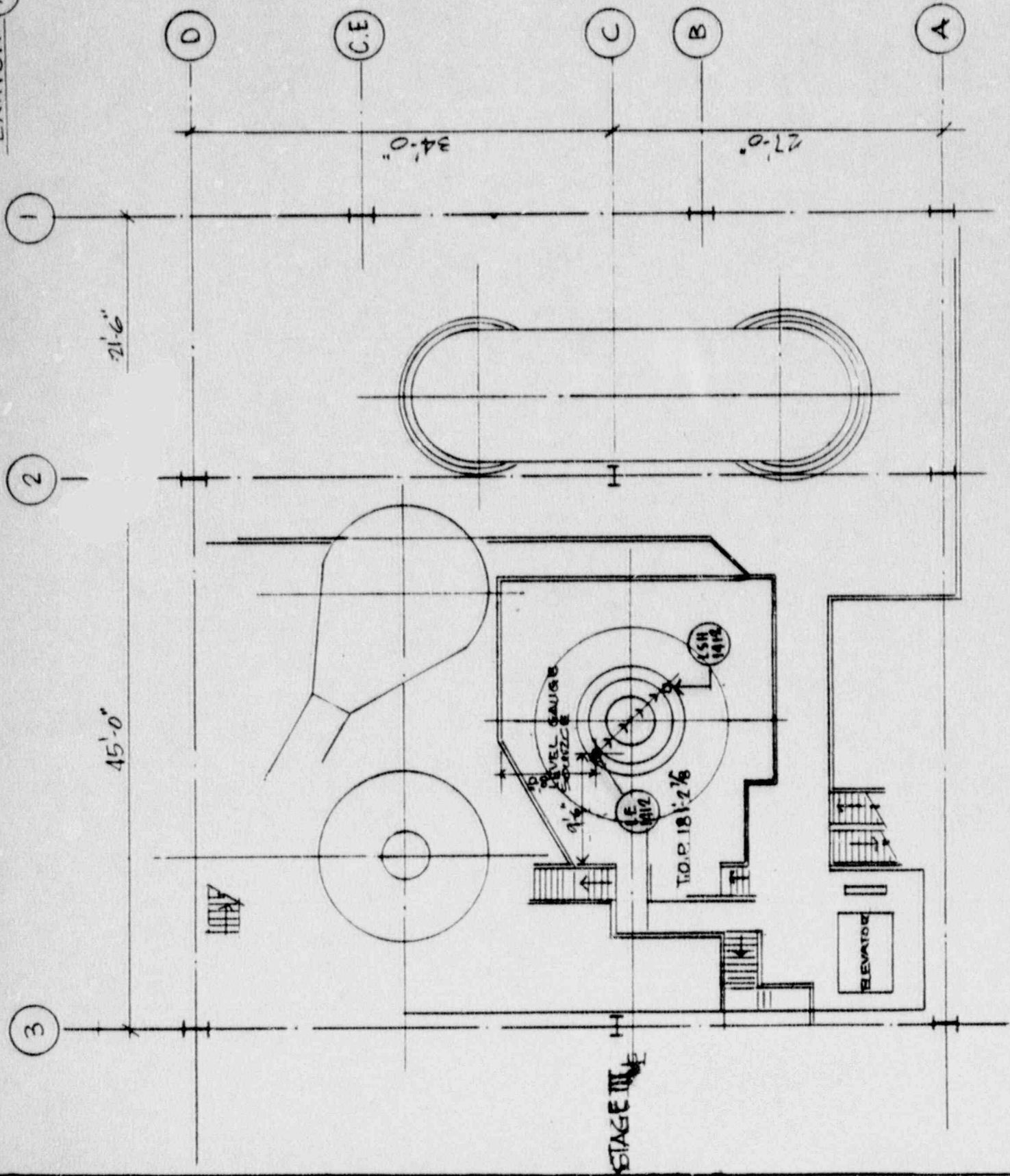

PUERTO RICAN CEMENT CO. INC.

PLAUTOS. 175'-11 7/8"

PUERTO RICAN CEMENT CO. INC.

POUCE, P. R.
SK-7.12.89 *Altera.*

EXHIBIT

(A1)

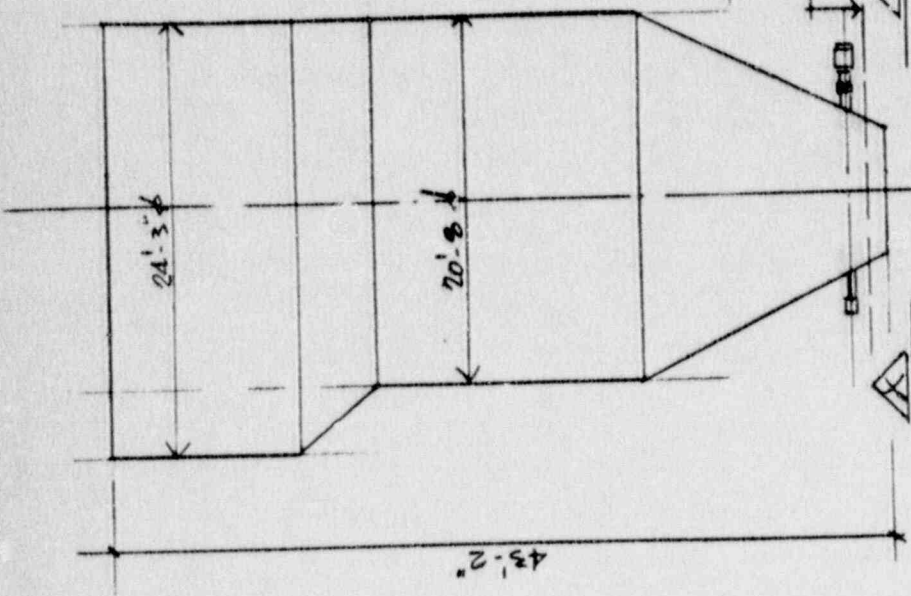

ELEVATION

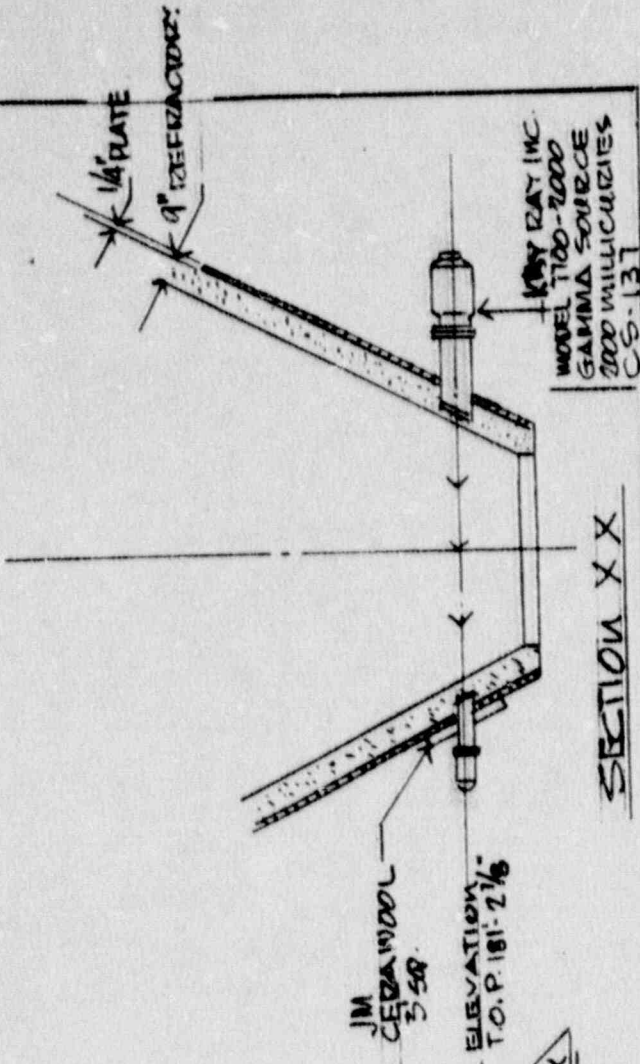

SECTION XX

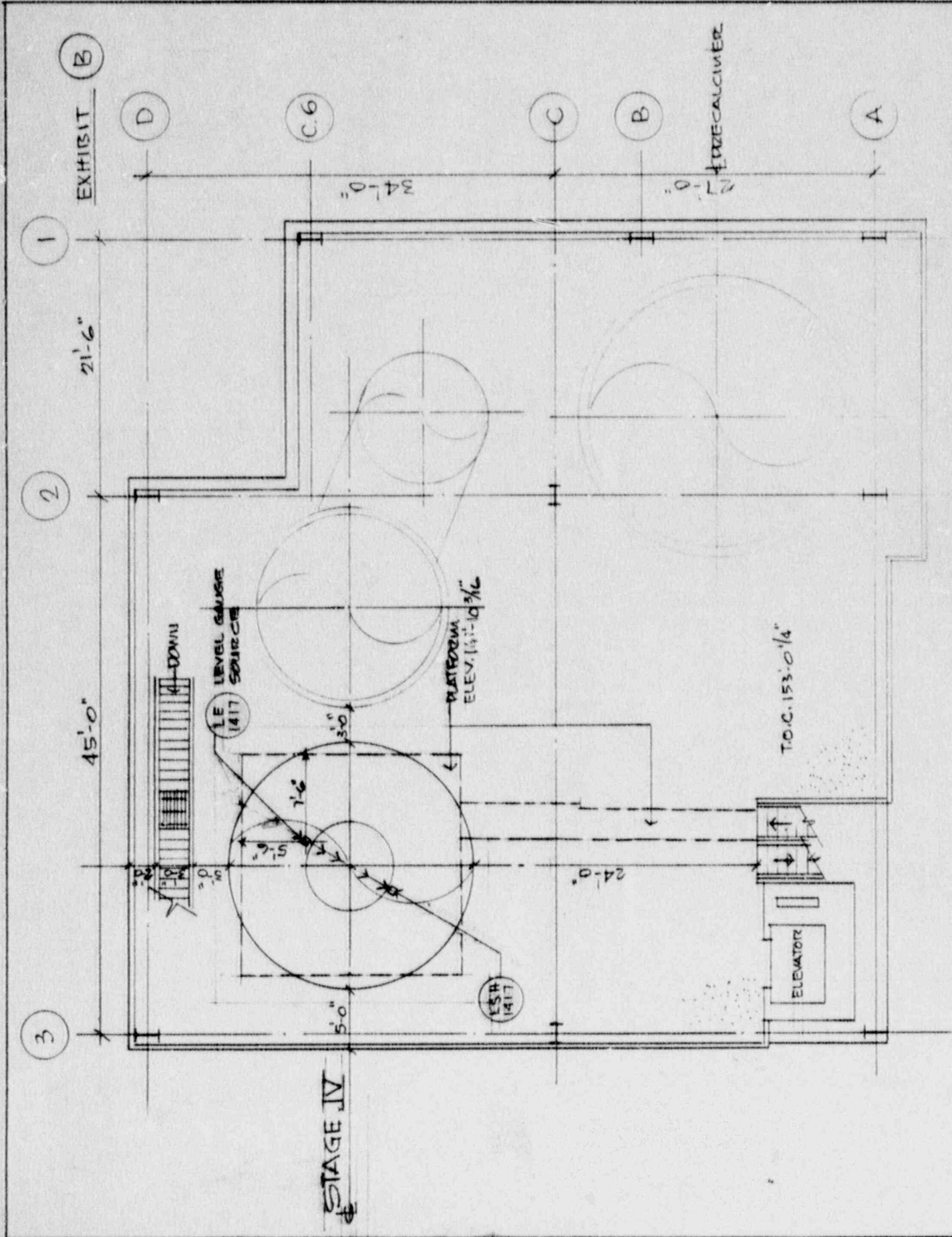

PLAN AT T.O.C. 153'-0 1/4" DUERTO RIZCAN CEMENT CO. INC.

DUEIZTO RIKAN CEMENT CO. INC.

PONCE, P.R.

SK. 7.12.89

U. DEZZA

EXHIBIT (B1)

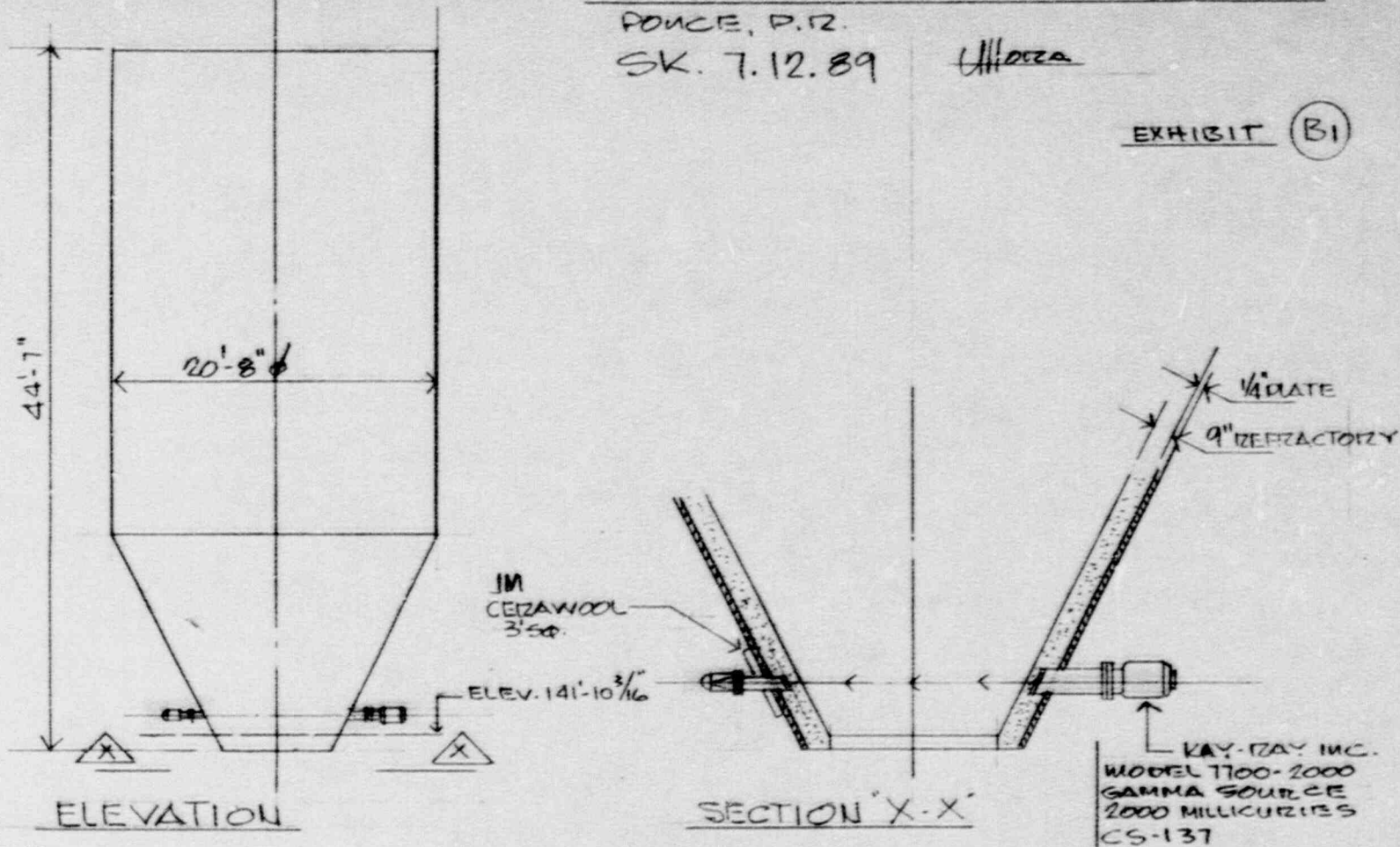

**EMERGENCY PROCEDURE TO BE FOLLOWED AFTER
DAMAGE TO KAY-RAY SOURCE HOUSING**

1. This procedure applies to all instances where damage is incurred by the source holder due to such action as fire, etc.
2. Immediately rope off the area around the source holder. Use the following formula to determine the rope off radius in feet.

For Cesium 137,	R = 0.84 A
For Cobalt 60,	R = 1.69 A
For Americium Beryllium 241,	R = 0.22 A

where A = activity in millicuries (mCi)
and R = rope-off radius in feet (ft.)

For example: if you have a 100 mCi Cs 137 source,
R = (0.84) (100) = 8.4 ft. radius

3. Inform Plant Radiation Protection Officer of person responsible for the use of the source as to the situation.
4. Inform by phone or telegram the proper Regional NRC Office of the accident.
5. Notify Kay-Ray at 800/323-7594 or 312/520-1100 if their assistance is desired.
6. Limit access to source housing until a radiation survey and source wipe can be performed by a qualified personnel or a representative.

ROPE-OFF RADIUS, FT.

<u>Activity, mCi</u>	<u>Cs137</u>	<u>Co60</u>	<u>Am241Be</u>
1	1	--	--
5	2	--	--
10	3	--	--
25	4 1/2	8 1/2	--
50	6	12	--
100	8 1/2	17	--
200	12	24	--
500	19	38	5
1000	27	54	7
2000	38	76	10
3000	46 1/2	93	--
5000	60	--	--
10000	84 1/2	--	--

PUERTO RICAN CEMENT CO., INC.
APPLICATION FOR MATERIAL LICENSE

ITEM 10 CONTINUED-RADIATION SAFETY PROGRAM

10-3 Radiation Detection Instruments.

A calibrated, operable survey meter that can measure at least 1.0 through 200 milliroentgens per hour will be available. This instrument will be (1) calibrated so that the readings are +/- 10% of the actual values over the range of the instrument (2) have a calibration chart or graph that shows the results of the calibration, the date of the last calibration affixed to the survey meter, and (3) be calibrated at least annually and after servicing.

Calibration records will be kept a minimum of 2 years after each calibration.

Calibration of survey meter is to be performed by Kay-Ray Inc., 1400 Business Center Drive, Mt. Prospect Il 60056. License No. 12-11184-01.

10-4 Leak-Testing

Kay-Ray will perform the leak testing on the source housing under option 2. The leak-test used by Kay-Ray is the Kay-Ray Inc. Model A kit, which has been approved by the NRC for use in the source wiping of Kay-Ray source housings. We wish to have our license worded to allow a 3 year source wipe interval on the devices listed above. An extension has been granted to Kay-Ray allowing a 3 year interval for source wiping, and we wish to have our license reflect this extended test period.

PUERTO RICAN CEMENT CO., INC.
APPLICATION FOR MATERIAL LICENSE

10-5 Lock-Out Procedures

If maintenance is required inside the vessel, a lockout procedure will be employed to prevent personnel access within the vessel whenever the source is in the "measure" (on) position.

Basically the procedure consists of having all access doors to the vessels locked with a key kept by the responsible person for the radiation safety program on duty at the time (shift superintendent).

If operating personnel desire access into the vessel the responsible person would be notified and he would make sure that the source housing(s) are locked "store" (off) position before allowing the access doors to be opened. This procedure will be posted so that personnel can see them.

ITEM 11- WASTE MANAGEMENT

Disposal of licensed material will be by transfer to a licensee specifically authorized to possess the radioactive material. Sealed source and device will be transferred to supplier for disposal or authorized disposal firm.