

APPLICATION FOR MATERIAL LICENSE

030-13596

INSTRUCTIONS: SEE THE APPROPRIATE LICENSE APPLICATION GUIDE FOR DETAILED INSTRUCTIONS FOR COMPLETING APPLICATION. SEND TWO COPIES OF THE ENTIRE COMPLETED APPLICATION TO THE NRC OFFICE SPECIFIED BELOW.

APPLICATIONS FOR DISTRIBUTION OF EXEMPT PRODUCTS FILE APPLICATIONS WITH:

U.S. NUCLEAR REGULATORY COMMISSION
DIVISION OF FUEL CYCLE AND MATERIAL SAFETY, NMSS
WASHINGTON, DC 20556

ALL OTHER PERSONS FILE APPLICATIONS AS FOLLOWS, IF YOU ARE LOCATED IN:

CONNECTICUT, DELAWARE, DISTRICT OF COLUMBIA, MAINE, MARYLAND, MASSACHUSETTS, NEW HAMPSHIRE, NEW JERSEY, NEW YORK, PENNSYLVANIA, RHODE ISLAND, OR VERMONT, SEND APPLICATIONS TO:

U.S. NUCLEAR REGULATORY COMMISSION, REGION I
NUCLEAR MATERIALS SAFETY SECTION B
475 ALLENDALE ROAD
KING OF PRUSSIA, PA 19406

ALABAMA, FLORIDA, GEORGIA, KENTUCKY, MISSISSIPPI, NORTH CAROLINA, PUERTO RICO, SOUTH CAROLINA, TENNESSEE, VIRGINIA, VIRGIN ISLANDS, OR WEST VIRGINIA, SEND APPLICATIONS TO:

U.S. NUCLEAR REGULATORY COMMISSION, REGION II
NUCLEAR MATERIALS SAFETY SECTION
101 MARIETTA STREET, SUITE 2900
ATLANTA, GA 30323

IF YOU ARE LOCATED IN:

ILLINOIS, INDIANA, IOWA, MICHIGAN, MINNESOTA, MISSOURI, OHIO, OR WISCONSIN, SEND APPLICATIONS TO:

U.S. NUCLEAR REGULATORY COMMISSION, REGION III
MATERIALS LICENSING SECTION
799 ROOSEVELT ROAD
GLEN ELLYN, IL 60137

ARKANSAS, COLORADO, IDAHO, KANSAS, LOUISIANA, MONTANA, NEBRASKA, NEW MEXICO, NORTH DAKOTA, OKLAHOMA, SOUTH DAKOTA, TEXAS, UTAH, OR WYOMING, SEND APPLICATIONS TO:

U.S. NUCLEAR REGULATORY COMMISSION, REGION IV
MATERIAL RADIATION PROTECTION SECTION
611 RYAN PLAZA DRIVE, SUITE 1000
ARLINGTON, TX 76011

ALASKA, ARIZONA, CALIFORNIA, HAWAII, NEVADA, OREGON, WASHINGTON, AND U.S. TERRITORIES AND POSSESSIONS IN THE PACIFIC, SEND APPLICATIONS TO:

U.S. NUCLEAR REGULATORY COMMISSION, REGION V
NUCLEAR MATERIALS SAFETY SECTION
1460 MARIA LANE, SUITE 210
WALNUT CREEK, CA 94596

PERSONS LOCATED IN AGREEMENT STATES SEND APPLICATIONS TO THE U.S. NUCLEAR REGULATORY COMMISSION ONLY IF THEY WISH TO POSSESS AND USE LICENSED MATERIAL IN STATES SUBJECT TO U.S. NUCLEAR REGULATORY COMMISSION JURISDICTION.

1. THIS IS AN APPLICATION FOR (Check appropriate item)

- A. NEW LICENSE
- B. AMENDMENT TO LICENSE NUMBER _____
- C. RENEWAL OF LICENSE NUMBER 06-17892-01

2. NAME AND MAILING ADDRESS OF APPLICANT (Include Zip Code)

New Milford Hospital, Inc.
21 Elm Street
New Milford, Ct. 06776

3. ADDRESS(ES) WHERE LICENSED MATERIAL WILL BE USED OR POSSESSED.

New Milford Hospital, Inc.
21 Elm Street
New Milford, Ct. 06776

RECEIVED
88 AUG -8 AM 11:25

4. NAME OF PERSON TO BE CONTACTED ABOUT THIS APPLICATION

Robert Lange, Ph.D.

TELEPHONE NUMBER

(203) 785 - 6147

SUBMIT ITEMS 5 THROUGH 11 ON 8 1/2 x 11" PAPER. THE TYPE AND SCOPE OF INFORMATION TO BE PROVIDED IS DESCRIBED IN THE LICENSE APPLICATION GUIDE.

5. RADIOACTIVE MATERIAL

a. Element and mass number, b. chemical and/or physical form, and c. maximum amount which will be possessed at any one time. **See attached**

6. PURPOSE(S) FOR WHICH LICENSED MATERIAL WILL BE USED.

See attached

7. INDIVIDUAL(S) RESPONSIBLE FOR RADIATION SAFETY PROGRAM AND THEIR TRAINING AND EXPERIENCE.

Jules White, M.D.

8. TRAINING FOR INDIVIDUALS WORKING IN OR FREQUENTING RESTRICTED AREAS.

See attached

9. FACILITIES AND EQUIPMENT.

See attached

10. RADIATION SAFETY PROGRAM. See attached

11. WASTE MANAGEMENT.

See attached

12. LICENSEE FEES (See 10 CFR 170 and Section 170.31)

FEE CATEGORY **7.C.** AMOUNT ENCLOSED **\$ 580.00**

13. CERTIFICATION. (Must be completed by applicant) THE APPLICANT UNDERSTANDS THAT ALL STATEMENTS AND REPRESENTATIONS MADE IN THIS APPLICATION ARE BINDING UPON THE APPLICANT.

THE APPLICANT AND ANY OFFICIAL EXECUTING THIS CERTIFICATION ON BEHALF OF THE APPLICANT, NAMED IN ITEM 2, CERTIFY THAT THIS APPLICATION IS PREPARED IN CONFORMITY WITH TITLE 10, CODE OF FEDERAL REGULATIONS, PARTS 30, 32, 33, 34, 35, AND 40 AND THAT ALL INFORMATION CONTAINED HEREIN, IS TRUE AND CORRECT TO THE BEST OF THEIR KNOWLEDGE AND BELIEF.

WARNING: 18 U.S.C. SECTION 1001 ACT OF JUNE 25, 1948, 62 STAT. 749 MAKES IT A CRIMINAL OFFENSE TO MAKE A WILLFULLY FALSE STATEMENT OR REPRESENTATION TO ANY DEPARTMENT OR AGENCY OF THE UNITED STATES AS TO ANY MATTER WITHIN ITS JURISDICTION.

SIGNATURE—CERTIFYING OFFICER

TYPED/PRINTED NAME

TITLE

DATE

Richard E. Pugh

President

7/15/88

9001120097 880014
REG1 LIC30
06-17892-01 PDR

RECEIVED
JUL 22 11 23 AM '88

FOR NRC USE ONLY

TYPE OF FEE REN	FEE LC Aug 8 88	FEE CATEGORY 7C	COMMENTS ML10. 109311	APPROVED BY
AMOUNT RECEIVED \$ 580	CHECK NUMBER 39548	"OFFICIAL RECORD COPY"		DATE 8/11/88

22 JUL 1988

U S NRC LICENSE RENEWAL APPLICATION

License Number 06-17892-01

New Milford Hospital

New Milford, CT 06776

Page 1 of 4 pages.

ITEMS 5 and 6: Byproduct materials for medical use:

<u>Item No.</u>	<u>Byproduct Material</u>	<u>Amount</u>	<u>Item No.</u>	<u>Purpose</u>
5. a	Material in § 35.100	As needed	6. a	Medical use
5. b	Material in § 35.200	As needed	6. b	Medical use
5. c	Material in § 35.300	As needed	6. c	Medical use

ITEM 7: Individuals responsible for Radiation Safety Programs.

7.1 Authorized Users for Medical Use: Jules White, MD who has been an Authorized User on this License.

7.3 Radiation Safety Officer: Jules White, MD, Director of Nuclear Medicine Service.

ITEM 8: Training for individuals working in or frequenting Restricted Areas.

8.1 Training Program: We will establish and implement the model training program that was published in Appendix A to Regulatory Guide 10.8, Revision 2, as follows:

<u>Worker Group</u>	<u>Training Method</u>	<u>Frequency of Training</u>
Nuclear Medicine staff workers	lectures	At start of employment and annually thereafter.
Ancillary Personnel, nurses, housekeeping personnel who frequent Nuclear Medicine area.	lectures	At start of employment and annually thereafter.

ITEM 9: Facilities and Equipment

9.1 An annotated drawing of the Nuclear Medicine Clinic Area is appended as ATT 9.1.

U.S. NRC LICENSE RENEWAL APPLICATION

License Number 06-17892-01

New Milford Hospital

New Milford, CT 06776

Page 2 of 4 pages.

9.2 Survey Instrument Calibration : We will establish and implement the model procedure for calibrating survey instruments that was published in Appendix B to Regulatory Guide 10.8, Revision 2.

9.3 Dose Calibrator Calibration : We will establish and implement the model procedure for calibrating our dose calibrator that was published in Appendix C to Regulatory Guide 10.8, Revision 2., except that the data will not be plotted on graph paper, but compared with the calculated activity of the Tc-99m source, using the measured activity at approximately 30 hours after the start of the linearity test as the base activity for the calculations to determine the accuracy of the linearity test.

9.3 Personnel Monitoring Program : We will establish and implement the model personnel external exposure monitoring program published in Appendix D to Regulatory Guide 10.8, Revision 2.

9.5 Mobile Imaging Equipment: N/A.

9.6 Other Equipment and Facilities: N/A.

ITEM 10: Radiation Safety Program

10.1 Radiation Safety Committee/Radiation Safety Officer: We will issue the model Radiation Safety Committee Charter and Radiation Safety Officer Delegation of Authority that was published in Appendix F to Regulatory Guide 10.8, Revision 2.

10.2 ALARA Program: We will establish and implement the model ALARA program that was published in Appendix G to Regulatory Guide 10.2, Revision 2.

U S NRC LICENSE RENEWAL APPLICATION

License Number 06-17892-01

New Milford Hospital

New Milford, CT 06776

Page 3 of 4 pages.

10.3 Leak Testing: We will establish and implement the model procedure for leak testing sealed sources that was published in Appendix H to Regulatory Guide 10.2, Revision 2.

10.4 Safe Use of Radiopharmaceuticals: We will establish and implement the model safety rules published in Appendix I to Regulatory Guide 10.2, Revision 2.

10.5 Spill Procedures: We will establish and implement the model spill procedures published in Appendix J to Regulatory Guide 10.2, Revision 2.

10.6 Ordering and Receiving: We will establish and implement the model guidance for ordering and receiving radioactive material that was published in Appendix K to Regulatory Guide 10.2, Revision 2.

10.7 Opening Packages: We will establish and implement the model procedure for opening packages that was published in Appendix L to Regulatory Guide 10.2, Revision 2.

10.8 Unit Dosage Records: We will establish and implement the model procedure for a unit dosage record system that was published in Appendix M.1 to Regulatory Guide 10.8, Revision 2.

10.9 Multidose Vial Records: We will establish and implement the model procedure for a multidose vial record system that was published in Appendix M.2 to Regulatory Guide 10.2, Revision 2.

10.10 Molybdenum - 99 Concentration Records: We will establish and implement the model procedure for measuring and recording molybdenum-99 concentrations that was published in Appendix M.3 to Regulatory Guide 10.2, Revision 2.

10.11 Implant Source Use Records: N/A.

U S NRC LICENSE RENEWAL APPLICATION

License Number 06-17892-01

New Milford Hospital

New Milford, CT 06776

Page 4 of 4 pages.

10.12 Area Survey Procedures: We will establish and implement the model procedure for area surveys that was published in Appendix N to Regulatory Guide 10.2, Revision 2.

10.13 Air Concentration Control:

10.13.1 Worker dose from noble gases: We will collect spent noble gas in a shielded container and will establish and implement the model procedures for checking trap effluent that was published in Appendix O.3 to Regulatory Guide 10.8, Revision 2. We will follow the model procedure for calculating worker dose from noble gases that was published in Appendix O.1 to Regulatory Guide 10.8, Revision 2.

10.13.3 Public dose from airborne effluent: We will follow the model procedure for calculating airborne effluent concentration that was published in Appendix O.2 to Regulatory Guide 10.8, Revision 2. We will calculate spilled gas clearance times according to the procedure that was published in Appendix O.4 to Regulatory Guide 10.8, Revision 2.

ITEM 11: Waste Management

11.1 Waste Disposal: We will establish and implement the general guidance and model procedures for waste disposal that was published in Appendix R to Regulatory Guide 10.2, Revision 2.

ITEM 12: License Fees: The fee category is 7.C. The License renewal fee is \$580.

File Room

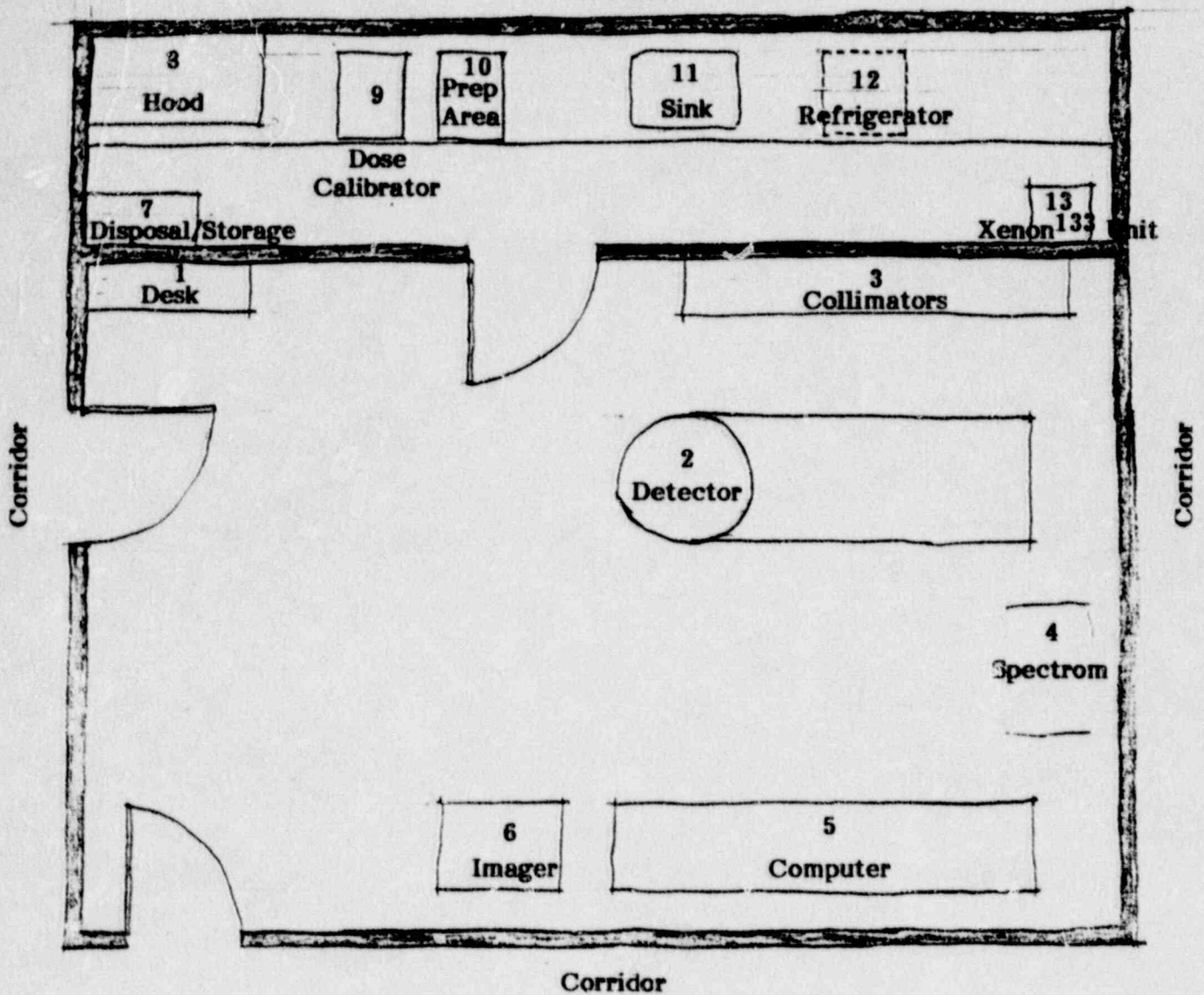

- Area 7 Waste Disposal storage area shielded with 1/8" of lead on all surfaces.
- Area 8 Hooded storage area shielded with 2" of lead on four sides with 3 courses of lead bricks.
- Area 10 Preparation area shielded by commercially manufactured L-Block equipped with equivalent thickness lead window. Shielding equivalent to 1/2" lead.
- Area 12 Refrigerated storage area shielded with 1/16" of lead on all surfaces.

College of Physicians & Surgeons of Columbia University | New York, N.Y. 10032

DEPARTMENT OF RADIOLOGY

630 West 168th Street

February 24, 1983

To Whom It May Concern

Dr. Philip M. Johnson (Deceased) was Director of the Nuclear Medicine Department during Dr. White's training and Dr. William B. Seaman was the Chairman of the Department of Radiology.

Sincerely,

Mary Jane Ahearn
Department of Radiology

TRAINING AND EXPERIENCE
AUTHORIZED USER OR RADIATION SAFETY OFFICER

1. NAME OF AUTHORIZED USER OR RADIATION SAFETY OFFICER Jules White, M.D.	2. STATE OR TERRITORY IN WHICH LICENSED TO PRACTICE MEDICINE
---	--

3. CERTIFICATION

SPECIALTY BOARD A	CATEGORY B	MONTH AND YEAR CERTIFIED C
Amer. Board of Radiology	Diagnostic Radiology	June 1980
Amer. Board of Surgery	General Surgery	September 1964
Amer. Board of Thoracic Surgery	Thoracic Surgery	May 1966

4. TRAINING RECEIVED IN BASIC RADIOISOTOPE HANDLING TECHNIQUES

FIELD OF TRAINING A	LOCATION AND DATE(S) OF TRAINING B	TYPE AND LENGTH OF TRAINING	
		LECTURE / LABORATORY COURSES (Hours) C	SUPERVISED LABORATORY EXPERIENCE (Hours) D
a. RADIATION PHYSICS AND INSTRUMENTATION	July 1977 - June 1980 Columbia Presbyterian Medical Center, NYC	150	
b. RADIATION PROTECTION		50	
c. MATHEMATICS PERTAINING TO THE USE AND MEASUREMENT OF RADIOACTIVITY		30	
d. RADIATION BIOLOGY		25	
e. RADIOPHARMACEUTICAL CHEMISTRY		30	

5. EXPERIENCE WITH RADIATION. (Actual use of Radioisotopes or Equivalent Experience)

ISOTOPE	MAXIMUM AMOUNT	WHERE EXPERIENCE WAS GAINED	DURATION OF EXPERIENCE	TYPE OF USE
99 Mo-99m Tc	2 Ci	Columbia-Presbyterian	3 months	Diagnostic
¹³¹ I	100mCi	Columbia-Presbyterian	3 months	Therapy
⁶⁷ Ga	10mCi	Columbia-Presbyterian	3 months	Diagnostic
²⁰¹ Tl	10mCi	" "	3 months	Diagnostic

PRECEPTOR STATEMENT

Supplement B must be completed by the applicant physician's preceptor. If more than one preceptor is necessary to document experience, obtain a separate statement from each.

1. APPLICANT PHYSICIAN'S NAME AND ADDRESS			KEY TO COLUMN C PERSONAL PARTICIPATION SHOULD CONSIST OF: 1-Supervised examination of patients to determine the suitability for radioisotope diagnosis and/or treatment and recommendation for prescribed dosage. 2-Collaboration in dose calibration and actual administration of dose to the patient including calculation of the radiation dose, related measurements and plotting of data. 3-Adequate period of training to enable physician to manage radioactive patients and follow patients through diagnosis and/or course of treatment.
FULL NAME			
Jules White, M.D.			
STREET ADDRESS			
21 Elm Street			
CITY	STATE	ZIP CODE	
New Milford	CT	06776	

2. CLINICAL TRAINING AND EXPERIENCE OF ABOVE NAMED PHYSICIAN

ISOTOPE A	CONDITIONS DIAGNOSED OR TREATED B	NUMBER OF CASES INVOLVING PERSONAL PARTICIPATION C	COMMENTS (Additional information or comments may be submitted in duplicate on separate sheets.) D
I-131 or I-125	DIAGNOSIS OF THYROID FUNCTION	25	
	DETERMINATION OF BLOOD AND BLOOD PLASMA VOLUME	50	
	LIVER FUNCTION STUDIES		
	FAT ABSORPTION STUDIES		
	KIDNEY FUNCTION STUDIES	10	
IN VITRO STUDIES T ₃ T ₄	100		
OTHER			
I-125	DETECTION OF THROMBOSIS		
I-131	THYROID IMAGING	25	
P-32	EYE TUMOR LOCALIZATION		
Se-75	PANCREAS IMAGING		
Yb-169	CHEST RADIOGRAPHY		
Xe-133	BLOOD FLOW STUDIES AND PULMONARY FUNCTION STUDIES	30	
OTHER			
Tc-99m	BRAIN IMAGING	50	
	CARDIAC IMAGING	25	
	THYROID IMAGING		
	SALIVARY GLAND IMAGING		
	BLOOD POOL IMAGING		
	PLACENTA LOCALIZATION		
	LIVER AND SPLEEN IMAGING	75	
	LUNG IMAGING	50	
BONE IMAGING	100		
OTHER			

PRECEPTOR STATEMENT (Continued)

2. CLINICAL TRAINING AND EXPERIENCE OF ABOVE NAMED PHYSICIAN (Continued)

ISOTOPE A	CONDITIONS DIAGNOSED OR TREATED B	NUMBER OF CASES INVOLVING PERSONAL PARTICIPATION C	COMMENTS <i>(Additional information or comments may be submitted in duplicate on separate sheet.)</i> D
P-32 <i>(Soluble)</i>	TREATMENT OF POLYCYTHEMIA VERA, LEUKEMIA, AND BONE M...ASES	5	
P-32 <i>(Colloidal)</i>	INTRACAVITARY TREATMENT		
I-131	TREATMENT OF THYROID CARCINOMA	2	
	TREATMENT OF HYPERTHYROIDISM	5	
Au-198	INTRACAVITARY TREATMENT		
Co-60 or Cs-137	INTERSTITIAL TREATMENT		
	INTRACAVITARY TREATMENT		
I-125 or Ir-192	INTERSTITIAL TREATMENT		
	TELE THERAPY TREATMENT		
Co-60 or Cs-137	TELE THERAPY TREATMENT		
	TREATMENT OF EYE DISEASE		
	RADIOPHARMACEUTICAL PREPARATION		
Mo-99/ Tc-99m	GENERATOR	10	
Sn-113/ In-113m	GENERATOR		
Tc-99m	REAGENT KITS	100	
Other			

3. DATES AND TOTAL NUMBER OF HOURS RECEIVED IN CLINICAL RADIOISOTOPE TRAINING

July 1977 - June 1980 520 Hours

4. THE TRAINING AND EXPERIENCE INDICATED ABOVE WAS OBTAINED UNDER THE SUPERVISION OF:

a. NAME OF SUPERVISOR

Philip M. Johnson, M.D. (Deceased)

b. NAME OF INSTITUTION

Columbia Presbyterian Medical Center

c. MAILING ADDRESS

622 West 168th Street

d. CITY

New York, New York 10032

5. MATERIALS LICENSE NUMBER(S)

NYC 630-1

6. PRECEPTOR'S SIGNATURE

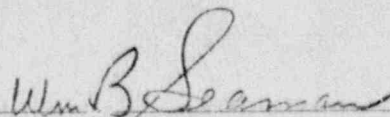

7. PRECEPTOR'S NAME (Please type or print)

William B. Seaman, M.D.

8. DATE

February 23, 1983

(FOR LFMS USE)
INFORMATION FROM LTS

BETWEEN:

LICENSE FEE MANAGEMENT BRANCH, ARM
AND
REGIONAL LICENSING SECTIONS

PROGRAM CODE: 03120
STATUS CODE: 2
FEE CATEGORY: 7C
EXP. DATE: 19880831 *Code 23*
FEE COMMENTS: _____

LICENSE FEE TRANSMITTAL

A. REGION *I*

1. APPLICATION ATTACHED

APPLICANT/LICENSEE: NEW MILFORD HOSPITAL, INC.
RECEIVED DATE: 880722
DOCKET NO: 3013596
CONTROL NO.: 109311
LICENSE NO.: 06-17892-01
ACTION TYPE: RENEWAL

2. FEE ATTACHED

AMOUNT: *\$580.00*
CHECK NO.: *38548*

3. COMMENTS

SIGNED *R. J. Brown*
DATE *88/08/04*

B. LICENSE FEE MANAGEMENT BRANCH (CHECK WHEN MILESTONE 03 IS ENTERED *1-5*)

1. FEE CATEGORY AND AMOUNT: *7C* *\$580*

2. CORRECT FEE PAID. APPLICATION MAY BE PROCESSED FOR:

AMENDMENT _____
RENEWAL _____
LICENSE _____

3. OTHER _____

SIGNED *S. Kimbrey*
DATE *8/11/88*