

bdcelectronics, inc.

P.O. Box 4996 • Midland, Texas 79704 • Tele: (915) 694-7887 • FAX: (915) 694-7952

November 21, 1988

U.S. Nuclear Regulatory Commission
Nuclear Materials Safety and Safeguard
M/S 6H3
Washington, D.C. 20555
Attn: Mr. Michael Lamastra

RE: Amendment to -
Material License No. 42-23668-01E

Log	Dec 7/88
Remitter	
Check No.	2909
Amount	\$120
Fee Category	3H
Type of Fee	AMD
Date Check	12/11/88
Date Completed	12/11/88
By	J. Kimberly

Dear Mr. Lamastra,

BDC Electronics, Inc. request to amend the above referenced license as follows:

1. Name and mailing address -
BDC Electronics, Inc.
P.O. Box 4996
Midland, TX 79704
2. Address(es) where licensed material will be used -
Maxtron Corporation BDC Electronics, Inc.
310 Regal Row and 100 So. County Rd. 1207
Dallas, TX 75247 Midland, TX 79701
3. Name of person to be contacted - Delete Steve Marshall
and add John Doughty in that capacity.
4. Individual responsible for radiation safety program -
Delete Steve Marshall and add John Doughty in that
capacity. Radiation Safety Officer class completed by
Mr. Doughty on 11-15-88. (resume of Mr. Doughty
enclosed)
5. CONDITIONS (11) - Delete distribution facilities at
4800 Casbeer Rd., Midland, Tx and 1438 Crescent, Suite
105, Carrollton, TX. and add 100 South County Rd. 1207,
Midland, TX. (plan of facilities enclosed)

If you should have any questions or need additional information
please do not hesitate to contact me at (915)694-7887.

Regards,

John P. Doughty
John P. Doughty
Production
BDC Electronics, Inc.

9001300079 881121
LIC30
42-23668-01E PDR

enclosure

cc: Dr. Dale Powers, U.S. NRC - Region IV

Rec'd 11/22/88

020695

John P. Doughty
2 Quail Run
Midland, TX 79707
(915)699-5207 Home
(915)694-7887 Work

PROFESSIONAL EXPERIENCE

May 1986 to Present: BDC Electronics, Inc.

Exec. Vice President (5-86 to Present) Midland, Texas
Responsible for operational and strategic aspects of consumer products based company. Duties included but not limited to:

Marketing

- Established 26 state Manufacturing Rep and Distribution network.
- Contract negotiations and product presentations
- Marketing strategies, penetration analysis, demographic studies, sales projections and sales attainment.

Merchandising

- Directed all aspects of marketing communication media, ie; trade show exhibits, press releases, product brochures, promotional video tapes and direct mailers.
- Designed packaging, both retail and wholesale.

Planning

- Strategic, production and inventory control
- Financial planning, budget formulation and cash flow analysis.

Technical/Engineering

- Assisted engineering with patent application which resulted in US patent No. 4,688,021.
- Worked with engineering in design of product

Accounting/Purchasing/Administrative staffing

Corporate Secretary/Treasurer

Maintained minutes at all Board and Stockholder meetings, maintained strict control of memorandums for stock offerings and on issuance of Corporation Stock.

June 1977 to May 1986: Texas Instruments, Inc.

Marketing Communications Manager (6-81 to 5-86) Midland, Tx
Responsible for all merchandising aspects of the Military Products Division Semiconductor Group. Duties included but not limited to:

- Supervisor responsibility of application engineers and technical writers, production of all product brochures and ads, technical articles, trade show exhibits, data book specs and training video tapes and formulated monthly forecast and track actuals against budget.

Major accomplishments: Directed production and full ad campaign of Texas Instruments' first satellite teleconf. to a customer base.

Product Marketing Engineer (5-80 to 6-81) Midland, Tx
Responsible for marketing semiconductors for military applications in the northeast area of the U.S. This includes but not limited to:

- Maintenance and revision of pricing for 5000 IC's, purchase agreement negotiations with customer, marketing developments on new packaging technology, new product intro. presentations, price and delivery quotes and competitive activity analysis, systems coordination and development.

Major accomplishments: Obtained 128% of total year forecast of \$3.8M.

Drafting Supervisor (9-78 to 5-80) Dallas, Tx
Supervised Methods and Tooling drafting group, Engineering Change Notice(ECN) typing group and Facilities drafting group.

Responsibilities Included:

- Scheduling work load from tooling engineers into drafting and ECN's into typing group from product engineering.
- Constantly working with staff on methods of improving production.

Major accomplishments: Increased production time in the ECN typing group by 38%(from .23 hr/sht to .17 hr/sht).

Tooling Engineer (6-77 to 9-78) Dallas, Tx
Responsibilities Included supporting the Electro Optics Division and the Radar Division of the Equipment Group with tooling for the assembly lines. This included:

- Identify solutions, by means of tooling, to support the assembly line, estimate sustaining tooling needed for a given program for a given capacity, and over see the completion of a job thru implementation.

Major accomplishments included designing a transport/test cart for a radar that had to perform six (6) different functions with the radar attached to cart.

Prior to June 1977 I worked full and part time as a draftman and lab instructor while attending college.

EDUCATION

BS - Mechanical Engineering Technology, Oklahoma State University, Stillwater, Oklahoma.

Seminars and/or courses - Texas Instruments, Inc.
Supervisory Training, Effective Negotiations, Computer software courses, 1st MS-DOS, Lotus 1-2-3, D-Base II, PFS File/Report, Juran on Quality and Understanding Microprocessors.

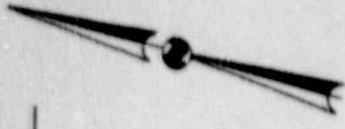

DESCRIPTION:

A survey of a 1.24 acre tract of land out of the NW¹/₄ Sec. 9, Block 39, T-2-S., R-14-E., NE. Co. Survey, Midland County, Texas, being more particularly described as follows:

Beginning at a $\frac{1}{4}$ " iron rod set for the Northeast corner of this survey, from which the Northeast corner of said Section 9 bears N15°14'W. a distance of 1335.7 feet; and N.74°47'W. a distance of 1316.72 feet;

Thence S.74°47'W. 300 feet to a $\frac{1}{4}$ " iron rod;

Thence S.15°00'31"W. 180 feet to a $\frac{1}{4}$ " iron rod;

Thence N.74°47'W. 300 feet to a $\frac{1}{4}$ " iron rod;

Thence N.15°00'31"W. 180 feet to the point of beginning.

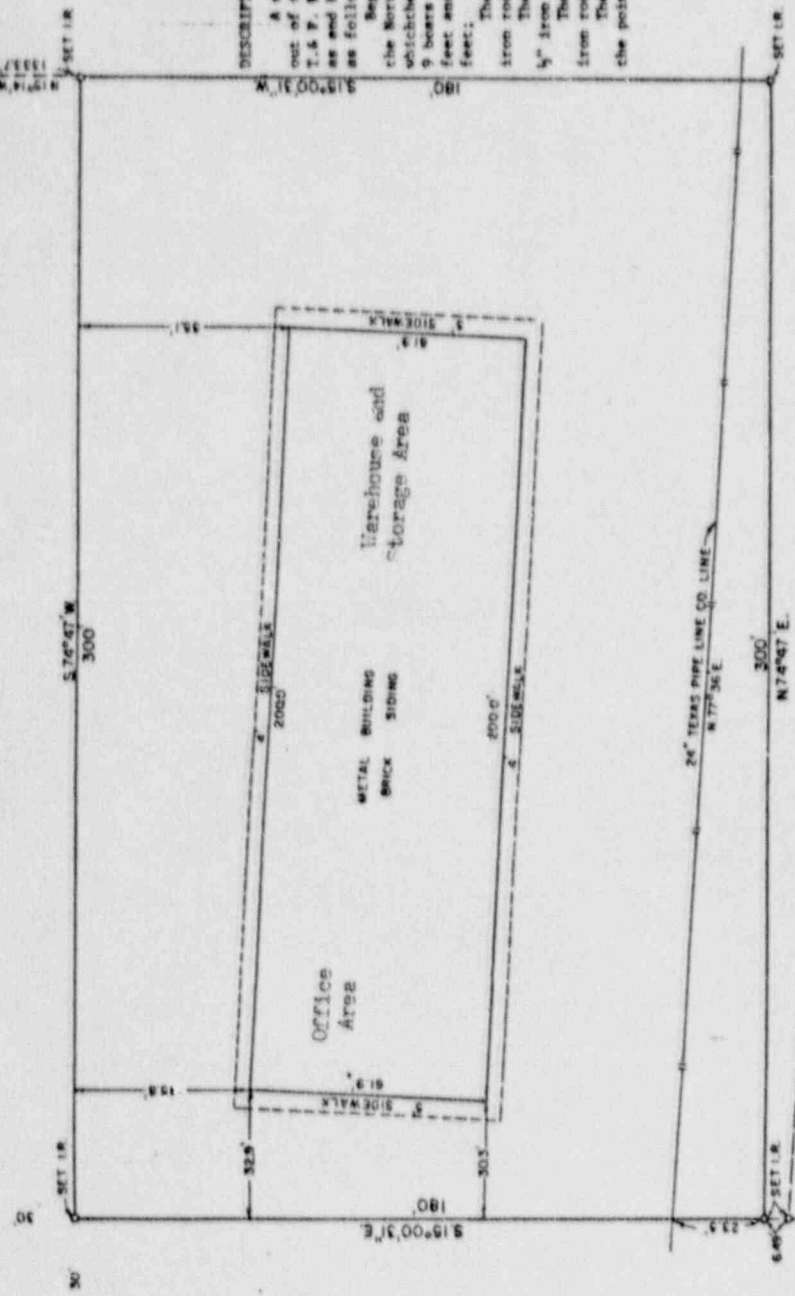

I HEREBY CERTIFY THIS SKETCH TO BE A TRUE AND ACCURATE REPRESENTATION OF THE LAMOS SHOWN AND DESCRIBED HEREON AS SURVEYED UNDER MY DIRECTION AND SUPERVISION.

Ronald J. Eidson
RONALD J. EIDSON YEARS 8 P.2 NC. 1983

DAN FENDER	Survey of a 124 acre tract in the NW 1/4 of Section 9, Block 39, T-2-S, R-8-P RR Co. Survey, Midland County, Texas JOHN WEST & ASSOCIATES CONSULTING ENGINEERS	MIDLAND, TEXAS
	Drawn By: E. C. P.	
	Scale 1" = 30'	
	Date: May 19, 1962	Sheet 1 of 1 Sheets