

DOCKET NOS.  
50-352  
50-353

THIS IS NOT A PAID ADVERTISEMENT

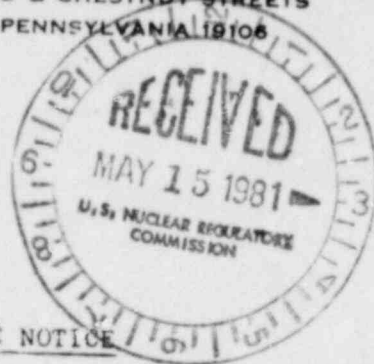

DEPARTMENT OF THE ARMY  
PHILADELPHIA DISTRICT, CORPS OF ENGINEERS  
CUSTOM HOUSE - 2 D & CHESTNUT STREETS  
PHILADELPHIA, PENNSYLVANIA 19106



6 April 1981

IN REPLY REFER TO

NAPOP-R-80-0813-3

PUBLIC NOTICE

Notice is hereby given that Neshaminy Water Resources Authority, 4259 Swamp Road, Doylestown, Pennsylvania 18901, has applied for a Department of the Army permit to relocate the channel of Pine Run and reshape the channel of North Branch Neshaminy Creek, just upstream of their junction, Ferry Road, Chalfont Borough, Bucks County, Pennsylvania.

The applicant's plans provide for construction work at two separate sites in the same locale. At the first site, the applicant's plans provide for relocating the existing Pine Run channel by excavating approximately 18,610 cubic yards of material. All of the excavated material would be used to fill the existing channel of Pine Run. The plans also provide for placing approximately 2,850 cubic yards of rip-rap on the proposed side slopes and on segments of the proposed 40 foot channel bottom width. The plans also provide for constructing a water intake structure with roller gates across the width of the proposed channel of Pine Run.

At the second site the applicant's plans provide for reshaping part of the existing North Branch Neshaminy Creek channel by excavating approximately 6,190 cubic yards of material. The excavated material would be used for reshaping, and 1,620 cubic yards of rip-rap would be placed on the side slopes and bottom of the proposed channel. The plans further provide for constructing a water intake structure with roller gates across the width of the proposed channel of North Branch Neshaminy Creek. The applicant's stated purpose of the proposed project is to improve the stream channels in connection with the proposed water treatment plant which would supply potable water to Central Bucks and Montgomery County water agencies. The location of the proposed work is shown on the attached plans.

The Delaware River Basin Commission is considered the lead agency for the overall project. The Delaware River Basin Commission has prepared an Environmental Assessment (February 1980) on the proposed water treatment plant construction and has prepared an Environmental Impact Statement (1973) and an updated Environmental Assessment (August 1980) for the overall Point Pleasant water diversion project. There are no known sites, eligible for or included in the National Register of Historic Places, within the proposed work areas described in this public notice.

8705200104

A

NAPOP-R-80-0813-3

Neshaminy Water Resources Authority

Comments on the work described above should be submitted, in writing, to the District Engineer, at the above address within 30 days of the date of this notice.

The decision whether to issue a permit will be based on an evaluation of the probable impact of the proposed activity on the public interest. That decision will reflect the national concern for both protection and utilization of important resources. The benefit which reasonably may be expected to accrue from the proposal must be balanced against its reasonably foreseeable detriments. All factors which may be relevant to the proposal will be considered; among those are conservation, economics, aesthetics, general environmental concerns, historic values, fish and wildlife values, flood damage prevention, land use, navigation, recreation, water supply, water quality, energy needs, safety, food production, and, in general, the needs and welfare of the people. No permit will be granted unless its issuance is found to be in public interest.

The evaluation of the impact of the work described above on the public interest will include application of the guidelines promulgated by the Administrator, U. S. Environmental Protection Agency, under authority of Section 404 (b) of the Clean Water Act. Any person may request, in writing, to the District Engineer, within the comment period specified in this notice, that a public hearing be held to consider this application. Requests for public hearings shall state, with particularity, the reasons for holding a public hearing.

In accordance with Section 401 of the Clean Water Act a Water Quality Certificate is necessary from the Pennsylvania Department of Environmental Resources. Any comments concerning the work described above which relate to Water Quality considerations should be sent to this office, with a copy to the Pennsylvania Department of Environmental Resources, Bureau of Water Quality Management, 1875 New Hope Street, Norristown, Pennsylvania 19401.

The processing of this Department of the Army permit application is under the statutory authority of Section 404 of the Clean Water Act.

FOR THE DISTRICT ENGINEER:

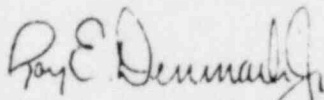

ROY E. DENMARK, JR.  
Chief, Permits Branch

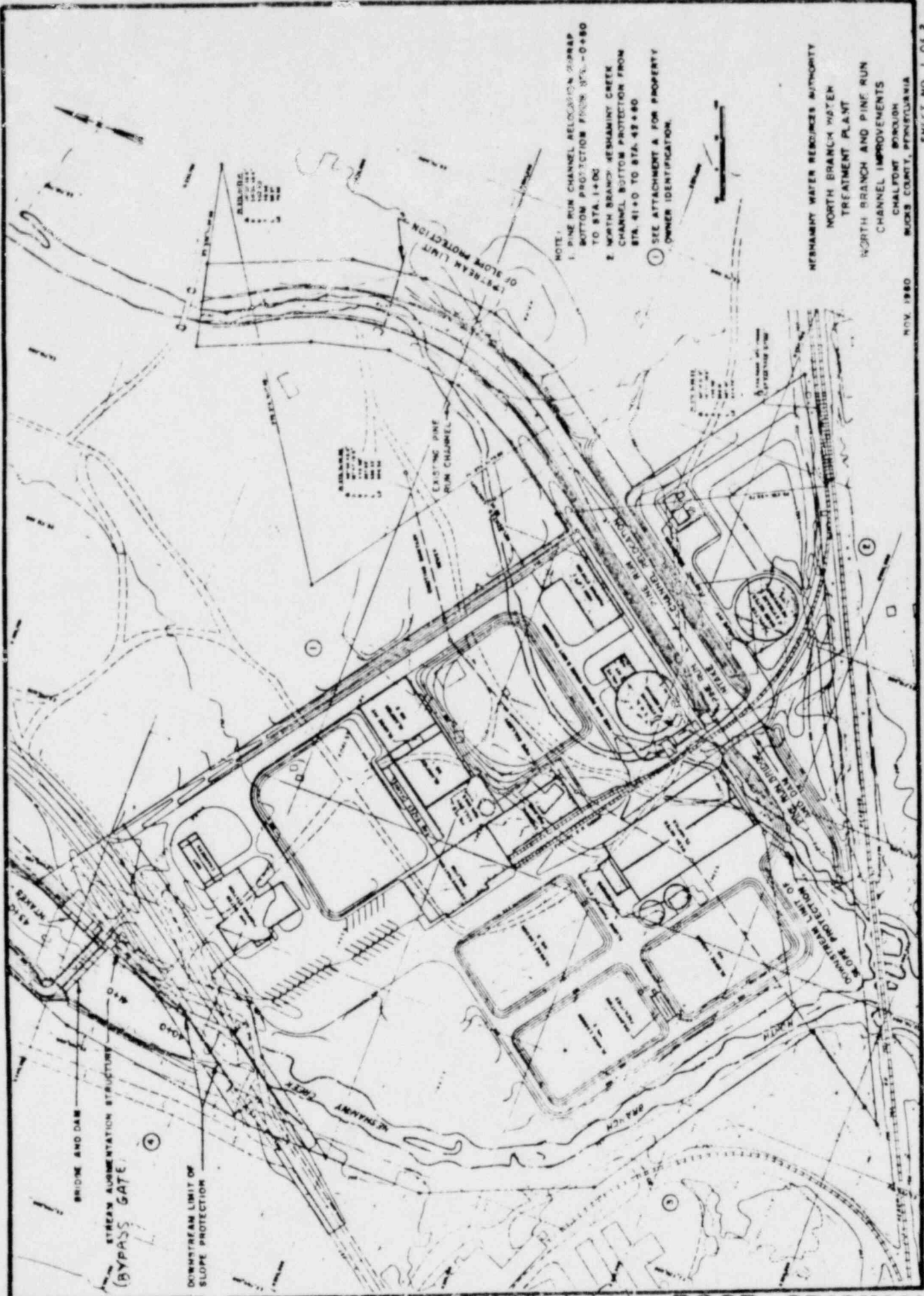

NOTE:  
 1. PINE RUN CHANNEL RELOCATION SHARP BOTTOM PROTECTION FROM STA. 0+80 TO STA. 1+00  
 2. NORTH BRANCH RESHANNY CREEK CHANNEL BOTTOM PROTECTION FROM STA. 41+0 TO STA. 43+80  
 3. SEE ATTACHMENT A FOR PROPERTY OWNER IDENTIFICATION

RESHANNY WATER REVENUE AUTHORITY  
 NORTH BRANCH WATER TREATMENT PLANT  
 NORTH BRANCH AND PINE RUN CHANNEL IMPROVEMENTS  
 CHALFONT BOROUGH  
 MUCKS COUNTY, PENNSYLVANIA

NOV. 1980

BRIDGE AND DAM

STREAM AUGMENTATION STRUCTURE (BYPASS GATE)

UPSTREAM LIMIT OF SLOPE PROTECTION

EXISTING PINE RUN CHANNEL

PINE RUN CHANNEL

DOWNSTREAM LIMIT OF SLOPE PROTECTION

80-0813-3(3)

POOR ORIGINAL

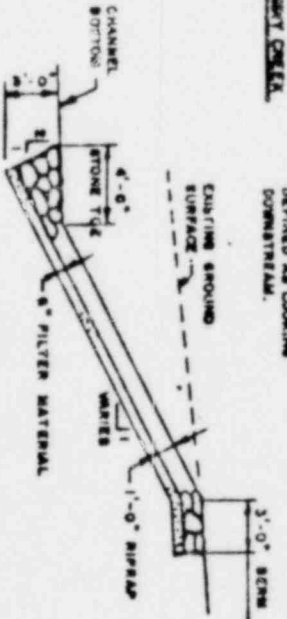
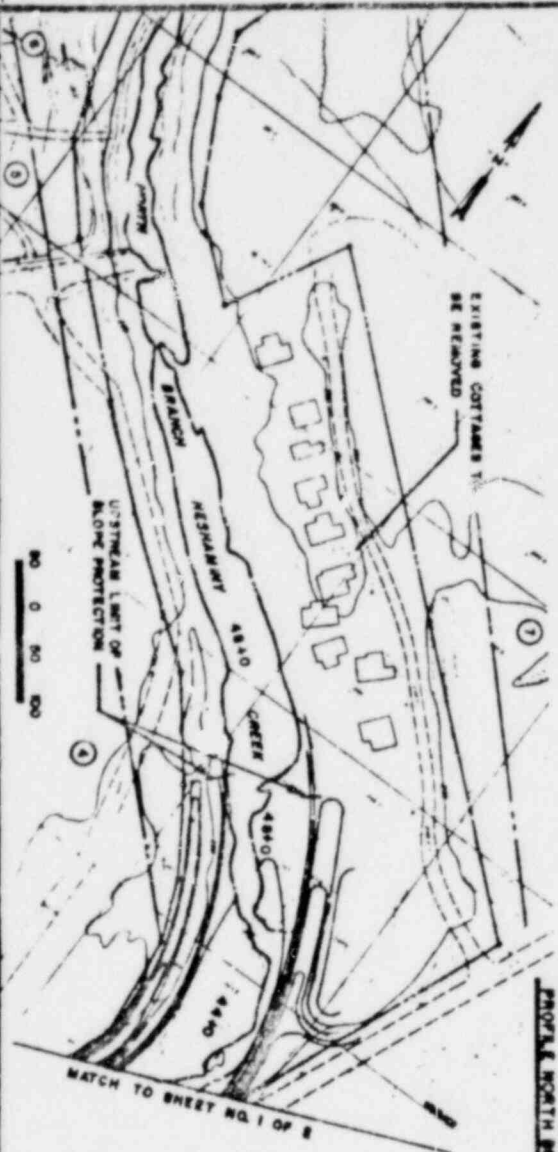
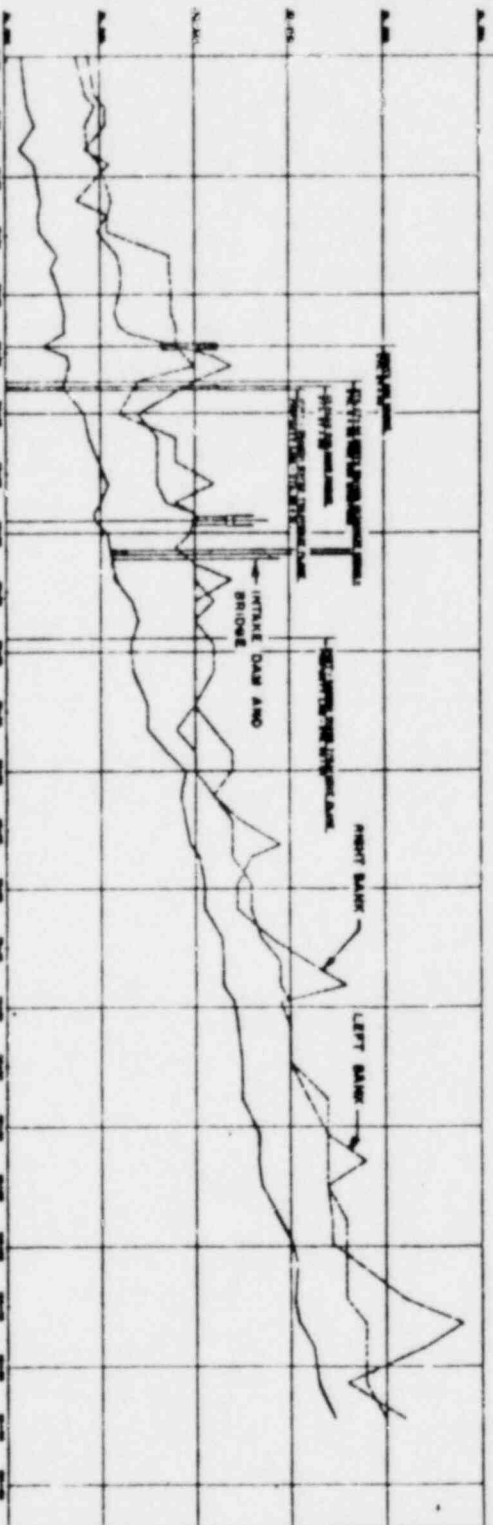
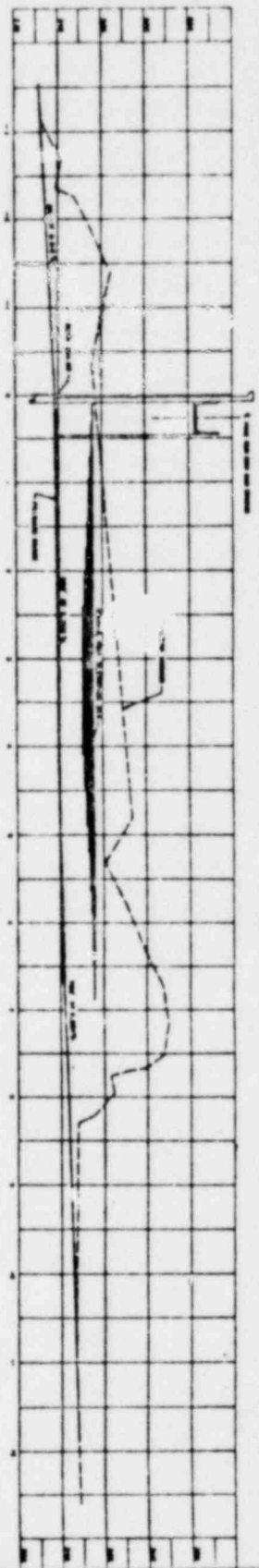

**RRAP SLOPE PROTECTION**  
CROSS SECTION  
NO SCALE

REMAINING WATER RESOURCES AUTHORITY

NORTH BRANCH WATER  
TREATMENT PLANT

NORTH BRANCH AND PINE RUN  
CHANNEL IMPROVEMENTS  
CHAFFONT BOROUGH  
SIXES COUNTY, PENNSYLVANIA

REV. JAN. 1981  
NOV. 1980

SHEET NO. 2 OF 2

20-0813-3(4) POOR ORIGINAL

NOTE - OPERATING STEM SUPPORTS NOT SHOWN

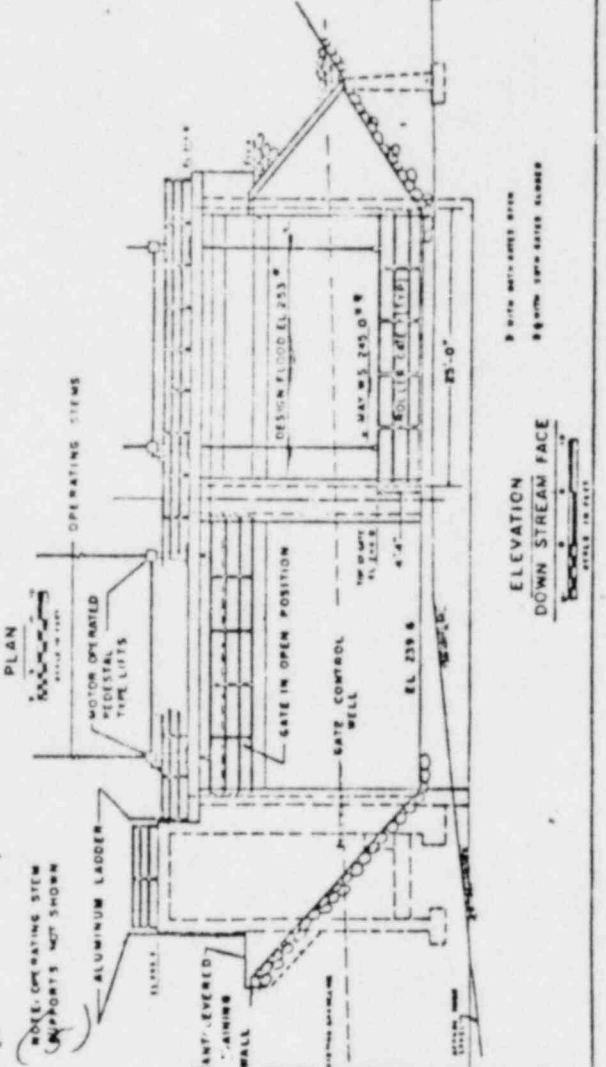
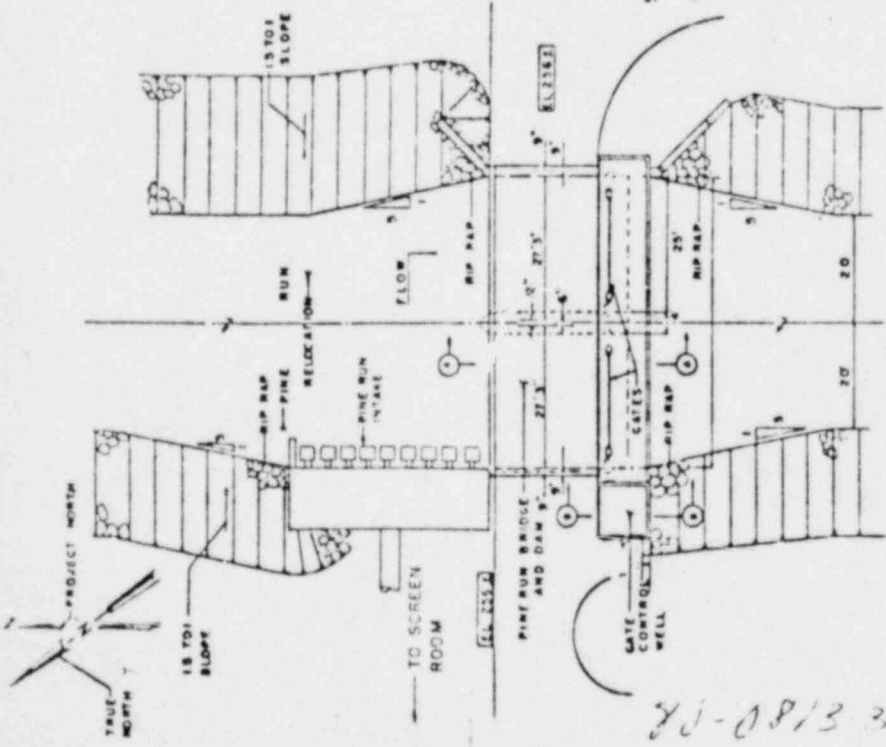
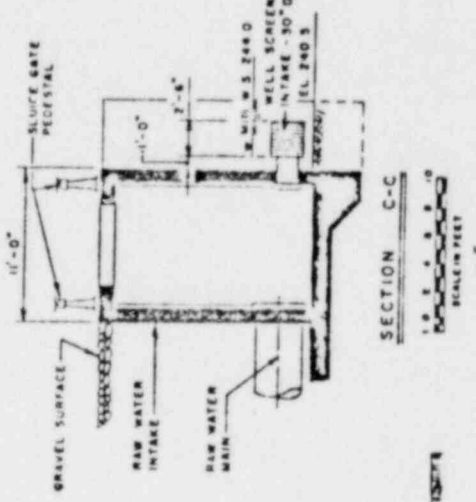
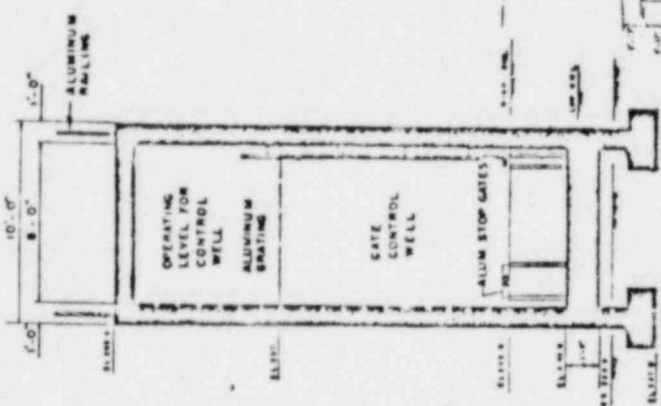
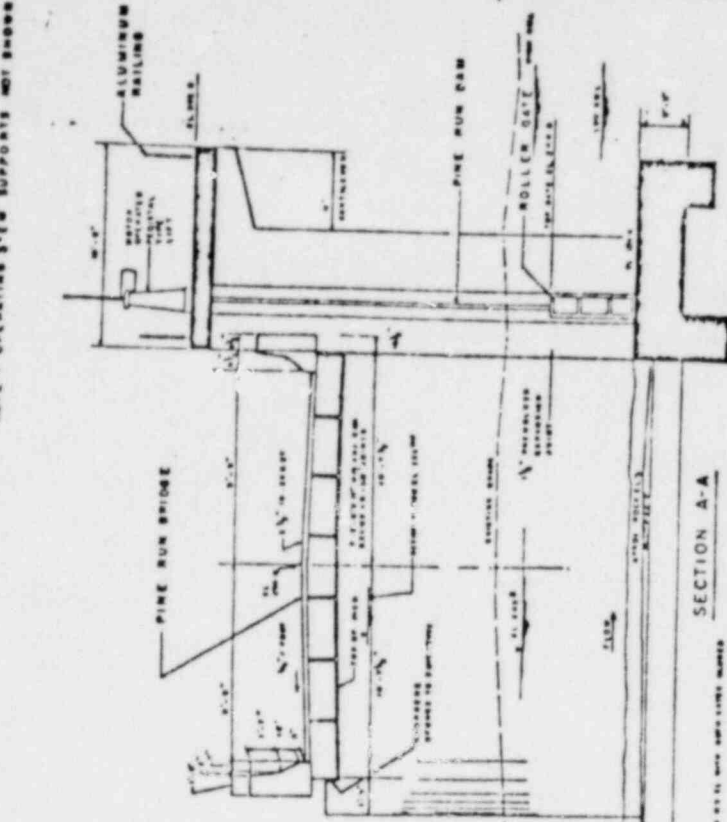

WATER RESOURCES DEVELOPMENT PLAN
NORTH BOUNDARY WATER TREATMENT PLANT PRELIMINARY DESIGN
PINE RUN INTAKE DAM
E. H. BOURGARD ASSOCIATES, INC. CONSULTING ENGINEERS
COUNTY OF BOOYS EQUINE WATER RESOURCES AUTHORITY

POOR ORIGINAL

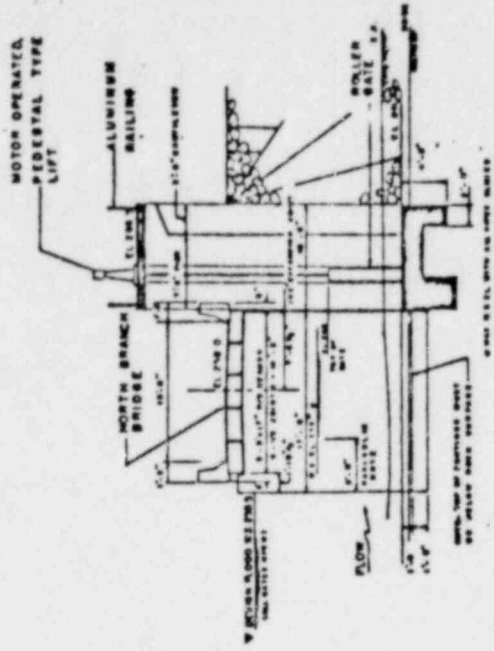
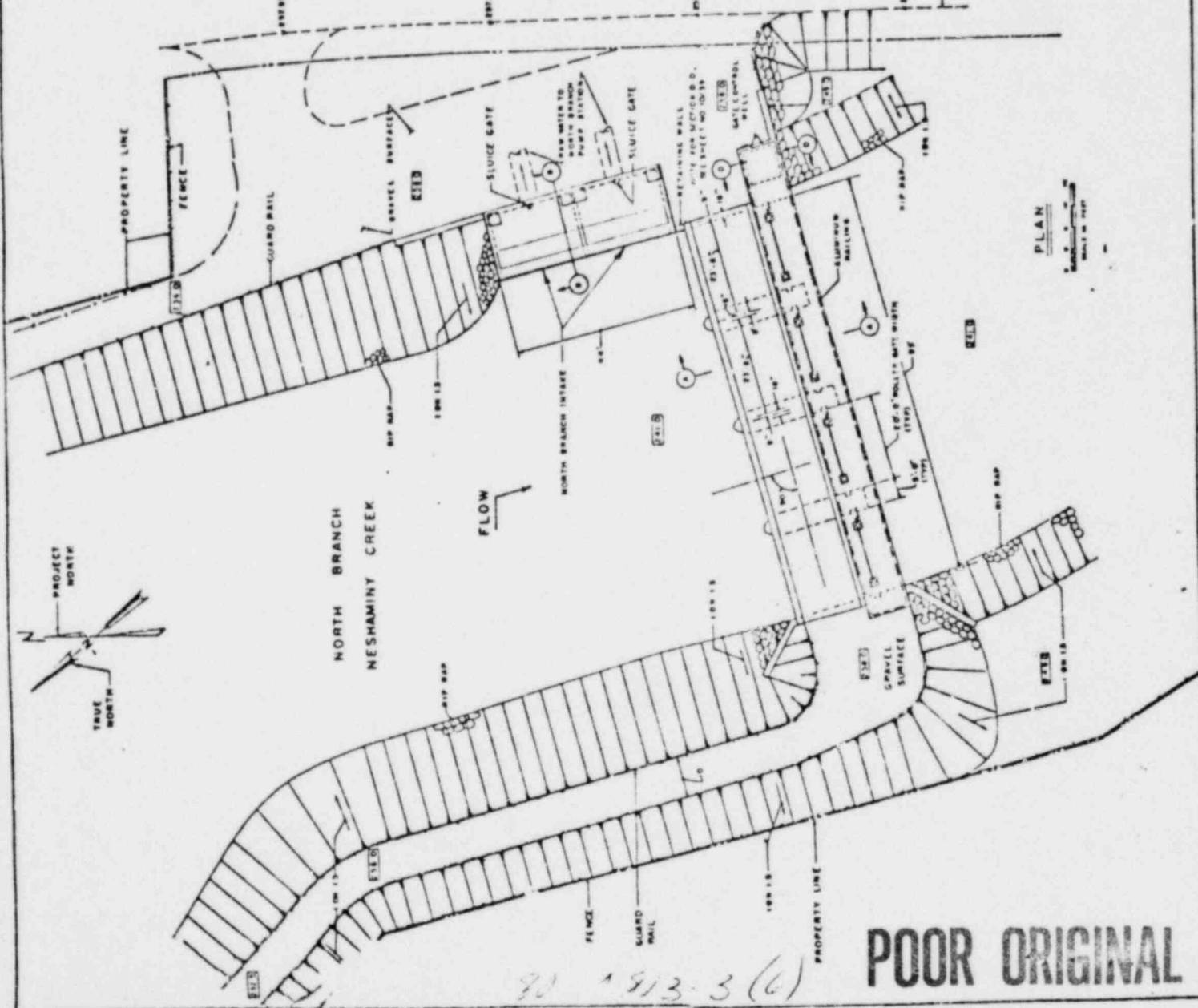
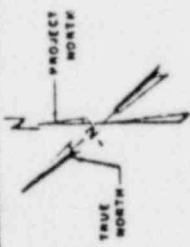

SECTION A-A  
SCALE IN FEET

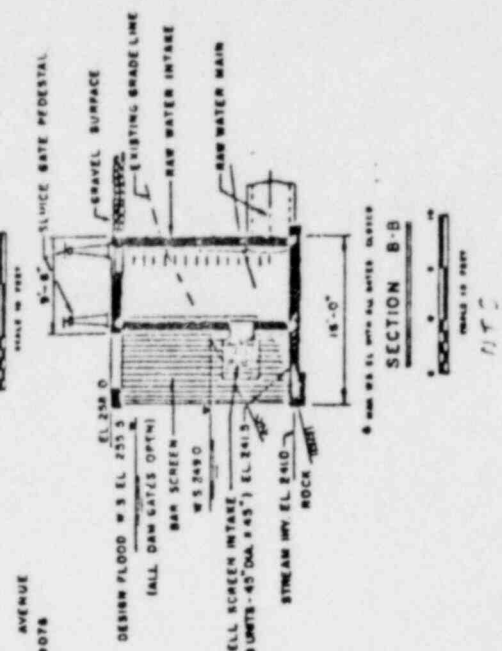

SECTION B-B  
SCALE IN FEET

NESHAMINY CREEK WATER RESOURCES DEVELOPMENT PLAN	
NORTH BRANCH WATER TREATMENT PLANT PRELIMINARY DESIGN	
NORTH BRANCH INTAKE DAM	
E. H. BOURGARD ASSOCIATES, INC. CONSULTING CIVIL ENGINEERS	
DATE: 12/22/66	PROJECT NO.: 1913-3(6)
SHEET NO.: 1	TOTAL SHEETS: 3
COUNTY OF SACKS NESHAMINY WATER RESOURCES AUTHORITY	

POOR ORIGINAL

1913-3(6)