

FARLEY NUCLEAR PLANT
EMERGENCY PLAN IMPLEMENTING PROCEDURE
FNP-0-EIP-0

S
E
P
A
R
A
T
E
D

EMERGENCY ORGANIZATION
AND
CONTROL ROOM ACCESS

PERSONAL PRIVACY INFORMATION
DELETED IN ACCORDANCE WITH THE
FREEDOM OF INFORMATION ACT

Approved:

W. J. [Signature]
Plant Manager

Date Issued: 11-3-80

Date of Implementation: 11-17-80

Diskette EIP-2
List-of-Effective-Page
Page Rev. #

1-4 Rev. 2
Fig. 1 Rev. 2

DOCUMENT CONTROL
CONTROLLED COPY
DO NOT REPRODUCE
COPY NO. 039

EMERGENCY ORGANIZATION
AND
CONTROL ROOM ACCESS

1.0 Purpose

This procedure establishes and delineates the lines of authority for coping with operational accidents and limits access to the control room in the event of an emergency.

2.0 References

Joseph M. Farley Nuclear Plant Emergency Plan

3.0 General

3.1 All personnel except those with direct operational responsibilities shall stay out of the at-the-controls area of the control room during emergency conditions.

3.2 The southeast corner of the control room shall be used as the Operations Support Center for on shift operations and C&HP personnel, during emergency situations.

3.3 The Technical Support Center when activated will be manned as described in paragraph 4.3.

3.4 The Shift Supervisor shall only be relieved of his operational responsibilities, by a person who is qualified by AP-16 to assume the responsibilities of the Shift Supervisor.

4.0 Procedure

4.1 The Shift Supervisor shall direct operational activities to combat the emergency and act as the Emergency Director and shall be the primary authority, as delineated by EIP-2, until properly relieved by the Emergency Director.

4.2 The Shift Supervisor shall provide the Emergency Director the following information, as applicable, when being relieved:

- (1) Status of the unaffected unit

- (2) Status of the affected unit
- (3) Emergency classification and basis for classification
- (4) Emergency actions initiated
- (5) Release information
- (6) Requests for offsite assistance initiated
- (7) Notifications initiated
- (8) Prognosis for worsening or termination of the event

Once properly relieved by the Emergency Director, the shift Supervisor will continue to direct operational activities to combat the emergency and to place the unit in a safe condition in accordance with the applicable Emergency Operating Procedure. He will also be responsible for restricting access to the at-the-controls area to:

- (1) The Emergency Director
- (2) Licensed Operations Supervisory Personnel
- (3) Plant Operators
- (4) Shift Technical Advisor
- (5) Resident NRC Inspector
- (6) Persons authorized by the Emergency Director or Shift Supervisor

4.3 The following personnel shall report to the Technical Support Center, see Figure 1, and shall be responsible for the duties described:

- 4.3.1 The Emergency Director will coordinate the overall emergency activities.
- 4.3.2 The Operations Manager shall coordinate the efforts of the operating crew and advise the Emergency Director.
- 4.3.3 The Maintenance Manager shall coordinate the efforts of the Emergency Repair Party and advise the Emergency Director.

- 4.3.4 The Technical Manager shall coordinate off-site communications, with the aid of engineers as needed, and advise the Emergency Director.
- 4.3.5 The Health Physics Manager shall coordinate the efforts of the Radiological Monitoring Team(s), decontamination and Health Physics support, and advise the Emergency Director.

In the event that any of the above personnel are not available, the respective supervisor or assistant supervisor shall assume the responsibilities.

- 4.4 The following support personnel shall be responsible for the duties described:
 - 4.4.1 The Operations Supervisor shall report to the Control Room (Southeast corner) and direct the efforts of the operations group support personnel, as directed by the Emergency Director or the Operations Manager.
 - 4.4.2 The Maintenance Supervisor and the I&C Supervisor shall report to the Maintenance Shop and direct the efforts of the Emergency Repair Party.
 - 4.4.3 The Technical Supervisor shall report to the Service Building Auditorium and direct any support requested by the Emergency Director.
 - 4.4.4 The Sector Supervisor (Health Physics) shall report to the Control Room (Southeast corner) and direct the activities of Health Physics Support and the Radiological Monitoring Team(s).
 - 4.4.5 The Assistant Security Supervisor will report to Central Security Control and direct the activities of the non-essential security personnel.

In the event that any of the above personnel are not available, the respective assistant supervisor, foreman or designated individual shall assume the responsibilities.

- 4.5 Personnel not assigned specific duties during the emergency shall remain in their designated assembly areas (Operations Support Centers) until otherwise instructed by the Emergency Director.

POOR ORIGINAL

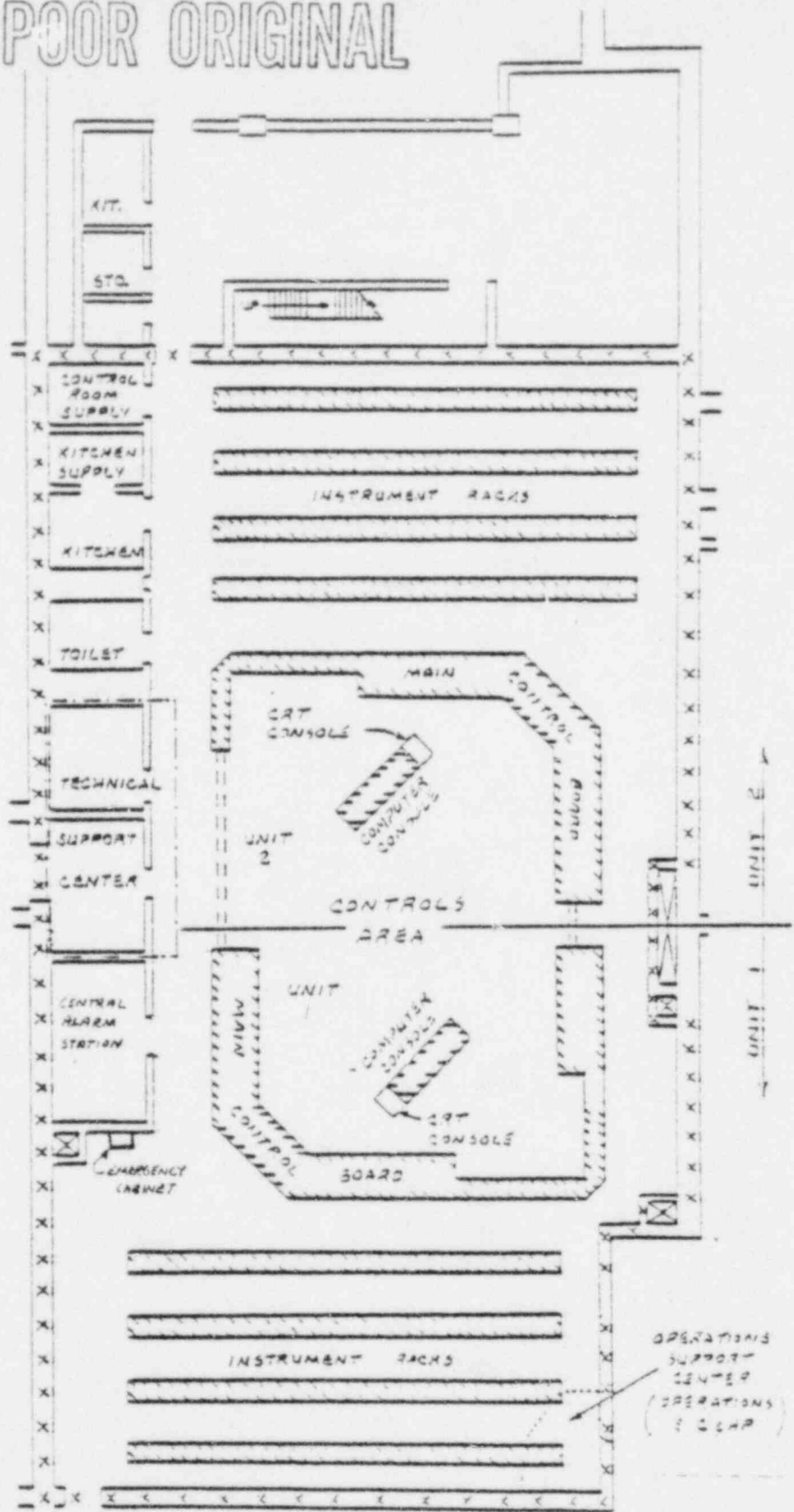

x x x Confines of Control Room

==== Controls Area

- - - - Technical Support Center

Controls Area and Confines of Control Room (two unit operation)

Technical Support Center and Operations Support Center (Operations & C&RP)

Figure 1



POOR ORIGINAL

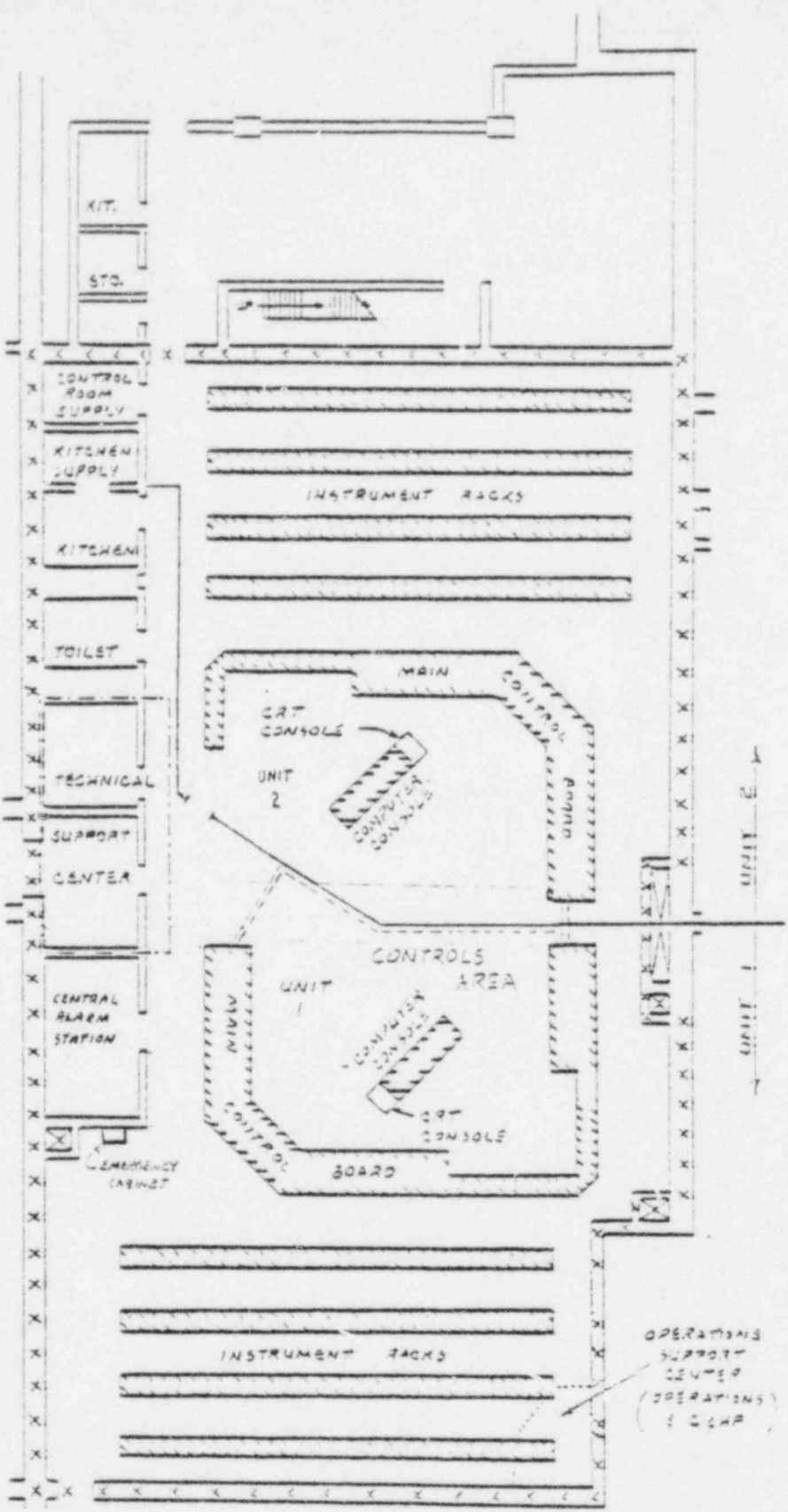

- x x x Confines of Control Room
- ==== Controls Area
- - - - Technical Support Center

Controls Area and Confines of Control Room (Prior to Unit 2 Fuel Loading)
 Technical Support Center and Operations Support Center (Operations & C&M)