

CABOT

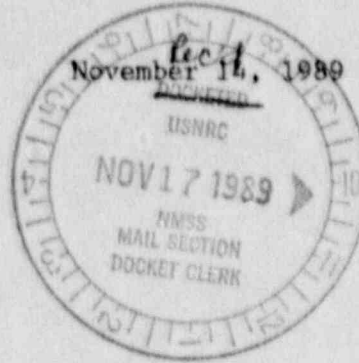
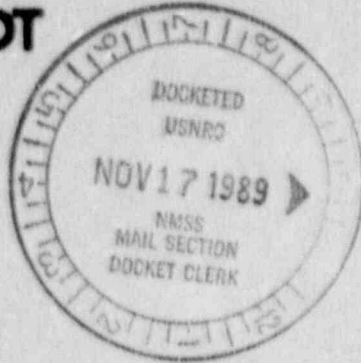

Mr. Jerry LaRoche
 Uranium Fuel Licensing Branch
 NMSS U.S. Nuclear Regulatory Commission
 Washington, D.C. 20555

Ref: License SMB-920
 Docket 40-6940
 Expiration Date 12/31/88
 Application Received by NRC on 11/23/88

Dear Jerry:

In accordance with our NRC License SMB-920, Section 21, we are required to report results of fluoride analysis on forage crops if "the average fluoride concentration exceeds 40 ppm". Our sampling location is the east side of County Line Road (map enclosed).

Enclosed are copies of the analysis performed by Environmental Strategies, Inc. The average fluoride for the seven samples of corn and grass is 128 ppm. We do not include area G samples in the calculation since it is a control from twenty miles away.

Please call if you have any questions.

Sincerely,

William C. Gannon

William C. Gannon
 Radiation Safety Officer

WCG/jle
 Enclosures
 L111401

cc: N. Rao Kona,
 Pollution Control Engineer
 Pennsylvania DER

*DF03
 1/1*

additional information

Cabot Corporation
 County Line Road
 Boyertown, Pennsylvania 19512
 Phone: 215 367-2181

8911300028 891114
 PDR ADOCK 04006940
 C PDC

26091

Sampling Areas
 Forage Crops
 Summer 1989
 WC Linneman

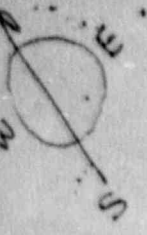

#5	#7
#6	

#1	#3
#2	#4

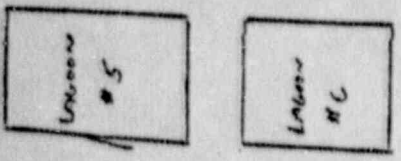

NO CORN PLANTING AT SCHLEGEL LAKE

FARM HOUSE

Schlegel

0 GRASS in Circle
 # COUSIMPLES
 1989

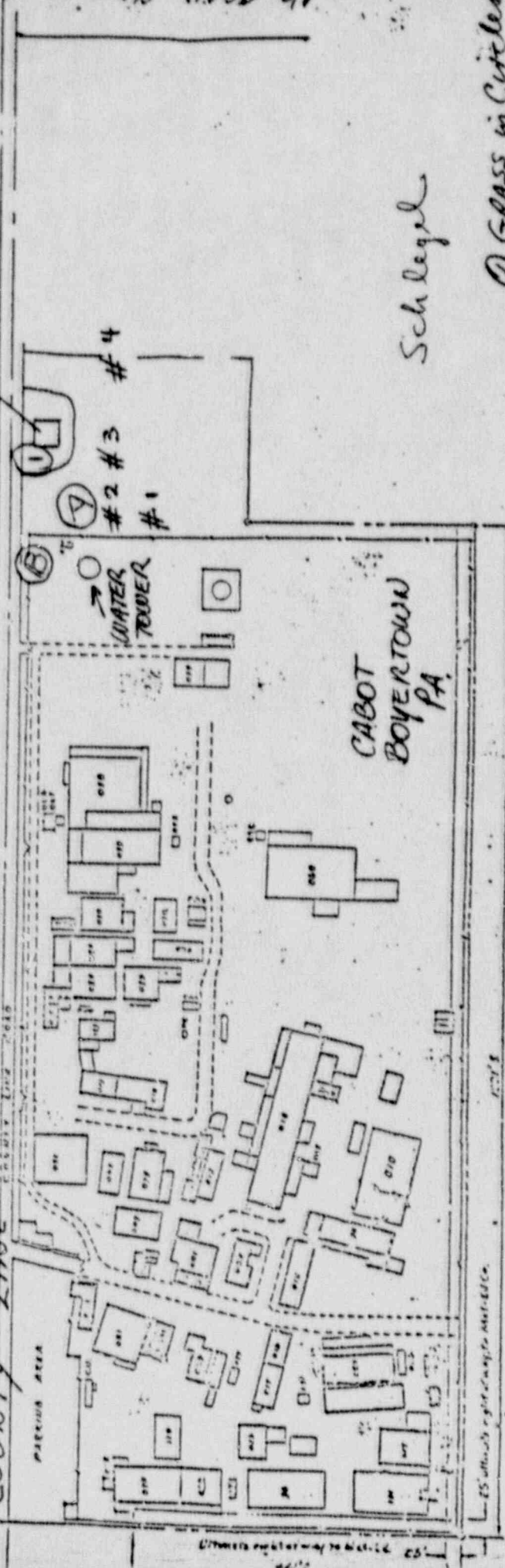
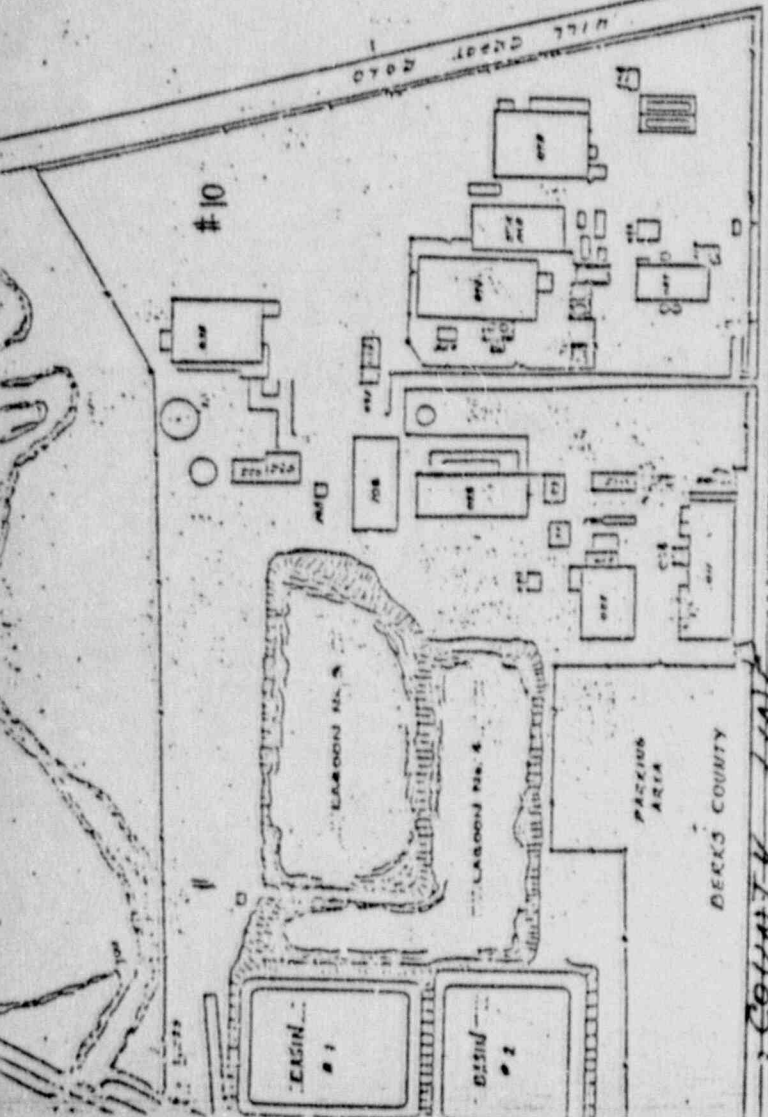

Moyer

DETAIL

FORAGE CROP SAMPLES

8/8/89

CORN ONLY

CABOT

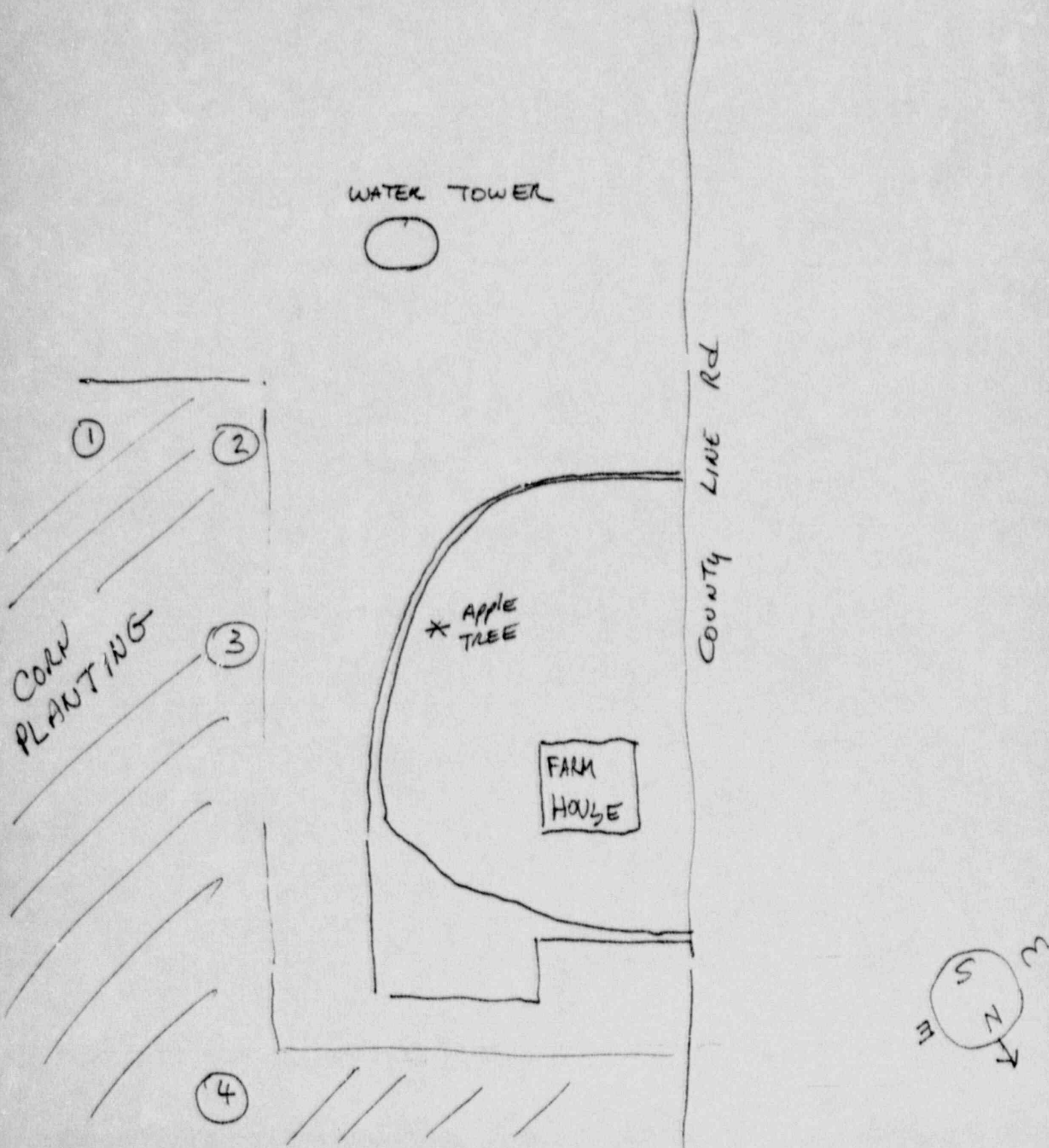



Copy SMS 920
A. Compitelli
B.J. Higgins
EFFL
CHRON
ENV. STAT

1 September 1989

Cabot Corporation
County Line Road
Boyertown, PA 19512
Attn: W. C. Gannon

Results of fluoride analysis of grass samples. Values are ppm F
or μg F per gram dry mass.

Re: P.O. # 173240 and 173328

SAMPLES RECEIVED IN JUNE 1989 (PO # 173240)

#1 FARM HOUSE 6/8/89	10.2 ppm F
#2 OLD AIR FIELD 6/12/89	37.9

across the street

SAMPLES RECEIVED IN JULY 1989 (PO # 173328)

A - WATER TOWER EAST	21.5
B - WATER TOWER WEST	22.9



ENVIRONMENTAL STRATEGIES INCORPORATED
309 THE PARKWAY • ITHACA, NEW YORK 14850 • (607) 272-6155

29 October 1989

Cabot Corporation
County Line Road
Boyertown, PA 19512
Attn: W. C. Gannon

Results of fluoride analysis of corn samples. Values are ppm F or μg F per gram dry mass.

Re: P.O.# 173759

<u>SAMPLE ID</u>	<u>FLUORIDE CONC</u>
#1 WATER TOWER LEFT	169 ppm F
#2 WATER TOWER	257
#3 FARM HOUSE	242
#4 FARM HOUSE EAST	174
#5 AREA G	24.3

DOCKET NO. 40-6940

CONTROL NO. 26091

DATE OF DOC. Nov. 14, 1989

DATE RCVD. Nov. 17, 1989

FCUF PDR

FCAF _____ LPDR _____

I & E REF.

SAFEGUARDS _____

FCTC _____ OTHER _____

DATE 11/17/89

INITIAL SAC