

# GENERAL ELECTRIC

CASTLE HAYNE ROAD • P. O. BOX 780 • WILMINGTON, N. C. 28401 • (919) 343-5000

PDR 70-1113  
 1B 5/81  
 NUCLEAR ENERGY  
 PRODUCTS DIVISION  
 WILMINGTON MANUFACTURING  
 DEPARTMENT  
 June 11, 1980

Director  
 Office of Nuclear Materials Safety & Safeguards  
 U. S. Nuclear Regulatory Commission  
 Washington, D. C. 20555

Attention: Mr. W. T. Crow, Section Leader  
 Uranium Processing Licensing Section

Dear Sir:

Reference: NRC License SNM-1097, Docket #70-1113

Subject: APPLICATION AMENDMENT N-8,  
 INTENTION TO CONSTRUCT WAREHOUSE BUILDING

RECEIVED  
 JUN 30 AM 11 54  
 U.S. NUCLEAR REGULATORY COMMISSION

With reference to activities authorized by SNM-1097 at the GE fuel fabrication plant in Wilmington, N. C., General Electric Company hereby informs you of the intent to construct a building on the plant site for use as a warehouse. Details related to this project are enclosed as an attachment to this letter.

Based upon the information contained in this letter and our telephone conversation on June 6, 1980, I assume that no prior authorization by the NRC is required for General Electric to proceed with the project as described herein, since there are no radiological or criticality safety implications nor any significant environmental impact associated with the project, and since there are no new activities being undertaken in connection with use of the building.

Pursuant to 10 CFR 170.31, enclosed is a General Electric check for \$150 for processing this amendment request.

General Electric personnel would be pleased to discuss this matter further with you and your staff as you may deem necessary.

Very truly yours,

GENERAL ELECTRIC COMPANY

  
 Arthur L. Kaplan, Manager  
 Licensing & Compliance Audits  
 M/C J26

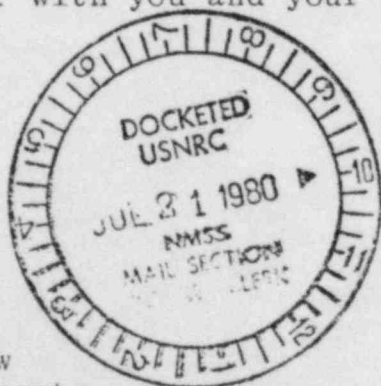

ALK:bmw  
 Attachments  
 cc: Document Management Branch  
 NSD-L+

Applicant.....	
Check No. 870.965	
Amount Fee Category 150-1B	
Type of Fee admin	
Date Check Rec'd. 7/1/80	
Received By. [Signature]	

16585

8009193 111 C

Director, ONMSS  
June 11, 1980  
Attachment - Page 1

DETAILS RELATED TO PLANNED WAREHOUSE BUILDING

General Electric Company is planning to construct a warehouse building for use in storage of various shipping containers and supplies at the GE fuel fabrication plant in Wilmington, N. C. Details related to this planned building are shown below.

1) Location

137 feet north of the northeast corner of the fuel manufacturing building as shown in the attached figure

2) Dimensions

- Length - 285 feet
- Width - 95 feet
- Height - 30 feet with pitched roof and gabled ends

3) Construction

- Pre-engineered structure
- Sheet metal siding
- Steel frame
- Twenty-two skylight windows in ceiling

4) Foundation

Poured concrete slab into four-foot deep excavation

5) Use - Storage of

- Empty and/or full RA-series fuel bundle shipping containers
- Empty and/or full BU-5 and/or BU-7 shipping containers
- General non-nuclear storage (e.g., empty 5-gallon steel pails, fire brick, industrial supplies, etc.)

6) Radiological Safety

There will be no unencapsulated uranium (or any other radioactive material) handled in the planned warehouse building. The building will be a non-controlled area from the uranium processing viewpoint.

Director, ONMSS  
June 11, 1980  
Attachment - Page 2

7) Criticality Safety

Uranium fuel will be stored in the new building only within Fissile Class I shipping packages or in the inner metal container of the model RA-series shipping package, as authorized in Section 1.6.2(d) and (c), respectively. Therefore, since prior analyses have shown these configurations to be critically safe as considered under normal and credible accident conditions of storage as required by the NRC for GE to obtain the above authorizations, no further criticality safety analyses are deemed to be required.

8) Environmental Impact

There will be no manufacturing activities performed in this building; in fact, the building will be used for nothing except storage as described above. Therefore, there will be no emissions to the environment of any sort in connection with use of the building.

Construction of the steel frame/siding building involves no significant excavation or other construction-related activities. Therefore, we believe that no further environmental impact assessment is required because there appears to be no significant environmental impact associated with this project.

Director, ONMSS  
June 11, 1980  
Attachment - Page 3

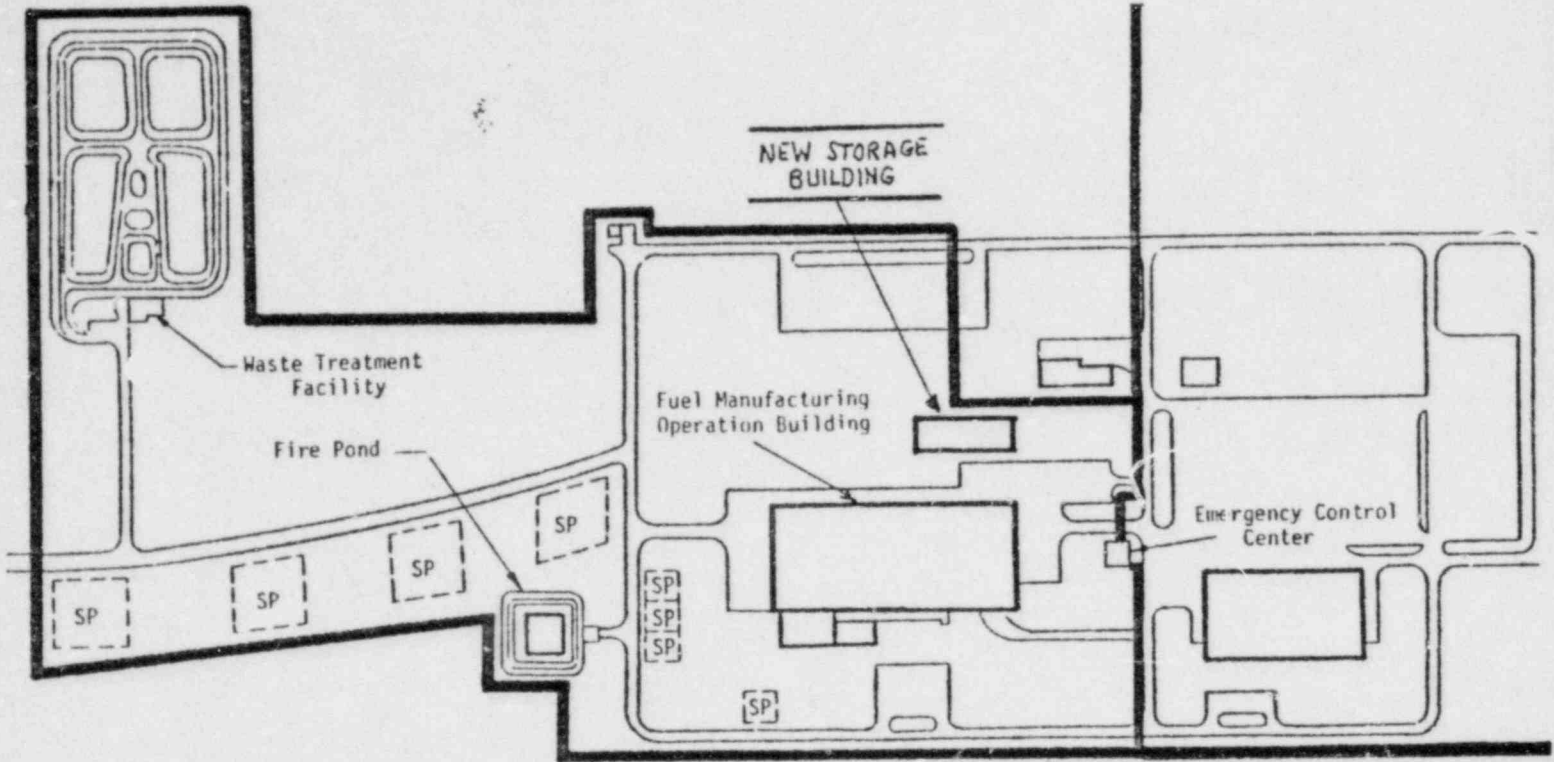

Legend:

- SP Storage Pad (Typical Number and Location)
-  Fence Line



GE-Wilmington Manufacturing Department  
NEW WAREHOUSE BUILDING

A. L. Kaplan  
:bmw