

OCT 12 1989

In Reply Refer To:
Docket: STN 50-482

Wolf Creek Nuclear Operating Corporation
ATTN: Bart D. Withers
President and Chief Executive Officer
P.O. Box 411
Burlington, Kansas 66839

Gentlemen:

This refers to the meeting conducted at Wolf Creek Nuclear Operating Corporation's request in the Region IV office on October 4, 1989. This meeting related to activities authorized by NRC License No. NPF-42 for Wolf Creek and was attended by those listed on the attached Attendance List.

The subject discussed at this meeting is described in the enclosed Meeting Summary.

It is our opinion that this meeting was beneficial and has provided a better understanding of your planned activity.

In accordance with Section 2.790 of the NRC's "Rules of Practice," Part 2, Title 10, Code of Federal Regulations, a copy of this letter will be placed in the NRC's Public Document Room.

Should you have any questions concerning this matter, we will be pleased to discuss them with you.

Sincerely,

Original Signed By:
James L. Milhoan

James L. Milhoan, Director
Division of Reactor Projects

Enclosure: Meeting Summary w/attachments

cc w/enclosure:
(see next page)

C:DRP/D
EHoller:cdh
10/12/89

D:DRP
JMilhoan
10/12/89

8910180311 891012
PDR ADOCK 05000482
F PDC

TEAS

Wolf Creek Nuclear Operating
Corporation

-2-

Wolf Creek Nuclear Operating Corp.
ATTN: Gary Boyer, Plant Manager
P.O. Box 411
Burlington, Kansas 66839

Shaw, Pittman, Potts & Trowbridge
ATTN: Jay Silberg, Esq.
1800 M Street, NW
Washington, D.C. 20036

Public Service Commission
ATTN: Chris R. Rogers, P.E.
Manager, Electric Department
P.O. Box 360
Jefferson City, Missouri 65102

U.S. Nuclear Regulatory Commission
ATTN: Regional Administrator, Region III
799 Roosevelt Road
Glen Ellyn, Illinois 60137

U.S. Nuclear Regulatory Commission
ATTN: Regional Administrator, Region IV
611 Ryan Plaza Drive, Suite 1000
Arlington, Texas 76011

U.S. Nuclear Regulatory Commission
ATTN: Senior Resident Inspector
P.O. Box 311
Burlington, Kansas 66839

Wolf Creek Nuclear Operating Corp.
ATTN: Otto Maynard, Manager
Regulatory Services
P.O. Box 411
Burlington, Kansas 66839

Kansas Corporation Commission
ATTN: Robert Elliot, Chief Engineer
Utilities Division
4th Floor - State Office Building
Topeka, Kansas 66612-1571

Office of the Governor
State of Kansas
Topeka, Kansas 66612

Wolf Creek Nuclear Operations
Corporation

-3-

Attorney General
1st Floor - The Statehouse
Topeka, Kansas 66612

Chairman Coffey County Commission
Coffey County Courthouse
Burlington, Kansas 66839

Kansas Department of Health
and Environment
Bureau of Air Quality & Radiation
Control
ATTN: Gerald Allen, Public
Health Physicist
Division of Environment
Forbes Field Building 321
Topeka, Kansas 66620

bcc to DMB (IE45)

bcc distrib. by RIV:

Section Chief (DRP/D)	DRP
RPB-DRSS	R. DeFayette, RIII
RIV File	SRI, Callaway, RIII
Project Engineer (DRP/D)	Lisa Shea, RM/ALF
DRS	
D. V. Pickett, NRR Project Manager (MS: 13-D-18)	

MEETING SUMMARY

Licensee: Wolf Creek Nuclear Operating Corporation (WCNOC)
Facility: Wolf Creek Generating Station (WCGS)
License No.: NPF-42
Docket Nos.: 50-482
Subject: Family Open House at WCGS

On October 4, 1989, representatives of WCNOC met with Region IV personnel in Arlington, Texas, to discuss a planned family open house at WCGS. The meeting was held at the request of WCNOC. The attendance list and licensee handout are attached to this summary.

Attachments:

1. Attendance List
2. Licensee Handout (NRC distribution only)

ATTENDANCE LIST

May 24, 1989, meeting with WCNOG in Arlington, Texas

NRC: J. L. Milhoan, Director, Division of Reactor Projects (DRP)
L. A. Yandell, Deputy Director, Division of Radiation Safety and
Safeguards (DRSS)
J. H. Austin, Acting Deputy Director, DRSS
D. Powers, Chief, Security & Emergency Preparedness Section, DRSS
J. A. Kelly, Inspector, DRSS
J. T. Gilliland, Public Affairs Officer
E. J. Holler, Chief, Project Section D, DRP

WCNOG: O. Maynard, Manager, Regulatory Services
W. Wood, General Counsel and Secretary
M. Williams, Manager Plant Support
R. Smith, Information Administration

**WOLF CREEK
FAMILY OPEN HOUSE
OCTOBER 28 AND 29, 1989**

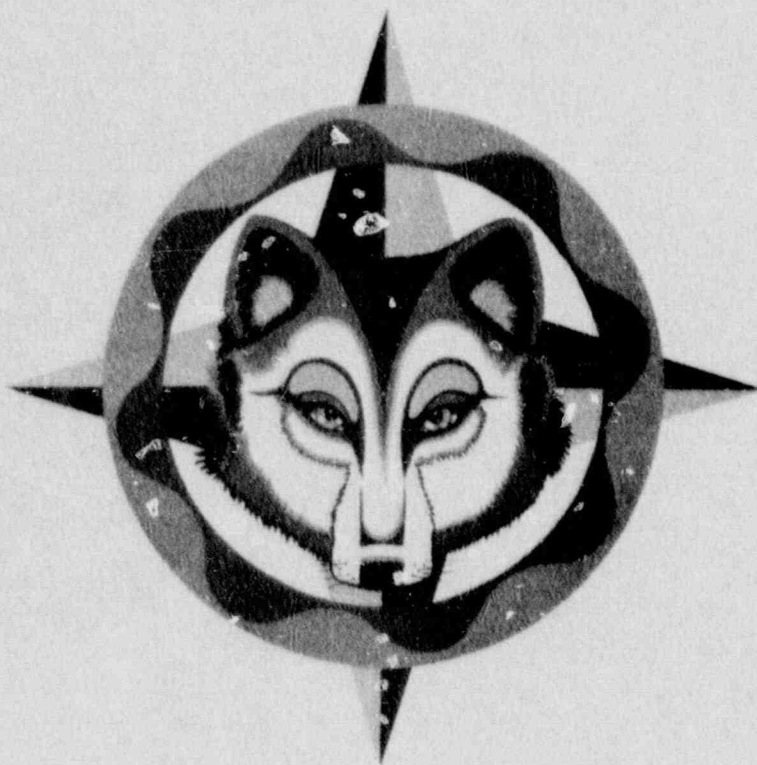

OCTOBER 4, 1989

WOLF CREEK
NUCLEAR OPERATING CORPORATION

WCNOC ATTENDEES

WARREN WOOD

GENERAL COUNSEL

OTTO MAYNARD

MGR REGULATORY SVCS

MERLIN WILLIAMS

NUCLEAR PLANT SUPPORT

RONN SMITH

INFORMATION ADMINISTRATOR

AGENDA

INTRODUCTION

OTTO MAYNARD

OPEN HOUSE PLANS

RONN SMITH

**REASON FOR OPEN HOUSE
SCHEDULE
PLANNED ACTIVITIES**

ACCESS CONTROL

MERLIN WILLIAMS

**GENERAL CONSIDERATIONS
ACCESS TO PAB
TOUR PATH
EXIT FROM PAB**

OPEN DISCUSSION

INTRODUCTION

PURPOSE OF MEETING

**DISCUSS WCNOC PLANS AND PREPARATIONS
FOR AN EMPLOYEES OPEN HOUSE**

KEY CONSIDERATIONS

**PLANT SAFETY AND OPERATIONAL CONSIDERATIONS
HAVE PRIORITY OVER OPEN HOUSE ACTIVITIES**

**NORMAL ON SHIFT OPERATING STAFF WILL
NOT BE INVOLVED IN OPEN HOUSE ACTIVITIES**

**OPEN HOUSE WILL BE CONDUCTED IN ACCORDANCE
WITH WCNOC APPROVED SECURITY PLAN**

PRESENTATIONS

OPEN HOUSE PLANS (RONN SMITH)

**REASON FOR OPEN HOUSE
SCHEDULE
PLANNED ACTIVITIES**

ACCESS CONTROL (MERLIN WILLIAMS)

**GENERAL SECURITY CONSIDERATIONS
ACCESS TO PAB
TOUR PATH
EXIT FROM PAB**

OPEN DISCUSSION

OPEN HOUSE PLANS

REASONS FOR OPEN HOUSE

PROMOTE POSITIVE ATTITUDE TOWARD NUCLEAR POWER

POSITIVE ATTITUDE STARTS WITH FAMILY

POSITIVE ATTITUDE PROMOTED THROUGH KNOWLEDGE

ATTENDANCE LIMITATIONS

FAMILIES OF EMPLOYEES

FAMILIES OF OWNERS

FAMILIES OF VENDOR PERSONNEL ASSIGNED TO WCNOC

SCHEDULE

OCTOBER 28 AND 29, 1989

9:00 A.M. TO 4:00 P.M.

PLANNED ACTIVITIES

EXHIBITS AND DEMONSTRATIONS

ENVIRONMENTAL MANAGEMENT

QA/QC TESTING PROCEDURES

SAFETY SERVICES DEMONSTRATION

RADIATION PROTECTION/HEALTH PHYSICS

TRAINING DEPARTMENT

WOLF CREEK ORIENTATION PRESENTATION

EMERGENCY PLANNING EXHIBIT

SNACKS AND BEVERAGES

IN PLANT TOUR

ADVANCE SIGN-UP REQUIRED

ALL VISITORS PRE-REGISTERED

CHECK-IN UPON ARRIVAL

CONTROLLED ACCESS TO PAB

GROUPS OF ~ 20 PEOPLE PER 5 MINUTES

EMPLOYEE-GUIDED TOURS

MAXIMUM 10 PER ESCORT

ESCORTED TOUR AREA

MAXIMUM 5 PER ESCORT

DEFINED, ROPED-OFF TOUR ROUTE

SAFE W/O HARD HATS OR SAFETY GLASSES

NO AGE RESTRICTIONS

EMPLOYEES MAY VISIT WORK AREAS

**WORK AREA NOT IN POWER BLOCK
DON'T HAVE TO GO THROUGH RCA OR VITAL AREA**

MEDICAL CONTINGENCIES

COFFEY COUNTY AMBULANCE

SAFETY SERVICES DEPARTMENT

**PHYSICIANS ASSISTANT
NURSE
FIRST AID**

EMTs ON SHIFT

ACCESS CONTROL

GENERAL CONSIDERATIONS

TOURS PROCESSED AT 5 MINUTE INTERVALS

NORMAL ON SHIFT SECURITY FORCE WILL NOT BE UTILIZED

NORMAL SEARCH EQUIPMENT AND PROCESSING

SPECIAL VISITORS BADGES WILL BE USED

**PRE-NUMBERED
PRE-DATED
MAXIMUM OF 600**

SPECIAL VISITORS ACCESS LOGS WILL BE UTILIZED

**ALL VISITOR BADGES WILL BE ACCOUNTED FOR
AT THE END OF EACH DAY**

ACCESS TO PAB

**OFF DUTY SECURITY PERSONNEL WILL BE STAGED
IN THE SECURITY BUILDING AS SHOWN**

BOTH SETS OF SEARCH EQUIPMENT WILL BE UTILIZED

**EMPLOYEES AND VISITORS WILL GO TO THE VISITORS
BADGE ISSUANCE TABLE**

**PRESENT COMPLETED ACCESS LOG FORM
GET VISITORS BADGE
BADGE NUMBERS LOGGED ON ACCESS LOG FORM**

**ESCORT WILL BE THEN PROCEED WITH VISITORS
THROUGH SEARCH EQUIPMENT**

**VISITORS WILL THEN PROCEED THROUGH
RADIATION DETECTOR**

**ESCORT WILL OBTAIN ACAD FROM PAC
(ADDITIONAL SECURITY PERSONNEL IN PAC)**

ESCORTS AND VISITORS WILL THEN ENTER PAB

TOUR PATH

TOURS WITH ESCORTS WILL PROCEED ON DESIGNATED ROUTE

**TOURS WILL NOT BE ALLOWED TO DEVIATE FROM
DESIGNATED ROUTE IN TURBINE BUILDING**

TOUR ROUTE ROPED AND FLAGGED

SECURITY PERSONNEL WILL BE STATIONED AS FOLLOWS:

**2000' ELEVATION TURBINE BUILDING COM COR
MAIN TURBINE GENERATOR OPERATING FLOOR
INSIDE CONDENSATE FILTERS DEMIN AREA
OUTSIDE POWER BLOCK ROVING, NORTH, WEST, & SOUTH**

**AFTER EXITING TURBINE BUILDING EMPLOYEES WILL BE
ALLOWED TO TAKE FAMILY TO THEIR WORK AREA PROVIDED:**

**WORK AREA NOT IN POWER BLOCK
DON'T HAVE TO GO THROUGH RCA, OR VITAL AREA**

EXIT FROM PAB

TOURS WILL RETURN TO SECURITY BUILDING



**GO THROUGH PORTAL MONITORS
EXIT THROUGH TURNSTILE DOOR**

**BADGES WILL BE COLLECTED AND ACCOUNTED
FCR WITH VISITORS ACCESS LOG**

**FOLLOWING ACCOUNTABILITY, VISITORS
BADGES MAY BE REUSED**

WCNOC OPEN HOUSE FACILITY AND ACCESS MAP

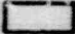
LEGEND:

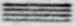
-  OPEN TO WCNOC EMPLOYEES AND CONTRACTORS
-  ACCESS LIMITED TO TOUR ROUTE
-  PEDESTRIAN WALKWAY

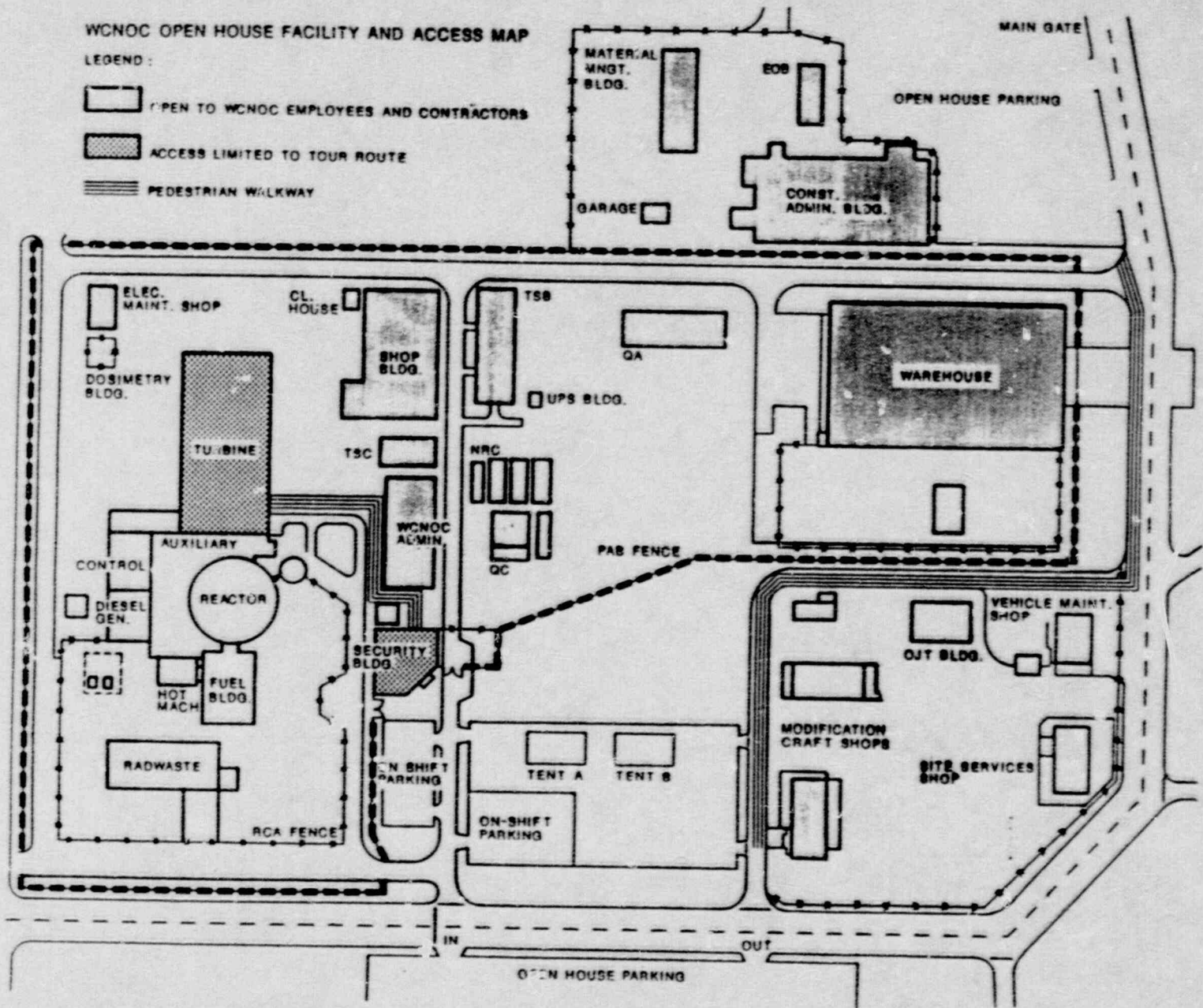

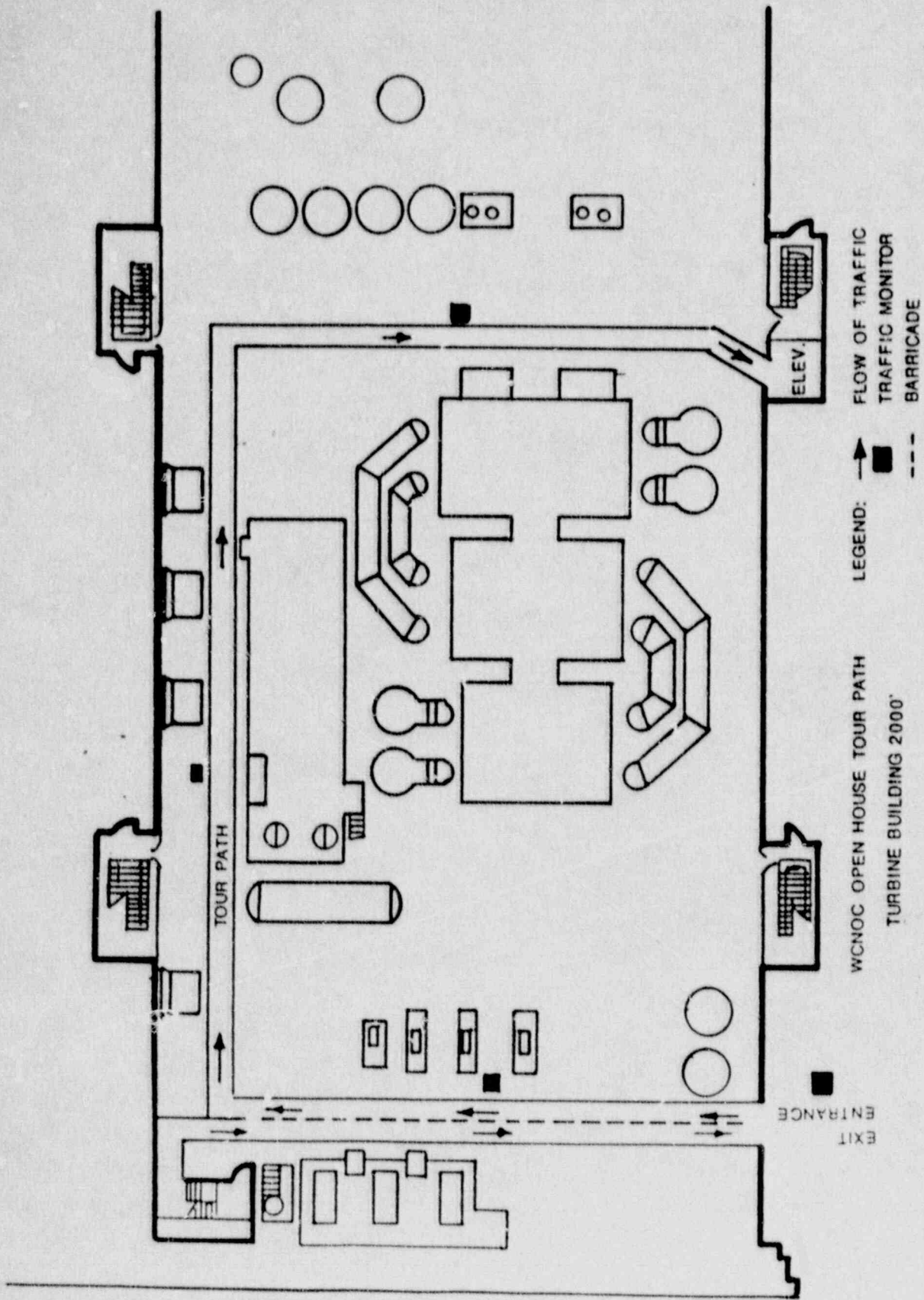

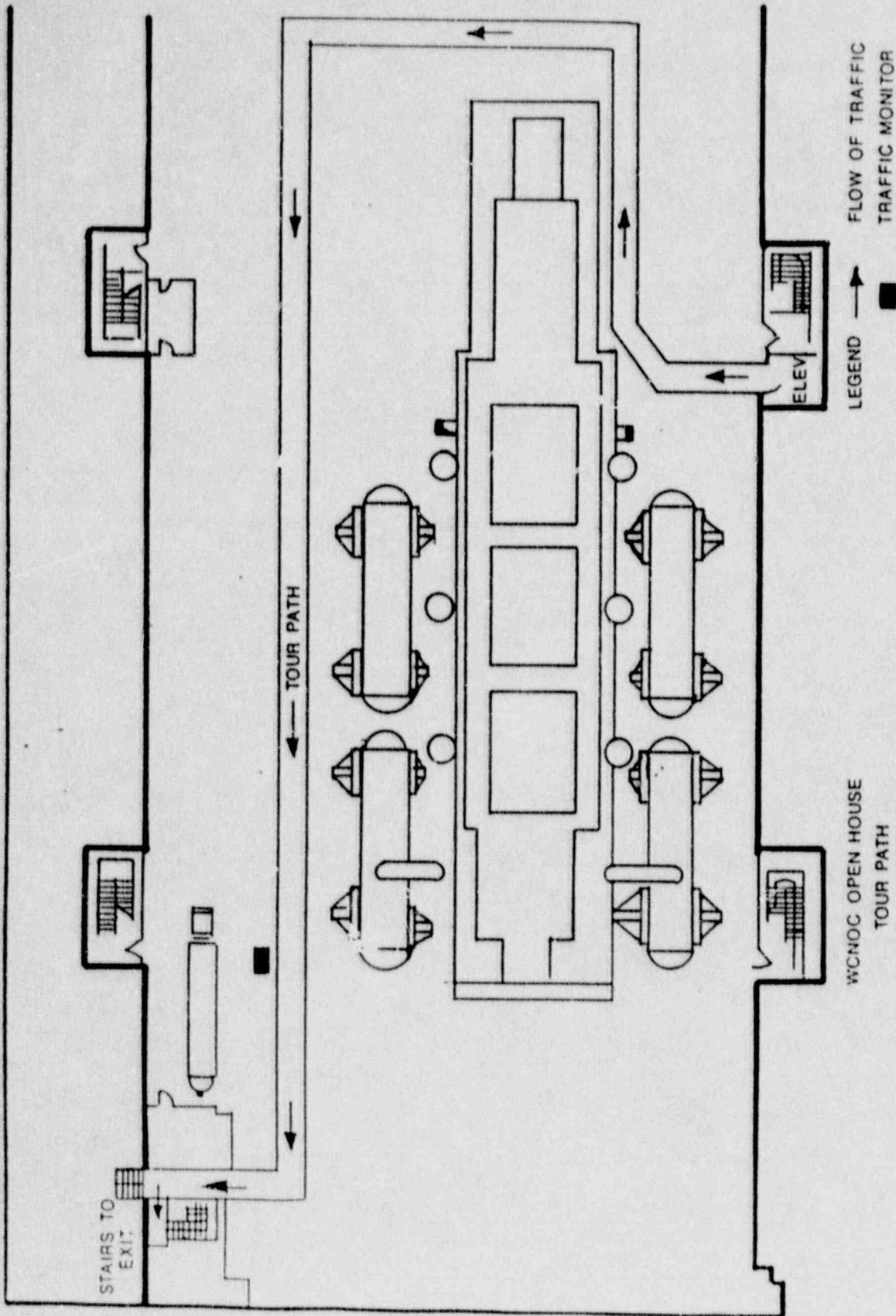

WCNOC OPEN HOUSE
 TOUR PATH
 TURBINE BUILDING 2065

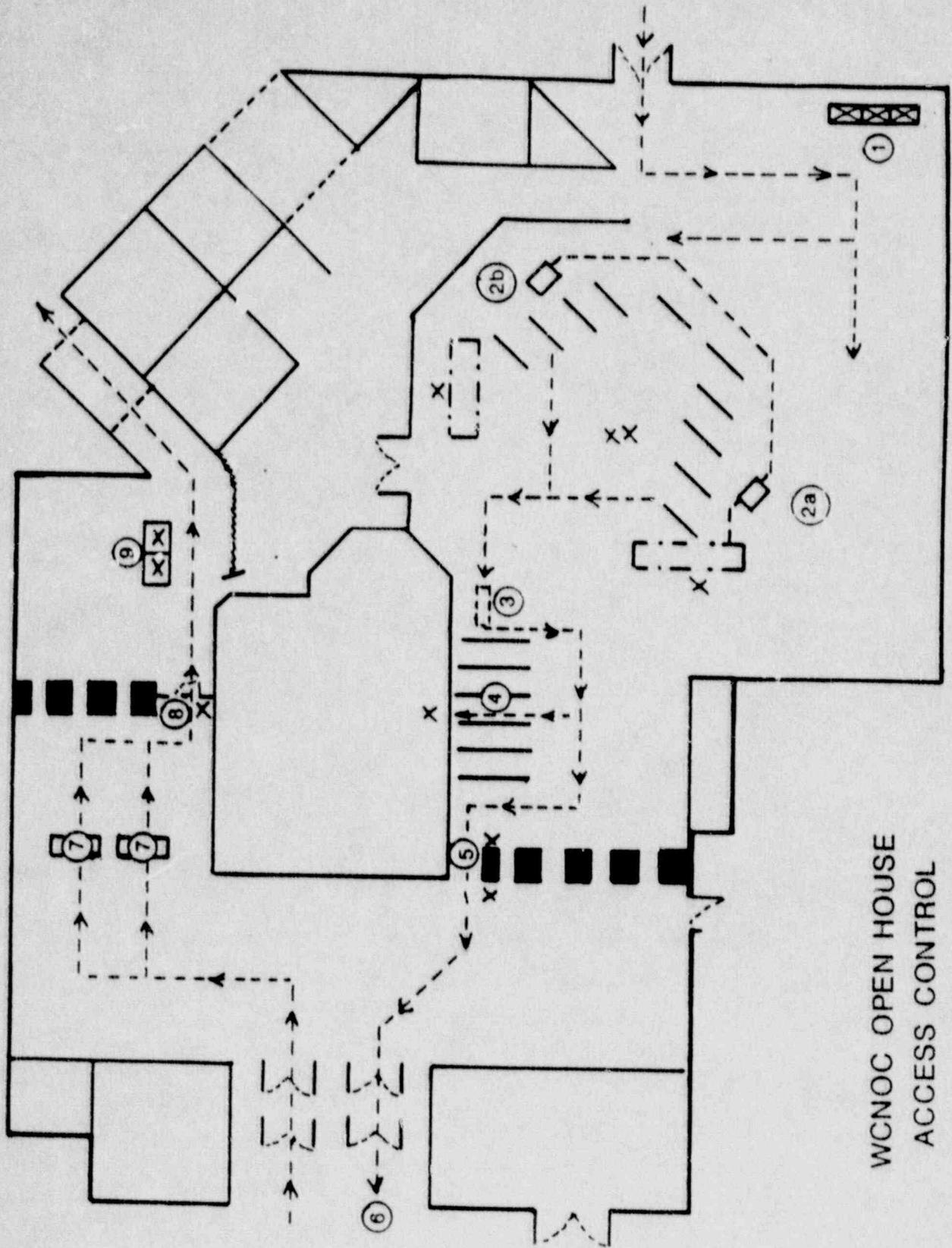

WCNOC OPEN HOUSE
ACCESS CONTROL