

SHAW, PITTMAN, POTTS & TROWBRIDGE

1800 M STREET, N. W.

WASHINGTON, D. C. 20036

RAMSAY D. POTTS
STUART L. PITTMAN
GEORGE F. TROWBRIDGE
STEPHEN G. POTTS
GERALD CHARNOFF
PHILLIP D. BOSTWICK
R. TIMOTHY HANLON
GEORGE M. ROGERS, JR.
JOHN B. RHINELANDER
BOUCE W. CHURCHILL
E. LIE A. NICHOLSON, JR.
MARTIN D. KRALL
RICHARD J. KENDALL
JAY E. SILBERG
L. BARA M. ROSSOTTI
GEORGE V. ALLEN, JR.
WM. GRADFORD REYNOLDS
FRED A. LITTLE
FRED DRASNER
NATHANIEL P. BREED, JR.
MARK AUGENBLICK
ERNEST L. BLAKE, JR.
CARLETON S. JONES
THOMAS A. BAXTER
JAMES M. BURGER
SHELDON J. WEISEL
JOHN A. McCULLOUGH
J. PATRICK HICKEY
JAMES THOMAS LENHART

STEVEN L. MELTZER
DEAN D. AULICK
JOHN ENGEL
STEPHEN B. HUTTNER
WINTHROP N. BROWN
JAMES B. HAMLIN
ROBERT E. ZAHLER
RICHARD E. GALEN
ROBERT B. ROBBINS
LAURA K. FARRAND
MATIAS F. TRAVIESO-DIAZ
VICTORIA J. PERKINS
JOHN H. O'NEILL, JR.
JAY A. EPSTEN
GEORGE D. CROWLEY, JR.
MICHAEL D. HAYS
THOMAS H. MCCORMICK
SUSAN D. FALKSON
STEVEN M. LUCAS
RAND L. ALLEN
ALAN J. WEISBARD
WILLIAM P. BARR
ALAN R. YUSPEH
JOHN L. CARR, JR.
PHILIP J. HARVEY
KAY L. RICHMAN
TIMOTHY B. McBRIDE
CHARLES W. SURASKY

(202) 331-4100

TELECOPIER

(202) 296-0694 & 296-1760

TELEX

89-2693 (SHAWLAW WSH)

CABLE "SHAWLAW"

JOHN H. SHARON

EDWARD B. CROSLAND
COUNSEL

*NOT ADMITTED IN D. C.

September 18, 1979

George Frampton, Esquire
NRC/TMI Special Inquiry Group
Nuclear Regulatory Commission
Washington, D. C. 20555

Dear George:

Enclosed is a copy of a portion of James McConnell's notebook which John Dienelt requested during Mr. McConnell's deposition on September 14, 1979. According to our records this was the only requested document. Please contact me if your records indicate otherwise.

Sincerely,

Mat

Matias F. Travieso-Diaz

MFTD:ry
Enclosure

cc: John Dienelt, Esquire (w/o encl.)
Lisa Ridgway, Esquire (w/o encl.)

*cc
Roz Bellamy
10/12/79*

7911060213

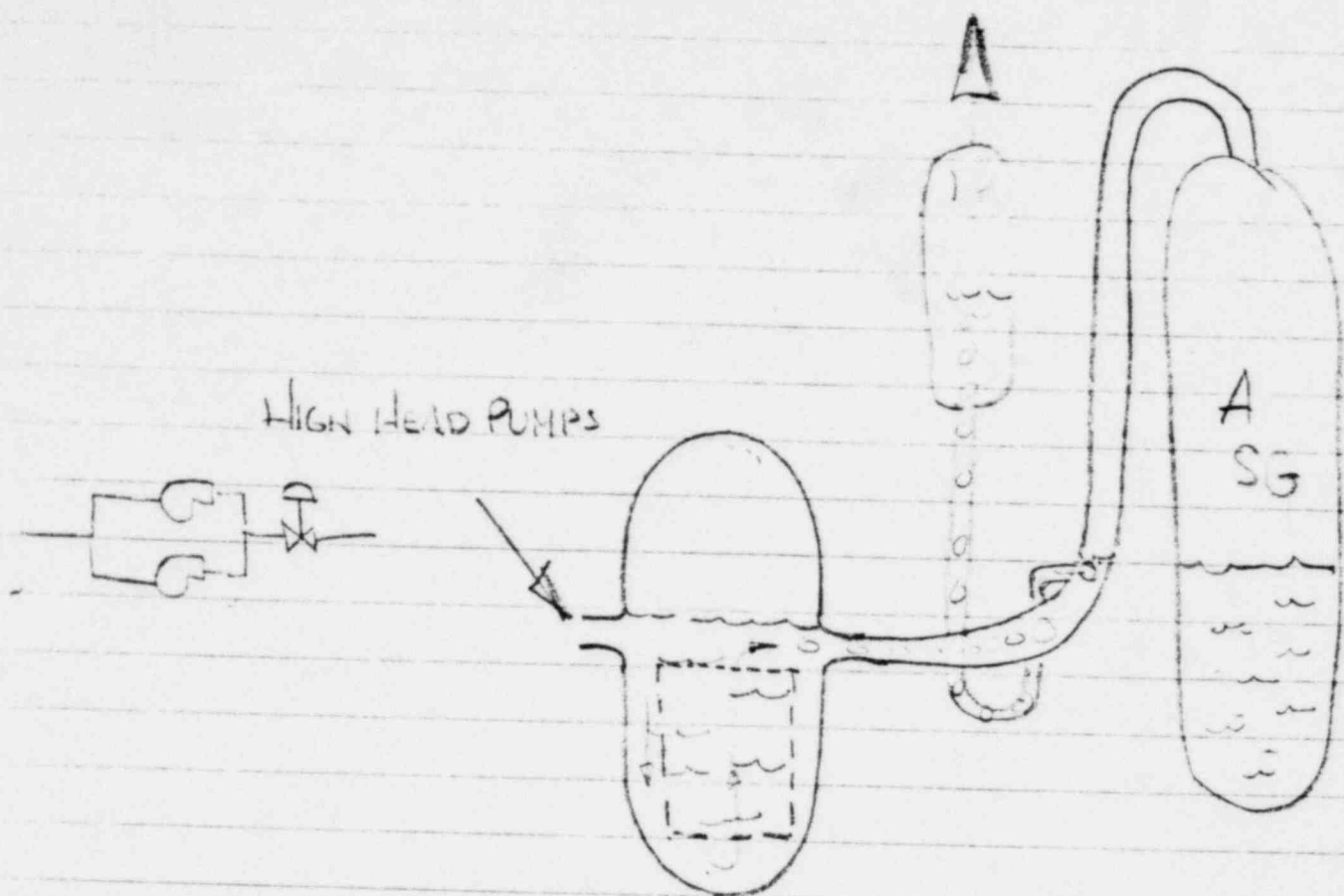

HIGH HEAD PUMPS

SLOW DEPRESSURIZE AND BURP

Ask Gary Broughton (944-1293) if we can get a detailed gas analysis from primary coolant. Can we get it from the Bethis sample --- or a new one
It's important

6 hrs for sample (3.2EM exposure to get it)

As ml sent to Bethis - no chance for gas analysis

100 ml sample needs 1000 R.

Ask Dan Rappert to have some one

think about how to do a gas sample.

- Please call 1800 hrs - sample open (depressured); can't do

RING-BELL III ASSESSMENT - FOR ACCESS TO 26

Bubble resolution (MIT version)

1. No evidence that bubble is anything but stable

2. Priorities

What you plan for:

- Detailed bubble removal plan
- Critical equipment check out

What you implement:

1. Secure all site power
2. Shield critical aux building system areas
3. Secure Accumulator (Core sink)
4. "Possible perturbances"

Willcox's report

- single loop, single pump operation
- Stable situation
- Cycle through 1 PCPS
- Try natural circulation - not sure we will get it (have 20 minutes of time to decide)
- Go solid through pressurizer vent, charge with make-up pumps - go to BWST
- Should core flood tanks be isolated?
- Surveillance done as directed
- Emergency power arranged for pressurizer electromotive valve
- Cont. loss, 7000 gal/min
- 10-18 gpm make up

DeHole & Keppner have been making the procedures

Jim Moore is developing calculation on bubble size

HMD's 6:00 Meeting agenda

1. NRC Plant Assessment
2. GPU Δ s
3. Group reports
 - x Core - H₂
 - x Current cooling mode
 - x Contingencies
 - x Waste management - not at this time
4. Key issue focus and narrowing
5. Base plan for resolutions

Contingency

if the power is } tends into
disrupted } decay heat removal

Coolest

Canisters at Bettis

10-12 fuel are heated

20-30% of

Estimated Bubble 347 ft^3

Radiolysis - increase O₂ the percentage 1% / day

- it goes into the bubble -

Other info says if collection, we are
recombining

5/1 1730

Bubble reduced

4/2 @ 9:00
HOURS

1. Get in Unit 2 switch Board
want HP-

blakey } want to talk to
Durbale } Ron Williams - ALARA Team

* Eric Harkin	Bechtel
Bob Brooksbank	ORNAL
ED WAGNER	EJRUSS & ROE
Jim McConnell	GPU
Rich Schower	3ER
Orlin Yarbro	ORNAL
WASTE MANAGEMENT	

Cold body look at containment/waste
situation. general look at what needs
to be done to control the waste
situation

Focus on what the primary problem and
the mission

- Federal decontamination teams (?) are alerted
- Support and Equipment on order
- Constructing a waste processing system
 - * Construction
 - * Liquid holding
- Tank and contents inventory

Don't let [unclear]
Current environment [unclear]
Cost recovery

History

Get for a set of full size Bldg drawings

1. Tie-up I-131-133
2. Make DI system accessibility
3. Containment

Techspec limit: I-131 & 133
(Emergency)

Need to look at back-up hold up tanks
if waste gas decay tanks ^{capacity} are exceeded

Tape - record

Ken Brockway (201) 265-5717
- all to "watch"

Dieckamp (11) to look into the
raining thing
Jack Tracy

25th

263-4010
RCP - have looked into

Jay Galetti
Chisum

Disadvantages:
- design speed becomes less reliable
- speed control etc.

practical
etc.

Low Key - Operator you go through to start-up
is tricky.

we know where
it is
it is
it is

Charlie Anthony (W) (412) - 274-6300
(412) 836-0233
Romano Salvatore (414) - 373-5555

Summary:
Several units 7000 HP 4160 volt FM
diesel generators -
5000 HP driven at for seabird
Dunham Elec
MG-Set 500, 200 generator

4/3

-0800

Briefing information

- Information released by NCC at 20 p.m. concerning I₁₃₁
- Plumb monitoring Carlisle
- NCC taking lots of numbers
- DOE SWAT teams in at 2300, meet with Brookbanks

• Maybe we should review JL pathway

• Ray Clark

Aux building

- is ventilation system on or off?
- has it been on or off?

xxx Meist have a water sample from the aux building floor or sumps

Monitor HPR 222 in? History and status
226 out

John Vincent 944-1505 *

944 1266

367-4887 *

367-6346

Bill Hirst - On h.l.

944 5014

Wilson 944 0158

James 944 5070

~~Bob Long~~

~~367-6351~~

~~944 4023~~

~~944 4620~~

Carot

Thurs

M-Lanning is BFP engineering team

Developing has requested that we move very fast on what to do to vent waste gas holding tanks back into containment

Need RD Clark

Need a procedure to keep caustic (NaOH solution) wet up.

Actions at 10:30 A.M. I control

- Emergency Report
- Stack monitor I results
 - Procedure to maintain caustic wet state in critical area being done
 - Critique - emergency waste gas treatment
 - Critique - waste water demineralization plan
 - Up grade filter train on Aux building

Do's and Don'ts

1. Secure and tag out I pathway into Unit 1 (Misc waste connection to Unit 1 evaporator)
2. Check condenser gas ejectors - secondary side

I: 8 day

12:00 - Request status and history of liquid transfer to unit 1 and if so - on I sample from Unit 1 Misc WASTE TANK UNIT 1

minutes regarding temporary piping
between Waste Gas hold-up tank to
Containment.

1. Per Ron Williams a cruise line
was connected several days ago
(Gary Boughton should be called to
verify this)

12:15

Work on oil filter trays in the condenser
at some common downstream point

3:40

5:20 Review of the FHB as a site for
the following:

1. Contingency storage for the sump
liquid in containment
2. Liquid waste treatment plant
3. Make-off gas treatment

17:30 Vacuum Pump sample - secondary system -
at 10^{-3} Mc/cc of I 131

17:30

WASTE MANAGEMENT GROUP

- last data needs - prioritized -

1 Is the Aux building fan on or off?
and what is its history in the last 24 hrs

2 Reading of down stream filter monitor
and up stream gamma (HP R. 222B gross -
and HPR. 228 - I / G)

3. Gas - or liquid? vacuum pump sample -
(What is the origin of it?)
issue is should air be back into
filter system

- * Alert Naebien about Solution In wet down, AIX
- * Bleed back waste gas into containment
- * Clarify gas sample ambiguity
- * Replace charcoal filters a NVAC

Can we vent containment via the
Charcoal waste gas system - use the
prod as an option (primary) physical

make gas zinc/iodine reaction \rightarrow Hz

* Change out some AUX bubbling filters
with ~~char~~ charcoal

See about loc. NVAC 6 to 8 people

Went out NP-E-219

2 General Chemistry Lab

A @ 0600 on 3rd I₁₃₁ in H₂O $\mu\text{c}/\text{cc}$
error est. %

I ₁₃₁ -	1.4×10^{-3}	0.3
I ₁₃₃	5.6×10^{-5}	2.4
Ce ₁₃₄	2.8×10^{-6}	26.5
Ce ₁₃₇	2.4×10^{-5}	4.1
Mn ₉₉	2.5×10^{-6}	46.7

B @ 0700 on 3rd l

error est. %

I ₁₃₁	2.9×10^0	.001
I ₁₃₃	0.081	.3
Ce ₁₃₄	0.008	3.5 %
Ce ₁₃₆	0.018	1.5 %
Ce ₁₃₇	0.032	1.3

⊙

01030 @ 30th - B g/L
u/cc em-8

I 131 7.9 0.6

I 133 2.1 0.3

I 135 8.5 (-2) 30 (-2)

Cc 136 6.8 (-3) 1.5 (-3)

Waste Release Data (to River)

~~944 - 409
+ 1 - 105
159~~

18:55 - Jim Floyd, Ron Williams, Alin Yamburaw
Meeting... Service Building in Jim Seelinger's office

Aux building has primary coolant leakage rates
on the order of 100 cc/hour

Issue is, where is Iodine in Aux building
to coming from. There are

* 60,000 ft² ... very difficult to develop
a method to get caustic trisulfate
down to tie up I 131

* Maybe we can flood the primary
leak area

Procedure buy ins.

- HP
- ALARA
-

7/20/82

9845

A Priority do list (I)

- I
1. Get lots of chemical beds in long!
 2. Find out if we can (radiologically) replace the filter (Broughton/Lowe teams)
 3. I² yes - change a filter "chip-chip"
 4. Get in with design of a down stream - build (both buildings)
- II
5. Cock the gun to the procedure for a caustic-sulfate wet down procedure
 6. Review primary coolant additive program
 - O Y - chemical bed
 - VFM - Tank critique of 6.5 < 7

B Priority do list.

1. design/procure oil gas treatment system
2. design/procure containment waste storage
3. Procure B pool equipment on model of oil gas treatment
4. Install oil-gas treatment
5. Remove A pool equipment
6. Install ~~oil-gas~~ primary storage tank

Bob Arnold is "going in" after
Ron Williams - getting a sample

Ed Volario (DOE SWAT TEAMS)

Where is the ^{2nd} of the ~~sample~~ - has the ~~sample~~ sample
(Ron Williams says as of 12:00 hrs, there was a
decision not to - he will reconfirm)

Looking for a vehicle to use
Indiana - (checked with Tsi Gazzani)

1. ~~at~~ ~~the~~ ~~same~~ ~~time~~ ~~as~~ ~~the~~ ~~other~~ ~~technique~~ to
ambiguously ~~is~~ ~~the~~ ~~Indiana~~ - up ~~on~~ ~~last~~ ~~from~~ ~~the~~
classification. Instruments are currently being worked by
Senes.

2 Page Hill Rd - Palo Alto Sq. - SAI - Tsi Gazzani
(415) - 493-4326

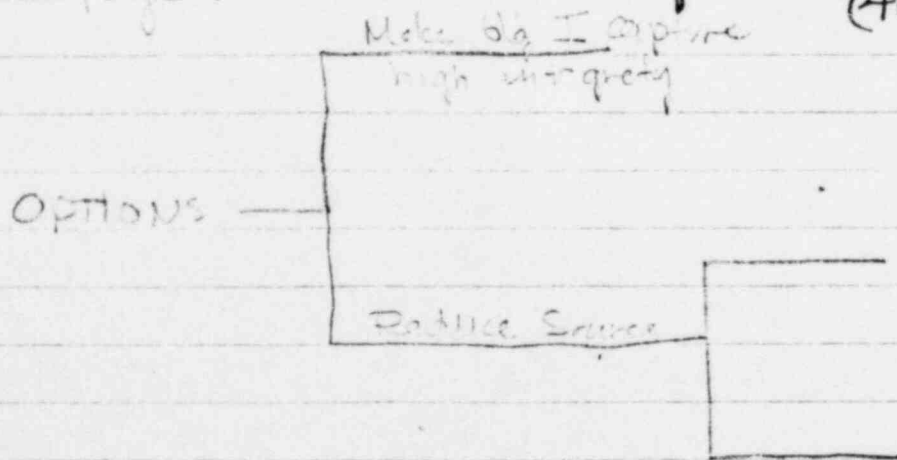

3 Should confirm organic I fraction in the
primary coolant.

17:00 HRS

- Relayed information to Ivan Potter on ORNL instrument analyzer - as asked by Dick Wilson
- Feed back from Gazzoni recommends substituting "standard" Silver-Aralite filters for charcoal filters in the stack Iodine monitors
- Per Ron Williams - Howard Doble is confident that the off-gas waste storage tank sample as determined by GPU is correct. The Bethel sample was contaminated by air. Prudence dictates that we resample and check for O₂/N₂. Also there is at least one sump in the Aux building 3/4 full of water - we should treat these with caustic thiosulfate

SAV 11/13/82 5203 223

18:30

- Per discussion with Dick Wilson - wants to determine/cure to happen in tie to vent WGST to containment - try to reach Gary Miller - no good - try to reach Jim Sellinger at 19:00
- cf. 944-4621
- 944-7621
- 944-4041

- Venting, make up tank -
- I don't think that venting W₂O tanks must

Jack Levine -

John F. - - -

appears on "Waste Gas Vent to Containment" problem
appears to be a non problem

- System is in place to vent back to containment.
The procedure is drafted to do this and
signed-off - except WRC will have reviewed it
- Degradable animal carcasses will
dump at the containment bin via the
Make-up tank. The VIGT can/will be
isolated. Relief line may be kind changed
if analysis supports it
- Containment pressure can be regulated/increased
by raising temperature
- Risks associated with gas vent have over
small - should be avoided in a satisfactory
alternative is available
- Heavy calculations for the secured times
would serve a destination -
- No exposure scope - only for venting into
environment at current concentrations - vent can
only be as a blower

0830

Access to Unit 2 FHB

Procedures:

1. Get to UNIT 1 CONTROL POINT
2. See DALE FERGUSON
 - 40 ft ladder with safety rails
 - H₂ Recombiner
 - Full Anti C₃ & Respirators

} Visit model
if it includes
fuel pool

0915 - STATUS MEETING

- Waste water treatment plant "flow sheet"
 - * Process scheme ... criteria
 - * Solidification scheme ... criteria

Evolution of criteria is the first step -
followed by NEC et al critique

- Review tank inventory -- looks like max tankage is 200,000 gal in the A pool

• Charcoal filter status, getting new filters
in as soon as we can (Have a problem in
authorizing charcoal filters - this is Coburn)

Need 90 each in train

160 Morgan
180
120
310

160 on site today

0.3 curies/deer

Walter write a "work request"
Orlan says "too-late"

Vacuum pump/air ejecta system drawings
done - plane arrives momentarily -
Charcoal trap equipment

Will ~~to~~ have OML look a solidification system

Dryer system for AUX/FNB - HVAC venting
filter control

Gas-emergency system design goes on looking
at new fuel ~~fit~~ probl.

Filters are getting hot (200K)

Ron Toole is the "Planning Manager"
review the current SOP

iodine monitors (Silver Zeolite - discharge monitor)

DAILY PLANNING MTG

Current status - degassing with current procedure

... Ed Wallace

1st priority - upgrade degassification process
we have 5000 Cu in solution

- must degas like hell!
- Increase let down blow!
- Use sampling system as a degas rate
- MU tank vent to containment

• MUD } submitted and signed at
• DNT }

• being installed

• verified - procedure approved

• Tank sample - unknown status -

• Gary Miller says it will be available today

Review AIG/FAB I discharge -

if we satisfy plant man, the situation is
heat - must get back to Gary Miller / Herb

Must coordinate on ~~the~~ Waste Management
action plan with Ron ~~at~~ Toole

60 Mh @ 300 = 18.

* * *
WMG * * *
Condensate deaerator ^{shield} will ... get this
into Burns & Roe via Waste Management Group

Aux Bldg sum I 1.6×10^{-7}

Waste Management G-

Donnie | ~~Porter~~, Nagai & Renshaw

WASTE GAS DECAY TANK VE

VENT MU TANK THIS MORNING

ASSESSMENT OF DECAY TANK - (2ND PRIORITY)
LEAKAGE RATE VS ? ANALYSIS

BLANK THE HEADERS

* ~~PH~~ CHARCOAL FILTERS ARE ON QA HOLD

MODEL BEING MOVED IN A ROOM IN THE
AUX BUILDING

PICTURES SET UP IN THE ~~TOP~~ TURBINE BUILDING

* { IVAN PORTER HAS IODINE DATA
TANK INVENTORY DATA - how much and what

* * RADIATION MONITORING INFORMATION

- * MILLER/WALLACE GET BACK TO WMS on ^{Liquid Waste} ~~sources~~
- * OPERATIONS IS HESITANT TO TRANSFER LIQUID TO UNIT 1

Mem 22 -

* * 23 Desensitization and Monitoring System

Mem 25 - update plan to measure high Iodine levels
- Gary Miller = Alert and Action levels
- Dick Decible

"Have NRC memo on this"

Good for 2.5 PSI negative on the PCB
-- concern is resurfacing - Devine back to Think Tank
with the problem

No 3 ref/c I_{131} in B steam generator - filler
req is high priority

FRANK PALMER
- CHAIR ED

4. Must process Unit 1 water

RMS eqny
: Operator info

WASTE GAS MANAGEMENT GROUP -- Kick-off meeting

Introduction by Ron Toole

Ron Toole's people: Rich McGee
Earl

WMG - Briefing Meeting

RLW - Critiqued AB volume off-gassing situation
 W McGee - no look and see yet for leaks
 - Control Room wants caustic in AB sump
 - Want ICRPOD meeting want WMG recommendation

WMG - will produce criteria on caustic H₂O addition to AB sump - P&R will prepare the methods - we? will prepare the procedure Harrington/White are responsible

RLW critiqued charcoal filter change situation
 • 6 hr change time - non-radiation plan
 • Need a survey

Third Times

Dayce Company Representation

~~NRC~~ - ~~John~~ CAP-GUN - system

John Collins is the NRC individual who must be convinced

TASK - Design demonstration system in the chemical cleaning bldg.

Snigden & McGee

Byron & Lee

11/15/85
11/15/85
11/15/85

#1773

- Candy and Candies minimum purchased
- P... ..
-
- (put it on hold unless we see a need for it) put it on hold

#1773

-
-
-

11/15/85

#1775

WNG Organization

LIQUID
~~WILLIAM~~
WILLIAM

GAS
~~WILLIAM~~

0800 Mly of WMG - 4/7/79

letter is required from GPU to NRC to authorize shipment from WPSS to TMI - 250,000 parts

Contact of WPSS - (509) 377-2351

contacts: John Thomas

Bob Peters

Ed Wagener is the coordinator on this end

Fred Stern identified "Unit 2 water storage tanks as the ¹ NE 1 priority. Ken Harris (#23) is available to help

0830 WMG 4/8/79 PLAN & UPDATE MEETING

Organization:

Get things down to the critical priority items

WATER RUN DOWN

CAP-GUN Ran 20K gal, I₁₃₁ is high.
-- must reprocess it

Unit transfer 6000 gal to RBT
shows as decrease in AB sump (filters clogged)
Pulling filters in ~~in~~

RBT A B/C, 3 set of readings - very high in I₁₃₁
POK ~~each~~ A-I, 10⁻² µc/cc (Full)
B-- 75-100 µc/cc (1/2 FULL)
C-- 100-110 µc/cc (Full)

@ 2213 see monitor X10 .

Sampled

Roof equip for roof top filter is arriving
started bending duct metal

Take a look at vent fan operation in P FHR

Why did we stop decay tanks at 20psi?
Answer .. went below critical velocity for
potential burn back

Filter unit for air jet ejecta,
Mtg at 1000 for blessing.
another day if OK to finish

Plan & draw

Review change out of aux bldg filter train
Futrell will help
Do we need heaters

Unit 2 CIP-GUN project. - Jim Snider is the coordinator

- Design of equipment skapping
- Building caulking at finish sump
concrete
- Need vent monitor for tanks

Portland GE must give us a release on
NMC units - want all four

... to call

... force -

... CALL. some work

... in the data processing

... long range

... processing

... processing

Be'R Buzz Colson

↳ Called Hedge to request an assessment of the need/value of Ion airlock into the FNB

Some Jules works for Don Shuklin
call 944-4041, x 206, 282.316-

Sar Jules

Problem. arc

last accident - no days ago was 700116

A-pool

Circuit operators exposure - stay time limit

maybe shield

moment operation is then if leg. +

switch for ≈ 25 + change on

1102 ON SAME \approx switch will look into
25- BRIDGE

S U

S S

Are ladders into the pools

Load trucks

Above doors

Lots of drum (not too many) HP storage
solid waste contain - maybe give us
enough space to stage

Grotes ~~over~~ over key door
need cherry picker

a- lower racks on side 15x10x10
reach in with cherry picker -

More refueling, reaching against RB

Wire fence 8' high on 347 at Unit 1

Some ore from catalytic would be

Cont 1 etc low pressure

Jack 31 hrs. Comm -

08:30 - 1/5/15

* CIP GUN I low flow ce

* RST (R) has 13' (2' of capacity left)

Trans etc + ~~trans~~ test run with AB @ 3 gpm

Leakage identification/prediction program
addressing

We have 2 days left in tanks -
2 days on AB flow
after 3 days in DN pump & valve

RB low concentration

CHC GUN 2nd pass had I₁₃₁ 20 DF
reported to higher Xe should not be!

Procedure completed

Review CIP GUN II pipes not in to get
done - chemical cleaning by pipes not in

Work done 2nd day - continue to get the
tanks done

City

Spent

to improve will look into the HVAC

AP All the things mentioned have been checked
Marie MacIntyre will do it.

High I sample was done

I will be done in 1 day

Unit 2 will be DF test. will not

2200 Coburn Farm

IIA W642 2nd Run II
 TS 43 6th SC B
 TS 44 Measure RB Water level
 Fict. Run to RB
 W646 4th Ten's Farm

TS 40 DG location
 TS 41 2nd area of Plant District
 W647 Stand in field 2/2

W648
 2 V DISTRICT OFF GIP FICT. Run 3/2
 TS 6 Pressure Point PCB in water
 TS 7 1st Run to RB
 W649 1st Run to RB
 W650 1st Run to RB

15:30

Get with Joe Logan or someone else
at 15:30 to start moving things

• Got hold of Don Shuman at 15:15 -- will act
with Seelinger / Logan - or rest of
to progress the job of moving things
to other location or out of the
camp / 300 315

Seelinger - Miami

Jim Smith - Leo Kirkick
Coral Gables, Jim Seelinger
Ed Finney - will supply the Finney

Jim Smith - 221 will be the Finney at the job
more than any other person

Ask H. Dale Finney

... 200 - 50 clean ...
... 50 Duty down
... in the pit area

THE RECORDS

Monday - 11/10/19
with Mrs. [unclear] [unclear]

at [unclear] in [unclear] [unclear] [unclear] [unclear]

at [unclear] [unclear] [unclear] [unclear] [unclear]

at [unclear] [unclear] [unclear] [unclear] [unclear]

at [unclear] [unclear] [unclear] [unclear] [unclear]

#1 [unclear] [unclear] [unclear] [unclear] [unclear]

at [unclear] [unclear] [unclear] [unclear] [unclear]

at [unclear] [unclear] [unclear] [unclear] [unclear]

What physical cell
we are looking for
Kontrol checking
on flow sheets
can + quide

WVNG - Gas Group

- Ed Wagner - BFR
- Bob Dunn - Gilbert
- Walt Stone - Gilson (Curt)
- Bob Feltrell - Duke
(Rosenman)

#1 Priority for Gas is Filter Change

Biggest problem may be "Do we have cells?"
 we are concerned whether the right cells are
 available - may have 80 to 90 cells of design
 spec - 200 cells are on order - 40" length
 from MST - stretched over 2 weeks at 25 per day

sequence - 90 per AB train
 60 per FNB train

have 78 to 95 proper units

All Control is in Plant Maintenance
 need procedures for etc. logon

10/6/3

#2 Down through the Cobean Group

Expedite the return of the Cobean Group
by all force

ACTION: Down through Charles & Peter
change detector sensitivity
(may not be necessary)
Charles is working with

Monitor incident log, start in the same as intended
for the new filter system

Armed not on line

Marlin Sheen (RFR NRC) has lead on
back up filter

condenser vents
#3 Air jet ejector - still being work
RFR Group } Cobean task
George Harper

* Get letter to George Tisdell with work order
for the air duct cleaning plant
- pending

ECM → WO to Carcadden et al → WA

Kenzie, Tom, compile together a memo

C. ~~Peet~~ Peletier } Working the monitor
Carcadden, BER

Sandy Levine will make arrangements
to get out the "NMC" monitor from the
FNE

Escalator work goes in

I want to set a reading time since in
this situation of leaving open the filter
while getting back on ventilation to support
the charcoal filter change

Filter Change Gang

Bill Brannock (ALARA)

Bob Futrell - WMC

Al Conrad - MET ED - Maintenance supervisor

Sandy Levine - Construction support

Exhibition VIMS Co. Group Critical Hazard

1. Provide support to Al Conrad to take off back pressure
2. Determine that we can work the air filter change while we open FIB Dose for Tank Farm 100
3. Realize that we can move out the CAI from FIB for the stack monitor

Bill LeScott }
Scott Ah }
Bill }
Scott }

SAI contact man on Manito - Jim Cline

Doug Weaver is getting the thing put together
John Plummer (Engr) will get the release through Fink

Dr!
Bill! Charcoal sample out of the reactor purge system

1500 Update

AC Filter Change

1. Dan is going to be doing the change of
plan to increase people. There is some
information by various people. I will
be out.

2. Training of team (12/shift) completed
regarding H.P.

Vent Man - (1600 hrs)

- Set to left E-beeline instrument into work

HP - I set monitor

HP - 2 Place wires (as side)

HP - Pump & die

See instrument station/terminal and
central air monitor

Jim Cina/E-beeline make a tag-

ting. Plans number are on site

1700 .. Talked with Dan Shovlin ..

He has checked the area - ok.

HP is working the air supply system, ^{insulation} ^{stayed}
1st shift is trained, 2nd is underway

Hot spot survey and route definition underway

Dan will stay until support disassembly is done
and a filter cell is pulled.

Check out the new pump in the even
room

4/11/79

W

10:00

10:30

11:15

Check out of where we stand on the Corliss
vacuum pump discharge filter

Got hold of Greg Hite.

"System is not in use, cost in is made,
Hite like a 2000 evolution unit
available".

4/12/79

0820 WMC update meeting

Start taking a look at what shut downs we can do
on the HVAC system in the AB and FHB.

Bill Dunn's update on CAM for the vent stack

April 13, 1979

11:30

Called - Sample coordinator 944-1880.

Gary Hanner talked - he knows nothing about my sample request.

Asked to have Joe Lacey visit in AP/SLUPH. He was advised he would be tasked to support the filter change evolution.

- Ernie Day is checking on the gas meters - has it MetEd W.R. C 190? (HPR 222) repair sample pump

TRACOR vent, venturi is d/t z
HPR Inlet HPR 281-A
Outlet HPR 281-B

AE Inlet HPR 221A
Outlet HPR 221B

- Need to get WCC sample sequence and procedure into the program

Line into isolation of new/old system

Received this for testing with ...
 ...

Vaccine (consultant)

max no. FIB have not been tested

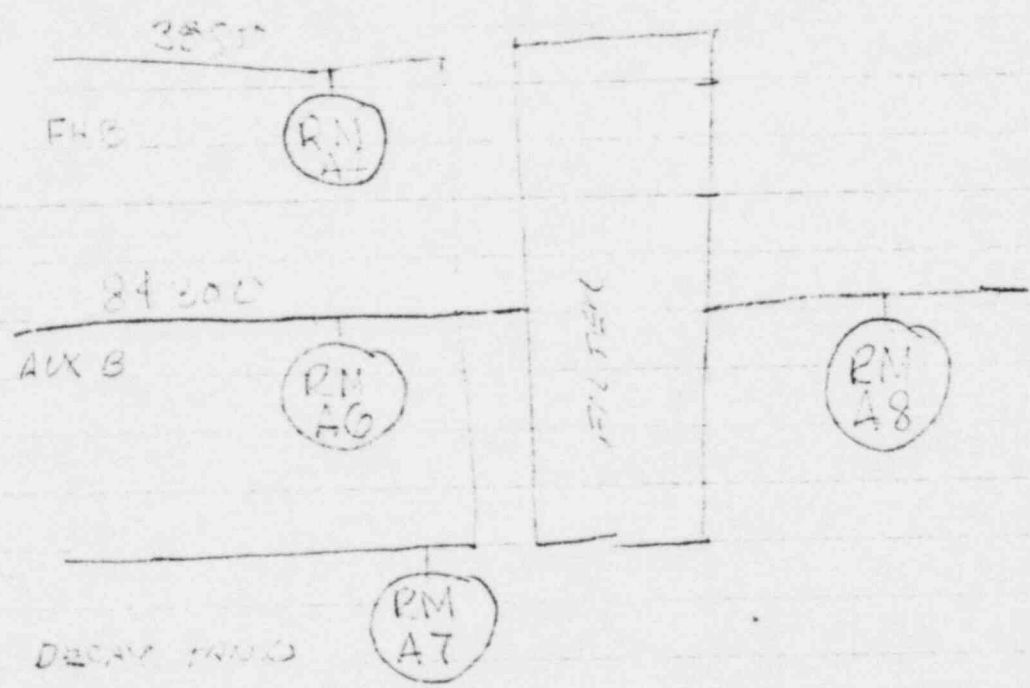

Have people change coat, wash 12-2 times
 Change again and ... the 12/24 hrs ...
 Report :

I 131, Particulate and ...
 Record on flow at both (then changes)
 (Same a sample in HD 219)

MC

To MEL Ed - THU operation
82+X

4/16/79 - 0800 - 01800 general status info

1. HP 219 - Electrical monitor resolved
calibration question - readings 2 - 2 1/2 times
and some - want to justify calibration
because grab sample. Per Jim Chase, it looks
like 0.3 curies/day discharge since sat.
2. Talk with Burrows about activating process
alarms to back up manual damper -
3. 80 CFM air compressor (and service air)
sample sent to calibration
4. In control room to go, Had a sleep, looking to
establish manual start system.
5. Got shift - starting to go to work
6. Status of WCC - lot of the sample uncertain
7. Gendy Lewis burst to create shift
After call
8. Consider vacuum pump discharge filter
OK - in operation.
9. Ask Bill Dem to go cover back shift

Orlando Yarbrough phone # (615) 574-7035 - work
(615) 691-0077 - home

4/16/79 - Do list

1. Need Aux building elevator slump information -
how much water - what's in it. Talked to Dave
X 317 - Earl Schwaetter will get back to me
on this.

2. Want to coordinate with Joe Lieberman, Bill
Itchenes et al on evaluation of where air
is coming from and going, status of dampers,
air flow and a strategy for managing
air.

4/17/75

River Hydrocarbon Unit Control Room
PMA 81 monitoring 870 CPU since
at 1570, steady since 0700

Lake Barrett NRC rep. gas release
management group

4/15

Murray of Helmer called regarding
commercialization/shipping cost study being done
for EFR

- Check Montserrat re WPSS follow
- Get answers to birdies the breeding
system from Summit River

EFR drafting system description, start up
and operating procedure

MSA - now wants to consider total order quantity

Mark Bagall - 347 - will identify format

Ray Wom

Ken records - MSA - look at Ficon and DOP test.

MRC wants Noble gas on-line monitor functional
SAL/CLIN - w/ ECP/ELINE -
Need ECP/ELINE in here to make it work

Walt Mullock - WPSS

Roger WPSS

Investigated MSA availability to do DOP and
Ficon test. JLCB advised.

Wants Dennis D. and Frank Gilbert
Kept up speed

Ordered 200 more filters, should order
more

Contaminated air tank - is it being monitored?
get some caustic thiosulfate.

N Martin

10F0

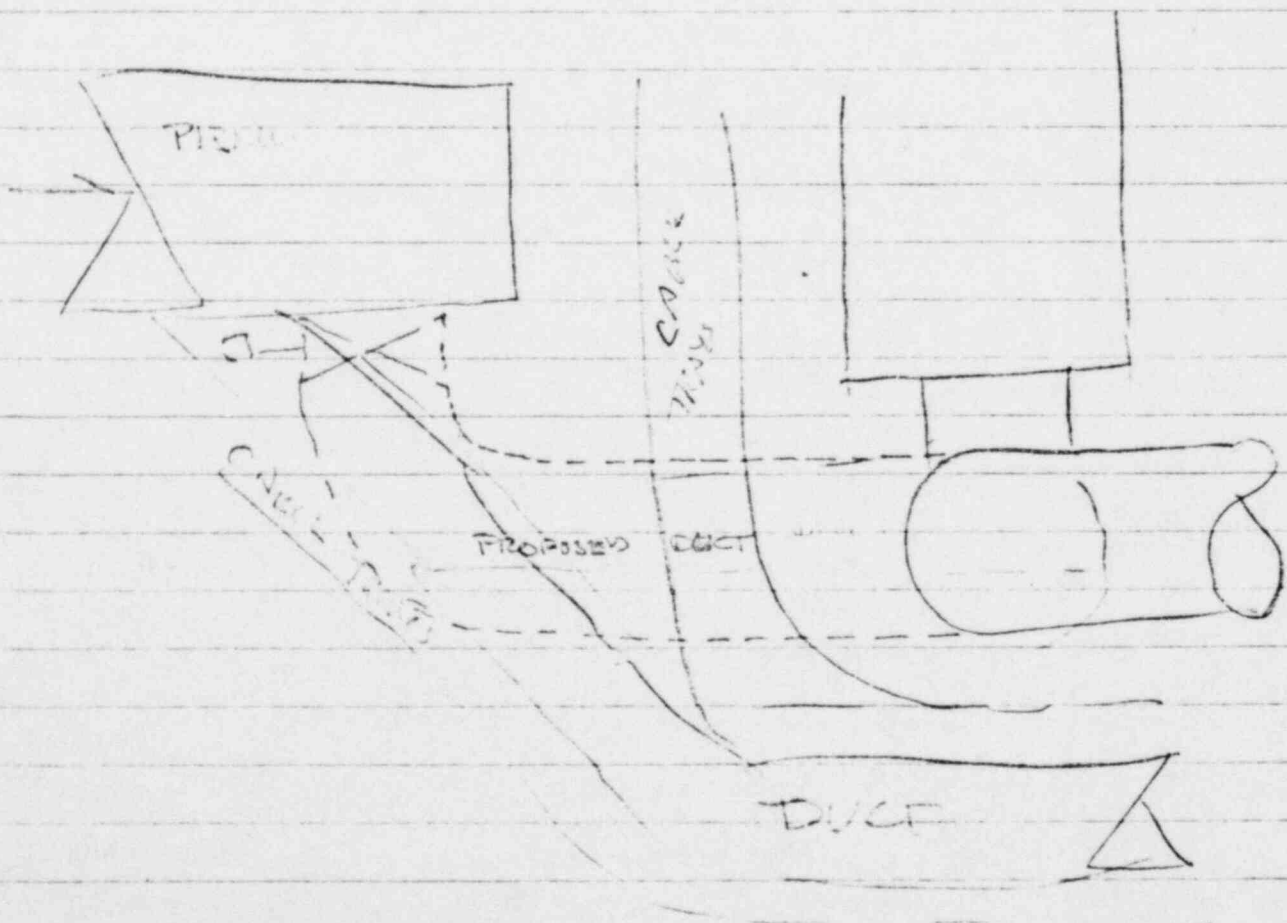
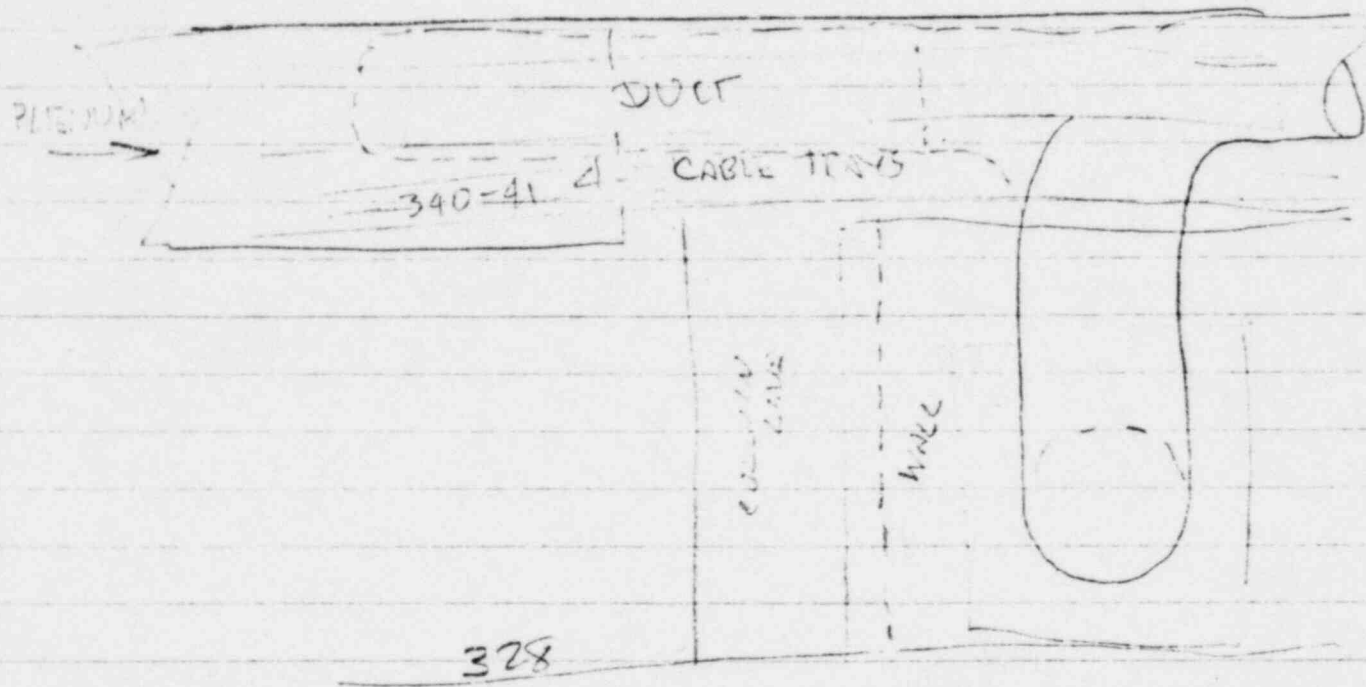

total review for air work done:

1. Proposed duct will have to run near the ceiling line of the 308 elevation (between 341 and 348)
2. The duct running south from the Aux Bldg filter inlet plenum towards the RFE will have to be removed (blacked off or rerun uncertain). If blacked off then the condensate vacuum pump discharge vent will have to be connected to the Aux Bldg filter inlet plenum.
3. Duct will have to be assembled between cable trays at 341' and ceiling line at 348'
4. Major work required near the BAM tank.

0800 - 4/19

Action Items

1. Get an expedited order going to change out AR & FRC filter trains
2. Determine the cost of cross connect
3. Keep going on the "Gas status"
4. Get a RB purge filter
5. Must get the word out that painting and welding must be controlled

1215 hr

Identified A up - B down - B isolated sequence
talked to Tom Hawkins about this.
Shut down manual dampers - up and down stream
and back up by jumping the power damper

checklist was taken as a test to identify all the
and the emergency is here

• Ventilation operating on line ^{Naval #3} - 15 min

• Release of the Navy #10

• Service of the Seafarer 200

• Special task for the JMS Robinson

Vacuum pump filter is functional now per JMS
Robinson

Charcoal Filter Changes:

Aux A-	late	4/19	
FMS A	0630	4/24	?
AUX B	0500	4/25	?

5/1/01

Key Events:

4th Meeting with Kovach