

**MARSSIM Survey Unit 1
Gamma Walkover Survey -
Trench HOG Spoils**
Winchester Engineering &
Analytical Center
Winchester, MA

- Legend**
- Excavation Areas in SU1
 - MARSSIM Survey Unit
 - Building Footprint
 - Fence
 - SU-1 Trench HOG Line
 - SU-1 Trench HOG Spoils Sample
- Gamma Walkover Survey - SU-1
Trench Spoils (CPM)**
- ≤ 15,000
 - > 15,000 ≤ 30,000
 - > 30,000 ≤ 40,000
 - > 40,000 ≤ 80,000
 - > 80,000 ≤ 810,473

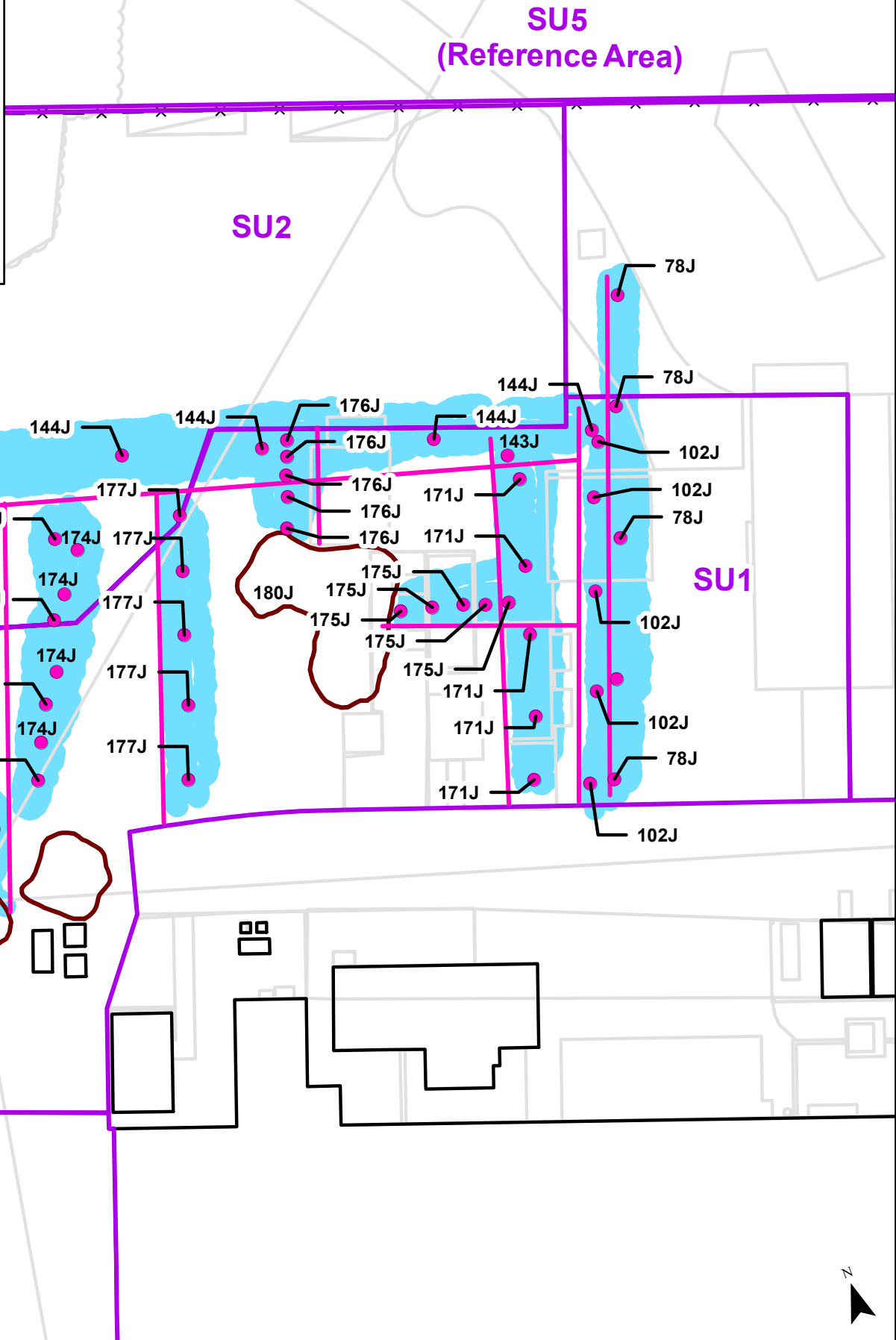

Document Path: Y:\WEAC_FDA_MARSSIM\Project\Walkover_Gamma Survey\Report\Final Status Survey\Final Report\FSS_Gamma Walkover Survey - Trenches - SU1.mxd