



VIRGINIA POWER

January 26, 1993

Mr. Lance M. Gardner
Environmental Specialist, Sr.
State Water Control Board
P. O. Box 11143
Richmond, VA 23230-1143

RE: PERMIT APPLICATION #92-1347
SURRY POWER STATION - PROPOSED DREDGING

Dear Mr. Gardner:

Enclosed is an Addendum to the Joint Permit Application for the maintenance dredging project at Surry Power Station. Also enclosed, for your information, are copies of additional material regarding this project which were provided to the Army Corps of Engineers.

We have been notified that the Virginia Marine Resources Commission has approved issuance of their permit for this project. No decision has been received from the Army Corps of Engineers on which type of permit action they will apply to this project.

Should you need additional information or have any questions, please contact Daniel James at (804) 273-2996.

Sincerely,

B. M. Marshall, P.E.
Manager
Water Quality

Attachments (2)

cc: (w/attachment 1)
U.S. Nuclear Regulatory Commission
Region II
101 Marietta Street, NW
Suite 2900
Atlanta, GA 30323
Re: Surry Units 1 & 2
Docket Nos. 50-280/50-281
License Nos. DPR-32/DPR-37

020039

9302020430 930126
PDR ADOCK 05000280
P PDR

Coal
1/1

Mr. Lance M. Gardner
January 26, 1993
Page 2

cc: U.S. Nuclear Regulatory Commission
Document Control Desk
Washington, DC 20555
Re: Surry Units 1 & 2
Docket Nos. 50-280/50-281
License Nos. DPR-32/DPR-37

Mr. M. W. Branch
NRC Senior Resident Inspector
Surry Power Station

JOINT PERMIT APPLICATION #92-1347

SURRY POWER STATION - MAINTENANCE DREDGING

VIRGINIA WATER PROTECTION PERMIT
ADDENDUM TO THE JOINT PERMIT APPLICATIONPart I

1. Local Government Approval Form- Form has been sent to Surry County and will be forwarded upon receipt.
2. Joint Permit Application- Copy attached.
3. Location map- Attached.
 - a. Latitude/Longitude- 37° 09' 25"/76° 40' 15" at the shoreward end of the channel.
 - b. Hydrologic Unit Code- 02080205
 - c. Stream Classification- I
 - d. Drainage area of upstream state waters- Greater than 6,758 mi² (USGS datum at Richmond).
 - e. Watershed- James River
4. Functional values and beneficial uses- Other than the unavoidable, temporary, localized increases in turbidity normally associated with dredging operations, no surface waters will be affected or functional values impacted. The only beneficial use impacts will be the maintenance of the existing uses of the James River as a source of cooling water for the Surry Nuclear Power Station and as a route of transportation to the station.
5. Description of project- As described in the Joint Permit Application, the proposed project consists of maintenance dredging of the previously permitted intake channel to its original dimensions. No changes in alignment, width, or depth from those in the prior permits are proposed. Disposal of dredged materials will be into the upland, bermed, clay lined disposal pond used for previous dredging operations. After solids settling, water from the disposal pond discharges into the station's intake canal. (Reference note: The intake "channel" is in the James River, the intake "canal" is the upland facility through which water flows from the intake pumps to the station.) The pond's discharge will be controlled with stoplogs and/or valving to provide adequate settling to prevent excessive solids carryover.

6. Toxic contaminants- All dredged material will be disposed of in the previously approved, upland disposal area with no significant return of any toxic contaminants which may be present. The area to be dredged receives no contaminants from the operations at Surry Power Station, other than as authorized by the VPDES permit. Any contaminants present or involved in the proposed project would be those which may exist in the James River from other sources.

Although kepone was once of concern in this area, the proposed maintenance dredging project does not involve disturbance of any old sediments. Only sediments deposited in the channel since previous dredging projects will be handled. Therefore, the level of any kepone contamination involved would be that which presently exists in this area of the James River and equivalent to, or less than, the levels detected by analyses conducted in reference to previous dredging projects of this same channel. Since the previous analyses did not indicate a need for extraordinary precautionary measures to control kepone contamination, other than those already planned for this project, the imposition of requirements for additional kepone analyses is not warranted.

7. Beneficial use impacts- As described in #4 above.
8. Wetlands impacts- No wetlands areas are present in the area of the proposed project nor are any expected to be impacted.
9. Mitigation plans- All dredging operations will be conducted by an experienced contractor, with Virginia Power oversight, in accordance with established practices to control discharges of dredged materials to the minimal, unavoidable amounts associated with such operations. If necessary, the appropriate control measures, such as silt curtains, will be employed to reduce the resuspension of silt in adjacent surface waters. As mentioned in #5 above, discharge of dredged materials from the disposal pond will be controlled at the pond's discharge structure. If the disposal pond is filled to levels which do not provide adequate settling time and the solids concentration in the pond's discharge approaches unacceptable levels, the rate of dredging and pumping of spoils into the pond will be reduced as necessary.

Part II- Not Applicable.

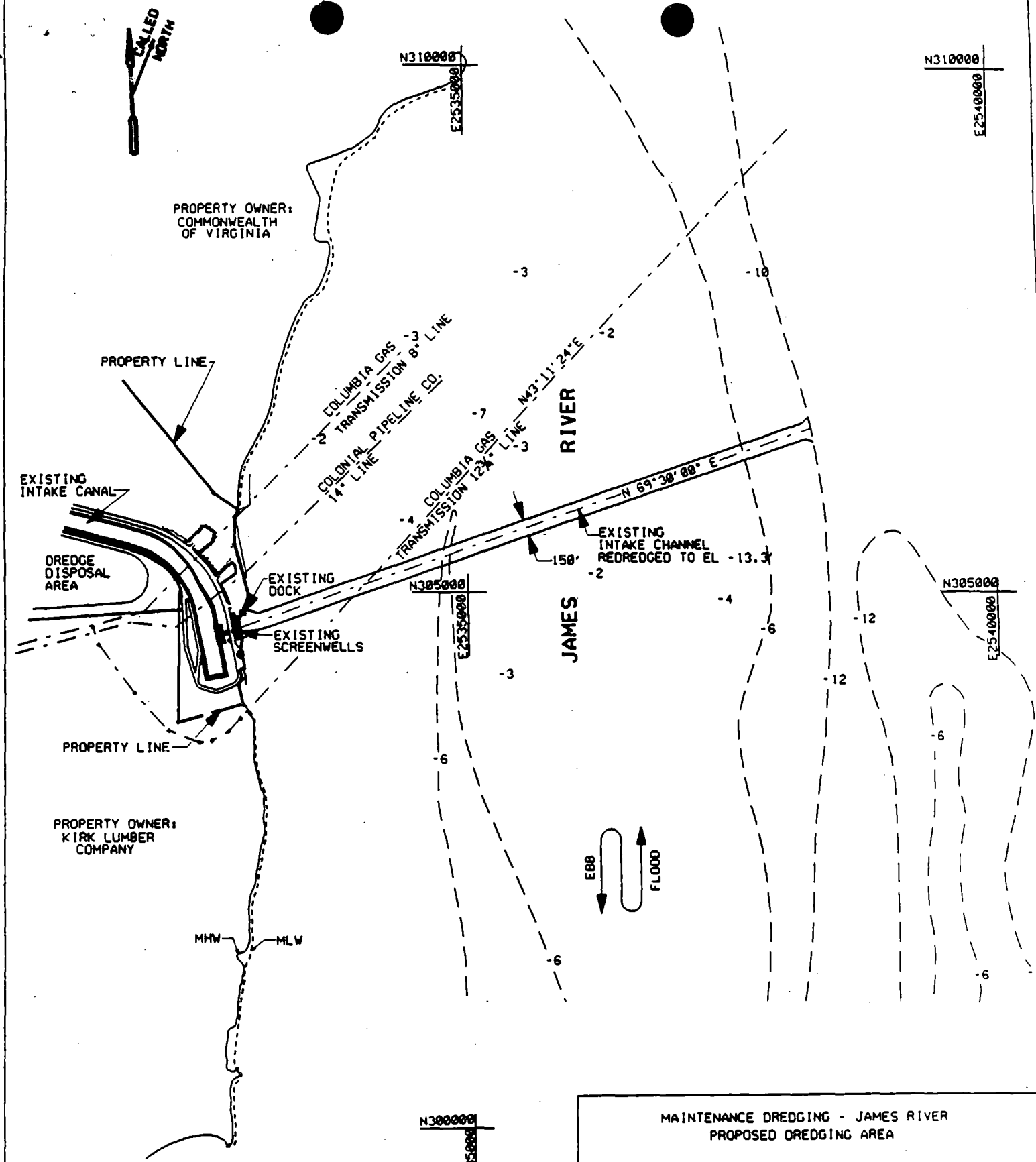

**MAINTENANCE DREDGING - JAMES RIVER
PROPOSED DREDGING AREA**

- a. Latitude/Longitude- 37° 09' 25"/76° 40' 15" at : shoreward end of the channel.
- b. Hydrologic Unit Code- 02080205
- c. Stream Classification- I
- d. Drainage area of upstream state waters- Greater than 6,758 mi² (USGS datum at Richmond).
- e. Watershed- James River

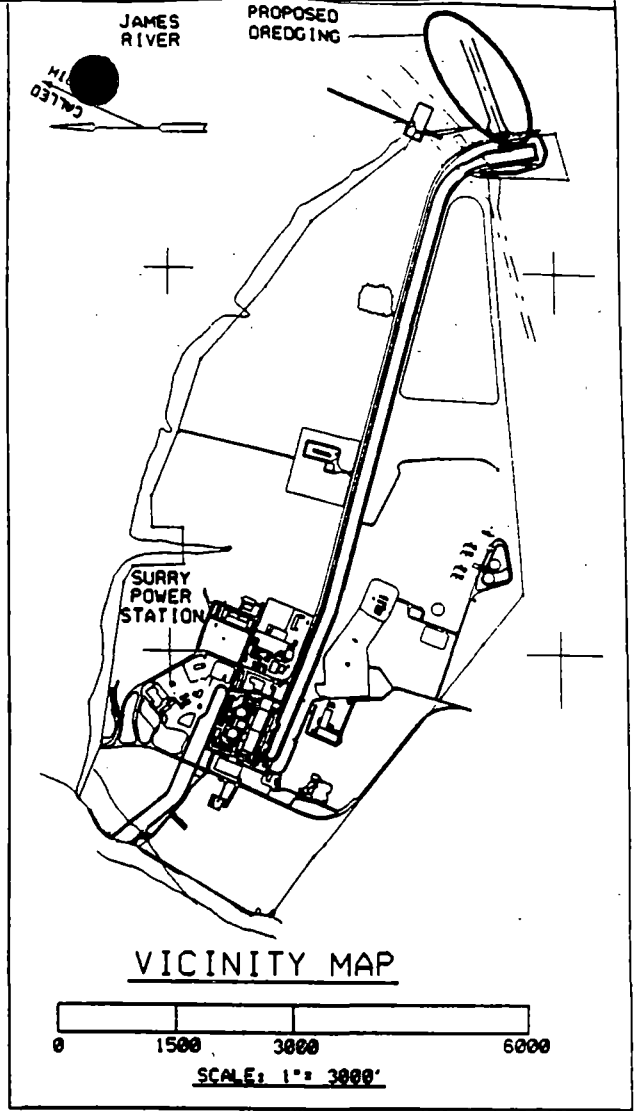
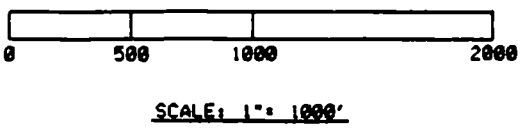
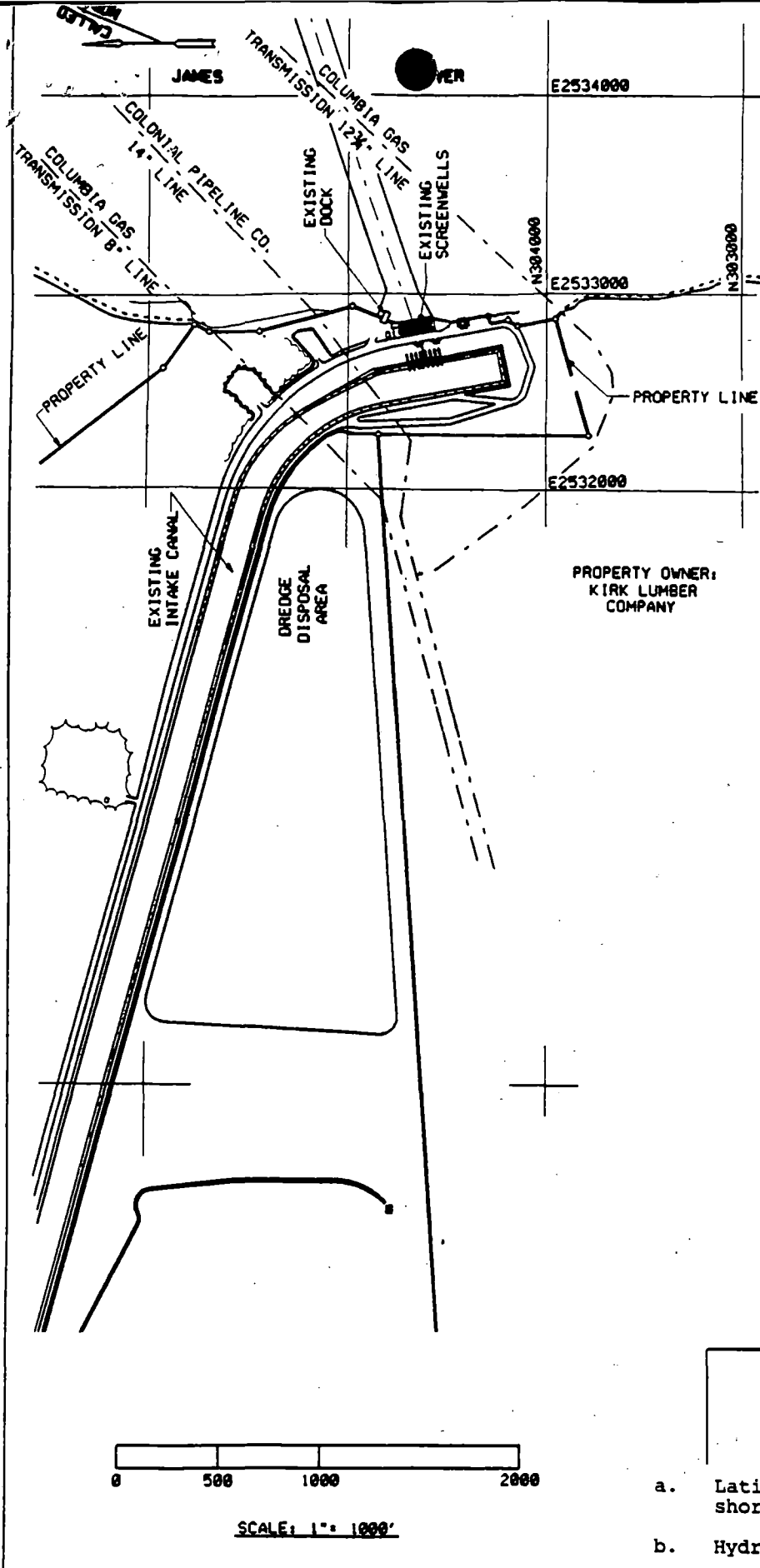

**MAINTENANCE DREDGING - JAMES RIVER
PROPOSED DREDGING AREA**

- a. Latitude/Longitude- 37° 09' 25"/76° 40' 15" at the shoreward end of the channel.
- b. Hydrologic Unit Code- 02080205
- c. Stream Classification- I
- d. Drainage area of upstream state waters- Greater than 6,758 mi² (USGS datum at Richmond).
- e. Watershed- James River