

Frederick W. Schneider
Vice President
Production

Public Service Electric and Gas Company 80 Park Place Newark, N.J. 07101 201/430-7373

July 3, 1980

Director Nuclear Reactor Regulation
U.S. Nuclear Regulatory Commission
Washington, DC 20555

Attention: Mr. Steven A. Varga, Chief
Operating Reactors Branch 1
Division of Licensing

Dear Mr. Varga:

NEARSITE EMERGENCY OPERATIONS FACILITY
SALEM GENERATING STATION
UNIT NOS. 1 AND 2
DOCKET NOS. 50-272 AND 50-311

On May 22, 1980 we wrote to you stating our desire to move our nearsite Emergency Operations Facility (EOF) from the Lower Alloways Creek Township (LACT) municipal building to our newly leased training facility in Quinton, New Jersey. This Quinton facility is being used until our new permanent training facility is constructed nearby in Salem.

Subsequent to that, by letter of June 13, 1980, we informed you that we would delay moving the EOF until open issues concerning the appropriate location of an EOF had been satisfactorily addressed. On July 1, 1980 we met with Mr. Brian Grimes and other members of your staff and among other items, discussed the use of the Quinton facility and ultimately the Salem training facility as the EOF. Mr. Grimes stated that EOF criteria and an implementing schedule were presently being drafted and should be available for utility use within the next month or two. Recognizing that the time period between now and fully implementing an NRC acceptable EOF may be considerable, we would like to proceed with the use of our Quinton facility as the EOF on an interim basis. Our primary reasons for wanting to make the move center around the inadequacy of the LACT municipal building as an EOF. The LACT facilities have only two rooms of modest size available for recovery operations. These rooms are not ideally suited as they are primarily used as town meeting rooms and are not set up as offices. In addition, there are only a few telephones available for communications which are located in other municipal offices. LACT has been very gracious in permitting Public Service Electric and Gas Company to designate their

F

8 007140

429

F

ADD: B021
B GRIMES 11 3
STATE PROC 11 1

municipal building as the EOF but we believe from what we have learned from TMI, that larger recovery facilities with good communications are necessary. We feel that the Quinton facility which is 12.5 country road miles, approximately 15-17 minutes from the site, is superior to the LACT municipal building for the following reasons:

1. It is under the complete control of PSE&G
2. It has approximately 7000 square feet of space
3. It has numerous classrooms and offices which have been equipped with telephones and are ready to be used as recovery operations offices (see attached figure).
4. Technical documents are maintained, many in multiple copies, which will be needed to assist recovery operations. A partial list of these documents is:
 - a) Technical Specifications, Units 1 and 2
 - b) Final Safety Analysis Report
 - c) Station Operating Procedures
 - d) Station Emergency Procedures
 - e) Station general arrangement drawings, piping and instrumentation drawings and electrical one lines
 - f) System descriptions
 - g) Station Administrative Procedures
 - h) Security Manual
 - i) Fire Fighting Manual
 - j) Emergency Plan and Implementing Procedures.

Based on these advantages, we believe that moving the EOF to Quinton would result in an immediate significant increase in the effectiveness of emergency preparedness. We, therefore, propose to activate the Quinton training facility as the EOF on an interim basis until such time as final NRC guidance has been issued, agreement on an ultimate site has been reached, and the ultimate EOF is ready for service.

Your prompt attention to this matter is respectfully requested.

Sincerely,

A handwritten signature in cursive script, appearing to read "R. Schneider". The signature is written in dark ink and is positioned below the word "Sincerely,".

EMERGENCY OPERATIONS FACILITY

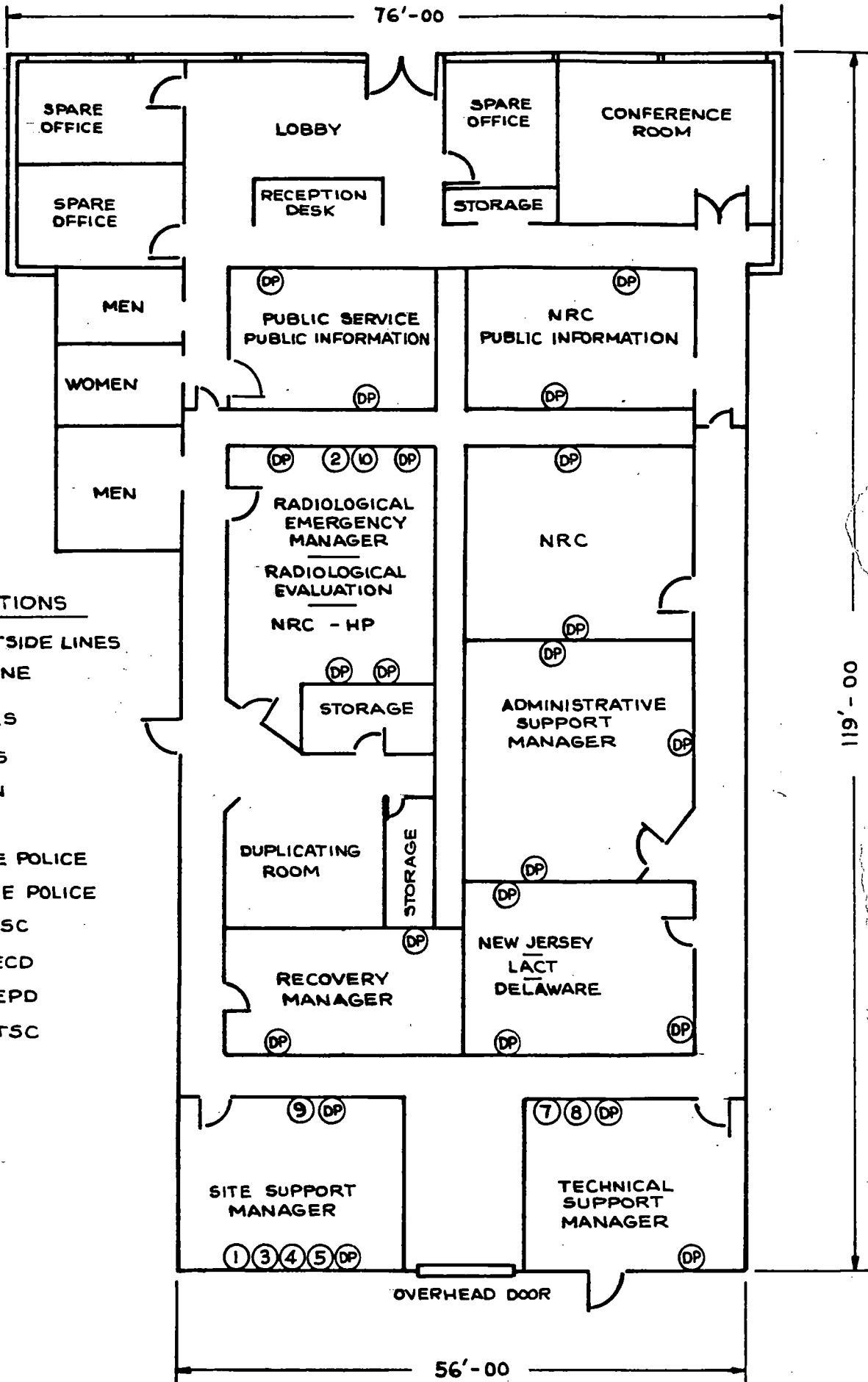

COMMUNICATIONS

DIRECT DIAL OUTSIDE LINES

Ⓛ = DIAL PHONE

PRIVATE LINES

- ① = NRC/ENS
- ② = NRC/HPN
- ③ = LACT
- ④ = N.J. STATE POLICE
- ⑤ = DEL. STATE POLICE
- ⑦ = TSM TO TSC
- ⑧ = TSM TO ECD
- ⑨ = SSM TO EPD
- ⑩ = REM TO TSC