

BEFORE THE
UNITED STATES NUCLEAR REGULATORY COMMISSION

In the Matter of

PENNSYLVANIA POWER &
LIGHT COMPANY

:

:

Docket Nos. 50-387
50-388

AMENDMENT NO. 55

APPLICATION FOR CLASS 103

OPERATING LICENSES FOR THE SUSQUEHANNA
STEAM ELECTRIC STATION

UNITS NO. 1 AND NO. 2

Applicant, Pennsylvania Power & Light Company, hereby files Amendment No. 55 to its Operating License Application dated July 31, 1978.

This amendment contains Revision 7 to the Susquehanna SES Emergency Plan.

PENNSYLVANIA POWER & LIGHT COMPANY
BY:

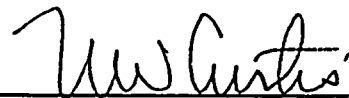

N. W. Curtis

Vice President - Engineering and
Construction - Nuclear

Sworn to and subscribed before me
this 23rd of November, 1983.



Notary Public

MARTHA C. BARTO, Notary Public
Allentown, Lehigh County, Pa.
My Commission Expires Jan. 13, 1986

8312280131 831123
PDR-ADDOCK 05000387
PDR

1954

1954

1954

1954

1954

1954

1954

1954

1954

1954

1954

1954

1954



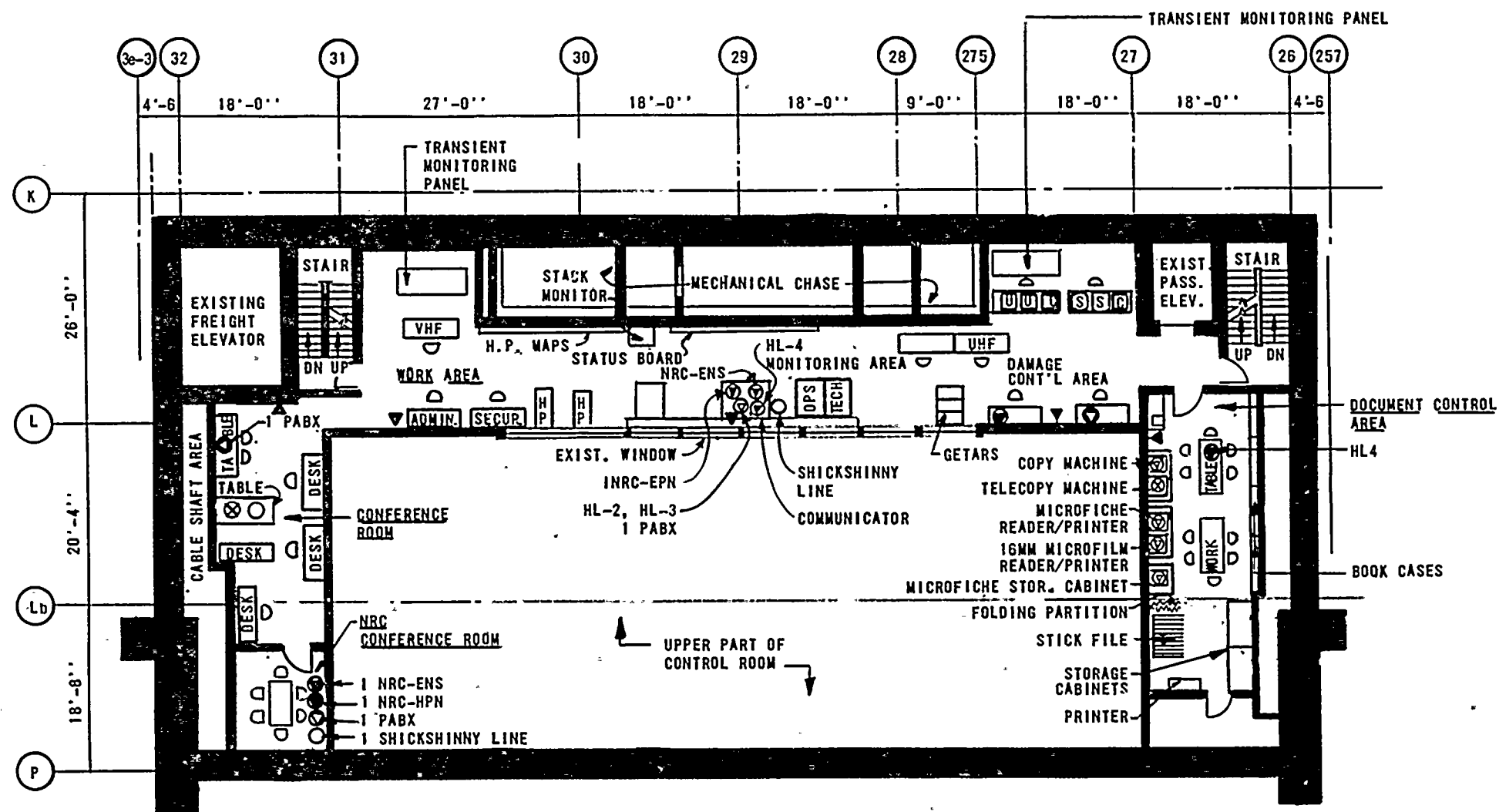

FLOOR PLAN - TECHNICAL SUPPORT CENTER

@ ELEVATION 741'-1" OF CONTROL STRUCTURE (PREVIOUS OBSERVATION GALLERY C-410, MEASURING & TEST EQUIP. CONTROL C-412, CALIBRATION RM. C-414 & COLD INSTRUMENT REPAIR SHOP C-411).



LEGEND

- ⊙ PABX
- HOTLINE
- ▼ P.A.
- ⊞ PCS MONITOR
- ⊗ ALLENTOWN EXTENSION
- ⊖ HOTLINE & PABX (ON SAME UNIT)
- SHICKSHINNY LINE
- ⊞ SPDS MONITOR
- ⊞ VIDEO COPIER

PRC
APERTURE
CARD

Also Available On
Aperture Card

NOTE: NOT ALL FURNITURE OR EQUIPMENT IS DRAWN TO SCALE. SOME P.A. SYSTEM COMPONENTS ARE NOT SHOWN.

FURNITURE LOCATIONS ARE SUBJECT TO CHANGE.

Rev. 7, 11/83

SUSQUEHANNA STEAM ELECTRIC STATION
UNITS 1 AND 2
EMERGENCY PLAN

TECHNICAL SUPPORT CENTER
FLOOR PLAN

Figure 7.3

8312280131-01

1
2
3
4
5
6
7
8
9
10
11
12
13
14
15
16
17
18
19
20
21
22
23
24
25
26
27
28
29
30
31
32
33
34
35
36
37
38
39
40
41
42
43
44
45
46
47
48
49
50
51
52
53
54
55
56
57
58
59
60
61
62
63
64
65
66
67
68
69
70
71
72
73
74
75
76
77
78
79
80
81
82
83
84
85
86
87
88
89
90
91
92
93
94
95
96
97
98
99
100

101
102
103
104
105
106
107
108
109
110
111
112
113
114
115
116
117
118
119
120
121
122
123
124
125
126
127
128
129
130
131
132
133
134
135
136
137
138
139
140
141
142
143
144
145
146
147
148
149
150

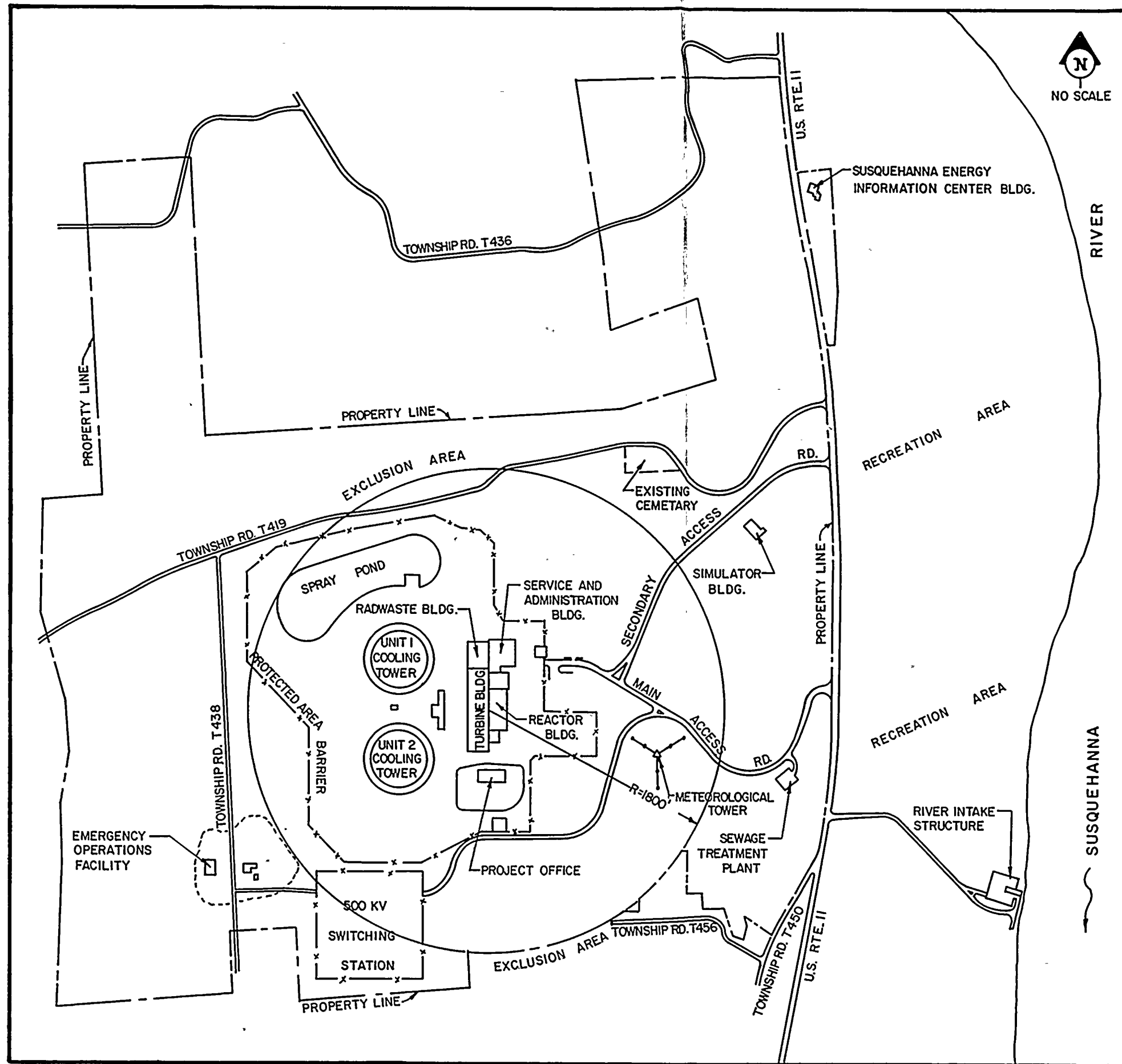

Rev. 6, 10/82

SUSQUEHANNA STEAM ELECTRIC STATION
 UNITS 1 AND 2
 EMERGENCY PLAN

LOCATION OF THE
 EMERGENCY OPERATIONS FACILITY

Figure 7.4

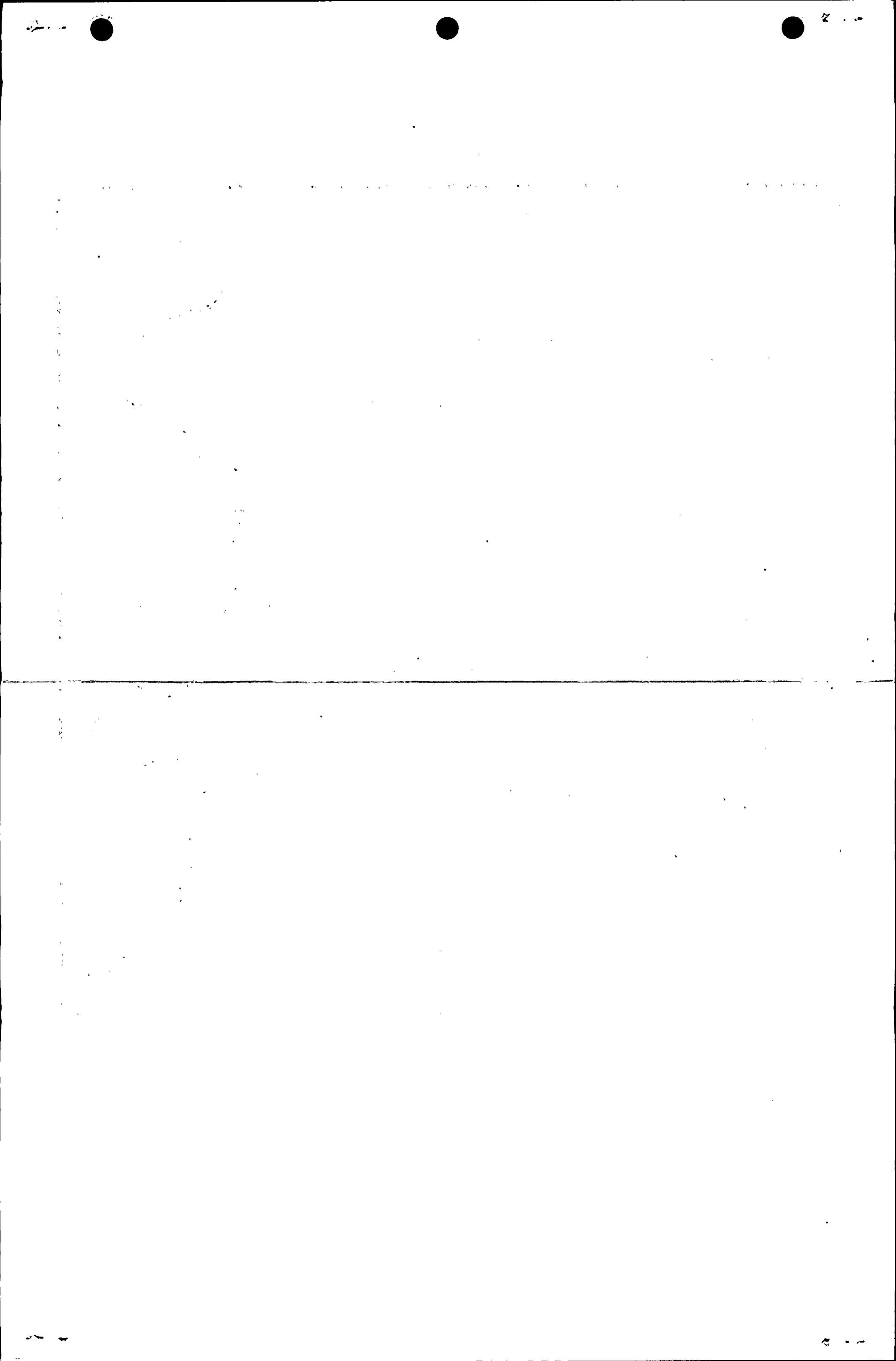

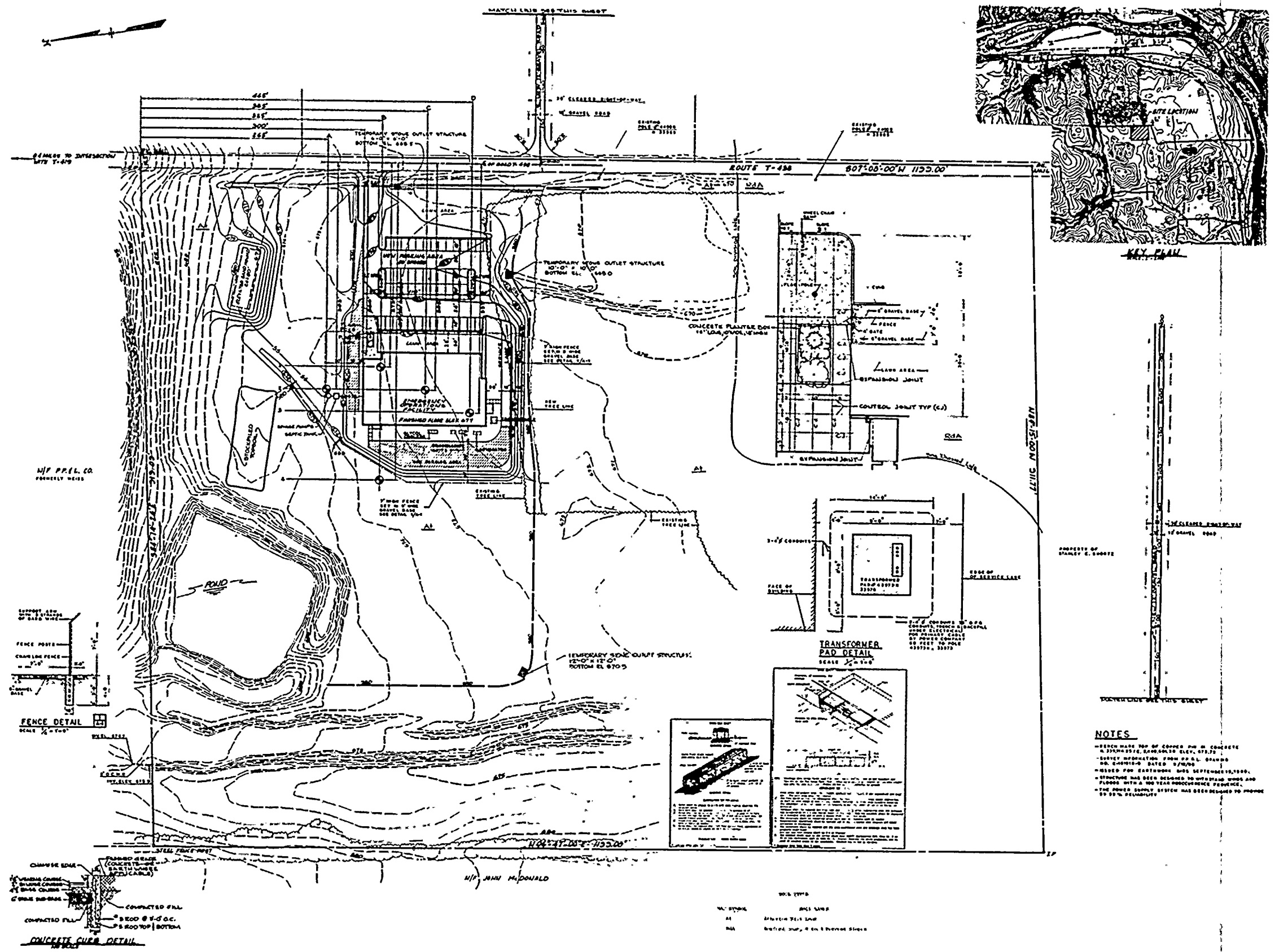

Rev. 6, 10/82

**SUSQUEHANNA STEAM ELECTRIC STATION
UNITS 1 AND 2
EMERGENCY PLAN**

**EMERGENCY OPERATIONS FACILITY
SITE PLAN**

Figure 7.5

