

ROOF PLAN
DIESEL GENERATOR BLDG

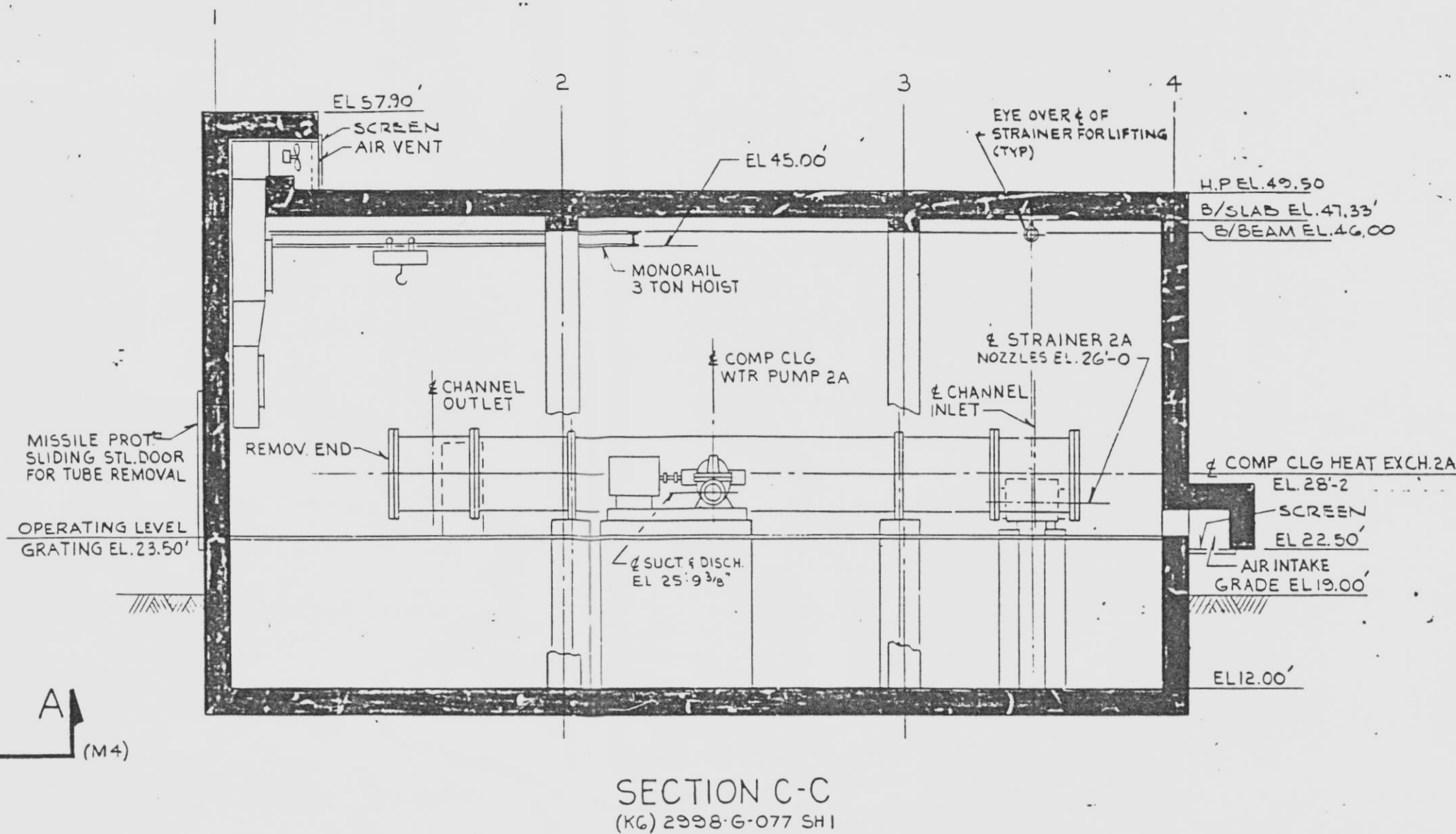

SECTION C-C
(K) 2998-G-077 SH1

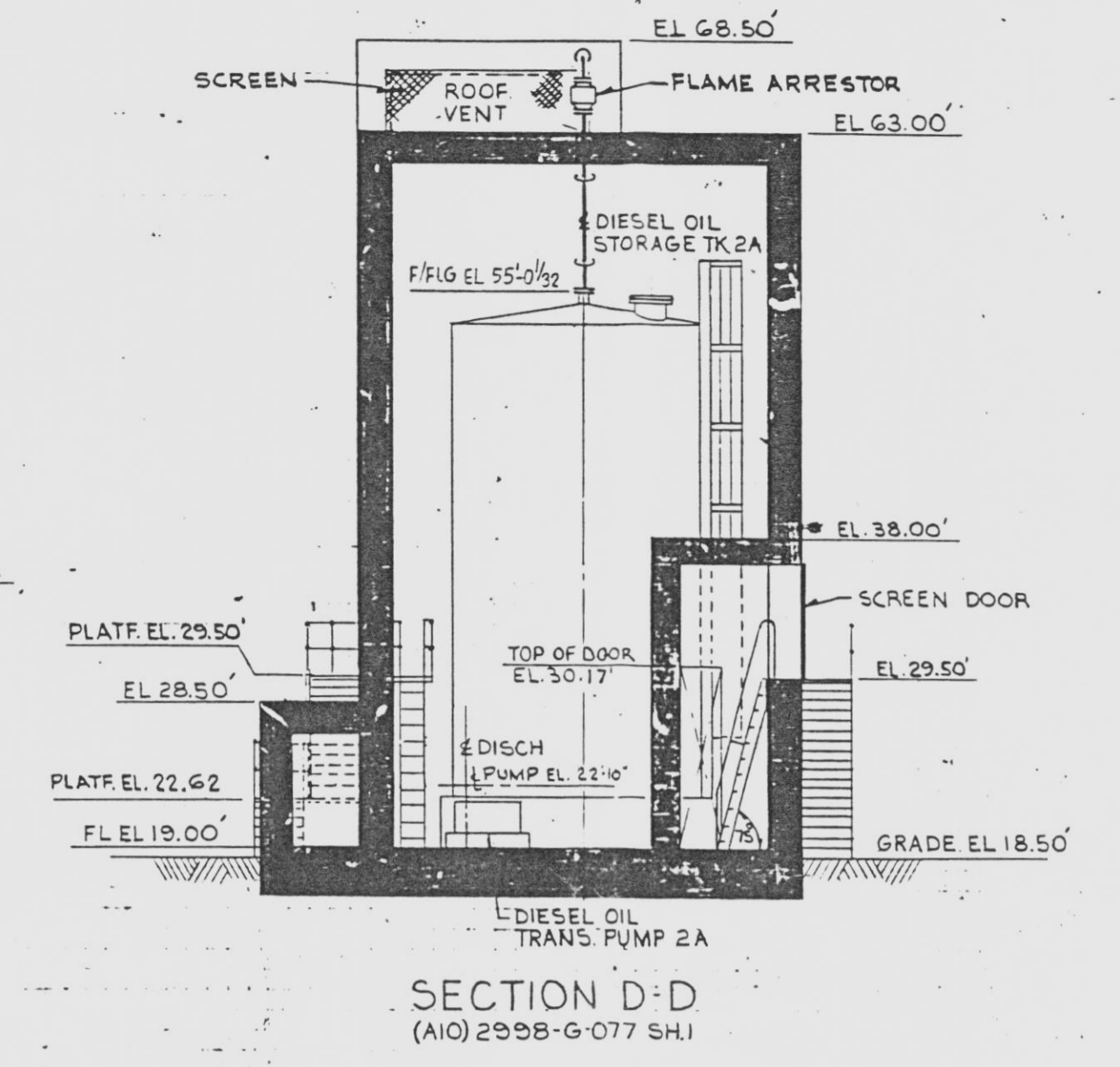

SECTION D-D
(A) 2998-G-077 SH1

NOTES:
FOR GENERAL NOTES & REFERENCES
SEE DWG. 2998-G-058

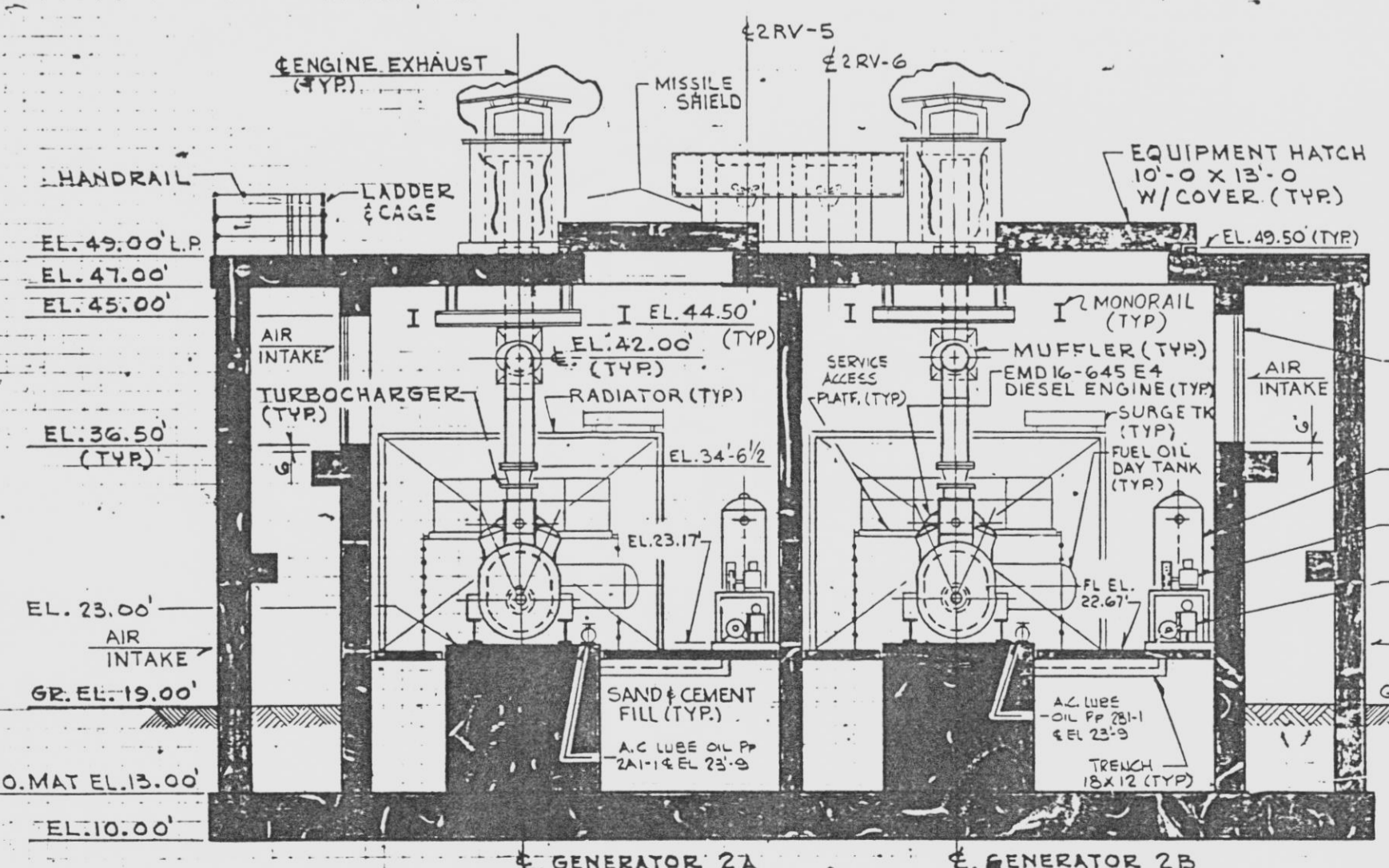
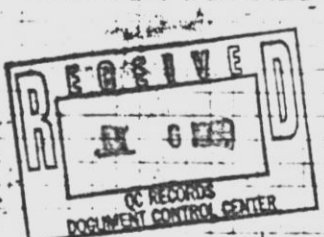

SECTION A-A
(E) THIS DWG
(HIS) 2998-G-077 SH1

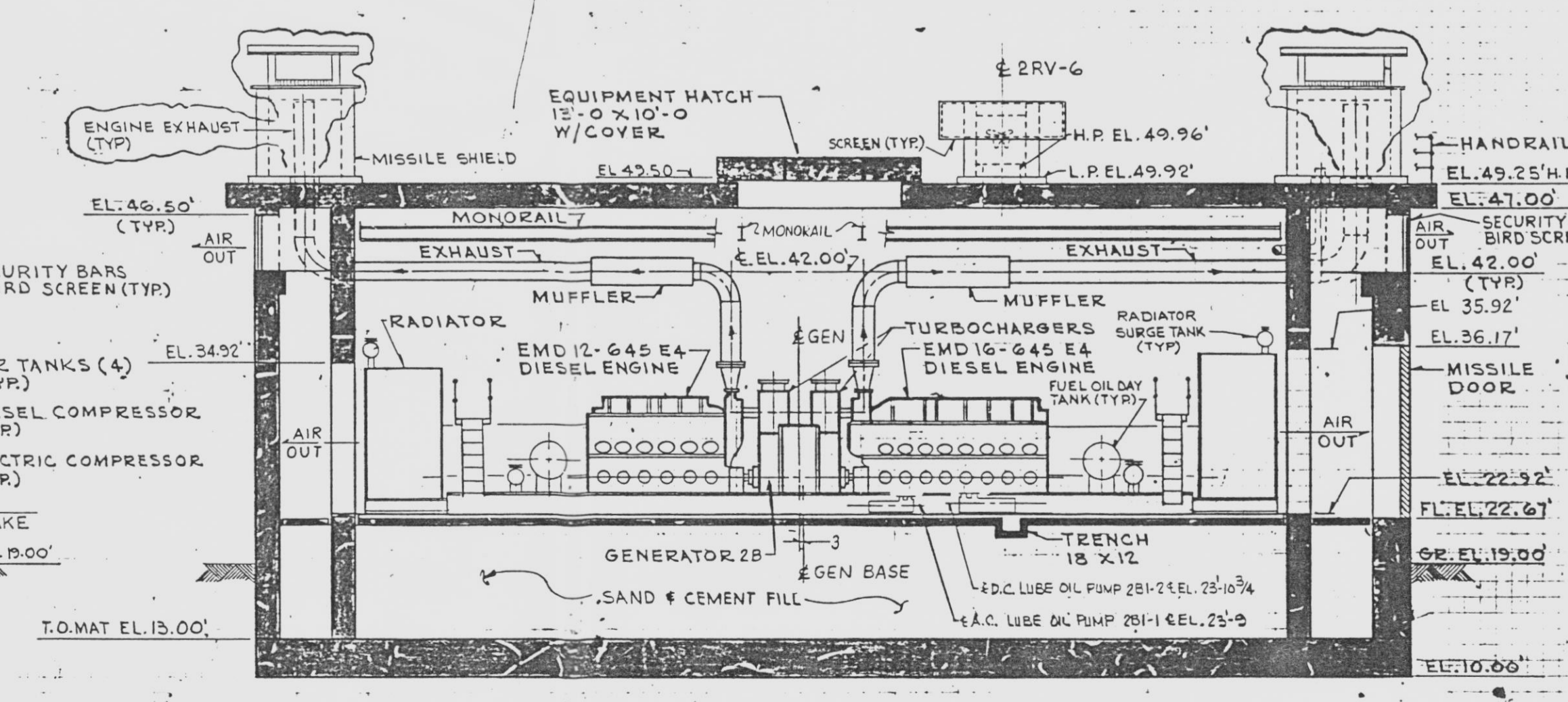

SECTION B-B
(A) THIS DWG
(DIB) 2998-G-077 SH1

NO.	DATE	DESCRIPTION	BY	CHKD	APP'D
6	6-28-84	PC/M 000-287 REV: (B) 85, K3, K5, K6, K7, K8, K9, K10, K11, K12, K13, K14, K15, K16, K17, K18, K19, K20, K21, K22, K23, K24, K25, K26, K27, K28, K29, K30, K31, K32, K33, K34, K35, K36, K37, K38, K39, K40, K41, K42, K43, K44, K45, K46, K47, K48, K49, K50, K51, K52, K53, K54, K55, K56, K57, K58, K59, K60, K61, K62, K63, K64, K65, K66, K67, K68, K69, K70, K71, K72, K73, K74, K75, K76, K77, K78, K79, K80, K81, K82, K83, K84, K85, K86, K87, K88, K89, K90, K91, K92, K93, K94, K95, K96, K97, K98, K99, K100	MK	LB	
5	1-29-85	PC/M 142-283 ANCO: (M) 3, 5, 7, 9, 11, 12, 13, 14, 15, 16, 17, 18, 19, 20, 21, 22, 23, 24, 25, 26, 27, 28, 29, 30, 31, 32, 33, 34, 35, 36, 37, 38, 39, 40, 41, 42, 43, 44, 45, 46, 47, 48, 49, 50, 51, 52, 53, 54, 55, 56, 57, 58, 59, 60, 61, 62, 63, 64, 65, 66, 67, 68, 69, 70, 71, 72, 73, 74, 75, 76, 77, 78, 79, 80, 81, 82, 83, 84, 85, 86, 87, 88, 89, 90, 91, 92, 93, 94, 95, 96, 97, 98, 99, 100	M	C	A
4	5-5-81	REVISED: (L) 1, (M) 1, (M) 2, (M) 3, (M) 4, (M) 5, (M) 6, (M) 7, (M) 8, (M) 9, (M) 10, (M) 11, (M) 12, (M) 13, (M) 14, (M) 15, (M) 16, (M) 17, (M) 18, (M) 19, (M) 20, (M) 21, (M) 22, (M) 23, (M) 24, (M) 25, (M) 26, (M) 27, (M) 28, (M) 29, (M) 30, (M) 31, (M) 32, (M) 33, (M) 34, (M) 35, (M) 36, (M) 37, (M) 38, (M) 39, (M) 40, (M) 41, (M) 42, (M) 43, (M) 44, (M) 45, (M) 46, (M) 47, (M) 48, (M) 49, (M) 50, (M) 51, (M) 52, (M) 53, (M) 54, (M) 55, (M) 56, (M) 57, (M) 58, (M) 59, (M) 60, (M) 61, (M) 62, (M) 63, (M) 64, (M) 65, (M) 66, (M) 67, (M) 68, (M) 69, (M) 70, (M) 71, (M) 72, (M) 73, (M) 74, (M) 75, (M) 76, (M) 77, (M) 78, (M) 79, (M) 80, (M) 81, (M) 82, (M) 83, (M) 84, (M) 85, (M) 86, (M) 87, (M) 88, (M) 89, (M) 90, (M) 91, (M) 92, (M) 93, (M) 94, (M) 95, (M) 96, (M) 97, (M) 98, (M) 99, (M) 100	JP	CCW	
3	12-20-78	REVISED: (B) 1, (B) 2, (B) 3, (B) 4, (B) 5, (B) 6, (B) 7, (B) 8, (B) 9, (B) 10, (B) 11, (B) 12, (B) 13, (B) 14, (B) 15, (B) 16, (B) 17, (B) 18, (B) 19, (B) 20, (B) 21, (B) 22, (B) 23, (B) 24, (B) 25, (B) 26, (B) 27, (B) 28, (B) 29, (B) 30, (B) 31, (B) 32, (B) 33, (B) 34, (B) 35, (B) 36, (B) 37, (B) 38, (B) 39, (B) 40, (B) 41, (B) 42, (B) 43, (B) 44, (B) 45, (B) 46, (B) 47, (B) 48, (B) 49, (B) 50, (B) 51, (B) 52, (B) 53, (B) 54, (B) 55, (B) 56, (B) 57, (B) 58, (B) 59, (B) 60, (B) 61, (B) 62, (B) 63, (B) 64, (B) 65, (B) 66, (B) 67, (B) 68, (B) 69, (B) 70, (B) 71, (B) 72, (B) 73, (B) 74, (B) 75, (B) 76, (B) 77, (B) 78, (B) 79, (B) 80, (B) 81, (B) 82, (B) 83, (B) 84, (B) 85, (B) 86, (B) 87, (B) 88, (B) 89, (B) 90, (B) 91, (B) 92, (B) 93, (B) 94, (B) 95, (B) 96, (B) 97, (B) 98, (B) 99, (B) 100	JS	MNJ	MM
2	8-25-77	REVISED: (B) 1, (B) 2, (B) 3, (B) 4, (B) 5, (B) 6, (B) 7, (B) 8, (B) 9, (B) 10, (B) 11, (B) 12, (B) 13, (B) 14, (B) 15, (B) 16, (B) 17, (B) 18, (B) 19, (B) 20, (B) 21, (B) 22, (B) 23, (B) 24, (B) 25, (B) 26, (B) 27, (B) 28, (B) 29, (B) 30, (B) 31, (B) 32, (B) 33, (B) 34, (B) 35, (B) 36, (B) 37, (B) 38, (B) 39, (B) 40, (B) 41, (B) 42, (B) 43, (B) 44, (B) 45, (B) 46, (B) 47, (B) 48, (B) 49, (B) 50, (B) 51, (B) 52, (B) 53, (B) 54, (B) 55, (B) 56, (B) 57, (B) 58, (B) 59, (B) 60, (B) 61, (B) 62, (B) 63, (B) 64, (B) 65, (B) 66, (B) 67, (B) 68, (B) 69, (B) 70, (B) 71, (B) 72, (B) 73, (B) 74, (B) 75, (B) 76, (B) 77, (B) 78, (B) 79, (B) 80, (B) 81, (B) 82, (B) 83, (B) 84, (B) 85, (B) 86, (B) 87, (B) 88, (B) 89, (B) 90, (B) 91, (B) 92, (B) 93, (B) 94, (B) 95, (B) 96, (B) 97, (B) 98, (B) 99, (B) 100	G	S	MM
1	12-27-76	REVISED: (B) 1, (B) 2, (B) 3, (B) 4, (B) 5, (B) 6, (B) 7, (B) 8, (B) 9, (B) 10, (B) 11, (B) 12, (B) 13, (B) 14, (B) 15, (B) 16, (B) 17, (B) 18, (B) 19, (B) 20, (B) 21, (B) 22, (B) 23, (B) 24, (B) 25, (B) 26, (B) 27, (B) 28, (B) 29, (B) 30, (B) 31, (B) 32, (B) 33, (B) 34, (B) 35, (B) 36, (B) 37, (B) 38, (B) 39, (B) 40, (B) 41, (B) 42, (B) 43, (B) 44, (B) 45, (B) 46, (B) 47, (B) 48, (B) 49, (B) 50, (B) 51, (B) 52, (B) 53, (B) 54, (B) 55, (B) 56, (B) 57, (B) 58, (B) 59, (B) 60, (B) 61, (B) 62, (B) 63, (B) 64, (B) 65, (B) 66, (B) 67, (B) 68, (B) 69, (B) 70, (B) 71, (B) 72, (B) 73, (B) 74, (B) 75, (B) 76, (B) 77, (B) 78, (B) 79, (B) 80, (B) 81, (B) 82, (B) 83, (B) 84, (B) 85, (B) 86, (B) 87, (B) 88, (B) 89, (B) 90, (B) 91, (B) 92, (B) 93, (B) 94, (B) 95, (B) 96, (B) 97, (B) 98, (B) 99, (B) 100	G	S	MM

THIS DOCUMENT IS THE PROPERTY OF EBASCO SERVICES INCORPORATED. ITS USE IS EXPRESSLY RESTRICTED BY THE TERMS OF THE CONTRACT, DATED AS OF SEPTEMBER 1, 1975 BETWEEN EBASCO SERVICES INCORPORATED AND FLORIDA POWER & LIGHT COMPANY.

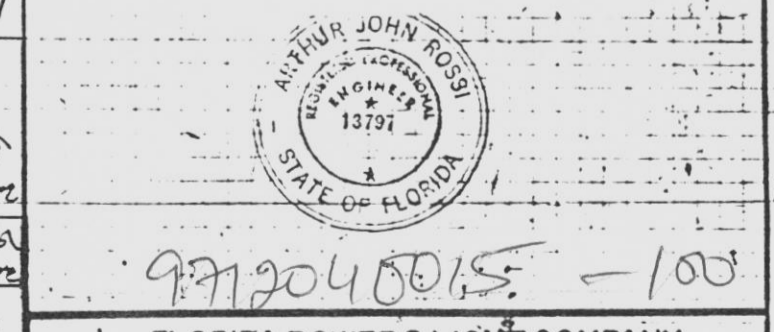

9712040015-100
FLORIDA POWER & LIGHT COMPANY
ST. LUCIE PLANT

1983-890M(N) EXTENSION UNIT NO. 2
GENERAL ARRANGEMENT
COMPONENT COOLING WATER AREA
AND DIESEL GENERATOR BUILDING

EBASCO SERVICES INCORPORATED

SCALE 1/8"=1'-0"	APPROVED	DATE 2-7-76
DR. MECH.		
DR. E. REED		2998-G-077
DR. SUN		SH. 2 OF 3

ANSTEC APERTURE CARD
INFORMATION ONLY
VIEW WITH A CONTROLLED COPY BEFORE USE