

**APPENDIX A-1
FINAL STATUS SURVEY RESULTS**

SU Description & Number: BSA 02-22 Cushman Room (South Walls and Floor)

Survey Log Number: HDP-PF-083115-050

Date: 08/31/15

Technician(s): Mark Shaffer *Mark C Shaffer* 10-5-15

Reviewed By: *ELLEN C. JAKUB* 10/6/15

Time: 1025

Survey Area Map / Diagram (Indicate Area Scanned):

Location	Surface	X	Y
1	Floor	2.4	5.2
2	Floor	11.6	5.2
3	Floor	20.8	5.2
4	Floor	7.0	13.4
5	West Wall	13.4	1.1
6	East Wall	20.4	2.3
7	South Wall	5.3	3.0
8	South Wall	16.1	3.0
9	Exterior Concrete Pad	2.4	-4.7
10	Exterior Concrete Pad	11.6	-4.7
11	Exterior Concrete Pad	20.8	-4.7

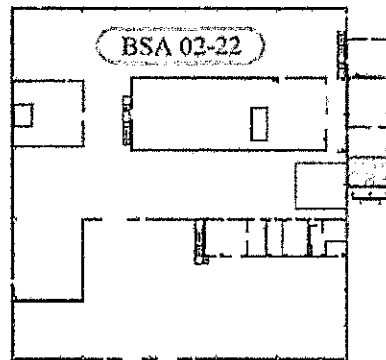
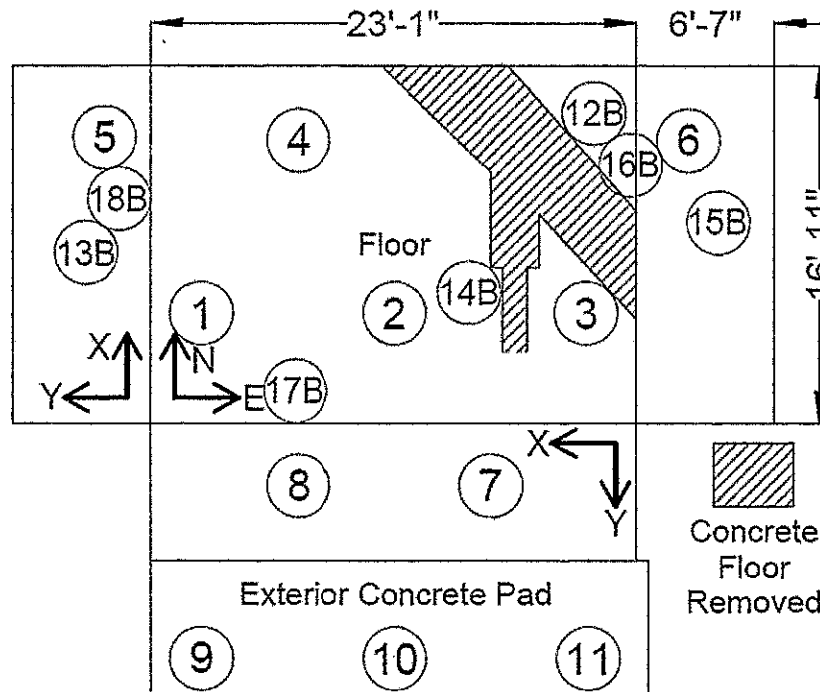

Note: The origin for the east wall section is located at the lower left corner of the wall in LSA 02-09.

COMMENTS: Systematic and biased directs performed with 43-93 "L" on 8/31/15. 100% floor scan performed with 43-37 "K" on 8/31/15. 100% wall scan performed with 43-93 "L". Supplemental floor scans, which generated 16B – 18B, were performed with 43-93 "L" on 10/5/15.