

TURBINE BUILDING ROOF H.P. EL. 622'-6"
 BUILD UP ROOFING ON INSULATION OVER
 3/4" PRECAST CONCRETE CHANNEL ROOF ALARMS

TURBINE BUILDING ROOF PLAN WEST AREA

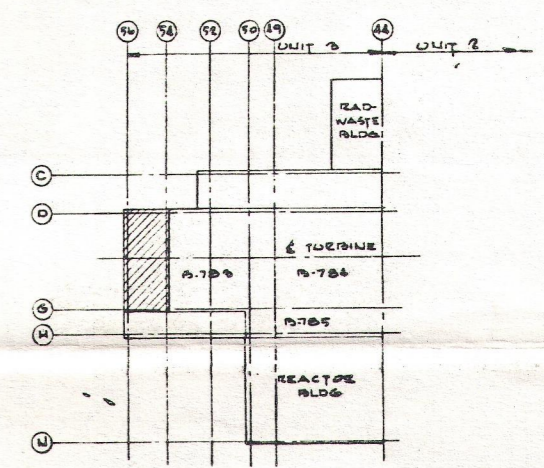

KEY PLAN

NOTES

1. SEE ARCHITECTURAL NOTES SEE DRAWING NO. B-792
2. ALL WORK SHOWN ON THIS DRAWING SHALL BE IN ACCORDANCE WITH JOB SPECIFICATION W-2200

REFERENCE DRAWINGS

- B-792 SOUTH ELEVATION
- B-791 TURBINE BUILDING ROOF SECTIONS DETAILS SHEET 1
- B-544 TURBINE BUILDING PLUMBING ZONE PLANS
- B-710 TURBINE BUILDING ROOF FINISHING PLAN WEST AREA

**SI
APERTURE
CARD**

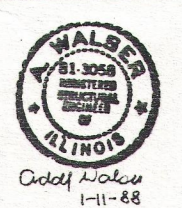

ANY MODIFICATION OR ADDITION TO THIS DRAWING BY AN ORGANIZATION OTHER THAN SARGENT & LUNDY IS NOT THE RESPONSIBILITY OF SARGENT & LUNDY.

DRAWING RELEASE RECORD				
REV.	DATE RELEASED	PURPOSE	PREPARED	APPROVED
A	1-11-85	FOR RECORD	R. A. Rood	K
A	1-23-85	SENT TO CLIENT	R. Rood	

REVISIONS	
1	FOR RECORD
2	FOR RECORD
3	FOR RECORD
4	FOR RECORD
5	FOR RECORD
6	FOR RECORD
7	FOR RECORD
8	FOR RECORD
9	FOR RECORD
10	FOR RECORD

**TURBINE BUILDING WEST AREA
 ROOF PLAN**
 DRESDEN NUCLEAR POWER STATION
 UNIT 3
 GENERAL ELECTRIC CO.
 FOR
 COMMONWEALTH EDISON CO.
 CHICAGO, ILLINOIS

SCALE 1/4" = 1'-0"
 DRAWN BY POLAND 12-10-84
 CHECKED BY WEAVER 2-15-85
 DESIGNED BY R. Rood 2-6-82
 APPROVED BY R. Rood 12-24-84
SARGENT & LUNDY
 INCORPORATED
 ENGINEERS
 CHICAGO
B-792

50-237
 w/let dtd 8/30/89
 # 8909050 464