

# PRIORITY 1

(ACCELERATED RIDS PROCESSING)

## REGULATORY INFORMATION DISTRIBUTION SYSTEM (RIDS)

ACCESSION NBR: 9509180145      DOC. DATE: 95/09/11      NOTARIZED: NO      DOCKET #  
 FACIL: 50-335 St. Lucie Plant, Unit 1, Florida Power & Light Co.      05000335 P  
 50-389 St. Lucie Plant, Unit 2, Florida Power & Light Co.      05000389

AUTH. NAME      AUTHOR AFFILIATION  
 SAGER, D.A.      Florida Power & Light Co.  
 RECIP. NAME      RECIPIENT AFFILIATION  
                          Document Control Branch (Document Control Desk)

SUBJECT: Special rept: on 950812, post hurricane Erin Beach Dune survey performed. Average values of results greater than or within range provided in St Lucie Unit 1 final USAR, Section 2.4.2.2 & acceptable.

DISTRIBUTION CODE: IE22D      COPIES RECEIVED: LTR 1 ENCL 1 SIZE: 20  
 TITLE: 50.73/50.9 Licensee Event Report (LER), Incident Rpt, etc.

### NOTES:

	RECIPIENT ID CODE/NAME	COPIES LTTR ENCL	RECIPIENT ID CODE/NAME	COPIES LTTR ENCL
	PD2-1 PD	1 1	NORRIS, J	1 1
INTERNAL:	ACRS	1 1	<del>AEOD/SPD/RAB</del>	2 2
	AEOD/SPD/RRAB	1 1	<u>FILE CENTER</u>	1 1
	NRR/DE/ECGB	1 1	NRR/DE/EELB	1 1
	NRR/DE/EMEB	1 1	NRR/DISP/PIPB	1 1
	NRR/DRCH/HHFB	1 1	NRR/DRCH/HICB	1 1
	NRR/DRCH/HOLB	1 1	NRR/DRPM/PECB	1 1
	NRR/DSSA/SPLB	1 1	NRR/DSSA/SPSB/B	1 1
	NRR/DSSA/SRXB	1 1	RES/DSIR/EIB	1 1
	RGN2 FILE 01	1 1		
EXTERNAL:	L ST LOBBY WARD	1 1	LITCO BRYCE, J H	2 2
	NOAC MURPHY, G.A	1 1	NOAC POORE, W.	1 1
	NRC PDR	1 1	NUDOCS FULL TXT	1 1

### NOTE TO ALL "RIDS" RECIPIENTS:

PLEASE HELP US TO REDUCE WASTE! CONTACT THE DOCUMENT CONTROL DESK, ROOM OWFN 5D8 (415-2083) TO ELIMINATE YOUR NAME FROM DISTRIBUTION LISTS FOR DOCUMENTS YOU DON'T NEED!

TOTAL NUMBER OF COPIES REQUIRED: LTR 27 ENCL 27



September 11, 1995

L-95-258  
10 CFR 50.36

U. S. Nuclear Regulatory Commission  
Attn: Document Control Desk  
Washington, DC 20555

Re: St. Lucie Units 1 and 2  
Docket Nos. 50-335 and 50-389  
St. Lucie Plant Beach Survey

The attached special report is being submitted pursuant to Technical Specification 4.7.6.1.1. The field survey for this report was completed on August 12 1995 and the results of the survey are attached.

Since the average values of these results are greater than or within the range of those provided in the St. Lucie Unit 1 Final Updated Safety Analysis Report (FUSAR), Section 2.4.2.2, it is concluded that the dune condition is acceptable according to the criteria in the St. Lucie Unit 1 Technical Specification 5.1.3.

If there should be any questions please contact us.

Very truly yours,

D. A. Sager  
Vice President  
St. Lucie Plant

DAS:PTQ

cc: Stewart D. Ebnetter, Regional Administrator, Region II, USNRC  
Senior Resident Inspector, USNRC, St. Lucie Plant

DAS/PSL

100100

9509180145 950911  
PDR ADCK 05000335  
S PDR



---

TO: Nuclear Licensing                    LOCATION: CSL/LU  
FROM: Gary L. Bouska *Gary L. Bouska*                    DATE: 8/29/95  
SUBJECT: ST. LUCIE SITE  
POST HURRICANE ERIN BEACH DUNE SURVEY

Attached please find the results of the post hurricane Erin Beach Dune Survey. This work was performed August 12, 1995 in accordance with licensing requirements.

If you have any questions, please call me at 3835.



**ST. LUCIE SITE - DUNE SURVEY  
AUGUST 12, 1995**

<u>REF. NO.</u>	<u>CREST ELEVATION ABOVE MSL (Ft.)</u>	<u>DUNE WIDTH AT CREST ELEVATION (Ft.) (*)</u>	<u>WIDTH OF OLD DUNE ROAD ELEVATION (Ft.) (**)</u>	<u>DISTANCE FROM CENTER OF OLD DUNE ROAD TO MHW (Ft.)</u>
76	12.0	10.0	27.0	86.0
77	11.3	27.0	35.0	92.0
78	11.3	20.0	65.0	110.0
79	13.4	16.0	90.0	151.0
80	13.3	26.0	80.0	145.0
80-A	12.3	50.0	88.0	158.0
80-B	16.6	N/A	N/A	N/A
81	14.5	38.0	N/A	N/A
81-A	14.8	24.0	N/A	N/A
81-B	14.3	35.0	N/A	N/A
82	14.1	20.0	N/A	N/A
82-A	14.2	37.0	N/A	N/A
82-B	13.8	11.0	N/A	N/A
83	13.3	37.0	N/A	N/A
83-A	12.8	15.0	N/A	N/A
83-B	12.4	26.0	N/A	N/A
84	13.3	6.0	N/A	N/A
85	11.7	26.0	N/A	N/A
86	11.0	29.0	N/A	N/A
87	12.2	23.0	N/A	N/A
88	13.2	18.0	N/A	N/A
<b>AVERAGE:</b>	13.1	24.7	64.2	123.7
<b>MAXIMUM:</b>	16.6	50.0	90.0	158.0
<b>MINIMUM:</b>	11.0	6.0	27.0	86.0

- (\*) Measured one foot below the crest elevation.  
(\*\*) Elevation taken at centerline of Old Dune Road.  
N/A No apparent road visible.

**SPECIFIC PURPOSE SURVEY  
FOR  
FLORIDA POWER & LIGHT COMPANY**

**AUGUST 1995**

**SOUTH FLORIDA PROFESSIONAL  
LAND SURVEYORS**

**2434 N.E. MYRTLE STREET  
SUITE 1000  
JENSEN BEACH, FLORIDA 34957  
407 / 465-3020  
407 / 334-2585**

**SURVEYORS NOTES**

- 1) This survey was performed for the Specific Purpose of providing Florida Power and Light Company with cross section data at points along the Dune of the Atlantic Ocean. These points having a previously determined Horizontal and Vertical location.
- 2) All elevations shown hereon are based on the National Geodetic Vertical Datum of 1929, as related to the Florida Department of Environmental Protection (FDEP) R series monuments as indicated in the individual cross sections contained herein.

**CERTIFICATION**

**(NOT VALID UNLESS SEALED WITH AN EMBOSSED SURVEYORS SEAL)**

**I HEREBY CERTIFY THAT THE SPECIFIC PURPOSE SURVEY SHOWN  
HEREON WAS COMPLETED UNDER MY DIRECTION. I FURTHER CERTIFY  
THAT THIS SURVEY MEETS THE MINIMUM TECHNICAL STANDARDS FOR  
SURVEYS SET FORTH BY THE FLORIDA BOARD OF LAND SURVEYORS IN  
CHAPTER 61G17-6, FLORIDA ADMINISTRATIVE CODE, PURSUANT TO  
SECTION 472.027, FLORIDA STATE STATUTES.**

8/28/95  
DATE OF SIGNATURE

8/12/95  
DATE OF SURVEY

  
TERRY L. MACDEVITT  
PROFESSIONAL LAND SURVEYOR  
FLORIDA CERTIFICATE NO. 4557



# Florida Power & Light Co.

SKETCH SHOWING APPROXIMATE LOCATIONS OF D.E.P. & F.P.&L. REFERENCE MONUMENTS FOR DUNE SURVEYS AT THE ST. LUCIE POWER PLANT.

AUGUST 1995

△ = DENOTES D.E.P. MONUMEN  
○ = DENOTES F.P.&L. MONUMEN



NOT TO SCALE

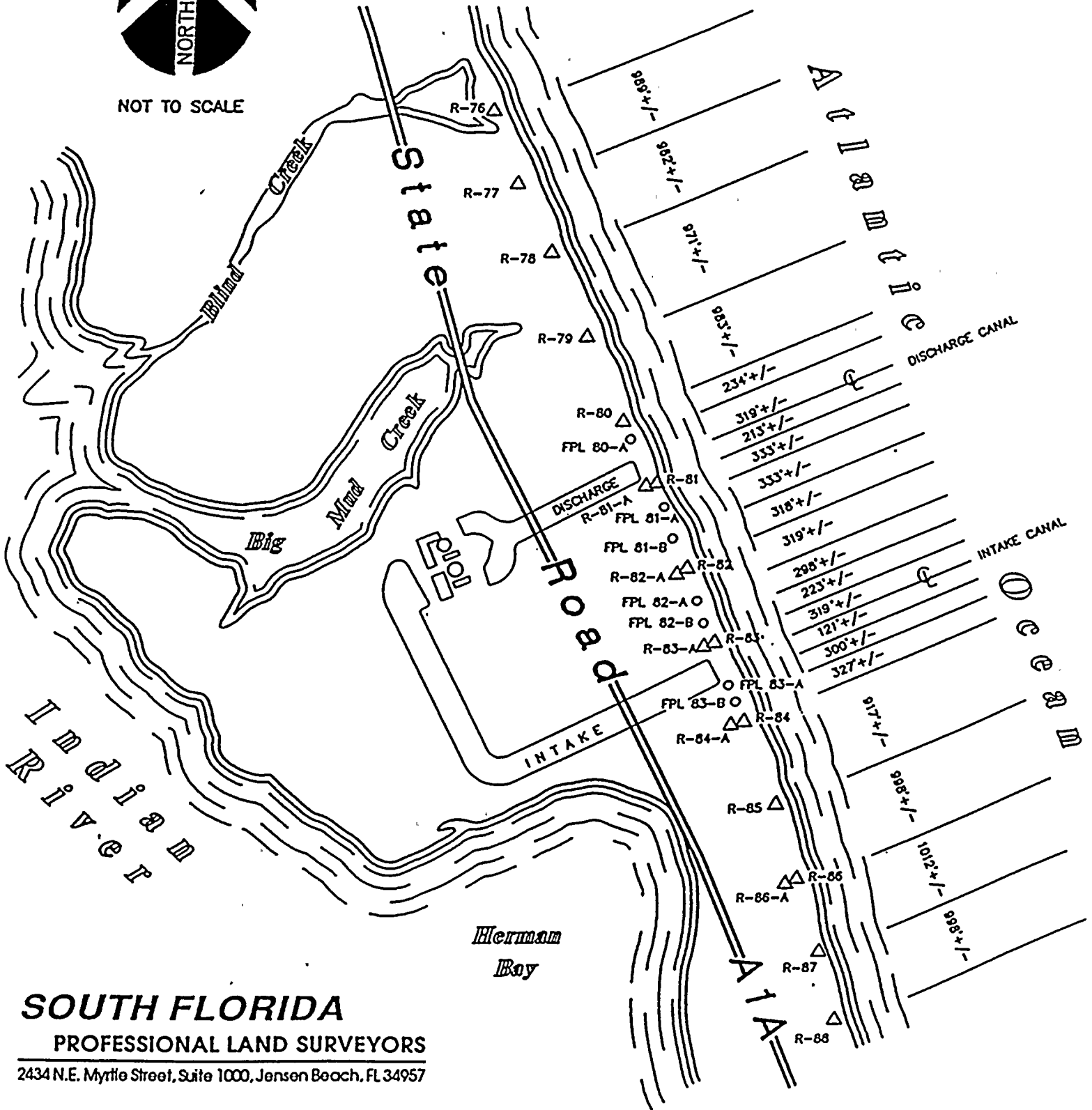

**SOUTH FLORIDA**

**PROFESSIONAL LAND SURVEYORS**

2434 N.E. Myrtle Street, Suite 1000, Jensen Beach, FL 34957



# ST. LUCIE DUNE SURVEY

PREPARED BY:

SOUTH FLORIDA PROFESSIONAL LAND SURVEYORS

VERTICAL SCALE: 1" = 4'  
HORIZONTAL SCALE: 1" = 40'

AUGUST 1995

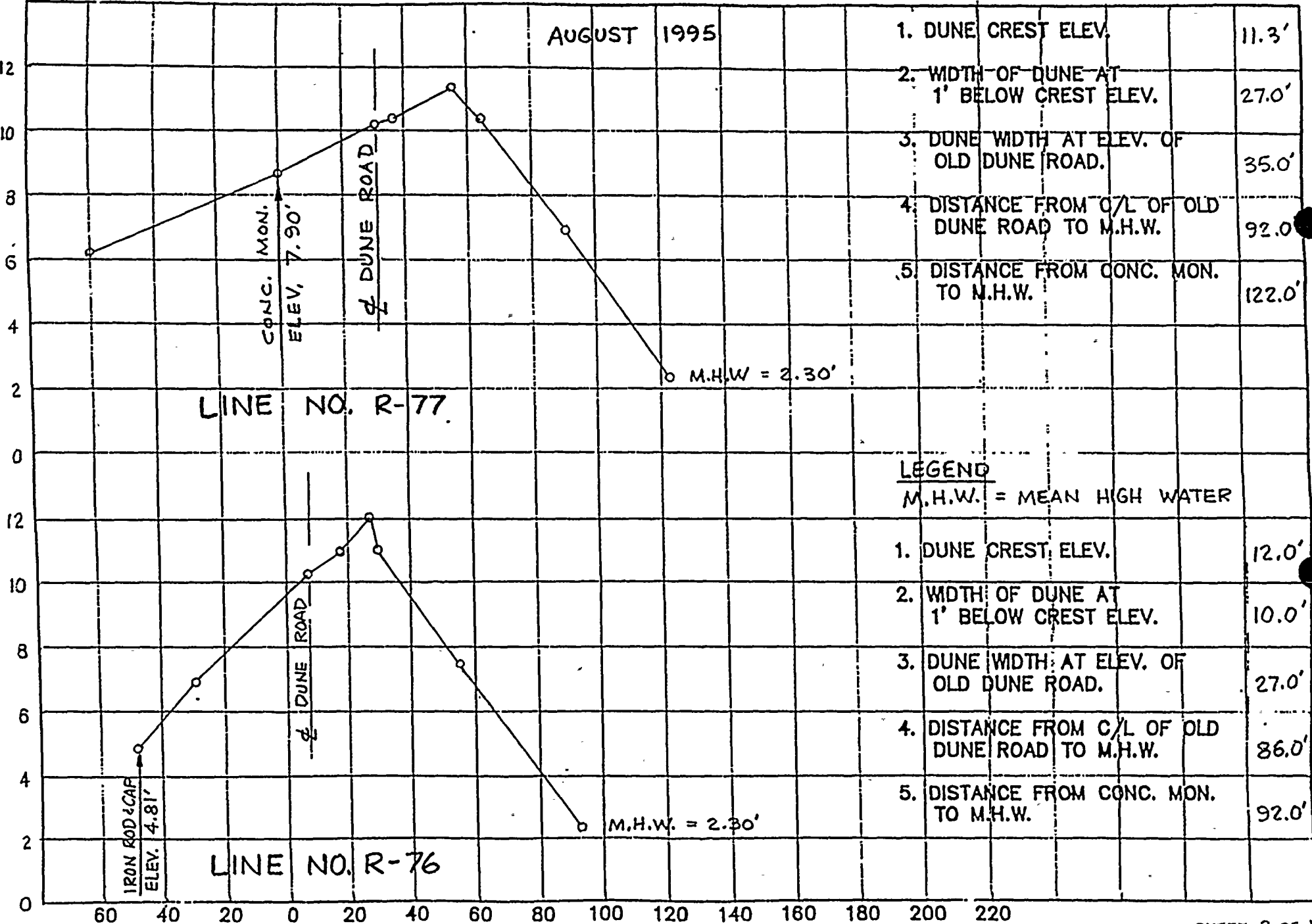

1. DUNE CREST ELEV.	11.3'
2. WIDTH OF DUNE AT 1' BELOW CREST ELEV.	27.0'
3. DUNE WIDTH AT ELEV. OF OLD DUNE ROAD.	35.0'
4. DISTANCE FROM C/L OF OLD DUNE ROAD TO M.H.W.	92.0'
5. DISTANCE FROM CONC. MON. TO M.H.W.	122.0'

LEGEND  
M.H.W. = MEAN HIGH WATER

1. DUNE CREST ELEV.	12.0'
2. WIDTH OF DUNE AT 1' BELOW CREST ELEV.	10.0'
3. DUNE WIDTH AT ELEV. OF OLD DUNE ROAD.	27.0'
4. DISTANCE FROM C/L OF OLD DUNE ROAD TO M.H.W.	86.0'
5. DISTANCE FROM CONC. MON. TO M.H.W.	92.0'

VERTICAL SCALE: 1" = 4'  
 HORIZONTAL SCALE: 1" = 40'

AUGUST 1995

LINE NO. R-79

IRON ROD & CAP  
 @ ELEV. 8.20'  
 @ DUNE ROAD

M.H.W. = 2.30'

1. DUNE CREST ELEV.	13.4'
2. WIDTH OF DUNE AT 1' BELOW CREST ELEV.	16.0'
3. DUNE WIDTH AT ELEV. OF OLD DUNE ROAD.	90.0'
4. DISTANCE FROM C/L OF OLD DUNE ROAD TO M.H.W.	151.0'
5. DISTANCE FROM CONC. MON. TO M.H.W.	159.0'

LINE NO. R-78

CONC. MON.  
 @ ELEV. 6.67'  
 @ DUNE ROAD

M.H.W. = 2.30'

1. DUNE CREST ELEV.	11.3'
2. WIDTH OF DUNE AT 1' BELOW CREST ELEV.	20.0'
3. DUNE WIDTH AT ELEV. OF OLD DUNE ROAD.	65.0'
4. DISTANCE FROM C/L OF OLD DUNE ROAD TO M.H.W.	110.0'
5. DISTANCE FROM CONC. MON. TO M.H.W.	120.0'

60 40 20 0 20 40 60 80 100 120 140 160 180 200 220

PROFILE DUNE SURVEY

PREPARED BY:

SOUTH FLORIDA PROFESSIONAL LAND SURVEYORS

VERTICAL SCALE: 1" = 4'  
HORIZONTAL SCALE: 1" = 40'

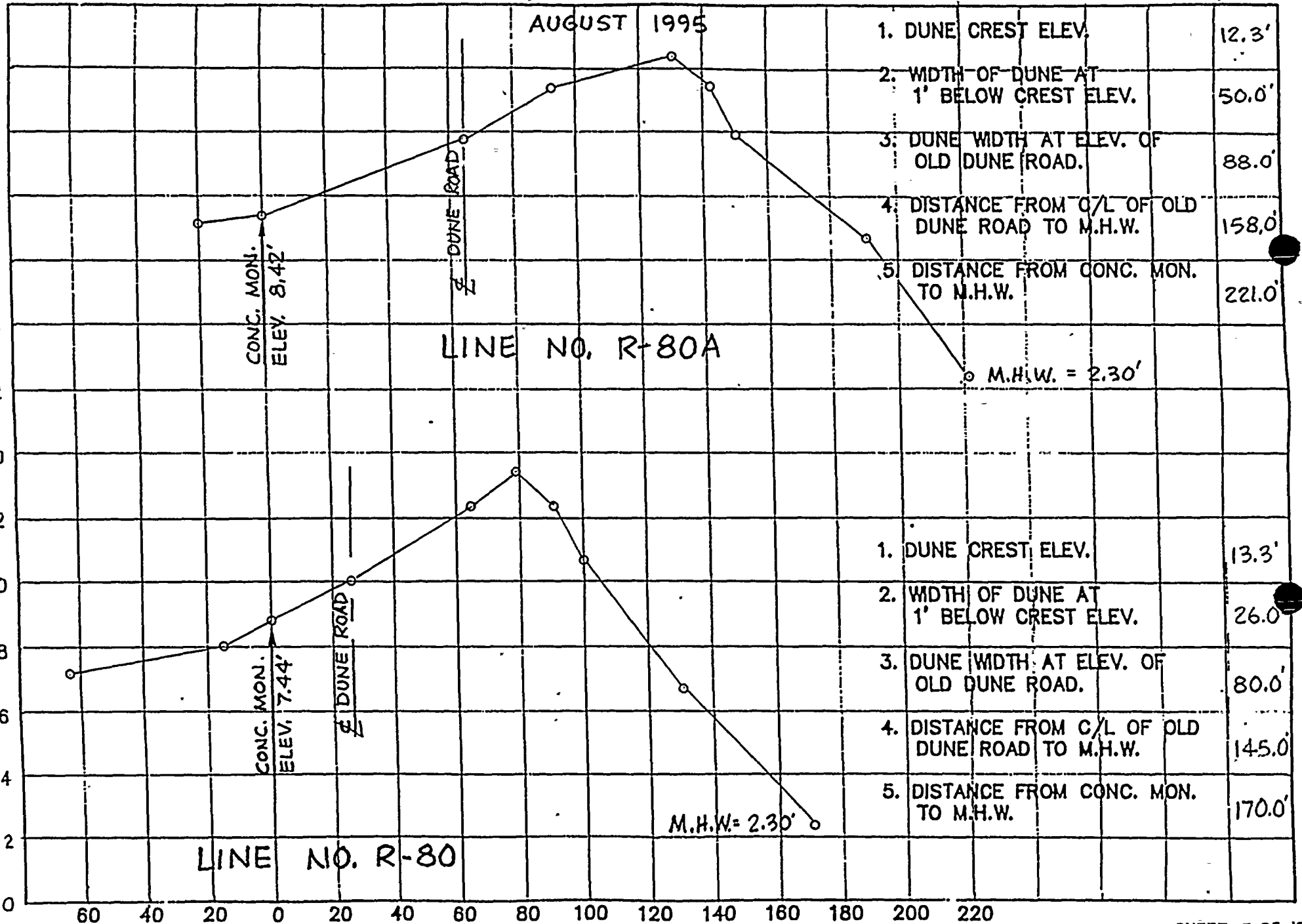

ST. LUCIE DUNE SURVEY

PREPARED BY:

SOUTH FLORIDA PROFESSIONAL LAND SURVEYORS

VERTICAL SCALE: 1" = 4'  
HORIZONTAL SCALE: 1" = 40'

AUGUST 1995

1. DUNE CREST ELEV.

2. WIDTH OF DUNE AT 1' BELOW CREST ELEV.

3. DUNE WIDTH AT ELEV. OF OLD DUNE ROAD.

4. DISTANCE FROM C/L OF OLD DUNE ROAD TO M.H.W.

5. DISTANCE FROM CONC. MON. TO M.H.W.

1. DUNE CREST ELEV.

2. WIDTH OF DUNE AT 1' BELOW CREST ELEV.

3. DUNE WIDTH AT ELEV. OF OLD DUNE ROAD.

4. DISTANCE FROM C/L OF OLD DUNE ROAD TO M.H.W.

5. DISTANCE FROM CONC. MON. TO M.H.W.

16.6'

N/A

N/A

N/A

92.0'

CONC. MON.  
ELEV. 16.47'

M.H.W. = 2.30'

LINE NO. R-80B

VERTICAL SCALE: 1" = 4'  
 HORIZONTAL SCALE: 1" = 40'

AUGUST 1995

1. DUNE CREST ELEV.
2. WIDTH OF DUNE AT 1' BELOW CREST ELEV.
3. DUNE WIDTH AT ELEV. OF OLD DUNE ROAD.
4. DISTANCE FROM C/L OF OLD DUNE ROAD TO M.H.W.
5. DISTANCE FROM CONC. MON. TO M.H.W.

- |   |        |
|---|--------|
| 1. DUNE CREST ELEV.                             | 14.5'  |
| 2. WIDTH OF DUNE AT 1' BELOW CREST ELEV.        | 38.0'  |
| 3. DUNE WIDTH AT ELEV. OF OLD DUNE ROAD.        | N/A    |
| 4. DISTANCE FROM C/L OF OLD DUNE ROAD TO M.H.W. | N/A    |
| 5. DISTANCE FROM CONC. MON. TO M.H.W.           | 105.0' |

CONC. MON.  
 ELEV. 14.16'

M.H.W. = 2.30'

LINE NO. R-81



PREPARED BY:

SOUTH FLORIDA PROFESSIONAL LAND SURVEYORS

VERTICAL SCALE: 1" = 4'  
HORIZONTAL SCALE: 1" = 40'

AUGUST 1995

1. DUNE CREST ELEV.
2. WIDTH OF DUNE AT 1' BELOW CREST ELEV.
3. DUNE WIDTH AT ELEV. OF OLD DUNE ROAD.
4. DISTANCE FROM C/L OF OLD DUNE ROAD TO M.H.W.
5. DISTANCE FROM CONC. MON. TO M.H.W.

CONC. MON.  
ELEV. 15.55'

- |   |        |
|---|--------|
| 1. DUNE CREST ELEV.                             | 14.8'  |
| 2. WIDTH OF DUNE AT 1' BELOW CREST ELEV.        | 24.0'  |
| 3. DUNE WIDTH AT ELEV. OF OLD DUNE ROAD.        | N/A    |
| 4. DISTANCE FROM C/L OF OLD DUNE ROAD TO M.H.W. | N/A    |
| 5. DISTANCE FROM CONC. MON. TO M.H.W.           | 110.0' |

M.H.W. = 2.30'

LINE NO. 81-A

# ST. LUCIE DUNE SURVEY

PREPARED BY:

SOUTH FLORIDA PROFESSIONAL LAND SURVEYORS

VERTICAL SCALE: 1" = 4'  
HORIZONTAL SCALE: 1" = 40'

AUGUST 1995

1. DUNE CREST ELEV.
2. WIDTH OF DUNE AT 1' BELOW CREST ELEV.
3. DUNE WIDTH AT ELEV. OF OLD DUNE ROAD.
4. DISTANCE FROM C/L OF OLD DUNE ROAD TO M.H.W.
5. DISTANCE FROM CONC. MON. TO M.H.W.

CONC. MON.  
ELEV. 14.84'

M.H.W. = 2.30'

LINE NO. 81-B

- |   |       |
|---|-------|
| 1. DUNE CREST ELEV.                             | 14.3' |
| 2. WIDTH OF DUNE AT 1' BELOW CREST ELEV.        | 35.0' |
| 3. DUNE WIDTH AT ELEV. OF OLD DUNE ROAD.        | N/A   |
| 4. DISTANCE FROM C/L OF OLD DUNE ROAD TO M.H.W. | N/A   |
| 5. DISTANCE FROM CONC. MON. TO M.H.W.           | 97.0' |

60 40 20 0 20 40 60 80 100 120 140 160 180 200 220



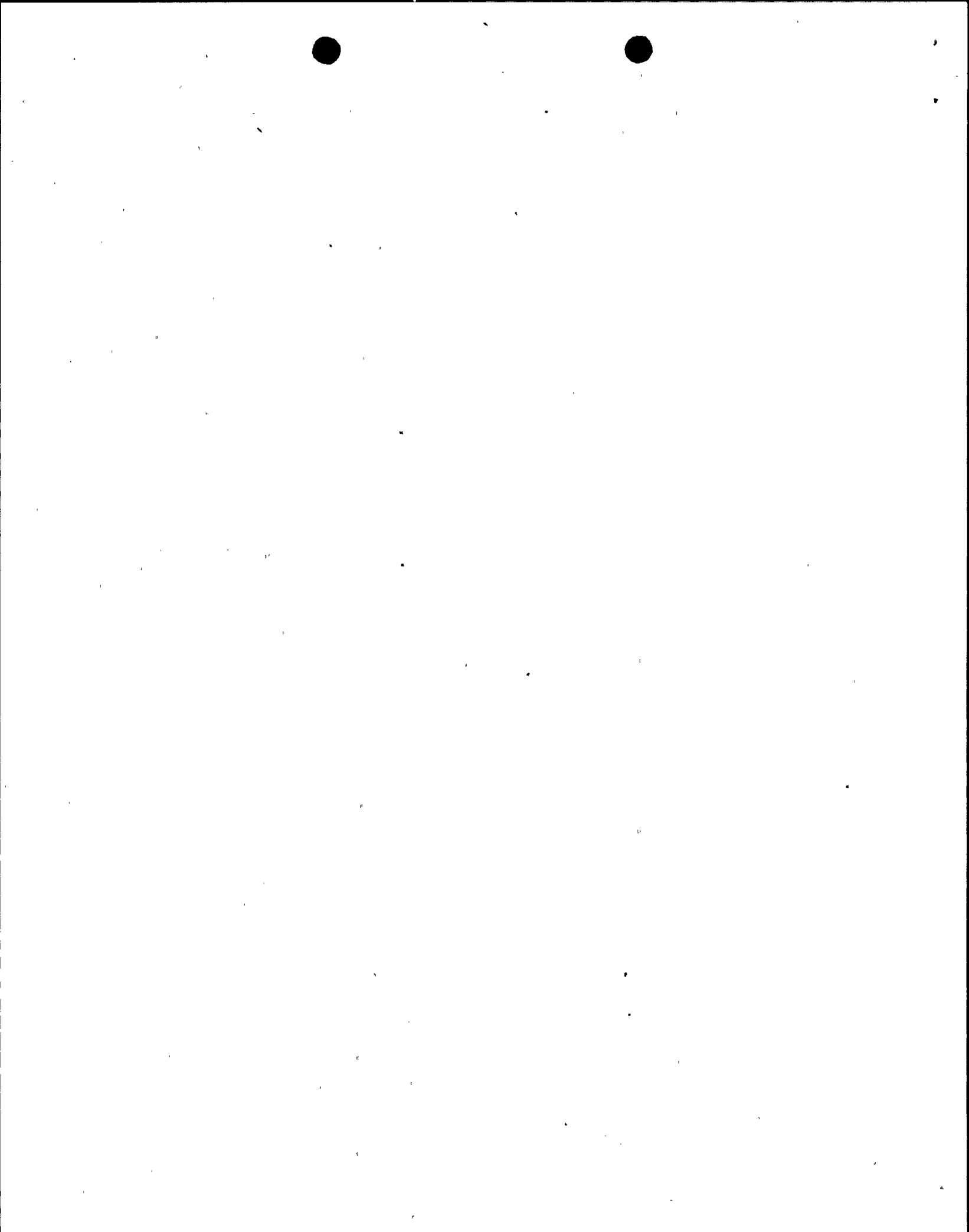

ST. LUCIE DUNE SURVEY

PREPARED BY:

SOUTH FLORIDA PROFESSIONAL LAND SURVEYORS

VERTICAL SCALE: 1" = 4'  
HORIZONTAL SCALE: 1" = 40'

AUGUST 1995

1. DUNE CREST ELEV.
2. WIDTH OF DUNE AT 1' BELOW CREST ELEV.
3. DUNE WIDTH AT ELEV. OF OLD DUNE ROAD.
4. DISTANCE FROM C/L OF OLD DUNE ROAD TO M.H.W.
5. DISTANCE FROM CONC. MON. TO M.H.W.

- |   |       |
|---|-------|
| 1. DUNE CREST ELEV.                             | 14.1' |
| 2. WIDTH OF DUNE AT 1' BELOW CREST ELEV.        | 20.0' |
| 3. DUNE WIDTH AT ELEV. OF OLD DUNE ROAD.        | N/A   |
| 4. DISTANCE FROM C/L OF OLD DUNE ROAD TO M.H.W. | N/A   |
| 5. DISTANCE FROM CONC. MON. TO M.H.W.           | 95.0' |

CONC. MON.  
ELEV. 14.51'

M.H.W. = 2.30'

LINE NO. R-82



PREPARED BY:

SOUTH FLORIDA PROFESSIONAL LAND SURVEYORS

VERTICAL SCALE: 1" = 4'  
HORIZONTAL SCALE: 1" = 40'

AUGUST 1995

1. DUNE CREST ELEV.
2. WIDTH OF DUNE AT 1' BELOW CREST ELEV.
3. DUNE WIDTH AT ELEV. OF OLD DUNE ROAD.
4. DISTANCE FROM C/L OF OLD DUNE ROAD TO M.H.W.
5. DISTANCE FROM CONC. MON. TO M.H.W.

- |   |        |
|---|--------|
| 1. DUNE CREST ELEV.                             | 14.2'  |
| 2. WIDTH OF DUNE AT 1' BELOW CREST ELEV.        | 37.0'  |
| 3. DUNE WIDTH AT ELEV. OF OLD DUNE ROAD.        | N/A    |
| 4. DISTANCE FROM C/L OF OLD DUNE ROAD TO M.H.W. | N/A    |
| 5. DISTANCE FROM CONC. MON. TO M.H.W.           | 101.0' |

CONC. MON. ELEV. 14.26'

M.H.W. = 2.30'

LINE NO. 82-A

ST. LOUIS DUNE SURVEY

PREPARED BY:

SOUTH FLORIDA PROFESSIONAL LAND SURVEYORS

VERTICAL SCALE: 1" = 4'  
HORIZONTAL SCALE: 1" = 40'

AUGUST 1995

1. DUNE CREST ELEV.
2. WIDTH OF DUNE AT 1' BELOW CREST ELEV.
3. DUNE WIDTH AT ELEV. OF OLD DUNE ROAD.
4. DISTANCE FROM C/L OF OLD DUNE ROAD TO M.H.W.
5. DISTANCE FROM CONC. MON. TO M.H.W.

- |   |        |
|---|--------|
| 1. DUNE CREST ELEV.                             | 13.8'  |
| 2. WIDTH OF DUNE AT 1' BELOW CREST ELEV.        | 11.0'  |
| 3. DUNE WIDTH AT ELEV. OF OLD DUNE ROAD.        | N/A    |
| 4. DISTANCE FROM C/L OF OLD DUNE ROAD TO M.H.W. | N/A    |
| 5. DISTANCE FROM CONC. MON. TO M.H.W.           | 120.0' |

CONC. MON.  
ELEV. 11.56'

M.H.W. = 2.30'

LINE NO. 82-B

PREPARED BY:

SOUTH FLORIDA PROFESSIONAL LAND SURVEYORS

VERTICAL SCALE: 1" = 4'  
HORIZONTAL SCALE: 1" = 40'

AUGUST 1995

1. DUNE CREST ELEV.
2. WIDTH OF DUNE AT 1' BELOW CREST ELEV.
3. DUNE WIDTH AT ELEV. OF OLD DUNE ROAD.
4. DISTANCE FROM C/L OF OLD DUNE ROAD TO M.H.W.
5. DISTANCE FROM CONC. MON. TO M.H.W.

CONC. MON.  
ELEV. 12.65'

- |   |        |
|---|--------|
| 1. DUNE CREST ELEV.                             | 13.3'  |
| 2. WIDTH OF DUNE AT 1' BELOW CREST ELEV.        | 37.0'  |
| 3. DUNE WIDTH AT ELEV. OF OLD DUNE ROAD.        | N/A    |
| 4. DISTANCE FROM C/L OF OLD DUNE ROAD TO M.H.W. | N/A    |
| 5. DISTANCE FROM CONC. MON. TO M.H.W.           | 122.0' |

M.H.W. = 2.30'

LINE NO. R-83



# ST. LUCIE DUNE SURVEY

PREPARED BY:

SOUTH FLORIDA PROFESSIONAL LAND SURVEYORS

VERTICAL SCALE: 1" = 4'  
HORIZONTAL SCALE: 1" = 40'

AUGUST, 1995

LINE NO. 83-B

CONC. MON.  
ELEV. 11.46'

M.H.W. = 2.30'

1. DUNE CREST ELEV.	12.4'
2. WIDTH OF DUNE AT 1' BELOW CREST ELEV.	26.0'
3. DUNE WIDTH AT ELEV. OF OLD DUNE ROAD.	N/A
4. DISTANCE FROM C/L OF OLD DUNE ROAD TO M.H.W.	N/A
5. DISTANCE FROM CONC. MON. TO M.H.W.	90.0'

LINE NO. 83-A

CONC. MON.  
ELEV. 10.05'

M.H.W. = 2.30'

1. DUNE CREST ELEV.	12.8'
2. WIDTH OF DUNE AT 1' BELOW CREST ELEV.	15.0'
3. DUNE WIDTH AT ELEV. OF OLD DUNE ROAD.	N/A
4. DISTANCE FROM C/L OF OLD DUNE ROAD TO M.H.W.	N/A
5. DISTANCE FROM CONC. MON. TO M.H.W.	115.0'

60 40 20 0 20 40 60 80 100 120 140 160 180 200 220



PROFILE DUNE SURVEY

PREPARED BY:

SOUTH FLORIDA PROFESSIONAL LAND SURVEYORS

VERTICAL SCALE: 1" = 4'  
HORIZONTAL SCALE: 1" = 40'

AUGUST 1995

LINE NO. R-85

CONC. MON.  
ELEV. = 8.01'

M.H.W. = 2.30'

1. DUNE CREST ELEV. 11.7'
2. WIDTH OF DUNE AT 1' BELOW CREST ELEV. 26.0'
3. DUNE WIDTH AT ELEV. OF OLD DUNE ROAD. N/A
4. DISTANCE FROM C/L OF OLD DUNE ROAD TO M.H.W. N/A
5. DISTANCE FROM CONC. MON. TO M.H.W. 157.0'

LINE NO. R-84

CONC. MON.  
ELEV. 10.26'

M.H.W. = 2.30'

1. DUNE CREST ELEV. 13.3'
2. WIDTH OF DUNE AT 1' BELOW CREST ELEV. 6.0'
3. DUNE WIDTH AT ELEV. OF OLD DUNE ROAD. N/A
4. DISTANCE FROM C/L OF OLD DUNE ROAD TO M.H.W. N/A
5. DISTANCE FROM CONC. MON. TO M.H.W. 100.0'

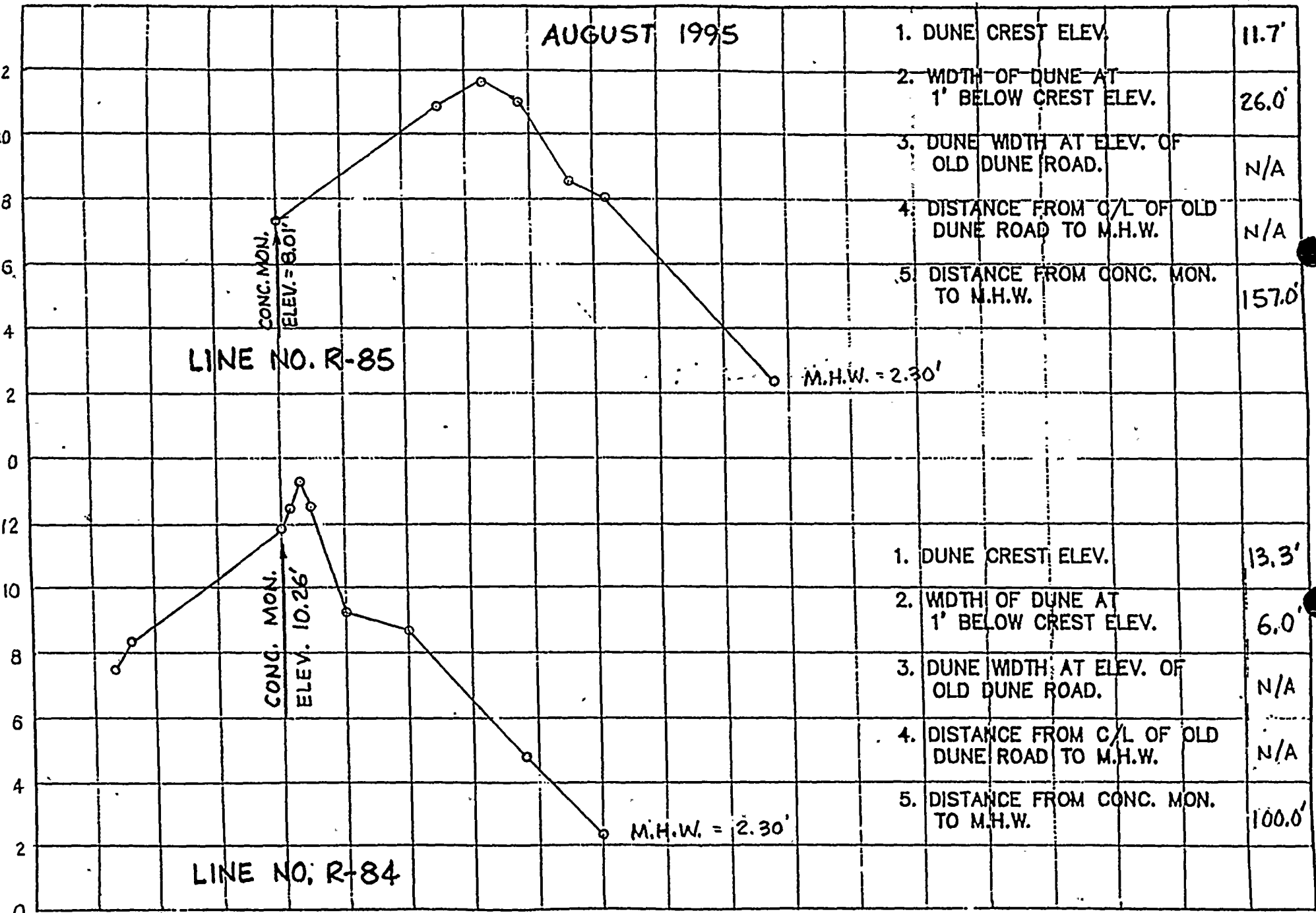

ST. LOUIS DUNE SURVEY

PREPARED BY:

SOUTH FLORIDA PROFESSIONAL LAND SURVEYORS

VERTICAL SCALE: 1" = 4'  
 HORIZONTAL SCALE: 1" = 40'

AUGUST 1995

- |   |       |
|---|-------|
| 1. DUNE CREST ELEV.                             | 12.2' |
| 2. WIDTH OF DUNE AT 1' BELOW CREST ELEV.        | 23.0' |
| 3. DUNE WIDTH AT ELEV. OF OLD DUNE ROAD.        | N/A   |
| 4. DISTANCE FROM C/L OF OLD DUNE ROAD TO M.H.W. | N/A   |
| 5. DISTANCE FROM CONC. MON. TO M.H.W.           | 280.0 |

M.H.W. = 2.30'

LINE NO. R-87

CONC. MON.  
 ELEV. 4.67'

- |   |        |
|---|--------|
| 1. DUNE CREST ELEV.                             | 11.0'  |
| 2. WIDTH OF DUNE AT 1' BELOW CREST ELEV.        | 29.0'  |
| 3. DUNE WIDTH AT ELEV. OF OLD DUNE ROAD.        | N/A    |
| 4. DISTANCE FROM C/L OF OLD DUNE ROAD TO M.H.W. | N/A    |
| 5. DISTANCE FROM CONC. MON. TO M.H.W.           | 115.0' |

M.H.W. = 2.30'

LINE NO. R-86

CONC. MON.  
 ELEV. 8.74'

60 40 20 0 20 40 60 80 100 120 140 160 180 200 220 240 260 280

ST. LUCIE DUNE SURVEY

PREPARED BY:

SOUTH FLORIDA PROFESSIONAL LAND SURVEYORS

VERTICAL SCALE: 1" = 4'  
HORIZONTAL SCALE: 1" = 40'

AUGUST 1995

1. DUNE CREST ELEV.
2. WIDTH OF DUNE AT 1' BELOW CREST ELEV.
3. DUNE WIDTH AT ELEV. OF OLD DUNE ROAD.
4. DISTANCE FROM C/L OF OLD DUNE ROAD TO M.H.W.
5. DISTANCE FROM CONC. MON. TO M.H.W.

CONC. MON.  
ELEV. 10.51'

- |   |       |
|---|-------|
| 1. DUNE CREST ELEV.                             | 13.2' |
| 2. WIDTH OF DUNE AT 1' BELOW CREST ELEV.        | 18.0  |
| 3. DUNE WIDTH AT ELEV. OF OLD DUNE ROAD.        | N/A   |
| 4. DISTANCE FROM C/L OF OLD DUNE ROAD TO M.H.W. | N/A   |
| 5. DISTANCE FROM CONC. MON. TO M.H.W.           | 87.0' |

LINE NO. R-88

