

REGULATORY INFORMATION DISTRIBUTION SYSTEM (RIDS)

ACCESSION NBR: 8209100131 DOC. DATE: 82/09/03 NOTARIZED: NO  
 FACIL: 50-389 St. Lucie Plant, Unit 2, Florida Power & Light Co.  
 AUTH. NAME: UHRIG, R.E. AUTHOR AFFILIATION: Florida Power & Light Co.  
 RECIP. NAME: EISENHUT, D.G. RECIPIENT AFFILIATION: Division of Licensing

DOCKET # 05000389

SUBJECT: Forwards fire protection commitments made during May 1982 site visit, including commitment to add automatic smoke detection capability to both safety-related battery rooms. Drawing encl.

DISTRIBUTION CODE: B002S COPIES RECEIVED: LTR 1 ENCL 1 SIZE: 3  
 TITLE: Licensing Submittal: Fire Protection

NOTES:

	RECIPIENT ID CODE/NAME	COPIES		RECIPIENT ID CODE/NAME	COPIES	
		LTTR	ENCL		LTTR	ENCL
	LIC BR #3 BC	1	1	NERSES, V. 01	1	1
INTERNAL:	ELD/HDS2	1	0	IE FILE 07	1	1
	NRR/DE/ADMQE	1	0	NRR/DE/CEB 06	4	4
	NRR/DSI/ASB	1	1	REG FILE 04	1	1
	RGN2	1	1			
EXTERNAL:	ACRS 10	10	10	LPDR 03	1	1
	NRC PDR 02	1	1	NSIC 05	1	1
	NTIS	1	1			



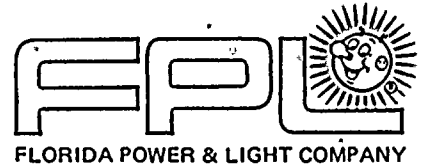

September 3, 1982  
L-82-394

Office of Nuclear Reactor Regulations  
Attention: Mr. Darrell G. Eisenhut, Director  
Division of Licensing  
U. S. Nuclear Regulatory Commission  
Washington, D. C. 20555

Dear Mr. Eisenhut:

Re: St. Lucie Unit No. 2  
Docket No. 50-389  
Additional Fire Protection Commitments

Attached please find our conclusions and commitments that resulted from the site audit of St. Lucie 2 conducted by your staff during May 1982. These commitments are being forwarded to your office to document our agreement with each item. If you have any questions, please contact us accordingly.

Very truly yours,

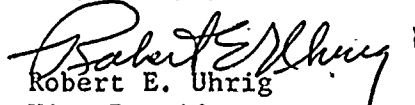
  
Robert E. Uhrig  
Vice President  
Advanced Systems and Technology

REU/RAK/jea

Attachment

cc: J. P. O'Reilly, Region II  
Harold F. Reis, Esquire

Boo2

8209100131 820903  
PDR ADDCK 05000389  
PDR

Comments to Draft SSER

The following commitments were made during an NRC site audit conducted during May of 1982:

- 1) One hose station will be provided in the Fuel Handling Building on elevation 62'. This hose station will be located in the Spent Fuel Pool area, within reach of the New Fuel area in accordance with the guidelines of Appendix A.
- 2) All trouble and alarm signals from the preaction sprinkler system protecting safe shutdown equipment (Diesel Generator & Reactor Auxiliary Buildings only) will be transmitted to the control room in accordance with NFPA72D.
- 3) Three supplemental smoke detectors will be provided in the southeast corner of the control room. In addition, numerous solid ceiling tiles will be replaced with the open metal grid type to facilitate the flow of the products of combustion to the smoke detectors located above the suspended ceiling. These changes are reflected in sketch NYO-2998-143 (attached).
- 4) A curb will be provided at the east stairwells of the Diesel Generator Building to contain 110% of the oil from one day tank within the building.
- 5) Automatic smoke detection capability will be added to both safety related battery rooms.
- 6) Three hour fire rated penetration seals will be provided in all fire rated barriers as defined in drawings SK-590-068 sheets 1 through 5 transmitted by FP&L letter L-82-282.

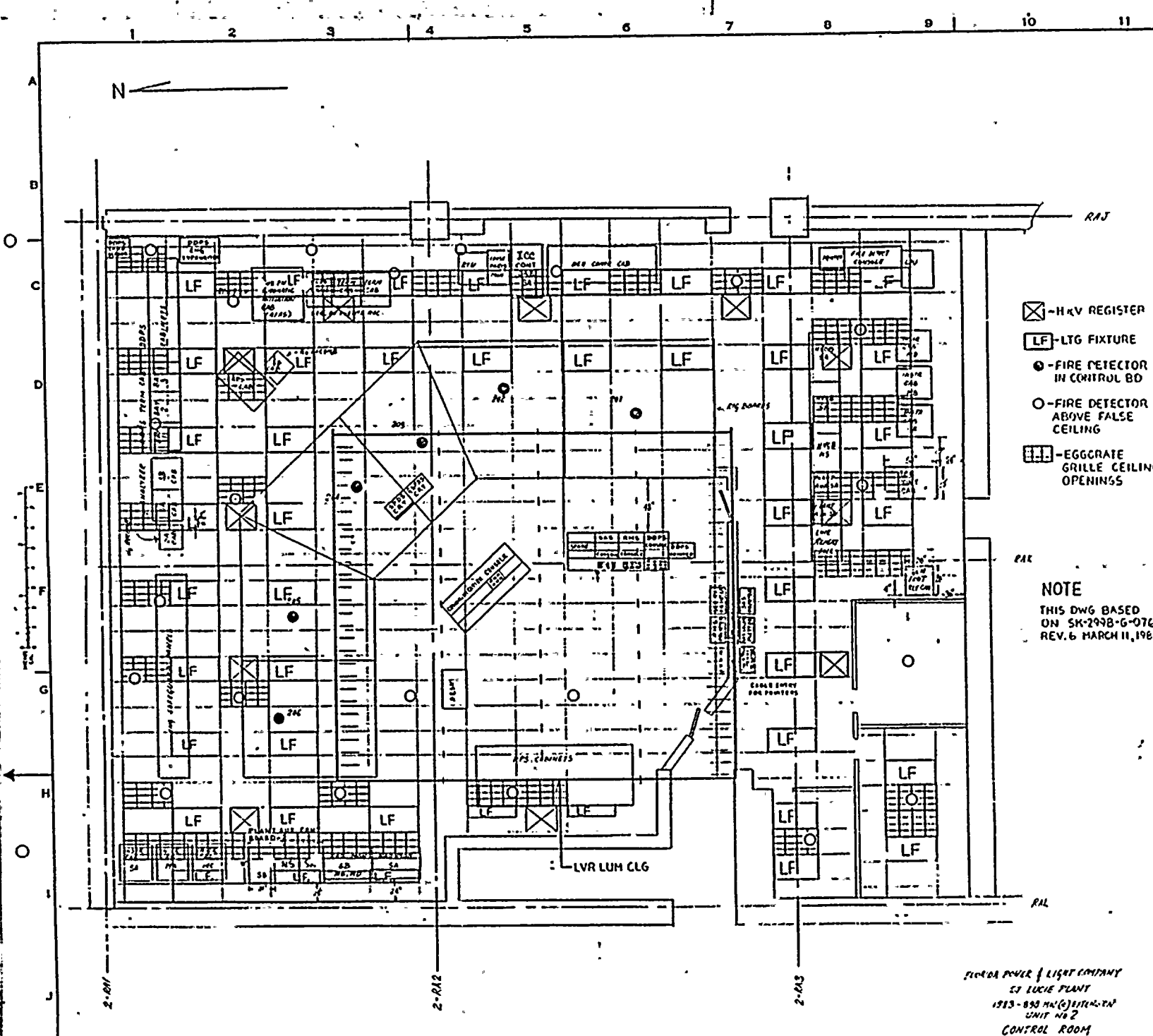

- ☒ - HVAC REGISTER
- LF - LITG FIXTURE
- - FIRE DETECTOR IN CONTROL BD
- - FIRE DETECTOR ABOVE FALSE CEILING
- ▣ - EGGRATE GRILLE CEILING OPENINGS

**NOTE**  
 THIS DWG BASED  
 ON SK-2998-G-076  
 REV. 6 MARCH 11, 1982

FLUOR DANER & LIGHT COMPANY  
 57 LUCIE PLANT  
 1915 - 890 MA(6) BIRMINGHAM  
 UNIT NO 2  
 CONTROL ROOM  
 SK NO HNO-2998-143  
 FIRE HAZARD ANALYSIS  
 FIRE DETECTORS & PROPOSED  
 CEILING OPENINGS  
 SCALE = 1/4" = 1'

DATE: 6.28.82