

| | | |
|--|---|---------------|
| Hematite Decommissioning Project | Procedure: HDP-PR-FSS-712, Final Status Surveys of Structures, Systems, and Components (SSCs) | |
| | Revision: 5 | Page A-1 of 2 |

**APPENDIX A-1
FINAL STATUS SURVEY RESULTS**

| | | | | | |
|---|--|-------------------------------|---|------------------|-----------|
| Survey Unit Description & Survey Unit Number: | PSA 01-09 / STM-9 | Survey Log Number: | 6937 C 160203 | Date: | 12/3/2015 |
| Technician(s) Print/Sign/Date: | J. Michel / <i>JM</i> 12/3/15 | Reviewed by: Print/Sign/Date: | J. Bushman / <i>JB</i> 12/3/15 | Time: | 16:30 |
| Instrument # 1 | | Instrument # 2 | | Tennelec | |
| Instrument & Probe: | Lud 2360/43-68 MDA (dpm/100cm ²): 431.5 | Instrument & Probe: | N/A MDA (dpm/100cm ²): N/A | Unit #: | N/A |
| Instrument SN: | 248144 Bkg 1: 111 | Instrument SN: | N/A Bkg 1: N/A | Alpha Bkg: | N/A |
| Cal Due Date: | 10/2/2016 Bkg 2: 123 | Cal Due Date: | N/A Bkg 2: N/A | Alpha Eff: | N/A |
| Probe Size: | 125 Bkg 3: 121 | Probe Size: | N/A Bkg 3: N/A | Alpha MDA (dpm): | N/A |
| Weighted Eff.: | 9.5% Ave. Bkg: 118 | Weighted Eff.: | N/A Ave. Bkg: N/A | Beta MDA (dpm): | N/A |
| | | | | Batch No: | N/A |

Comments: Systematic FSS scan of 18" pipe from MH 01 to the West. Instrument sled pulled via braided steel cable at 1-2" per second. Static measurements taken at all points by allowing instrument to set in place for two minutes ensuring proper count. See map page 2 for locations.

| Sample No. | Instrument Number (i.e., 1 or 2) | Description | Removable Alpha | | Removable Beta | | Total Contamination (α + β) | | DCGL Fraction |
|------------|----------------------------------|--------------------|-----------------|--------------------------|----------------|--------------------------|-----------------------------|--------------------------|---------------|
| | | | Net CPM | DPM / 100cm ² | Net CPM | DPM / 100cm ² | Gross CPM | DPM / 100cm ² | |
| 1 | 1 | P01-09-01-S-O-S-00 | N/A | N/A | N/A | N/A | 95 | 0 | 0.00 |
| 2 | 1 | P01-09-02-S-O-S-00 | N/A | N/A | N/A | N/A | 98 | 0 | 0.00 |
| 3 | 1 | P01-09-03-S-O-S-00 | N/A | N/A | N/A | N/A | 96 | 0 | 0.00 |
| 4 | 1 | P01-09-04-S-O-S-00 | N/A | N/A | N/A | N/A | 109 | 0 | 0.00 |
| 5 | 1 | P01-09-05-S-O-S-00 | N/A | N/A | N/A | N/A | 79 | 0 | 0.00 |
| 6 | 1 | P01-09-06-S-O-S-00 | N/A | N/A | N/A | N/A | 78 | 0 | 0.00 |
| 7 | 1 | P01-09-07-S-O-S-00 | N/A | N/A | N/A | N/A | 81 | 0 | 0.00 |
| 8 | 1 | P01-09-08-S-O-S-00 | N/A | N/A | N/A | N/A | 69 | 0 | 0.00 |
| 9 | 1 | P01-09-09-S-O-S-00 | N/A | N/A | N/A | N/A | 109 | 0 | 0.00 |
| 10 | 1 | P01-09-10-S-O-S-00 | N/A | N/A | N/A | N/A | 103 | 0 | 0.00 |
| 11 | 1 | P01-09-11-S-O-S-00 | N/A | N/A | N/A | N/A | 64 | 0 | 0.00 |
| 12 | 1 | P01-09-12-S-O-S-00 | N/A | N/A | N/A | N/A | 68 | 0 | 0.00 |
| 13 | 1 | P01-09-13-S-O-S-00 | N/A | N/A | N/A | N/A | 87 | 0 | 0.00 |
| 14 | 1 | P01-09-14-S-O-S-00 | N/A | N/A | N/A | N/A | 78 | 0 | 0.00 |
| 15 | 1 | P01-09-15-S-O-S-00 | N/A | N/A | N/A | N/A | 86 | 0 | 0.00 |
| N/A | N/A | N/A | N/A | N/A | N/A | N/A | N/A | N/A | N/A |
| N/A | N/A | N/A | N/A | N/A | N/A | N/A | N/A | N/A | N/A |
| N/A | N/A | N/A | N/A | N/A | N/A | N/A | N/A | N/A | N/A |
| N/A | N/A | N/A | N/A | N/A | N/A | N/A | N/A | N/A | N/A |
| N/A | N/A | N/A | N/A | N/A | N/A | N/A | N/A | N/A | N/A |
| N/A | N/A | N/A | N/A | N/A | N/A | N/A | N/A | N/A | N/A |
| N/A | N/A | N/A | N/A | N/A | N/A | N/A | N/A | N/A | N/A |
| N/A | N/A | N/A | N/A | N/A | N/A | N/A | N/A | N/A | N/A |
| N/A | N/A | N/A | N/A | N/A | N/A | N/A | N/A | N/A | N/A |
| N/A | N/A | N/A | N/A | N/A | N/A | N/A | N/A | N/A | N/A |
| N/A | N/A | N/A | N/A | N/A | N/A | N/A | N/A | N/A | N/A |
| N/A | N/A | N/A | N/A | N/A | N/A | N/A | N/A | N/A | N/A |
| N/A | N/A | N/A | N/A | N/A | N/A | N/A | N/A | N/A | N/A |

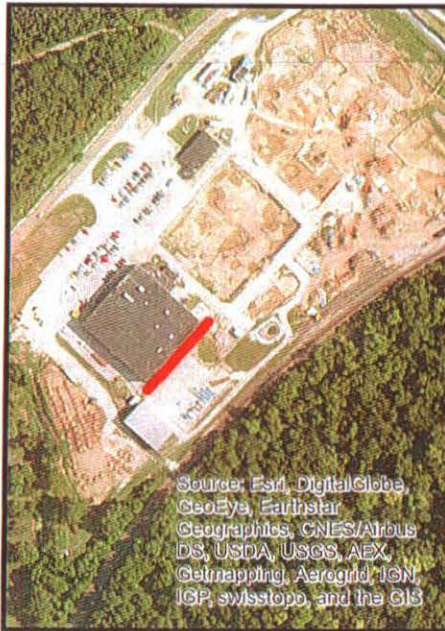

Source: Esri, DigitalGlobe, GeoEye, Earthstar Geographics, CNES/Airbus DS, USDA, USGS, AEX, Getmapping, Aergrid, IGN, IGP, swisstopo, and the GIS

BSA-02-01
Building 230

C:\GIS Data\Projects\Owners\C Evers\PSA_01_09_Piping_Survey_Map_020416.mxd

| Survey Unit | Sample ID | Distance from MH-01 toward MH-22 |
|-------------|--------------------|----------------------------------|
| PSA-01-09 | P01-09-01-S-O-S-00 | 12 ft. |
| PSA-01-09 | P01-09-02-S-O-S-00 | 26 ft. |
| PSA-01-09 | P01-09-03-S-O-S-00 | 39 ft. |
| PSA-01-09 | P01-09-04-S-O-S-00 | 53 ft. |
| PSA-01-09 | P01-09-05-S-O-S-00 | 67 ft. |
| PSA-01-09 | P01-09-06-S-O-S-00 | 81 ft. |
| PSA-01-09 | P01-09-07-S-O-S-00 | 94 ft. |
| PSA-01-09 | P01-09-08-S-O-S-00 | 108 ft. |
| PSA-01-09 | P01-09-09-S-O-S-00 | 122 ft. |
| PSA-01-09 | P01-09-10-S-O-S-00 | 136 ft. |
| PSA-01-09 | P01-09-11-S-O-S-00 | 149 ft. |
| PSA-01-09 | P01-09-12-S-O-S-00 | 163 ft. |
| PSA-01-09 | P01-09-13-S-O-S-00 | 177 ft. |
| PSA-01-09 | P01-09-14-S-O-S-00 | 191 ft. |
| PSA-01-09 | P01-09-15-S-O-S-00 | 204 ft. |

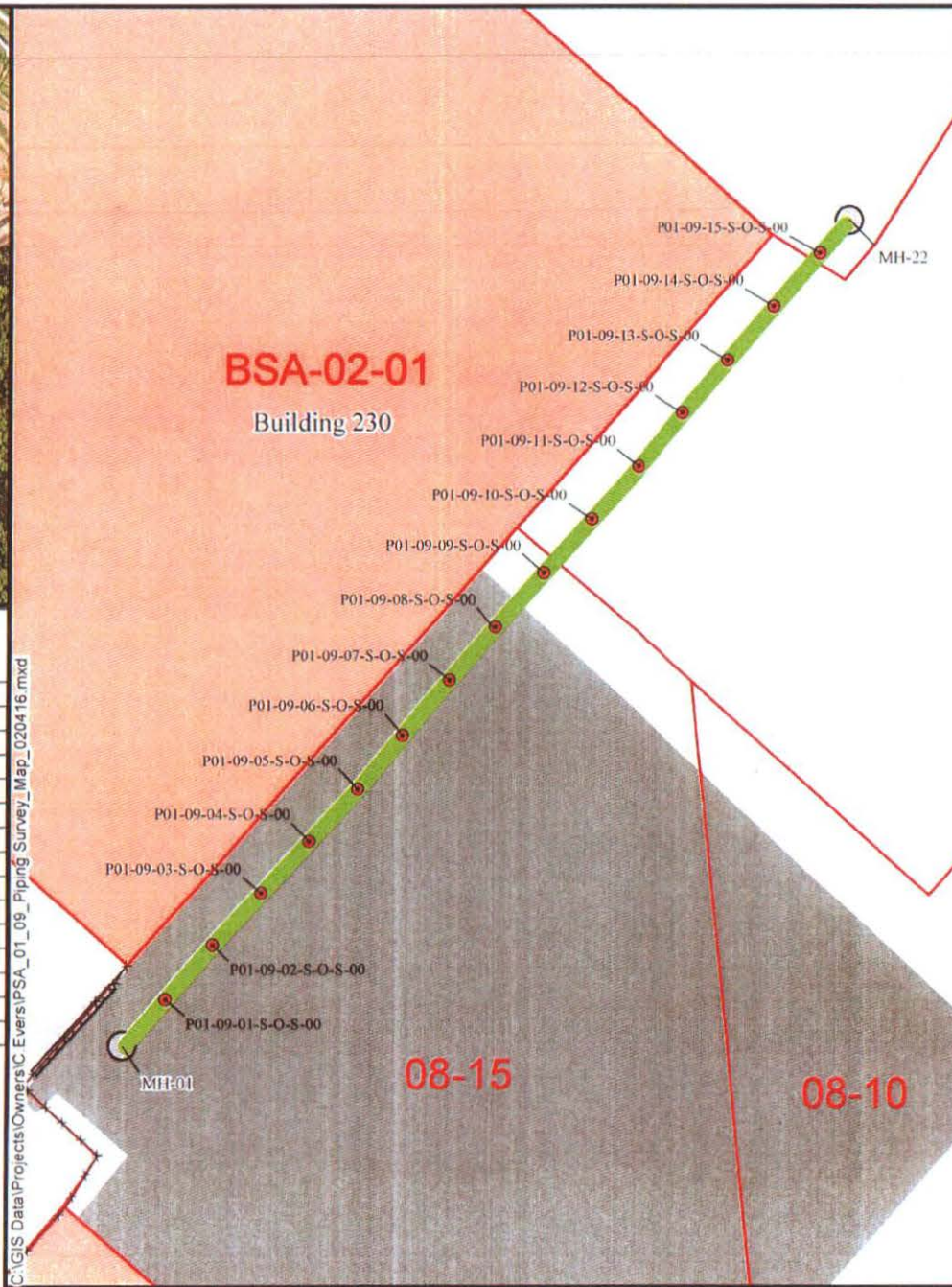

- LEGEND:**
- STM-9 Pipe Samples
 - STM-9
 - LSA Boundaries
 - Manhole
 - Building
 - Haul Road
 - Concrete Slab
 - × Fence

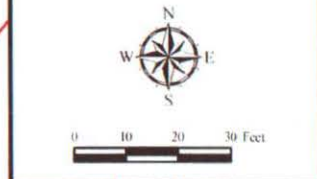

| | | |
|--|----------------|-------------------------------------|
| Requested By J. Michel | Page 2 of 2 | Document/Reason HDP-ENG13-WP-009 |
| PSA-01-09 Piping Survey Survey # 6937-C-160203 | | |
| Hematite Decommissioning Project Jefferson County Hematite, MO | | |
| Prepared By SDJ | Rev 0 | Date 02-04-16 |