

Hematite Decommissioning Project	Procedure: HDP-PR-FSS-712, Final Status Surveys of Structures, Systems, and Components (SSCs)	Revision: 5 Page A-1 of 2
--	---	------------------------------

**APPENDIX A-1  
FINAL STATUS SURVEY RESULTS**

Survey Unit Description & Survey Unit Number: STM-5 / PSA 01-05		Survey Log Number: 7656C160608		Date: 6/8/2016							
Technician(s): J. Michel / <i>JM</i>		Reviewed by: J. Bushman / <i>JB</i>		Time: 16:30							
Print/Sign/Date: <i>6/9/16</i>		Print/Sign/Date: <i>6/13/16</i>									
Instrument # 1			Instrument # 2			Tennelec					
Instrument & Probe:	Lud 2360/43-68	MDA (dpm/100cm <sup>2</sup> ):	541.1	Instrument & Probe:	N/A	MDA (dpm/100cm <sup>2</sup> ):	N/A	Unit #:	N/A	Cal Due:	N/A
Instrument SN:	248144	Bkg 1:	190	Instrument SN:	N/A	Bkg 1:	N/A	Alpha Bkg:	N/A	Beta Bkg:	N/A
Cal Due Date:	10/2/2016	Bkg 2:	180	Cal Due Date:	N/A	Bkg 2:	N/A	Alpha Eff:	N/A	Beta Eff:	N/A
Probe Size:	125	Bkg 3:	190	Probe Size:	N/A	Bkg 3:	N/A	Alpha MDA (dpm):	N/A	Beta MDA (dpm):	N/A
Weighted Eff.:	9.5%	Ave. Bkg:	187	Weighted Eff.:	N/A	Ave. Bkg:	N/A	Batch No:	N/A		

Comments: Systematic FSS scan of STM-5. Pipe surveyed from C-124B Southwest to MH-02. Scan performed manually of all accessible areas on bottom of the pipe. Static measurements taken at all systematic locations. See map page 2 for systematic locations. 3 background readings taken in C-124B at waist level.

Sample No.	Instrument Number (i.e., 1 or 2)	Description	Removable Alpha		Removable Beta		Total Contamination (α + β)		DCGL Fraction
			Net CPM	DPM / 100cm <sup>2</sup>	Net CPM	DPM / 100cm <sup>2</sup>	Gross CPM	DPM / 100cm <sup>2</sup>	
1	1	P01-05-01-S-O-S-00	N/A	N/A	N/A	N/A	116	0	0.00
2	1	P01-05-02-S-O-S-00	N/A	N/A	N/A	N/A	137	0	0.00
3	1	P01-05-03-S-O-S-00	N/A	N/A	N/A	N/A	116	0	0.00
4	1	P01-05-04-S-O-S-00	N/A	N/A	N/A	N/A	120	0	0.00
5	1	P01-05-05-S-O-S-00	N/A	N/A	N/A	N/A	127	0	0.00
6	1	P01-05-06-S-O-S-00	N/A	N/A	N/A	N/A	127	0	0.00
7	1	P01-05-07-S-O-S-00	N/A	N/A	N/A	N/A	113	0	0.00
8	1	P01-05-08-S-O-S-00	N/A	N/A	N/A	N/A	136	0	0.00
9	1	P01-05-09-S-O-S-00	N/A	N/A	N/A	N/A	115	0	0.00
10	1	P01-05-10-S-O-S-00	N/A	N/A	N/A	N/A	116	0	0.00
11	1	P01-05-11-S-O-S-00	N/A	N/A	N/A	N/A	119	0	0.00
12	1	P01-05-12-S-O-S-00	N/A	N/A	N/A	N/A	135	0	0.00
13	1	P01-05-13-S-O-S-00	N/A	N/A	N/A	N/A	138	0	0.00
14	1	P01-05-14-S-O-S-00	N/A	N/A	N/A	N/A	158	0	0.00
15	1	P01-05-15-S-O-S-00	N/A	N/A	N/A	N/A	N/A	N/A	N/A
N/A	N/A	N/A	N/A	N/A	N/A	N/A	N/A	N/A	N/A
N/A	N/A	N/A	N/A	N/A	N/A	N/A	N/A	N/A	N/A
N/A	N/A	N/A	N/A	N/A	N/A	N/A	N/A	N/A	N/A
N/A	N/A	N/A	N/A	N/A	N/A	N/A	N/A	N/A	N/A
N/A	N/A	N/A	N/A	N/A	N/A	N/A	N/A	N/A	N/A
N/A	N/A	N/A	N/A	N/A	N/A	N/A	N/A	N/A	N/A
N/A	N/A	N/A	N/A	N/A	N/A	N/A	N/A	N/A	N/A
N/A	N/A	N/A	N/A	N/A	N/A	N/A	N/A	N/A	N/A
N/A	N/A	N/A	N/A	N/A	N/A	N/A	N/A	N/A	N/A
N/A	N/A	N/A	N/A	N/A	N/A	N/A	N/A	N/A	N/A
N/A	N/A	N/A	N/A	N/A	N/A	N/A	N/A	N/A	N/A
N/A	N/A	N/A	N/A	N/A	N/A	N/A	N/A	N/A	N/A
N/A	N/A	N/A	N/A	N/A	N/A	N/A	N/A	N/A	N/A



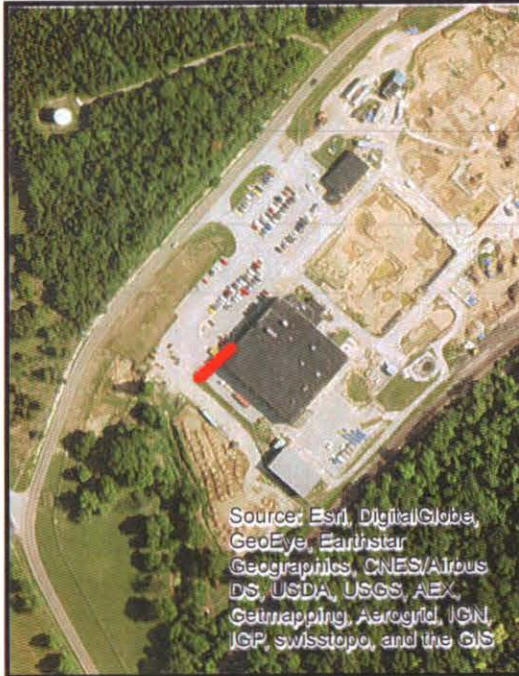

Survey Unit	Sample ID	Distance from C-124B toward MH-02
PSA-01-05	P01-05-01-S-O-S-00	4 ft.
PSA-01-05	P01-05-02-S-O-S-00	10 ft.
PSA-01-05	P01-05-03-S-O-S-00	17 ft.
PSA-01-05	P01-05-04-S-O-S-00	23 ft.
PSA-01-05	P01-05-05-S-O-S-00	29 ft.
PSA-01-05	P01-05-06-S-O-S-00	36 ft.
PSA-01-05	P01-05-07-S-O-S-00	43 ft.
PSA-01-05	P01-05-08-S-O-S-00	48 ft.
PSA-01-05	P01-05-09-S-O-S-00	55 ft.
PSA-01-05	P01-05-10-S-O-S-00	61 ft.
PSA-01-05	P01-05-11-S-O-S-00	67 ft.
PSA-01-05	P01-05-12-S-O-S-00	74 ft.
PSA-01-05	P01-05-13-S-O-S-00	80 ft.
PSA-01-05	P01-05-14-S-O-S-00	86 ft.
PSA-01-05	P01-05-15-S-O-S-00	93 ft.

C:\GIS\Data\Projects\Owners\C.Evers\PSA\_01\_05\_Piping Survey\_Map\_060816.mxd

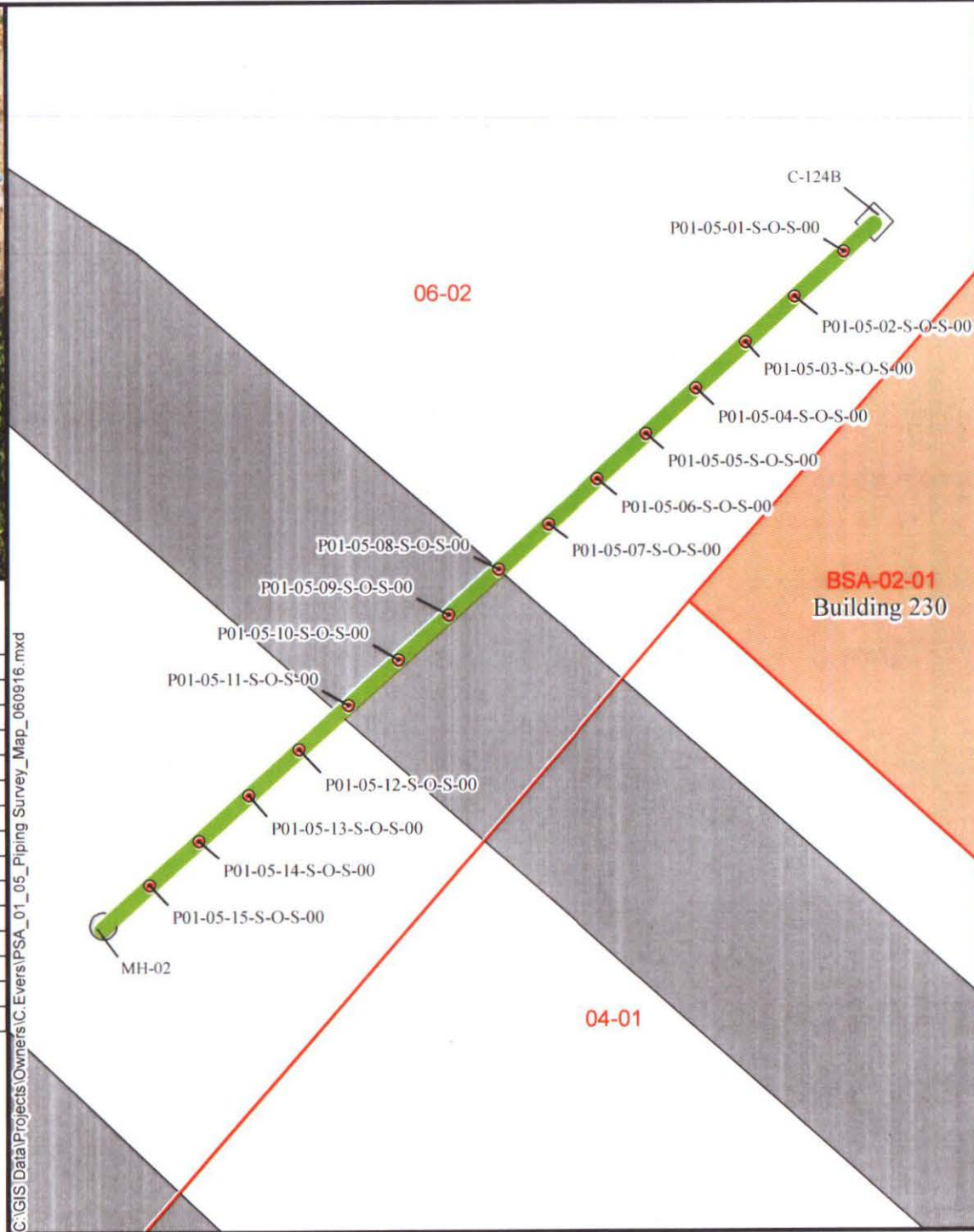

- LEGEND:**
- STM - 5 Pipe Samples
  - STM - 5
  - LSA Boundaries
  - Manhole
  - Building
  - Driveway

Survey Log #  
7456 C160608

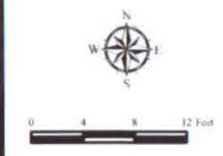

Requested By C. Evers	Document Reason HDP-ENG13-WP-009		
PSA-01-05 Piping Figure			
Hematite Decommissioning Project Jefferson County Hematite, MO			
Prepared By SDJ	Rev 0	Size 11x17	Date 12-03-15