

Hematite Decommissioning Project	Procedure: HDP-PR-FSS-712, Final Status Surveys of Structures, Systems, and Components (SSCs)		
	Revision: 5	Page A-1 of 2	

**APPENDIX A-1
FINAL STATUS SURVEY RESULTS**

Survey Unit Description & Survey Unit Number:	STM-2 / PSA 01-02	Survey Log Number:	6980C160204	Date:	2/4/2016
Technician(s): Print/Sign/Date	J. Michel / <i>Mote</i> 2/4/16	Reviewed by: Print/Sign/Date	J. Bushman / <i>genc</i> 2/4/16	Time:	16:30
Instrument # 1		Instrument # 2			Tennelec
Instrument & Probe:	Lud 2360/43-68	MDA (dpm/100cm ²):	495.0	Instrument & Probe:	N/A
Instrument SN:	248144	Bkg 1:	150	Instrument SN:	N/A
Cal Due Date:	10/2/2016	Bkg 2:	160	Cal Due Date:	N/A
Probe Size:	125	Bkg 3:	158	Probe Size:	N/A
Weighted Eff.:	9.5%	Ave. Bkg:	156	Weighted Eff.:	N/A
Unit #:	N/A	Alpha Bkg:	N/A	Alpha MDA (dpm):	N/A
Cal Due:	N/A	Beta Bkg:	N/A	Beta MDA (dpm):	N/A
Alpha Eff.:	N/A	Beta Eff.:	N/A	Batch No.:	N/A

Comments: Systematic FSS scan of STM-2. Pipe first surveyed from MH 25 towards MH 06. Then survey from MH 25 to MH 09. Instrument sled pulled via braided steel cable at 1-2" per second. Static measurements taken at all points by allowing instrument to set in place for two minutes ensuring proper count. See map page 2 for systematic locations.

Sample No.	Instrument Number (i.e., 1 or 2)	Description	Removable Alpha		Removable Beta		Total Contamination (α + β)		DCGL Fraction
			Net CPM	DPM / 100cm ²	Net CPM	DPM / 100cm ²	Gross CPM	DPM / 100cm ²	
1	1	P01-02-06-S-O-S-00	N/A	N/A	N/A	N/A	180	203	0.01
2	1	P01-02-05-S-O-S-00	N/A	N/A	N/A	N/A	143	0	0.00
3	1	Biased Reading #1 - Taken at seam 74'	N/A	N/A	N/A	N/A	157	8	0.00
4	1	P01-02-04-S-O-S-00	N/A	N/A	N/A	N/A	99	0	0.00
5	1	Biased reading #2 - Bottom of MH 06 66'	N/A	N/A	N/A	N/A	117	0	0.00
6	1	P01-02-07-S-O-S-00	N/A	N/A	N/A	N/A	74	0	0.00
7	1	Biased reading #3 - Taken at seam 127'	N/A	N/A	N/A	N/A	72	0	0.00
8	1	P01-02-08-S-O-S-00	N/A	N/A	N/A	N/A	82	0	0.00
9	1	Biased Reading #4 - Taken at seam 145'	N/A	N/A	N/A	N/A	108	0	0.00
N/A	N/A	N/A	N/A	N/A	N/A	N/A	N/A	N/A	N/A
N/A	N/A	N/A	N/A	N/A	N/A	N/A	N/A	N/A	N/A
N/A	N/A	N/A	N/A	N/A	N/A	N/A	N/A	N/A	N/A
N/A	N/A	N/A	N/A	N/A	N/A	N/A	N/A	N/A	N/A
N/A	N/A	N/A	N/A	N/A	N/A	N/A	N/A	N/A	N/A
N/A	N/A	N/A	N/A	N/A	N/A	N/A	N/A	N/A	N/A
N/A	N/A	N/A	N/A	N/A	N/A	N/A	N/A	N/A	N/A
N/A	N/A	N/A	N/A	N/A	N/A	N/A	N/A	N/A	N/A
N/A	N/A	N/A	N/A	N/A	N/A	N/A	N/A	N/A	N/A
N/A	N/A	N/A	N/A	N/A	N/A	N/A	N/A	N/A	N/A
N/A	N/A	N/A	N/A	N/A	N/A	N/A	N/A	N/A	N/A
N/A	N/A	N/A	N/A	N/A	N/A	N/A	N/A	N/A	N/A
N/A	N/A	N/A	N/A	N/A	N/A	N/A	N/A	N/A	N/A
N/A	N/A	N/A	N/A	N/A	N/A	N/A	N/A	N/A	N/A
N/A	N/A	N/A	N/A	N/A	N/A	N/A	N/A	N/A	N/A
N/A	N/A	N/A	N/A	N/A	N/A	N/A	N/A	N/A	N/A
N/A	N/A	N/A	N/A	N/A	N/A	N/A	N/A	N/A	N/A



Survey Unit	Sample ID	Distance from Southwest end of pipe
PSA-01-02	P01-02-01-S-O-S-00	11 ft.
PSA-01-02	P01-02-02-S-O-S-00	29 ft.
PSA-01-02	P01-02-03-S-O-S-00	47 ft.
PSA-01-02	P01-02-04-S-O-S-00	65 ft.
PSA-01-02	P01-02-05-S-O-S-00	83 ft.
PSA-01-02	P01-02-06-S-O-S-00	101 ft.
PSA-01-02	P01-02-07-S-O-S-00	119 ft.
PSA-01-02	P01-02-08-S-O-S-00	137 ft.
PSA-01-02	P01-02-09-S-O-S-00	155 ft.
PSA-01-02	P01-02-10-S-O-S-00	173 ft.
PSA-01-02	P01-02-11-S-O-S-00	191 ft.
PSA-01-02	P01-02-12-S-O-S-00	209 ft.
PSA-01-02	P01-02-13-S-O-S-00	227 ft.
PSA-01-02	P01-02-14-S-O-S-00	245 ft.
PSA-01-02	P01-02-15-S-O-S-00	263 ft.

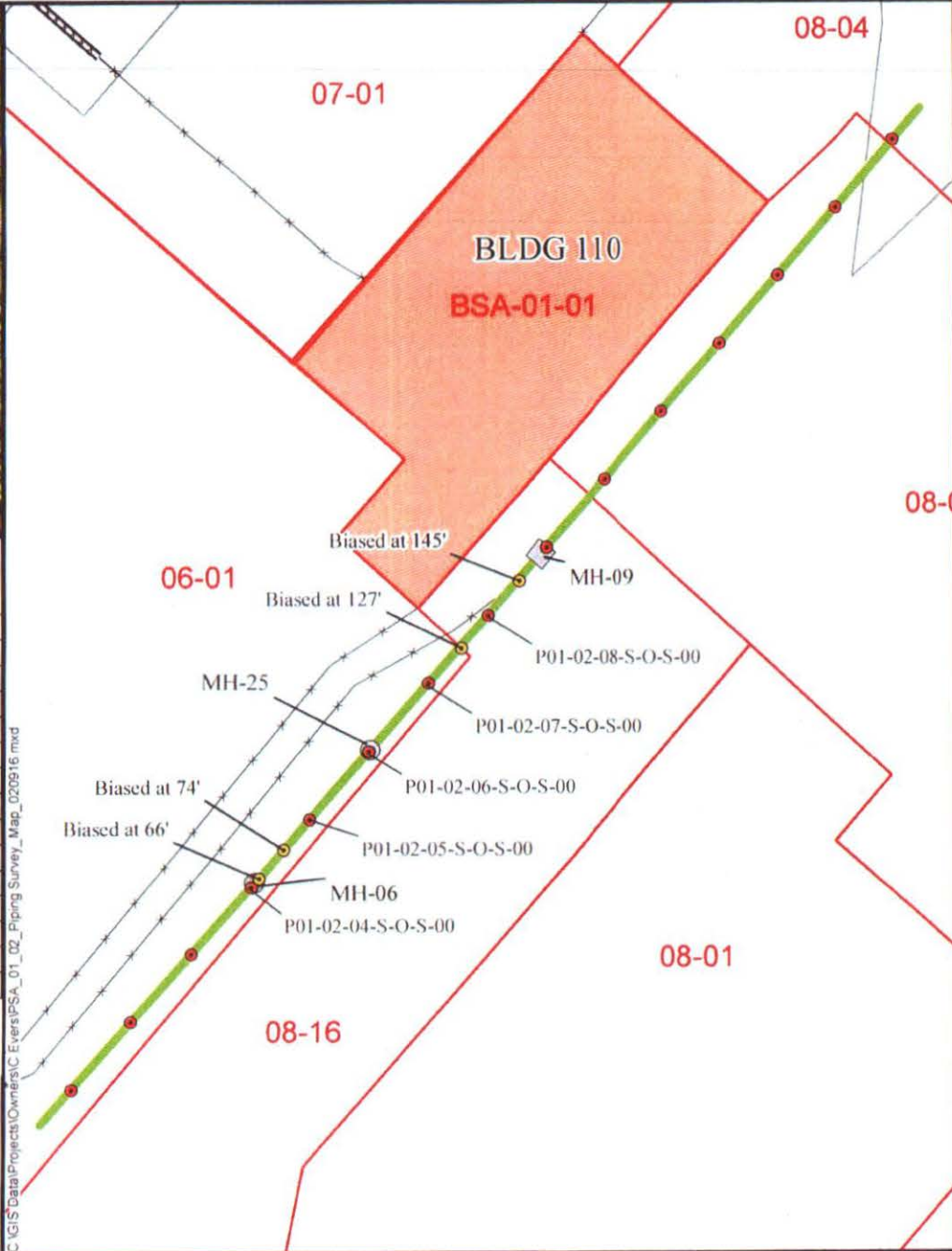

- LEGEND:**
- Biased Reading
 - Sample Location
 - PSA 01-02
 - LSA Boundaries
 - Manholes
 - Building
 - Haul Road
 - Fence

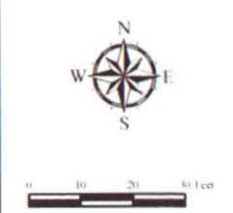

Requested By Michel	Document/Reason HDD-ENGL-WF-009
PSA-01-02 Piping Survey Survey # 6980-C-160204	
Hematite Decommissioning Project Jefferson County Hematite, MO	
Prepared By NDJ	Rev 0 Size 8.5X11 Date 03/02/16

C:\GIS Data\Projects\Owners\VC Evers\PSA_01_02_Piping Survey_Map_020916.mxd