



Mercy Hospital Jefferson
Administration
P.O. Box 350
Crystal City, MO 63019
phone 636-933-1000
fax 636-933-1119
mercy.net

June 14, 2017

RAML: 24-18315-01

Materials Licensing Branch
U.S. Nuclear Regulatory Commission Region III
2443 Warrenville Road, Suite 210
Lisle, IL 60532-4352

To whom it may concern:

This is a request for an expedited review as related to the removal of restrictions for the former office location: hot lab, imaging room, and stress lab areas of the nuclear cardiology operation of **Mercy Hospital Jefferson, in Crystal City, Missouri**. As related to our correspondence from January, relocation of the outpatient cardiology office at 1390 Hwy 61 South, Suite 3300, Festus, MO is complete. All RAM operations have been moved to the new department on the ground floor of the main hospital at Hwy 61 South, Crystal City, MO under the same RAM license. The licensee requests release of the old outpatient office for unrestricted use as soon as possible so new occupancy and property renovation may commence. Requested license changes are noted in item 5.

The following is submitted for your review:

1. All radioactive materials have been moved to the new office hot lab. All diagnostic use of radioactive materials was terminated on June 6, 2017.
2. Tc-99m was the primary nuclide used in the former nuclear cardiology department.
3. Enclosed please find the results of the area surveys and wipe testing that were conducted in the former nuclear cardiology department after all radioactive sources had been removed. No residual activity or contamination was found. Close-out surveys and wipe testing were performed on June 7, 2017 by our consultant. All results were at background levels. Enclosed you will find the area surveys and area wipe test results for your review in attachments A and B. Also, enclosed is a floor plan diagram of the former office indicating where area surveys and wipe testing were conducted, attachment C. The former department consisted of an imaging room, hot lab, injection area and stress lab.
4. 2 sealed calibration sources and 1 exempt quantity rod source were moved to the new department by the nuclear medicine technologist on June 6, 2017. Sealed sources were leaked tested prior to the move on May 17, 2017, and certificate copies are enclosed as attachments D and E. The last RAM waste bin was moved to the new department by the nuclear medicine technologist on June 6, 2017.

5. Please **remove** the old address under the license condition 10B:
1390 Hwy 61 South, Suite 3300, Festus, MO

U.S. Nuclear Regulatory Commission
Region III
Materials Licensing Section

Page 2

It is understood that all restrictions will remain in place at the vacated location until the area is released for unrestricted use by your office.

If you have any questions concerning this matter, please contact our office, or call our physicist consultant, Tom Schlarman, at 618/210-3925. Thank you.

Sincerely,



Daniel Eckenfels
VP of Finance

CC:

Enclosures: Attachment A close out surveys
Attachment B close out wipe testing
Attachment C closeout diagram
Attachment D leak test cert.
Attachment E leak test cert.
NRC form 313

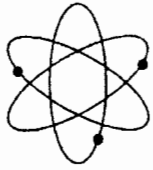

Radiation Protection Services, Ltd.
Serving Radiology, Nuclear Medicine, Therapy and Industry

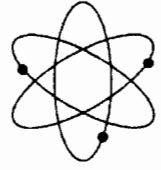

1405 Stevenson Dr., Suite 11
Springfield, Illinois 62703

Phone: (217) 786-3839
Fax: (217) 786-3110

Attachment A

Mercy Hospital Jefferson-Outpatient Cardiology
1390 Highway 61 South, Suite 3300
Festus, MO 63028
Close-out Area Surveys

Date: June 7, 2017

Survey Meter: Ludlum 14C
Probe: Pancake 44-9

Serial Number: 260774

Check Source Reading: 1.0mr/hr

Calibrated: September 23, 2016

Area #	Description	Survey Results (mr/hr)
1	Hot lab counter-right	0.03
2	Hot lab counter-left	0.03
3	Hot lab floor	0.03
4	Camera controls area	0.03
5	Imaging table area	0.03
6	Injection/Prep area	0.03
7	Workstation area	0.03
8	RAM receiving area	0.03
9	RAM waste storage	0.03
10	Treadmill	0.03
11	Stress lab floor	0.03
12	Background	0.03

X All areas \leq background levels (N/A=not applicable)

X No contamination found

Performed by:

Thomas Schlarman
Radiation Physicist

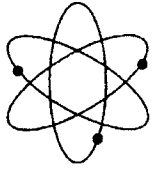

Radiation Protection Services, Ltd.
Serving Radiology, Nuclear Medicine, Therapy and Industry

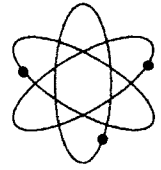

1405 Stevenson Dr., Suite 11
Springfield, Illinois 62703

Phone: (217) 786-3839
Fax: (217) 786-3110

Attachment B

Mercy Hospital Jefferson-Outpatient Cardiology
1390 Highway 61 South, Suite 3300
Festus, MO 63028

Close-out Area Wipe Analysis Report for removable contamination

Date: June 9, 2017

Well counter: Capintec Model Caprac

Serial Number: 000736

Calibration date: November 8, 2016

Efficiency: 80.0%

Area #	Description	Wipe results (cpm)	Net cpm	Net dpm
1	Hot lab counter-right		0	0
2	Hot lab counter-left		-1	0
3	Hot lab floor		-21	0
4	Camera controls area		-12	0
5	Imaging table area		-6	0
6	Injection/Prep area		-12	0
7	Workstation area		-5	0
8	RAM receiving area		18	22
9	RAM waste storage		3	4
10	Treadmill		-18	0
11	Stress lab floor		6	8
12	Background	213		
	System Test: Cs137 check=2.1%dev			

All areas \leq 200dpm

No contamination found

Samples collected by: Thomas Schlarman on June 7, 2017

Analyzed by: Thomas Schlarman
Radiation Physicist

Attachment C
Mercy Hospital Jefferson-Cardiology
1390 Hwy 61 South, Suite 3300
Festus, MO

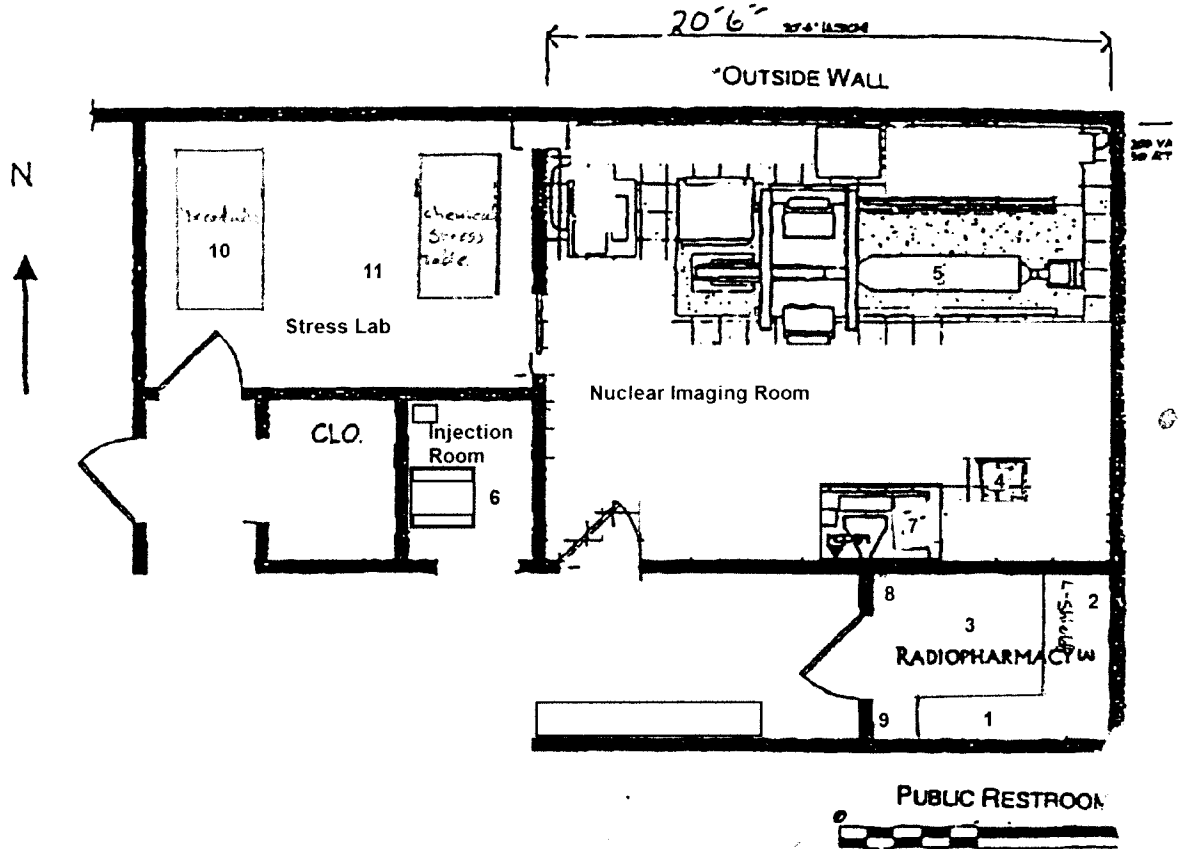

Locations of surveys and wipes:
 (Daily/weekly)

Stress Room Nuclear (includes treadmill, chemical stress table in stress room) and injection chair in corridor.

Hot Lab radiopharmaceutical prep area (behind L-shield)

Radiopharmacy counter and around dose calibrator.

Radiopharmacy floor (area of radiopharmacy cases on floor)

Camera Acquisition Terminal and work desk in imaging room

Camera (patient imaging table)

Waste bin in hot lab.



Radiation Protection Services, Ltd

Serving Radiology, Nuclear Medicine, Therapy and Industry



1401 Stevenson Drive-Suite 11
Springfield, Illinois 62703

Phone: (312) 786-1139
Fax: (312) 786-5131

SEALED SOURCE WIPE/LEAK TEST

Facility: Mercy Hospital - Jefferson-Cardiology NRC License #: 24-18815-01
 Address: Festus, MO State License #: _____
 Date Performed: 05/17/17 By: Thomas Schlarman, Rad. Physicist
 Date Analyzed: 05/17/17 By: Thomas Schlarman, Rad. Physicist

SOURCE INFORMATION			
Nuclide:	Co-57	Activity:	10.0 mCi
Manufacturer:	EZIP	Model #:	MED-3727
Serial #:	1814-093	Assay Date:	08/01/2015
Location:	Hot Lab	Holder:	Flood

Test Data: Background CPM* 208

Sample #	Sample Location	Net CPM	DPM **	Result: uCi ***	Comments
1	Source Front	10	12	M	
2	Source Back	-2	-0-	M	
Standard Used:	Cs-137 68.7nCi	Measured:	68.7nCi		

CONCLUSION:

N	Results of these tests <u>do not indicate the presence</u> of reportable removable radioactivity (less than 0.005 uCi).
	Results of these tests <u>indicate the presence</u> of reportable removable radioactivity (greater than 0.005 uCi). See attached recommendations.

NEXT WIPE/LEAK TEST DUE: **November 30, 2017**

* Counts per minute
 ** Disintegrations per minute
 *** M = < 0.005 microcuries

Reviewed By: Thomas Schlarman, Rad. Physicist

Facility R.S.O.:

James A. [Signature], M.D.

Test performed under License # IL-D1799-01

FORM-RS-1 Rev. 01/10/14 1/10



Radiation Protection Service

Serving Radiology, Nuclear Medicine, Therapy and Industry



1405 Stevenson Drive-Gate 11
Springfield, Illinois 62703

Phone: (217) 786-1877
Fax: (217) 786-3110

SEALED SOURCE WIPE/LEAK TEST

Facility: Mercy Hospital - Jefferson -Cardiology NRC License #: 24-18815-01
 Address: Festus, MO State License #: _____
 Date Performed: 05/17/17 By: Thomas Schlarman, Rad. Physicist
 Date Analyzed: 05/19/17 By: Thomas Schlarman, Rad. Physicist

SOURCE INFORMATION			
Nuclide:	Cs-137	Activity:	207 uCi
Manufacturer:	DuPont		
Model #:	NES 356	Serial #:	S356043-030
Assay Date:	05/27/2000		
Location:	Hot Lab	Holder:	Vial

Test Data: Background CPM* 208

Sample #	Sample Location	Net CPM	DPM **	Results uCi ***	Comment:
1	Source Exterior	-1	-0-	M	
2					
Standard Used:	Cs-137 68.7nCi		Measured:	68.7nCi	

CONCLUSION:

X	Results of these tests <u>do not indicate the presence</u> of reportable removable radioactivity (less than 0.005 uCi).		
	Results of these tests <u>indicate the presence</u> of reportable removable radioactivity (greater than 0.005 uCi). See attached recommendations.		
<table border="1" style="width: 100%; border-collapse: collapse;"> <tr> <td style="width: 40%;">NEXT WIPE/LEAK TEST DUE:</td> <td style="text-align: center;">November 30, 2017</td> </tr> </table>		NEXT WIPE/LEAK TEST DUE:	November 30, 2017
NEXT WIPE/LEAK TEST DUE:	November 30, 2017		

- * Counts per minute
 ** Disintegrations per minute
 *** M = < 0.005 microcuries

Reviewed By: Tom Schlarman
 Radiation Physicist

Facility R.S.O.: James A. Jenkins, M.D.

Test performed under License # IL-01799-01

CPM-888 LEAK WIP/LEAK 4-96



APPLICATION FOR MATERIALS LICENSE

Estimated burden per response to comply with this mandatory collection request: 4.3 hours. Submittal of the application is necessary to determine that the applicant is qualified and that adequate procedures exist to protect the public health and safety. Send comments regarding burden estimate to the FOIA, Privacy, and Information Collections Branch (T-5 F53), U.S. Nuclear Regulatory Commission, Washington, DC 20555-0001, or by e-mail to Infocollections.Resource@nrc.gov, and to the Desk Officer, Office of Information and Regulatory Affairs, NEOB-10202, (3150-0120), Office of Management and Budget, Washington, DC 20503. If a means used to impose an information collection does not display a currently valid OMB control number, the NRC may not conduct or sponsor and a person is not required to respond to, the information collection.

INSTRUCTIONS: SEE THE CURRENT VOLUMES OF THE NUREG-1556 TECHNICAL REPORT SERIES ("CONSOLIDATED GUIDANCE ABOUT MATERIALS LICENSES") FOR DETAILED INSTRUCTIONS FOR COMPLETING THIS FORM: <http://www.nrc.gov/reading-rm/doc-collections/nuregs/staff/ser1556/>. SEND TWO COPIES OF THE COMPLETED APPLICATION TO THE NRC OFFICE SPECIFIED BELOW.

APPLICATION FOR DISTRIBUTION OF EXEMPT PRODUCTS FILE APPLICATIONS WITH:

MATERIALS SAFETY LICENSING BRANCH
DIVISION OF MATERIAL SAFETY, STATE, TRIBAL AND RULEMAKING PROGRAMS
OFFICE OF NUCLEAR MATERIALS SAFETY AND SAFEGUARDS
U.S. NUCLEAR REGULATORY COMMISSION
WASHINGTON, DC 20555-0001

ALL OTHER PERSONS FILE APPLICATIONS AS FOLLOWS:

IF YOU ARE LOCATED IN:

ALABAMA, CONNECTICUT, DELAWARE, DISTRICT OF COLUMBIA, FLORIDA, GEORGIA, KENTUCKY, MAINE, MARYLAND, MASSACHUSETTS, NEW HAMPSHIRE, NEW JERSEY, NEW YORK, NORTH CAROLINA, PENNSYLVANIA, PUERTO RICO, RHODE ISLAND, SOUTH CAROLINA, TENNESSEE, VERMONT, VIRGINIA, VIRGIN ISLANDS, OR WEST VIRGINIA,

SEND APPLICATIONS TO:

LICENSING ASSISTANCE TEAM
DIVISION OF NUCLEAR MATERIALS SAFETY
U.S. NUCLEAR REGULATORY COMMISSION REGION I
2100 RENAISSANCE BOULEVARD, SUITE 100
KING OF PRUSSIA, PA 19406-2713

IF YOU ARE LOCATED IN:

ILLINOIS, INDIANA, IOWA, MICHIGAN, MINNESOTA, MISSOURI, OHIO, OR WISCONSIN. SEND APPLICATIONS TO:

MATERIALS LICENSING BRANCH
U.S. NUCLEAR REGULATORY COMMISSION, REGION III
2443 WARRENVILLE ROAD SUITE 210
LISLE, IL 60532-4352

ALASKA, ARIZONA, ARKANSAS, CALIFORNIA, COLORADO, HAWAII, IDAHO, KANSAS, LOUISIANA, MISSISSIPPI, MONTANA, NEBRASKA, NEVADA, NEW MEXICO, NORTH DAKOTA, OKLAHOMA, OREGON, PACIFIC TRUST TERRITORIES, SOUTH DAKOTA, TEXAS, UTAH, WASHINGTON, OR WYOMING.

SEND APPLICATIONS TO:

NUCLEAR MATERIALS LICENSING BRANCH
U.S. NUCLEAR REGULATORY COMMISSION, REGION IV
1600 E. LAMAR BOULEVARD
ARLINGTON TX 76011-4511

PERSONS LOCATED IN AGREEMENT STATES SEND APPLICATIONS TO THE U.S. NUCLEAR REGULATORY COMMISSION ONLY IF THEY WISH TO POSSESS AND USE LICENSED MATERIAL IN STATES SUBJECT TO U.S. NUCLEAR REGULATORY COMMISSION JURISDICTIONS.

1 THIS IS AN APPLICATION FOR (Check appropriate item)

- A. NEW LICENSE
- B. AMENDMENT TO LICENSE NUMBER 24-18315-01
- C. RENEWAL OF LICENSE NUMBER _____

2. NAME AND MAILING ADDRESS OF APPLICANT (Include ZIP code)

Mercy Hospital Jefferson
P.O. Box 350
Crystal City, MO 63019

3. ADDRESS WHERE LICENSED MATERIAL WILL BE USED OR POSSESSED

Same as item 2

4. NAME OF PERSON TO BE CONTACTED ABOUT THIS APPLICATION

Thomas Schlarman

BUSINESS TELEPHONE NUMBER

6182103915

BUSINESS CELLULAR TELEPHONE NUMBER

6182103925

BUSINESS EMAIL ADDRESS

tschlar@mchsi.com

SUBMIT ITEMS 5 THROUGH 11 ON 8-1/2 X 11" PAPER. THE TYPE AND SCOPE OF INFORMATION TO BE PROVIDED IS DESCRIBED IN THE LICENSE APPLICATION GUIDE.

5. RADIOACTIVE MATERIAL

a. Element and mass number; b. chemical and/or physical form; and c. maximum amount which will be possessed at any one time

6. PURPOSE(S) FOR WHICH LICENSED MATERIAL WILL BE USED.

7. INDIVIDUAL(S) RESPONSIBLE FOR RADIATION SAFETY PROGRAM AND THEIR TRAINING AND EXPERIENCE.

8. TRAINING FOR INDIVIDUALS WORKING IN OR FREQUENTING RESTRICTED AREAS.

9. FACILITIES AND EQUIPMENT.

10. RADIATION SAFETY PROGRAM.

11. WASTE MANAGEMENT.

12. LICENSE FEES (Fees required only for new applications, with few exceptions*)

(See 10 CFR 170 and Section 170.31)

*Amendments/Renewals that increase the scope of the existing license to a new or higher fee category will require a fee.

FEE CATEGORY	7C	AMOUNT ENCLOSED \$	0
--------------	----	--------------------	---

13. CERTIFICATION. (Must be completed by applicant) THE APPLICANT UNDERSTANDS THAT ALL STATEMENTS AND REPRESENTATIONS MADE IN THIS APPLICATION ARE BINDING UPON THE APPLICANT

THE APPLICANT AND ANY OFFICIAL EXECUTING THIS CERTIFICATION ON BEHALF OF THE APPLICANT, NAMED IN ITEM 2, CERTIFY THAT THIS APPLICATION IS PREPARED IN CONFORMITY WITH TITLE 10, CODE OF FEDERAL REGULATIONS, PARTS 30, 32, 33, 34, 35, 36, 37, 39 AND 40, AND THAT ALL INFORMATION CONTAINED HEREIN IS TRUE AND CORRECT TO THE BEST OF THEIR KNOWLEDGE AND BELIEF.
WARNING 18 U.S.C. SECTION 1001 ACT OF JUNE 25, 1948 82 STAT 749 MAKES IT A CRIMINAL OFFENSE TO MAKE A WILLFULLY FALSE STATEMENT OR REPRESENTATION TO ANY DEPARTMENT OR AGENCY OF THE UNITED STATES AS TO ANY MATTER WITHIN ITS JURISDICTION.

CERTIFYING OFFICER - TYPED/PRINTED NAME AND TITLE

DANIEL ECKENFELS VP-FINANCE

SIGNATURE

DATE

6-12-17

FOR NRC USE ONLY

TYPE OF FEE	FEE LOG	FEE CATEGORY	AMOUNT RECEIVED	CHECK NUMBER	COMMENTS
			\$		
APPROVED BY				DATE	



Mercy†

Mercy Hospital Jefferson
P.O. Box 350
Crystal City, MO 63019

Materials Licensing Branch
U.S. Nuclear Regulatory Commission Region 3
2443 Warrenville Rd, Ste 210
Lisle, IL 60532-4352

RECEIVED JUN 19 2017

