

7208

7182 X

7150

7128

7100

Draw

11

7114

7100

074

14

7100

7050

BM
7035

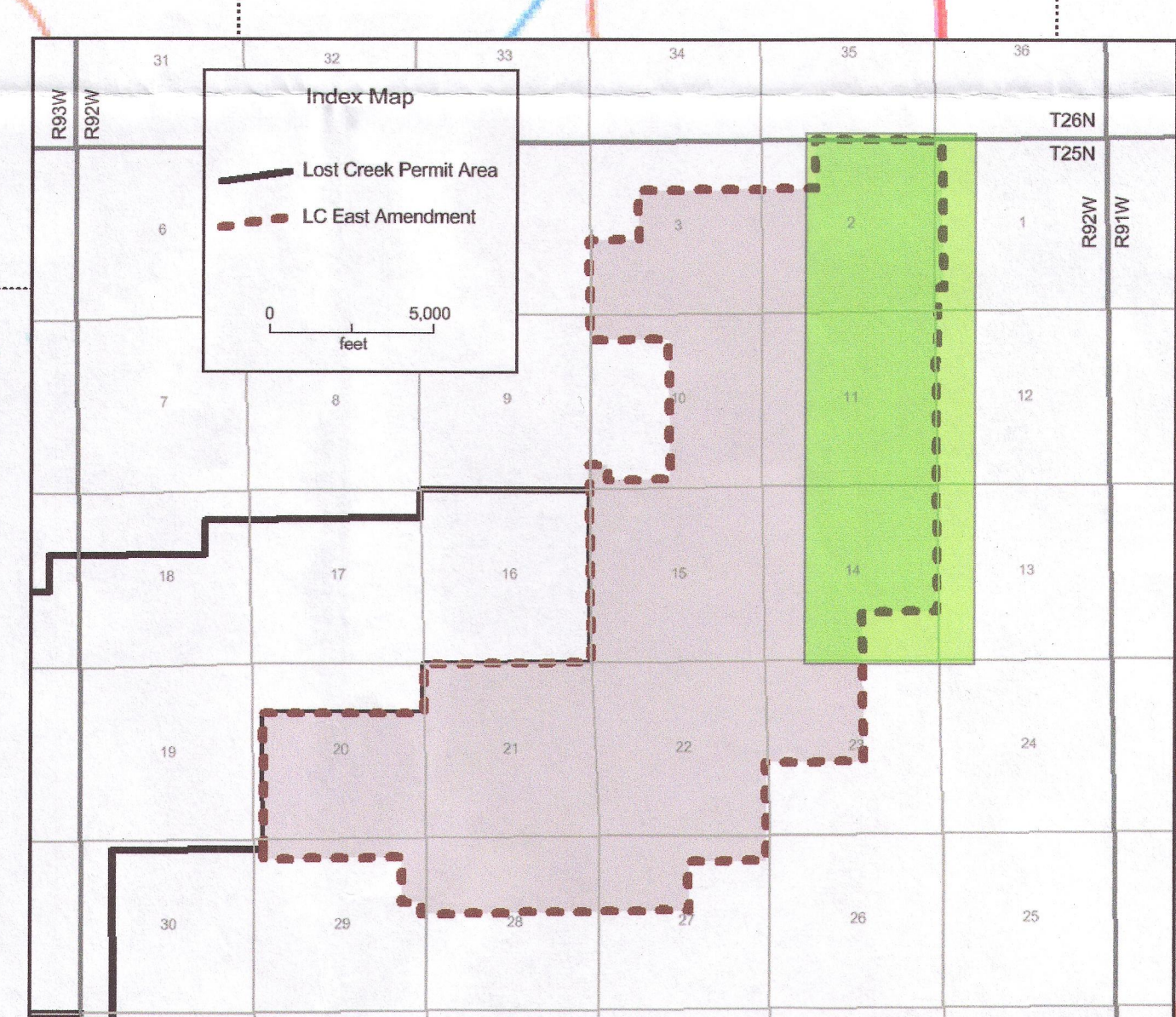

Lost Creek ISR, LLC
Casper, Wyoming, USA

Legend

- LC East Amendment
- Drill Hole ID
- Main Access Road

Plate Attachment OP-1c
Location Map of Historical Drill Holes -
Northeast
LC East Amendment
Issued For: WEEO-LOG
Issued/Revised: Original
Drawn By: mmf

