

07-251-91

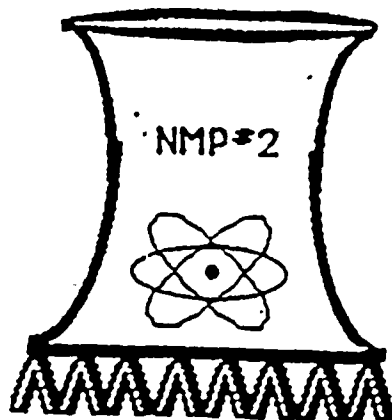

# OPERATIONS DEPARTMENT INSTRUCTION

N2-ODI-3.02  
Rev 2

(TCN-1 and Publication Change, \*1)

## CONTROL ROOM CONDUCT

Approved: [Signature]  
**FOR INFORMATION ONLY**

### 1.0 POLICY

Safe and efficient operation depends on a proper functioning Control Room. Activities that impede our operation are prohibited.

### 2.0 IMPLEMENTATION

In keeping with the above policy, the following rules are to be followed and enforced by Operations Department personnel.

### 3.0 RULES

- Control Room entry beyond the mark-up desk by CSO, SSS or ASSS authorization.
- Control Room shall be kept clean and businesslike.
- Unnecessary personnel are not permitted in the Control Room.
- Noise levels shall be kept to a minimum.
- No hard hats at Control Room front panels.
- No coffee or drinks at Control Room front panels.
- CSO permission must be obtained for any Control Room activities.
- A licensed operator shall be "At the Controls" at all times.
- No procedures or other large loose objects shall be placed on the benchboard portions of Control Room front panels.

TCN. 1  
\* 1

9305040377 911031  
PDR ADDCK 05000410  
S PDR

N2-ODI-3.02 -1 July 1990

5/4/377 3pp



FOR INFORMATION ONLY

- The following guidelines apply to the performance of OSP's having significant plant impact, such as N2-OSP-EGS-R001.
  - 1) The duty SSS is always in charge. The Test Director shall set up the test, but the duty SSS takes command.
  - 2) Operations management should observe and support as requested. They shall not take control away from the duty SSS.
  - 3) The duty SSS shall define each participant's role.
  - 4) The control room shall be closed to all personnel not directly associated with the test.
  - 5) All other work in the control room shall be stopped.
  - 6) The duty SSS shall assign someone to answer the phones.
  - 7) Clear, concise communications shall be employed, especially use of repeatbacks. (N2-ODI-1.06).

10

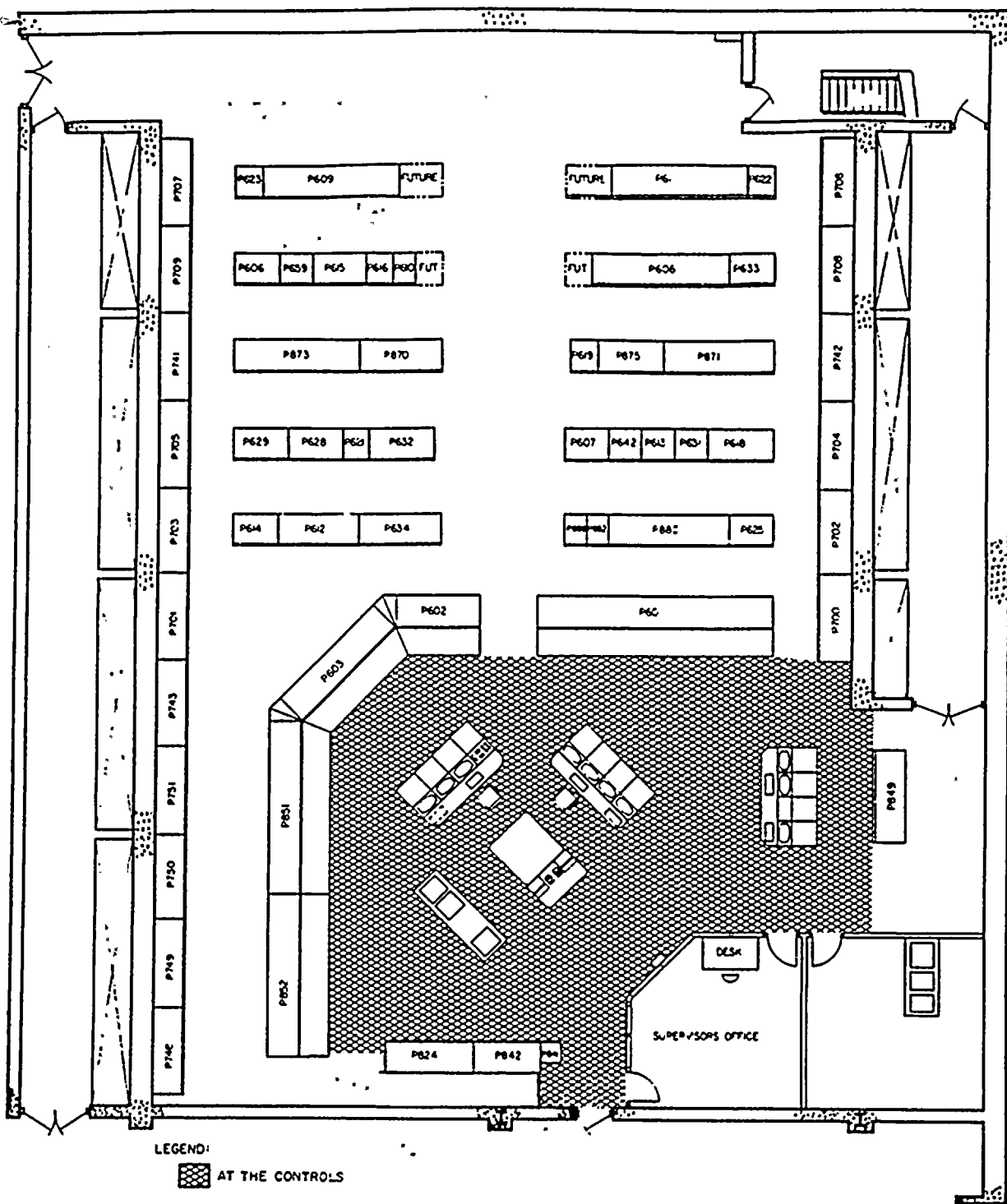

FIGURE 13.5-1

"AT THE CONTROLS"  
 MAIN CONTROL ROOM  
 EL. 306'-0"

NIAGARA MOHAWK POWER CORPORATION  
 NINE MILE POINT-UNIT 2  
 FINAL SAFETY ANALYSIS REPORT

100