



David Susser, D.O.
F.A.C.O.I
Mark A. Rasak, D.O.
F.A.C.C., F.A.C.O.I., F.S.C.A.I.

Daniel R. Harber, D.O.
F.A.C.C., F.A.C.O.I.
Majid Qazi, D.O.

Nenad Serafimovski, M.D.
R.P.V.I.
Michael Abdul-Malek, D.O.

November 10, 2016

United States Nuclear Regulatory Commission
Region III, Materials Licensing
2442 Warrenville Road, Suite 210
Lisle, IL 60532-4352

RE: **Terminate NRC License No. 21-26391-01**
Cardiovascular Clinical Associates, P.C.

Dear Sir/Madam:

We would like to permanently cease licensed activities at the entire site and terminate our current NRC license located at:

23801 W. Warren Ave.
Dearborn Heights, MI 48127

NRC form 314 and the results of the decommissioning (surveys, wipes, diagram, sealed source leak test, etc.) are enclosed for your review.

Thank you for your cooperation. If you have any questions or require additional information, please contact our medical physics consult, Cari Dzanbazoff at cdzanbazoff@mpcphysics.com or 734-662-3197.

Sincerely,

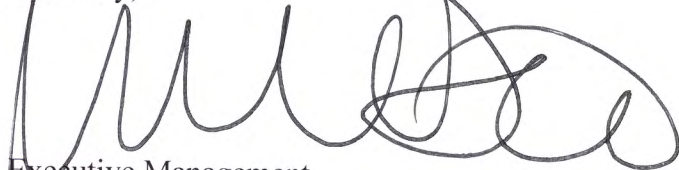

Executive Management

Mark Rasak, D.O.

Executive Management
Cardiovascular Clinical Associates, P.C.



RECEIVED NOV 15 2016



CERTIFICATE OF DISPOSITION OF MATERIALS

Estimated burden per response to comply with this mandatory collection request: 30 minutes. This submittal is used by NRC as part of the basis for its determination that the facility is released for unrestricted use. Send comments regarding burden estimate to the FOIA, Privacy, and Information Collections Branch (T-5 F53), U.S. Nuclear Regulatory Commission, Washington, DC 20555-0001, or by internet e-mail to Infocollects.Resource@nrc.gov, and to the Desk Officer, Office of Information and Regulatory Affairs, NEOB-10202, (3150-0028), Office of Management and Budget, Washington, DC 20503. If a means used to impose an information collection does not display a currently valid OMB control number, the NRC may not conduct or sponsor, and a person is not required to respond to, the information collection.

LICENSEE NAME AND ADDRESS
Cardiovascular Clinical Associates, P.C.
23801 W. Warren Ave
Dearborn Heights, MI 48127

LICENSE NUMBER: 21-26391-01
DOCKET NUMBER: 030-32696
LICENSE EXPIRATION DATE: December 21, 2022

A. LICENSE STATUS (Check the appropriate box)

- This license has expired. This license has not yet expired; please terminate it.

B. DISPOSAL OF RADIOACTIVE MATERIAL

(Check the appropriate boxes and complete as necessary. If additional space is needed, provide attachments)

The licensee, or any individual executing this certificate on behalf of the licensee, certifies that:

1. No radioactive materials have ever been procured or possessed by the licensee under this license.
 2. All activities authorized by this license have ceased, and all radioactive materials procured and/or possessed by the licensee under this license number cited above have been disposed of in the following manner:
 a. Transfer of radioactive materials to the licensee listed below:

- b. Disposal of radioactive materials:
 1. Directly by the licensee:

Low level radioactive waste was decayed in storage with proper disposal

2. By licensed disposal site:

3. By waste contractor:

All sealed sources were properly transferred to Bionomics, Inc. on 11/1/06

Address: 1550 Bear Creek Road, Oak Ridge, TN 37830 Phone: 865-220-8501 on 11/1/16 (Contact Denise Janssen)

- c. All radioactive materials have been removed such that any remaining residual radioactivity is within the limits of 10 CFR Part 20, Subpart E, and is ALARA.

C. SURVEYS PERFORMED AND REPORTED

1. A radiation survey was conducted by the licensee. The survey confirms:
 a. the absence of licensed radioactive materials
 b. that any remaining residual radioactivity is within the limits of 10 CFR 20, Subpart E, and is ALARA.
 2. A copy of the radiation survey results:
 a. is attached; or b. is not attached (Provide explanation); or c. was forwarded to NRC on: _____ Date
 3. A radiation survey is not required as only sealed sources were ever possessed under this license, and
 a. The results of the latest leak test are attached; and/or b. No leaking sources have ever been identified.

The person to be contacted regarding the information provided on this form:

NAME: Mark Rosak, DO TITLE: President TELEPHONE (Include Area Code): (248) 615-7300 E-MAIL ADDRESS: mrosak@heartarts.com

Mail all future correspondence regarding this license to:

28080 Grand River Ave., Suite 300 W., Farmington Hills, MI 48336

C. CERTIFYING OFFICIAL

I CERTIFY UNDER PENALTY OF PERJURY THAT THE FOREGOING IS TRUE AND CORRECT

PRINTED NAME AND TITLE: Allison Czarnik office manager SIGNATURE: Allison Czarnik DATE: 11/10/2016

WARNING: FALSE STATEMENTS IN THIS CERTIFICATE MAY BE SUBJECT TO CIVIL AND/OR CRIMINAL PENALTIES. NRC REGULATIONS REQUIRE THAT SUBMISSIONS TO THE NRC BE COMPLETE AND ACCURATE IN ALL MATERIAL RESPECT. 18 U.S.C. SECTION 1001 MAKES IT A CRIMINAL OFFENSE TO MAKE A WILLFULLY FALSE STATEMENT OR REPRESENTATION TO ANY DEPARTMENT OR AGENCY OF THE UNITED STATES AS TO ANY MATTER WITHIN ITS JURISDICTION.

Close-out Survey Information

Close-out Location:

CARDIOVASCULAR CLINICAL ASSOCIATES, P.C.
23801 W. Warren Ave.
Dearborn Heights, MI 48127

Date Performed: November 3, 2016

Performed By: Cari Dzanbazoff, Medical Physics Consultants Inc.

Comments: Radioactive sealed sources were picked up by Bionomics Inc. for disposal. Most current sealed source leak test is enclosed.

Instruments:

Wipes for contamination performed with the following well counter:

Manufacturer: Capintec
Model Number: Captus 3000
Serial Number: 900271
Efficiency Factor: 2.5 dpm/cpm

Area survey performed with the following survey meter:

Manufacturer: Ludlum
Type: GM
Model Number: Model 14 C
Serial Number: 210192
Probe Model: Side Window
Calibration Date: 2/26/16

Battery check acceptable: YES
Operational check acceptable: YES
Constancy check acceptable: YES
Check source value: 3.5 mR/hr

CLOSEOUT DIAGRAM

CARDIOVASCULAR CLINICAL ASSOCIATES, P.C.
 23801 W. Warren Ave.
 Dearborn Heights, MI 48127

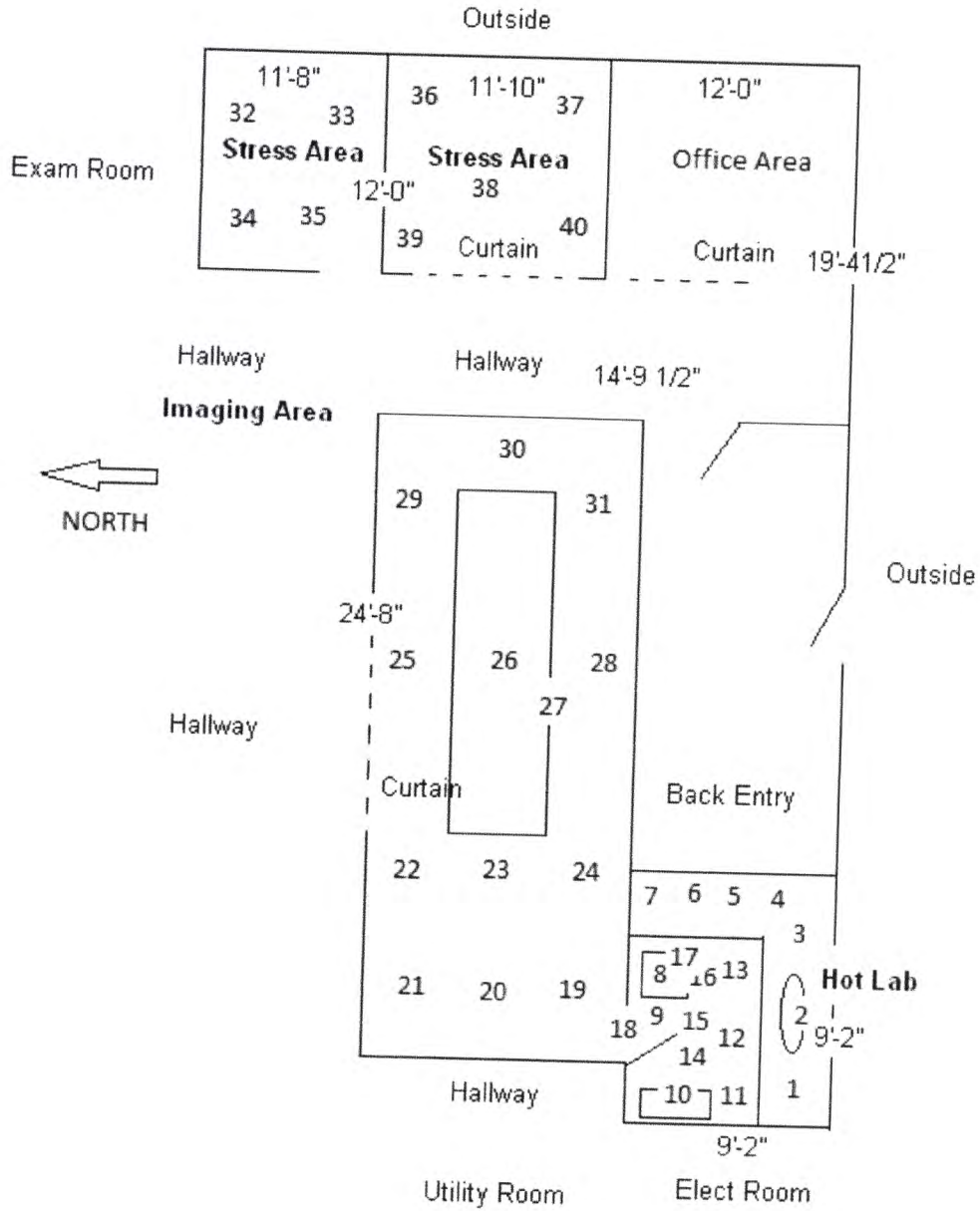

This is a single level facility – ground below, roof above

**CARDIOVASCULAR CLINICAL ASSOCIATES, P.C.
WIPE/SURVEY RESULTS - LICENSE # 21-26391-01**

Date: 11/3/2016 **Performed By:** Cari Dzanbazoff

Survey Meter: Ludlum 14C **Well Counter:** Capintec
Serial Number: 210192 **Model:** Captus 3000
Calibration Date: 2/26/2016 **Serial Number:** 900271

| | | cpm | net dpm | mR/h |
|-------|-----------------|-----|---------|------|
| 1 | Counter Top | 562 | 155.0 | 0.02 |
| 2 | Sink | 562 | 155.0 | 0.02 |
| 3 | Counter Top | 562 | 155.0 | 0.02 |
| 4 | Counter Top | 497 | 0 | 0.02 |
| 5 | Counter Top | 497 | 0 | 0.02 |
| 6 | Counter Top | 497 | 0 | 0.02 |
| 7 | Waste Container | 505 | 12.5 | 0.02 |
| 8 | Injection Chair | 505 | 12.5 | 0.02 |
| 9 | Floor | 505 | 12.5 | 0.02 |
| 10 | Waste Container | 516 | 40.0 | 0.02 |
| 11 | Floor | 516 | 40.0 | 0.02 |
| 12 | Floor | 516 | 40.0 | 0.02 |
| 13 | Floor | 490 | 0 | 0.02 |
| 14 | Floor | 490 | 0 | 0.02 |
| 15 | Floor | 490 | 0 | 0.02 |
| 16 | Floor | 558 | 145.0 | 0.02 |
| 17 | Floor | 558 | 145.0 | 0.02 |
| 18 | Floor | 558 | 145.0 | 0.02 |
| 19 | Floor | 527 | 67.5 | 0.02 |
| 20 | Floor | 527 | 67.5 | 0.02 |
| 21 | Floor | 527 | 67.5 | 0.02 |
| 22 | Floor | 490 | 0 | 0.02 |
| 23 | Floor | 490 | 0 | 0.02 |
| 24 | Floor | 490 | 0 | 0.02 |
| 25 | Floor | 475 | 0 | 0.02 |
| 26 | Camera | 475 | 0 | 0.02 |
| 27 | Floor | 475 | 0 | 0.02 |
| 28 | Floor | 493 | 0 | 0.02 |
| 29 | Floor | 493 | 0 | 0.02 |
| 30 | Floor | 493 | 0 | 0.02 |
| 31 | Floor | 541 | 102.5 | 0.02 |
| 32 | Floor | 541 | 102.5 | 0.02 |
| 33 | Floor | 541 | 102.5 | 0.02 |
| 34-36 | Floor | 521 | 52.5 | 0.02 |
| 36-40 | Floor | 569 | 172.5 | 0.02 |
| | background | 500 | | 0.02 |

ACTION LEVELS: 1000 dpm/100 cm sq Efficiency Factor = 2.5 dpm/cpm
 Full Spectrum

COMMENTS: No evidence of removable contamination.



Sealed Source Leak Test

Licensee: Cardiovascular Clinical Associates-Dearborn Hgts. Date: 08/02/16

Performed by: Cari Dzanbazoff

| Nuclide | Type | Calibration | | Location | M/N | S/N |
|---------|-------|-----------------------------|----------|----------|----------|--------------|
| | | Activity | Date | | | |
| Cs-137 | Vial | 206.9 uCi | 05/01/05 | Hot Lab | IPL | 1111-60-12 |
| | | Current Activity: 159.5 uCi | | | | |
| Ba-133 | Vial | 277.9 uCi | 06/01/05 | Hot Lab | IPL | 1111-59-10 |
| | | Current Activity: 133.1 uCi | | | | |
| Co-57 | Flood | 10 mCi | 05/01/13 | Hot Lab | MED3709 | 1666-112 |
| | | Current Activity: 0.478 mCi | | | | |
| Cs-137 | Vial | 213 uCi | 05/27/87 | Hot Lab | NES-356 | S356002-39 |
| | | Current Activity: 108.5 uCi | | | | |
| Ba-133 | Vial | 289 uCi | 07/13/90 | Hot Lab | 130/134 | Ba-133-EGAG0 |
| | | Current Activity: 51.93 uCi | | | | |
| Co-57 | Flood | 10 mCi | 06/10/16 | Hot Lab | BM01L-10 | 16132102 |
| | | Current Activity: 8.732 mCi | | | | |

Comment: The sources listed above were leak tested using a dry wipe technique and were found to have less than 0.005 uCi removable activity. The following Minimum Detectable Activities are based upon a background at the indicated value. Background was at or below these levels when the above tests were completed.

Well Counter: Captus 3000

| <u>Nuclide</u> | <u>MDA</u> | <u>Background</u> |
|----------------|--------------------------|-------------------|
| Cs-137 | 2.0×10^{-4} uCi | 145 counts/1 min |
| Ba-133 | 8.8×10^{-5} uCi | 204 counts/1 min |
| Co-57 | 1.7×10^{-5} uCi | 53 counts/1 min |

Radionuclides Used:

Unsealed

Tc-99m, Tl-201

Sealed

Ba-133, Co-57, Cs-137

Radioactive sealed sources were picked up by Bionomics Inc. for disposal. Most current sealed source leak test is enclosed.

Visual Check: The area was checked to ensure that all radioactive waste had been removed. No evidence of radioactive material was noted.

Radiation Level Survey: No area within the lab demonstrated radiation levels in excess of the background reading of 0.02 mR/hr.

Removable Contamination: No area within the lab demonstrated removable contamination in excess of established trigger levels.

Sealed Sources: Radioactive sealed sources were picked up by Bionomics Inc. for disposal. Most current sealed source leak test is enclosed.

Surveys, Wipes, and Diagrams are enclosed for review.

ORIGIN ID:DEOA (248) 615-7300
CARDIOVASCULAR CLINICAL ASSOCIATES
28080 GRAND RIVER AVE.
SUITE 300 W
FARMINGTON HILLS, MI 48336
UNITED STATES US

SHIP DATE: 10NOV16
ACTWGT: 0.50 LB
CAD: 102559262/NET3790

BILL SENDER

TO MATERIALS LICENSING
US NUCLEAR REG COMM REGION III
2442 WARRENVILLE RD
SUITE 210
LISLE IL 60532

544L3/CBB1/14EB

(248) 615-7300
INV.
PO:

REF:

DEPT:

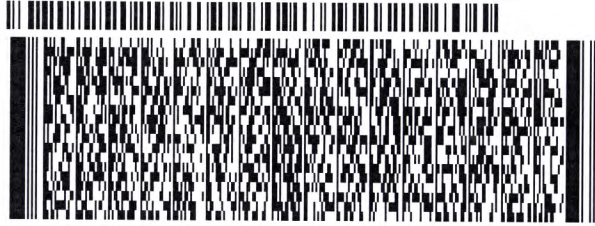

FedEx
Express



J162016101201ur

TUE - 15 NOV 4:30P
EXPRESS SAVER

TRK# 7776 8664 3148
0201

DSR

60532

IL-US ORD

SH ENLA

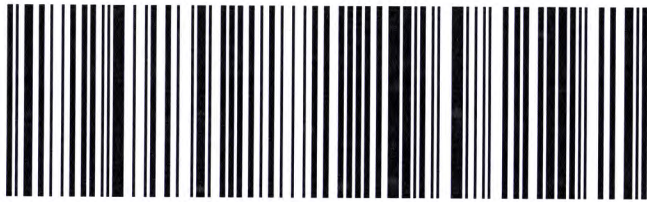

After printing this label:

1. Use the 'Print' button on this page to print your label to your laser or inkjet printer.
2. Fold the printed page along the horizontal line.
3. Place label in shipping pouch and affix it to your shipment so that the barcode portion of the label can be read and scanned.

Warning: Use only the printed original label for shipping. Using a photocopy of this label for shipping purposes is fraudulent and could result in additional billing charges, along with the cancellation of your FedEx account number.

Use of this system constitutes your agreement to the service conditions in the current FedEx Service Guide, available on fedex.com. FedEx will not be responsible for any claim in excess of \$100 per package, whether the result of loss, damage, delay, non-delivery, misdelivery or misinformation, unless you declare a higher value, pay an additional charge, document your actual loss and file a timely claim. Limitations found in the current FedEx Service Guide apply. Your right to recover from FedEx for any loss, including intrinsic value of the package, loss of sales, income interest, profit, attorney's fees, costs, and other forms of damage whether direct, incidental, consequential, or special is limited to the greater of \$100 or the authorized declared value. Recovery cannot exceed actual documented loss. Maximum for items of extraordinary value is \$1,000, e.g. jewelry, precious metals, negotiable instruments and other items listed in our ServiceGuide. Written claims must be filed within strict time limits, see current FedEx Service Guide.