

⊕
Saint Mary's
HOSPITAL

Office of the President
Chad W. Wable, FACHE

RECRG 1 09 12 '16 AM 10:24

September 2, 2016

Nuclear Regulatory Commission
Region I
Nuclear Materials Safety Branch
Division of Radiation Safety and Safeguards
2100 Renaissance Blvd, Suite 100
King of Prussia, PA 19406-2713

Br. 1

03001243

REFERENCE: License # 06-00679-01 Amendment

To Whom It May Concern:

We request the following changes to our license:

A. New Authorized User

Please add Kevin G. Kett, MD as an authorized user. Dr. Kett is presently named on Waterbury Hospital License # 06-02406-01.

B. Removal of listed Authorized Users

Please remove the following individuals from our license:

1. Matthew Bushey, MD
2. Peter Chia-Gee Chien, MD

C. Discontinuation of the Use of the Dose Calibrator

By way of information, we have discontinued the use of a dose calibrator for measurement of patient doses at our Naugatuck Valley Surgery Site. The facility only uses low doses of Tc-99m for sentinel node surgery. Administered doses are in the form of unit doses, and the administered dose will be calculated for decay prior to administration.

D. Updated Cardiology Laboratory Facility

We have modified one dressing room by lining the walls with 1/16" of lead, provided a combination lock on the door, and added a small bench, cabinet, and L-Block. This room will be used for temporary handling and storage of patient doses, storage of a cobalt 57 sheet source, and short term storage of radioactive waste. Door will be kept locked when unattended. Please see attached drawing. Modifications are shown in green.

Please let us know if you require any additional information and thank you for your prompt attention to this matter.

Sincerely,

Chad W. Wable, FACHE
President and Chief Executive Officer

Enc: Updated floor plan for SMH Nuclear Cardiology

591912

Saint Mary's
HOSPITAL

Nuclear Medicine Department

**Saint Mary's Hospital 2nd Floor
Cardiology Dept**

Nuclear Cardiology Room located on Sacred Heart 2 within the Cardiology Department.

Policy 7111C ~ Diagram of NM Cardiology Stress Rooms

Diagram Revised 8/1/16

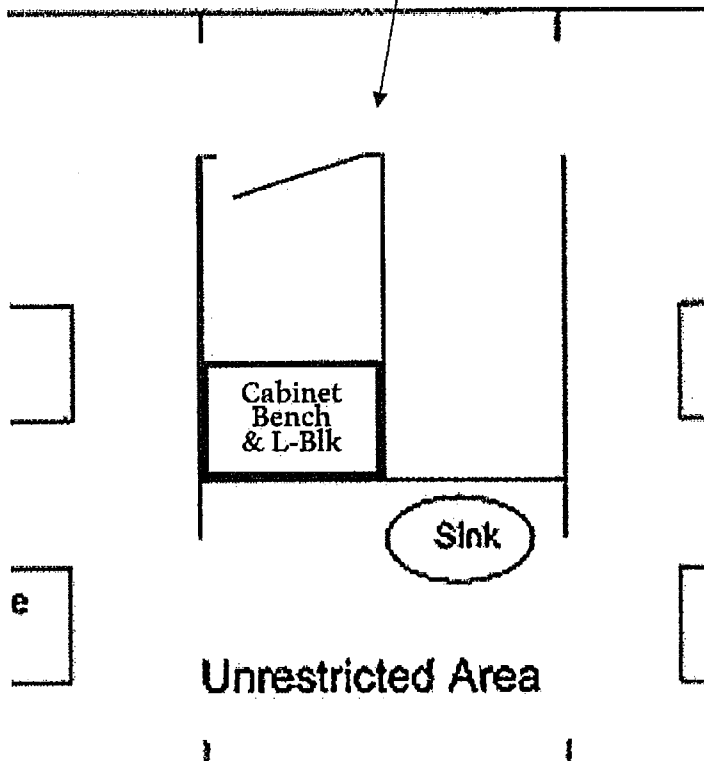
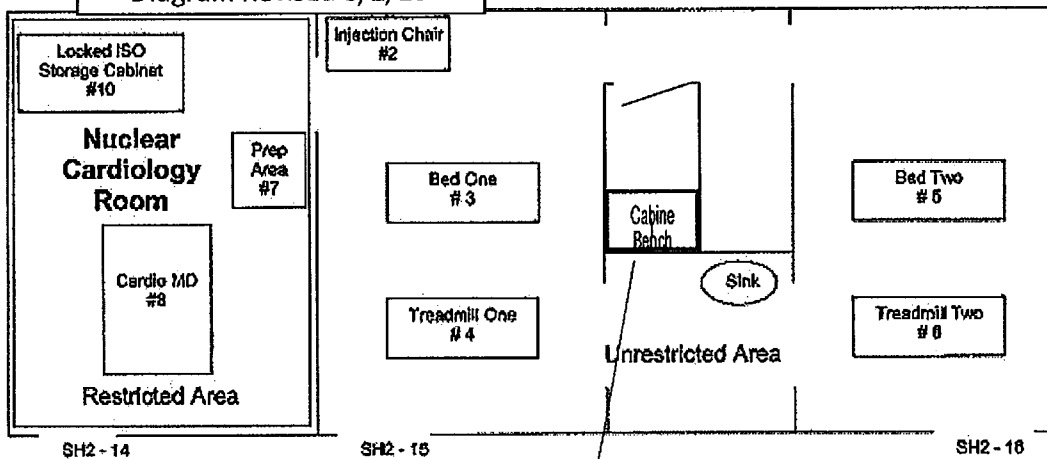



ACKNOWLEDGEMENT - RECEIPT OF CORRESPONDENCE

Name and Address of Applicant and/or Licensee Chad W. Wable President and CEO Saint Mary's Hospital 56 Franklin Street Waterbury, CT 06706	Date September 13, 2016
	License Number(s) 06-00679-01
	Mail Control Number(s) 591912
	Licensing and/or Technical Reviewer or Branch Medical Branch

This is to acknowledge receipt of your: Letter and/or Application Dated: September 2, 201

The initial processing, which included an administrative review, has been performed.
 Amendment Termination New License Renewal

There were no administrative omissions identified during our initial review.

This is to acknowledge receipt of your application for renewal of the material(s) license identified above. Your application is deemed timely filed, and accordingly, the license will not expire until final action has been taken by this office.

Your application for a new NRC license did not include your taxpayer identification number. Please complete and submit NRC Form 531, Request for Taxpayer Identification Number, located at the following link: <http://www.nrc.gov/reading-rm/doc-collections/forms/nrc531.pdf>
 Follow the instructions on the form for submission.

The following administrative omissions have been identified:
 [Empty box for listing omissions]

Your application has been assigned the above listed MAIL CONTROL NUMBER. When calling to inquire about this action, please refer to this control number. Your application has been forwarded to a technical reviewer. Please note that the technical review, which is normally completed within 180 days for a renewal application (90 days for all other requests), may identify additional omissions or require additional information. If you have any questions concerning the processing of your application, our contact information is listed below:

Region I
U. S. Nuclear Regulatory Commission
Division of Nuclear Materials Safety
2100 Renaissance Boulevard, Suite 100
King of Prussia, PA 19406-2713
(610) 337-5260, (610) 337-5313,
(610) 337-5398, (610) 337-5239