



**Golden
Valley
Memorial**
HEALTHCARE

July 11, 2016

Materials Licensing Branch
U.S. Nuclear Regulatory Commission, Region III
2443 Warrenville Road, Suite 210
Lisle, IL 60532-4352

RE: NRC Materials License #24-16597-01

Dear Sirs:

Golden Valley Memorial Hospital has moved from the old nuclear medicine area. We wish to amend the above license to remove the old nuclear medicine area from our license.

The old area consisted of a hot lab, two camera rooms, a stress lab and an injection area. Enclosed is the decommissioning report for these rooms. All radioactive sources have been moved to the new area and the monitoring and wipe test results show that no radioactivity remains.

Should you need further information, please do not hesitate to contact me.

Sincerely,

Craig Thompson
Chief Operating Officer

RECEIVED JUL 25 2016

**REPORT
DECOMMISSIONING OF NUCLEAR MEDICINE AREA**

Date: **06/22/16**

Location of Decommissioning: **Golden Valley Memorial Hospital
1600 North Second Street
Clinton, MO 64735**

Rooms Decommissioned: **Hot Lab, Camera Room 1, Camera Room 2, Stress Lab,
Injection Area**

Management Representative: **Randy Wertz, C.E.O.**

Radiation Safety Officer: **Michael A. Gilbert, D.O.**

Radiology Administrator: **Tamara Hull, RT, CRA, BHM**

Nuclear Medicine Technologist: **Phil James, BS, RT(N), CNMT**

RADIOACTIVE MATERIALS LICENSES

Nuclear Regulatory Commission
Region III

License Number: **24-16597-01**
Amendment Number: **19**
Expiration Date: **08/31/21**

DECOMMISSIONING RESULTS

- 1 No radioactive materials were stored in the area decommissioned.
- 2 The imaging systems, stress system and all removable objects were removed from the rooms.
- 2 No radioactive materials or sources were found during the decommissioning survey.
- 3 The ambient exposure rate survey was acceptable.
- 4 The removable contamination survey was acceptable.

Medical Physics Consultant:

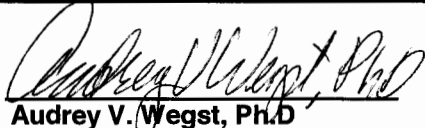
Audrey V. Wegst, Ph.D.
Diagnostic Technology Consultants, Inc.
5930 Roe Avenue
Mission, Kansas 66205

Date

July 11, 2016
(913) 236-6000
(913) 236-6655 FAX

Radiation Safety Officer:

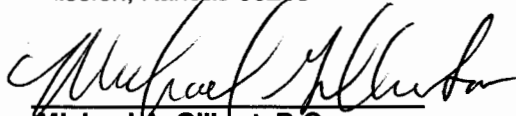
Michael A. Gilbert, D.O.

Date

7/18/16

Licensee: Golden Valley Memorial Hospital
Address: 1600 North Second Street
Clinton, MO 64735

License Number: 24-16597-01
Expiration: 08/31/21

Decommission Data 06/22/16

Historical Use:

The area for decommissioning consists of the nuclear medicine department consisting of the Hot Lab, 2 Camera Rooms, Stress Lab and a Patient Injection area.

Sealed Sources were stored in the Hot Lab. Patient doses were also stored in the hot lab. The radioactive material used in the stress room consisted of technetium for stress imaging.

The radioactive materials used in the camera/imaging area consisted of a cobalt-57 sealed source for camera QC. Technetium and Iodine-131 was used for imaging.

All radioactive waste from dose administration was stored in the hot lab.

Equipment and Device Removal:

The rooms were cleared of all equipment, desks, chairs, wall canisters and items that were not permanently fixed in their location.

Wipe Survey Procedure:

Each wipe test sample was collected by wiping an alcohol pad over the surface over an area identified on the diagrams. The wipe sample was secured in the alcohol packet and appropriately identified with the location of the wipe. The wipe samples were then taken to the Diagnostic Technology Consultants, Inc. office for measurement. The wipe samples were placed into the well counter after all required quality control and test measurements were completed. The results of the wipe surveys were then entered into the spread sheet tables in cpm. The dpm was calculated based on the most recent quarterly efficiency testing.

Wipe Test Results Evaluation:

No Detectable Activity (NDA) means the wipe count was equal to or less than the Action Level of $[BKG + 2.33 \cdot \text{SQRT}(Bkg)]$

Area Survey Procedure:

The survey meter pancake probe was passed in a sweeping motion over each area identified on the diagrams. The probe to surface distance was maintained at a minimum distance of less than 3.0 cm. The background level was established by taking a series of area survey readings in the hallway adjacent to the rooms being surveyed. The background survey readings were determined to be ≤ 3.0 mR/hr.

Area Survey Results and Trigger Level:

The action level was based on any area survey reading exceeding background levels.

Licensee: Golden Valley Memorial Hospital
 Address: 1600 North Second Street
 Clinton, MO 64735

License Number: 24-16597-01
 Expiration: 08/31/21

Survey and Analysis Equipment Parameters 06/22/16

All Equipment used for surveyers are the property of Diagnostic Technology Consultants, Inc.

Well Counter

Manufacturer: Capintec
 Model: Caprac-t
 Serial Number: 10067

Standard Source Information							
Source	Serial No.	Activity (uCi)	Calibration Date	Halflife (Days)	Decay Time (t) (Days)	A(t) (uCi)	A(t) (dpm)
Co-57	1639-11-2	1.03E-01	01/01/13	271.74	1177	5.12E-03	1.14E+04
Ba-133	1036-32-2	1.06E-01	02/01/04	3836.15	4434	4.74E-02	1.05E+05
Co-60	NEN100S	1.21E-01	02/26/80	1925.28	13175	1.05E-03	2.34E+03
Cs-137	962-51-9	9.76E-02	03/01/04	10975.55	4405	7.39E-02	1.64E+05

Minimum Detectable Activity (MDA)						
Source	Analysis Date	Source Count (5 min)	Bkg (5 min)	Efficiency	MDA (dpm)	MDA (uCi)
Co-57	03/23/16	53070	1125	0.913	79	3.57E-05
Ba-133	03/23/16	492620	1125	0.934	78	3.49E-05
Co-60	03/23/16	5075	1125	0.337	215	9.68E-05
Cs-137	03/23/16	246265	1125	0.299	242	1.09E-04

All wipe test samples are counted using a window setting of 10 Kev to 800 Kev.

Survey Meter			Probe:		
Manufacturer:	Ludlum		Manufacturer:	Ludlum	
Model:	14C		Model:	44-9 (pancake)	
Serial Number:	80112		Serial Number:	pr073932	

Calibration Date: July 2, 2015
 Correction Factors as of July 2, 2015.

Scale Multiplier	Reference Cal. Point	Instrument 'as found read'	Instrument Meter Reading
1000	1500 mR/hr	1.5	1.5
1000	500 mR/hr	0.55	0.55
100	150 mR/hr	1	1.65
100	50 mR/hr	0.35	0.5
10	15 mR/hr	1.2	1.5
10	5 mR/hr	0.4	0.5
1	1.5 mR/hr	1.5	1.5
1	1 mR/hr	1	1
0.1	387 cpm	1.2	1.5
0.1	129 cpm	0.35	0.5

Calibrated by Ludlum Measurements, Inc. 501 Oak Street, Sweetwater, TX 79556 64082, Texas Calibration License Number: LO-1963, in accordance with the requirements of ANSI/NCLS Z540-1-1994 and ANSI N323-1978. Standards used are traceable to the National Institute of Standards and Technology, or to the calibration facilities of other International Standards Organizations or have been derived from accepted values of natural physical constants or have been derived by the ratio type of calibration techniques.

Licensee: Golden Valley Memorial Hospital

License Number: 24-16597-01

Address: 1600 North Second Street
Clinton, MO 64735

Expiration: 8/31/2021

HOT LAB

1	2	3	4	5	6	7 67
8	9-11	12-14	15-17	18-20	21-22	23
24	25	26	27	28	29	30
31	32	33	34	35	36	37 68
38	39	40	41	42	43	44
60-63		64	65	66		
45	46	1-7 counter top			57-59 bottom shelf of metal racks	
53, 56, 59		9, 12, 15, 18 drawers			60 top of storage cabinet	
47	48	10, 13, 16, 19 top shelf of cabinets			61 bottom shelf of storage cabinet	
52, 55, 58		11, 14, 17, 20, 22 bottom shelf of cabinets			62-63 drawers in storage cabinet	
49	50	8, 24-50 floor			64-66 table top where RAM received	
51, 54, 57		51-53 top shelf of metal storage racks			67 telephone mounted on wall	
		54-56 middle shelf of metal storage racks			68 door handle	



= 1 Foot

Licensee: Golden Valley Memorial Hospital

License Number: 24-16597-01

Address: 1600 North Second Street
Clinton, MO 64735

Expiration: 8/31/2021

CAMERA ROOM 1 - GE DISCOVERY

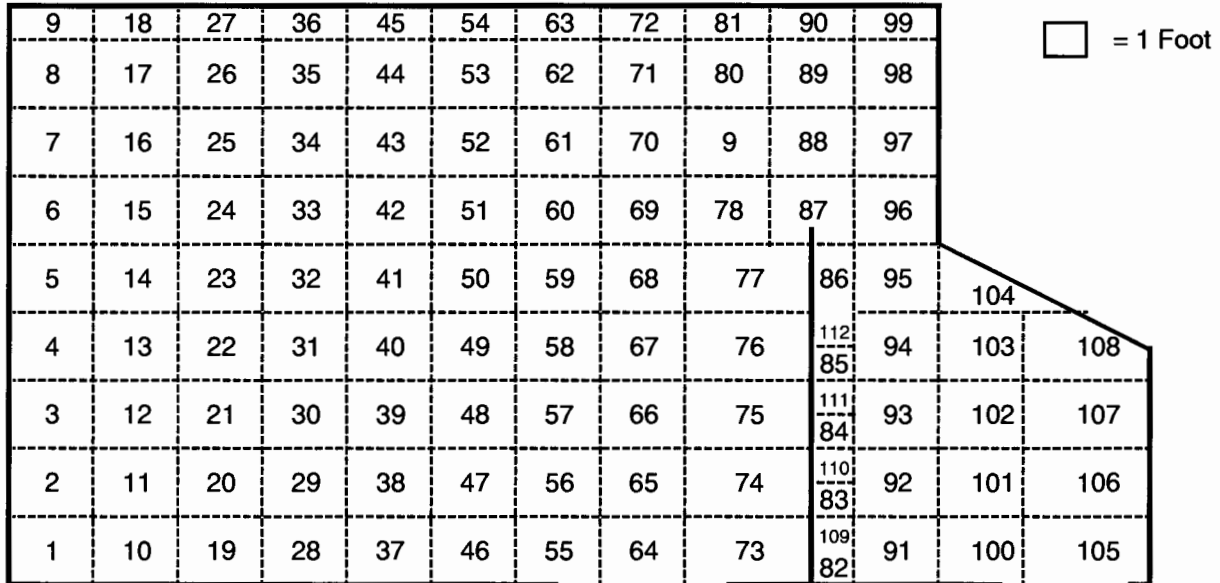

1-35, 37-108: Floor

36: Sink

109-112: Control Room Desk Top

Licensee: Golden Valley Memorial Hospital

License Number: 24-16597-01

Address: 1600 North Second Street
Clinton, MO 64735

Expiration: 8/31/2021

CAMERA ROOM 2 - SKYLIGHT

1	2	3	4	5	6
7	8	9	10	11	12
13	14	15	16	17	18
19	20	21	22	23	24
25	26	27	28	29	30
31	32	33	34	35	36
37	38	39	40	41	42
43	44	45	46	47	48
49	50	51	52	53	54
55	56	57	58	59	60
61	62	63	64	65	66
67	68	69	70	71	72
73	74	75	76	77	78

 = 1 Foot

1-78: Floor

Licensee: Golden Valley Memorial Hospital

License Number: 24-16597-01

Address: 1600 North Second Street
Clinton, MO 64735

Expiration: 8/31/2021

PATIENT INJECTION ROOM

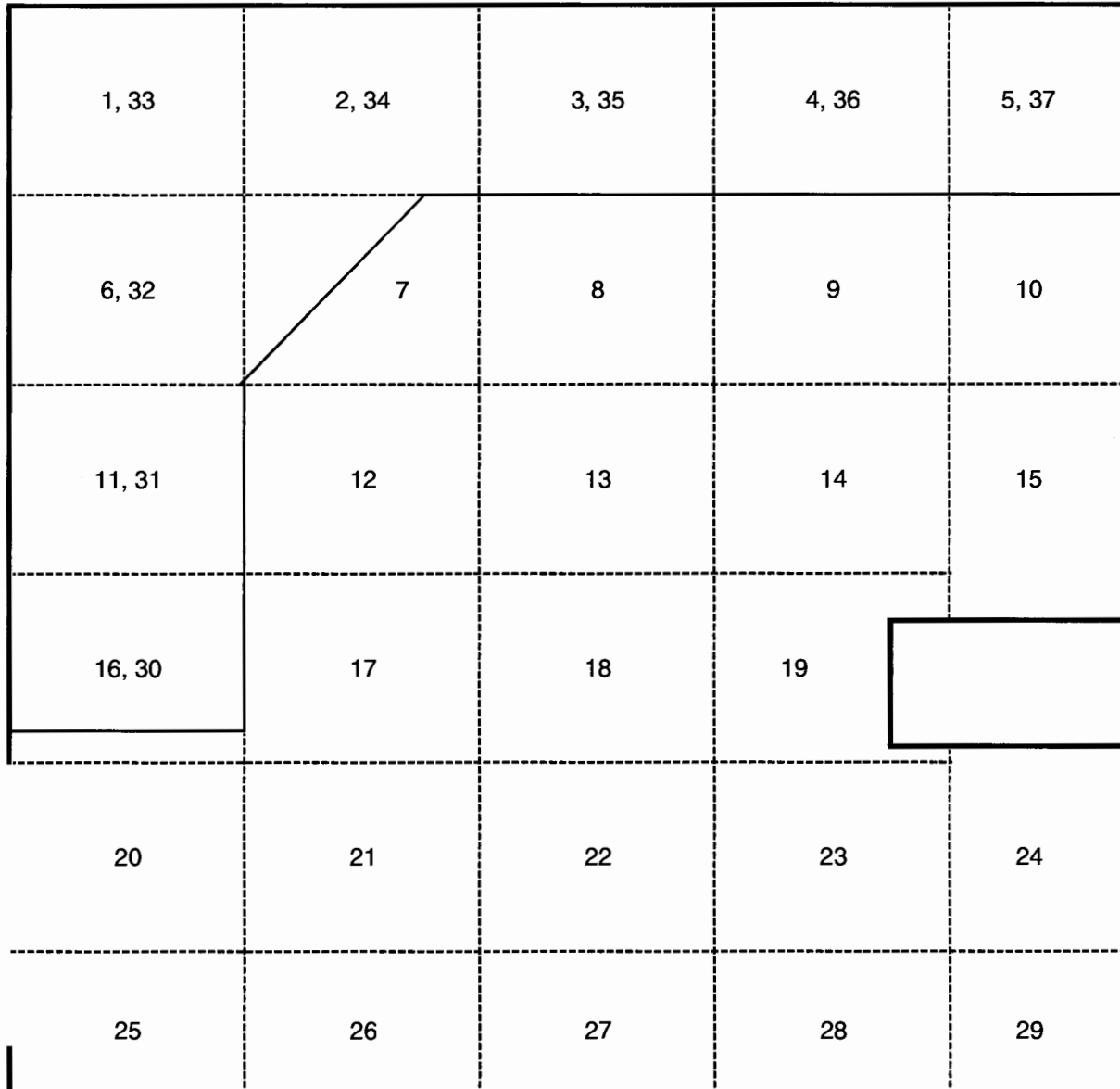

= 1 Foot

1 - 29: Floor

30 - 37: Desk Top

Licensee: Golden Valley Memorial Hospital

License Number: 24-16597-01

Address: 1600 North Second Street
Clinton, MO 64735

Expiration: 8/31/2021

STRESS LAB

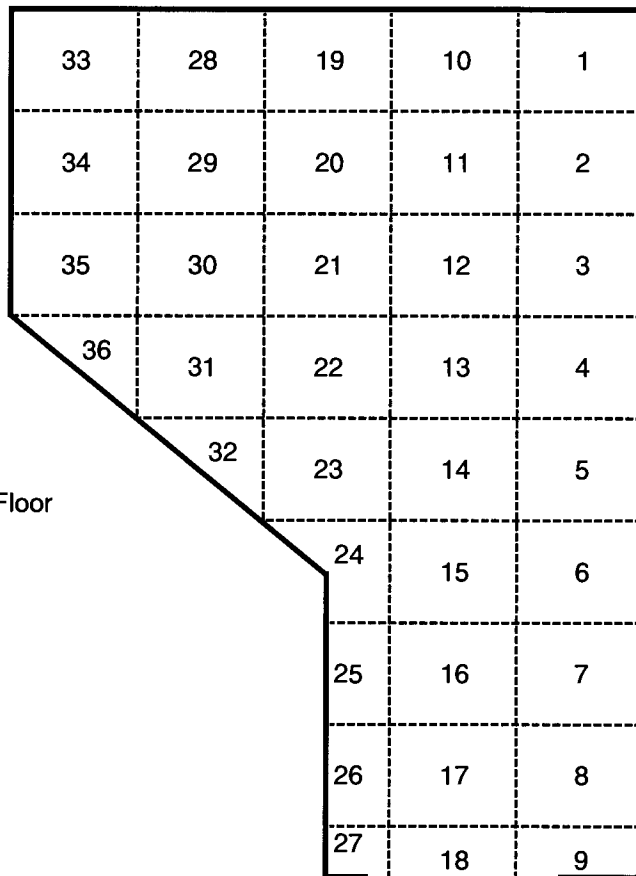

 = 1 Foot

1 - 36: Floor

Licensee: Golden Valley Memorial Hospital
 Address: 1600 North Second Street
 Clinton, MO 64735

License Number: 24-16597-01
 Expiration: 08/31/21

RADIATION SURVEY - HOT LAB 06/22/16

SURVEY				Radiation Survey			Results	SURVEY				Radiation Survey			Results
No.	Room	Location	Area	Ambient (mR/hr)	Wipe (cpm)	Wipe (dpm)		No.	Room	Location	Area	Ambient (mR/hr)	Wipe (cpm)	Wipe (dpm)	
		Background		0.03	212				Background		0.03	212			
1	Hot Lab	Counter Top	Restricted	0.03	226	NDA	PASS	46	Floor	Floor	Restricted	0.03	202	NDA	PASS
2	Hot Lab	Counter Top	Restricted	0.03	207	NDA	PASS	47	Floor	Floor	Restricted	0.03	208	NDA	PASS
3	Hot Lab	Counter Top	Restricted	0.03	192	NDA	PASS	48	Floor	Floor	Restricted	0.03	243	NDA	PASS
4	Hot Lab	Counter Top	Restricted	0.03	197	NDA	PASS	49	Floor	Floor	Restricted	0.03	202	NDA	PASS
5	Hot Lab	Counter Top	Restricted	0.03	234	NDA	PASS	50	Floor	Floor	Restricted	0.03	197	NDA	PASS
6	Hot Lab	Counter Top	Restricted	0.03	202	NDA	PASS	51	Top Shelf	Floor	Restricted	0.03	222	NDA	PASS
7	Hot Lab	Counter Top	Restricted	0.03	226	NDA	PASS	52	Top Shelf	Floor	Restricted	0.03	192	NDA	PASS
8	Hot Lab	Floor	Restricted	0.03	226	NDA	PASS	53	Top Shelf	Floor	Restricted	0.03	224	NDA	PASS
9	Hot Lab	Drawer	Restricted	0.03	217	NDA	PASS	54	Mid. Shelf	Floor	Restricted	0.03	217	NDA	PASS
10	Hot Lab	Top Shelf	Restricted	0.03	215	NDA	PASS	55	Mid. Shelf	Floor	Restricted	0.03	234	NDA	PASS
11	Hot Lab	Bot. Shelf	Restricted	0.03	192	NDA	PASS	56	Mid. Shelf	Floor	Restricted	0.03	207	NDA	PASS
12	Hot Lab	Drawer	Restricted	0.03	221	NDA	PASS	57	Bot. Shelf	Floor	Restricted	0.03	208	NDA	PASS
13	Hot Lab	Top Shelf	Restricted	0.03	224	NDA	PASS	58	Bot. Shelf	Floor	Restricted	0.03	188	NDA	PASS
14	Hot Lab	Bot. Shelf	Restricted	0.03	224	NDA	PASS	59	Bot. Shelf	Floor	Restricted	0.03	227	NDA	PASS
15	Hot Lab	Drawer	Restricted	0.03	215	NDA	PASS	60	Top Cabin	Floor	Restricted	0.03	187	NDA	PASS
16	Hot Lab	Top Shelf	Restricted	0.03	206	NDA	PASS	61	Bot. Cabin	Floor	Restricted	0.03	240	NDA	PASS
17	Hot Lab	Bot. Shelf	Restricted	0.03	222	NDA	PASS	62	Drawer	Floor	Restricted	0.03	234	NDA	PASS
18	Hot Lab	Drawer	Restricted	0.03	232	NDA	PASS	63	Drawer	Floor	Restricted	0.03	217	NDA	PASS
19	Hot Lab	Top Shelf	Restricted	0.03	188	NDA	PASS	64	Table	Floor	Restricted	0.03	232	NDA	PASS
20	Hot Lab	Bot. Shelf	Restricted	0.03	234	NDA	PASS	65	Table	Floor	Restricted	0.03	205	NDA	PASS
21	Hot Lab	Sink	Restricted	0.03	243	NDA	PASS	66	Table	Floor	Restricted	0.03	221	NDA	PASS
22	Hot Lab	Shelf	Restricted	0.03	225	NDA	PASS	67	Telephone	Floor	Restricted	0.03	222	NDA	PASS
23	Hot Lab	Shelf	Restricted	0.03	227	NDA	PASS	68	Door	Floor	Restricted	0.03	225	NDA	PASS
24	Hot Lab	Floor	Restricted	0.03	227	NDA	PASS	69							
25	Hot Lab	Floor	Restricted	0.03	234	NDA	PASS	70							
26	Hot Lab	Floor	Restricted	0.03	224	NDA	PASS	71							
27	Hot Lab	Floor	Restricted	0.03	205	NDA	PASS	72							
28	Hot Lab	Floor	Restricted	0.03	207	NDA	PASS	73							
29	Hot Lab	Floor	Restricted	0.03	240	NDA	PASS	74							
30	Hot Lab	Floor	Restricted	0.03	215	NDA	PASS	75							
31	Hot Lab	Floor	Restricted	0.03	232	NDA	PASS	76							
32	Hot Lab	Floor	Restricted	0.03	221	NDA	PASS	77							
33	Hot Lab	Floor	Restricted	0.03	206	NDA	PASS	78							
34	Hot Lab	Floor	Restricted	0.03	213	NDA	PASS	79							
35	Hot Lab	Floor	Restricted	0.03	243	NDA	PASS	80							
36	Hot Lab	Floor	Restricted	0.03	234	NDA	PASS	81							
37	Hot Lab	Floor	Restricted	0.03	222	NDA	PASS	82							
38	Hot Lab	Floor	Restricted	0.03	234	NDA	PASS	83							
39	Hot Lab	Floor	Restricted	0.03	213	NDA	PASS	84							
40	Hot Lab	Floor	Restricted	0.03	208	NDA	PASS	85							
41	Hot Lab	Floor	Restricted	0.03	240	NDA	PASS	86							
42	Hot Lab	Floor	Restricted	0.03	188	NDA	PASS	87							
43	Hot Lab	Floor	Restricted	0.03	213	NDA	PASS	88							
44	Hot Lab	Floor	Restricted	0.03	206	NDA	PASS	89							
45	Hot Lab	Floor	Restricted	0.03	205	NDA	PASS	90							

Survey Performed By:	Audrey Wegst, Ph.D. Jiping Zhan, PI	Background Count:	212
Survey Performed On:	06/22/16	Delta1 (net counts):	34
Wipe Test Samples Counted By:	Jiping Zhan, Ph.D	Delta2 (net counts):	70
Wipe Test Samples Counted On:	06/23/16	Decision Limit (L _c):	246

Licensee: Golden Valley Memorial Hospital
 Address: 1600 North Second Street
 Clinton, MO 64735

License Number: 24-16597-01
 Expiration: 08/31/21

RADIATION SURVEY - CAMERA ROOM 1 (GE DISCOVERY)

06/22/16

SURVEY				Radiation Survey			Results
No.	Room	Location	Area	Ambient (mR/hr)	Wipe (cpm)	Wipe (dpm)	
			Background	0.03	212		
1	Cam Rm	Floor	Restricted	0.03	199	NDA	PASS
2	Cam Rm	Floor	Restricted	0.03	206	NDA	PASS
3	Cam Rm	Floor	Restricted	0.03	190	NDA	PASS
4	Cam Rm	Floor	Restricted	0.03	215	NDA	PASS
5	Cam Rm	Floor	Restricted	0.03	191	NDA	PASS
6	Cam Rm	Floor	Restricted	0.03	190	NDA	PASS
7	Cam Rm	Floor	Restricted	0.03	223	NDA	PASS
8	Cam Rm	Floor	Restricted	0.03	200	NDA	PASS
9	Cam Rm	Floor	Restricted	0.03	202	NDA	PASS
10	Cam Rm	Floor	Restricted	0.03	191	NDA	PASS
11	Cam Rm	Floor	Restricted	0.03	241	NDA	PASS
12	Cam Rm	Floor	Restricted	0.03	197	NDA	PASS
13	Cam Rm	Floor	Restricted	0.03	223	NDA	PASS
14	Cam Rm	Floor	Restricted	0.03	190	NDA	PASS
15	Cam Rm	Floor	Restricted	0.03	191	NDA	PASS
16	Cam Rm	Floor	Restricted	0.03	208	NDA	PASS
17	Cam Rm	Floor	Restricted	0.03	222	NDA	PASS
18	Cam Rm	Floor	Restricted	0.03	202	NDA	PASS
29	Cam Rm	Floor	Restricted	0.03	182	NDA	PASS
20	Cam Rm	Floor	Restricted	0.03	223	NDA	PASS
21	Cam Rm	Floor	Restricted	0.03	202	NDA	PASS
22	Cam Rm	Floor	Restricted	0.03	223	NDA	PASS
23	Cam Rm	Floor	Restricted	0.03	200	NDA	PASS
24	Cam Rm	Floor	Restricted	0.03	208	NDA	PASS
25	Cam Rm	Floor	Restricted	0.03	223	NDA	PASS
26	Cam Rm	Floor	Restricted	0.03	212	NDA	PASS
27	Cam Rm	Floor	Restricted	0.03	222	NDA	PASS
28	Cam Rm	Floor	Restricted	0.03	219	NDA	PASS
29	Cam Rm	Floor	Restricted	0.03	206	NDA	PASS
30	Cam Rm	Floor	Restricted	0.03	215	NDA	PASS
31	Cam Rm	Floor	Restricted	0.03	197	NDA	PASS
32	Cam Rm	Floor	Restricted	0.03	222	NDA	PASS
33	Cam Rm	Floor	Restricted	0.03	206	NDA	PASS
34	Cam Rm	Floor	Restricted	0.03	200	NDA	PASS
35	Cam Rm	Floor	Restricted	0.03	221	NDA	PASS
36	Cam Rm	Floor	Restricted	0.03	212	NDA	PASS
37	Cam Rm	Floor	Restricted	0.03	191	NDA	PASS
38	Cam Rm	Floor	Restricted	0.03	200	NDA	PASS
39	Cam Rm	Floor	Restricted	0.03	182	NDA	PASS
40	Cam Rm	Floor	Restricted	0.03	208	NDA	PASS
41	Cam Rm	Floor	Restricted	0.03	206	NDA	PASS
42	Cam Rm	Floor	Restricted	0.03	200	NDA	PASS
43	Cam Rm	Floor	Restricted	0.03	233	NDA	PASS
44	Cam Rm	Floor	Restricted	0.03	208	NDA	PASS
45	Cam Rm	Floor	Restricted	0.03	199	NDA	PASS

SURVEY				Radiation Survey			Results
No.	Room	Location	Area	Ambient (mR/hr)	Wipe (cpm)	Wipe (dpm)	
			Background	0.03	212		
46	Cam Rm	Floor	Restricted	0.03	205	NDA	PASS
47	Cam Rm	Floor	Restricted	0.03	223	NDA	PASS
48	Cam Rm	Floor	Restricted	0.03	212	NDA	PASS
49	Cam Rm	Floor	Restricted	0.03	212	NDA	PASS
50	Cam Rm	Floor	Restricted	0.03	225	NDA	PASS
51	Cam Rm	Floor	Restricted	0.03	199	NDA	PASS
52	Cam Rm	Floor	Restricted	0.03	215	NDA	PASS
53	Cam Rm	Floor	Restricted	0.03	241	NDA	PASS
54	Cam Rm	Floor	Restricted	0.03	197	NDA	PASS
55	Cam Rm	Floor	Restricted	0.03	204	NDA	PASS
56	Cam Rm	Floor	Restricted	0.03	225	NDA	PASS
57	Cam Rm	Floor	Restricted	0.03	206	NDA	PASS
58	Cam Rm	Floor	Restricted	0.03	233	NDA	PASS
59	Cam Rm	Floor	Restricted	0.03	212	NDA	PASS
60	Cam Rm	Floor	Restricted	0.03	200	NDA	PASS
61	Cam Rm	Floor	Restricted	0.03	241	NDA	PASS
62	Cam Rm	Floor	Restricted	0.03	223	NDA	PASS
63	Cam Rm	Floor	Restricted	0.03	208	NDA	PASS
64	Cam Rm	Floor	Restricted	0.03	202	NDA	PASS
65	Cam Rm	Floor	Restricted	0.03	202	NDA	PASS
66	Cam Rm	Floor	Restricted	0.03	203	NDA	PASS
67	Cam Rm	Floor	Restricted	0.03	208	NDA	PASS
68	Cam Rm	Floor	Restricted	0.03	223	NDA	PASS
69	Cam Rm	Floor	Restricted	0.03	219	NDA	PASS
70	Cam Rm	Floor	Restricted	0.03	196	NDA	PASS
71	Cam Rm	Floor	Restricted	0.03	214	NDA	PASS
72	Cam Rm	Floor	Restricted	0.03	212	NDA	PASS
73	Cam Rm	Floor	Restricted	0.03	223	NDA	PASS
74	Cam Rm	Floor	Restricted	0.03	215	NDA	PASS
75	Cam Rm	Floor	Restricted	0.03	196	NDA	PASS
76	Cam Rm	Floor	Restricted	0.03	215	NDA	PASS
77	Cam Rm	Floor	Restricted	0.03	196	NDA	PASS
78	Cam Rm	Floor	Restricted	0.03	231	NDA	PASS
79	Cam Rm	Floor	Restricted	0.03	202	NDA	PASS
80	Cam Rm	Floor	Restricted	0.03	225	NDA	PASS
81	Cam Rm	Floor	Restricted	0.03	196	NDA	PASS
82	Control Rm	Floor	Restricted	0.03	210	NDA	PASS
83	Control Rm	Floor	Restricted	0.03	203	NDA	PASS
84	Control Rm	Floor	Restricted	0.03	214	NDA	PASS
85	Control Rm	Floor	Restricted	0.03	205	NDA	PASS
86	Control Rm	Floor	Restricted	0.03	215	NDA	PASS
87	Control Rm	Floor	Restricted	0.03	225	NDA	PASS
88	Control Rm	Floor	Restricted	0.03	204	NDA	PASS
89	Control Rm	Floor	Restricted	0.03	215	NDA	PASS
90	Control Rm	Floor	Restricted	0.03	204	NDA	PASS

Survey Performed By:	Audrey Wegst, Ph.D. Jiping Zhan, Pt	Background Count:	212
Survey Performed On:	06/22/16	Delta1 (net counts):	34
Wipe Test Samples Counted By:	Jiping Zhan, Ph.D	Delta2 (net counts):	70
Wipe Test Samples Counted On:	06/23/16	Decision Limit (L _c):	246

Licensee: Golden Valley Memorial Hospital
 Address: 1600 North Second Street
 Clinton, MO 64735

License Number: 24-16597-01
 Expiration: 08/31/21

RADIATION SURVEY - CAMERA ROOM 1 (GE DISCOVERY) CONTINUED
06/22/16

SURVEY				Radiation Survey			Results
No.	Room	Location	Area	Ambient (mR/hr)	Wipe (cpm)	Wipe (dpm)	
			Background	0.03	212		
91	Control Rm	Floor	Restricted	0.03	196	NDA	PASS
92	Control Rm	Floor	Restricted	0.03	215	NDA	PASS
93	Control Rm	Floor	Restricted	0.03	215	NDA	PASS
94	Control Rm	Floor	Restricted	0.03	221	NDA	PASS
95	Control Rm	Floor	Restricted	0.03	206	NDA	PASS
96	Control Rm	Floor	Restricted	0.03	225	NDA	PASS
97	Control Rm	Floor	Restricted	0.03	225	NDA	PASS
98	Control Rm	Floor	Restricted	0.03	210	NDA	PASS
99	Control Rm	Floor	Restricted	0.03	225	NDA	PASS
100	Control Rm	Floor	Restricted	0.03	203	NDA	PASS
101	Control Rm	Floor	Restricted	0.03	214	NDA	PASS
102	Control Rm	Floor	Restricted	0.03	195	NDA	PASS
103	Control Rm	Floor	Restricted	0.03	205	NDA	PASS
104	Control Rm	Floor	Restricted	0.03	231	NDA	PASS
105	Control Rm	Floor	Restricted	0.03	219	NDA	PASS
106	Control Rm	Floor	Restricted	0.03	225	NDA	PASS
107	Control Rm	Floor	Restricted	0.03	225	NDA	PASS
108	Control Rm	Floor	Restricted	0.03	233	NDA	PASS
109	Control Rm	Desk Top	Restricted	0.03	231	NDA	PASS
110	Control Rm	Desk Top	Restricted	0.03	210	NDA	PASS
111	Control Rm	Desk Top	Restricted	0.03	182	NDA	PASS
112	Control Rm	Desk Top	Restricted	0.03	225	NDA	PASS

SURVEY				Radiation Survey			Results
No.	Room	Location	Area	Ambient (mR/hr)	Wipe (cpm)	Wipe (dpm)	
			Background	0.03	212		

Survey Performed By:	Audrey Wegst, Ph.D. Jiping Zhan, Ph.D	Background Count:	212
Survey Performed On:	06/22/16	Delta1 (net counts):	34
Wipe Test Samples Counted By:	Jiping Zhan, Ph.D	Delta2 (net counts):	70
Wipe Test Samples Counted On:	06/23/16	Decision Limit (L _c):	246

RADIATION SURVEY - CAMERA ROOM 2 (SKYLIGHT) 06/22/16

SURVEY				Radiation Survey			Results
No.	Room	Location	Area	Ambient (mR/hr)	Wipe (cpm)	Wipe (dpm)	
Background				0.03	212		
1	Cam Rm 2	Floor	Restricted	0.03	219	NDA	PASS
2	Cam Rm 2	Floor	Restricted	0.03	198	NDA	PASS
3	Cam Rm 2	Floor	Restricted	0.03	224	NDA	PASS
4	Cam Rm 2	Floor	Restricted	0.03	227	NDA	PASS
5	Cam Rm 2	Floor	Restricted	0.03	215	NDA	PASS
6	Cam Rm 2	Floor	Restricted	0.03	215	NDA	PASS
7	Cam Rm 2	Floor	Restricted	0.03	232	NDA	PASS
8	Cam Rm 2	Floor	Restricted	0.03	230	NDA	PASS
9	Cam Rm 2	Floor	Restricted	0.03	241	NDA	PASS
0	Cam Rm 2	Floor	Restricted	0.03	215	NDA	PASS
11	Cam Rm 2	Floor	Restricted	0.03	219	NDA	PASS
12	Cam Rm 2	Floor	Restricted	0.03	224	NDA	PASS
13	Cam Rm 2	Floor	Restricted	0.03	194	NDA	PASS
14	Cam Rm 2	Floor	Restricted	0.03	219	NDA	PASS
15	Cam Rm 2	Floor	Restricted	0.03	198	NDA	PASS
16	Cam Rm 2	Floor	Restricted	0.03	199	NDA	PASS
17	Cam Rm 2	Floor	Restricted	0.03	240	NDA	PASS
18	Cam Rm 2	Floor	Restricted	0.03	230	NDA	PASS
19	Cam Rm 2	Floor	Restricted	0.03	227	NDA	PASS
20	Cam Rm 2	Floor	Restricted	0.03	239	NDA	PASS
21	Cam Rm 2	Floor	Restricted	0.03	232	NDA	PASS
22	Cam Rm 2	Floor	Restricted	0.03	196	NDA	PASS
23	Cam Rm 2	Floor	Restricted	0.03	201	NDA	PASS
24	Cam Rm 2	Floor	Restricted	0.03	230	NDA	PASS
25	Cam Rm 2	Floor	Restricted	0.03	205	NDA	PASS
26	Cam Rm 2	Floor	Restricted	0.03	203	NDA	PASS
27	Cam Rm 2	Floor	Restricted	0.03	203	NDA	PASS
28	Cam Rm 2	Floor	Restricted	0.03	224	NDA	PASS
29	Cam Rm 2	Floor	Restricted	0.03	224	NDA	PASS
30	Cam Rm 2	Floor	Restricted	0.03	205	NDA	PASS
31	Cam Rm 2	Floor	Restricted	0.03	202	NDA	PASS
32	Cam Rm 2	Floor	Restricted	0.03	203	NDA	PASS
33	Cam Rm 2	Floor	Restricted	0.03	200	NDA	PASS
34	Cam Rm 2	Floor	Restricted	0.03	229	NDA	PASS
35	Cam Rm 2	Floor	Restricted	0.03	241	NDA	PASS
36	Cam Rm 2	Floor	Restricted	0.03	202	NDA	PASS
37	Cam Rm 2	Floor	Restricted	0.03	200	NDA	PASS
38	Cam Rm 2	Floor	Restricted	0.03	229	NDA	PASS
39	Cam Rm 2	Floor	Restricted	0.03	205	NDA	PASS
40	Cam Rm 2	Floor	Restricted	0.03	240	NDA	PASS
41	Cam Rm 2	Floor	Restricted	0.03	218	NDA	PASS
42	Cam Rm 2	Floor	Restricted	0.03	212	NDA	PASS
43	Cam Rm 2	Floor	Restricted	0.03	240	NDA	PASS
44	Cam Rm 2	Floor	Restricted	0.03	218	NDA	PASS
45	Cam Rm 2	Floor	Restricted	0.03	241	NDA	PASS

SURVEY				Radiation Survey			Results
No.	Room	Location	Area	Ambient (mR/hr)	Wipe (cpm)	Wipe (dpm)	
Background				0.03	212		
46	Cam Rm 2	Floor	Restricted	0.03	196	NDA	PASS
47	Cam Rm 2	Floor	Restricted	0.03	198	NDA	PASS
48	Cam Rm 2	Floor	Restricted	0.03	199	NDA	PASS
49	Cam Rm 2	Floor	Restricted	0.03	196	NDA	PASS
50	Cam Rm 2	Floor	Restricted	0.03	194	NDA	PASS
51	Cam Rm 2	Floor	Restricted	0.03	213	NDA	PASS
52	Cam Rm 2	Floor	Restricted	0.03	241	NDA	PASS
53	Cam Rm 2	Floor	Restricted	0.03	202	NDA	PASS
54	Cam Rm 2	Floor	Restricted	0.03	227	NDA	PASS
55	Cam Rm 2	Floor	Restricted	0.03	205	NDA	PASS
56	Cam Rm 2	Floor	Restricted	0.03	201	NDA	PASS
57	Cam Rm 2	Floor	Restricted	0.03	196	NDA	PASS
58	Cam Rm 2	Floor	Restricted	0.03	230	NDA	PASS
59	Cam Rm 2	Floor	Restricted	0.03	212	NDA	PASS
60	Cam Rm 2	Floor	Restricted	0.03	203	NDA	PASS
61	Cam Rm 2	Floor	Restricted	0.03	213	NDA	PASS
62	Cam Rm 2	Floor	Restricted	0.03	194	NDA	PASS
63	Cam Rm 2	Floor	Restricted	0.03	213	NDA	PASS
64	Cam Rm 2	Floor	Restricted	0.03	199	NDA	PASS
65	Cam Rm 2	Floor	Restricted	0.03	218	NDA	PASS
66	Cam Rm 2	Floor	Restricted	0.03	240	NDA	PASS
67	Cam Rm 2	Floor	Restricted	0.03	218	NDA	PASS
68	Cam Rm 2	Floor	Restricted	0.03	218	NDA	PASS
69	Cam Rm 2	Floor	Restricted	0.03	196	NDA	PASS
70	Cam Rm 2	Floor	Restricted	0.03	241	NDA	PASS
71	Cam Rm 2	Floor	Restricted	0.03	196	NDA	PASS
72	Cam Rm 2	Floor	Restricted	0.03	203	NDA	PASS
73	Cam Rm 2	Floor	Restricted	0.03	200	NDA	PASS
74	Cam Rm 2	Floor	Restricted	0.03	212	NDA	PASS
75	Cam Rm 2	Floor	Restricted	0.03	203	NDA	PASS
76	Cam Rm 2	Floor	Restricted	0.03	230	NDA	PASS
77	Cam Rm 2	Floor	Restricted	0.03	232	NDA	PASS
78	Cam Rm 2	Floor	Restricted	0.03	218	NDA	PASS
Restricted							FAIL

Survey Performed By:	Audrey Wegst, Ph.D. Jiping Zhan, Ph.D	Background Count:	212
Survey Performed On:	06/22/16	Delta1 (net counts):	34
Wipe Test Samples Counted By:	Jiping Zhan, Ph.D	Delta2 (net counts):	70
Wipe Test Samples Counted On:	06/23/16	Decision Limit (L _c):	246

Method: Each leak test sample was collected by wiping an alcohol pad over the exposed surface of the source.

No Detectable Activity (NDA): Wipe count equal to or less than the Decision Limit [Bkg + 2.33*SQRT(Bkg)]

Licensee: Golden Valley Memorial Hospital
 Address: 1600 North Second Street
 Clinton, MO 64735

License Number: 24-16597-01
 Expiration: 08/31/21

RADIATION SURVEY - PATIENT INJECTION ROOM
06/22/16

SURVEY				Radiation Survey			Results
No.	Room	Location	Area	Ambient (mR/hr)	Wipe (cpm)	Wipe (dpm)	
			Background	0.03	212		
1	Pt Inj Rm	Floor	Restricted	0.03	200	NDA	PASS
2	Pt Inj Rm	Floor	Restricted	0.03	214	NDA	PASS
3	Pt Inj Rm	Floor	Restricted	0.03	198	NDA	PASS
4	Pt Inj Rm	Floor	Restricted	0.03	230	NDA	PASS
5	Pt Inj Rm	Floor	Restricted	0.03	208	NDA	PASS
6	Pt Inj Rm	Floor	Restricted	0.03	230	NDA	PASS
7	Pt Inj Rm	Floor	Restricted	0.03	212	NDA	PASS
8	Pt Inj Rm	Floor	Restricted	0.03	214	NDA	PASS
9	Pt Inj Rm	Floor	Restricted	0.03	202	NDA	PASS
10	Pt Inj Rm	Floor	Restricted	0.03	204	NDA	PASS
11	Pt Inj Rm	Floor	Restricted	0.03	198	NDA	PASS
12	Pt Inj Rm	Floor	Restricted	0.03	219	NDA	PASS
13	Pt Inj Rm	Floor	Restricted	0.03	203	NDA	PASS
14	Pt Inj Rm	Floor	Restricted	0.03	203	NDA	PASS
15	Pt Inj Rm	Floor	Restricted	0.03	204	NDA	PASS
16	Pt Inj Rm	Floor	Restricted	0.03	239	NDA	PASS
17	Pt Inj Rm	Floor	Restricted	0.03	202	NDA	PASS
18	Pt Inj Rm	Floor	Restricted	0.03	204	NDA	PASS
19	Pt Inj Rm	Floor	Restricted	0.03	198	NDA	PASS
20	Pt Inj Rm	Floor	Restricted	0.03	214	NDA	PASS
21	Pt Inj Rm	Floor	Restricted	0.03	198	NDA	PASS
22	Pt Inj Rm	Floor	Restricted	0.03	203	NDA	PASS
23	Pt Inj Rm	Floor	Restricted	0.03	219	NDA	PASS
24	Pt Inj Rm	Floor	Restricted	0.03	208	NDA	PASS
25	Pt Inj Rm	Floor	Restricted	0.03	202	NDA	PASS
26	Pt Inj Rm	Floor	Restricted	0.03	198	NDA	PASS
27	Pt Inj Rm	Floor	Restricted	0.03	200	NDA	PASS
28	Pt Inj Rm	Floor	Restricted	0.03	212	NDA	PASS
29	Pt Inj Rm	Floor	Restricted	0.03	230	NDA	PASS
30	Pt Inj Rm	Desk Top	Restricted	0.03	212	NDA	PASS
31	Pt Inj Rm	Desk Top	Restricted	0.03	230	NDA	PASS
32	Pt Inj Rm	Desk Top	Restricted	0.03	230	NDA	PASS
33	Pt Inj Rm	Desk Top	Restricted	0.03	198	NDA	PASS
34	Pt Inj Rm	Desk Top	Restricted	0.03	208	NDA	PASS
35	Pt Inj Rm	Desk Top	Restricted	0.03	200	NDA	PASS
36	Pt Inj Rm	Desk Top	Restricted	0.03	230	NDA	PASS
37	Pt Inj Rm	Desk Top	Restricted	0.03	219	NDA	PASS

SURVEY				Radiation Survey			Results
No.	Room	Location	Area	Ambient (mR/hr)	Wipe (cpm)	Wipe (dpm)	
			Background	0.03	212		

Survey Performed By:	Audrey Wegst, Ph.D. Jiping Zhan, Ph.D.,	Background Count:	212
Survey Performed On:	06/22/16	Delta1 (net counts):	34
Wipe Test Samples Counted By:	Jiping Zhan, Ph.D	Delta2 (net counts):	70
Wipe Test Samples Counted On:	06/23/16	Decision Limit (L _c):	246

Method: Each leak test sample was collected by wiping an alcohol pad over the exposed surface of the source.

No Detectable Activity (NDA): Wipe count equal to or less than the Decision Limit [Bkg + 2.33*SQRT(Bkg)]

Licensee: Golden Valley Memorial Hospital
 Address: 1600 North Second Street
 Clinton, MO 64735

License Number: 24-16597-01
 Expiration: 08/31/21

RADIATION SURVEY - STRESS LAB

06/22/16

SURVEY				Radiation Survey			Results
No.	Room	Location	Area	Ambient (mR/hr)	Wipe (cpm)	Wipe (dpm)	
			Background	0.03	212		
1	Stress Lab	Floor	Restricted	0.03	210	NDA	PASS
2	Stress Lab	Floor	Restricted	0.03	204	NDA	PASS
3	Stress Lab	Floor	Restricted	0.03	210	NDA	PASS
4	Stress Lab	Floor	Restricted	0.03	223	NDA	PASS
5	Stress Lab	Floor	Restricted	0.03	223	NDA	PASS
6	Stress Lab	Floor	Restricted	0.03	212	NDA	PASS
7	Stress Lab	Floor	Restricted	0.03	212	NDA	PASS
8	Stress Lab	Floor	Restricted	0.03	217	NDA	PASS
9	Stress Lab	Floor	Restricted	0.03	229	NDA	PASS
10	Stress Lab	Floor	Restricted	0.03	234	NDA	PASS
11	Stress Lab	Floor	Restricted	0.03	216	NDA	PASS
12	Stress Lab	Floor	Restricted	0.03	210	NDA	PASS
13	Stress Lab	Floor	Restricted	0.03	223	NDA	PASS
14	Stress Lab	Floor	Restricted	0.03	218	NDA	PASS
15	Stress Lab	Floor	Restricted	0.03	234	NDA	PASS
16	Stress Lab	Floor	Restricted	0.03	223	NDA	PASS
17	Stress Lab	Floor	Restricted	0.03	210	NDA	PASS
18	Stress Lab	Floor	Restricted	0.03	210	NDA	PASS
19	Stress Lab	Floor	Restricted	0.03	223	NDA	PASS
20	Stress Lab	Floor	Restricted	0.03	204	NDA	PASS
21	Stress Lab	Floor	Restricted	0.03	226	NDA	PASS
22	Stress Lab	Floor	Restricted	0.03	226	NDA	PASS
23	Stress Lab	Floor	Restricted	0.03	218	NDA	PASS
24	Stress Lab	Floor	Restricted	0.03	229	NDA	PASS
25	Stress Lab	Floor	Restricted	0.03	216	NDA	PASS
26	Stress Lab	Floor	Restricted	0.03	216	NDA	PASS
27	Stress Lab	Floor	Restricted	0.03	204	NDA	PASS
28	Stress Lab	Floor	Restricted	0.03	234	NDA	PASS
29	Stress Lab	Floor	Restricted	0.03	217	NDA	PASS
30	Stress Lab	Floor	Restricted	0.03	218	NDA	PASS
31	Stress Lab	Floor	Restricted	0.03	223	NDA	PASS
32	Stress Lab	Floor	Restricted	0.03	229	NDA	PASS
33	Stress Lab	Floor	Restricted	0.03	212	NDA	PASS
34	Stress Lab	Floor	Restricted	0.03	226	NDA	PASS
35	Stress Lab	Floor	Restricted	0.03	210	NDA	PASS
36	Stress Lab	Floor	Restricted	0.03	217	NDA	PASS

SURVEY				Radiation Survey			Results
No.	Room	Location	Area	Ambient (mR/hr)	Wipe (cpm)	Wipe (dpm)	
			Background	0.03	212		
							Restricted
							FAIL

Survey Performed By:	Audrey Wegst, Ph.D. Jiping Zhan, Ph.D., C	Background Count:	212
Survey Performed On:	06/22/16	Delta1 (net counts):	34
Wipe Test Samples Counted By:	Jiping Zhan, Ph.D	Delta2 (net counts):	70
Wipe Test Samples Counted On:	06/23/16	Decision Limit (L _c):	246

Method: Each leak test sample was collected by wiping an alcohol pad over the exposed surface of the source.

No Detectable Activity (NDA): Wipe count equal to or less than the Decision Limit [Bkg + 2.33*SQRT(Bkg)]

JUMH
1600 N. 2nd
Clinton, MO
64735

neopost,[®]
07/20/2016
FIRST CLASS MAIL
US POSTAGE \$01.57[®]
73R 84735
041L11239528



Materials Licensing Branch
U.S. Nuclear Regulatory Commission, Region III
2443 Warransville Road, Ste 216
Lisle, IL 60532-4352

RECEIVED JUL 25 2016