

# Beaumont

---

Beaumont Hospital – Taylor  
10000 Telegraph Road  
Taylor, MI 48180

U.S. Nuclear Regulatory Commission  
Region III  
Materials Licensing Branch  
2443 Warrenville Road  
Suite 210  
Lisle, IL 60532

Re: Letter of Notification for 21-17789-01

Dear Madam or Sir:

As per 10 CFR 35.14 (5) we are notifying you of the reconstruction of our present Nuclear Medicine section as follows:

- We have included a plan diagram of our present department.
- We will remain a unit dosage 10 CFR 35.100 and 35.200 facility only.
- We have included a plan diagram of our reconfigured department.
- All walls with the areas shown will be shielded with 1/16" of lead lining from the floor to ceiling to include doors and jambs.
- Except for a change of storage cabinets the Hot Lab will remain as is and always secured.
- We have included a final survey and wipe test of our existing area to confirm no residual contamination prior to reconstruction.

If you require any additional information, please contact our Medical Nuclear Physicist Thomas M. Kumpuris, M.S. at [tkumpuris@mpcphysics.com](mailto:tkumpuris@mpcphysics.com)

Sincerely,

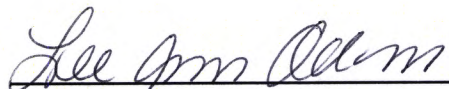

---

Lee Ann Odom PT, MSA  
Division President  
Beaumont Hospital-Taylor  
10000 Telegraph Road  
Taylor, Michigan 48180  
Phone: 313-295-5253  
Fax: 313-295-5085

RECEIVED JUL 11 2016

Beaumont Hospital – Taylor

Material's License 21-17789-01

Existing Nuclear Medicine Section 12/2015

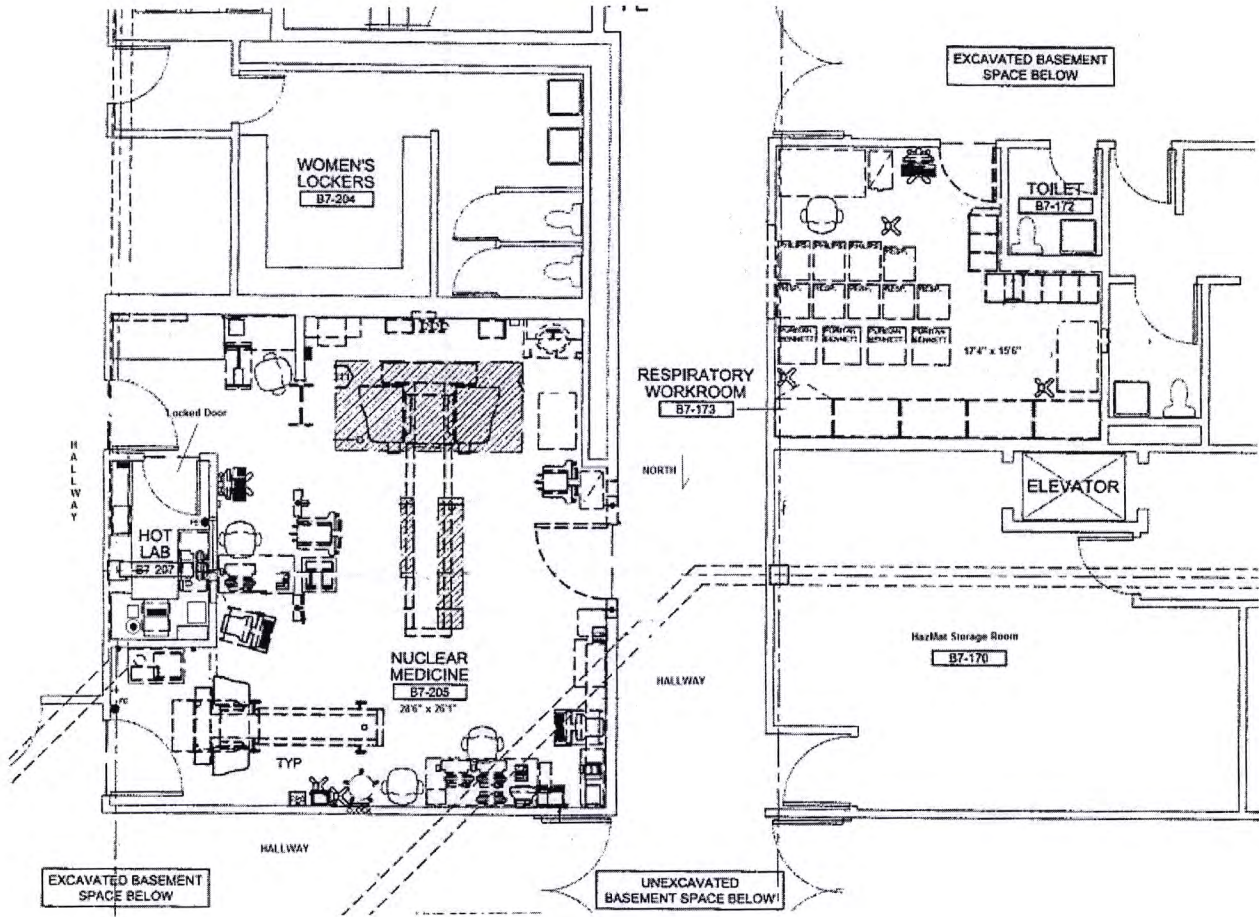



<b>NUCLEAR MEDICINE</b>	
1- Bkg (Hall)	
2- Dose Prep Shield	
3- Hot Lab Counter	
4- Lead Cabinet	
5- Injection Chair	
6. MG	
7- SMV Camera	
8- Uptake Probe	

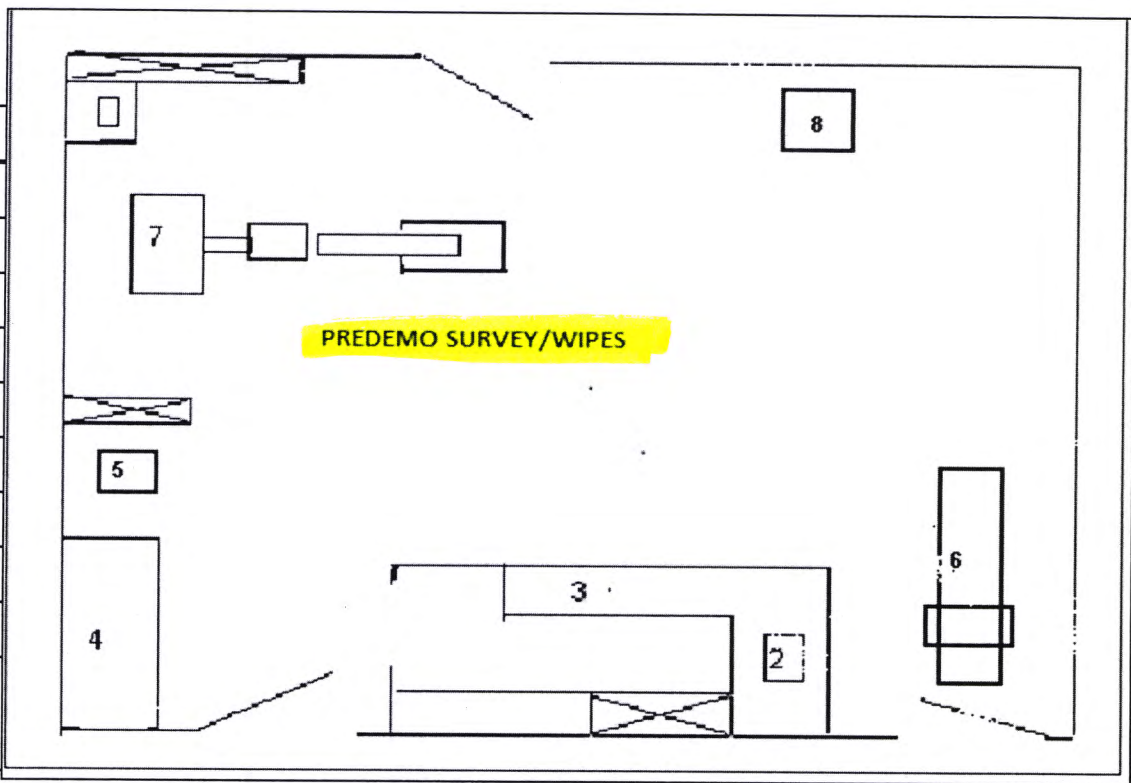

This is a single room unit dose Nuclear Medicine facility located on the first floor of the Oakwood Hospital-Taylor

<b>CARDIOLOGY</b>
<b>STRESS ROOM</b>
9 - Stretcher 1A
10 - Treadmill 1B
11 - Stretcher 2A
12 - Treadmill 2B

The Cardiology Stress Room is located ~300 feet to the North West on the same floor

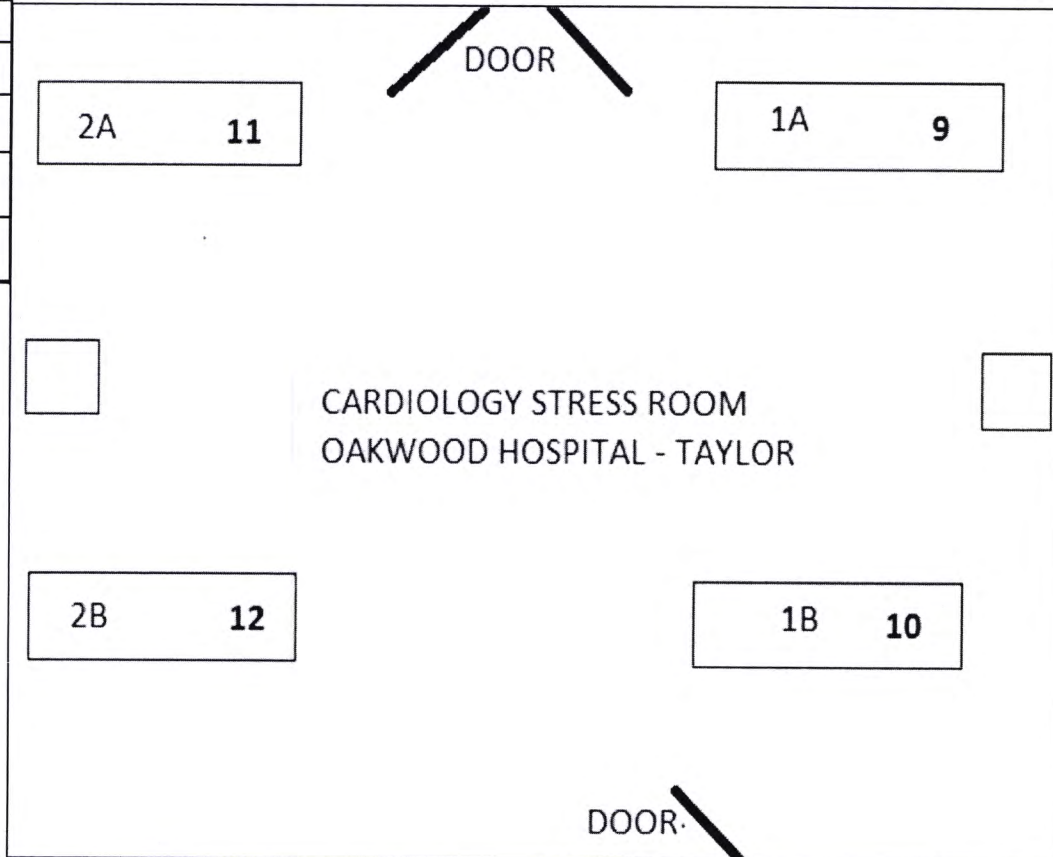

# Oakwood Heritage Hospital

## Nuclear Medicine Department

Daily Report for Date : 02-29-2016

02-29-16	LUDLUM 214963	Ludlum	PROBE 226487	02-01-17	TR	Check Source	1.4 mR/hr	Passed	
02-29-16	LUDLUM 214963	Ludlum	PROBE 226487	02-01-17	TR	Battery Check	Pass	Passed	Pass;Fail;Not Done
02-29-16	CAPTUS 3000 WEL		900580	03-14-16	TR	Background	268 CPM	Passed	
02-29-16	HAIER-PAT REFRIGERATOR	HAIER REFRIGERATOR	ECR27		TR	TEMPERATURE	30 °F	Passed	30.000;50.000
02-29-16	REFRIGERATOR	KENMORE	EXCELLEN		TR	TEMP CHECK	40 °F	Passed	30.000;50.000

### Monitor Daily Report :

Group: <<None>>

Date: 02-29-2016  
Instrument: LUDLUM 214963  
Trigger Limit: 0.05 mR/hr  
Background: .02 mR/hr

Time: 16:57  
Serial: PROBE 226487  
Efficiency: N/A

Tech : TR  
Manufacturer : Ludlum  
Next Cal. : 02-01-2017

Areas	mR/hr	Trigger Limit	Areas	mR/hr	Trigger Limit
AREA 10 ( STRETCHER )	0.02	0.50	AREA 11 ( TREADMILL 2 )	0.02	0.50
AREA 12 ( STRETCHER 2 )	0.02	0.50	AREA 1 ( HALL )	0.02	0.50
AREA 2 ( DOSE PREP SHIELD )	0.06	0.50	AREA 3 ( HOT LAB COUNTER )	0.02	0.50
AREA 4 ( LEAD CABINET )	0.02	0.50	AREA 5 ( INJECTION CHAIR )	0.02	0.50
AREA 7 ( SMV CAMERA )	0.02	0.50	AREA 6 ( MG CAMERA )	0.02	0.50
AREA 8 ( UPTAKE PROBE )	0.02	0.50	AREA 9 ( TREADMILL )	0.02	0.50

**Bold values** indicate the TRIGGER LIMIT has been exceeded.

Initials	Personnel Name
TR	- TERRI RIGGS
SAM	- SANDRA WILLIAMS
JM	- JULIE MARTIN
TBS	- THERESE BOK-SCHMIDT

Tech. Signature : \_\_\_\_\_



**Oakwood Heritage Hospital**

Nuclear Medicine Department

10000 Telegraph Rd, Taylor, Michigan

LIC.# 21-17789-01

---

**Area Wipe Report**

**Group Name : <<None>>**

**Date Range : 02/01/2016 To 02/29/2016**

Date/Time	Tech	In		Ck.Src	Bkg	Area 1		Area 2		Area 3		Area 4		Area 5		Area 6		Area 7		Area 8		Area 9		Area 10	
		st	Batt			CPM	DPM	CPM	DPM	CPM	DPM	CPM	DPM	CPM	DPM	CPM	DPM	CPM	DPM	CPM	DPM	CPM	DPM	CPM	DPM
02-05-16 08:46	JM	3	--	--	254	0	0	0	0	0	0	0	0	0	0	0	0	0	0	0	0	0	0	0	
02-10-16 15:06	JM	3	--	--	244	17	17	0	0	0	0	0	0	0	0	0	0	0	0	0	0	0	0	0	
02-17-16 14:29	JM	3	--	--	213	1	1	29	29	176	176	7	7	14	14	0	0	0	0	24	24	23	23	0	0
02-26-16 17:19	TR	3	--	--	265	0	0	0	0	1	1	0	0	0	0	0	0	0	0	0	0	0	0	0	



# Oakwood Heritage Hospital

Nuclear Medicine Department

Area Wipe Report : Group Name : <<None>>

Date Range : 02/01/2016 To 02/29/2016<sup>016</sup>

Date/Time	Tech	In st	Batt	Ck.Src	Bkg CPM	Area 11 CPM	DPM	Area 12 CPM	DPM
02-05-16 08:46	JM	3	--	--	254	0	0	0	0
02-10-16 15:06	JM	3	--	--	244	0	0	0	0
02-17-16 14:29	JM	3	--	--	213	14	14	0	0
02-26-16 17:19	TR	3	--	--	265	0	0	0	0

### Note:

Areas            are over trigger limit.

\*\*\*\*\*

Battery Check: "P" = Pass "F" = Fail

Test Not performed or Not Required: "..."

Check source reading was done today but not as part of this survey/wipe test: " \* "

Wipe Area : 300.00 Sq. CM

Trigger Limit : 6600.00 DPM

Current Area Trigger Limits (DPM): 6,600.00

### Instrument Details:

#	Instrument	Manufacturer	Next Cal Date	Serial No	Efficiency
3	CAPTUS 3000 WELL		03-14-2016	900580	100.00%

### Original area names:

Generic Name	Actual area name	Generic Name	Actual area name	Generic Name	Actual area name
Area 1	AREA 1 (HALL)	Area 2	AREA 2 ( DOSE PREP SHIELD	Area 3	AREA 3 ( HOT LAB COUNTER)
Area 4	AREA 4 ( LEAD CABINET)	Area 5	AREA 5 ( INJECTION CHAIR)	Area 6	AREA 6 ( MG CAMERA )

# Oakwood Heritage Hospital

Nuclear Medicine Department

Area Wipe Report : Group Name : <<None>>

Date Range : 02/01/2016 To 02/29/2016

---

Area 7	AREA 7 ( SMV CAMERA)	Area 8	AREA 8 ( UPTAKE PROBE)	Area 9	AREA 9 ( TREADMILL)
Area 10	AREA 10 ( STRETCHER)	Area 11	AREA 11 ( TREADMILL 2 )	Area 12	AREA 12 ( STRETCHER 2 )

**Tech Information:**

Tech	Tech Name
JM	JULIE MARTIN
TR	TERRI RIGGS

**DURING CONSTRUCTION**

**WIPE/SURVEY AREAS**

<b>NUCLEAR MEDICINE</b>								
1- Bkg (Hall)								
2- Dose Prep Shield								
3- Hot Lab Counter	<i>Please See Attached</i>							
4- Lead Cabinet								
5- Injection Chair								
6- MG								
7- Injection Room								
8- Uptake Probe								

**WIPE /SURVEY AREAS**

The Cardiology Stress Room is located ~300 feet to the North West on the same floor

<b>CARDIOLOGY</b>
<b>STRESS ROOM</b>
9 - Stretcher 1A
10 - Treadmill 1B
11 - Stretcher 2A
12 - Treadmill 2B

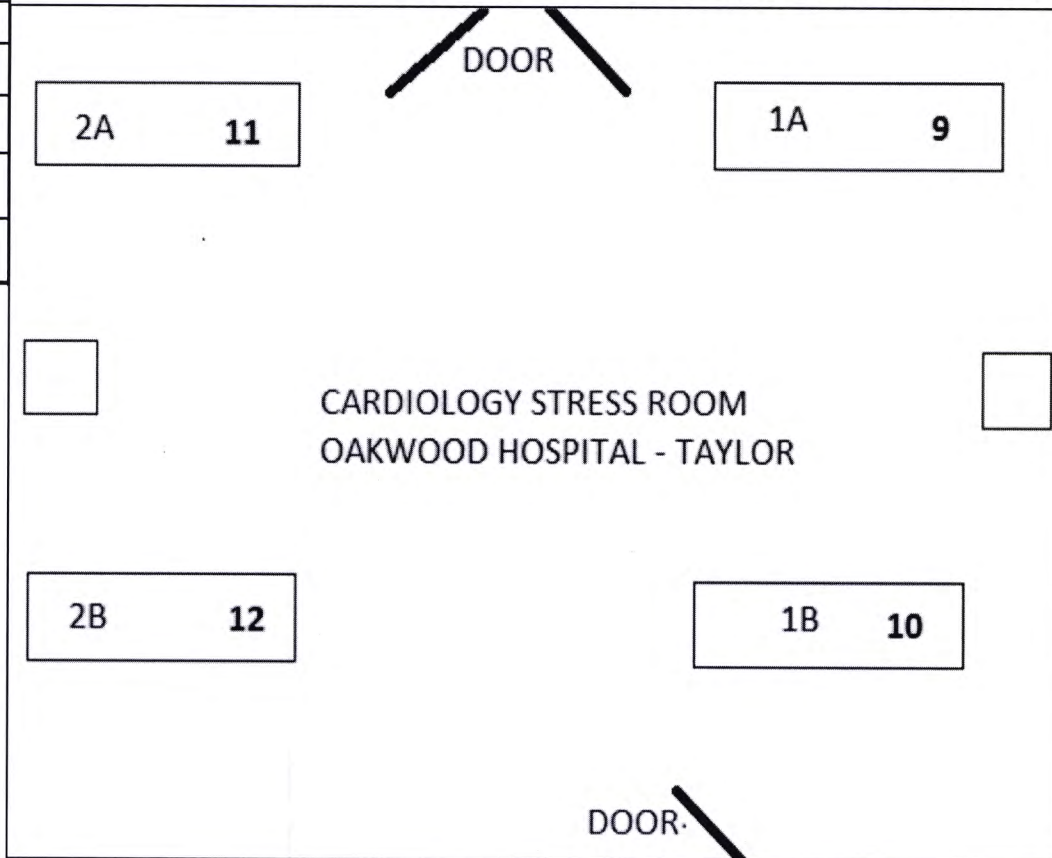



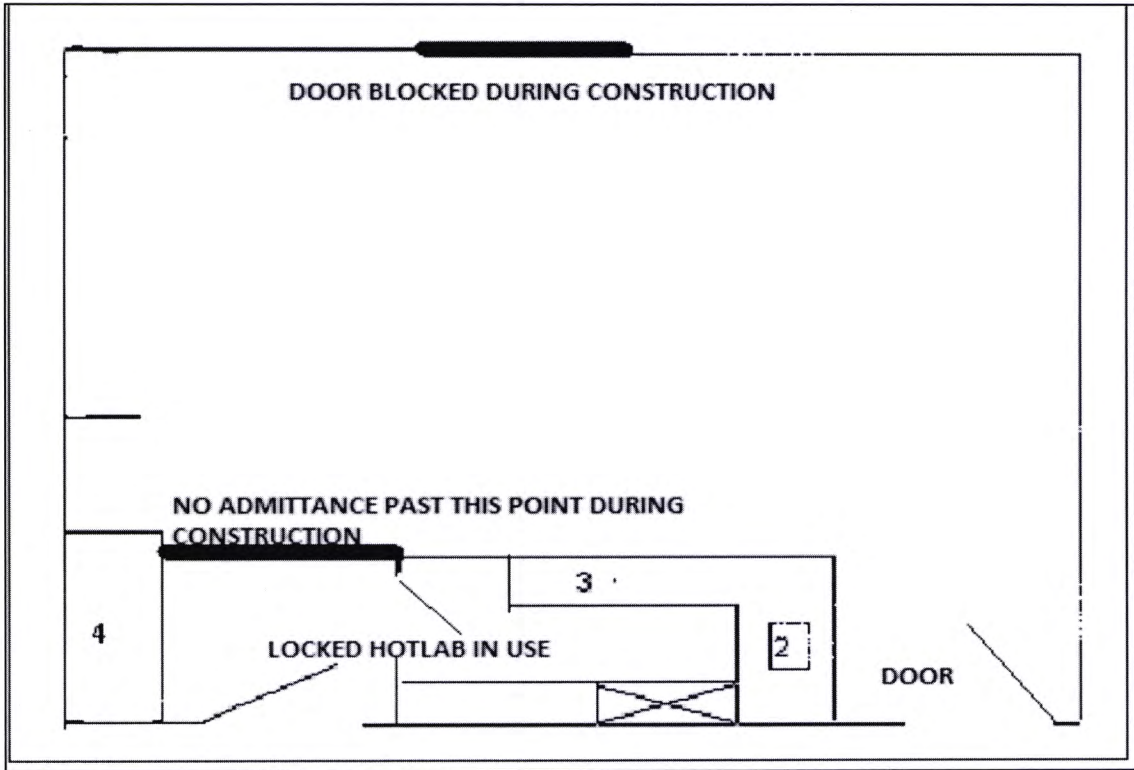

X-RAY ROOM TEMPORARY USE FOR INJECTIONS DURING CONSTRUCTION

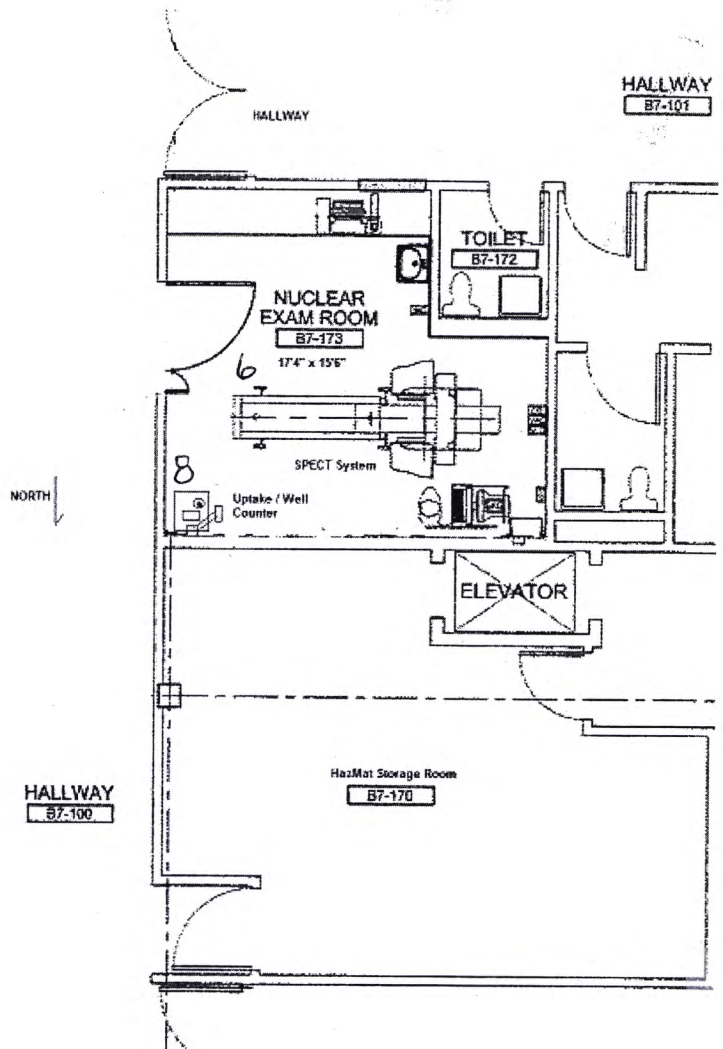
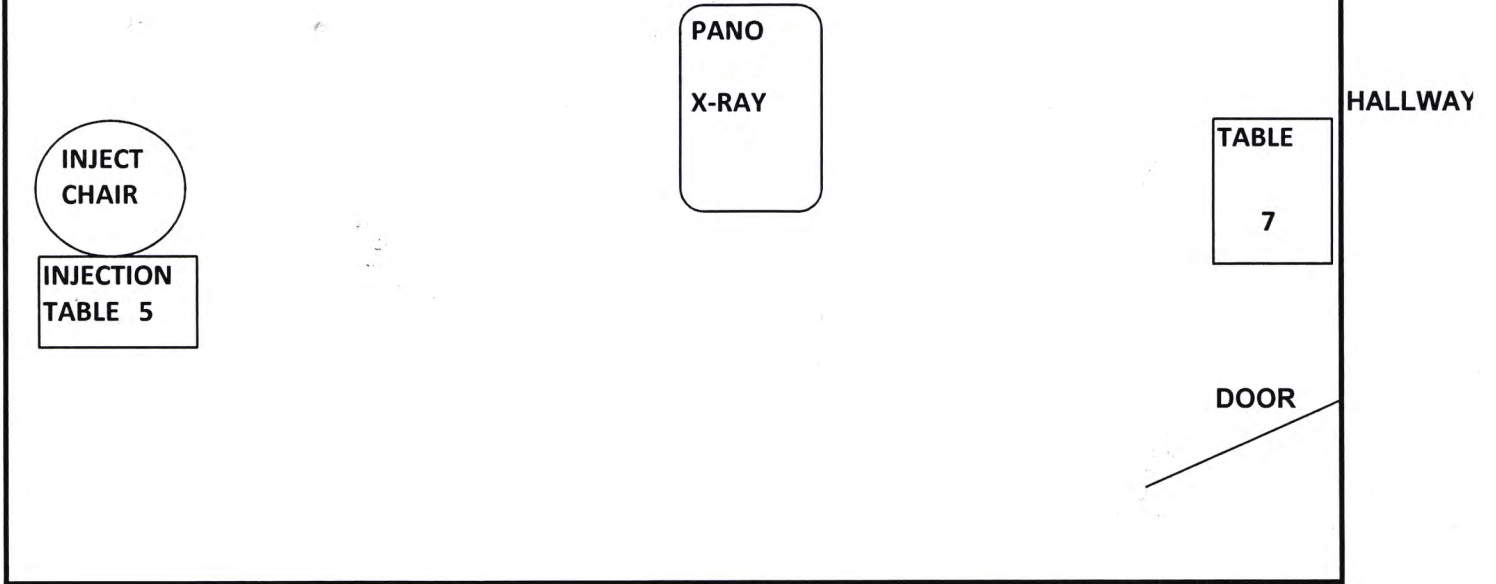

Beaumont Hospital – Taylor

Material's License 21-17789-01

NEW Nuclear Medicine Section - 2016

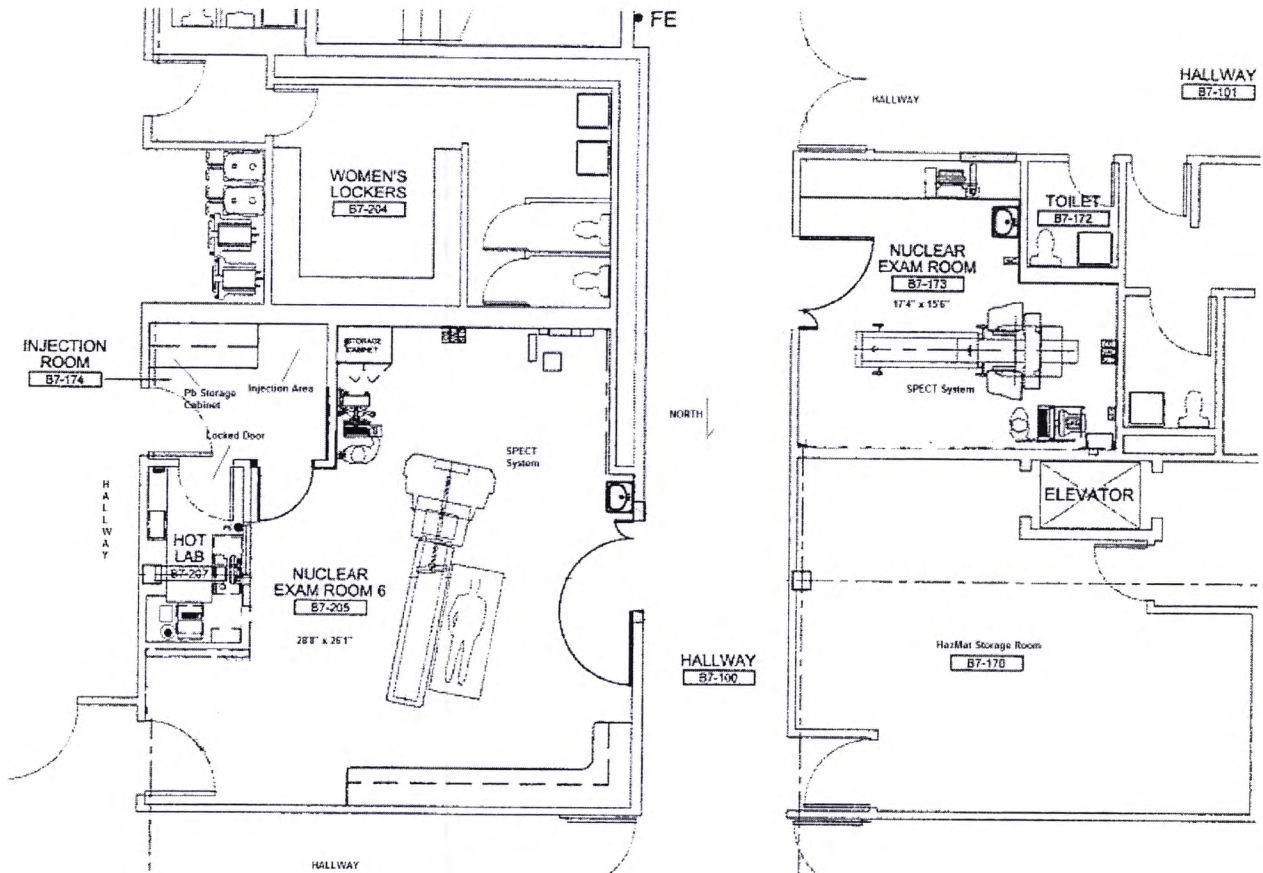



<b>NUCLEAR MEDICINE</b>	
1- Bkg (Hall)	
2- Dose Prep Shield	
3- Hot Lab Counter	
4- Lead Cabinet	
5- Injection Chair	
6- Injection Table	
7- Discovery 630	
8- Uptake Probe	

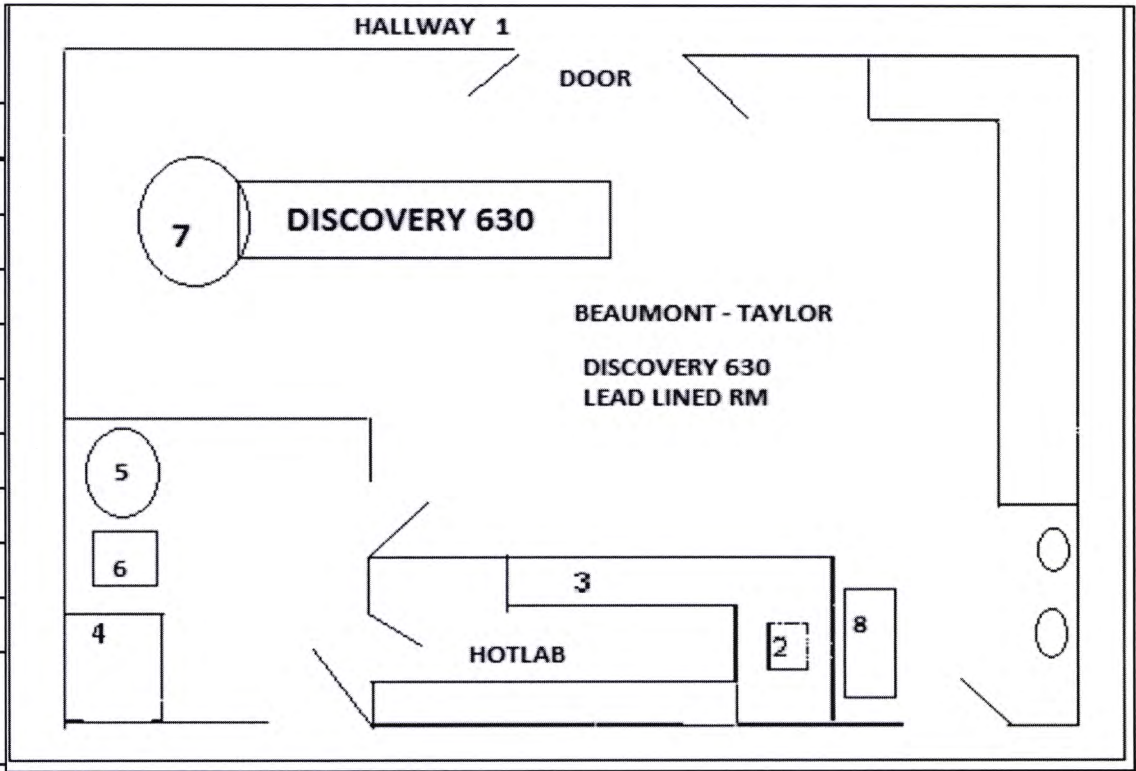

<b>CARDIOLOGY</b>	
<b>STRESS ROOM</b>	
9 - Stretcher 1A	
10 - Treadmill 1B	
11 - Stretcher 2A	
12 - Treadmill 2B	

The Cardiology Stress Room is located ~300 feet to the North West on the same floor

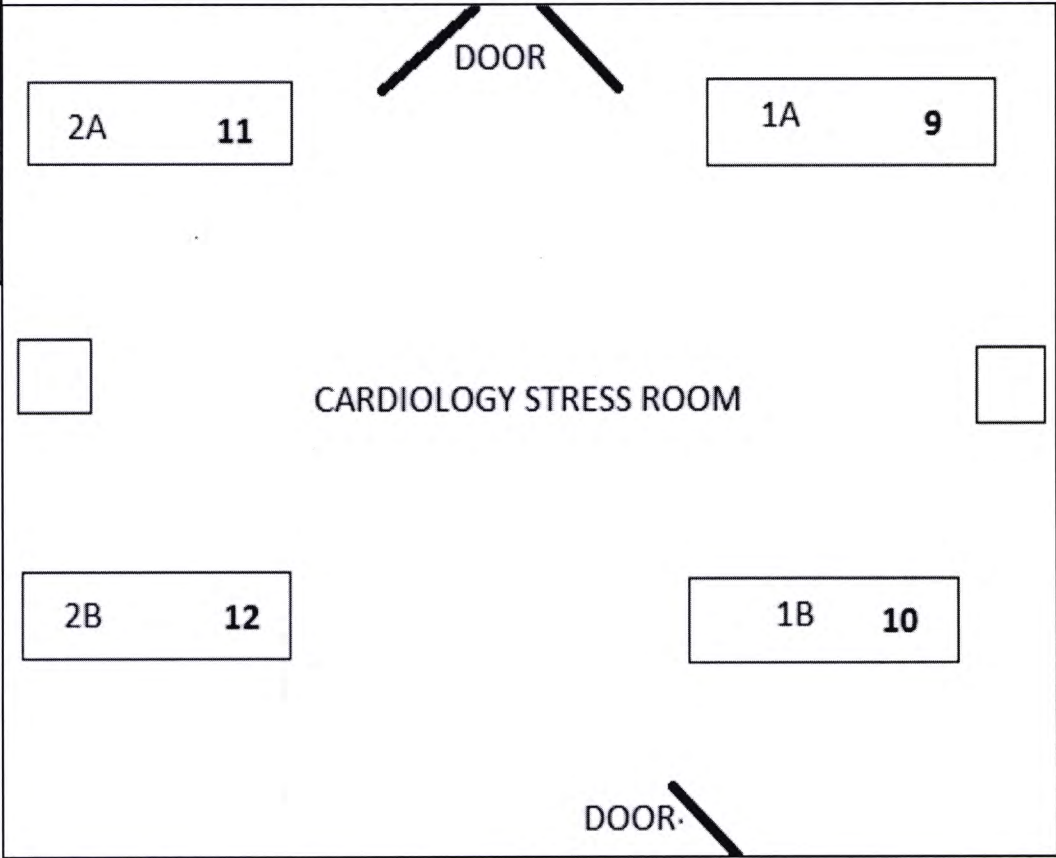

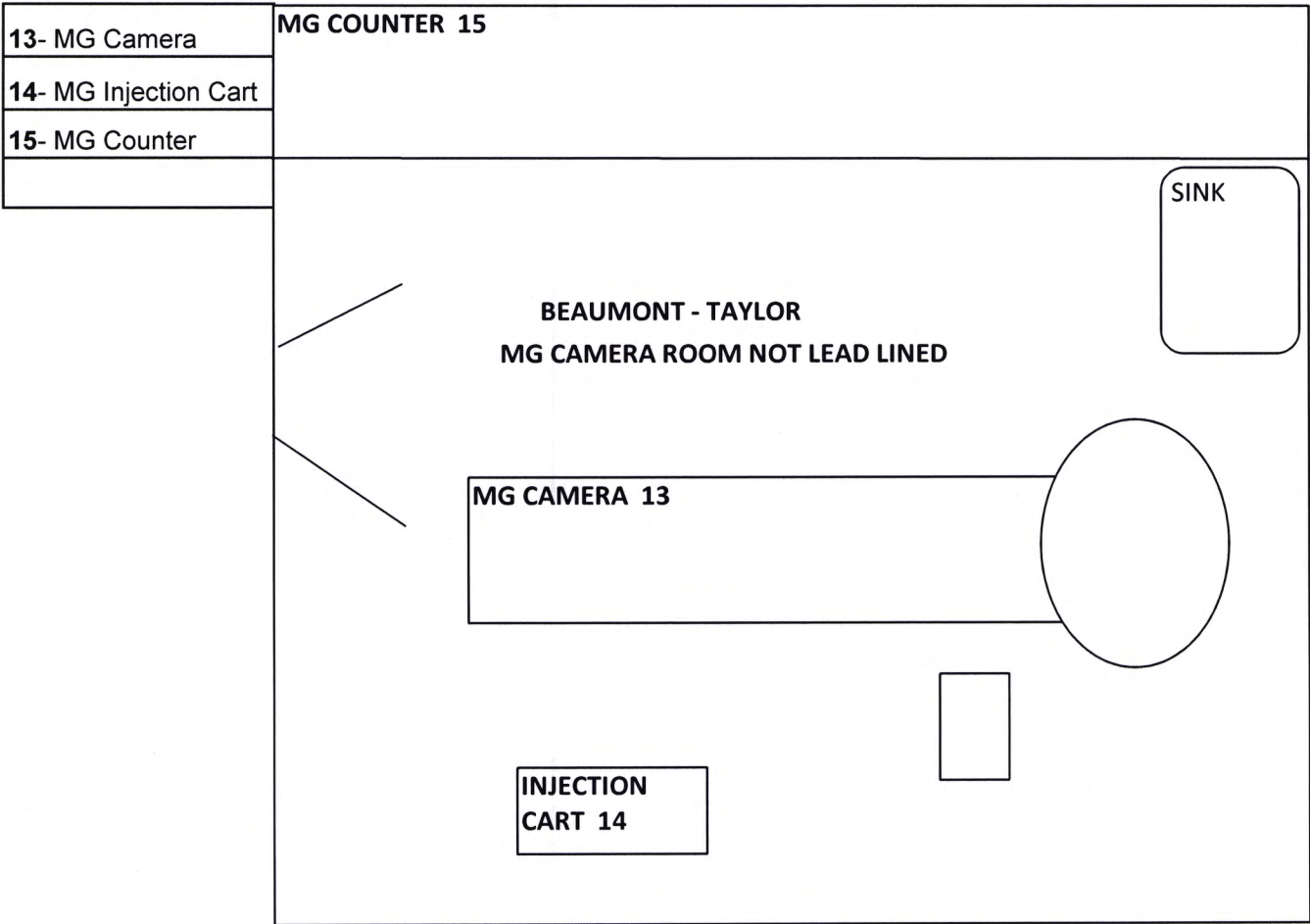

# Beaumont

---

Beaumont Hospital – Taylor  
10000 Telegraph Road  
Taylor, MI 48180

U.S. Nuclear Regulatory Commission  
Region III  
Materials Licensing Branch  
2443 Warrenville Road  
Suite 210  
Lisle, IL 60532

Re: Letter of Notification for 21-17789-01

Dear Madam or Sir:

As per 10 CFR 35.14 (5) we are notifying you of the reconstruction of our present Nuclear Medicine section as follows:

- We have included a plan diagram of our present department.
- We will remain a unit dosage 10 CFR 35.100 and 35.200 facility only.
- We have included a plan diagram of our reconfigured department.
- All walls with the areas shown will be shielded with 1/16" of lead lining from the floor to ceiling to include doors and jams.
- Except for a change of storage cabinets the Hot Lab will remain as is and always secured.
- We have included a final survey and wipe test of our existing area to confirm no residual contamination prior to reconstruction.

If you require any additional information, please contact our Medical Nuclear Physicist Thomas M. Kumpuris, M.S. at [tkumpuris@mpcphysics.com](mailto:tkumpuris@mpcphysics.com)

Sincerely,

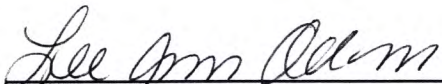

---

Lee Ann Odom PT, MSA  
Division President  
Beaumont Hospital-Taylor  
10000 Telegraph Road  
Taylor, Michigan 48180  
Phone: 313-295-5253  
Fax: 313-295-5085



Beaumont Hospital – Taylor

Material's License 21-17789-01

Existing Nuclear Medicine Section 12/2015

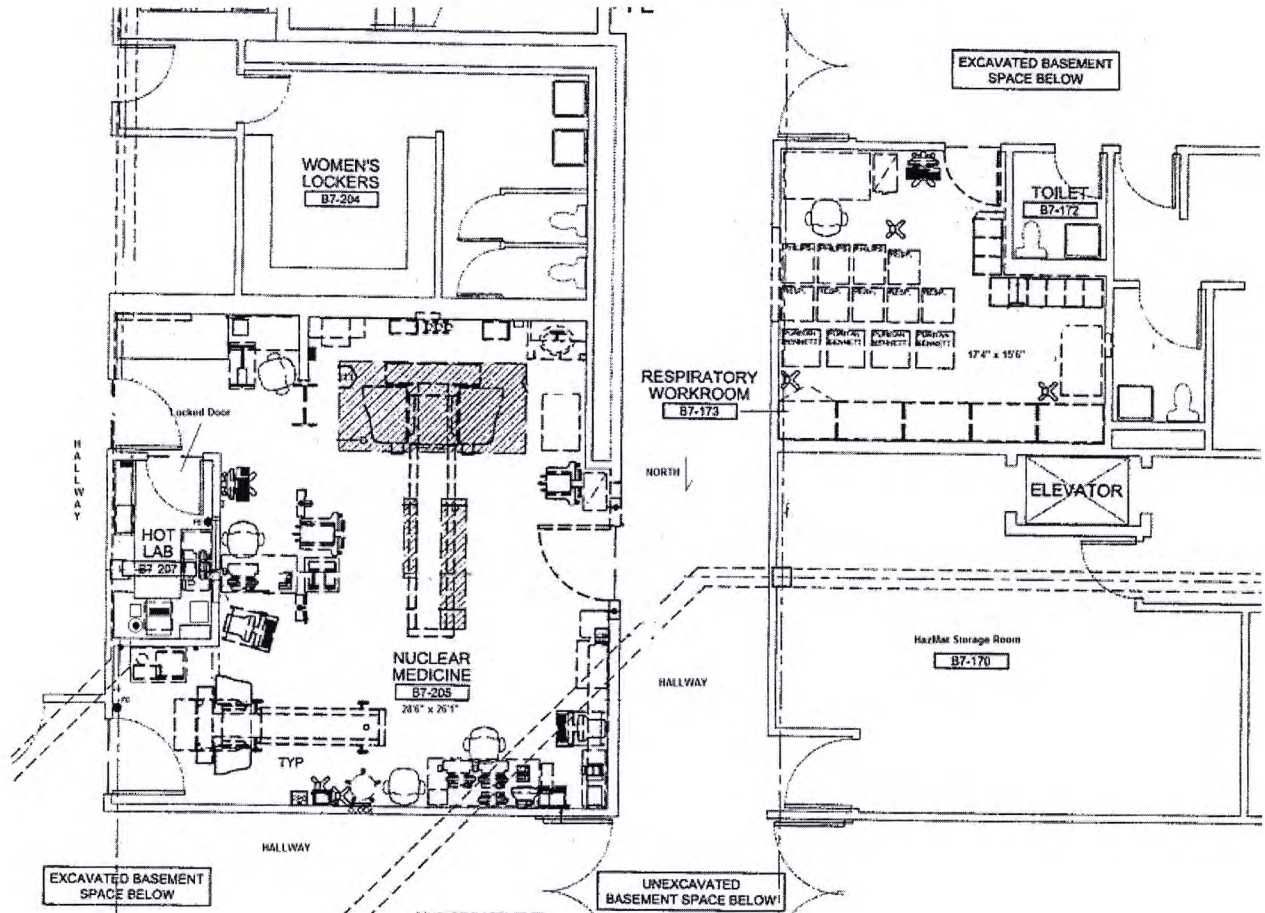

<b>NUCLEAR MEDICINE</b>
1- Bkg (Hall)
2- Dose Prep Shield
3- Hot Lab Counter
4- Lead Cabinet
5- Injection Chair
6. MG
7- SMV Camera
8- Uptake Probe

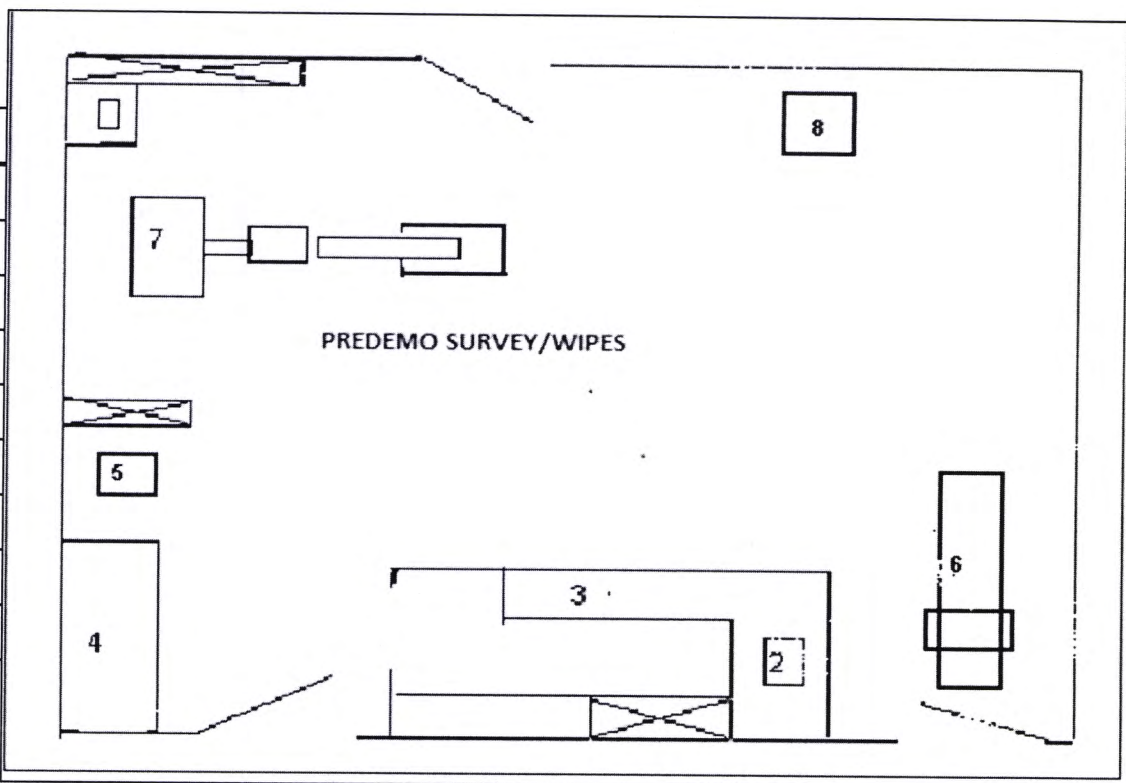

This is a single room unit dose Nuclear Medicine facility located on the first floor of the Oakwood Hospital-Taylor

<b>CARDIOLOGY</b>
<b>STRESS ROOM</b>
9 - Stretcher 1A
10 - Treadmill 1B
11 - Stretcher 2A
12 - Treadmill 2B

The Cardiology Stress Room is located ~300 feet to the North West on the same floor

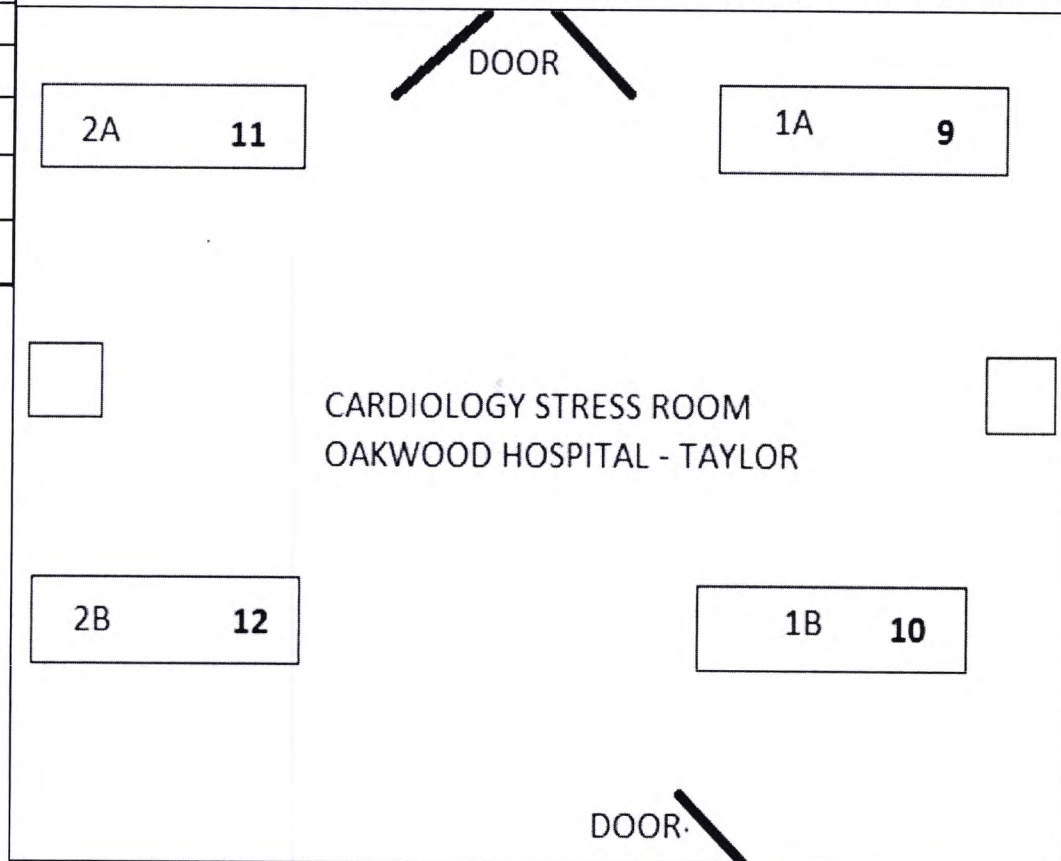

# Oakwood Heritage Hospital

## Nuclear Medicine Department

Daily Report for Date : 02-29-2016

02-29-16	LUDLUM 214963	Ludlum	PROBE 226487	02-01-17	TR	Check Source	1.4 mR/hr	Passed
02-29-16	LUDLUM 214963	Ludlum	PROBE 226487	02-01-17	TR	Battery Check	Pass	Passed Pass;Fail;Not Done
02-29-16	CAPTUS 3000 WEL		900580	03-14-16	TR	Background	268 CPM	Passed
02-29-16	HAIER-PAT REFRIG	HAIER REFIECR27			TR	TEMPERATURE	30 °F	Passed 30.000;50.000
02-29-16	REFRIGERATOR	KENMORE EXCELLEN			TR	TEMP CHECK	40 °F	Passed 30.000;50.000

### Monitor Daily Report :

Group: <<None>>

Date: 02-29-2016      Time: 16:57      Tech : TR  
Instrument: LUDLUM 214963      Serial: PROBE 226487      Manufacturer : Ludlum  
Trigger Limit: 0.05 mR/hr      Efficiency: N/A      Next Cal. : 02-01-2017  
Background: .02 mR/hr

Areas	mR/hr	Trigger Limit	Areas	mR/hr	Trigger Limit
AREA 10 ( STRETCHER )	0.02	0.50	AREA 11 ( TREADMILL 2 )	0.02	0.50
AREA 12 ( STRETCHER 2 )	0.02	0.50	AREA 1 ( HALL )	0.02	0.50
AREA 2 ( DOSE PREP SHIELD )	0.06	0.50	AREA 3 ( HOT LAB COUNTER )	0.02	0.50
AREA 4 ( LEAD CABINET )	0.02	0.50	AREA 5 ( INJECTION CHAIR )	0.02	0.50
AREA 7 ( SMV CAMERA )	0.02	0.50	AREA 6 ( MG CAMERA )	0.02	0.50
AREA 8 ( UPTAKE PROBE )	0.02	0.50	AREA 9 ( TREADMILL )	0.02	0.50

**Bold values** indicate the TRIGGER LIMIT has been exceeded.

Initials	Personnel Name
TR	- TERRI RIGGS
SAM	- SANDRA WILLIAMS
JM	- JULIE MARTIN
TBS	- THERESE BOK-SCHMIDT

Tech. Signature : \_\_\_\_\_





# Oakwood Heritage Hospital

Nuclear Medicine Department

10000 Telegraph Rd, Taylor, Michigan

LIC.# 21-17789-01

## Area Wipe Report

Group Name : <<None>>

Date Range : 02/01/2016 To 02/29/2016

Date/Time	Tech	In st Batt	Ck.Src	Bkg CPM	Area 1		Area 2		Area 3		Area 4		Area 5		Area 6		Area 7		Area 8		Area 9		Area 10	
					CPM	DPM	CPM	DPM	CPM	DPM	CPM	DPM	CPM	DPM	CPM	DPM	CPM	DPM	CPM	DPM	CPM	DPM	CPM	DPM
02-05-16 08:46	JM	3 -- --	--	254	0	0	0	0	0	0	0	0	0	0	0	0	0	0	0	0	0	0	0	0
02-10-16 15:06	JM	3 -- --	--	244	17	17	0	0	0	0	0	0	0	0	0	0	0	0	0	0	0	0	0	0
02-17-16 14:29	JM	3 -- --	--	213	1	1	29	29	176	176	7	7	14	14	0	0	0	0	24	24	23	23	0	0
02-26-16 17:19	TR	3 -- --	--	265	0	0	0	0	1	1	0	0	0	0	0	0	0	0	0	0	0	0	0	0

# Oakwood Heritage Hospital

## Nuclear Medicine Department

Area Wipe Report : Group Name : <<None>>

Date Range : 02/01/2016 To 02/29/2016

Date/Time	Tech	In st	Batt	Ck.Src	Bkg CPM	Area 11 CPM	Area 11 DPM	Area 12 CPM	Area 12 DPM
02-05-16 08:46	JM	3	--	--	254	0	0	0	0
02-10-16 15:06	JM	3	--	--	244	0	0	0	0
02-17-16 14:29	JM	3	--	--	213	14	14	0	0
02-26-16 17:19	TR	3	--	--	265	0	0	0	0

### Note:

Areas            are over trigger limit.

\*\*\*\*\*

Battery Check: "P" = Pass "F" = Fail

Test Not performed or Not Required: "--"

Check source reading was done today but not as part of this survey/wipe test: " \* "

Wipe Area : 300.00 Sq. CM

Trigger Limit : 6600.00 DPM

Current Area Trigger Limits (DPM): 6,600.00

### Instrument Details:

#	Instrument	Manufacturer	Next Cal Date	Serial No	Efficiency
3	CAPTUS 3000 WELL		03-14-2016	900580	100.00%

### Original area names:

Generic Name	Actual area name	Generic Name	Actual area name	Generic Name	Actual area name
Area 1	AREA 1 (HALL)	Area 2	AREA 2 ( DOSE PREP SHIELD	Area 3	AREA 3 ( HOT LAB COUNTER)
Area 4	AREA 4 ( LEAD CABINET)	Area 5	AREA 5 ( INJECTION CHAIR)	Area 6	AREA 6 ( MG CAMERA )

**Oakwood Heritage Hospital**

Nuclear Medicine Department

Area Wipe Report : Group Name : <<None>>

Date Range : 02/01/2016 To 02/29/2016

---

Area 7	AREA 7 ( SMV CAMERA)	Area 8	AREA 8 ( UPTAKE PROBE)	Area 9	AREA 9 ( TREADMILL)
Area 10	AREA 10 ( STRETCHER)	Area 11	AREA 11 ( TREADMILL 2 )	Area 12	AREA 12 ( STRETCHER 2 )

**Tech Information:**

Tech	Tech Name
JM	JULIE MARTIN
TR	TERRI RIGGS



**DURING CONSTRUCTION**

**WIPE/SURVEY AREAS**

<b>NUCLEAR MEDICINE</b>								
1- Bkg (Hall)								
2- Dose Prep Shield								
3- Hot Lab Counter	<i>Please See Attached</i>							
4- Lead Cabinet								
5- Injection Chair								
6- MG								
7- Injection Room								
8- Uptake Probe								

**WIPE /SURVEY AREAS**

The Cardiology Stress Room is located ~300 feet to the North West on the same floor

<b>CARDIOLOGY</b>
<b>STRESS ROOM</b>
9 - Stretcher 1A
10 - Treadmill 1B
11 - Stretcher 2A
12 - Treadmill 2B

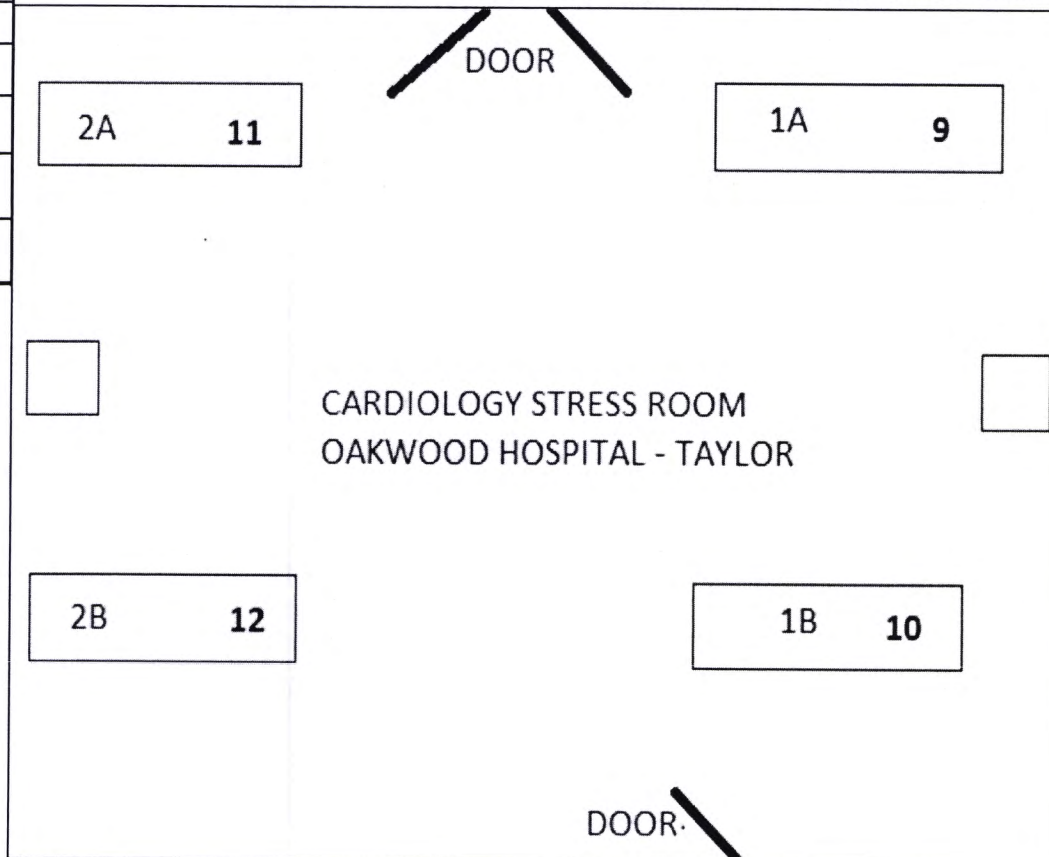

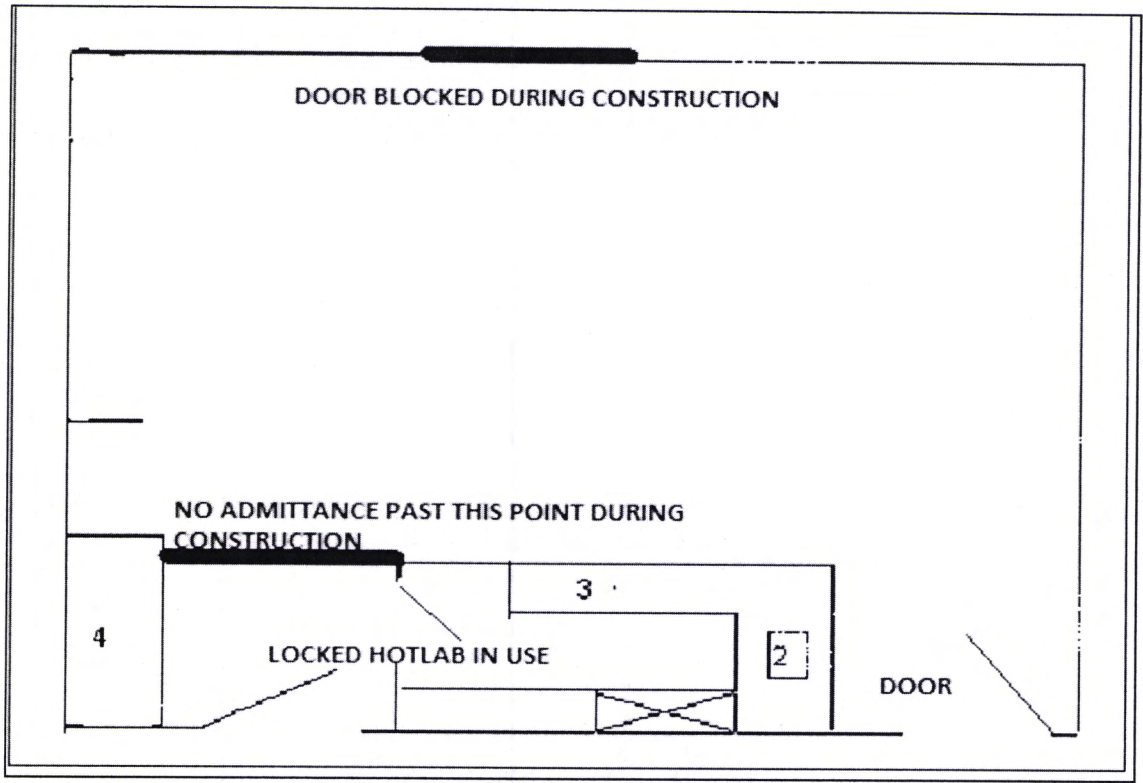

X-RAY ROOM TEMPORARY USE FOR INJECTIONS DURING CONSTRUCTION

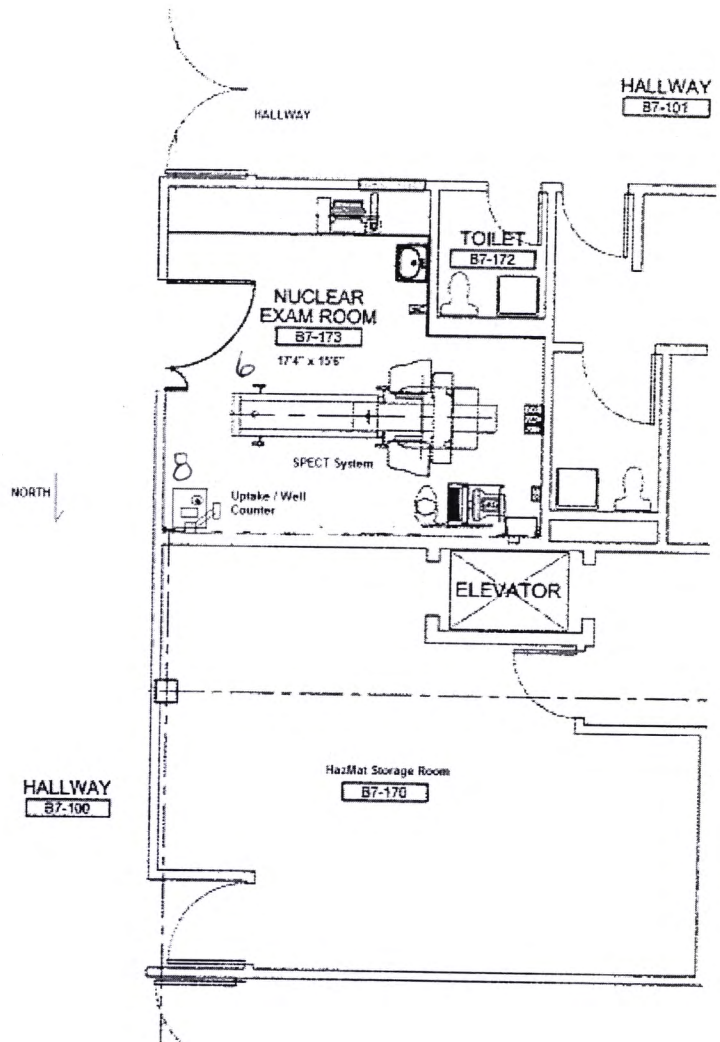
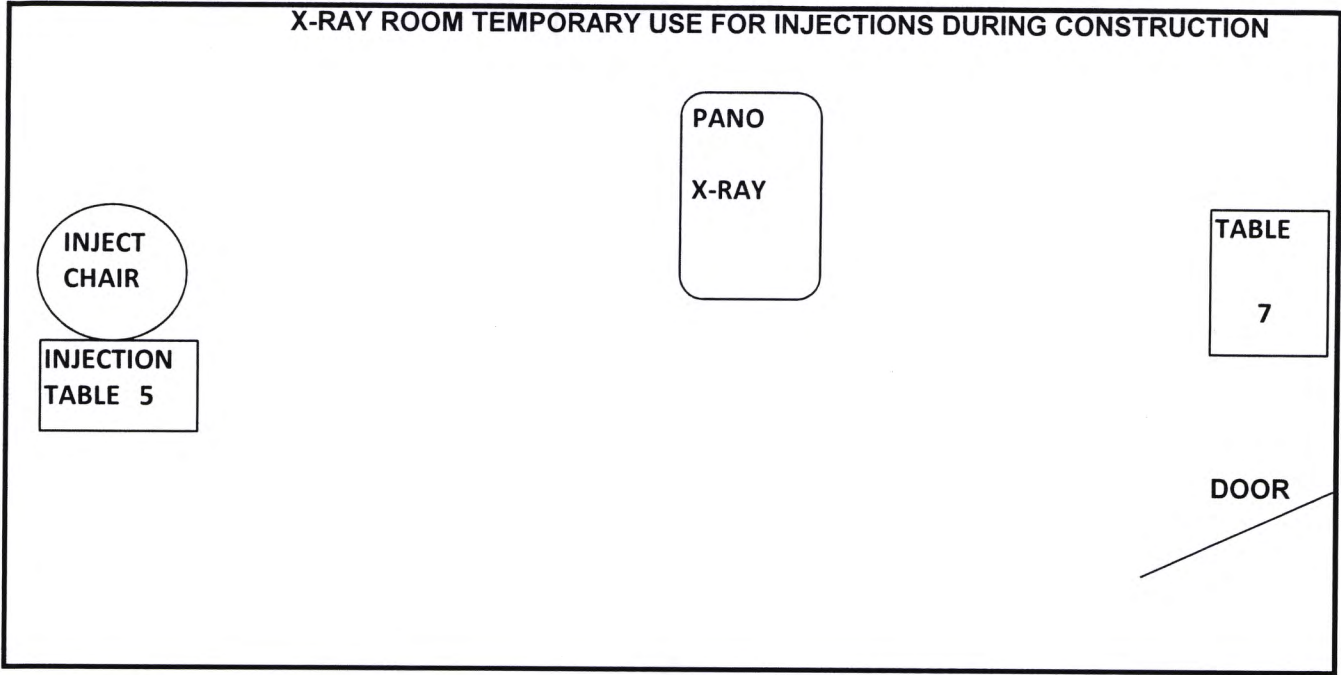



Beaumont Hospital – Taylor

Material's License 21-17789-01

NEW Nuclear Medicine Section - 2016

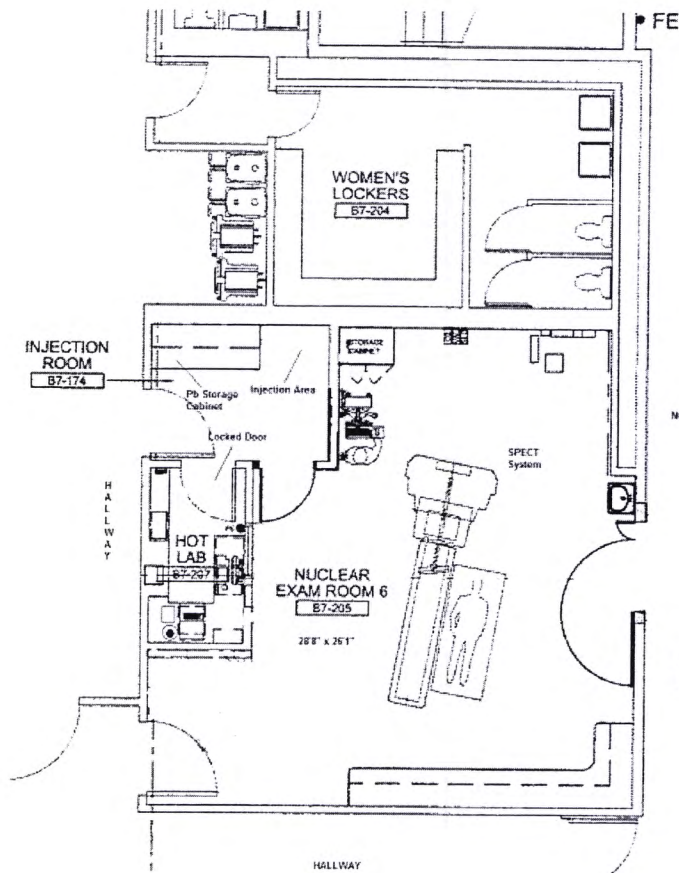

NORTH

HALLWAY  
B7-100

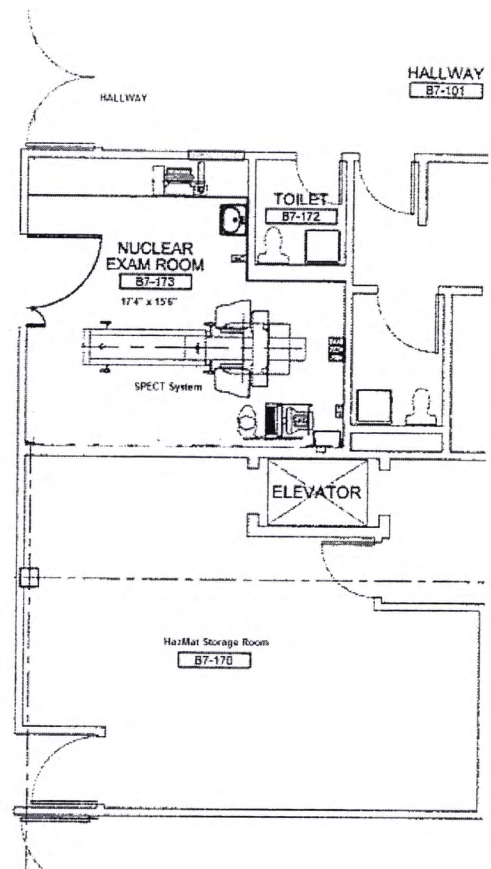

<b>NUCLEAR MEDICINE</b>	
1- Bkg (Hall)	
2- Dose Prep Shield	
3- Hot Lab Counter	
4- Lead Cabinet	
5- Injection Chair	
6- Injection Table	
7- Discovery 630	
8- Uptake Probe	

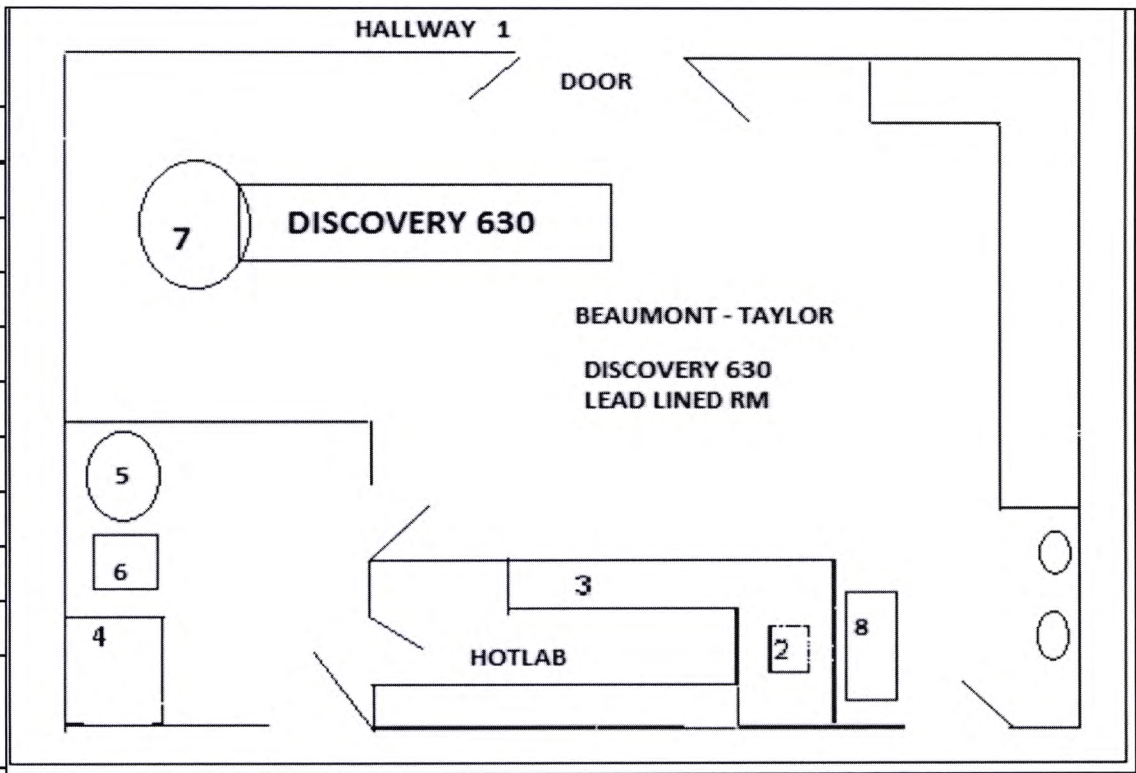

<b>CARDIOLOGY</b>	
<b>STRESS ROOM</b>	
9 - Stretcher 1A	
10 - Treadmill 1B	
11 - Stretcher 2A	
12 - Treadmill 2B	

The Cardiology Stress Room is located ~300 feet to the North West on the same floor

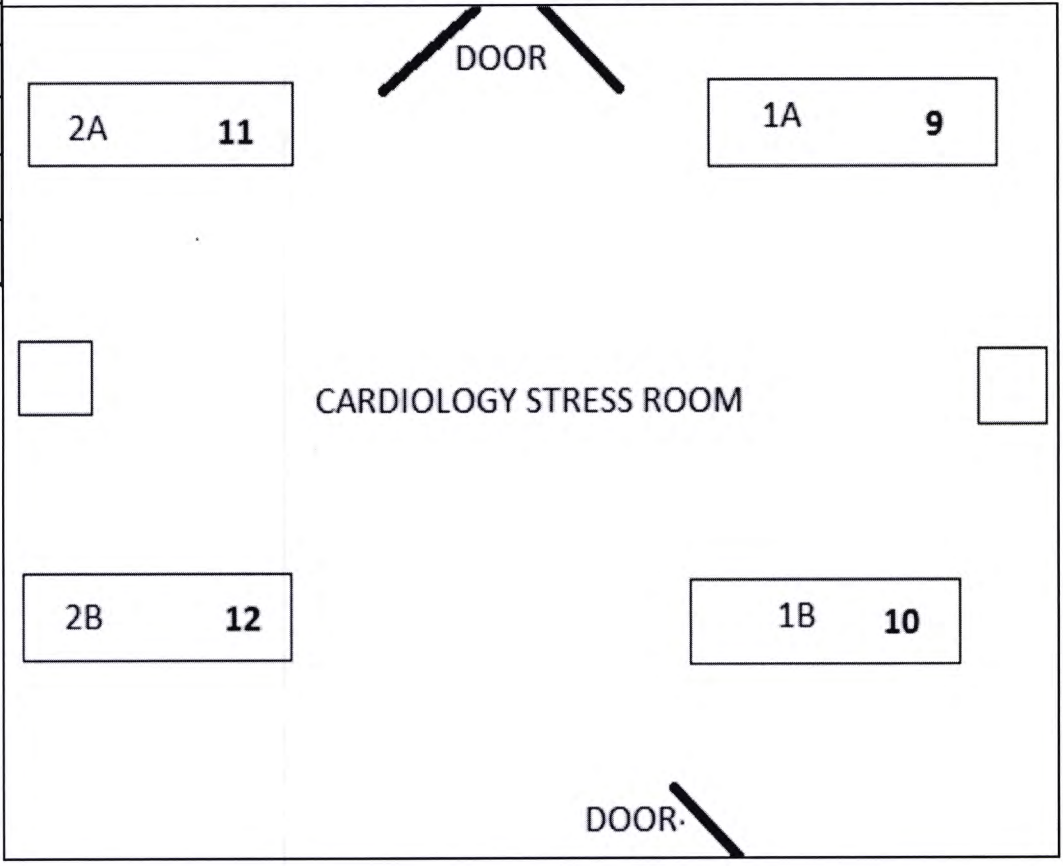

13- MG Camera

MG COUNTER 15

14- MG Injection Cart

15- MG Counter

SINK

BEAUMONT - TAYLOR  
MG CAMERA ROOM NOT LEAD LINED

MG CAMERA 13

INJECTION  
CART 14

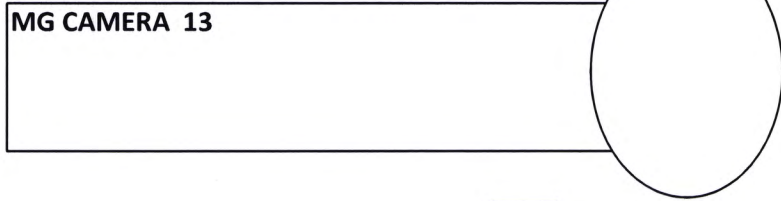
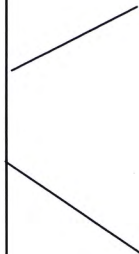



ORIGIN ID: NFBA (313) 791-4509  
MATTHEW BRAY  
OAKWOOD HOSPITAL TAYLOR  
10,000 TELEGRAPH ROAD

TAYLOR, MI 48180  
UNITED STATES US

SHIP DATE: 08JUL16  
ACTWGT: 1.00 LB  
CAD: 109272537/WSXI3100

BILL THIRD PARTY

TO REGION III MATERIALS LICENSING BRAN  
U.S NUCLEAR REGULATORY COMMISSION  
2443 WARRENVILLE ROAD  
SUITE 210  
LISLE IL 60532

(313) 295-5244  
INV:  
PO:

REF:

DEPT: TYL01-831225

540J115C6D1727F

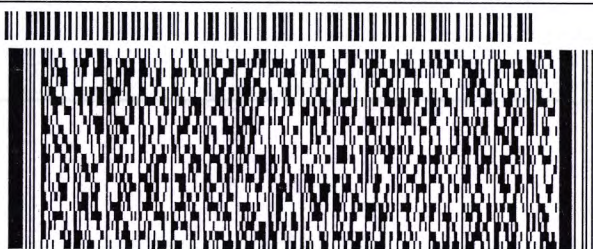

FedEx  
Express



J16161828561ur

MON - 11 JUL 10:30A  
PRIORITY OVERNIGHT

TRK# 7835 4026 8760  
0201

SE ENLA

60532  
IL-US ORD

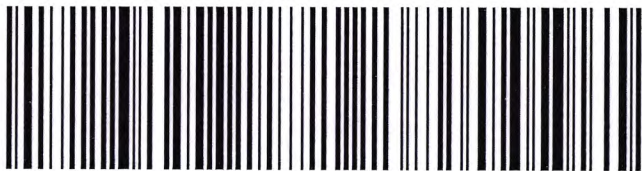

RECEIVED JUL 11 2016

After printing this label:

1. Fold the first printed page in half and use as the shipping label.
2. Place label in shipping pouch and affix it to your shipment so that the barcode portion of the label can be read and scanned.

**Shipment Summary**

---

<b>Ship Date:</b> 7/8/2016	<b>Estimated Charge:</b> \$13.82
<b>Service Type:</b> FedEx Priority Overnight®	<b>Shipper Account #:</b> 126534540
<b>Package Type:</b> FedEx® Pak	
<b>Tracking Number(s):</b> 783540268760	
<b>From Address:</b> Oakwood Hospital Taylor Matthew Bray 10,000 Telegraph Road Taylor, MI 48180 3137914509	<b>To Address:</b> U.S Nuclear Regulatory Commission Region III Materials Licensing Branch 2443 Warrenville Road Suite 210 Lisle, IL 60532 3132955244