

OCT 25 1967

WR7-25-66
20 45

STATE OF COLORADO
DIVISION OF WATER RESOURCES
OFFICE OF THE STATE ENGINEER

RECEIVED

AUG 15 1967

GROVE WATER SOURCE
COLORADO
STATE ENGINEER

Index No. 296
IDWD 4-60
Use 1
Registered _____

MAP AND STATEMENT FOR WATER WELL FILING

PERMIT NUMBER 30127

Know all men by these presents: That the undersigned Mr. J. Rigg Vaughn, claimant(s), whose address is Corner 7th and College, City Columbus, Mississippi states: Claimant(s) is (are) the owner(s) of well No. 30127 located as shown on the map below; the total number of acres of land owned by him (them) to be irrigated from this well is _____; work was commenced on this well by actual construction _____ day of _____, 19____; the tested capacity of said well is 70 (gpm) (cfs), for which claim is hereby made for _____ purposes; that the average annual amount of water to be diverted is _____ acre-ft.; and that the aforementioned statements are made and this map and statement are filed in compliance with the law.

State of Colorado)
County of Montrose) ss _____
Claimant(s)

Subscribed and sworn before me this _____ day of _____, 19____.

My Commission expires _____
Notary Public

MAP

THE WELL SHALL BE LOCATED WITH REFERENCE TO GOVERNMENT SURVEY CORNERS OR MONUMENTS, OR SECTION LINES BY DISTANCE AND BEARING.

_____ feet from _____ (North or South) section line
_____ feet from _____ (East or West) section line

IF WELL IS FOR IRRIGATION, THE AREA TO BE IRRIGATED MUST BE SHADED OR CROSS-HATCHED.

The square below will be used to indicate the location of the well and the irrigated land.

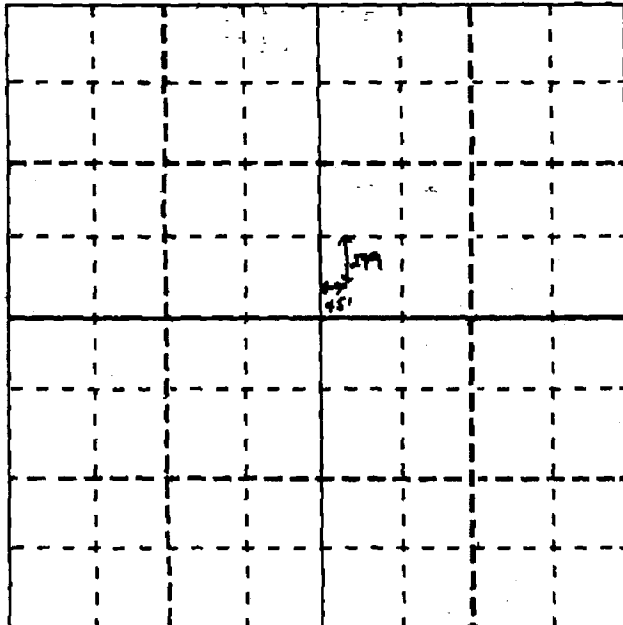

1 mi.

WELL LOCATION

Montrose 43 County

SW 1/4 SE 1/4, sec. 27

T. 46N, R. R16W, 7 P. M.

Ground Water Basin _____
Water Management _____
District _____

Domestic wells may be located by the following: LOT _____, BLOCK _____

_____ SUBDIVISION

ACCEPTED FOR FILING IN THE OFFICE OF THE STATE ENGINEER OF COLORADO ON THIS
DAY OF _____, 19____.

State Engineer

LOG AND HISTORY

WELL LOG

Ground Elevation 5000'

Type Drilling Rotary

WELL DATA

Date Started 3/18/67

Date Completed 5/1/67

From	To	Type of Material	Water Loc.	Perf.
0	170	Black shale	250	
170	180	white sand		
180	264	white sand		
264	265	blue clay		

Hole Diameter:
6-3/4 in. from 0 ft. to 180 ft.
4-3/4 in. from 180 ft. to 265 ft.
 _____ in. from _____ ft. to _____ ft.

CASING RECORD
 Cemented from 170-180
Plain Casing
 Size 5" I.D. kind 1/4 stem from 0 ft. to 180 ft.
 Size _____, kind _____ from _____ ft. to _____ ft.
 Size _____, kind _____ from _____ ft. to _____ ft.
Perforated Casing
 Size _____, kind _____ from _____ ft. to _____ ft.
 Size _____, kind _____ from _____ ft. to _____ ft.
 Size _____, kind _____ from _____ ft. to _____ ft.

TEST DATA
 Date Tested May 1, 1967
 Type of Pump air tested
 Length of Test 2 hr.
 Constant Yield 30 gal. per min.
 Drawdown 250

PUMP DATA (To be filled in)
 Type of Pump none installed
 Outlet Size to be installed by owner
 Driven by _____
 Horsepower _____

Use additional paper if necessary to complete log and attach.

State of Colorado)
 County of Montrose) ss

WELL DRILLERS STATEMENT

DEPTH TO WATER unk
 TOTAL DEPTH 250

Jack R. Smith

being duly sworn, deposes and says: he is the driller of the above described well; he has read the above map and statement, knows the content thereof, and the same is true of his own knowledge.

Jack R. Smith
 License No. _____

Subscribed and sworn to before me this _____ day of _____, 19____.

My Commission expires _____, 19____.

Notary Public

FORM TO BE MADE OUT IN QUADRUPPLICATE:
 Original WHITE (both sides) & Triplicate GREEN Copy must be filed with the State Engineer within 30-days after well is completed. Duplicate PINK copy is for the Owner & YELLOW copy for the Driller. WHITE FORM MUST BE AN ORIGINAL COPY ON BOTH SIDES AND SIGNED.

STATE OF COLORADO

APPLICATION FOR: A PERMIT TO USE GROUND WATER
 A PERMIT TO CONSTRUCT A WELL
 OTHER

Application must be completed satisfactorily before acceptance

RECEIVED
JAN 25 1967
GROUND WATER SECT
COLORADO
STATE ENGINEER

PRINT OR TYPE

LOCATION OF WELL

APPLICANT J. Rigg Vaughn

COUNTY Montrose

Street Address 709 Second Ave South

NW $\frac{1}{4}$ SW $\frac{1}{4}$, sec. 27

City & State Columbus, Mississippi

T. 46N, R. 16 W, NM P.M.

Use of ground water domestic

Ground Water Basin _____

Owner of land on which well is located same

Water Management District _____

Number of acres to be irrigated _____

USE DIAGRAM ON THE BACK OF THIS SHEET TO LOCATE WELL.

Legal description of irrigated land _____

Other water rights on this land _____

Driller Smith Drilling No. 530

Owner of irrigated land _____

Driller's Address Box 417, Nucla, Colorado

Aquifer(s) ground water is to be obtained from _____

ESTIMATED WELL DATA

Signature of Applicant _____

Est. quantity of ground water to be claimed:
Est. Max. Yield 20 GPM or CFS
Est. average annual amount to be used in acre-feet _____
Storage capacity _____ AF

CONDITIONS OF APPROVAL

Anticipated start of drilling Feb 15 19 67

Hole Diameter:
6 in. from 0 ft. to 7 ft.
_____ in. from _____ ft. to _____ ft.

Casing:
Plain 5 in. from 0 ft. to ? ft.
_____ in. from _____ ft. to _____ ft.
Perf. _____ in. from _____ ft. to _____ ft.
_____ in. from _____ ft. to _____ ft.

PUMP DATA: Type submersible HP 1/2 Outlet Size 1"

This application approved
PERMIT NUMBER 30127
DATE ISSUED MAR 16, 1967
[Signature]
State Engineer
[Signature]
by _____

This application approved
CONDITIONAL PERMIT NO. _____
(Permit good for one (1) year after date of issuance)
DATE ISSUED _____

Chairman Ground Water Commission
by _____

THE LOCATION OF THE PROPOSED WELL SHALL BE SHOWN ON THE DIAGRAM BELOW. THE LOCATION WILL BE INDICATED BY THE DISTANCES FROM THE SECTION LINES, OR THE DISTANCE AND BEARING FROM GOVERNMENT SURVEY CORNERS OR MONUMENTS.

IF WELL IS FOR IRRIGATION, THE AREA TO BE IRRIGATED MUST BE SHADED OR CROSS-HATCHED.

Domestic wells may be located by the following:

Lot _____ Block _____ Street Address _____
or
City _____
Subdivision _____

The diagram represents nine (9) sections. Use the center square (section) to indicate the location of the well.

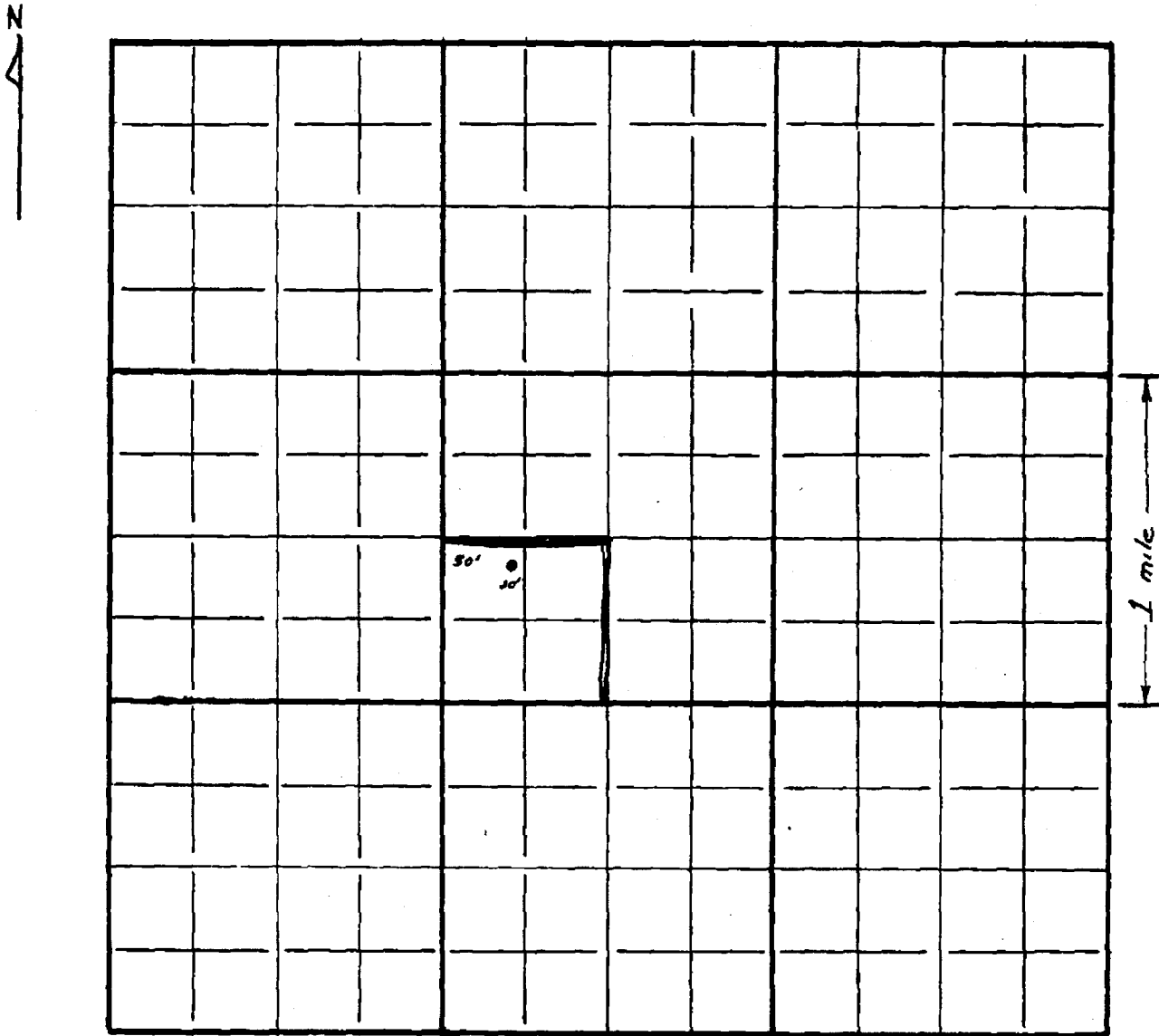

THE SCALE OF THE DIAGRAM IS TWO INCHES EQUALS ONE-MILE