

- NOTES:**
1. THE FOLLOWING ARE THE COORDINATES FOR NEW PLANT SITE CENTER:
 NEW JERSEY STATE PLAN (NAD83)
 NORTHING: 234,753,998.5
 EASTING: 188,529,293.8
 GEOGRAPHIC (NAD83)
 LATITUDE: 39° 28' 23.7436"
 LONGITUDE: 75° 39' 24.3316"
 UNIVERSAL TRANSVERSE MERCATOR (NAD83 ZONE 18)
 NORTHING: 14,335,392,324
 EASTING: 1488007,170
 U.S. NATIONAL GRID (NAD83)
 USNG: 18SVJ5354569436
 PLANT GRID COORDINATES
 N3532.538"
 W980.666"
 2. TEMPORARY CONSTRUCTION IMPACT DUE TO INSTALLATION OF TRANSMISSION TOWERS IN THIS AREA (APPROXIMATELY 5 ACRES).
 3. AREAS DESIGNATED AS "TEMPORARY CONSTRUCTION AREA" WILL INCLUDE CONSTRUCTION SUPPORT FACILITIES INCLUDING PARKING, CONSTRUCTION OFFICES, CONSTRUCTION FABRICATION AND SERVICES FACILITIES, LAYDOWN STORAGE, AND OTHER FACILITIES / FEATURES NECESSARY FOR CONSTRUCTION OF THE PROPOSED FACILITY.
 4. PERMANENT IMPACT DUE TO INSTALLATION OF BARGE MOORING CAISSONS, LESS THAN 1 ACRE IMPACT.

- LEGEND**
- PERMANENT PLANT USE AREA
 - TEMPORARY CONSTRUCTION USE AREA
 - New TLD
 - Existing TLD

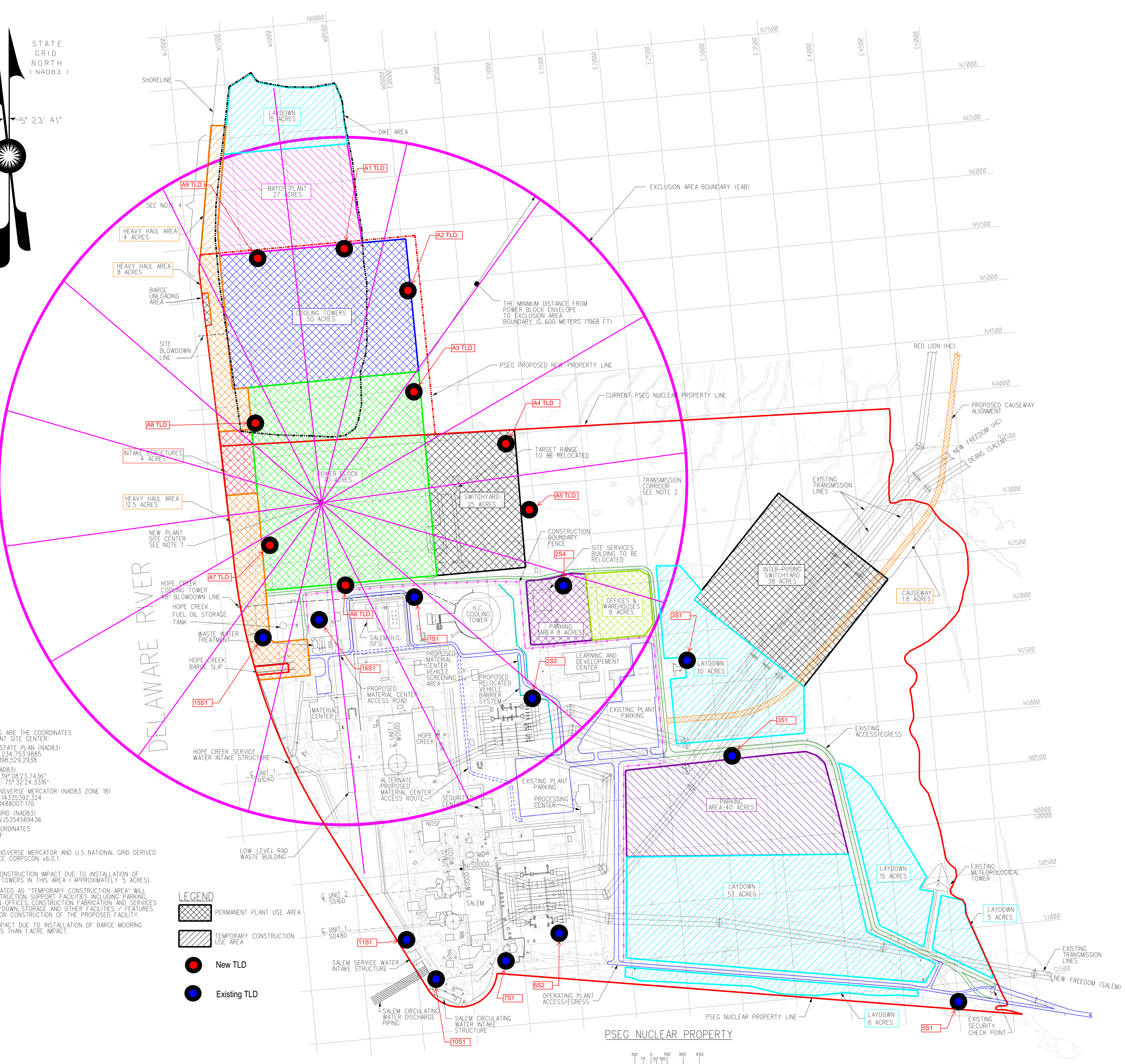

**PSEG Power, LLC
 PSEG Site ESPA
 Part 3, Environmental Report**

New Sample Locations

**FIGURE 6.2-3
 Rev. 0**