

## Radiological Survey Sheet

Job Location PFIZER, GROTON, CT. LAB 118W/W227 Page 1 of 22

Survey Purpose LAB CLOSE OUT Date 1-10-04

Performed by E. GAILOR E. Gailor  
 (Print) (Sign)

Instrument (Model/S/N)	Packard Tri-Carb S/N 431521	Packard Tri-Carb S/N 431520	Ludlum 2241-2 163603	✓
Det. (Model/SN)	Internal	Internal	Ludlum 43-68 PR 149613	✓ EA
Type Rad.	β	β	β	✓
Cal. Due:	10/24/04	10/24/04	6/25/04	
Check Instruments Used	X		X	

No.	Time	Locations	See attached LSC printout for Total Activity (cpm/100 cm <sup>2</sup> )			
1.	0930	BACKGROUND				
2.	↑	door & HNDL				
3.		FLOOR				
4.		TOP LEFT SIDE OF HOOD				
5.		BOTTOM " " " "				
6.		TOP BACK OF HOOD LEFT SIDE				
7.		MIDDLE " " "				
8.		TOP " " " RIGHT SIDE				
9.		MIDDLE " " " LEFT "				
10.		" " " "				
11.		" " " " RIGHT SIDE				
12.		BOTTOM " " " LEFT SIDE				
13.		" " " " MIDDLE				
14.		" " " " RIGHT SIDE				
15.		BOTTOM " " " LEFT SIDE				
16.		" " " " MIDDLE				
17.		" " " " RIGHT SIDE				
18.		↓	HOOD LIP			

# Radiological Survey Continuation Sheet

Page 2 of 22

Date 1-10-04

No.	Time	Locations	See attached LSC printout for Total Activity (cpm/100 cm <sup>2</sup> )
19	0930 ↑	RIGHT TOP LEFT SIDE OF HOOD	
20		BOTTOM " " "	
21		CAB. DOORS & HANDLS	
22		RIGHT SIDE OF CAB.	
23		BOTTOM OF CAB	
24		RIGHT SIDE OF CAB.	
25		BACK OF CAB.	
26		CAB. DOORS & HANDL	
27		LEFT SIDE OF CAB.	
28		BOTTOM " "	
29		RIGHT " " "	
30		BACK " "	
31		FLOOR	
32		FLOOR	
33		UPPER WALL	
34		SHELF	
35		WALL BEHIND SINK	
36		BEHIND SINK	
37		COUNTER	
38		INSIDE SINK	
39		SINK LEDGE	
40		COUNTER	
41		LEFT CAB. DOOR & HANDL	
42		RIGHT " " " "	
43		LEFT SIDE OF CAB	
44		BOTTOM " "	
45	✓	RIGHT " " "	

# Radiological Survey Continuation Sheet

Page 3 of 22

Date 1-10-04

No.	Time	Locations	See attached LSC printout for Total Activity (cpm/100 cm <sup>2</sup> )
46	0930	TOP DRAWER & HNDL	
47	↑	2ND " "	" "
48		3RD " "	" "
49		4TH " "	" "
50		TOP "	
51		2ND "	
52		3RD "	
53		4TH "	
54		FLOOR	
55		FLOOR	
56		LEFT CAB. door & HNDL	
57		RIGHT " " & "	
58		TOP SHELF	
59		2ND "	
60		3RD "	
61		4TH "	
62		UPPER WALL	
63		LOWER "	
64		UPPER "	
65		LOWER "	
66		FLOOR	
67		FLOOR	
68		TABLE TOP	
69		UPPER WALL	
70		" "	
71		LOWER "	
72	√	" "	

# Radiological Survey Continuation Sheet

Page 4 of 22

Date 1-10-04

No.	Time	Locations	See attached LSC printout for Total Activity (cpm/100 cm <sup>2</sup> )
73	0930	FLOOR	
74	"	FLOOR	
75		HEATER	
76		"	
77		FLOOR	
78		"	
79		UPPER WALL	
80		" "	
81		LOWER "	
82		" "	
83		FLOOR	
84		"	
85		TOP SHELF	
86		2ND "	
87		3RD "	
88		4TH "	
89		5TH "	
90		6TH "	
91		LEFT CAB. DOOR & HNDL	
92		RIGHT " " & "	
93		TOP SHELF	
94		2ND "	
95		3RD "	
96		BOTTOM "	
97		SHELF	
98		"	
99	✓	TOP "	

# Radiological Survey Continuation Sheet

Page 5 of 22

Date 1-10-00

No.	Time	Locations	See attached LSC printout for Total Activity (cpm/100 cm <sup>2</sup> )
100	0930	BOTTOM SHELF	
101	↑	DESIC TOP	
102	'	TOP DRAWER & HNDL	
103		2ND " & HNDL	
104		3RD " & HNDL	
105		TOP "	
106		2ND "	
107		3RD "	
108		PULL OUT SHELF	
109		TOP SHELF	
110		2ND "	
111		3RD "	
112		CUP	
113		TOP SHELF	
114		2ND "	
115		3RD "	
116		CUP	
117		COUNTER	
118		"	
119		"	
120		"	
121		TOP DRAWER & HNDL	
122		2ND " & "	
123		3RD " & "	
124		TOP "	
125		2ND "	
126	↓	TOP SHELF	

# Radiological Survey Continuation Sheet

Page 6 of 22

Date 1-10-04

No.	Time	Locations	See attached LSC printout for Total Activity (cpm/100 cm <sup>2</sup> )
127	0930	<del>TOP</del> BOTTOM SHELF	
128	↑	<del>TOP</del> <del>BOTTOM</del> " MIDDLE DRAWER & HANDL	
129		DRAWER	
130		TOP LEFT DRAWER & HANDL	
131		2ND " " & HANDL	
132		3RD DRAWER & HANDLS	
133		4TH DRAWER & HANDLS	
134		TOP RIGHT DRAWER & HANDL	
135		2ND " " & HANDL	
136		TOP LEFT DRAWER	
137		2ND " "	
138		TOP RIGHT "	
139		2ND " "	
140		3RD DRAWER	
141		4TH "	
142		COUNTER	
143		INSIDE SINK	
144		LEFT DOOR & HANDL	
145		<del>RIGHT</del> RIGHT DOOR & HANDL	
146		LEFT SIDE OF CAB.	
147		RIGHT " " "	
148		BOTTOM " "	
149		BACK " "	
150		FLOOR	
151		FLOOR	
152		FLOOR	
153	✓	FLOOR	

# Radiological Survey Continuation Sheet

Page 7 of 22

Date 11-04

No.	Time	Locations	See attached LSC printout for Total Activity (cpm/100 cm <sup>2</sup> )
154	0930	COUNTER	
155	↑	"	
156		"	
157		DESK	
158		TOP LEFT DRAWER & HNDL	
159		2ND " " & "	
160		TOP RIGHT " & "	
161		2ND " " & "	
162		TOP LEFT DRAWER	
163		2ND " "	
164		TOP RIGHT "	
165		2ND " "	
166		3RD DRAWER & HNDLS	
167		" "	
168		4TH " & HNDLS	
169		" "	
170		DRAWER & HNDL	
171		"	
172		TOP DRAWER & HNDL	
173		" "	
174		MIDDLE " & "	
175		" "	
176		CAB DOOR & HNDL	
177		TOP SHELF	
178		BOTTOM SHELF	
179		TOP DRAWER & HND	
180	✓	MIDDLE " & "	

# Radiological Survey Continuation Sheet

Page 8 of 27

Date 1-10-04

No.	Time	Locations	See attached LSC printout for Total Activity (cpm/100 cm <sup>2</sup> )
181	0930	BOTTOM DRAWER & HNDL	
182	↑	TOP DRAWER	
182		2ND DRAWER	
183		BOTTOM "	
184		LEFT DOOR & HNDL	
185		RIGHT " & "	
186		TOP SHELF	
187		2ND "	
188		3RD "	
189		4TH "	
190		DOOR & HNDL	
191		TOP SHELF	
192		2ND "	
193		3RD "	
194		4TH "	
195		TOP SHELF	
196		2ND "	
197		3RD "	
198		BOTTOM "	
199		WALL	
200		WALL	
201		COUNTER	
202		COUNTER	
203		TOP DRAWER & HNDL	
204		MIDDLE " & "	
205		BOTTOM " & "	
206	✓	TOP DRAWER	



# Radiological Survey Continuation Sheet

Page 9 of 22

Date 1-10-04

No.	Time	Locations	See attached LSC printout for Total Activity (cpm/100 cm <sup>2</sup> )
207	0930	2nd DRAWER	
208	↑	BOTTOM "	
209		DRAWER & HNDL	
210		DRAWER	
211		SHELF	
212		TOP SHELF	
213		BOTTOM "	
214		DESK	
215		TOP LEFT DRAWER <sup>ER</sup> & HNDL	
216		2nd " " & "	
217		TOP RIGHT " & "	
218		2nd RIGHT " & "	
219		3rd DRAWER & HNDLS	
220		4TH " & "	
221		TOP LEFT DRAWER	
222		2nd " "	
223		TOP RIGHT "	
224		2nd " "	
225		3rd "	
226		4TH "	
227		TOP LEFT DRAWER & HNDL	
228		2nd " " & "	
229		3rd " " & "	
230		TOP RIGHT " & "	
231		2nd " " & "	
232		1ST LARGE DRAWER & HNDLS	
233	√	2nd " " & "	

# Radiological Survey Continuation Sheet

Page 10 of 22

Date 1-10-04

No.	Time	Locations	See attached LSC printout for Total Activity (cpm/100 cm <sup>2</sup> )
234	0930	TOP LEFT DRAWER	
235	↑	2ND " "	
236		3RD " "	
237		TOP RIGHT "	
238		2ND " "	
239		1ST LARGE DRAWER	
240		2ND " "	
241		FLOOR	
242		" "	
243		" "	
244		" "	
245		TOP SHELF	
246		2ND " "	
247		3RD " "	
248		CUP	
249		TOP SHELF	
250		2ND " "	
251		3RD " "	
252		CUP	
253		TOP SHELF	
254		2ND " "	
255		3RD " "	
256		COUNTER	
257		COUNTER	
258		COUNTER	
259		COUNTER	
260	✓	COUNTER	

# Radiological Survey Continuation Sheet

Page 11 of 22

Date 1-10-04

No.	Time	Locations	See attached LSC printout for Total Activity (cpm/100 cm <sup>2</sup> )
261	0930	COUNTER	
262	↑	"	
263		"	
264		TOP LEFT DRAWER & HNDL	
265		2ND " " & "	
266		TOP RIGHT " & "	
267		2ND " " & "	
268		3RD " " & "	
269		1ST LARGE DRAWER & HNDLS	
270		" " "	
271		2ND " " & "	
272		" " "	
273		TOP LEFT DRAWER	
274		2ND " "	
275		TOP RIGHT "	
276		2ND " "	
277		3RD " "	
278		TOP LEFT DRAWER & HNDL	
279		2ND " " & "	
280		TOP RIGHT " & "	
281		2ND " " & "	
283		1ST LARGE DRAWER & HNDLS	
284		<del>2ND</del> 1ST " "	
285		2ND " " & "	
286		2ND " "	
287		TOP LEFT DRAWER	
288	↓	2ND " "	

# Radiological Survey Continuation Sheet

Page 12 of 22

Date 1-10-04

No.	Time	Locations	See attached LSC printout for Total Activity (cpm/100 cm <sup>2</sup> )
289	0930	TOP RIGHT DRAWER	
290	↑	2ND " "	
291		DRAWER & HNDL	
292		DRAWER	
293		TOP DRAWER & HNDL	
294		2ND " & "	
295		CAB DOOR & "	
296		TOP DRAWER	
297		TRAY IN DRAWER	
298		2ND DRAWER	
299		TOP SHELF	
300		2ND "	
301		DESK	
302		TOP DRAWER & HNDL	
303		2ND " & "	
304		3RD " & "	
305		TOP DRAWER	
306		2ND "	
307		3RD "	
308		LEFT DOOR & HNDL	
309		RIGHT " & "	
310		TOP SHELF	
311		2ND "	
312		3RD "	
313		4TH "	
314		LEFT DOOR & HNDL	
315	✓	RIGHT " & "	

# Radiological Survey Continuation Sheet

Page 13 of 22

Date 1-10-04

No.	Time	Locations	See attached LSC printout for Total Activity (cpm/100 cm <sup>2</sup> )
316	0930	TOP SHELF	
317	↑	2ND "	
318		3RD "	
319		4TH "	
320		COUNTER	
321		COUNTER	
322		WALL UNDER CABINETS	
323		" " COUNTER	
324		UPPER WALL	
325		LOWER "	
326		DOOR	
327		UPPER WALL	
328		LOWER "	
329	TOP SHELF		
330	MIDDLE "		
331	BOTTOM "		
332	UPPER WALL		
333	" "		
334	LOWER "		
335	LOWER "		
336	TABLE TOP		
337	" "		
338	LEFT DRAWER & HWDL		
339	MIDDLE " & "		
340	RIGHT " & "		
341	LEFT DRAWER		
342	↓	MIDDLE "	



**Bld. 118W Room W227**

Date: 1-10-04

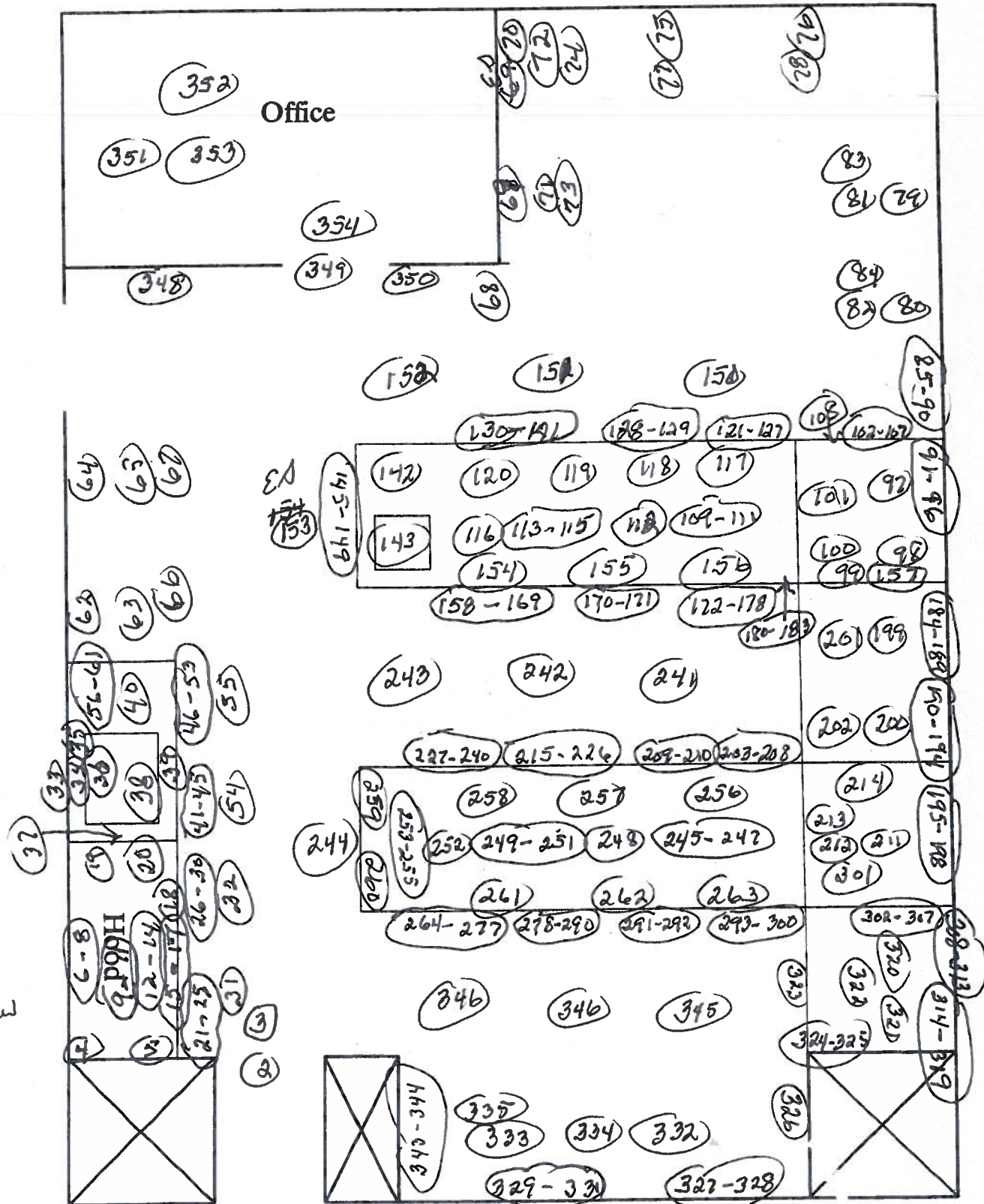

O = wipe location

ALL SURFACES SURVEYED WITH LUDLUM 2241-Z AND FOUND TO BE WITHIN LIMITS. (W) 1/17/04

Assay Definition-

Assay Description:  
Monthly Swipes

Assay Type: CPM  
Report Name: Report1  
Output Data Path: C:\Packard\Tricarb\Results\Ed Gailor\Eds Monthly Swipes  
Raw Results Path: C:\Packard\Tricarb\Results\Ed Gailor\Eds Monthly Swipes\20040110\_1359.results  
Assay File Name: C:\Packard\TriCarb\Assays\Eds Monthly Swipes.lsa

Count Conditions-

Nuclide: Triple  
Quench Indicator: tSIE/AEC  
External Std Terminator (sec): 0.5 2s%  
Pre-Count Delay (min): 0.00  
Quench Set: n/a  
Count Time (min): 1.00  
Count Mode: Normal  
Assay Count Cycles: 1 Repeat Sample Count: 1  
#Vials/Sample: 1 Calculate % Reference: Off

Background Subtract: Off  
Low CPM Threshold: Off  
2 Sigma % Terminator: Off

Regions	LL	UL
A	0.0	18.6
B	18.6	156.0
C	0.0	2000.0

Count Corrections-

Static Controller: On Luminescence Correction: On  
Colored Samples: n/a Heterogeneity Monitor: n/a  
Coincidence Time (nsec): 18 Delay Before Burst (nsec): 75

Half Life-

Regions	Half Life	Units	Reference Date	Reference Time
A				
B				
C				

Cycle 1 Results

S#	CPMA	CPMB	CPMC	MESSAGES
1	11	9	25	
2	26	6	39	
3	6	6	21	
4	9	14	31	
5	13	6	26	
6	16	9	33	
7	21	13	39	
8	8	7	19	
9	14	10	29	
10	14	11	40	
11	13	7	28	
12	16	7	32	



Protocol# 4 - Eds Monthly Swipes.lsa

User: Ed Gailor

13	14	7	23
14	23	8	38
15	7	6	19
16	7	9	24
17	20	8	35
18	13	4	24
19	8	9	22
20	7	11	27
21	15	5	28
22	16	9	29
23	14	9	27
24	9	9	22
25	12	12	30
26	20	5	35
27	15	9	31
28	12	9	26
29	14	10	27
30	13	6	26
31	18	12	38
32	12	3	19
33	8	10	22
34	8	9	23
35	16	6	24
36	15	9	29
37	14	6	32
38	11	5	21
39	16	12	35
40	11	9	32
41	22	8	40
42	14	6	33
43	10	6	23
44	3	8	15
45	15	14	35
46	10	6	24
47	9	11	26
48	17	7	33
49	8	9	20
50	11	4	25
51	11	10	25
52	12	5	22
53	17	5	26
54	7	9	26
55	13	4	24
56	19	3	25
57	11	7	25
58	19	5	29
59	12	8	28
60	8	10	22
61	16	9	30
62	10	3	21
63	15	7	29
64	17	7	29
65	7	7	21
66	8	5	17
67	14	4	22
68	11	8	22
69	13	13	32
70	13	6	22
71	13	9	30
72	13	6	28
73	25	9	39
74	19	9	36
75	21	5	31

Protocol# 4 - Eds Monthly Swipes.lsa

User: Ed Gailor

76	18	14	41
77	9	10	31
78	14	12	34
79	6	12	24
80	16	10	30
81	12	10	27
82	14	7	27
83	11	12	29
84	15	10	31
85	17	4	27
86	17	6	30
87	19	5	34
88	16	13	37
89	13	6	27
90	13	7	27
91	12	6	24
92	8	2	19
93	15	7	26
94	14	6	30
95	14	10	31
96	11	7	23
97	14	5	28
98	17	11	35
99	16	15	33
100	6	10	24
101	9	12	31
102	7	9	26
103	11	5	22
104	14	4	28
105	6	6	19
106	16	4	26
107	13	8	28
108	16	12	32
109	8	9	21
110	19	8	34
111	15	12	35
112	15	12	33
113	15	9	35
114	14	8	28
115	13	9	27
116	0	8	15
117	19	1	27
118	7	8	21
119	12	8	27
120	14	7	27
121	13	7	25
122	14	6	31
123	17	10	33
124	16	5	28
125	19	11	41
126	21	14	41
127	19	12	42
128	9	8	26
129	11	6	27
130	12	12	32
131	12	9	24
132	10	10	27
133	12	6	22
134	15	6	25
135	9	6	25
136	15	7	33
137	16	5	29
138	10	9	28

Protocol# 4 - Eds Monthly Swipes.lsa

User: Ed Gailor

139	14	7	28
140	14	3	25
141	17	13	39
142	4	11	16
143	11	14	29
144	10	9	25
145	8	7	20
146	8	8	19
147	14	11	26
148	15	11	32
149	5	7	15
150	8	9	24
151	16	4	26
152	18	7	27
153	8	6	21
154	13	6	26
155	11	9	29
156	10	4	26
157	6	10	29
158	14	6	30
159	8	6	19
160	11	12	32
161	15	9	32
162	18	6	31
163	5	9	18
164	19	5	32
165	10	6	20
166	9	9	23
167	11	8	26
168	10	5	21
169	3	8	18
170	18	9	33
171	6	10	21
172	18	10	32
173	16	9	31
174	18	11	37
175	18	4	28
176	11	8	25
177	11	9	24
178	13	7	22
179	14	13	33
180	9	2	16
181	8	2	15
182	8	8	20
183	17	4	25
184	4	8	18
185	9	12	29
186	12	3	21
187	6	8	25
188	14	7	29
189	11	9	26
190	14	6	25
191	17	12	33
192	5	6	18
193	12	6	26
194	11	7	28
195	16	11	38
196	6	5	12
197	12	7	22
198	4	8	16
199	24	3	34
200	13	6	26
201	7	8	25

Protocol# 4 - Eds Monthly Swipes.lsa

User: Ed Gailor

202	13	10	33
203	13	8	26
204	12	10	28
205	11	11	29
206	7	10	23
207	6	8	20
208	11	11	27
209	8	6	24
210	5	5	17
211	11	7	23
212	13	7	23
213	12	7	23
214	10	9	25
215	15	7	25
216	4	2	10
217	6	13	30
218	11	5	21
219	14	7	28
220	13	7	25
221	8	7	15
222	9	5	18
223	16	4	24
224	7	5	23
225	12	7	24
226	13	8	27
227	9	10	28
228	16	8	29
229	10	9	23
230	10	11	32
231	8	10	21
232	12	6	25
233	17	5	29
234	6	5	20
235	13	9	30
236	7	9	20
237	13	8	23
238	10	4	20
239	14	11	28
240	21	4	32
241	20	2	27
242	7	4	20
243	13	3	22
244	19	9	35
245	7	8	18
246	23	13	41
247	8	7	19
248	16	6	34
249	16	7	27
250	20	9	37
251	8	5	19
252	12	8	30
253	15	7	32
254	14	11	29
255	12	7	23
256	10	4	22
257	24	10	42
258	6	4	11
259	10	8	22
260	6	11	28
261	3	5	10
262	13	9	24
263	13	4	26
264	11	5	24

Protocol# 4 - Eds Monthly Swipes.lsa

User: Ed Gailor

265	21	7	31
266	12	7	24
267	15	8	25
268	8	10	21
269	11	3	16
270	4	7	20
271	14	6	24
272	18	7	34
273	19	5	29
274	19	14	43
275	13	5	22
276	9	6	21
277	10	11	28
278	10	4	21
279	22	9	37
280	17	5	27
281	12	10	31
282	13	7	25
283	22	6	36
284	15	3	22
285	13	7	26
286	9	8	22
287	14	5	28
288	14	8	28
289	16	9	30
290	2	7	15
291	29	8	41
292	12	8	26
293	33	8	47
294	11	7	26
295	16	5	24
296	0	3	11
297	8	12	23
298	11	3	21
299	9	8	23
300	14	6	26
301	12	11	29
302	4	10	17
303	12	11	27
304	18	10	31
305	14	4	24
306	6	11	21
307	22	11	44
308	16	9	34
309	14	4	24
310	13	11	34
311	15	12	34
312	11	7	22
313	5	11	24
314	6	8	18
315	21	10	41
316	21	5	30
317	14	5	22
318	14	6	26
319	12	7	23
320	14	5	23
321	13	9	26
322	4	8	21
323	13	3	26
324	13	6	25
325	16	9	31
326	25	11	44
327	6	6	18

Protocol# 4 - Eds Monthly Swipes.lsa

User: Ed Gailor

328	13	6	26
329	20	9	31
330	10	14	30
331	0	14	17
332	7	9	18
333	10	5	25
334	14	8	31
335	10	10	26
336	24	5	31
337	13	9	28
338	10	9	25
339	12	9	27
340	6	3	15
341	20	6	30
342	6	9	17
343	13	9	29
344	12	7	26
345	6	5	19
346	9	11	28
347	12	5	22
348	6	8	23
349	21	7	32
350	13	9	26
351	5	9	18
352	10	10	26
353	13	4	21
354	7	3	18