

Radiological Survey Sheet

Job Location Pfizer Central Research Ginton 118W/W226 Page 1 of 20
 Survey Purpose Radiological Assessment Date 5/1/01
 Performed By Pam Jones (Print) Pam Jones (Sign)

Inst.(1) (Model/SN) Beckman LS 6500 #7069448	Inst.(2) <u>Ludium 2241-2</u> (Model/SN) <u>#163603</u>	Inst.(3) (Model/SN)
Det. Internal (Model/SN)	Det. <u>Ludium 43-68</u> (Model/SN) <u>#PR149613</u>	Det. (Model/SN)
Eff. <u>See LSC Printout</u>	Eff. <u>~ 8% CI4</u>	Eff.
Type rad. β	Type rad. β	Type rad.
Bkgd. <u>See LSC Printout</u>	Bkgd. <u>300 cpm</u>	Bkgd.
Cal. Due: <u>12/01</u>	Cal. Due <u>1/26/02</u>	Cal. due

No.	Time	Location	Inst. Used	Total Activity (dpm/100 cm ²)
1.	1406	door	1	See attached LSC Printout
2.		wall	1	
3.		"	1	
4.		"	1	
5.		"	1	
6.		"	1	
7.		top shelf	1	
8.		shelf	1	
9.		bottom shelf	1	
10.		glass	1	
11.		glass	1	
12.		wall	1	
13.		"	1	
14.		floor	1	
15.		"	1	
16.		"	1	
17.		"	1	
18.	✓	"	1	

Radiological Survey Continuation Sheet

82

20

Da

No.	Time	Location	sed	cm ²
19		FLOOR		
20		"	1	See attached LSC Printout
21		"	1	
22		"	1	
23		"	1	
24		"	1	
25		"	1	
26		TOP shelf	1	
27		shelf	1	
28		"	1	
29		bot. shelf	1	
30		TOP shelf	1	
31		shelf	1	
32		"	1	
33		bot. shelf	1	
34		COUNTER	1	
35		"	1	
36		"	1	
37		"	1	
38		Hand waste container outside	1	
39		" " inside	1	
40		Top metal shelf	1	
41		shelf	1	
42		bot. shelf	1	
43		TOP shelf	1	
44		shelf	1	
45		bot. shelf	1	
46	↓	bot. shelf counter	1	↓

Radiological Survey Continuation Sheet

Page 3 of 28

Date 5/1/01

No.	Time	Location	Inst. Used	Total Activity (dpm/100 cm ²)
47		top shelf		
48		shelf	1	See attached LSC Printout
49		"	1	
50		"	1	
51		bot. shelf	1	
52		counter	1	
53		"	1	
54		"	1	
55		cup sink	1	
56		"	1	
57		counter	1	
58		"	1	
59		"	1	
60		metal baskets	1	
61		orange chair	1	
62		beige chair	1	
63		outside drawers	1	
64		top drawer	1	
65		drawer	1	
66		top shelf	1	
67		bot. shelf	1	
68		drawer	1	
69		out. drawers	1	
70		top left drawer	1	
71		drawer	1	
72		top right drawer	1	
73		drawer	1	
74	✓	"	1	
			1	

Radiological Survey Continuation Sheet

No.	Time	Location	Inst. Used	
75		bottom drawer		
76		out. drawers	1	See attached LSC Printout
77		top left drawer	1	
78		drawer	1	
79		"	1	
80		top rt. drawer	1	
81		drawer	1	
82		"	1	
83		bot. drawer	1	
84		mid. drawers	1	
85		top drawer	1	
86		drawer	1	
87		bot. drawer	1	
88		drawer	1	
89		out. drawers	1	
90		top drawer	1	
91		drawer	1	
92		bot. drawer	1	
93		floor	1	
94		"	1	
95		"	1	
96		"	1	
97		"	1	
98		brown chair	1	
99		out. waste container	1	
100		inside "	1	
101		out. shelves	1	
102	↓	top shelf	1	↓

Radiological Survey Continuation Sheet

of

to

No.	Time	Location	Inst. Used	Total Acti (dpm/100)
103		Shelf		
104		"	1	See attached LSC Printout
105		bot. shelf	1	
106		top shelf	1	
107		shelf	1	
108		bot. shelf	1	
109		wall	1	
110		"	1	
111		filter system	1	
112		sink counter	1	
113		"	1	
114		sides of sink	1	
115		bottom	1	
116		drawn	1	
117		out. drawers	1	
118		top drawer	1	
119		drawer	1	
120		"	1	
121		bot. drawer	1	
122		out. cabinet	1	
123		inside left	1	
124		↓ bottom	1	
125		↓ right	1	
126		left outside hand	1	
127		top ↓	1	
128		right ↓	1	
129		glass + handlers	1	
130	↓	ledge	1	↓

Radiological Survey Continuation Sheet

Page 6 of 20

Date 5/2/01

No.	Time	Location	Inst. Used	Total Activity (dpm/100 cm ²)
131	0900	left top hood side		
132		left bottom " "	1	See attached LSC Printout
133		top back	1	
134		middle back	1	
135		bottom back	1	
136		right top hood side	1	
137		right bottom " "	1	
138		hood counter	1	
139		"	1	
140		cup sink	1	
141		out. cabinet	1	
142		left	1	
143		bottom	1	
144		right	1	
145		plastic tray	1	
146		out. cabinet	1	
147		left	1	
148		bottom w/ py	1	
149		right	1	
150		plastic tray	1	
151		out. shelves	1	
152		top shelf	1	
153		shelf	1	
154		"	1	
155		out. shelf	1	
156		out. shelves	1	
157		top shelf	1	
158	↓	shelf	1	↓

Radiological Survey Continuation Sheet

Page 7 of 20

Date 5/2/01

No.	Time	Location	Inst. Used	Total Activity (dpm/100 cm ²)
159		shelf		
160		bot. shelf	1	See attached LSC Printout
161		top shelf	1	
162		shelf	1	
163		"	1	
164		bot. shelf	1	
165		top shelf	1	
166		shelf	1	
167		bot. shelf	1	
168		metal shelf parts	1	
169		sm. shielding	1	
170		lg. shielding	1	
171		counter	1	
172		"	1	
173		"	1	
174		"	1	
175		"	1	
176		out. drawers	1	
177		top left drawer	1	
178		drawer	1	
179		top rt. drawer	1	
180		drawer	1	
181		"	1	
182		"	1	
183		bottom drawer	1	
184		out. drawers	1	
185		top left drawer	1	
186		drawer	1	

Radiological Survey Continuation Sheet

Page

No.	Time	Location		dpm/
187		TOP RT. DRAWER		
188		DRAWER	1	See attached LSC Printout
189		"	1	
190		BOTTOM DRAWER	1	
191		DRAWER	1	
192		OUT. DRAWERS	1	
193		TOP DRAWER	1	
194		DRAWER	1	
195		TOP SHELF	1	
196		BOTTOM SHELF	1	
197		LEDGE	1	
198		FLOOR	1	
199		"	1	
200		"	1	
201		"	1	
202		"	1	
203		"	1	
204		"	1	
205		TOP METAL SHELF	1	
206		SHELF	1	
207		BOTTOM SHELF	1	
208		COUNTER SHELF	1	
209		DESK SHELF	1	
210		DESKTOP	1	
211		COUNTER	1	
212		"	1	
213		"	1	
214	✓	CWD SMK	1	↓

Radiological Survey Continuation Sheet

Page 9 of

Date 12/1

No.	Time	Location	Inst. Used	Total Activity (dpm/100)
215		Cup sink & sink		
216		out. drawers	1	See attached LSC
217		top drawer	1	
218		drawer	1	
219		bot. drawer	1	
220		drawer	1	
221		out. drawers	1	
222		top drawer	1	
223		drawer	1	
224		top shelf	1	
225		bottom shelf	1	
226		drawer	1	
227		out. drawers	1	
228		top left drawer	1	
229		drawer	1	
230		top rt. drawer	1	
231		drawer	1	
232		"	1	
233		bottom drawer	1	
234		side of sink cabinet	1	
235		floor	1	
236		"	1	
237		"	1	
238		"	1	
239		"	1	
240		"	1	
241		"	1	
242	↓	"	1	

Radiological Survey Continuation Sheet

Page 10 of 20

Date 5/2/01

No.	Time	Location	Inst. Used	Total Activity (dpm/100 cm ²)
243		wall		
244		"	1	See attached LSC Printout
245		"	1	
246		glass + shelf parts	1	
247		sink counter	1	
248		"	1	
249		sides of sink	1	
250		bottom	1	
251		drain	1	
252		outside sink cabinet	1	
253		left	1	
254		bottom	1	
255		right	1	
256		counter	1	
257		"	1	
258		"	1	
259		desk shelf	1	
260		desk ledge	1	
261		desk top	1	
262		floor	1	
263		"	1	
264		"	1	
265		"	1	
266		"	1	
267		"	1	
268		"	1	
269		wall	1	
270	↓	door	1	
			1	↓

Radiological Survey Continuation Sheet

Pa

te

No.	Time	Location	Inst. Used	Total Acti (dpm/100)
271		Side of sink cabinet		
272		Out. drawers	1	See attached LSC Printout
273		Top left drawer	1	
274		drawer	1	
275		Top rt. drawer	1	
276		drawer	1	
277		"	1	
278		Bottom drawer	1	
279		drawer	1	
280		Out. drawers	1	
281		Top drawer	1	
282		drawer	1	
283		Top shelf	1	
284		Bottom shelf	1	✓ (see # 303)
285		drawer	1	15
286		Out. drawers	1	
287		Top drawer	1	
288		drawer	1	
289		Bot. drawer	1	
290		wall	1	
291		glass wall	1	
292		"	1	
293		Shelves	1	
294		desk	1	
295		Shelves	1	
296		desk	1	
297		floor	1	
298	✓	Shelves	1	✓

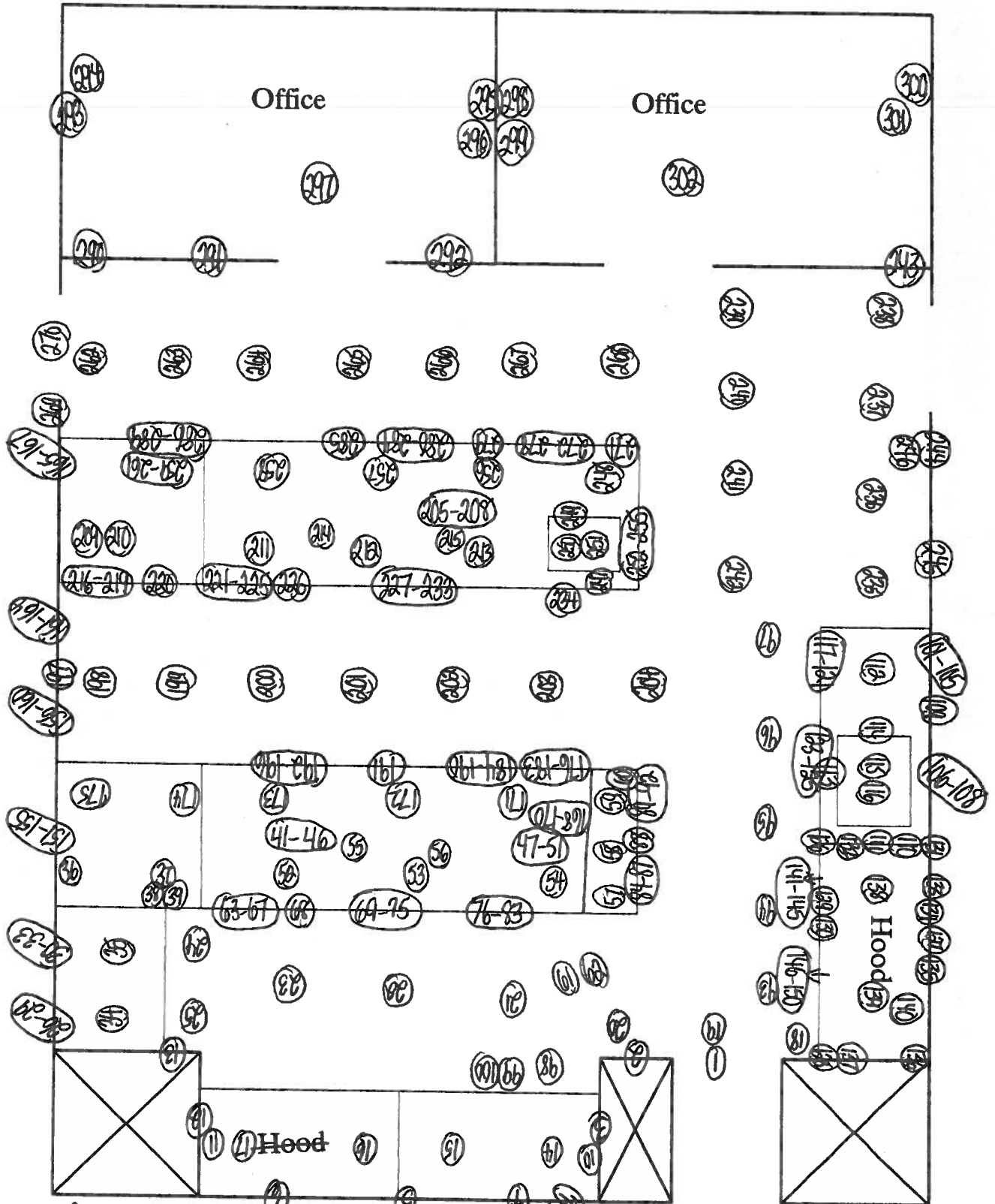

Surveyed 100% of all floor surfaces using instrument #2. All areas were found to be at a level of normal background.

ID: EQUIPMENT SURVY

3 MAY 2001 14:55

USER: 3 COMMENT: EQUIPMENT SURVEY
 PRESET TIME : 1.00
 A CALD : DL DPM H# : YES SAMPLE REPEATS: 1 PRINTER : EDIT
 COUNT BLANK : YES ICM : NO REPLICATES : 1 MONITOR : EDIT
 TWO PHASE : NO ACC : YES CYCLE REPEATS : 1
 SCINFILLATOR: LIQUID LUMEX: YES LOW SAMPLE RES: 0
 LOW LEVEL : NO HALF LIFE CORRECTION RATE: None

ISOTOPE 1: 3H XERROR: 2.00 FACTOR: 1.0000 BKG. SUB: 0
 ISOTOPE 2: 14C XERROR: 2.00 FACTOR: 1.0000 BKG. SUB: 0
 WIDE OPEN WINDOW XERROR: 0.00 FACTOR: 1.0000 BKG. SUB: 0

BACKGROUND GIBSON CURVE: Off COLOR QUENCH CORRECTION: Off

Quench Low: 13.688 High: 306.34

SAM NO	H#	3H CPM	14C CPM	WIDE CPM	3H DPM	14C DPM	LUMEX %	
B1	72.1	24.00	5.00	34.00	47.21	6.29	3.22	
		Blank Average	DPM	for	3H :	47.21	COEF. OF VAR:	0.000
		Blank Average	DPM	for	14C :	6.29	COEF. OF VAR:	0.000
1	73.2	16.00	10.00	30.00	-18.97	6.01	3.22	
2	73.2	20.00	8.00	30.00	3.36	3.98	3.22	
3	82.2	16.00	7.00	25.00	-15.34	2.05	3.22	
4	80.2	27.00	12.00	30.00	-14.10	10.00	3.22	
5	77.2	17.00	8.00	30.00	0.98	10.83	3.86	
6	77.2	22.00	11.00	33.00	-15.41	5.49	3.32	
8	81.0	17.00	8.00	33.00	-0.61	8.07	3.43	
9	85.0	20.00	11.00	43.00	-14.66	4.15	3.28	
10	79.9	23.00	11.00	43.00	-9.00	8.15	3.00	
11	79.5	15.00	8.00	43.00	-3.49	8.07	3.16	
12	91.5	24.00	7.00	30.00	-19.19	4.18	3.34	
13	86.8	18.00	11.00	37.00	3.65	2.72	3.78	
14	104.1	11.00	23.00	48.00	-13.10	8.20	3.42	
15	94.4	8.00	9.00	25.00	-34.13	24.75	2.69	
16	87.9	15.00	11.00	37.00	-33.77	5.72	6.11	
17	90.8	17.00	6.00	35.00	-19.62	8.26	3.34	
18	92.1	26.00	10.00	46.00	-11.90	1.50	4.56	
19	84.5	15.00	12.00	35.00	6.70	6.74	3.91	
20	79.1	20.00	9.00	34.00	-20.62	9.58	3.32	
21	80.2	14.00	10.00	37.00	-9.05	5.44	3.59	
22	92.9	18.00	15.00	42.00	-22.28	6.88	3.61	
23	78.8	17.00	10.00	36.00	-14.26	13.63	3.94	
24	85.1	15.00	14.00	38.00	-16.04	6.82	3.97	
25	85.3	17.00	11.00	36.00	-21.62	12.27	3.28	
26	76.8	17.00	8.00	33.00	-15.57	8.20	3.39	
27	78.8	10.00	6.00	26.00	-15.30	4.14	3.26	
28	81.9	14.00	7.00	34.00	-28.93	1.58	4.69	
29	91.3	13.00	7.00	28.00	-20.50	2.87	1.64	
30	82.4	15.00	12.00	39.00	-21.48	2.92	5.13	
31	80.4	20.00	10.00	41.00	-20.90	9.56	3.44	
32	83.0	24.00	10.00	42.00	-9.34	6.78	2.11	
33	91.7	19.00	13.00	39.00	-0.12	6.73	3.16	
34	100.2	17.00	11.00	41.00	-11.06	10.91	3.39	
35	87.4	16.00	8.00	31.00	-12.98	8.30	3.54	
36	91.9	21.00	5.00	35.00	-15.83	4.20	3.05	
					-1.99	0.08	4.36	

SAM NO	H#	3H CPM	14C CPM	WIDE CPM	3H DPM	14C DPM	LUMEX %
	80.7	22.00	14.00	47.00	-7.05	12.11	2.55
	73.6	18.00	10.00	40.00	-14.69	6.78	2.56
39	76.0	24.00	6.00	40.00	0.35	1.34	1.78
40	89.8	24.00	16.00	52.00	-1.76	14.85	2.17
41	89.7	12.00	10.00	27.00	-25.60	6.97	4.41
42	89.8	17.00	10.00	39.00	-14.29	6.88	3.21
43	90.5	19.00	7.00	37.00	-7.97	2.81	2.97
44	87.9	18.00	13.00	39.00	-14.00	10.90	2.74
45	86.7	16.00	7.00	33.00	-15.41	2.85	3.55
46	92.9	17.00	8.00	37.00	-12.62	4.20	2.97
47	91.9	13.00	11.00	33.00	-23.63	8.32	3.35
48	104.1	11.00	5.00	20.00	-23.30	0.29	6.72
49	84.1	16.00	10.00	35.00	-17.42	6.87	4.27
50	84.1	16.00	8.00	36.00	-16.36	4.18	6.74
51	89.1	15.00	9.00	36.00	-18.37	5.57	4.45
52	86.2	14.00	11.00	36.00	-22.08	8.26	2.92
53	89.1	19.00	11.00	40.00	-10.44	8.19	2.93
54	96.3	20.00	8.00	35.00	-4.96	4.16	12.62
55	82.2	18.00	6.00	33.00	-11.24	1.46	3.41
56	87.5	12.00	11.00	37.00	-26.38	8.31	3.07
57	89.6	23.00	6.00	34.00	1.44	1.39	3.28
58	95.5	19.00	8.00	36.00	-7.47	4.18	4.64
59	86.7	20.00	13.00	39.00	-9.75	10.85	3.75
60	79.1	17.00	5.00	31.00	-13.40	0.13	2.06
61	75.5	15.00	15.00	43.00	-23.25	13.52	2.06
62	80.6	19.00	15.00	43.00	-14.06	13.50	2.41
	78.4	17.00	6.00	31.00	-14.03	1.46	2.69
64	73.8	19.00	16.00	42.00	-15.59	14.78	3.02
65	76.8	21.00	5.00	33.00	-5.30	0.06	4.04
66	77.3	16.00	6.00	37.00	-16.33	1.48	1.78
67	77.5	19.00	10.00	41.00	-11.98	6.78	2.90
68	85.1	21.00	15.00	51.00	-8.91	13.51	1.11
69	79.1	19.00	2.00	30.00	-7.57	-3.92	3.04
70	78.4	20.00	12.00	40.00	-10.73	9.45	2.48
71	76.1	20.00	12.00	43.00	-11.11	9.43	1.93
72	75.6	11.00	11.00	34.00	-29.64	8.24	3.37
73	78.2	21.00	10.00	40.00	-7.60	6.75	3.66
74	75.5	23.00	14.00	50.00	-5.93	12.05	2.29
75	80.1	20.00	10.00	34.00	-9.39	6.78	2.13
76	79.8	22.00	11.00	42.00	-5.67	8.09	2.15
77	75.3	21.00	12.00	45.00	-9.16	9.41	1.50
78	76.6	8.00	11.00	30.00	-35.90	8.30	3.21
79	80.3	19.00	8.00	48.00	-10.45	4.12	1.86
80	75.2	20.00	7.00	37.00	-8.74	2.74	1.83
81	77.1	15.00	13.00	39.00	-22.06	10.86	3.13
82	79.1	20.00	7.00	37.00	-8.01	2.76	3.07
83	76.2	18.00	11.00	35.00	-14.81	8.13	2.10
84	80.7	16.00	11.00	39.00	-18.43	8.19	2.09
85	78.5	16.00	13.00	43.00	-19.76	10.86	3.13
86	75.5	22.00	8.00	40.00	-4.98	4.05	2.36
87	80.1	23.00	9.00	43.00	-2.42	5.39	1.96
	79.3	16.00	6.00	35.00	-16.03	1.48	3.62
	79.3	17.00	11.00	40.00	-16.48	8.17	2.08
90	78.3	21.00	10.00	37.00	-7.57	6.75	2.47
91	74.1	20.00	12.00	42.00	-11.44	9.42	2.66
92	80.9	25.00	8.00	50.00	2.62	4.02	2.04
93	88.0	8.00	5.00	18.00	-32.02	0.30	6.14
94	84.4	7.00	7.00	25.00	-35.55	3.00	6.22

SAM NO	H#	3H CPM	14C CPM	WIDE CPM	3H DPM	14C DPM	LUMEX %
95	81.1	18.00	5.00	34.00	-10.92	0.11	5.08
96	82.4	18.00	7.00	30.00	-11.74	2.80	2.13
97	83.3	14.00	8.00	30.00	-20.84	4.21	3.1
98	75.1	18.00	10.00	33.00	-14.47	6.75	2.94
99	82.3	25.00	7.00	32.00	-13.39	5.47	2.22
100	75.2	25.00	7.00	32.00	-5.17	1.40	2.22
101	84.6	23.00	5.00	30.00	-23.15	8.21	2.22
102	80.2	19.00	10.00	34.00	-30.45	12.34	2.28
103	85.2	19.00	10.00	38.00	-28.74	6.93	2.84
104	85.7	13.00	9.00	28.00	-10.63	6.82	4.29
105	81.4	22.00	10.00	44.00	-23.28	5.59	2.37
106	80.4	13.00	9.00	30.00	-4.81	6.75	1.75
107	77.1	11.00	8.00	29.00	-23.90	5.56	2.79
108	75.3	13.00	9.00	31.00	-27.98	4.24	2.77
109	87.7	12.00	12.00	37.00	-24.44	5.53	5.51
110	90.3	13.00	12.00	37.00	-26.91	9.65	2.53
111	77.7	23.00	10.00	41.00	-24.37	9.65	3.00
112	78.1	14.00	8.00	30.00	-4.55	9.39	3.14
113	75.7	21.00	12.00	42.00	-16.00	0.14	2.69
114	80.7	18.00	16.00	42.00	-1.86	9.39	1.47
115	80.2	17.00	21.00	42.00	-16.73	14.86	1.72
116	78.3	22.00	11.00	58.00	-12.06	8.14	1.67
117	79.1	13.00	4.00	34.00	14.24	7.89	1.64
118	78.1	19.00	5.00	33.00	-18.20	1.50	3.13
119	85.6	18.00	14.00	45.00	-9.31	0.09	2.65
120	75.1	19.00	9.00	38.00	-14.93	12.22	2.28
121	91.9	28.00	7.00	46.00	-20.28	5.50	2.59
122	73.8	13.00	7.00	31.00	12.89	2.65	3.14
123	81.4	25.00	7.00	44.00	-23.59	2.85	2.94
124	83.6	13.00	11.00	33.00	3.24	2.68	3.14
125	80.5	20.00	7.00	42.00	-24.02	8.30	3.66
126	80.9	17.00	8.00	34.00	-7.76	2.76	2.95
127	83.9	22.00	10.00	48.00	-14.67	4.15	3.42
128	81.2	17.00	5.00	30.00	-4.28	6.77	2.03
129	80.7	15.00	9.00	33.00	-13.06	0.13	3.45
130	89.0	18.00	12.00	38.00	-19.55	5.53	3.28
131	83.6	13.00	10.00	37.00	-13.26	9.56	3.03
132	95.8	20.00	8.00	42.00	-24.06	6.92	3.06
133	82.7	25.00	6.00	55.00	-5.08	4.16	3.13
134	83.2	21.00	9.00	45.00	4.10	1.34	1.66
135	91.1	14.00	18.00	37.00	-6.09	5.44	1.25
136	111.4	12.00	11.00	30.00	-25.33	17.73	3.94
137	88.5	10.00	15.00	38.00	-23.47	8.47	5.64
138	90.8	15.00	10.00	34.00	-32.95	13.73	6.36
139	84.3	14.00	17.00	39.00	-16.38	6.91	4.20
140	88.7	7.00	6.00	34.00	-25.51	1.50	2.65
141	95.5	17.00	14.00	42.00	-21.36	3.67	2.95
142	80.2	14.00	14.00	34.00	-11.97	1.50	2.65
143	80.2	14.00	14.00	34.00	-11.97	1.50	2.65
144	80.2	14.00	14.00	34.00	-11.97	1.50	2.65
145	80.2	14.00	14.00	34.00	-11.97	1.50	2.65
146	80.2	14.00	14.00	34.00	-11.97	1.50	2.65
147	80.2	14.00	14.00	34.00	-11.97	1.50	2.65
148	80.2	14.00	14.00	34.00	-11.97	1.50	2.65
149	80.2	14.00	14.00	34.00	-11.97	1.50	2.65
150	86.0	27.00	10.00	50.00	-17.07	2.81	2.69
151	87.5	10.00	12.00	30.00	7.24	6.69	2.18
152	83.6	26.00	11.00	47.00	-31.39	9.69	3.10
					3.86	8.04	2.40

SAM NO	H#	3H CPM	14C CPM	WIDE CPM	3H DPM	14C DPM	LUMEX %
155	79.7	17.00	9.00	34.00	-15.37	5.49	2.49
	84.3	22.00	10.00	40.00	-4.21	6.77	3.25
155	81.0	22.00	7.00	40.00	-3.32	2.73	2.43
156	79.4	19.00	7.00	34.00	-10.10	2.77	3.34
157	84.7	20.00	17.00	47.00	-12.26	16.21	2.54
158	79.3	27.00	11.00	46.00	4.96	8.00	2.75
159	79.6	19.00	5.00	38.00	-9.22	0.09	2.50
160	81.8	19.00	13.00	47.00	-12.81	10.83	1.77
161	82.3	18.00	13.00	41.00	-14.91	10.85	2.45
162	79.0	18.00	12.00	37.00	-14.90	9.49	3.34
163	78.9	18.00	14.00	42.00	-15.95	12.16	2.37
164	78.1	16.00	11.00	36.00	-18.79	8.17	2.36
165	81.8	15.00	10.00	34.00	-19.91	6.87	3.50
166	78.5	15.00	9.00	38.00	-19.83	5.52	2.97
167	89.7	9.00	12.00	32.00	-33.48	9.72	4.75
168	81.1	21.00	7.00	42.00	-5.46	2.75	2.96
169	77.1	21.00	9.00	42.00	-7.29	5.41	2.51
170	84.1	9.00	7.00	25.00	-31.18	2.96	5.64
171	94.7	23.00	7.00	44.00	2.19	2.75	23.80
172	91.8	22.00	10.00	44.00	-2.51	6.81	6.39
173	100.9	18.00	7.00	41.00	-8.08	2.86	3.18
174	83.2	21.00	11.00	41.00	-7.15	8.12	2.50
175	95.2	14.00	7.00	32.00	-18.60	2.92	4.80
176	85.5	16.00	8.00	37.00	-16.14	4.19	4.24
177	81.5	20.00	8.00	34.00	-8.08	4.11	6.69
178	81.9	16.00	10.00	33.00	-17.73	6.86	5.39
	80.9	18.00	8.00	33.00	-12.51	4.14	5.16
180	83.5	20.00	12.00	41.00	-9.81	9.48	3.27
181	83.7	17.00	12.00	43.00	-16.34	9.54	4.78
182	87.3	22.00	9.00	43.00	-3.00	5.44	4.72
183	86.6	19.00	7.00	37.00	-8.76	2.80	4.79
184	84.9	14.00	9.00	35.00	-21.16	5.57	1.87
185	83.2	19.00	10.00	34.00	-11.00	6.81	3.76
186	86.1	18.00	8.00	34.00	-10.53	1.47	2.78
187	84.1	21.00	9.00	35.00	-5.90	5.41	2.51
188	81.5	13.00	5.00	27.00	-11.17	1.81	2.50
189	85.6	16.00	7.00	33.00	-1.85	2.75	4.75
	81.5	18.00	7.00	33.00	-14.39	6.87	4.41
192	82.7	17.00	5.00	29.00	-15.66	12.16	2.37
194	86.6	14.00	7.00	32.00	-18.60	2.92	4.80
	81.5	18.00	8.00	33.00	-12.51	4.14	5.16
196	90.7	6.00	11.00	38.00	-26.02	10.92	5.75
197	92.3	15.00	9.00	32.00	-16.95	8.26	6.77
198	97.5	13.00	14.00	36.00	-17.87	5.59	3.97
199	86.4	22.00	7.00	41.00	-24.65	12.42	10.17
200	96.6	12.00	12.00	26.00	-2.13	2.74	7.56
201	90.5	17.00	9.00	36.00	-25.95	9.72	6.93
202	88.3	8.00	12.00	28.00	-13.61	5.54	7.85
203	83.8	23.00	9.00	44.00	-35.81	9.73	11.33
204	88.2	22.00	7.00	45.00	-1.58	5.41	3.71
	96.4	22.00	7.00	45.00	-1.70	2.75	3.55
206	86.8	14.00	9.00	35.00	-21.16	5.57	1.87
207	81.5	16.00	10.00	34.00	-11.00	6.81	3.76
208	88.6	15.00	13.00	43.00	-10.46	11.04	8.60
209	83.5	17.00	9.00	37.00	-14.81	5.51	5.79
210	84.6	15.00	10.00	32.00	-19.63	6.89	4.77

SAM NO	H#	3H CPM	14C CPM	WIDE CPM	3H DPM	14C DPM	LUMEX %
90.7		21.00	19.00	47.00	-9.60	18.98	5.77
213	95.3	22.00	10.00	42.00	-2.77	6.80	5.76
214	86.6	15.00	12.00	33.00	-19.11	9.66	11.24
215	88.2	19.00	9.00	34.00	-9.83	5.49	4.37
216	80.3	26.00	9.00	43.00	6.17	5.37	
217	85.3	15.00	9.00	33.00	-19.60	5.52	5.36
218	86.4	23.00	-11.00	-4.00	-2.32	8.10	9.42
219		21.00	13.00	44.00	-3.15	10.80	4.47
220		20.00	8.00	38.00	-6.93	0.08	2.62
221	83.1	19.00	14.00	33.00	-32.78	12.34	4.64
222	77.2	13.00	8.00	28.00	-23.50	4.21	4.28
223	78.9	15.00	8.00	31.00	-19.78	5.52	5.32
224	82.9	10.00	11.00	30.00	-31.21	8.31	6.02
225	81.3	13.00	10.00	33.00	-24.31	6.90	4.95
226	80.8	23.00	11.00	44.00	-3.31	8.07	2.49
227	81.4	19.00	5.00	34.00	-8.69	0.10	5.41
228	84.5	10.00	14.00	36.00	-32.69	12.35	3.97
229	76.0	17.00	16.00	43.00	-19.50	14.83	2.95
230	81.9	17.00	5.00	34.00	-12.94	0.13	4.45
231	80.5	17.00	7.00	34.00	-14.22	2.81	3.63
232	81.0	19.00	9.00	39.00	-10.85	5.46	3.27
233	81.6	17.00	9.00	37.00	-15.08	5.50	2.69
234	82.5	16.00	8.00	35.00	-16.59	4.18	3.57
235	84.4	18.00	10.00	36.00	-12.97	6.84	3.10
236	98.2	14.00	10.00	35.00	-19.88	6.99	8.03
237	100.4	21.00	12.00	42.00	-3.95	9.58	5.34
238	93.3	15.00	9.00	36.00	-17.72	5.59	5.33
239	90.9	16.00	9.00	31.00	-15.81	5.56	6.63
240	91.7	14.00	13.00	38.00	-22.48	11.00	5.37
241	91.8	14.00	10.00	35.00	-20.80	6.95	5.20
242	94.0	17.00	6.00	29.00	-11.30	1.51	9.29
243	89.8	15.00	7.00	28.00	-17.16	2.88	5.88
244	107.8	13.00	6.00	28.00	-18.39	1.62	2.69
245	91.5	14.00	9.00	37.00	-20.29	5.60	6.38
246	91.1	13.00	7.00	33.00	-21.51	2.92	7.54
247	93.8	18.00	15.00	42.00	-14.10	13.64	4.77
248	93.1	16.00	10.00	32.00	-16.01	6.92	6.02
249	85.6	16.00	9.00	39.00	-16.65	5.53	5.43
250	82.4	21.00	9.00	37.00	-6.26	5.43	5.35
251	84.3	21.00	14.00	43.00	-8.53	12.16	4.41
252	81.3	19.00	7.00	34.00	-11.92	2.80	3.34
253	80.6	12.00	7.00	32.00	-24.98	2.90	5.97
254	77.2	13.00	14.00	38.00	-26.80	12.23	3.92
255	83.6	21.00	12.00	44.00	-7.60	9.47	5.03
256	80.9	17.00	8.00	35.00	-14.68	4.15	3.39
257	90.4	16.00	5.00	29.00	-13.69	0.17	5.50
258	85.0	25.00	5.00	45.00	5.25	0.00	2.92
259	101.4	10.00	8.00	21.00	-27.84	4.37	15.50
260	88.4	21.00	11.00	41.00	-6.09	8.15	6.73
261	97.8	11.00	12.00	35.00	-28.18	9.75	6.26
262	119.8	9.00	12.00	33.00	-30.97	9.98	7.90
263	92.5	13.00	16.00	38.00	-26.35	15.07	4.76
264	94.3	13.00	13.00	41.00	-24.46	11.04	6.80
265	92.1	17.00	7.00	34.00	-12.21	2.85	3.83
266	89.7	18.00	9.00	37.00	-11.49	5.52	5.19
267	88.8	17.00	12.00	39.00	-15.55	9.57	4.75
268	83.9	18.00	11.00	47.00	-13.58	8.18	3.68
269	89.1	17.00	7.00	33.00	-12.76	2.84	5.41

SAM NO	H#	3H CPM	14C CPM	WIDE CPM	3H DPM	14C DPM	LUMEX %
269	80.0	19.00	7.00	42.00	-9.99	2.78	3.16
270	81.5	12.00	7.00	30.00	-24.88	2.90	5.47
271	86.9	21.00	8.00	37.00	-4.78	4.11	2.77
272	84.0	21.00	11.00	45.00	-6.98	8.13	3.91
273	81.2	19.00	15.00	42.00	-13.96	13.51	2.07
274	85.8	11.00	8.00	22.00	-27.15	4.28	4.55
275	79.6	19.00	10.00	41.00	-11.62	6.79	2.77
276	82.1	20.00	8.00	37.00	-7.95	4.11	4.93
277	86.5	15.00	14.00	38.00	-21.43	12.28	4.15
278	92.5	16.00	11.00	35.00	-16.67	8.27	6.56
279	76.8	15.00	10.00	38.00	-20.56	6.84	4.33
280	82.3	14.00	8.00	33.00	-20.97	4.21	3.88
281	81.1	11.00	11.00	32.00	-29.18	8.28	3.44
282	84.0	11.00	10.00	37.00	-28.40	6.96	3.64
283	81.0	92.00	23.00	110.00	117.98	23.17	1.71
284	86.2	15.00	7.00	27.00	-17.70	2.87	5.18
285	90.7	16.00	8.00	31.00	-15.29	4.21	3.00
286	81.4	15.00	10.00	32.00	-19.97	6.87	4.38
287	83.9	18.00	6.00	36.00	-10.93	1.46	2.61
288	82.1	18.00	8.00	42.00	-12.31	4.14	2.39
289	109.2	12.00	10.00	31.00	-23.16	7.10	7.73
290	77.0	16.00	13.00	39.00	-19.95	10.84	2.81
291	79.7	23.00	7.00	43.00	-1.47	2.77	2.77
292	85.1	15.00	13.00	38.00	-21.08	10.85	2.77
293	83.7	22.00	6.00	35.00	-1.14	-1.29	2.77
294	81.1	15.00	10.00	32.00	-5.34	10.81	2.77
295	81.1	15.00	10.00	32.00	-14.19	5.21	2.77
296	81.1	15.00	10.00	32.00	-15.75	0.15	2.77
297	81.1	15.00	10.00	32.00	-10.56	5.54	8.24
298	81.1	15.00	10.00	32.00	-5.84	4.15	2.65
299	84.8	19.00	13.00	42.00	-12.32	10.85	4.83
300	83.4	20.00	6.00	30.00	-6.65	1.43	4.45
301	97.7	12.00	9.00	31.00	-24.09	5.67	6.27
302	90.9	21.00	11.00	45.00	-5.56	8.17	6.22

ID # EQUIPMENT SURVY

7 MAY 2001 15:12

USER: 3 COMMENT: EQUIPMENT SURVEY

PRESET TIME : 1.00
 A CALC : DL DPM H# : YES SAMPLE REPEATS: 1 PRINTER : EDIT
 COUNT BLANK : YES IC# : NO REPLICATES : 1 RS232 : EDIT
 TWO PHASE : NO ABC : YES CYCLE REPEATS : 1
 SCINTILLATOR: LIQUID LUMEX: YES LOW SAMPLE REJ: 0
 LOW LEVEL : NO HALF LIFE CORRECTION DATE: none

ISOTOPE 1: 3H %ERROR: 2.00 FACTOR: 1.0000 BKG. SUB: 0
 ISOTOPE 2: 14C %ERROR: 2.00 FACTOR: 1.0000 BKG. SUB: 0
 WIDE OPEN WINDOW %ERROR: 0.00 FACTOR: 1.0000 BKG. SUB: 0

BACKGROUND QUENCH CURVE: Off COLOR QUENCH CORRECTION: Off

Quench Limits Low: 13.688 High: 306.34

SAM NO	H#	3H CPM	14C CPM	WIDE CPM	3H DPM	14C DPM	LUMEX %
B1	72.5	14.00	10.00	38.00	24.05	13.12	0.57
		Blank Average DPM for		3H :	24.05	COEF. OF VAR: 0.000	
		Blank Average DPM for		14C :	13.12	COEF. OF VAR: 0.000	

303	72.0	13.00	9.00	31.00	-1.13	-2.66	9.47
304	68.8	32.00	13.00	54.00	34.85	3.69	5.55