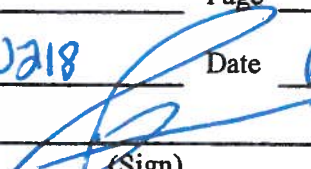

## Radiological Survey Sheet

Job Location Pfizer Gorton Page 1 of 11  
 Survey Purpose LAB DECON 118W Wa18 Date 6/20/09  
 Performed by Dikeefe (Print)  (Sign)

<b>Instrument (Model/S/N)</b>	Packard Tri-Carb S/N 431521	Packard Tri-Carb S/N 431520	Ludlum 2241-2 163603	Wallac Model 1409 S/N 4061042
<b>Det. (Model/SN)</b>	Internal	Internal	Ludlum 43-68 PR 149613	Internal
<b>Type Rad.</b>	β	β	β	β
<b>Cal. Due:</b>	04/03/2010	04/03/2010	04/01/2010	04/03/2010
<b>Check Instruments Used</b>		X	X	

No.	Time	Locations	See attached LSC printout for Total Activity (cpm/100 cm <sup>2</sup> )	
1.	1030	BACKGROUND		
2.		LAB DOOR		
3.		WALL SWIPE		
4.		DRONE		
5.		SHOWER		
6.		OVERHEAD CABINET -OUT		
7.		-IN		
8.		- BENCHTOP		
9.		- DRAWS -OUT		
10.		-IN		
11.		- WALL SWIPE		
12.		- WALL SWIPE		
13.		OVERHEAD CABINET -OUT		
14.		-IN		
15.		- BENCHTOP SWIPE		
16.		- WALL		
17.		- WALL		
18.		1050	- FLOOR	

# Radiological Survey Continuation Sheet

Page 2 of 11

Date 6/20/09

LAB DECON 118 WA18

No.	Time	Locations	See attached LSC printout for Total Activity (cpm/100 cm <sup>2</sup> )	
19	1050	Overhead CABINET	- OUT	
20			- IN	
21		WALL SWIPE		
22		Desktop	- DRAWS - OUT	
23			- IN	
24			ALCOVE	
25			FLOOR	
26			metal Shelf UNIT	- shelves
27				- SUPPORTS
28				- FLOW VALVES
29				- BENCHTOP shelf
30				- BENCHTOP
31				- BASIN
32				- DRAWS - OUT
33				- IN
34				- CABINET - OUT
35				- IN
36				- ALCOVE
37				- FLOOR SWIPE
38			metal Shelf UNIT	- shelves
39				- SUPPORT
40				- FLOW VALVES
41				- BENCHTOP shelf
42				- BENCHTOP
43				- DRAWS - OUT
44		↓		- IN
45		1120		- DRAWS - OUT

# Radiological Survey Continuation Sheet

Page 3 of 11

Date 6/20/09

LAB Decon 118W Wa18

No.	Time	Locations	See attached LSC printout for Total Activity (cpm/100 cm <sup>2</sup> )
46	1120		- IN
47			FLOOR SWIPE
48			END OF BENCHTOP
49			- DRAWS - OUT
50			- IN
51			- FLOOR
52			- FLOOR
53			- DRAWS - OUT
54			- IN
55			- FLOOR
56			Metal shelf unit - shelves
57			- supports
58			BENCHTOP shelf
59			Flow Valves
60			BENCHTOP
61			- DRAWS - OUT
62			- IN
63			- FLOOR
64			Metal shelf unit - shelves
65			- supports
66			- BENCHTOP shelf
67			- Flow Valves
68		- BENCHTOP	
69		- DRAWS - OUT	
70		- IN	
71	D		- Accoure
72	1145		- Floor

# Radiological Survey Continuation Sheet

Page 4 of 11

Date 6/20/09

LAB DeCON 118W wa18

No.	Time	Locations	See attached LSC printout for Total Activity (cpm/100 cm <sup>2</sup> )
73	1145	Desktop	
74		DRAWS	
75		ACCOVE	
76		OVERHEAD CABINET -OUT	
77		-IN	
78		OVERHEAD CABINET -OUT	
79		-IN	
80		Benchtop	
81		ACCOVE	
82		FLOOR SWIPE	
83		metal Shelf UNIT -shelves	
84		-SUPPORTS	
85		- BENCHTOP shelf	
86		- FLOW valves	
87		- BENCHTOP	
88		- DRAWS -OUT	
89		-IN	
90		-CABINET	
91		-ACCOVE	
92		- FLOOR SWIPE	
93		metal Shelf UNIT -shelves	
94		-SUPPORTS	
95		- FLOW valves	
96		- BENCHTOP shelf	
97		- BASIN	
98	▼	- BENCHTOP	
99	1216	- DRAWS -OUT	

# Radiological Survey Continuation Sheet

Page 5 of 11

Date 6/20/09

LAB Decon 118W W218

No.	Time	Locations	See attached LSC printout for Total Activity (cpm/100 cm <sup>2</sup> )
100	1210		- IN
101			- FLOOR
102		END OF BENCHTOP	
103			- FLOOR
104			- CABINET - OUT
105			- IN
106			- FLOOR
107			- FLOOR
108		METAL SHELVES UNIT	- SHELVES
109			- SUPPORTS
110			- FLOW Valves
111			- BENCHTOP
112			- DRAWS - OUT
113			- IN
114			- FLOOR
115		METAL SHELVES UNIT	- SHELVES
116			- SUPPORTS
117			- FLOW Valves
118			- BENCHTOP
119			- DRAWS - OUT
120			- IN
121			- ACCOVE
122			- FLOOR
123		Desktop -	
124		ACOVE	
125	▼		- FLOOR
126	1230		- FLOOR



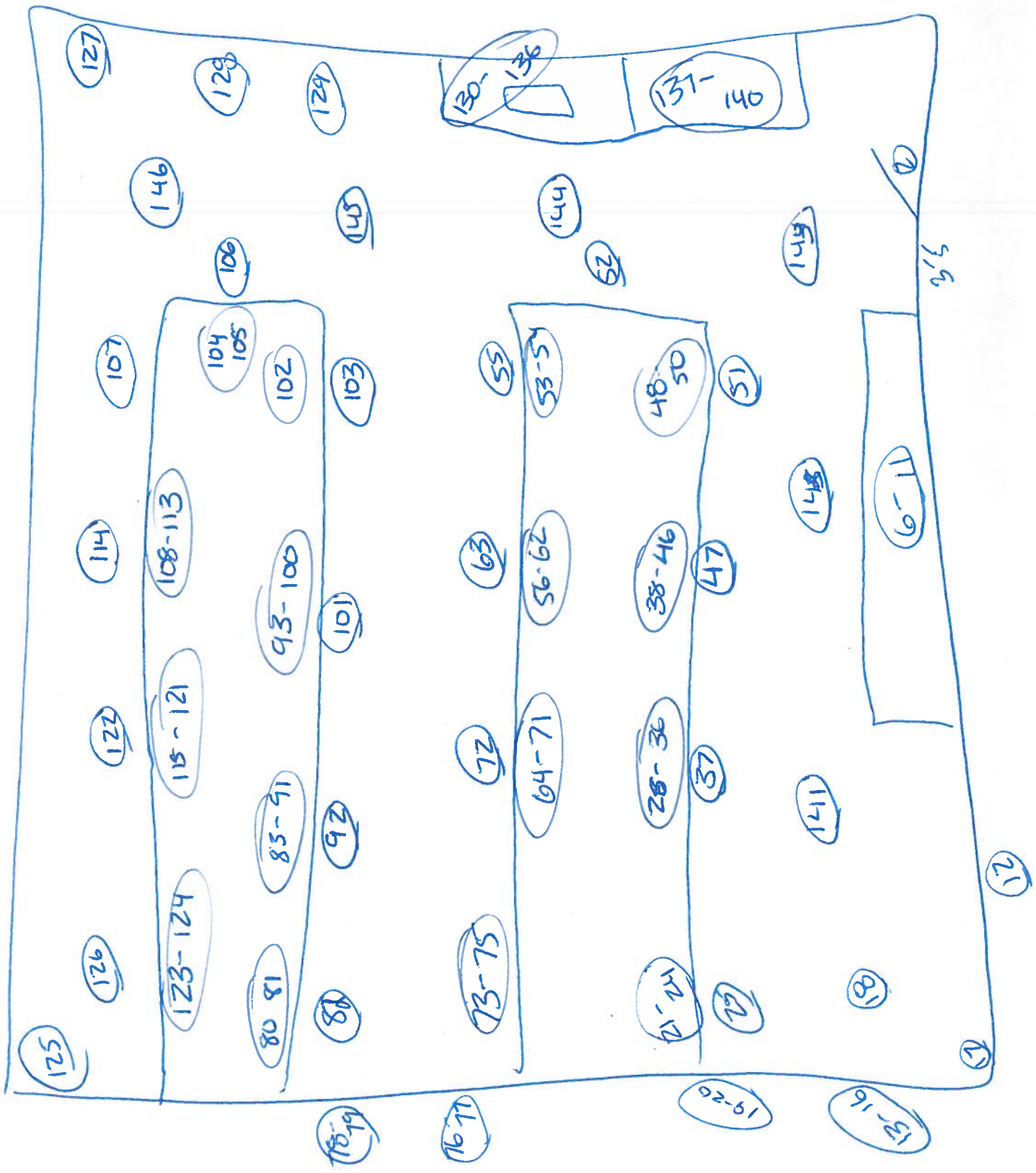

- Surveyed 100% of lower surfaces using 43-68. No readings in excess of normal standards were noted

O = wipe leaflet

Assay Definition-

Assay Description:

Background check for PM Lab (Mikey)

Assay Type: CPM

Report Name: Report1

Output Data Path: C:\Packard\Tricarb\Results\bc\bills swipes

Raw Results Path: C:\Packard\Tricarb\Results\bc\bills swipes\20090620\_1538\20090620\_1538.results

RTF File Name: C:\Packard\Tricarb\Results\bc\bills swipes\Report1.rtf

Assay File Name: C:\Packard\TriCarb\Assays\bills swipes.lsa

Count Conditions-

Nuclide: TRIPLE

Quench Indicator: tSIE/AEC

External Std Terminator (sec): 0.5 2s

Pre-Count Delay (min): 0.00

Quench Set: n/a

Count Time (min): 1.00

Count Mode: Normal

Assay Count Cycles: 1

Repeat Sample Count: 1

#Vials/Sample: 1

Calculate % Reference: Off

Background Subtract: Off

Low CPM Threshold: Off

2 Sigma % Terminator: Off

Regions	LL	UL
A	0.0	18.6
B	18.6	156.0
C	0.0	2000.0

Count Corrections-

Static Controller: On

Luminescence Correction: On

Colored Samples: n/a

Heterogeneity Monitor: n/a

Coincidence Time (nsec): 18

Delay Before Burst (nsec): 75

Half Life-

Half Life Correction: Off

Regions	Half Life	Units	Reference Date	Reference Time
A				
B				
C				

Cycle 1 Results

S#	CPMA	CPMB	CPMC	MESSAGES
1	14	6	20	<u>Background</u>
2	25	4	39	
3	8	3	19	
4	14	13	34	
5	8	6	22	
6	22	6	31	
7	9	6	21	
8	14	3	22	
9	9	6	21	
10	13	5	21	
11	7	7	17	



Protocol# 3 - bills swipes.lsa

User: bc

12	9	4	18
13	21	6	31
14	13	16	34
15	8	4	21
16	11	4	18
17	12	3	20
18	10	7	18
19	21	4	28
20	12	6	21
21	13	11	29
22	14	6	27
23	12	10	26
24	9	8	19
25	5	7	15
26	10	7	19
27	11	7	22
28	13	10	25
29	14	6	26
30	10	2	19
31	11	5	18
32	13	1	17
33	19	9	31
34	14	5	22
35	7	8	22
36	9	6	18
37	5	7	16
38	5	4	16
39	20	5	29
40	7	6	15
41	15	9	32
42	10	6	17
43	17	8	32
44	12	5	24
45	11	4	20
46	12	3	18
47	8	6	19
48	10	6	21
49	9	5	22
50	18	3	26
51	11	10	26
52	7	5	15
53	14	8	26
54	15	7	25
55	17	3	23
56	8	8	20
57	10	3	18
58	14	2	21
59	12	9	23
60	17	7	31
61	11	3	20
62	5	8	22
63	14	7	33
64	12	12	31
65	11	11	26
66	11	9	25
67	9	6	22
68	15	6	25
69	10	13	27
70	11	4	20
71	14	3	21
72	11	4	19
73	19	7	30
74	15	9	30

75	12	7	23
76	7	4	19
77	14	5	23
78	12	8	26
79	8	10	25
80	13	7	24
81	14	6	27
82	11	9	27
83	15	10	35
84	7	7	21
85	15	8	32
86	9	6	19
87	14	6	30
88	4	13	20
89	14	6	28
90	7	6	18
91	9	5	19
92	8	5	23
93	7	3	15
94	8	9	22
95	12	7	27
96	7	9	24
97	9	3	18
98	6	7	18
99	12	4	19
100	11	3	27
101	15	9	30
102	11	5	19
103	15	9	28
104	12	7	24
105	8	6	17
106	14	7	25
107	24	10	37
108	19	12	36
109	15	2	21
110	13	7	24
111	23	5	30
112	11	13	27
113	10	6	26
114	8	5	20
115	14	7	28
116	14	5	25
117	6	4	19
118	20	6	34
119	6	8	18
120	9	3	20
121	16	5	25
122	13	6	25
123	15	6	25
124	17	6	31
125	5	3	13
126	12	8	31
127	14	6	28
128	12	10	27
129	11	9	22
130	10	6	22
131	11	6	21
132	13	7	23
133	17	9	29
134	16	11	31
135	13	5	26
136	11	2	21
137	13	4	23

138	14	8	28
139	16	3	24
140	9	3	19
141	14	1	22
142	18	7	31
143	13	3	19
144	11	2	15
145	13	9	28
146	19	4	27