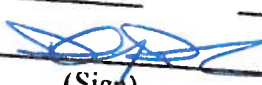

# Radiological Survey Sheet

Job Location PFIZER INC. GASTON CT Page 1 of 9  
 Survey Purpose DECOMMISSIONING 118W/W210A Date 10/20/09  
 Performed by DAVID DURICEZ (Print)  (Sign)

Instrument (Model/S/N)	Packard Tri-Carb S/N 431521	Packard Tri-Carb S/N 431520	Ludlum 2241-2 163603	Wallac Model 1409 S/N 4061042
Det. (Model/S/N)	Internal	Internal	Ludlum 43-68 PR 149613	Internal
Type Rad.	$\beta$	$\beta$	$\beta$	$\beta$
Cal. Due:	04/03/2010	04/03/2010	04/07/2010 <sup>21</sup> <sub>09</sub>	04/03/2010
Check Instruments Used		✓	✓	

No.	Time	Locations
See attached LSC printout for Total Activity (cpm/100 cm <sup>2</sup> )		
1.	0745	BACKGROUND
2.		
3.		UPPER WALL
4.		LOWER WALL
5.		UPPER WALL
6.		LOWER WALL
7.		UPPER WALL
8.		UPPER WALL
9.		LOWER WALL
10.		LOWER WALL
11.		UPPER WALL
12.		UPPER WALL
13.		COUNTER
14.		COUNTER
15.		COUNTER
16.		COUNTER
17.		COUNTER
18.		COUNTER

# Radiological Survey Continuation Sheet

Page 2 of 9

Date 6/20/09

No.	Time	Locations	See attached LSC printout for Total Activity (cpm/100 cm <sup>2</sup> )
19		Control	
20		Control	
21		Control	
22		Control	
23		Upper Door	
24		Lower Door	
25		Upper wall	
26		Lower wall	
27		Upper wall	
28		Upper <del>opposite</del> wall	
29		Lower wall opposite	
30		Lower wall	
31		Lower wall	
32		Lower wall	
33		Upper wall	
34		Upper wall	
35		Upper wall	
36		Upper wall	
37		Upper wall	
38		Upper wall	
39		Flint of wall unit	
40		Bottom shelf	
41		shelf	
42		shelf	
43		top shelf	
44		top shelf	
45	↓	shelf	

# Radiological Survey Continuation Sheet

Page 3 of 9

Date 10/20/09

No.	Time	Locations	See attached LSC printout for Total Activity (cpm/100 cm <sup>2</sup> )
46		SHelf	
47		BOTTOM SHelf	
48		FRONT OF WALL UNIT	
49		FRONT OF DRAWERS	
50		TOP DRAWER	
51		DRAWER	
52		BOTTOM DRAWER	
53		FRONT OF DRAWERS	
54		TOP DRAWER	
55		DRAWER	
56		BOTTOM DRAWER	
57		FRONT OF DRAWERS	
58		TOP DRAWER	
59		DRAWER	
60		BOTTOM DRAWER	
61		LOWER WALL	
62		LOWER WALL	
63		LOWER WALL	
64		LOWER WALL	
65		FRONT OF DRAWERS	
66		TOP DRAWER	
67		DRAWER	
68		BOTTOM DRAWER	
69		DRAWER	
70		DRAWER	
71		FRONT OF WALL UNIT	
72	↓	TOP SHelf	

# Radiological Survey Continuation Sheet

Page 5 of 9

Date 10/20/09

No.	Time	Locations	See attached LSC printout for Total Activity (cpm/100 cm <sup>2</sup> )
100		Floor	
101		Floor	
102		Floor	
103		Floor	
104		Floor	
105		Floor	
106		Floor	
107		Floor	
108		Floor	
109		Floor	
110			
111			
112			
113			
114			
115			
116			
117			
118			
119			
120			
121			
122			
123			
124			
125			
126			



118W/W210A

Page 6 of 7

10/20/09

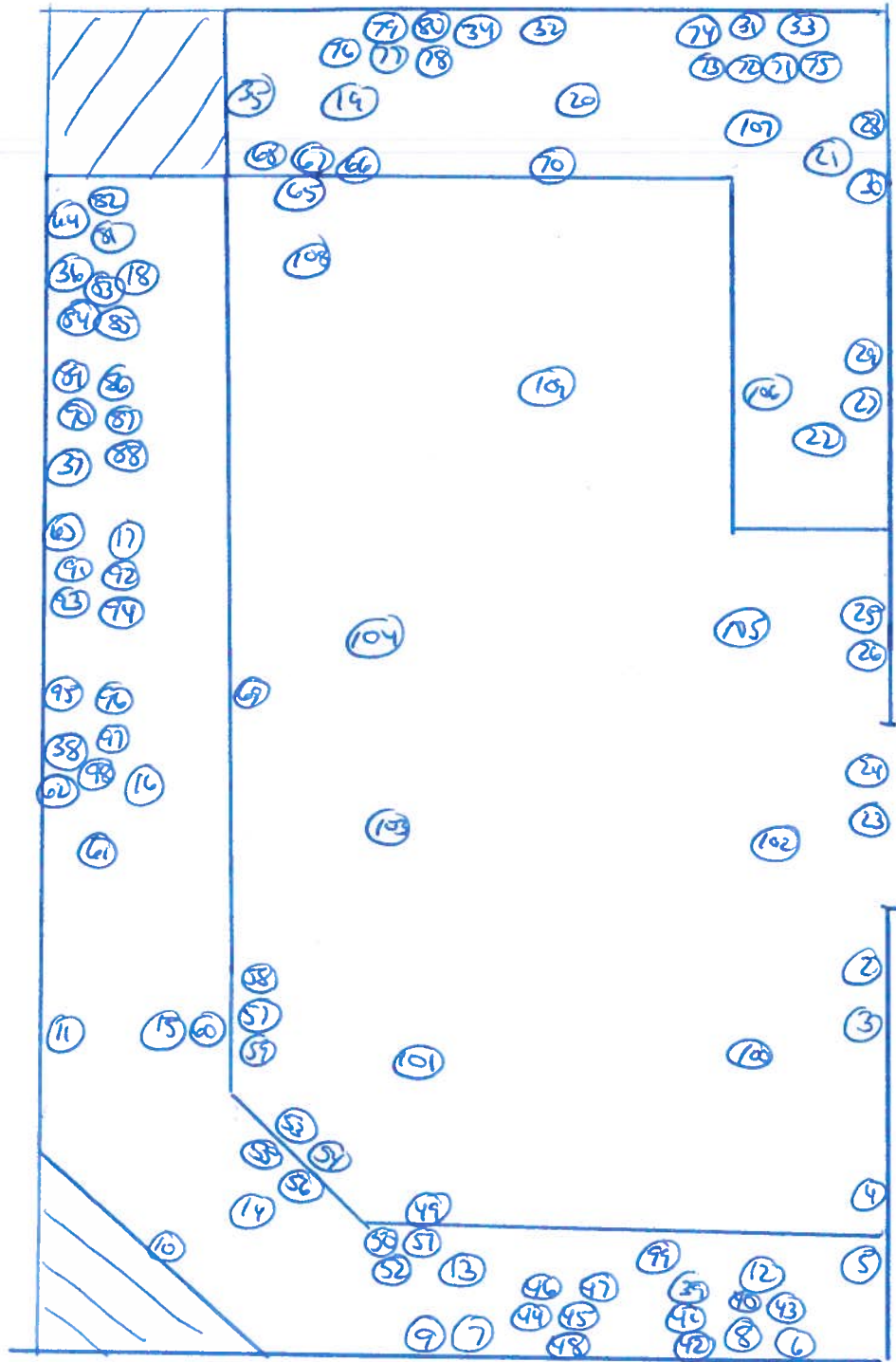

100% of lower surfaces were sampled with 43-68. no plumes noted.  
All readings at normal streamlines cores.

○ = well location

Assay Definition-

Assay Description:

Background check for PM Lab (Mikey)

Assay Type: CPM

Report Name: Report1

Output Data Path: C:\Packard\Tricarb\Results\bill\bills swipes

Raw Results Path: C:\Packard\Tricarb\Results\bill\bills swipes\20091020\_1016\20091020\_1016.results

RTF File Name: C:\Packard\Tricarb\Results\bill\bills swipes\Report1.rtf

Assay File Name: C:\Packard\TriCarb\Assays\bills swipes.lsa

Count Conditions-

Nuclide: TRIPLE

Quench Indicator: tSIE/AEC

External Std Terminator (sec): 0.5 2s3

Pre-Count Delay (min): 0.00

Quench Set: n/a

Count Time (min): 1.00

Count Mode: Normal

Assay Count Cycles: 1

Repeat Sample Count: 1

#Vials/Sample: 1

Calculate % Reference: Off

Background Subtract: Off

Low CPM Threshold: Off

2 Sigma % Terminator: Off

Regions	LL	UL
A	0.0	18.6
B	18.6	156.0
C	0.0	2000.0

Count Corrections-

Static Controller: On

Luminescence Correction: On

Colored Samples: n/a

Heterogeneity Monitor: n/a

Coincidence Time (nsec): 18

Delay Before Burst (nsec): 75

Half Life-

Half Life Correction: Off

Regions	Half Life	Units	Reference Date	Reference Time
A				
B				
C				

Cycle 1 Results

S#	CPMA	CPMB	CPMC	MESSAGES
1	16	2	19	
2	13	5	26	
3	19	7	30	
4	19	6	27	
5	14	8	27	
6	17	6	23	
7	22	7	37	
8	13	5	22	
9	7	4	16	
10	16	6	35	
11	30	5	38	

12	14	2	22
13	15	10	33
14	17	9	35
15	12	6	22
16	12	2	19
17	13	2	20
18	11	9	27
19	15	4	23
20	14	5	26
21	7	5	16
22	8	8	22
23	6	11	21
24	14	8	31
25	12	5	20
26	13	3	21
27	5	10	20
28	15	3	22
29	11	9	26
30	16	8	29
31	12	6	21
32	16	13	36
33	0	4	8
34	14	7	26
35	4	9	16
36	9	5	21
37	17	7	26
38	8	7	20
39	28	7	40
40	10	9	24
41	16	6	26
42	5	4	16
43	3	10	16
44	10	4	21
45	13	6	22
46	22	7	32
47	18	8	30
48	15	3	24
49	15	6	22
50	15	8	30
51	10	7	22
52	11	6	25
53	10	6	21
54	14	10	32
55	12	6	25
56	18	7	28
57	15	6	27
58	4	6	14
59	12	7	26
60	22	3	26
61	13	4	27
62	13	9	26
63	13	5	21
64	14	3	22
65	9	7	21
66	17	5	31
67	14	7	26
68	13	4	24
69	11	6	23
70	16	8	31
71	16	1	19
72	13	8	23
73	11	8	24
74	12	6	27

75	18	2	25
76	10	4	17
77	6	2	16
78	13	8	28
79	20	9	35
80	15	11	30
81	14	2	22
82	22	5	30
83	15	7	26
84	5	9	18
85	5	13	21
86	11	4	21
87	16	7	28
88	14	6	21
89	18	4	31
90	11	7	26
91	13	5	27
92	13	5	21
93	19	11	34
94	20	7	33
95	10	8	22
96	11	7	24
97	10	6	19
98	18	6	30
99	14	7	28
100	12	6	24
101	12	8	22
102	18	4	27
103	11	7	23
104	11	7	24
105	15	10	34
106	12	5	18
107	14	9	30
108	21	5	28
109	20	6	30
Missing vial 110.			
111	10	5	22

*Rest of backside*