

# Radiological Survey Sheet

Job Location Pfizer, Inc. Groton, Ct. 06340 118W/W207 Page 1 8  
 Survey Purpose Radiologic Survey of Equipment LAB DECOM Date 10-24-12  
 Performed by E. CAILOR (Print) E. Cailor (Sign)

Instrument (Model/S/N)	Packard Tri-Carb S/N 431521	Packard Tri-Carb S/N 431520	Ludlum 2241-2 163603	Wallac Model 1409 S/N 4061042
Det. (Model/SN)	Internal	Internal	Ludlum 43-68 PR 149613	Internal
Type Rad.	$\beta$	$\beta$	$\beta$	$\beta$
Cal. Due:	03/05/2013	03/05/2013	04/17/2013	09/15/2012
Check Instruments Used	✓	.	✓	

No.	Time	Locations	See attached LSC printout for Total Activity (cpm/100 cm <sup>2</sup> )
1.	1330	BACKGROUND	
2.		door	
3.		FLOOR	
4.		SINK AREA	
5.		PEG Bd & WALL	
6.		BENCH	
7.		CAB doors	
8.		CAB	
9.		door	
10.		"	
11.		"	
12.		"	
13.		CAB door & TOP SHELF	
14.		" 2nd SHELF	
15.		" 3rd "	
16.		" BOTTOM "	
17.		UPPER WALL	
18.	✓	LOWER WALL	

# Radiological Survey Continuation Sheet

Page 2 of 8

Date 10/24/12

No.	Time	Locations	See attached LSC printout for Total Activity (cpm/100 cm <sup>2</sup> )
19	1330	door	
20		FLOOR	
21		CAB DOOR	
22		" TOP SHELF	
23		" 2ND "	
24		" 3RD "	
25		LOWER WALL	
26		UPPER "	
27		LOWER "	
28		WINDOW & HEATER	
29		" " "	
30		TOP SHELF	
31		2ND "	
32		3RD "	
33		4TH "	
34		TOP "	
35		2ND "	
36		3RD "	
37		4TH "	
38		FLOOR	
39		TOP SHELF	
40		2ND "	
41		3RD "	
42		TOP "	
43		2ND "	
44		3RD "	
45	✓	FLOOR	

# Radiological Survey Continuation Sheet

Page 3 of 8

Date 10-24-12

No.	Time	Locations	See attached LSC printout for Total Activity (cpm/100 cm <sup>2</sup> )
46	1330	LEDGE & HEATER	
47		" "	
48		" "	
49		CAB DOORS	
50		" TOP SHELF	
51		" 2ND "	
52		" 3RD "	
53		" 4TH "	
54		" DOORS	
55		" TOP SHELF	
56		" 2ND "	
57		" 3RD "	
58		" 4TH "	
59		UPPER WALL	
60		LOWER "	
61		UPPER "	
62		LOWER "	
63		UPPER "	
64		LOWER "	
65		WINDOW & WALL	
66		" " "	
67		FLOOR	
68		FLOOR	
69		WINDOW & WALL	
70		FLOOR	
71		FLOOR	
72	✓	Floor	



118 W | W 207

pg 5 of 8  
10-21/12

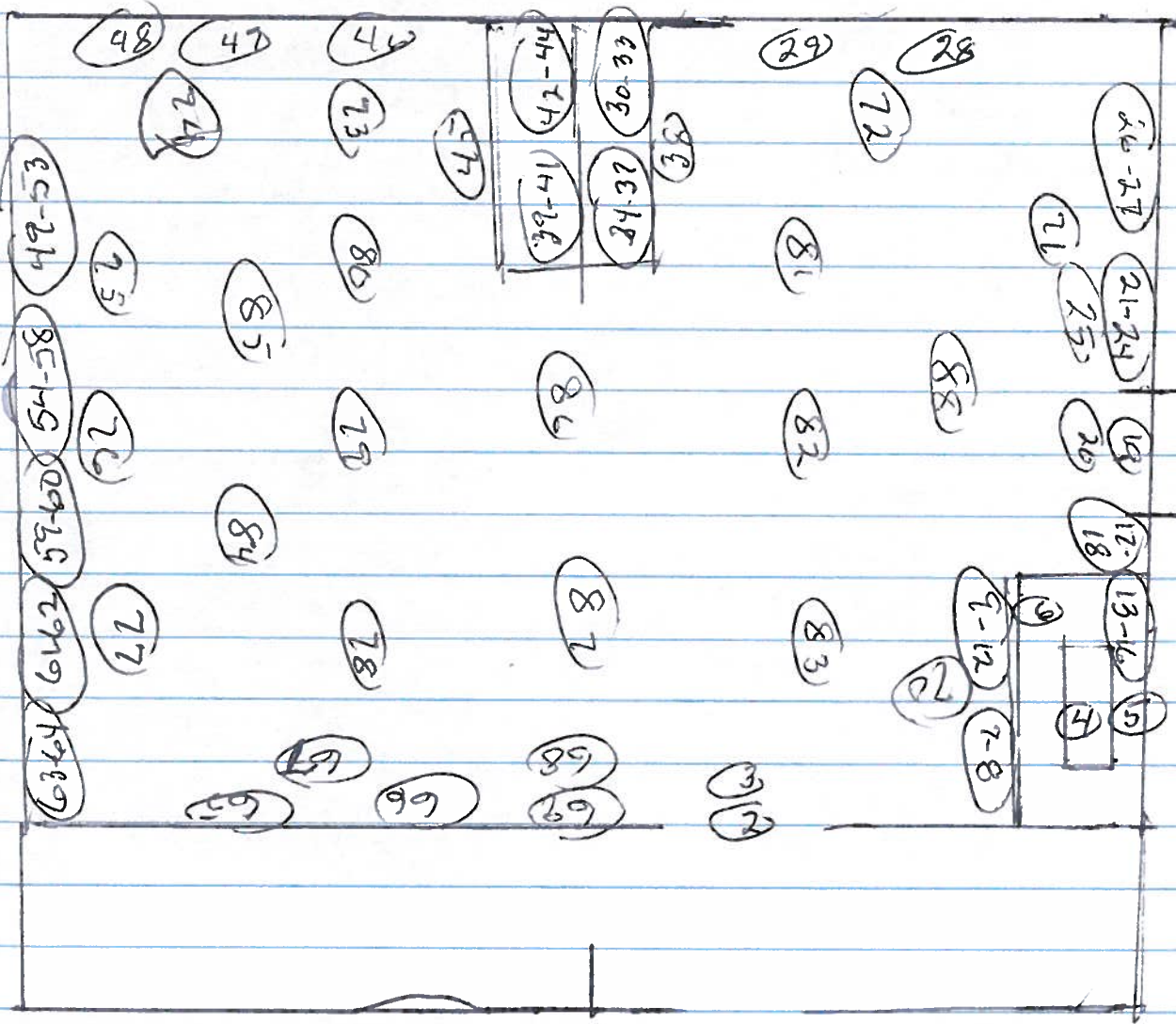

Assay Definition-

Assay Description:  
Equipment Swipes

Assay Type: CPM  
Report Name: Report1  
Output Data Path: C:\Packard\Tricarb\Results\Ed Gailor\Eds Monthly Swipes  
Raw Results Path: C:\Packard\Tricarb\Results\Ed Gailor\Eds Monthly Swipes\20121024\_1631  
\20121024\_1631.results  
RTF File Name: C:\Packard\Tricarb\Results\Ed Gailor\Eds Monthly Swipes\Ed's Monthly  
Swipes.rtf  
Assay File Name: C:\Packard\TriCarb\Assays\Eds Monthly Swipes.lsa

Count Conditions-

Nuclide: Triple  
Quench Indicator: tSIE/AEC  
External Std Terminator (sec): 5 sec  
Pre-Count Delay (min): 0.00  
Quench Set: n/a  
Count Time (min): 1.00  
Count Mode: Normal  
Assay Count Cycles: 1 Repeat Sample Count: 1  
#Vials/Sample: 1 Calculate % Reference: Off

Background Subtract: On - Manual  
Low CPM Threshold: Off  
2 Sigma % Terminator: Off

Regions	LL	UL	Bkg Subtract
A	0.0	18.6	0.00
B	18.6	156.0	0.00
C	0.0	2000.0	0.00

Count Corrections-

Static Controller: On Luminescence Correction: On  
Colored Samples: n/a Heterogeneity Monitor: n/a  
Coincidence Time (nsec): 18 Delay Before Burst (nsec): 75

Half Life-

Half Life Correction: Off

Regions	Half Life	Units	Reference Date	Reference Time
A				
B				
C				

Cycle 1 Results

S#	CPMA	CPMB	CPMC	MESSAGES
1	10	4	20	
2	13	6	28	
3	15	5	23	
4	5	8	18	
5	9	8	23	
6	10	8	20	
7	1	7	15	
8	12	4	23	
9	5	11	21	
10	1	4	9	

11	7	8	18
12	1	8	16
13	9	7	23
14	13	3	18
15	5	11	21
16	4	5	14
17	10	1	13
18	7	8	20
19	9	8	20
20	4	3	12
21	11	10	26
22	10	11	30
23	4	6	13
24	12	5	23
25	4	2	10
26	3	7	15
27	12	6	26
28	5	6	12
29	4	8	16
30	1	4	9
31	8	4	18
32	10	5	22
33	6	7	17
34	11	8	28
35	4	9	19
36	13	7	25
37	13	2	17
38	9	10	24
39	5	12	21
40	12	5	20
41	9	9	22
42	7	7	19
43	12	7	26
44	3	5	10
45	11	7	23
46	2	9	17
47	11	9	25
48	14	11	25
49	8	8	22
50	8	9	21
51	8	9	21
52	3	6	16
53	11	10	25
54	7	8	18
55	4	4	13
56	1	3	5
57	3	8	16
58	9	9	22
59	6	7	19
60	14	7	27
61	18	3	26
62	7	5	22
63	12	7	26
64	11	10	29
65	10	11	24
66	11	8	21
67	4	8	15
68	16	6	27
69	10	11	24
70	10	12	31
71	8	6	20
72	9	8	26
73	12	4	21

74	9	7	24
75	6	7	17
76	8	9	23
77	9	4	14
78	7	9	23
79	6	7	17
80	10	8	24
81	5	7	15
82	11	11	29
83	5	6	24
84	4	8	18
85	11	6	21
86	7	5	16
87	9	13	28
88	2	8	16