

Radiological Survey Sheet

Job Location PRIZEK GROTON CT 06340 Page 1 of 20
 Survey Purpose Room 1220N 118W W206 Date 5/19/04
 Performed by P. KEEFE (Print)  (Sign)

Instrument (Model/S/N)	Packard Tri-Carb S/N 431521	Packard Tri-Carb S/N 431520	Ludlum 2241-2 163603
Det. (Model/SN)	Internal	Internal	Ludlum 43-68 PR 149613
Type Rad.	β	β	β
Cal. Due:	10/24/04	10/24/04	6/25/04
Check Instruments Used	X		X

No.	Time	Locations	See attached LSC printout for Total Activity (cpm/100 cm ²)	
1.	0900	BACKGROUND		
2.		MAIN LAB DOOR - OUTSIDE		
3.		- INSIDE		
4.		WALL SWIPES - UPPER		
5.		- LOWER		
6.		WALL SWIPES - UPPER		
7.		- LOWER		
8.		OVERHEAD CABINET - DOORS		
9.		- Shelves - TOP / MID / BOTTOM		
10.		- INSIDE - LEFT / RIGHT / REAR / BOT		
11.		- OUTSIDE - LEFT / BOT		
12.		Wall shelves - Top		
13.		- Bottom		
14.		WALL SWIPE		
15.		OVERHEAD CABINET - DOORS		
16.		- Shelves - Top / MID / Bottom		
17.		- INSIDE - Left / Right / REAR / BOT		
18.		0920	- OUTSIDE - Bottom / Right	

Radiological Survey Continuation Sheet

Page 3 of 20

Date 5/19/04

Room DECON 118W W206

No.	Time	Locations	See attached LSC printout for Total Activity (cpm/100 cm ²)
46	0950	Wall Cabinet - outside - Bottom	
47		Shelf under cabinet	
48		Wall under shelf	
49		Wall Cabinet #2 - Doors	
50		Shelves - TOP / Bottom	
51		INSIDE - LEFT / Right / REAR / Bottom	
52		outside - Bottom	
53		Shelf under cabinet	
54		Wall under shelf	
55		Desk shelves and supports	
56		Desktop	
57		Desk draws - LEFT - TOP - OUTSIDE / INSIDE	
58		- MIDDLE	↓ ↓
59		- Bottom	
60		- CENTER	OUTSIDE / INSIDE
61		Alcove under desk - LEFT / Right	
62		- REAR / FLOOR	
63		OVERHEAD CABINET - shelves - UPPER / LOWER	
64		- INSIDE - LEFT / REAR / Right / Bottom	
65		- OUTSIDE - Bottom / Right	
66		Flow Values	
67	BENCH SWISS		
68	BENCH DRAWS - Right - UPPER / LOWER		
69	CABINET - DOOR		
70	- Shelf		
71	- INSIDE - Left / Right / REAR / Bottom		
72	1020	DRAW ABOVE ALCOVE - OUT / INSIDE	

Radiological Survey Continuation Sheet

Page 4 of 20

Date 5/19/04

Room DECON 118W W206

No.	Time	Locations	See attached LSC printout for Total Activity (cpm/100 cm ²)
73	1020	AKOGE UNDER BENCHTOP - LEFT / RIGHT	
74		- REAR / FLOOR	
75		OVERHEAD CABINET - shelves - UPPER / LOWER	
76		- INSIDE - LEFT / RIGHT / REAR / BOTTOM	
77		- OUTSIDE - BOTTOM	
78		BENCHTOP SWIPE	
79		CABINET UNDER BENCH - DOOR - OUT / IN	
80		shelf	
81		INSIDE - LEFT / RIGHT / REAR / BOTTOM	
82		OVERHEAD CABINET - DOORS - OUTSIDE / INSIDE	
83		- shelves - UPPER / LOWER	
84		- INSIDE - LEFT / RIGHT / REAR / BOTTOM	
85		- OUTSIDE - LEFT / BOTTOM	
86		BENCHTOP SWIPE	
87		BENCH DRAWS - TOP - OUTSIDE / INSIDE	
88		- UPPER MID	↓
89		- MIDDLE	↓
90		- LOWER MID	↓
91		- BOTTOM - OUTSIDE / INSIDE	
92		BENCH SWIPE	
93		WOODS FRIDGE - DOOR - OUT / IN	
94		- INSIDE - LEFT / RIGHT	
95		- REAR / BOTTOM	
96		DRAWS UNDER BENCH - TOP - OUT / IN	
97		- UPPER MID	↓
98		- LOWER MID	↓
99	1050	- BOTTOM - OUT / IN	

Radiological Survey Continuation Sheet

Page 5 of 20

Date 5/19/04

Room DECON 118W W206

No.	Time	Locations	See attached LSC printout for Total Activity (cpm/100 cm ²)
100	1050	OUTSIDE DRAW UNIT	
101		OUTSIDE DRAW UNIT	
102		BENCHTOP SWIPE	
103		DRAWN UNDER BENCH - TOP	- OUT / IN
104			- UPPER MID ↓
105			- LOWER MID ↓
106			- Bottom - OUT / IN
107		OVERHEAD CABINET - shelves	- UPPER / LOWER
108			- INSIDE - LEFT / RIGHT / REAR / BOTTOM
109			- OUTSIDE - Bottom / Right
110		BENCH SWIPE	
111		ALCOVE UNDER BENCH	- LEFT / RIGHT
112			- FLOOR
113		DRAWN UNDER BENCH	- Left - small top two OUT / IN
114			- med - OUT / IN
115			- Right - sm top two - OUT / IN
116			- med - OUT / IN
117		Lg UPPER	- OUT / INSIDE
118		LOWER	- OUT / INSIDE
119		OVERHEAD CABINET - shelves	- TOP / MID / BOTTOM
120			- INSIDE - LEFT / RIGHT / REAR
121			- OUTSIDE - BOTTOM
122		BENCH SWIPE	
123		OVERHEAD CABINET - shelves	- Top / MID / BOTTOM
124			- INSIDE - LEFT / RIGHT / REAR
125			- OUTSIDE - BOTTOM / LEFT
126	1120	BENCH SWIPE	

Radiological Survey Continuation Sheet

Page 6 of 20

Date 5/19/04

Room DECON 118W W206

No.	Time	Locations	See attached LSC printout for Total Activity (cpm/100 cm ²)
127	1120	SM DRAW UNDER BENCH Right side - OUT IN	
128		ALCOVE UNDER BENCH - LEFT Right	
129		- REAR FLOOR	
130		BENCH DRAW Left - OUT IN	
131		CABINET - DOOR - OUT IN	
132		- Shelf	
133		- INSIDE - LEFT RIGHT	
134		- REAR BOTTOM	
135		DESKTOP SHELVES SUPPORTS	
136		DESKTOP	
137		DRAW ABOVE ALCOVE - OUTSIDE INSIDE	
138		ALCOVE - LEFT Right	
139		- REAR FLOOR	
140		DESK DRWS LEFT - TOP - OUTSIDE INSIDE	
141		- MID ↓ ↓	
142	- BOTTOM - OUTSIDE INSIDE		
143	Wall CABINET #3 - DOORS - OUTSIDE INSIDE		
144	- Shelves - Top MID Bottom		
145	- INSIDE - LEFT Right REAR BOTTOM		
146	- OUTSIDE - Bottom		
147	shelf under CABINET		
148	Wall CABINET #4 - DOORS - OUTSIDE INSIDE		
149	- Shelves - Top MID Bottom		
150	- INSIDE - LEFT Right REAR Bottom		
151	- OUTSIDE - Bottom		
152	↓	shelf under Wall CABINET	
153	1130	Wall under shelf	

Radiological Survey Continuation Sheet

Page 7 of 20

Date 5/19/04

Room DECON 118W W206

No.	Time	Locations	See attached LSC printout for Total Activity (cpm/100 cm ²)
154	1150	Wall CABINET # 5 - DOORS - OUTSIDE/INSIDE	
155		- Shelves - Top / MID / BOTTOM	
156		- INSIDE - Right / LEFT / REAR / Bottom	
157		- OUTSIDE - Bottom	
158		shelf under CABINET	
159		DESKTOP shelves / supports	
160	↓	DESKTOP	
161	1200	DESK DRAWS - Right - Top - OUT / IN	
162	1230	- MID - ↓ ↓	
163		- Bottom - OUT / IN	
164		- CENTER - OUT / IN	
165		ALCOVE UNDER DESK - LEFT / Right	
166		- REAR / FLOOR	
167		OVERHEAD CABINET - DOORS	
168		- Shelves - UPPER / LOWER	
169		- INSIDE - LEFT / Right / REAR / Bottom	
170		- OUTSIDE - Bottom / Flow Values	
171		BENCHTOP SWIRE	
172		DRAWS - Right - UPPER - OUT / IN	
173		- LOWER - OUT / IN	
174		CABINET - DOOR - OUT / IN	
175		- shelf	
176		- LEFT / Right / REAR / Bottom	
177		Draw Above ALCOVE - OUT / IN	
178		ALCOVE - LEFT / Right / REAR / FLOOR	
179	↓	OVERHEAD CABINET - DOORS	
180	1300	- shelves - UPPER / LOWER	

Radiological Survey Continuation Sheet

Page 8 of 20

Date 5/19/04

Room Decon 118W W206

No.	Time	Locations	See attached LSC printout for Total Activity (cpm/100 cm ²)
181	1300	OVERHEAD CABINET - INSIDE - LEFT RIGHT REAR BOTTOM	
182		- OUTSIDE - BOTTOM	
183		BENCHTOP SWIPE	
184		OVERHEAD CABINET - DOORS - OUTSIDE INSIDE	
185		- Shelves - UPPER LOWER	
186		- INSIDE - LEFT RIGHT REAR BOTTOM	
187		- OUTSIDE - BOTTOM	
188		BENCHTOP SWIPE	
189		DRAW - LEFT - UPPER LOWER - OUTSIDE INSIDE	
190		- RIGHT - UPPER LOWER - OUTSIDE INSIDE	
191		- Lg - UPPER - OUTSIDE INSIDE	
192		- LOWER - OUTSIDE INSIDE	
193		BENCHTOP SWIPE	
194		DRAW - TOP - OUT IN	
195		- UPPER MID ↓ ↓	
196		- LOWER MID ↓ ↓	
197		- BOTTOM - OUT IN	
198		OUTSIDE OF DRAW CABINET - LEFT	
199		OUTSIDE OF DRAW CABINET - RIGHT	
200		DRAW - TOP - OUTSIDE INSIDE	
201	- UPPER MID ↓ ↓		
202	- LOWER MID ↓ ↓		
203	- BOTTOM - OUT IN		
204	OVERHEAD CABINET - DOORS - OUTSIDE INSIDE		
205	- Shelves - UPPER LOWER		
206	- INSIDE - LEFT RIGHT REAR BOTTOM		
207	1330	- OUTSIDE - BOTTOM RIGHT FLOW VENTS	

Radiological Survey Continuation Sheet

Page 9 of 20

Date 5/19/04

Room DECON 118W W206

No.	Time	Locations	See attached LSC printout for Total Activity (cpm/100 cm ²)
208	1330	BENCHTOP SWIPE	
209		Alcove under bench - LEFT / RIGHT	
210		- REAR / FLOOR	
211		BENCH DRAW - TOP - OUTSIDE / INSIDE	
212		- UPPER MID ↓ ↓	
213		- LOWER MID ↓ ↓	
214		- BOTTOM - OUTSIDE / INSIDE	
215		OVERHEAD CABINET - DOORS - OUTSIDE / INSIDE	
216		- Shelves - UPPER / LOWER	
217		- INSIDE - LEFT / RIGHT / REAR / BOTTOM	
218		- OUTSIDE - BOTTOM	
219		BENCH SWIPE	
220		DRAW - TOP - OUTSIDE / INSIDE	
221		- UPPER MID - ↓ ↓	
222		- LOWER MID - ↓ ↓	
223		- BOTTOM - OUT / INSIDE	
224		OVERHEAD CABINET - DOORS - OUTSIDE / INSIDE	
225		- Shelves - UPPER / LOWER	
226		- INSIDE - LEFT / RIGHT / REAR / BOTTOM	
227		- OUTSIDE - BOTTOM / LEFT / FLOW VALVES	
228		BENCHTOP	
229		DRAW ABOVE ALCOVE - OUTSIDE / INSIDE	
230	ALCOVE - LEFT / RIGHT		
231	- REAR / FLOOR		
232	DRAW - LEFT SIDE - UPPER - OUT / IN		
233	- LOWER - OUT / IN		
234	1400	CABINET - DOOR - OUTSIDE / INSIDE	

Radiological Survey Continuation Sheet

Page 10 of 20

Date 5/19/04

Room NECOW 18W W206

No.	Time	Locations	See attached LSC printout for Total Activity (cpm/100 cm ²)
235	1400	CABINET - shelf	
236		- INSIDE - LEFT RIGHT REAR BOTTOM	
237		DESK shelves supports	
238		DESK TOP	
239		DESK DRAWS - LEFT - TOP - OUT IN	
240		- MID ↓ ↓	
241		- BOTTOM - OUT IN	
242		DESK above ALCOVE - OUT IN	
243		ALCOVE - LEFT RIGHT	
244		- REAR BOTTOM	
245		Wall CABINET - DOORS - OUT IN	
246		- shelves - TOP MID BOTTOM	
247		- INSIDE - LEFT RIGHT REAR BOTTOM	
248		- OUTSIDE - LEFT BOTTOM	
249		shelf UNDER Wall CABINET	
250		AREA UNDER shelf	
251		Wall EA SWIDES - UPPER	
252		- LOWER	
253		Sm. CABINET - DOORS - OUT IN	
254		- TOP RIGHT LEFT	
255		- shelf	
256		- INSIDE - LEFT RIGHT REAR BOTTOM	
257		Wall SWIDES - UPPER	
258		- Lower	
259		- UPPER	
260		- LOWER	
261	1430	Window / HEATER SWIDES - Right Side	

Radiological Survey Continuation Sheet

Page 11 of 20

Date 5/19/04

Room Decou 118W W206

No.	Time	Locations	See attached LSC printout for Total Activity (cpm/100 cm ²)
262	1430	Window heater swipes - LEFT	
263		Wall swipes - UPPER	
264		- LOWER	
265		CABINET - OUTSIDE - LEFT / Right	
266		- DRAWS - TOP - OUT / IN	
267		- UPPER MID	↓
268		- MID	↓
269		- LOWER MID	↓
270		- BOTTOM - OUT / IN	
271		DESK SWIPES	
272		DRAWS - LEFT - OUT / IN	
273		- Right - OUT / IN	
274		WINDOW / HEATER - Right	
275		- LEFT	
276		FILE CABINET - Right	
277		FILE CABINET - LEFT	
278		GLASS DOORS	
279		Wall swipes - UPPER	
280		- LOWER	
281		OVERHEAD CABINET ^(Right) - DR DOORS - OUT / IN	
282		- Shelves - UPPER / LOWER	
283		- OUTSIDE Bottom / Right	
284		OVERHEAD CABINET - LEFT - DOORS - OUT / IN	
285		- Shelves - UPPER / LOWER	
286		- OUTSIDE - Bottom / Right	
287	↓	BENCHTOP SWIPE	
288	1500	Faucet / eyewash station	

Radiological Survey Continuation Sheet

Page 12 of 20

Date 5/19/04

Room DECON 11&W W206

No.	Time	Locations	See attached LSC printout for Total Activity (cpm/100 cm ²)
289	1500	BASIN - LEFT / RIGHT	
290		- REAR / BOTTOM	
291		CABINET UNDER BASIN - OUTSIDE - DOORS - OUT / IN	
292		- RIGHT	
293		- INSIDE - LEFT / RIGHT	
294		- REAR / BOTTOM	
295		DRAWERS - TOP - OUTSIDE / INSIDE	
296		- UPPER MID	↓
297		- LOWER MID	↓
298		- BOTTOM - OUTSIDE / INSIDE	
299		HOOD - OUTSIDE TOP	
300		- GLASS SASH	
301		- CONTROLS	
302		INSIDE - LEFT / RIGHT	
303		- NEAR - UPPER	
304		- LOWER	
305		- WORK AREA - LEFT	
306		- RIGHT	
307		CABINET UNDER HOOD - LEFT - DOORS - OUT / IN	
308		- INSIDE - LEFT / RIGHT / REAR / BOTTOM	
309		- RIGHT - DOORS - OUT / IN	
310		- INSIDE - LEFT / RIGHT / REAR / BOTTOM	
311		FLOOR SWIPES	
320	1545	FLOOR SWIPES	

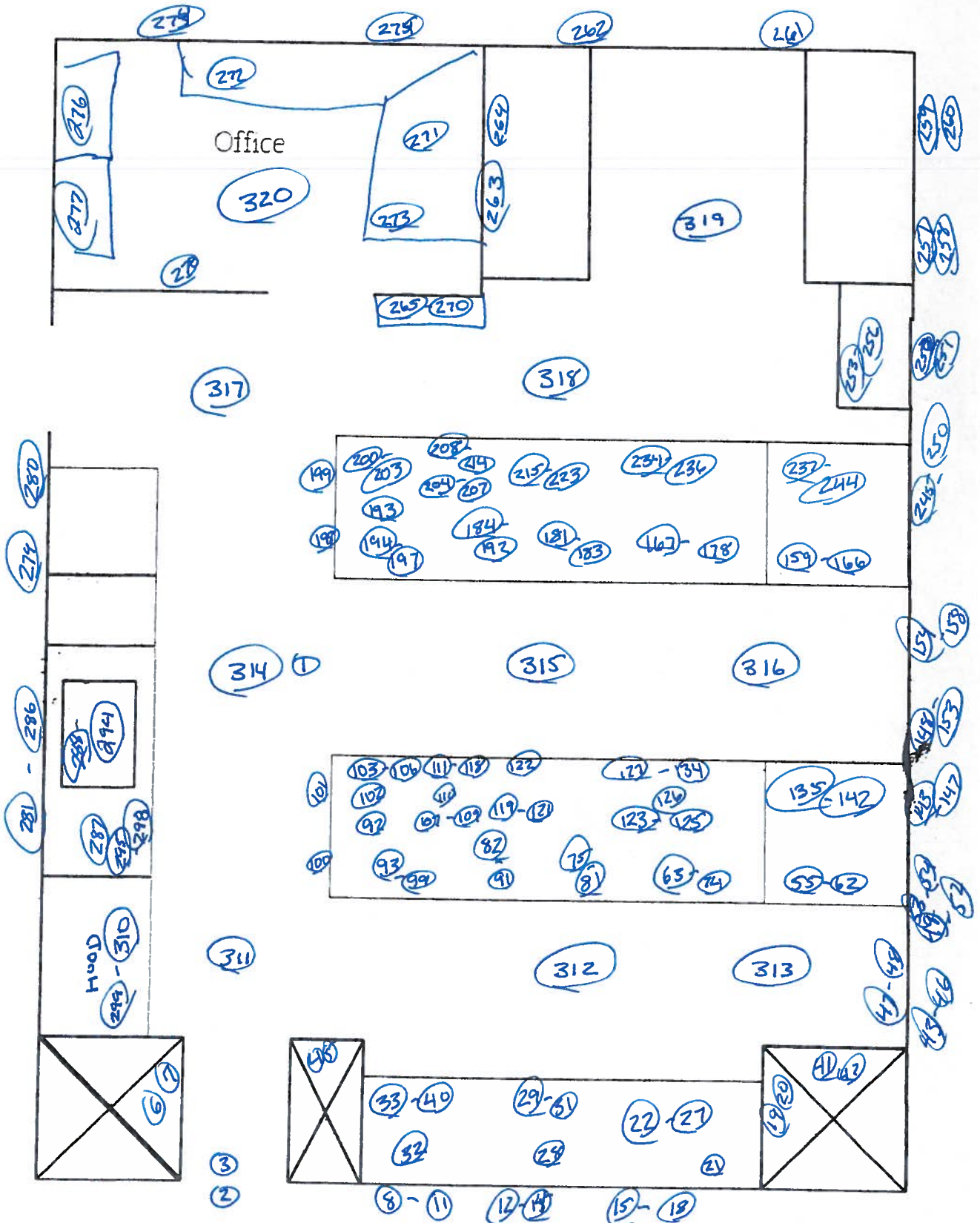

O-wipe
Lcmtm

All SURFACES surveyed with Lwelum 2241-2
AND FOUND to be within limits 6/4/04

Assay Definition-

Assay Description:

Assay Type: CPM

Report Name: Report1

Output Data Path: C:\Packard\Tricarb\Results\Pete Keefe\Room Decon

Raw Results Path: C:\Packard\Tricarb\Results\Pete Keefe\Room Decon\20040519_1237.results

Assay File Name: C:\Packard\TriCarb\Assays\Room Decon.lsa

Count Conditions-

Nuclide: Triple

Quench Indicator: tSIE/AEC

External Std Terminator (sec): 0.5 2s

Pre-Count Delay (min): 0.00

Quench Set: n/a

Count Time (min): 1.00

Count Mode: Normal

Assay Count Cycles: 1

#Vials/Sample: 1

Repeat Sample Count: 1

Calculate % Reference: Off

Background Subtract: Off

Low CPM Threshold: Off

2 Sigma % Terminator: Off

Regions	LL	UL
A	0.0	18.6
B	18.6	156.0
C	0.0	2000.0

Count Corrections-

Static Controller: On

Colored Samples: n/a

Coincidence Time (nsec): 18

Luminescence Correction: On

Heterogeneity Monitor: n/a

Delay Before Burst (nsec): 75

Half Life-

Half Life Correction: Off

Regions	Half Life	Units	Reference Date	Reference Time
A				
B				
C				

Cycle 1 Results

S#	CPMA	CPMB	CPMC	MESSAGES	LUM
1	10	3	24		31
2	16	5	28		24
3	9	4	15		35
4	11	4	22		18
5	13	6	30		26
6	9	9	26		27
7	13	7	30		22
8	19	6	33		18
9	7	7	20		41
10	7	6	19		48
11	15	3	19		29
12	23	10	40		22
13	14	11	33		23

Protocol# 10 - Room Decon.lsa

Room Decon Swipes 118W W206

User: Pete Keefe

Page 15 of 20

14	22	9	45	26
15	8	6	17	41
16	18	5	31	36
17	15	9	32	27
18	13	5	26	50
19	13	4	26	36
20	16	3	25	32
21	12	7	27	45
22	20	6	32	17
23	28	7	45	13
24	14	3	21	25
25	9	7	23	38
26	19	8	34	21
27	14	8	33	29
28	19	9	42	25
29	24	3	34	26
30	21	8	38	24
31	6	7	22	37
32	20	14	39	16
33	6	9	24	38
34	10	5	24	38
35	19	6	32	30
36	17	6	33	24
37	18	7	34	30
38	12	8	26	27
39	15	7	30	25
40	12	5	21	48
41	16	5	31	39
42	11	6	24	30
43	12	3	20	43
44	17	4	33	37
45	14	5	24	41
46	13	3	25	44
47	21	6	35	42
48	11	7	28	29
49	19	15	46	18
50	11	9	27	36
51	12	7	23	33
52	19	9	35	25
53	18	5	28	32
54	10	5	20	46
55	5	9	23	41
56	7	11	23	53
57	11	5	22	52
58	11	5	22	42
59	8	5	20	48
60	21	4	35	39
61	7	12	25	45
62	13	11	31	31
63	7	8	24	38
64	18	5	29	28
65	10	8	22	27
66	9	9	24	41
67	6	6	19	50
68	17	6	28	28
69	20	9	35	18
70	17	3	32	32
71	20	11	38	19
72	10	8	27	33
73	13	5	22	35
74	15	6	32	39
75	11	4	29	46
76	21	10	36	19

Protocol# 10 - Room Decon.lsa

Room Decon Swipes 118W W206

User: Pete Keefe

Page 16 of 20

77	21	6	33	24
78	8	7	30	39
79	11	5	23	32
80	5	3	13	85
81	11	5	24	44
82	10	8	26	24
83	16	5	25	21
84	17	8	34	15
85	13	8	35	13
86	3	5	22	50
87	21	7	35	16
88	16	8	30	19
89	13	6	22	26
90	9	7	22	30
91	10	7	23	25
92	14	7	30	26
93	10	10	27	27
94	17	10	34	17
95	19	5	30	27
96	18	8	29	20
97	17	6	31	24
98	17	8	37	18
99	14	8	27	33
100	4	3	14	72
101	6	8	16	48
102	20	3	30	27
103	9	11	28	27
104	14	10	25	27
105	5	7	18	38
106	15	7	27	23
107	15	5	29	25
108	11	12	26	19
109	15	6	26	24
110	13	9	26	23
111	17	11	38	21
112	10	10	27	27
113	11	6	23	52
114	14	3	25	35
115	20	4	35	23
116	16	9	31	27
117	6	6	21	39
118	5	7	21	45
119	21	5	33	33
120	14	8	26	35
121	12	3	24	32
122	13	8	30	21
123	13	11	31	19
124	14	9	31	22
125	15	11	32	17
126	14	4	29	20
127	12	6	23	29
128	16	4	25	32
129	3	10	19	37
130	6	4	20	58
131	15	1	24	36
132	17	3	35	38
133	12	11	30	29
134	11	6	31	40
135	9	10	26	28
136	17	10	35	24
137	12	6	29	27
138	15	5	25	25
139	15	7	29	25

Protocol# 10 - Room Decon.lsa

Room Decon Swipes 118W W206

User: Pete Keefe

Page 17 of 20

140	12	7	23	28
141	12	6	27	38
142	17	10	35	24
143	14	8	28	35
144	15	5	24	38
145	14	6	24	45
146	20	12	36	27
147	12	6	27	46
148	13	6	23	33
149	16	6	29	30
150	20	14	44	20
151	19	5	33	35
152	11	14	35	32
153	7	3	18	56
154	8	9	27	42
155	8	8	24	42
156	7	11	27	41
157	21	10	34	19
158	20	6	34	29
159	17	4	26	30
160	9	11	27	45
161	11	6	22	44
162	12	7	25	28
163	11	9	27	36
164	10	9	26	39
165	4	8	21	55
166	15	3	24	46
167	14	5	22	45
168	13	8	32	31
169	5	10	26	38
170	15	12	29	24
171	16	6	26	41
172	6	3	15	53
173	9	5	22	45
174	16	5	31	39
175	10	13	31	34
176	8	11	27	41
177	12	5	23	35
178	12	8	26	36
179	11	8	26	33
180	9	7	19	32
181	9	6	25	52
182	12	10	28	41
183	22	2	31	23
184	10	8	26	33
185	15	5	31	31
186	13	8	25	34
187	4	14	25	43
188	21	9	37	26
189	11	6	26	35
190	10	9	29	45
191	11	4	19	48
192	11	9	23	32
193	18	6	28	27
194	15	10	36	27
195	15	7	30	25
196	14	7	27	24
197	10	12	30	35
198	15	6	30	31
199	7	9	21	36
200	12	12	30	28
201	12	6	31	35
202	16	12	31	24

Protocol# 10 - Room Decon.lsa

Room Decon Swipes 118W W206

User: Pete Keefe

Page 18 of 20

203	7	8	20	39
204	10	6	19	38
205	15	12	33	19
206	8	6	18	33
207	17	5	26	25
208	17	6	33	22
209	15	9	27	21
210	22	8	36	19
211	16	9	36	21
212	11	12	29	9
213	14	4	19	27
214	14	6	28	22
215	10	7	22	21
216	9	8	27	16
217	20	7	35	10
218	12	2	16	7
219	11	7	25	11
220	13	14	35	7
221	14	6	25	25
222	4	4	13	50
223	11	4	25	28
224	8	6	17	33
225	9	5	18	25
226	11	13	30	21
227	13	5	21	29
228	11	3	17	25
229	19	5	30	23
230	15	6	25	21
231	18	7	33	11
232	11	11	31	17
233	11	7	25	15
234	14	7	24	10
235	8	13	26	13
236	14	10	34	8
237	4	7	20	18
238	12	8	29	10
239	9	8	20	16
240	5	8	18	20
241	11	7	25	20
242	11	8	30	39
243	12	10	33	23
244	13	4	22	29
245	12	8	23	25
246	15	8	35	19
247	9	8	27	25
248	16	10	36	20
249	14	9	31	28
250	18	13	39	12
251	10	1	16	47
252	15	12	30	19
253	15	3	25	11
254	12	4	23	13
255	15	6	30	5
256	10	4	18	19
257	11	7	30	11
258	13	8	30	17
259	13	5	26	15
260	14	5	27	11
261	18	6	32	12
262	13	8	29	21
263	10	12	31	20
264	11	4	24	18
265	12	12	31	12

Protocol# 10 - Room Decon.lsa

Room Decon Swipes 118W W206

User: Pete Keefe

Page 19 of 20

266	10	8	29	15
267	12	13	30	15
268	14	7	29	13
269	8	5	23	20
270	11	6	28	16
271	12	9	30	21
272	20	5	33	11
273	12	8	22	14
274	13	8	24	13
275	16	3	23	11
276	21	7	33	7
277	16	8	30	8
278	12	8	27	10
279	19	11	35	7
280	9	7	27	13
281	12	10	32	25
282	12	5	24	30
283	13	6	24	26
284	9	5	19	29
285	12	9	24	21
286	7	3	17	43
287	14	9	33	24
288	8	1	15	46
289	12	8	27	18
290	19	10	36	7
291	7	8	26	18
292	14	6	23	10
293	11	13	34	12
294	12	3	21	18
295	13	11	27	8
296	12	10	31	9
297	6	11	23	12
298	10	6	23	17
299	11	8	28	14
300	8	10	26	20
301	7	8	26	18
302	13	9	26	23
303	16	6	29	13
304	29	22	60	8
305	38	32	75	3
306	21	12	36	9
307	31	26	65	7
308	20	11	35	6
309	15	13	36	13
310	8	7	20	13
311	14	12	30	8
312	14	8	27	9
313	12	12	33	8
314	12	7	28	19
315	8	7	20	33
316	9	7	21	22
317	11	6	24	16
318	11	6	27	16
319	8	14	30	13
320	16	9	31	11

Protocol# 10 - Room Decon.lsa

Room Decon Reswipes 118W W206

User: Pete Keefe

Page 20 of 20

Assay Definition-

Assay Description:

Assay Type: CPM

Report Name: Report1

Output Data Path: C:\Packard\Tricarb\Results\Pete Keefe\Room Decon

Raw Results Path: C:\Packard\Tricarb\Results\Pete Keefe\Room Decon\20040520_1511.results

Assay File Name: C:\Packard\TriCarb\Assays\Room Decon.lsa

Count Conditions-

Nuclide: Triple

Quench Indicator: tSIE/AEC

External Std Terminator (sec): 0.5 2s*

Pre-Count Delay (min): 0.00

Quench Set: n/a

Count Time (min): 1.00

Count Mode: Normal

Assay Count Cycles: 1

#Vials/Sample: 1

Repeat Sample Count: 1

Calculate % Reference: Off

Background Subtract: Off

Low CPM Threshold: Off

2 Sigma % Terminator: Off

Regions	LL	UL
A	0.0	18.6
B	18.6	156.0
C	0.0	2000.0

Count Corrections-

Static Controller: On

Colored Samples: n/a

Coincidence Time (nsec): 18

Luminescence Correction: On

Heterogeneity Monitor: n/a

Delay Before Burst (nsec): 75

Half Life-

Half Life Correction: Off

Regions	Half Life	Units	Reference Date	Reference Time
A				
B				
C				

Cycle 1 Results

S#	CPMA	CPMB	CPMC	MESSAGES	LUM
1	11	6	26		30
2	15	8	31		28
3	12	7	28		39
4	8	9	31		36

Background Reswipe # 304 # 305 # 307