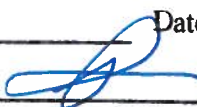

Radiological Survey Sheet

Job Location Pfizer Groton CT 06340 Page 1 of 20
 Survey Purpose Room Decon 118W W204 Date 5/28/04
 Performed by P. KEENE (Print)  (Sign)

Instrument (Model/S/N)	Packard Tri-Carb S/N 431521	Packard Tri-Carb S/N 431520	Ludlum 2241-2 163603	
Det. (Model/SN)	Internal	Internal	Ludlum 43-68 PR 149613	
Type Rad.	β	β	β	
Cal. Due:	10/24/04	10/24/04	6/25/04	
Check Instruments Used	X		X	

No.	Time	Locations	See attached LSC printout for Total Activity (cpm/100 cm ²)	
1.	0700	BACKGROUND		
2.	↓	MAIN LAB DOOR - OUTSIDE		
3.		- INSIDE		
4.		WALL SWIPES - UPPER		
5.		- LOWER		
6.		Wall SWIPES - UPPER		
7.		- LOWER		
8.		Wall SWIPES - UPPER		
9.		- LOWER		
10.		Wall SWIPES - UPPER		
11.		- LOWER		
12.		Wall SWIPES - UPPER		
13.		- LOWER		
14.		Wall SWIPES - UPPER		
15.		- LOWER		
16.			Wall CABINET #1 - DOORS - OUTSIDE / INSIDE	
17.			- shelves - TOP / MID / BOTTOM	
18.		0720	- INSIDE - LEFT / RIGHT / REAR / BOTTOM	

Radiological Survey Continuation Sheet

Page 2 of 20

Date 5/28/04

Room Below 118W W204

No.	Time	Locations	See attached LSC printout for Total Activity (cpm/100 cm ²)
19	0800	WALL CABINET #1 - OUTSIDE - Bottom	
20		shelf UNDER CABINET	
21		AREA UNDER shelf	
22		WALL CABINET #2 - DOORS - OUTSIDE / INSIDE	
23		- shelves - UPPER / LOWER	
24		- INSIDE - LEFT / RIGHT / REAR / BOTTOM	
25		- OUTSIDE - Bottom	
26		shelf UNDER CABINET	
27		AREA UNDER shelf	
28		DESKTOP shelves / supports	
29		DESKTOP	
30		DRAW ABOVE ALCOVE - OUT / IN	
31		ALCOVE - LEFT / RIGHT	
32		- REAR / FLOOR	
33		DRAW - RIGHT SIDE - TOP - OUT / IN	
34		- MID ↓ ↓	
35		- BOT - OUT / IN	
36		OVERHEAD CABINET - DOORS - OUT / IN	
37		- shelves - TOP / MID / BOT	
38		- INSIDE - LEFT / RIGHT / REAR / BOTTOM	
39		- OUTSIDE - Bottom	
40		shelf / FLOW valves	
41		BENCHTOP SWIRE	
42		DRAW UNDER BENCHTOP - UPPER - OUT / IN	
43		- LOWER - OUT / IN	
44	↓	CABINET - DOOR - OUT / IN	
45	0830	- shelf	

Radiological Survey Continuation Sheet

Page 3 of 20

Date 5/28/04

Room DECON 118W W204

No.	Time	Locations	See attached LSC printout for Total Activity (cpm/100 cm ²)
46	0880	CABINET - INSIDE - LEFT RIGHT REAR BOTTOM	
47		WOODS FRIDGE - DOOR - OUT IN	
48		- Shelves	
49		- INSIDE - LEFT RIGHT REAR BOTTOM	
50		OVERHEAD CABINET - DOORS - OUT IN	
51		- Shelves - UPPER LOWER	
52		- INSIDE - LEFT RIGHT REAR BOTTOM	
53		- OUTSIDE - BOTTOM	
54		shelf Flow Valves	
55		BENCHTOP SWIPE	
56		DRAW UNDER BENCHTOP - LEFT - UPPER - OUT IN	
57		- LOWER - OUT IN	
58		- Right - UPPER - OUT IN	
59		- LOWER - OUT IN	
60		- Lg UPPER - OUT IN	
61		Lower - OUT IN	
62		OVERHEAD CABINET - DOORS - OUTSIDE INSIDE	
63		- SHELVES	
64		- INSIDE - LEFT RIGHT REAR BOTTOM	
65		- OUTSIDE - BOTTOM LEFT	
66		shelf Flow Valves	
67		BENCHTOP SWIPE	
68		DRAW UNDER BENCHTOP - LEFT - UPPER - OUT IN	
69		- LOWER - OUT IN	
70		- Right - UPPER - OUT IN	
71		- LOWER - OUT IN	
72	0900	- Lg - UPPER - OUT IN	

Radiological Survey Continuation Sheet

Page 4 of 20

Date 5/28/04

Room Decon 118W W204

No.	Time	Locations	See attached LSC printout for Total Activity (cpm/100 cm ²)
73	0900	Draws under benchtop - Large - Lower - OUT/IN	
74		OUTSIDE DRAW UNIT - LEFT	
75		OUTSIDE DRAW UNIT - Right	
76		OVERHEAD CABINET - DOORS - OUT/IN	
77		- Shelves - UPPER/LOWER	
78		- INSIDE - LEFT RIGHT REAR BOT	
79		- OUTSIDE - Bottom Right	
80		Shelf / Flow Valves	
81		BENCHTOP SWIPES	
82		DRAWS UNDER BENCHTOP - LEFT - UPPER - OUT/IN	
83		- Lower -	↓
84		- Right - UPPER -	↓
85		- Lower -	↓
86		- Lg - UPPER -	↓
87		- Lower - OUT/IN	↓
88		OVERHEAD CABINET - DOORS - OUT/IN	
89		- Shelves - UPPER/LOWER	
90		- INSIDE - LEFT RIGHT REAR Bottom	
91		- OUTSIDE - Bottom	
92		Shelf / Flow Valves	
93		BENCHTOP SWIPE	
94		DRAWS UNDER BENCH - LEFT - UPPER - OUT/IN	
95		- Lower -	↓
96		- Right - UPPER -	↓
97		- Lower -	↓
98	↓	- Lg - UPPER -	↓
99	0930	- Lower - OUT/IN	↓

Radiological Survey Continuation Sheet

Page 5 of 20

Date 5/28/04

Room Decow 118 W W204

No.	Time	Locations	See attached LSC printout for Total Activity (cpm/100 cm ²)
100	0930	OVERHEAD CABINET - DOORS - OUT/IN	
101		- shelves - upper / lower	
102		- INSIDE LEFT RIGHT REAR BOTTOM	
103		- OUTSIDE - LEFT BOTTOM	
104		shelf / Flow Valves	
105		BENCHTOP SWIPE	
106		Marvel Fridge - DOOR - OUT/IN	
107		- shelves	
108		- INSIDE - LEFT RIGHT REAR BOTTOM	
109		DRAWNS UNDER BENCHTOP - UPPER - OUT/IN	
110		- LOWER - OUT/IN	
111		CABINET - DOOR - OUT/IN	
112		- shelf	
113		- INSIDE - LEFT RIGHT REAR BOTTOM	
114		DESKTOP SHELVES / SUPPORTS	
115		DESKTOP SWIPE	
116		DESK DRAW ABOVE ALCOVE - OUT/IN	
117		ALCOVE - LEFT RIGHT	
118		- REAR FLOOR	
119		DESK DRAWS - LEFT - TOP - OUT/IN	
120		- MID ↓ ↓	
121		- Bot - OUT/IN	
122		Wall CABINET #3 - DOORS - OUT/IN	
123		- shelves - upper / lower	
124		- INSIDE - LEFT RIGHT REAR BOTTOM	
125		- OUTSIDE - Bottom	
126	1000	shelf UNDER CABINET	

Radiological Survey Continuation Sheet

Page 6 of 20

Date 5/28/04

Room Decon 118W W204

No.	Time	Locations	See attached LSC printout for Total Activity (cpm/100 cm ²)
127	1030	AREA UNDER shelf	
128		Wall CABINET #4 - DOORS - OUT / IN	
129		- INSIDE - LEFT / RIGHT / REAR / BOTTOM	
130		- Shelves - Top / mid / Bottom	
131		- OUTSIDE - Bottom	
132		Shelf UNDER CABINET	
133		AREA UNDER shelf	
134		Wall CABINET #5 - DOOR - OUT / IN	
135		- Shelves - TOP / MID / BOT	
136		- INSIDE - LEFT / RIGHT / REAR / Bottom	
137		- OUTSIDE - Bottom	
138		Shelf UNDER CABINET	
139		AREA UNDER shelf	
140		DESKTOP shelves / supports	
141		DESKTOP SWIPE	
142		DRAW above ALCOVE - OUT / INSIDE	
143		ALCOVE - LEFT / RIGHT	
144		- REAR / FLOOR	
145		DRAW - Right Top - OUT / IN	
146		MID - ↓ ↓	
147		BOT - OUT / IN	
148		OVERHEAD CABINET - DOORS - OUT / INSIDE	
149		- Shelves - UPPER / LOWER	
150		- INSIDE - LEFT / RIGHT / REAR / Bottom	
151		- OUTSIDE - Bottom	
152	✓	shelf / supports / Flow valves	
153	1100	BENCHTOP SWIPE	

Radiological Survey Continuation Sheet

Page 7 of 20

Date 5/28/04

Room Decon 118W W204

No.	Time	Locations	See attached LSC printout for Total Activity (cpm/100 cm ²)
154	1300	ALCOVE UNDER BENCH - LEFT RIGHT	
155		- REAR FLOOR	
156		DRAWNS - UPPER - OUT IN	
157		- LOWER - OUT IN	
158		CABINET - DOOR - OUT IN	
159		- SHELF	
160		- INSIDE - LEFT RIGHT REAR BOTTOM	
161		OVERHEAD CABINET - DOORS - OUT IN	
162		- SHELVES	
163		- INSIDE LEFT RIGHT REAR BOTTOM	
164		- OUTSIDE - BOTTOM	
165		Shelf / Flow Valves	
166		BENCHTOP SWIPE	
167		DRAWNS UNDER BENCH - LEFT - UPPER - OUT IN	
168		- LOWER -	
169		- Right - UPPER -	
170		- LOWER -	
171		- Large - UPPER -	
172		- LOWER - OUT IN	
173		OVERHEAD CABINET - DOORS - OUT IN	
174		- Shelves - UPPER / LOWER	
175		- INSIDE - LEFT RIGHT REAR BOTTOM	
176		- OUTSIDE - BOTTOM LEFT	
177		Shelf / Flow Valves	
178		BENCHTOP SWIPE	
179	V	CABINET - DOORS - OUTSIDE	
180	1330	- INSIDE	

Radiological Survey Continuation Sheet

Page 8 of 20

Date 5/28/04

Room DECON 118W W204

No.	Time	Locations	See attached LSC printout for Total Activity (cpm/100 cm ²)
181	1330	CABINET - INSIDE - LEFT Right REAR BOTTOM	
182		- shelf	
183		- OUTSIDE - LEFT	
184		OVERHEAD CABINET - DOORS - OUTSIDE INSIDE	
185		- Shelves - UPPER LOWER	
186		- INSIDE - LEFT RIGHT REAR BOT	
187		- OUTSIDE - BOTTOM RIGHT	
188		Shelf Flow Valves	
189		BENCHTOP SWIPE	
190		CABINET - DOORS - OUTSIDE	
191		- INSIDE	
192		- shelf	
193		- INSIDE - LEFT RIGHT REAR BOT	
194		OVERHEAD CABINET - DOORS - OUT IN	
195		- Shelves - UPPER LOWER	
196		- INSIDE - LEFT RIGHT REAR BOTTOM	
197		- OUTSIDE - BOTTOM	
198		Shelf Flow Valves	
199		BENCHTOP SWIPE	
200		DRAWERS UNDER BENCH - LEFT - UPPER - OUT IN	
201	- LOWER - OUT IN		
202	- Right - UPPER -	↓ ↓	
203	- LOWER -	↓ ↓	
204	- Lg - UPPER -	↓ ↓	
205	- LOWER - OUT IN		
206	↓		
207	1400	Marvel fridge - Door - OUTSIDE INSIDE	

Radiological Survey Continuation Sheet

Page 9 of 20

Date 5/28/04

Room DECON 118W W204

No.	Time	Locations	See attached LSC printout for Total Activity (cpm/100 cm ²)
208	1430	MARKET FRIDGE - shelves	
209		- INSIDE - LEFT RIGHT REAR BOTTOM	
210		OVERHEAD CABINET - DOORS - OUT IN	
211		- Shelves - UPPER LOWER	
212		- INSIDE - LEFT RIGHT REAR BOTTOM	
213		- OUTSIDE - BOTTOM LEFT	
214		shelf Flow Valves	
215		BENCHTOP SWIPE	
216		DRAWS UNDER BENCH - UPPER - OUT IN	
217		- LOWER - OUT IN	
218		CABINET - DOORS - OUT IN	
219		- shelf	
220		- INSIDE - LEFT RIGHT REAR BOTTOM	
221		DESKTOP shelves SUPPORTS	
222		DESKTOP SWIPE	
223		DRAW ABOVE ALCOVE - OUT IN	
224		ALCOVE - LEFT RIGHT	
225		- REAR FLOOR	
226		DRAWS - LEFT SIDE - TOP - OUT IN	
227		- MID ↓ ↓	
228		- BOTTOM - OUT IN	
229		Wall CABINET - DOORS - OUT INSIDE	
230		- shelves - TOP MID BOTTOM	
231		- INSIDE - LEFT RIGHT REAR BOTTOM	
232		- OUTSIDE - BOTTOM LEFT	
233	↓	shelf UNDER CABINET	
234	1500	AREA UNDER shelf	

Radiological Survey Continuation Sheet

Page 10 of 20Date 5/28/04

Room DECON 118W W204

No.	Time	Locations	See attached LSC printout for Total Activity (cpm/100 cm ²)
235	↓ 1500	FILE CABINET	- OUTSIDE - TOP LEFT Right
236			- DRAWS TOP - OUT / IN
237			- UPPER MID - ↓ ↓
238			- MID -
239			- LOWER MID - ↓ ↓
240			- BOTTOM - OUT / IN
241			DESKTOP SWIPE
242			OVERHEAD SHEETS - Right
243			- LEFT
244			DESK DRAWS - LEFT - OUT / IN
245			- Right - OUT / IN
246			WINDOW - LEFT
247			- Right
248		FILE CABINET - LEFT - OUT / IN	
249		- Right - OUT / IN	
250		GLASS OFFICE WALL	
251		GLASS DOOR - OUT / IN	
252		DESK TOP	
253		OVERHEAD CABINET - LEFT - OUT / IN	
254		- Right - OUT / IN	
255		DESK DRAWS - LEFT - OUT / IN	
256		- Right - OUT / IN	
257		DESKTOP SWIPE	
258		DRAWS	
259		OVERHEAD CABINET - LEFT - OUT / IN	
260		- Right - OUT / IN	
261	↓ 1530	WINDOW SWIPE	

Radiological Survey Continuation Sheet

Page 11 of 20

Date 5/24/04

Room Decon N8W W204

No.	Time	Locations	See attached LSC printout for Total Activity (cpm/100 cm ²)
262	1530	WALL SWIPE	- UPPER
263			- LOWER
264			- UPPER
265			- LOWER
266		LAB DOOR	- OUT / IN
267		BENCH SWIPE	/ FLOW VALVES
268		FAUCET	/ eye wash
269		Basin	- FRONT / REAR
270			- LEFT / Right / Bottom
271		DRAWERS	- Top - OUT / IN
272			- UPPER MID - ↓ ↓
273			- LOWER MID - ↓ ↓
274			- Bottom - OUT / IN
275		CABINET	- DOORS - OUT / IN
276			- INSIDE - LEFT / Right
277			- REAR Bottom
278		HOOD	- OUTSIDE - TOP
279			- Right
280			- SASH / GLASS
281			- INSIDE - LEFT
282			- Right
283			- REAR / UPPER
284			/ LOWER
285		WORK AREA	- LEFT
286			- Right
287		CABINET	- LEFT - DOORS - OUT / IN
288	1600		- INSIDE - LEFT / Right / REAR / Bottom

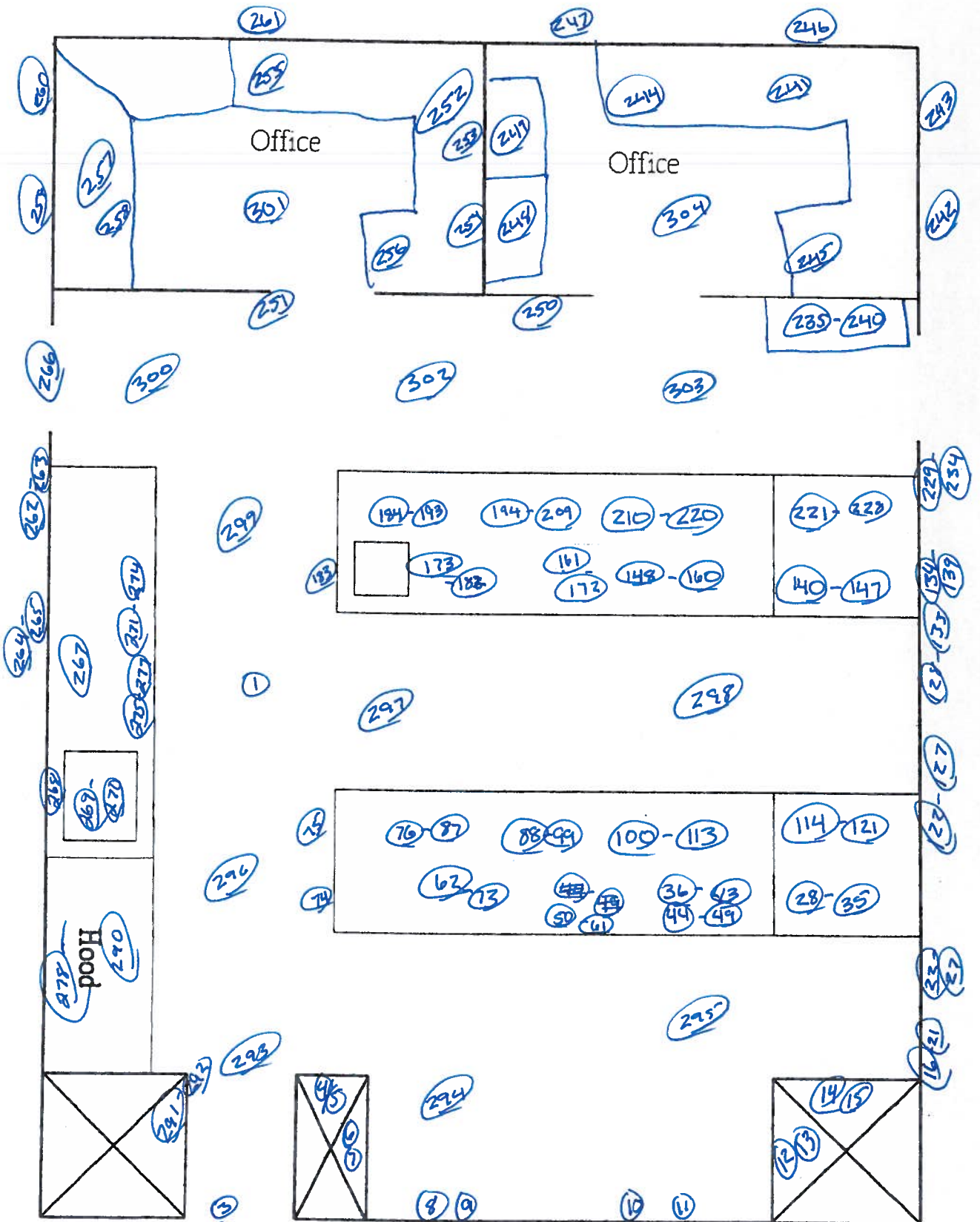

O = wipe location

ALL SURFACES SURVEYED BY CUDRUM 2241-2 AND FOUND TO BE WITHIN LIMITS 6/4/04

Protocol# 9 - Room Decon.lsa

Room Decon 118W W204

User: Pete Keefe

Assay Definition-

Assay Description:

Assay Type: CPM

Report Name: Report1

Output Data Path: C:\Packard\Tricarb\Results\Pete Keefe\Room Decon

Raw Results Path: C:\Packard\Tricarb\Results\Pete Keefe\Room Decon\20040524_1527.results

Assay File Name: C:\Packard\TriCarb\Assays\Room Decon.lsa

Count Conditions-

Nuclide: Triple

Quench Indicator: tSIE/AEC

External Std Terminator (sec): 0.5 2s%

Pre-Count Delay (min): 0.00

Quench Set: n/a

Count Time (min): 1.00

Count Mode: Normal

Assay Count Cycles: 1

Repeat Sample Count: 1

#Vials/Sample: 1

Calculate % Reference: Off

Background Subtract: Off

Low CPM Threshold: Off

2 Sigma % Terminator: Off

Regions	LL	UL
A	0.0	18.6
B	18.6	156.0
C	0.0	2000.0

Count Corrections-

Static Controller: On

Luminescence Correction: On

Colored Samples: n/a

Heterogeneity Monitor: n/a

Coincidence Time (nsec): 18

Delay Before Burst (nsec): 75

Half Life-

Half Life Correction: Off

Regions	Half Life	Units	Reference Date	Reference Time
A				
B				
C				

Cycle 1 Results

S#	CPMA	CPMB	CPMC	MESSAGES	LUM
1	11	7	23		11
2	10	4	16		14
3	16	11	34		7
4	10	9	23		14
5	16	5	30		10
6	12	6	25		15
7	14	6	27		10
8	17	7	28		8
9	20	4	31		8
10	10	4	19		14
11	7	7	20		14
12	12	8	28		14
13	17	5	25		9

Protocol# 9 - Room Decon.lsa

User: Pete Keefe

Room Decon 118W W204

14	15	5	32	10
15	5	6	21	18
16	8	5	25	15
17	5	2	18	33
18	11	5	23	17
19	14	8	28	9
20	10	7	26	12
21	13	5	24	11
22	16	7	35	9
23	15	5	28	14
24	8	7	23	18
25	14	4	27	6
26	9	10	22	11
27	10	5	25	18
28	8	8	22	13
29	17	4	36	10
30	19	9	33	7
31	10	12	27	13
32	12	11	25	12
33	12	11	25	12
34	16	6	30	13
35	13	10	31	16
36	19	3	32	13
37	17	13	39	9
38	16	5	26	10
39	17	5	30	9
40	8	5	21	15
41	10	8	26	15
42	9	7	24	6
43	16	7	33	12
44	9	8	26	16
45	12	12	31	15
46	19	4	28	9
47	17	7	30	12
48	19	10	34	10
49	15	8	32	9
50	14	8	33	13
51	17	6	29	16
52	8	8	27	17
53	13	5	26	15
54	21	7	34	10
55	11	8	28	11
56	12	9	26	10
57	16	4	25	18
58	11	4	23	13
59	17	4	29	13
60	18	5	33	16
61	14	8	35	20
62	15	11	34	17
63	10	6	19	17
64	13	11	30	15
65	17	9	31	17
66	9	6	18	24
67	17	7	32	15
68	8	12	24	18
69	7	5	23	33
70	18	10	36	13
71	15	5	26	22
72	11	5	25	22
73	11	6	24	12
74	17	11	33	10
75	15	8	35	16
76	15	10	31	11

Protocol# 9 - Room Decon.lsa

Room Decon 118W W204

User: Pete Keefe

77	9	5	27	7
78	11	8	22	11
79	8	10	24	15
80	16	6	36	20
81	12	8	30	22
82	17	6	33	16
83	13	10	31	19
84	7	9	30	22
85	10	10	27	22
86	16	12	33	16
87	17	5	27	13
88	12	6	24	20
89	18	8	34	11
90	10	9	25	19
91	8	9	23	16
92	9	7	27	26
93	4	4	15	30
94	16	3	26	19
95	11	7	24	15
96	11	9	24	18
97	9	4	21	27
98	6	2	16	45
99	15	7	28	9
100	9	7	19	17
101	8	6	21	29
102	7	4	14	23
103	7	3	16	33
104	14	3	27	25
105	10	7	20	12
106	11	8	26	19
107	17	5	29	17
108	11	4	20	24
109	9	3	16	38
110	10	10	30	25
111	8	10	28	20
112	13	9	26	17
113	12	3	21	24
114	8	13	32	17
115	14	5	27	14
116	6	6	16	29
117	21	3	28	19
118	11	6	18	21
119	7	10	23	25
120	15	8	29	16
121	8	6	18	19
122	9	8	24	25
123	7	9	22	22
124	12	6	25	20
125	9	9	28	15
126	10	13	28	12
127	16	6	24	13
128	11	2	20	27
129	13	8	29	21
130	17	8	32	11
131	18	7	33	15
132	10	3	19	20
133	8	6	18	25
134	14	11	30	11
135	20	7	35	17
136	21	11	44	12
137	8	5	22	15
138	12	10	33	17
139	16	5	30	13

Protocol# 9 - Room Decon.lsa

User: Pete Keefe

Room Decon 118W W204

140	11	6	25	21
141	16	10	31	14
142	8	13	29	17
143	18	5	34	19
144	6	7	23	27
145	5	6	19	40
146	15	6	28	13
147	16	4	25	18
148	9	8	24	21
149	15	9	30	19
150	6	2	17	40
151	9	5	25	35
152	9	12	29	13
153	10	5	22	24
154	16	7	30	16
155	21	10	36	12
156	13	6	27	19
157	8	5	18	20
158	23	4	29	14
159	12	9	31	17
160	11	7	26	15
161	15	5	31	18
162	11	8	23	14
163	11	4	20	18
164	15	7	28	17
165	16	8	35	15
166	17	8	36	11
167	26	27	63	5
168	10	7	23	21
169	18	4	26	13
170	17	8	32	15
171	11	6	23	21
172	17	9	30	14
173	19	9	33	13
174	11	9	22	10
175	11	9	25	14
176	8	10	25	15
177	13	6	21	19
178	10	7	27	21
179	11	10	26	13
180	16	9	31	18
181	15	11	36	17
182	8	7	22	28
183	15	8	27	16
184	13	8	27	17
185	9	9	27	15
186	11	5	22	22
187	13	4	28	25
188	11	5	24	22
189	15	10	32	18
190	12	10	30	17
191	14	6	28	18
192	11	4	24	18
193	9	4	19	20
194	13	11	31	12
195	15	9	29	19
196	12	7	25	23
197	14	8	23	17
198	16	6	28	9
199	18	14	39	12
200	13	5	27	20
201	3	8	16	18
202	13	5	22	11

Protocol# 9 - Room Decon.lsa

User: Pete Keefe

Room Decon 118W W204

203	10	6	20	13
204	20	7	33	7
205	10	7	27	16
206	10	10	23	5
207	14	4	27	15
208	10	9	24	11
209	6	10	24	17
210	19	7	32	17
211	12	8	25	18
212	13	5	27	15
213	8	4	19	29
214	11	9	24	14
215	15	16	38	15
216	12	8	24	10
217	19	8	32	7
218	8	3	13	31
219	12	8	25	18
220	13	7	27	25
221	11	6	25	16
222	12	4	21	17
223	9	12	30	17
224	12	7	26	14
225	11	11	30	13
226	8	5	22	15
227	5	8	20	27
228	17	8	31	8
229	14	6	27	18
230	16	5	25	17
231	15	6	27	13
232	17	11	36	13
233	14	1	19	28
234	13	6	24	14
235	15	7	23	17
236	11	6	21	16
237	18	6	31	21
238	10	5	21	24
239	13	8	29	21
240	18	5	27	16
241	20	6	35	17
242	20	6	31	11
243	11	9	31	22
244	11	7	25	15
245	14	6	23	18
246	13	9	27	17
247	15	11	36	14
248	12	3	22	18
249	13	7	23	25
250	6	11	23	25
251	7	6	20	31
252	12	6	24	24
253	18	9	33	14
254	11	11	24	17
255	13	4	25	16
256	10	6	30	17
257	9	10	25	14
258	17	10	32	14
259	14	6	26	22
260	10	5	20	28
261	21	5	31	14
262	10	9	28	26
263	12	8	24	14
264	9	4	22	31
265	17	9	32	17

Protocol# 9 - Room Decon.lsa

Room Decon 118W W204

User: Pete Keefe

266	18	9	36	7
267	5	3	13	45
268	19	5	30	15
269	15	10	30	18
270	1	6	12	55
271	15	6	27	17
272	12	5	19	25
273	6	11	24	30
274	17	8	29	11
275	15	9	30	15
276	10	9	23	19
277	15	9	32	8
278	10	5	23	18
279	11	9	29	14
280	10	4	21	25
281	11	7	27	20
282	8	11	26	19
283	11	6	22	16
284	13	9	29	13
285	13	9	28	13
286	8	9	20	16
287	15	12	35	14
288	8	5	16	20
289	7	9	21	22
290	12	6	21	15
291	17	7	34	12
292	13	5	23	20
293	11	8	22	19
294	8	11	26	19
295	9	7	24	17
296	17	3	27	14
297	12	4	19	17
298	6	9	20	13
299	11	10	31	17
300	8	6	23	19
301	9	10	23	14
302	8	13	26	17
303	9	9	27	20
304	14	7	25	17

Protocol# 9 - Room Decon Swipes.lsa

User: Peter Keefe

Reswipes W204

Assay Definition-

Assay Description:

Assay Type: CPM

Report Name: Report1

Output Data Path: C:\Packard\Tricarb\Results\Peter Keefe\Room Decon Swipes

Raw Results Path: C:\Packard\Tricarb\Results\Peter Keefe\Room Decon

Swipes\20040604_1415.results

Assay File Name: C:\Packard\TriCarb\Assays\Room Decon Swipes.lsa

Count Conditions-

Nuclide: TRIPLE

Quench Indicator: tSIE/AEC

External Std Terminator (sec): 0.5 2s%

Pre-Count Delay (min): 0.00

Quench Set: n/a

Count Time (min): 1.00

Count Mode: Normal

Assay Count Cycles: 1

Repeat Sample Count: 1

#Vials/Sample: 1

Calculate % Reference: Off

Background Subtract: Off

Low CPM Threshold: Off

2 Sigma % Terminator: Off

Regions	LL	UL
A	0.0	18.6
B	18.6	156.0
C	0.0	2000.0

Count Corrections-

Static Controller: On

Luminescence Correction: On

Colored Samples: n/a

Heterogeneity Monitor: n/a

Coincidence Time (nsec): 18

Delay Before Burst (nsec): 75

Half Life-

Half Life Correction: Off

Regions	Half Life	Units	Reference Date	Reference Time
A				
B				
C				

Cycle 1 Results

S#	CPMA	CPMB	CPMC	MESSAGES
1	21	8	37	BACKGROUND
2	19	11	40	#167