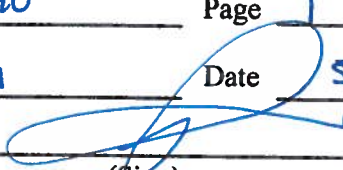

Radiological Survey Sheet

Job Location Pfizer Horton CT 06340 Page 1 of 15
 Survey Purpose Room Decon 118W W201 Date 5/27/04
 Performed by P. KEEFE (Print)  (Sign)

Instrument (Model/S/N)	Packard Tri-Carb S/N 431521	Packard Tri-Carb S/N 431520	Ludlum 2241-2 163603
Det. (Model/S/N)	Internal	Internal	Ludlum 43-68 PR 149613
Type Rad.	β	β	β
Cal. Due:	10/24/04	10/24/04	6/25/04
Check Instruments Used	X		X

No.	Time	Locations	See attached LSC printout for Total Activity (cpm/100 cm ²)	
1.	0700	BACKGROUND		
2.	↓	LAB ENTRANCE DOOR - OUTSIDE		
3.		- INSIDE		
4.		Wall SWIPES - UPPER		
5.		- LOWER		
6.		Wall SWIPES - UPPER		
7.		- LOWER		
8.		Wall SWIPES - UPPER		
9.		- LOWER		
10.		Wall SWIPES - LEFT		
11.		- RIGHT		
12.		Wall SWIPES - UPPER		
13.		- LOWER		
14.		Wall SWIPES - UPPER		
15.		- LOWER		
16.		Wall CABINET #1 - Shelves		
17.		↓	- INSIDE - LEFT RIGHT REAR BOTTOM	
18.		0720	- OUTSIDE - BOTTOM	

Radiological Survey Continuation Sheet

Page 2 of 15

Date 5/27/04

Room Decom USW W201

No.	Time	Locations	See attached LSC printout for Total Activity (cpm/100 cm ²)
19	0720	Shelf UNDER CABINET	
20		AREA UNDER shelf	
21		OUT WARM CABINET #2 - shelves	
22			- INSIDE - LEFT RIGHT REAR BOTTOM
23			- OUTSIDE - BOTTOM
24		shelf UNDER CABINET	
25		DESK Shelves SUPPORTS	
26		DESKTOP	
27		DESK DRAWS - TOP - OUT/IN	
28			- MID - ↓ ↓
29			- BOTTOM - OUT/IN
30		ALCOVE UNDER DESK - LEFT RIGHT	
31			- REAR FLOOR
32		BENCHTOP SWIPE FLOW VALVE	
33		DRAWS - RIGHT - UPPER - OUT/IN	
34			- LOWER - OUT/IN
35		CABINET - DOOR - OUT/IN	
36			- shelf
37			- INSIDE - LEFT RIGHT REAR BOTTOM
38		DRAW ABOVE ALCOVE - OUT/IN	
39		ALCOVE - LEFT RIGHT	
40			- REAR FLOOR
41		BENCHTOP SWIPE	
42		DRAWS #1 TOP - OUT/IN	
43			UPPER MID - ↓ ↓
44			LOWER MID - ↓ ↓
45	0750		BOTTOM - OUT/IN

Radiological Survey Continuation Sheet

Page 3 of 15

Date 5/27/04

Room Decon 118W W201

No.	Time	Locations	See attached LSC printout for Total Activity (cpm/100 cm ²)
46	0750	Alcove UNDER BENCH - LEFT / Right	
47		- FLOOR	
48		BENCHTOP SWIPE	
49		DRAWS - TOP - OUT / IN	
50		- UPPER MID - ↓ ↓	
51		- LOWER MID - ↓ ↓	
52		- BOTTOM - OUT / IN	
53		OUTSIDE DRAW UNIT - LEFT	
54		OUTSIDE DRAW UNIT - Right	
55		BENCHTOP SWIPE	
56		DRAWS - TOP - OUT / IN	
57		- UPPER MID ↓ ↓	
58		- LOWER MID ↓ ↓	
59		- BOTTOM - OUT / IN	
60		BENCHTOP SWIPE -	
61		ALCOVE - LEFT / Right	
62		DRAWS - TOP - OUT / IN	
63		- UPPER MID - ↓ ↓	
64		- LOWER MID - ↓ ↓	
65		- BOTTOM - OUT / IN	
66		BENCHTOP SWIPE / Flow Valve	
67		DRAW ABOVE ALCOVE - OUT / IN	
68	ALCOVE - LEFT / Right		
69	- WRM / FLOOR		
70	DRAWS - LEFT - UPPER - OUT / IN		
71	- LOWER - OUT / IN		
72	0815	CABINET DOORS - OUT / IN	

Radiological Survey Continuation Sheet

Page 4 of 15

Date 5/27/04

Room Below NSW W201

No.	Time	Locations	See attached LSC printout for Total Activity (cpm/100 cm ²)
73	0815	CABINET - INSIDE - LEFT / RIGHT / REAR / BOTTOM	
74		DESK shelves / supports	
75		DESKTOP	
76		Keyboard HOLDER	
77		DRAWERS - TOP - OUT / IN	
78		- MID - OUT / IN	
79		- BOTTOM - OUT / IN	
80		Wall CABINET #3 - glass Doors - OUT / IN	
81		- Shelves	
82		- INSIDE - LEFT / RIGHT / REAR / BOT	
83		- OUTSIDE - Bottom	
84		Shelf UNDER CABINET	
85		Wall CABINET #4 - Doors - OUT / IN	
86		Shelves	
87		INSIDE - LEFT / RIGHT / REAR / Bottom	
88		OUTSIDE - LEFT / Bottom	
89		Shelf UNDER CABINET	
90		AREA under shelf	
91		Wall SWIPES - UPPER 1/2	
92		- Lower	
93		Wall CABINET #5 - Doors - OUT / IN	
94		- Shelves	
95		- INSIDE - LEFT / RIGHT / REAR / Bottom	
96		- OUTSIDE - LEFT / RIGHT / Bottom	
97		Bench TOP SWIPE	
98	↓	Draw above ALCOVE	
99	0835	ALCOVE - LEFT / RIGHT	

Radiological Survey Continuation Sheet

Page 5 of 15

Date 5/27/04

Room Decon 118W W201

No.	Time	Locations	See attached LSC printout for Total Activity (cpm/100 cm ²)
100	0835	ALCOVE - REAR FLOOR	
101		DRAWNS - LEFT - TOP	
102		- UPPER MID	
103		- LOWER MID	
104		- BOTTOM	
105		WALL SWIPE - UPPER	
106		- WINDOW	
107		BEWCHTOP SWIPE	
108		ALCOVE - LEFT RIGHT	
109		- REAR FLOOR	
110		WALL CABINET #6 - DOORS	
111		- Shelves	
112		- INSIDE - LEFT RIGHT REAR BOTTOM	
113		- OUTSIDE - LEFT BOT RIGHT	
114		FLOW VALVES FAUCET	
115		BEWCHTOP SWIPE	
116		DRAWNS - TOP (4) - OUT IN	
117		- UPPER MID (2) - OUT IN	
118		- LOWER MID - OUT IN	
119		- BOTTOM - OUT IN	
120		DESK Shelves SUPPORTS	
121		DESK TOP	
122		Keyboard Holder	
123		ALCOVE - LEFT RIGHT	
124		- REAR FLOOR	
125	↓	OUTSIDE - LEFT	
126	0855	DRAWNS - TOP - OUT IN	

Radiological Survey Continuation Sheet

Page 6 of 15

Date 5/27/04

Room Decon

No.	Time	Locations	See attached LSC printout for Total Activity (cpm/100 cm ²)
127	0900	DRAWN - MID - OUT/IN	
128		- BOT - OUT/IN	
129		FILE CABINET - OUTSIDE	
130		- INSIDE	
131		DESK Shelves / supports	
132		DESKTOP SWIPE	
133		DRAW ABOVE ALCOVE - OUT/IN	
134		ALCOVE - LEFT / RIGHT	
135		- REAR / FLOOR	
136		DRAWN - TOP - OUT/IN	
137		- MID - OUT/IN	
138		- Bottom - OUT/IN	
139		Wall SWIPES - UPPER	
140		- LOWER	
141		DOOR - OUT/IN	
142	GLASS PANE		
143	Faucet / eyewash station		
144	COUNTER / BASIN		
145	CABINET - DOORS - OUT/IN		
146	- INSIDE - LEFT / RIGHT / REAR / FLOOR		
147	WINDOW		
148	BENCHTOP SWIPE		
149	Wall SWIPES - UPPER		
150	- LOWER		
151	BENCHTOP SWIPE		
152	↓	DRAWN - TOP	
153	0920	- UPPER MID	

Radiological Survey Continuation Sheet

Page 7 of 15

Date 5/27/04

Room Decow 118W W201

No.	Time	Locations	See attached LSC printout for Total Activity (cpm/100 cm ²)
154	0920	DRAWNS - LOWER MID - OUT / IN	
155		- BOTTOM - OUT / IN	
156		Wall shelves	
157		Wall SWIPES - LEFT	
158		- Right	
159		TABLETOP	
160		TABLETOP	
161		HEATER / WINDOW - LEFT	
162		- Right	
163		Wall SWIPES - UPPER	
164		- LOWER	
165		GLASS DOORS	
166		Wall shelves - LEFT	
167		FILE CABINET - LEFT	
168		Wall shelves - LEFT Right	
169		FILE CABINET - Right	
170		WINDOW / HEATER - Right	
171		- LEFT	
172	DESKTOP		
173	DRAWNS - Right SIDE		
174	- LEFT SIDE		
175	Wall shelves - LEFT		
176	Wall shelves - Right		
177	Wall SWIPES - UPPER		
178	- LOWER		
179	↓	glass wall - OUT	
180	0945	- IN	

Radiological Survey Continuation Sheet

Page 8 of 15

Date 5/27/04

Room Decon

No.	Time	Locations	See attached LSC printout for Total Activity (cpm/100 cm ²)
181	0945	LAB DOOR - OUT/IN	
182		WALL SWIPE - UPPER	
183		- LOWER	
184		Water Filtration System	
185		Faucets / Eyewash station / Flow Valves	
186		Benchtop	
187		Draws - Top - OUT/IN	
188		- UPPER MID - OUT/IN	
189		- LOWER MID - OUT/IN	
190		- Bottom - OUT/IN	
191		OUTSIDE DRAW UNIT - Right	
192		Basin - LEFT / Right / REAR / BOTTOM	
193		CABINET - DOORS - OUT/IN	
194		- INSIDE - LEFT / Right / REAR / Bottom	
195		DRAW ABOVE ALCOVE - OUT/IN	
196		ALCOVE - LEFT / Right	
197		- REAR / FLOOR	
198		Draws - LEFT SIDE - TOP	
199		- UPPER MID	
200		- LOWER MID	
201		- Bottom	
202	Wall shelves		
203	Hood - OUTSIDE - FRONT		
204	- Right		
205	- glass DOOR - OUT		
206	- IN		
207	1010	- SASH GUARD	

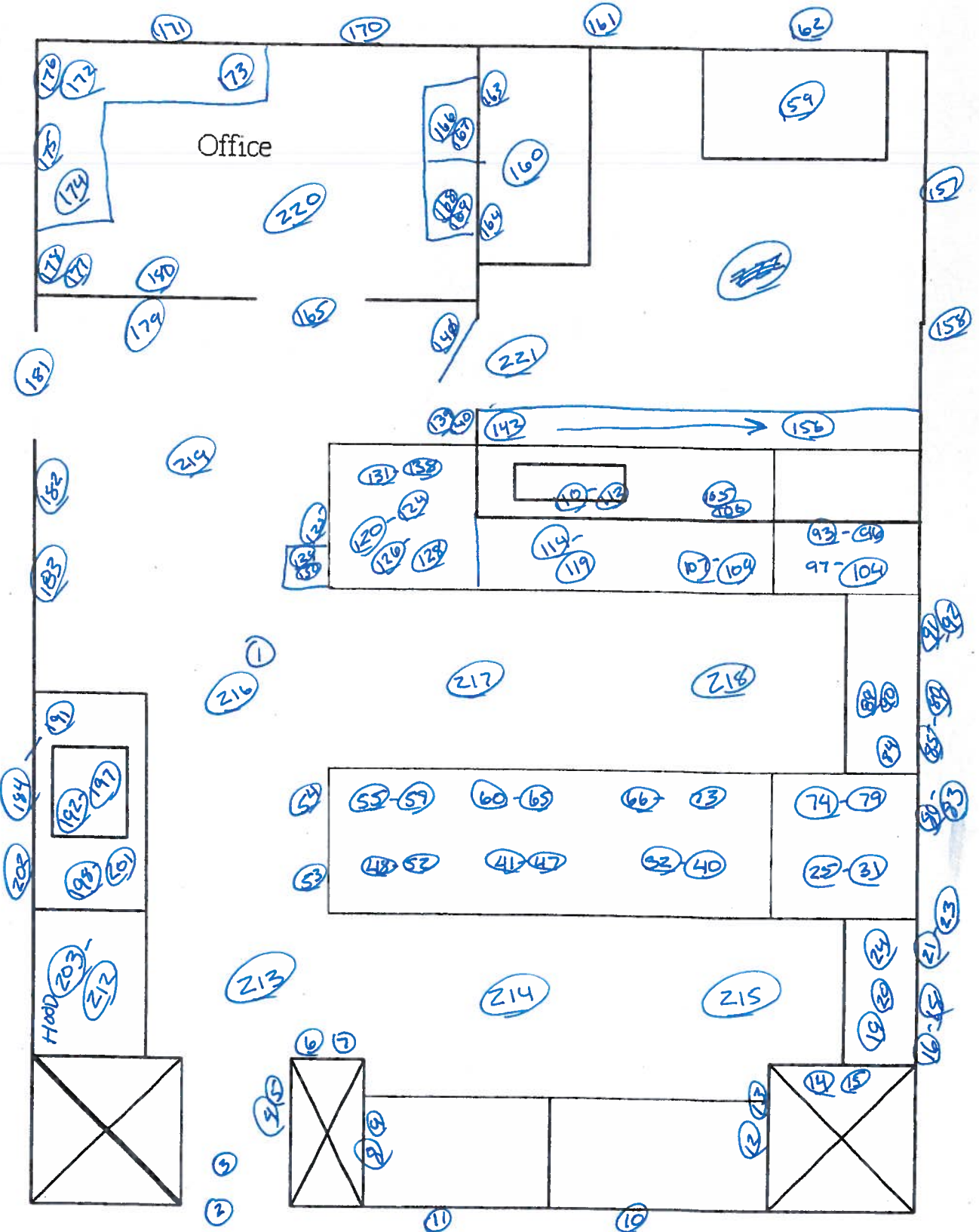

O-wide Locations

All surfaces surveyed with Ludlum 2241-2
AND found to be within limits 6/4/04

Protocol# 9 - Room Decon.lsa

User: Pete Keefe

Room Decon 118W W201

Assay Definition-

Assay Description:

Assay Type: CPM

Report Name: Report1

Output Data Path: C:\Packard\Tricarb\Results\Pete Keefe\Room Decon

Raw Results Path: C:\Packard\Tricarb\Results\Pete Keefe\Room Decon\20040527_1634.results

Assay File Name: C:\Packard\TriCarb\Assays\Room Decon.lsa

Count Conditions-

Nuclide: Triple

Quench Indicator: tSIE/AEC

External Std Terminator (sec): 0.5 2s%

Pre-Count Delay (min): 0.00

Quench Set: n/a

Count Time (min): 1.00

Count Mode: Normal

Assay Count Cycles: 1

Repeat Sample Count: 1

#Vials/Sample: 1

Calculate % Reference: Off

Background Subtract: Off

Low CPM Threshold: Off

2 Sigma % Terminator: Off

Regions	LL	UL
A	0.0	18.6
B	18.6	156.0
C	0.0	2000.0

Count Corrections-

Static Controller: On

Luminescence Correction: On

Colored Samples: n/a

Heterogeneity Monitor: n/a

Coincidence Time (nsec): 18

Delay Before Burst (nsec): 75

Half Life-

Half Life Correction: Off

Regions	Half Life	Units	Reference Date	Reference Time
A				
B				
C				

Cycle 1 Results

S#	CPMA	CPMB	CPMC	MESSAGES	LUM
1	17	4	27		17
2	17	5	28		17
3	14	8	31		17
4	11	9	26		14
5	10	10	27		10
6	13	8	29		10
7	10	3	18		27
8	9	3	18		29
9	23	3	35		17
10	10	8	24		6
11	18	6	27		8
12	19	3	29		9
13	13	3	21		17

Protocol# 9 - Room Decon.lsa

Room Decon 118W W201

User: Pete Keefe

14	17	1	23	15
15	9	8	23	16
16	17	2	23	19
17	11	11	26	9
18	12	4	22	17
19	16	8	26	8
20	25	10	41	6
21	17	5	30	13
22	14	12	32	11
23	7	3	14	25
24	17	10	34	7
25	7	11	28	20
26	22	8	36	9
27	16	6	28	9
28	12	2	20	25
29	12	8	27	14
30	5	6	16	23
31	11	4	20	18
32	15	4	25	14
33	10	5	27	18
34	12	7	27	11
35	16	9	34	8
36	11	5	24	13
37	21	8	31	7
38	17	3	25	22
39	13	5	23	11
40	6	10	21	17
41	24	5	37	18
42	13	7	27	22
43	21	7	33	16
44	14	10	29	19
45	14	3	28	21
46	18	13	36	12
47	16	3	23	19
48	18	6	33	19
49	15	7	27	17
50	16	8	33	19
51	16	16	39	12
52	13	9	27	13
53	11	8	26	19
54	12	7	24	14
55	18	6	30	12
56	12	2	24	19
57	14	7	26	17
58	13	9	29	17
59	13	4	23	16
60	11	7	24	15
61	19	5	27	23
62	4	5	15	42
63	18	5	29	22
64	19	6	27	15
65	13	7	29	31
66	20	5	26	18
67	14	14	32	19
68	13	6	22	26
69	13	5	29	20
70	6	6	18	38
71	25	2	35	14
72	12	6	30	24
73	14	7	24	17
74	13	7	30	18
75	12	5	24	21
76	9	8	22	25

Room Decon 118W W201

77	16	6	29	30
78	10	5	21	24
79	14	13	34	10
80	14	3	21	29
81	15	10	29	11
82	17	9	35	14
83	16	10	33	11
84	11	6	22	16
85	17	4	25	17
86	15	12	32	14
87	10	7	25	25
88	13	8	29	13
89	16	5	28	17
90	11	6	22	16
91	12	7	26	23
92	25	5	35	13
93	17	5	27	17
94	13	7	23	22
95	15	3	22	24
96	8	2	14	25
97	13	8	34	17
98	17	6	28	16
99	8	9	30	29
100	14	7	29	17
101	11	5	21	13
102	21	5	33	11
103	18	9	36	14
104	10	5	32	18
105	15	15	41	9
106	18	8	34	17
107	11	8	27	19
108	19	7	35	8
109	17	8	30	8
110	15	10	30	11
111	7	6	19	20
112	12	6	25	11
113	13	4	28	21
114	11	7	31	15
115	11	5	21	17
116	10	10	24	18
117	13	6	25	19
118	16	5	26	17
119	13	6	27	14
120	8	8	24	22
121	12	1	19	20
122	14	2	24	17
123	19	11	37	13
124	9	5	21	19
125	14	12	33	8
126	20	2	25	13
127	8	11	24	19
128	13	9	31	23
129	12	2	17	29
130	14	10	36	15
131	17	8	36	11
132	13	2	24	32
133	12	2	18	33
134	12	7	26	32
135	11	8	27	14
136	11	10	23	21
137	8	5	20	20
138	18	5	33	19
139	14	7	32	13

Protocol# 9 - Room Decon.lsa

Room Decon 118W W201

User: Pete Keefe

140	20	9	38	13
141	24	8	37	14
142	15	2	25	21
143	8	7	18	18
144	11	7	25	27
145	7	3	19	33
146	13	7	29	22
147	18	6	31	19
148	9	4	18	35
149	13	6	25	26
150	12	3	19	24
151	14	7	24	17
152	9	9	28	20
153	11	10	29	24
154	6	15	28	17
155	17	18	40	11
156	17	6	29	16
157	11	3	19	25
158	19	7	36	17
159	20	6	34	11
160	11	5	20	22
161	10	10	22	22
162	19	9	32	10
163	14	6	28	14
164	12	4	22	22
165	18	10	37	10
166	15	8	30	28
167	15	9	35	12
168	14	7	27	10
169	13	4	25	21
170	9	8	25	21
171	16	9	31	18
172	11	7	28	15
173	16	6	27	20
174	11	2	17	27
175	15	8	27	16
176	10	9	27	14
177	11	7	24	15
178	10	10	31	18
179	8	6	18	25
180	3	4	13	50
181	13	9	31	17
182	20	6	34	14
183	10	7	29	25
184	20	10	38	13
185	20	7	34	14
186	14	9	27	16
187	12	4	24	30
188	12	9	23	17
189	13	10	27	16
190	21	6	30	10
191	14	4	18	15
192	13	6	30	14
193	6	7	24	27
194	17	8	30	15
195	8	11	24	45
196	20	4	31	15
197	14	4	21	20
198	11	6	28	25
199	13	5	21	20
200	11	7	23	20
201	10	6	24	22
202	6	12	24	24

Protocol# 9 - Room Decon.lsa

Room Decon 118W W201

User: Pete Keefe

203	18	8	34	17
204	14	6	26	10
205	16	8	28	15
206	12	8	25	18
207	8	7	18	24
208	22	9	40	12
209	10	9	31	28
210	10	11	27	46
211	7	7	20	19
212	13	11	28	15
213	18	4	27	23
214	14	8	27	17
215	6	5	16	36
216	19	12	37	15
217	11	12	33	16
218	14	11	32	15
219	10	9	25	19
220	16	8	30	12
221	17	11	40	13