

Radiological Survey Sheet

Job Location Pfizer, Inc. Groton, Ct. 06340 118 w/W 126 Page 1 16

Survey Purpose ^{ED} Radiologic Survey of Equipment LAB DECOM. Date 10-2-12

Performed by E. GAILOR E. Gailor
(Print) (Sign)

Instrument (Model/S/N)	Packard Tri-Carb S/N 431521	Packard Tri-Carb S/N 431520	Ludlum 2241-2 163603	Wallac Model 1409 S/N 4061042
Det. (Model/SN)	Internal	Internal	Ludlum 43-68 PR 149613	Internal
Type Rad.	β	β	β	β
Cal. Due:	03/05/2013	03/05/2013	04/17/2013	09/15/2012
Check Instruments Used	✓		✓	

No.	Time	Locations	See attached LSC printout for Total Activity (cpm/100 cm ²)
1.	1050	BACKGROUND	
2.		door	
3.		FLOOR	
4.		Hood LEFT side	
5.		" " BACK	
6.		" MIDDLE "	
7.		" RIGHT "	
8.		" " side	
9.		" " BOTTOMS	
10.		" MIDDLE "	
11.		" LEFT "	
12.		" SASH	
13.		" CONTROL SECTION	
14.		FLOOR	
15.		UPPER WALL	
16.		LOWER "	
17.		FLOOR	
18.		UPPER WALL	

Radiological Survey Continuation Sheet

Page 2 of 16

Date 10-2-12

No.	Time	Locations	See attached LSC printout for Total Activity (cpm/100 cm ²)
19	1050	LOWER WALL	
20		CAB door	
21		" TOP SHELF	
22		" 2nd "	
23		" 3rd "	
24		" 4TH "	
25		TOP SHELF	
26		2nd "	
27		3rd "	
28		4TH "	
29		TOP "	
30		2nd "	
31		3rd "	
32		desk	
33		dwr	
34		"	
35		"	
36		"	
37		TOP SHELF	
38		2nd "	
39		3rd "	
40		TOP "	
41		2nd "	
42		3rd "	
43		4TH "	
44		BENCH	
45	N	" & cup	

Radiological Survey Continuation Sheet

Page 3 of 16

Date 10-2-12

No.	Time	Locations	See attached LSC printout for Total Activity (cpm/100 cm ²)
46	1050	BENCH & CUP	
47		"	
48		TOP dWR	
49		2ND "	
50		CAB DOOR	
51		" TOP SHELF	
52		" BOTTOM "	
53		dWR	
54		TOP LEFT dWR	
55		" RIGHT "	
56		2ND LEFT "	
57		2ND RIGHT "	
58		1ST LARGE dWR	
59		2ND " "	
60		TOP LEFT dWR	
61		2ND " "	
62		3RD " "	
63		TOP RIGHT 4	
64		2ND " 4	
65		1ST LARGE "	
66		2ND " 4	
67		LEDGE & WALL	
68		FLOOR	
69		"	
70		"	
71		HOOD LEFT SIDE	
72		" " BACK	

Radiological Survey Continuation Sheet

Page 4 of 16

Date 10-2-12

No.	Time	Locations	See attached LSC printout for Total Activity (cpm/100 cm ²)
73	1050	HOOD RIGHT BACK	
74		" " Side	
75		" LEFT BOTTOM of CUP	
76		" RIGHT "	
77		" SASH	
78		" LIP	
79		" Middle BOTTOM	
80		CAB DOORS	
81		"	
82		" DOORS	
83		"	
84		FLOOR	
85		TABLE TOP	
86		" "	
87		" SHELVES	
88		BENCH	
89		"	
90		"	
91		TOP SHELF	
92		2ND "	
93		3RD "	
94		SHELF	
95		TOP LEFT DWL	
96		2ND " "	
97		TOP RIGHT "	
98		2ND " "	
99	✓	3RD " "	

Radiological Survey Continuation Sheet

Page 5 of 16

Date 10-2-12

No.	Time	Locations	See attached LSC printout for Total Activity (cpm/100 cm ²)
100	1050	1ST LARGE dWR	
101		2ND " "	
102		TOP LEFT dWR	
103		2ND " "	
104		TOP RIGHT "	
105		2ND " "	
106		1ST LARGE "	
107		2ND " "	
108		dWR	
109		TOP "	
110		2ND "	
111		CAB door	
112		" TOP SHELF	
113		" BOTTOM "	
114		DESK	
115		dWR	
116		"	
117		"	
118		"	
119		CAB doors	
120		"	
121		CAB doors	
122		" TOP SHELF	
123		" 2ND "	
124		" 3RD "	
125		" 4TH "	
126	✓	SHELF	

Radiological Survey Continuation Sheet

Page 6 of 16

Date 10-2-12

No.	Time	Locations	See attached LSC printout for Total Activity (cpm/100 cm ²)
127	1050	TOP SHELF	
129		2ND "	
130		3RD "	
131		DESK	
132		TOP SHELF	
133 134		2ND "	
134 135		3RD "	
135		TOP "	
136		2ND "	
137		3RD "	
138		BENCH	
139		" # CUP	
140		"	
141		" # CUP	
142		BENCH # CUP	
143		DR	
144		"	
145		"	
146		"	
147		"	
148		"	
149		CAB door	
150		" TOP SHELF	
151		" BOTTOM "	
152		DR	
153		"	
154		"	

Radiological Survey Continuation Sheet

Page 7 of 16

Date 10-2-12

No.	Time	Locations	See attached LSC printout for Total Activity (cpm/100 cm ²)
155	1050	dwr	
156		"	
157		"	
158		"	
159		"	
160		"	
161		"	
162		Side of Hood	
163		PEG BOARD	
164		SINK AREA	
165		BENCH	
166		CAB DOORS	
167		" TOP SHELF	
168		" 2ND "	
169		" 3RD "	
170		" 4TH "	
171		CAB DOORS	
172		INSIDE CAB	
173		TOP dwr	
174		2nd "	
175		3rd "	
176		4th "	
177		FLOOR	
178		"	
179		"	
180		"	
181	✓	"	

Radiological Survey Continuation Sheet

Page 8 of 16

Date 10-2-12

No.	Time	Locations	See attached LSC printout for Total Activity (cpm/100 cm ²)
182	1050	LEDGE & WALL	
183		FLOOR	
184		FLOOR	
185		"	
186		"	
187		UPPER WALL	
188		LOWER "	
189		TOP SHELF	
190		BOTTOM "	
191		FLOOR	
192		"	
193		SIDE OF CABINETS	
194		FLOOR	
195		BENCH	
196		"	
197		"	
198		"	
199		TOP SHELF	
200		2ND "	
201		3RD "	
202		4TH "	
203		SHELVES	
204		DESK	
205		TOP DRAW	
206		2ND "	
207		3RD "	
208	✓	1 "	

Radiological Survey Continuation Sheet

Page 9 of 16

Date 10-2-12

No.	Time	Locations	See attached LSC printout for Total Activity (cpm/100 cm ²)
209	1050	TOP dwr	
210	↑	2nd "	
211		CAB door	
212		" TOP SHELF	
213		" BOTTOM "	
214		dwr	
215		TOP dwr	
216		2nd "	
217		3rd "	
218		4TH "	
219		TOP "	
220		2ND "	
221		3RD "	
222		4TH "	
223		door	
224		FLOOR	
225		UPPER WALL	
226		LOWER "	
227		FLOOR	
228		"	
229		"	
230		CAB	
231		dwrS	
232		CAB	
233	dwrS		
234	DESK & dwrS		
235	↓	" " "	

Radiological Survey Continuation Sheet

Page 10 of 16

Date 10-2-12

No.	Time	Locations	See attached LSC printout for Total Activity (cpm/100 cm ²)
236	10 50	SHelves	
237		"	
238		Window	
239		door	
240		Window	
241		Floor	
242		CAB	
243		"	
244		desk & drawers	
245		" " "	
246		SHelves	
247		"	
248		UPPER WALL	
249		lower "	
250		door	
251		Floor	
252		Window	
253		door	
254		Floor	
255		"	
256		"	
257		"	
258	✓	"	

Bld. 118W Room W126

Page 11 of 16

Date: 10-2-12

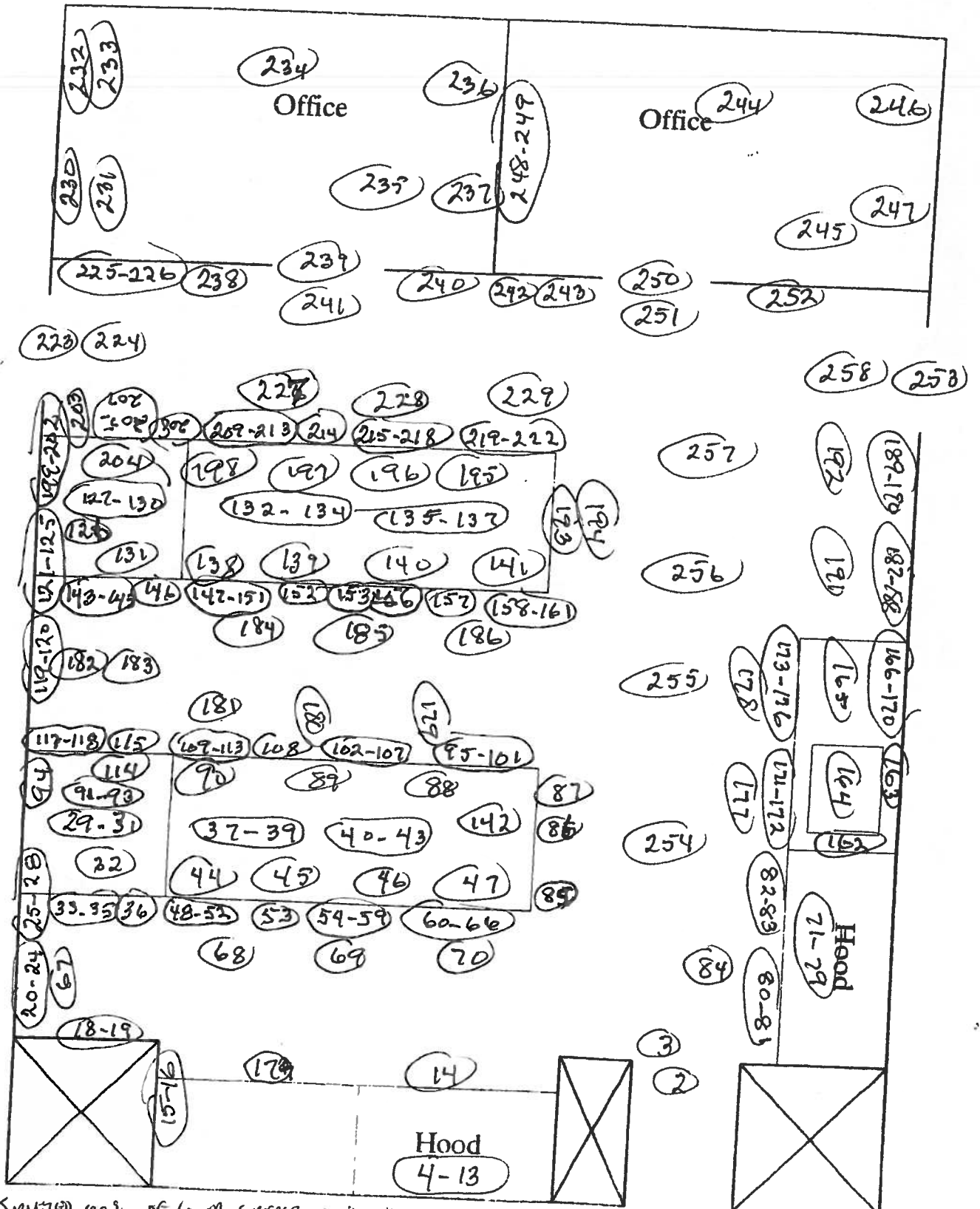

O = wipe
LOCATIONS

- Sampled 100% of lower surfaces using 43-69 notations in excess of normal background level noted.

Assay Definition-

Assay Description:
Equipment Swipes

Assay Type: CPM
Report Name: Report1
Output Data Path: C:\Packard\Tricarb\Results\Ed Gailor\Eds Monthly Swipes
Raw Results Path: C:\Packard\Tricarb\Results\Ed Gailor\Eds Monthly Swipes\20121002_1604
\20121002_1604.results
RTF File Name: C:\Packard\Tricarb\Results\Ed Gailor\Eds Monthly Swipes\Ed's Monthly
Swipes.rtf
Assay File Name: C:\Packard\TriCarb\Assays\Eds Monthly Swipes.lsa

Count Conditions-

Nuclide: Triple
Quench Indicator: tSIE/AEC
External Std Terminator (sec): 5 sec
Pre-Count Delay (min): 0.00
Quench Set: n/a
Count Time (min): 1.00
Count Mode: Normal
Assay Count Cycles: 1 Repeat Sample Count: 1
#Vials/Sample: 1 Calculate % Reference: Off

Background Subtract: On - Manual
Low CPM Threshold: Off
2 Sigma % Terminator: Off

Regions	LL	UL	Bkg Subtract
A	0.0	18.6	0.00
B	18.6	156.0	0.00
C	0.0	2000.0	0.00

Count Corrections-

Static Controller: On Luminescence Correction: On
Colored Samples: n/a Heterogeneity Monitor: n/a
Coincidence Time (nsec): 18 Delay Before Burst (nsec): 75

Half Life-

Half Life Correction: Off

Regions	Half Life	Units	Reference Date	Reference Time
A				
B				
C				

Cycle 1 Results

S#	CPMA	CPMB	CPMC	MESSAGES
1	10	8	25	
2	10	7	24	
3	2	6	13	
4	8	5	20	
5	6	11	20	
6	8	9	23	
7	13	8	26	
8	10	6	21	
9	8	8	22	
10	12	7	22	

Protocol# 4 - Eds Monthly Swipes.lsa

User: Ed Gallo

11	9	7	19
12	20	4	34
13	11	12	26
14	8	7	24
15	7	6	20
16	4	3	12
17	18	6	28
18	8	7	20
19	11	3	19
20	5	4	12
21	7	14	23
22	4	5	13
23	5	7	15
24	14	5	22
25	1	9	14
26	10	8	24
27	8	4	17
28	15	9	30
29	15	12	32
30	15	12	28
31	8	7	17
32	13	5	22
33	4	4	14
34	14	5	25
35	10	7	23
36	7	2	15
37	8	9	23
38	11	6	19
39	9	8	23
40	11	7	20
41	14	7	29
42	7	9	19
43	5	6	17
44	7	7	19
45	13	6	21
46	9	10	25
47	8	6	24
48	12	9	29
49	1	4	10
50	15	7	27
51	8	4	15
52	4	8	13
53	9	10	29
54	6	3	14
55	8	6	22
56	9	9	23
57	8	2	10
58	13	8	26
59	11	8	27
60	6	10	20
61	10	7	23
62	11	4	23
63	3	11	19
64	21	9	35
65	5	10	19
66	7	10	22
67	8	4	17
68	8	8	24
69	7	6	18
70	9	7	21
71	8	6	20
72	14	7	26
73	9	6	22

Protocol# 4 - Eds Monthly Swipes.lsa

User: Ed Gallor

74	6	5	15
75	10	10	30
76	5	7	21
77	6	6	18
78	6	8	16
79	6	5	18
80	13	9	34
81	12	6	23
82	7	6	18
83	8	8	19
84	13	11	30
85	11	4	18
86	3	4	11
87	6	6	19
88	10	10	23
89	14	4	21
90	4	8	17
91	15	9	36
92	17	6	31
93	15	9	29
94	10	7	18
95	12	5	24
96	20	5	39
97	8	8	23
98	11	4	18
99	12	6	23
100	8	11	26
101	12	6	21
102	0	5	8
103	8	5	16
104	16	5	27
105	4	9	22
106	11	7	21
107	10	7	22
108	9	6	21
109	2	4	13
110	7	5	13
111	9	12	26
112	7	7	22
113	3	7	14
114	7	11	23
115	17	4	28
116	4	5	15
117	11	4	20
118	0	5	13
119	8	10	22
120	11	6	22
121	9	6	19
122	2	5	12
123	5	7	20
124	13	5	26
125	7	3	17
126	6	3	15
127	12	11	32
128	3	8	17
129	5	11	22
130	7	4	17
131	14	6	25
132	9	9	21
133	7	9	17
134	13	6	29
135	12	15	33
136	9	7	23

137	15	10	30
138	3	7	13
139	10	8	23
140	9	9	26
141	0	7	9
142	8	10	25
143	8	7	22
144	9	6	24
145	5	7	18
146	8	4	17
147	0	6	10
148	16	6	29
149	7	6	18
150	8	5	19
151	9	5	16
152	2	5	10
153	3	7	13
154	15	11	30
155	7	6	20
156	5	6	14
157	16	8	30
158	14	7	24
159	12	3	22
160	10	4	19
161	10	10	25
162	7	6	18
163	2	5	10
164	0	5	11
165	6	10	23
166	6	9	18
167	7	7	16
168	15	10	31
169	15	12	31
170	11	10	27
171	16	6	24
172	14	8	30
173	12	5	20
174	10	7	26
175	12	12	29
176	6	8	18
177	11	11	27
178	4	9	20
179	4	7	18
180	10	6	18
181	7	7	19
182	5	11	18
183	9	9	26
184	11	7	26
185	10	7	23
186	9	9	21
187	5	7	16
188	15	4	28
189	13	6	26
190	7	6	16
191	3	8	16
192	9	12	24
193	12	7	23
194	14	7	24
195	17	4	32
196	9	9	23
197	13	14	35
198	3	12	19
199	43	33	82

200	21	11	37
201	8	8	23
202	17	8	29
203	13	12	31
204	2	7	18
205	3	5	12
206	5	10	17
207	10	7	23
208	16	7	30
209	15	7	25
210	8	6	20
211	13	4	27
212	14	11	36
213	0	5	9
214	7	2	13
215	7	7	30
216	14	6	27
217	9	2	16
218	7	10	24
219	10	8	28
220	9	6	21
221	7	2	11
222	9	14	28
223	12	7	27
224	9	9	23
225	10	6	19
226	18	6	25
227	2	3	11
228	7	7	23
229	16	3	25
230	3	6	20
231	13	8	30
232	13	8	29
233	7	5	20
234	10	7	20
235	10	10	24
236	14	10	34
237	8	4	16
238	8	7	20
239	8	12	26
240	11	8	28
241	9	5	22
242	6	11	23
243	6	5	17
244	5	7	19
245	9	3	18
246	10	3	18
247	7	13	25
248	8	9	23
249	14	5	22
250	8	10	24
251	0	10	11
252	9	7	22
253	6	9	19
254	13	7	27
255	5	8	20
256	12	12	28
257	8	10	23
258	14	8	28