

## Radiological Survey Sheet

Job Location PGRD - 118W/W125 Page 1 of 22  
 Survey Purpose Decommissioning Date 1/24/03  
 Performed By Pam Jones (Print) Pam Jones (Sign)

Inst.(1) Beckman LS 6000 (Model/SN) #7060743	Inst.(2) Ludlum 2241-2 (Model/SN) #163603	Inst.(3) (Model/SN)
Det. Internal (Model/SN)	Det. Ludlum 43-68 (Model/SN) #PR149613	Det. (Model/SN)
Eff. See LSC Printout	Eff. ≈ 8% C14	Eff.
Type rad. β	Type rad. β	Type rad.
Bkgd. See LSC Printout	Bkgd. 300 cpm	Bkgd.
Cal. Due: 4/26/03	Cal. Due: 4/5/03	Cal. due

No.	Time	Location	Inst. Used	Total Activity (cpm/100 cm <sup>2</sup> )
1.	0900	wall	1	See attached LSC Printout
2.			1	
3.			1	
4.			1	
5.			1	
6.			1	
7.			1	
8.			1	
9.		ledge	1	
10.			1	
11.		floor	1	
12.			1	
13.			1	
14.			1	
15.			1	
16.			1	
17.			1	
18.			1	

Radiological Survey Continuation Sheet

Page 2 of 22  
Date 1/24/03

No.	Time	Location	Inst. Used	Total Activity (cpm/100 cm <sup>2</sup> )
19		wall	1	See attached LSC Printout
20		↓	1	
21			1	
22		↓	1	
23		out. cabinet	1	
24		top shelf	1	
25		shelf	1	
26		↓	1	
27		bot. shelf	1	
28		out. cabinet	1	
29		top shelf	1	
30		shelf	1	
31		bot. shelf	1	
32		counter	1	
33		↓	1	
34		↓	1	
35		out. drawers	1	
36		top drawer	1	
37		drawer	1	
38		top shelf	1	
39		bot. shelf	1	
40		out. drawers	1	
41		top drawer	1	
42		drawer	1	
43		bot. drawer	1	
44		out. drawers	1	
45		top drawer	1	
46	↓	drawer	1	↓

Radiological Survey Continuation Sheet

Page 3 of 22

Date 1/24/03

No.	Time	Location	Inst. Used	Total Activity (cpm/100 cm <sup>2</sup> )
47		bot. drawer	1	See attached LSC Printout
48		inside glass	1	
49		inside glass door	1	
50		out. glass door	1	
51		out. glass	1	
52		floor	1	
53			1	
54			1	
55			1	
56			1	
57			1	
58			1	
59			1	
60		out. shelves	1	
61		top shelf	1	
62		shelf	1	
63			1	
64		bot. shelf	1	
65		top shelf	1	
66		bot. shelf	1	
67		wall	1	
68		pipe drier	1	
69		left <sup>side</sup> out. hood	1	
70		counter	1	
71			1	
72		sides of sink	1	
73		bottom	1	
74		drain	1	

Radiological Survey Continuation Sheet

Page 4 of 22

Date 1/24/03

No.	Time	Location	Inst. Used	Total Activity (cpm/100 cm <sup>2</sup> )
			1	See attached LSC Printout
75		out. drawers	1	
76		top drawer	1	
77		drawer	1	
78		↓	1	
79		bot. drawer	1	
80		out. cabinet	1	
81		left	1	
82		bottom	1	
83		right	1	
84		mid. hood left	1	
85		↓ top	1	
86		right	1	
87		glass + handles	1	
88		↓ ledge	1	
89		inside hood top left side	1	
90		bot. left side	1	
91		top left rear	1	
92		mid. left rear	1	
93		bot. left rear	1	
94		top right rear	1	
95		mid. right rear	1	
96		bot. right rear	1	
97		top rt. side	1	
98		bot. rt. side	1	
99		counter - left	1	* (see # 35)
100		counter - right	1	
101		cup sink	1	
102	↓	↓ rad. labelled beaker	1	* rad waste ↓

Radiological Survey Continuation Sheet

Page 5 of 22  
 Date 1/24/03

No.	Time	Location	Inst. Used	Total Activity (cpm/100 cm <sup>2</sup> )
103		out. cabinet	1	See attached LSC Printout
104		left	1	
105		bottom	1	
106		right	1	
107		out. cabinet	1	
108		left	1	
109		bottom	1	
110		right	1	
111		top shelf	1	
112		shelf	1	
113		bot. shelf	1	
114		top shelf	1	
115		shelf	1	
116		bot. shelf	1	
117		top shelf	1	
118		shelf	1	
119		bot. shelf	1	
120		counter	1	
121			1	
122			1	
123		↓	1	
124		shield	1	
125		top desk shelf	1	
126		desk <del>shd</del> top	1	
127		out. drawer	1	
128		top left drawer	1	
129		drawer	1	
130	↓	top rt. drawer	1	↓

Radiological Survey Continuation Sheet

Page 6 of 22

Date 1/24/03

No.	Time	Location	Inst. Used	Total Activity (cpm/100 cm <sup>2</sup> )
131		drawer	1	See attached LSC Printout
132		↓	1	
133		↓	1	
134		bot. drawer	1	
135		out. drawers	1	
136		top left drawer	1	
137		drawer	1	
138		top right drawer	1	
139		drawer	1	
140		↓	1	
141		bot. drawer	1	
142		drawer	1	
143		out. drawers	1	
144		top drawer	1	
145		drawer	1	
146		top shelf	1	
147		bot. shelf	1	
148		drawer	1	
149		out. drawers	1	
150		top drawer	1	
151		drawer	1	
152		bot. drawer	1	
153		floor	1	
154		↓	1	
155		↓	1	
156		↓	1	
157		↓	1	
158	↓	↓	1	↓

Radiological Survey Continuation Sheet

Page 7 of 22  
 Date 1/24/03

No.	Time	Location	Inst. Used	Total Activity (cpm/100 cm <sup>2</sup> )
159		top shelf	1	See attached LSC Printout
160		shelf	1	
161		↓	1	
162		bot. shelf	1	
163		top shelf	1	
164		shelf	1	
165		bot. shelf	1	
166		ledge	1	
167		↓	1	
168		shelf	1	
169		top shelf	1	
170		shelf	1	
171		↓	1	
172		bot. shelf	1	
173		shield	1	
174		desktop	1	
175		out. shelves	1	
176		top shelf	1	
177		shelf	1	
178		↓	1	
179		bot. shelf	1	
180		out. shelves	1	
181		top shelf	1	
182		shelf	1	
183		↓	1	
184		bot. shelf	1	
185		out. shelves	1	
186	↓	top shelf	1	↓

Radiological Survey Continuation Sheet

Page 8 of 22  
 Date 1/24/03

No.	Time	Location	Inst. Used	Total Activity (cpm/100 cm <sup>2</sup> )
187		shelf	1	See attached LSC Printout
188		↓	1	
189		bot. shelf	1	
190		left shelf	1	
191		mid. shelf	1	
192		rt. shelf	1	
193		counter	1	
194		↓	1	
195		↓	1	
196		cup sink	1	
197		↓	1	
198		drawer	1	
199		out. drawers	1	
200		top drawer	1	
201		drawer	1	
202		bot. drawer	1	
203		out. drawers	1	
204		top drawer	1	
205		drawer	1	
206		left	1	
207		bottom	1	
208		right	1	
209		drawer	1	
210		out. drawers	1	
211		top drawer	1	
212		drawer	1	
213		↓	1	
214	↓	bot. drawer	1	↓



Radiological Survey Continuation Sheet

Page 9 of 22

Date 1/24/03

No.	Time	Location	Inst. Used	Total Activity (cpm/100 cm <sup>2</sup> )
215		drawer	1	See attached LSC Printout
216		out. drawers	1	
217		top drawer	1	
218		drawer	1	
219		↓	1	
220		bot. drawer	1	
221		floor	1	
222		↓	1	
223		↓	1	
224		↓	1	
225		↓	1	
226		↓	1	
227		wall	1	
228		↓	1	
229		top shelf (file cabinet)	1	
230		shelf	1	
231		drawer	1	
232		↓	1	
233		↓	1	
234		bot. drawer	1	
235		wall	1	
236		top shelf	1	
237		shelf	1	
238		bot. shelf	1	
239		left glass	1	
240		left ledge	1	
241		rt. glass	1	
242		rt. ledge	1	

Radiological Survey Continuation Sheet

Page 10 of 22

Date 1/24/03

No.	Time	Location	Inst. Used	Total Activity (cpm/100 cm <sup>2</sup> )
243		wall	1	See attached LSC Printout
244		top shelf	1	
245		shelf	1	
246		bot. shelf	1	
247		desktops	1	
248		↓	1	
249		↓	1	
250		out. drawers	1	
251		top drawer	1	
252		drawer	1	
253		bot. drawer	1	
254		out. drawers	1	
255		top drawer	1	
256		drawer	1	
257		bot. drawer	1	
258		chair	1	
259		↓	1	
260		floor	1	
261		↓	1	
262		↓	1	
263		↓	1	
264		↓	1	
265		↓	1	
266		↓	1	
267		door	1	
268		out shades	1	
269		top shelf	1	
270	↓	shelf	1	↓

Radiological Survey Continuation Sheet

Page 11 of 22

Date 1/24/03

No.	Time	Location	Inst. Used	Total Activity (cpm/100 cm <sup>2</sup> )
271		shelf	1	See attached LSC Printout
272		bot. shelf	1	
273		out. shelves	1	
274		top shelf	1	
275		shelf	1	
276		↓	1	
277		bot. shelf	1	
278		out. shelves	1	
279		top shelf	1	
280		shelf	1	
281		↓	1	
282		bot. shelf	1	
283		top shelf	1	
284		shelf	1	
285		↓	1	
286		bot. shelf	1	
287		top shelf	1	
288		shelf	1	
289		↓	1	
290		bot. shelf	1	
291		top shelf	1	
292		shelf	1	
293		bot. shelf	1	
294		floor	1	
295			1	
296			1	
297			1	
298			1	

Radiological Survey Continuation Sheet

Page 12 of 22

Date 1/24/03

No.	Time	Location	Inst. Used	Total Activity (cpm/100 cm <sup>2</sup> )
299		floor	1	See attached LSC Printout
300		counter	1	
301		↓	1	
302			1	
303		↓	1	
304		shielding	1	
305		desktop	1	
306		out. drawers	1	
307		top drawer	1	
308		drawer	1	
309		↓	1	
310		bot. drawer	1	
311		out. drawers	1	
312		top drawer	1	
313		drawer	1	
314		↓	1	
315		bot. drawer	1	
316		drawer	1	
317		out. drawers	1	
318		top drawer	1	
319		drawer	1	
320		↓	1	
321		bot. drawer	1	
322		drawer	1	
323		out. drawers	1	
324		top drawer	1	
325		drawer	1	
326		top shelf	1	

Radiological Survey Continuation Sheet

Page 13 of 22  
 Date 1/24/03

No.	Time	Location	Inst. Used	Total Activity (cpm/100 cm <sup>2</sup> )
327		bot. shelf	1	See attached LSC Printout
328		drawer	1	
329		drawer	1	
330		wall	1	
331		↓	1	
332		desk top	1	
333		out. drawers	1	
334		top drawer	1	
335		drawer	1	
336		bot. drawer	1	
337		office glass door	1	
338		↓	1	
339		out. cabinet	1	
340		top drawer	1	
341		bot. drawer	1	
342		wall	1	
343		↓	1	
344		shelves	1	
345		desktop	1	
346		ledge	1	
347		shelves	1	
348		chair	1	
349		↓	1	
350		floor	1	
351		post decon #99	1	
			1	
			1	
			1	

Bld. 118W Room W125

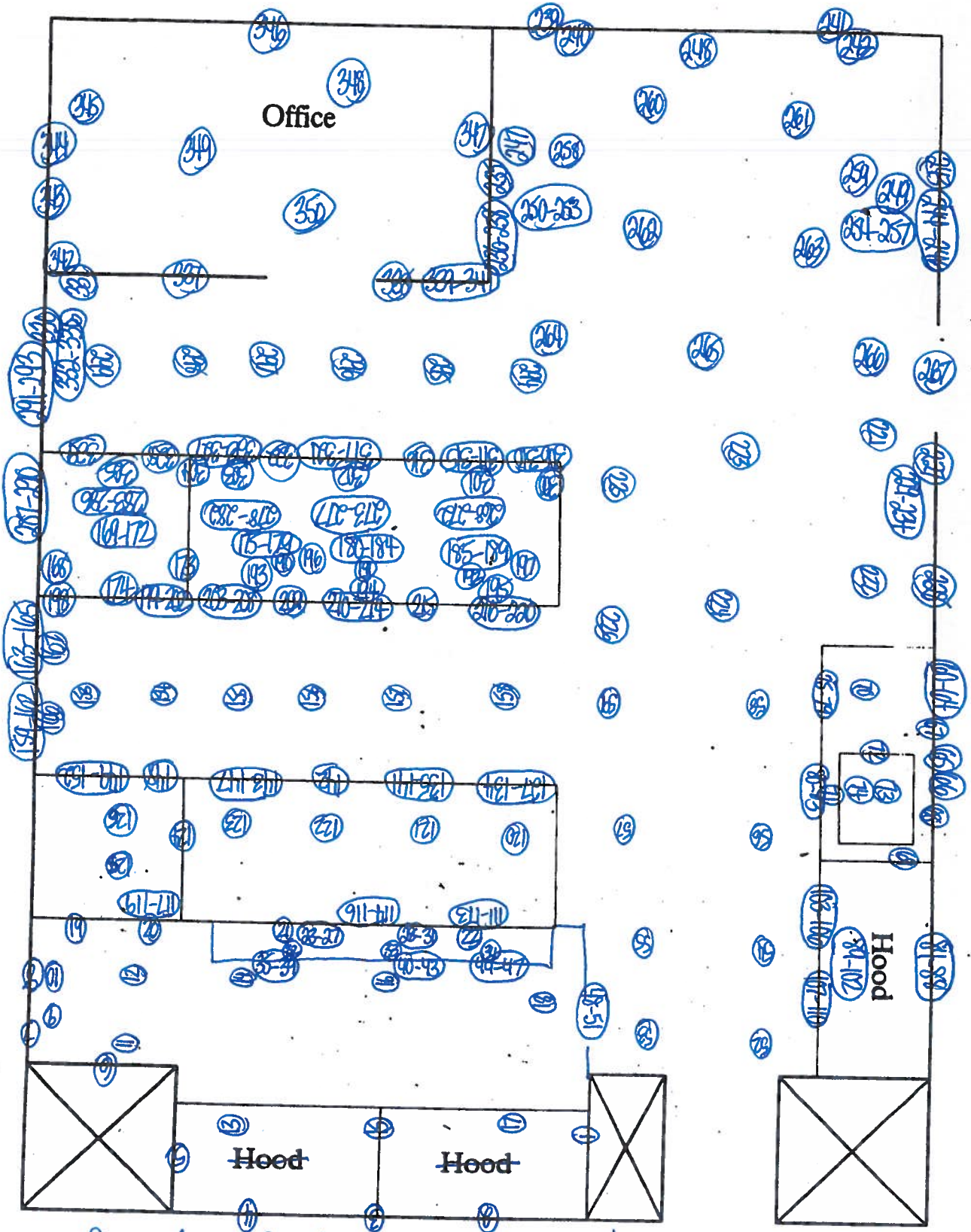

Surveyed 100% of all lower surfaces using instrument #2  
All areas were found to be at a level of normal background.

27 JAN 2003 14:36

**ID: WIPES**

USER: 5 COMMENT: WIPES  
 PRESET TIME : 1.00  
 DATA CALC : DL DPM H# : YES SAMPLE REPEATS: 1 PRINTER : EDIT  
 COUNT BLANK : YES IC# : NO REPLICATES : 1 RS232 : EDIT  
 TWO PHASE : NO AQC : YES CYCLE REPEATS : 1  
 SCINTILLATOR: LIQUID LUMEX: YES LOW SAMPLE REJ: 0  
 LOW LEVEL : NO HALF LIFE CORRECTION DATE: none

ISOTOPE 1: 3H %ERROR: 2.00 FACTOR: 1.0000 BKG. SUB: 0  
 ISOTOPE 2: 14C %ERROR: 2.00 FACTOR: 1.0000 BKG. SUB: 0  
 WIDE OPEN WINDOW %ERROR: 0.00 FACTOR: 1.0000 BKG. SUB: 0

BACKGROUND QUENCH CURVE: Off COLOR QUENCH CORRECTION: Off

Quench Limits Low: 13.688 High: 306.34

SAM NO	3H CPM	14C CPM	WIDE CPM	3H DPM	14C DPM		
B1	13.00	11.00	40.00	23.44	14.60		
	Blank Average	Blank Average	DPM for	3H :	23.44	COEF. OF VAR:	0.000
	Blank Average	Blank Average	DPM for	14C :	14.60	COEF. OF VAR:	0.000

1	15.00	9.00	41.00	5.70	-2.73
2	15.00	9.00	33.00	5.99	-2.72
3	13.00	8.00	27.00	1.82	-4.04
4	6.00	8.00	26.00	-13.90	-3.88
5	14.00	9.00	30.00	3.30	-2.72
6	7.00	7.00	25.00	-11.40	-5.28
7	12.00	12.00	40.00	-2.61	1.38
8	11.00	7.00	26.00	-2.15	-5.35
9	7.00	12.00	26.00	-14.34	1.43
10	18.00	11.00	43.00	10.74	-0.11
11	7.00	12.00	27.00	-14.01	1.49
12	13.00	14.00	35.00	-1.00	4.10
13	16.00	10.00	35.00	8.28	-1.37
14	8.00	12.00	33.00	-11.61	1.48
15	14.00	12.00	40.00	3.10	1.41
16	12.00	16.00	36.00	-3.80	6.90
17	14.00	7.00	31.00	5.30	-5.39
18	7.00	15.00	30.00	-15.49	5.60
19	9.00	12.00	30.00	-9.58	1.43
20	12.00	11.00	38.00	-2.33	0.01
21	15.00	12.00	32.00	4.80	1.35
22	11.00	6.00	30.00	-1.51	-6.70
23	13.00	4.00	29.00	3.66	-9.44
24	20.00	10.00	38.00	17.52	-1.45
25	16.00	12.00	33.00	6.31	1.30
26	7.00	13.00	32.00	-14.75	2.80
27	13.00	16.00	43.00	-2.90	6.73
28	14.00	8.00	30.00	3.91	-4.06
29	18.00	9.00	44.00	12.66	-2.78
30	8.00	15.00	35.00	-13.57	5.48
31	8.00	9.00	27.00	-10.28	-2.61
32	15.00	5.00	33.00	8.58	-8.12
33	15.00	7.00	30.00	7.50	-5.41
34	20.00	8.00	39.00	18.72	-4.15
35	9.00	8.00	22.00	-7.54	-3.98
36	15.00	6.00	25.00	7.79	-6.77

SAM NO	3H CPM	14C CPM	WIDE CPM	3H DFM	14C DFM
37	11.00	18.00	39.00	-8.25	9.50
38	11.00	11.00	33.00	-4.52	0.04
39	16.00	9.00	39.00	7.87	-2.75
40	13.00	11.00	33.00	-0.03	-0.00
41	15.00	8.00	31.00	6.55	-4.07
42	19.00	11.00	39.00	14.18	-0.09
43	15.00	9.00	40.00	6.37	-2.71
44	15.00	15.00	42.00	2.39	5.36
45	12.00	8.00	30.00	0.10	-4.00
46	11.00	9.00	26.00	-2.62	-2.62
47	4.00	6.00	16.00	-17.66	-6.58
48	7.00	12.00	26.00	-14.17	1.46
49	17.00	11.00	33.00	9.66	-0.05
50	13.00	13.00	35.00	-0.99	2.70
51	17.00	11.00	38.00	9.09	-0.07
52	12.00	10.00	27.00	-0.42	-1.26
53	16.00	8.00	38.00	9.68	-4.07
54	13.00	9.00	31.00	1.77	-2.67
55	20.00	10.00	42.00	17.35	-1.45
56	16.00	9.00	38.00	9.28	-2.71
57	16.00	18.00	44.00	4.03	9.48
58	8.00	9.00	35.00	-9.78	-2.57
59	15.00	11.00	35.00	5.97	0.03
60	12.00	13.00	35.00	-3.36	2.72
61	18.00	13.00	42.00	10.36	2.61
62	12.00	10.00	36.00	-1.66	-1.33
63	11.00	6.00	30.00	-1.72	-6.70
64	10.00	13.00	31.00	-7.36	2.81
65	13.00	6.00	27.00	3.64	-6.72
66	13.00	11.00	42.00	0.72	0.04
67	7.00	9.00	19.00	-12.39	-2.58
68	16.00	12.00	35.00	6.98	1.33
69	12.00	11.00	30.00	-2.09	0.03
70	13.00	12.00	36.00	0.39	1.41
71	7.00	8.00	27.00	-11.46	-3.89
72	12.00	9.00	34.00	-1.01	-2.67
73	10.00	17.00	35.00	-9.95	8.18
74	14.00	13.00	42.00	1.59	2.71
75	14.00	8.00	37.00	4.25	-4.05
76	11.00	9.00	30.00	-3.02	-2.64
77	18.00	15.00	42.00	9.81	5.34
78	11.00	18.00	38.00	-8.21	9.51
79	16.00	15.00	41.00	5.22	5.38
80	17.00	11.00	46.00	11.02	-0.00
81	10.00	18.00	44.00	-10.30	9.57
82	10.00	10.00	29.00	-5.75	-1.26
83	18.00	9.00	37.00	12.42	-2.79
84	8.00	12.00	34.00	-11.89	1.44
85	11.00	17.00	35.00	-7.56	8.17
86	8.00	8.00	23.00	-9.64	-3.95
87	18.00	12.00	39.00	11.11	1.27
88	18.00	10.00	37.00	13.32	-1.40
89	19.00	7.00	35.00	16.33	-5.49
90	19.00	11.00	39.00	13.97	-0.10
91	18.00	10.00	36.00	15.17	-1.35
92	16.00	8.00	35.00	9.06	-4.08
93	23.00	10.00	44.00	24.99	-1.49
94	16.00	12.00	43.00	6.80	1.32



SAM NO	3H CPM	14C CPM	WIDE CPM	3H DPM	14C DPM
95	12.00	10.00	28.00	-1.18	-1.30
96	14.00	3.00	35.00	7.19	-10.80
97	15.00	4.00	26.00	8.81	-9.47
98	19.00	14.00	43.00	12.25	3.95
99	75.00	3.00	91.00	155.02	-11.97
100	33.00	13.00	55.00	52.92	2.46
101	12.00	10.00	32.00	-1.02	-1.29
102	4443.00	11649.00	16107.00	3630.79	15617.74
103	10.00	10.00	35.00	-5.58	-1.25
104	10.00	18.00	44.00	-10.75	9.48
105	48.00	7.00	64.00	87.15	-6.02
106	15.00	11.00	32.00	5.43	0.00
107	17.00	9.00	34.00	10.93	-2.75
108	8.00	10.00	29.00	-10.64	-1.24
109	15.00	9.00	33.00	6.05	-2.72
110	14.00	8.00	36.00	3.97	-4.06
111	11.00	13.00	30.00	-4.95	2.80
112	14.00	11.00	37.00	2.57	-0.00
113	14.00	9.00	30.00	3.86	-2.70
114	18.00	13.00	43.00	12.07	2.68
115	14.00	11.00	38.00	3.19	0.03
116	15.00	8.00	35.00	7.56	-4.04
117	10.00	6.00	31.00	-1.57	-6.61
118	8.00	10.00	27.00	-10.54	-1.23
119	6.00	11.00	33.00	-15.74	0.16
120	11.00	9.00	27.00	-3.30	-2.65
121	11.00	14.00	31.00	-6.23	4.08
122	17.00	8.00	34.00	11.02	-4.11
123	15.00	8.00	34.00	7.11	-4.06
124	6.00	14.00	29.00	-17.44	4.21
125	5.00	11.00	27.00	-18.06	0.18
126	15.00	10.00	37.00	5.85	-1.36
127	14.00	14.00	42.00	1.24	4.07
128	11.00	5.00	26.00	-1.25	-8.05
129	11.00	8.00	30.00	-2.87	-4.01
130	5.00	14.00	32.00	-19.79	4.22
131	9.00	12.00	31.00	-9.52	1.43
132	13.00	11.00	36.00	0.43	0.02
133	11.00	6.00	29.00	-1.29	-6.69
134	14.00	9.00	31.00	3.55	-2.71
135	10.00	10.00	35.00	-5.83	-1.26
136	12.00	9.00	31.00	-0.80	-2.66
137	14.00	10.00	33.00	3.52	-1.34
138	21.00	11.00	38.00	18.81	-0.13
139	11.00	11.00	28.00	-4.19	0.06
140	16.00	15.00	42.00	5.33	5.39
141	17.00	6.00	29.00	12.49	-6.80
142	9.00	6.00	23.00	-6.06	-6.66
143	8.00	5.00	24.00	-7.82	-7.99
144	14.00	9.00	35.00	3.54	-2.71
145	8.00	9.00	30.00	-9.97	-2.58
146	9.00	13.00	33.00	-10.15	2.77
147	16.00	9.00	34.00	8.34	-2.74
148	9.00	13.00	35.00	-9.93	2.80
149	13.00	7.00	32.00	2.69	-5.38
150	18.00	15.00	41.00	9.48	5.32
151	6.00	9.00	25.00	-14.76	-2.57
152	13.00	8.00	31.00	2.02	-4.03

SAM NO	3H CPM	14C CPM	WIDE CPM	3H DPM	14C DPM
153	15.00	15.00	42.00	2.80	5.39
154	10.00	4.00	29.00	-2.63	-9.38
155	16.00	17.00	41.00	4.19	8.09
156	9.00	12.00	29.00	-9.11	1.48
157	12.00	9.00	27.00	-0.17	-2.63
158	12.00	13.00	38.00	-2.29	2.80
159	10.00	13.00	39.00	-7.66	2.78
160	15.00	6.00	24.00	7.60	-6.77
161	19.00	9.00	45.00	15.84	-2.78
162	17.00	21.00	45.00	4.18	13.47
163	9.00	13.00	36.00	-9.85	2.81
164	12.00	13.00	38.00	-2.87	2.76
165	17.00	12.00	39.00	9.05	1.30
166	15.00	14.00	41.00	3.09	4.02
167	12.00	18.00	39.00	-5.86	9.50
168	17.00	10.00	36.00	9.83	-1.41
169	13.00	4.00	28.00	5.76	-9.42
170	19.00	13.00	46.00	14.04	2.65
171	15.00	9.00	29.00	6.28	-2.71
172	12.00	9.00	33.00	-1.01	-2.67
173	14.00	10.00	35.00	3.47	-1.34
174	18.00	8.00	35.00	13.01	-4.13
175	19.00	10.00	39.00	14.73	-1.44
176	14.00	16.00	35.00	-0.45	6.73
177	20.00	5.00	36.00	19.11	-8.21
178	18.00	6.00	34.00	14.28	-6.83
179	10.00	12.00	32.00	-7.18	1.42
180	5.00	15.00	26.00	-20.37	5.55
181	17.00	15.00	42.00	7.29	5.35
182	8.00	10.00	22.00	-10.73	-1.25
183	13.00	10.00	35.00	0.85	-1.33
184	16.00	15.00	42.00	5.16	5.38
185	8.00	11.00	31.00	-11.25	0.10
186	16.00	8.00	31.00	9.16	-4.08
187	14.00	12.00	37.00	1.94	1.34
188	9.00	6.00	22.00	-6.06	-6.66
189	11.00	9.00	32.00	-2.88	-2.63
190	9.00	15.00	30.00	-10.71	5.56
191	13.00	13.00	35.00	-0.19	2.76
192	6.00	9.00	22.00	-14.70	-2.56
193	11.00	10.00	31.00	-3.21	-1.26
194	17.00	9.00	37.00	12.42	-2.71
195	15.00	9.00	31.00	6.60	-2.70
196	6.00	16.00	29.00	-18.45	6.99
197	18.00	8.00	44.00	13.77	-4.12
198	14.00	9.00	30.00	4.07	-2.69
199	9.00	4.00	15.00	-4.94	-9.36
200	14.00	15.00	38.00	0.24	5.39
201	17.00	12.00	38.00	8.70	1.28
202	14.00	16.00	44.00	-0.39	6.73
203	13.00	10.00	32.00	0.38	-1.36
204	12.00	9.00	32.00	-1.00	-2.67
205	18.00	10.00	38.00	12.38	-1.42
206	11.00	5.00	26.00	-1.02	-8.05
207	18.00	15.00	43.00	9.00	5.30
208	11.00	9.00	33.00	-3.40	-2.66
209	13.00	16.00	43.00	-2.49	6.77
210	9.00	11.00	25.00	-8.98	0.08

SAM NO	3H CPM	14C CPM	WIDE CPM	3H DPM	14C DPM
211	15.00	5.00	29.00	8.20	-8.12
212	14.00	18.00	46.00	-1.47	9.43
213	16.00	13.00	39.00	6.00	2.66
214	13.00	10.00	32.00	0.93	-1.33
215	17.00	7.00	34.00	11.64	-5.46
216	9.00	7.00	26.00	-6.55	-5.31
217	12.00	10.00	29.00	-1.14	-1.30
218	11.00	8.00	28.00	-1.51	-3.95
219	10.00	14.00	33.00	-7.43	4.22
220	3.00	10.00	23.00	-22.15	-1.14
221	15.00	7.00	33.00	7.89	-5.40
222	10.00	18.00	38.00	-9.89	9.65
223	14.00	11.00	39.00	2.96	0.02
224	5.00	7.00	21.00	-15.72	-5.22
225	16.00	10.00	37.00	8.03	-1.38
226	16.00	7.00	41.00	9.93	-5.43
227	13.00	10.00	39.00	0.88	-1.33
228	14.00	6.00	27.00	6.27	-6.74
229	9.00	8.00	31.00	-6.75	-3.93
230	23.00	11.00	44.00	25.24	-0.12
231	16.00	11.00	34.00	7.14	-0.04
232	7.00	11.00	31.00	-13.32	0.15
233	11.00	16.00	35.00	-7.08	6.81
234	15.00	9.00	36.00	6.52	-2.70
235	12.00	11.00	36.00	-2.01	0.03
236	13.00	9.00	32.00	2.24	-2.65
237	19.00	14.00	52.00	13.33	4.00
238	21.00	10.00	42.00	20.76	-1.45
239	12.00	12.00	34.00	-1.91	1.43
240	19.00	11.00	48.00	15.22	-0.06
241	18.00	12.00	41.00	12.23	1.31
242	16.00	12.00	36.00	7.45	1.35
243	15.00	11.00	36.00	5.05	-0.01
244	17.00	9.00	35.00	12.73	-2.70
245	15.00	8.00	40.00	9.70	-3.99
246	10.00	10.00	28.00	-4.57	-1.18
247	11.00	12.00	31.00	-3.63	1.50
248	8.00	13.00	35.00	-11.47	2.94
249	24.00	11.00	39.00	28.76	-0.12
250	13.00	10.00	33.00	1.10	-1.32
251	17.00	8.00	38.00	11.36	-4.10
252	10.00	7.00	26.00	-4.05	-5.32
253	16.00	11.00	32.00	7.36	-0.03
254	17.00	9.00	42.00	10.81	-2.75
255	18.00	11.00	36.00	11.82	-0.07
256	25.00	8.00	38.00	29.87	-4.25
257	19.00	15.00	41.00	12.61	5.34
258	14.00	17.00	41.00	-0.49	8.13
259	14.00	12.00	39.00	2.56	1.38
260	9.00	10.00	42.00	-7.78	-1.21
261	16.00	11.00	32.00	7.91	-0.01
262	19.00	14.00	43.00	12.85	3.98
263	15.00	13.00	40.00	4.35	2.71
264	14.00	16.00	43.00	0.30	6.79
265	14.00	12.00	40.00	3.12	1.41
266	22.00	12.00	44.00	22.28	1.25
267	10.00	10.00	32.00	-6.10	-1.28
268	14.00	13.00	41.00	2.08	2.74

SAM NO	3H CPM	14C CPM	WIDE CPM	3H DPM	14C DPM
269	12.00	12.00	39.00	-2.17	1.41
270	16.00	8.00	34.00	9.02	-4.08
271	17.00	9.00	38.00	10.68	-2.75
272	8.00	10.00	28.00	-10.51	-1.23
273	17.00	9.00	37.00	11.13	-2.74
274	16.00	13.00	37.00	6.91	2.70
275	11.00	10.00	31.00	-3.47	-1.28
276	21.00	9.00	40.00	20.69	-2.81
277	12.00	10.00	40.00	-0.96	-1.29
278	23.00	8.00	42.00	25.73	-4.21
279	9.00	7.00	23.00	-6.59	-5.31
280	14.00	16.00	43.00	0.63	6.82
281	21.00	8.00	39.00	21.58	-4.16
282	15.00	12.00	39.00	4.96	1.36
283	13.00	8.00	31.00	2.44	-4.02
284	12.00	14.00	44.00	-3.66	4.09
285	14.00	8.00	33.00	4.72	-4.04
286	12.00	10.00	36.00	-1.50	-1.32
287	18.00	15.00	42.00	11.01	5.40
288	13.00	8.00	34.00	2.73	-4.01
289	20.00	16.00	48.00	14.08	6.66
290	16.00	11.00	47.00	7.39	-0.03
291	8.00	8.00	26.00	-9.20	-3.92
292	9.00	9.00	30.00	-7.66	-2.60
293	10.00	15.00	30.00	-8.62	5.50
294	10.00	12.00	31.00	-6.89	1.45
295	12.00	7.00	27.00	0.78	-5.35
296	9.00	11.00	30.00	-8.55	0.12
297	14.00	12.00	41.00	2.60	1.38
298	12.00	11.00	34.00	-1.76	0.05
299	12.00	13.00	42.00	-3.05	2.74
300	16.00	12.00	42.00	7.45	1.35
301	16.00	10.00	32.00	9.24	-1.34
302	19.00	16.00	50.00	14.17	6.80
303	17.00	15.00	41.00	11.37	5.56
304	17.00	11.00	38.00	9.86	-0.04
305	12.00	13.00	36.00	-2.93	2.75
306	10.00	15.00	39.00	-8.55	5.51
307	18.00	15.00	47.00	10.17	5.36
308	13.00	10.00	36.00	1.19	-1.32
309	18.00	13.00	45.00	11.49	2.66
310	15.00	8.00	33.00	7.21	-4.05
311	18.00	12.00	41.00	11.78	1.30
312	12.00	13.00	35.00	-2.71	2.77
313	14.00	10.00	34.00	3.42	-1.34
314	8.00	15.00	34.00	-13.15	5.57
315	14.00	6.00	26.00	7.52	-6.72
316	12.00	9.00	34.00	-0.85	-2.66
317	20.00	4.00	30.00	20.98	-9.56
318	6.00	13.00	28.00	-16.92	2.85
319	12.00	12.00	35.00	-2.08	1.42
320	15.00	9.00	33.00	6.50	-2.70
321	14.00	10.00	40.00	3.77	-1.33
322	11.00	16.00	36.00	-7.00	6.82
323	13.00	15.00	37.00	-1.60	5.45
324	6.00	6.00	18.00	-12.67	-6.58
325	11.00	11.00	32.00	-4.15	0.06
326	5.00	17.00	29.00	-21.46	8.32

SAM NO	3H CPM	14C CPM	WIDE CPM	3H DPM	14C DPM
327	17.00	9.00	43.00	11.04	-2.75
328	12.00	9.00	32.00	-0.14	-2.63
329	13.00	8.00	33.00	2.00	-4.03
330	13.00	16.00	37.00	-2.52	6.77
331	13.00	6.00	27.00	3.37	-6.73
332	6.00	7.00	19.00	-13.33	-5.24
333	9.00	11.00	37.00	-8.64	0.11
334	12.00	7.00	29.00	1.00	-5.34
335	19.00	11.00	42.00	15.13	-0.06
336	10.00	11.00	31.00	-6.00	0.12
337	11.00	9.00	36.00	-2.92	-2.63
338	13.00	5.00	29.00	4.12	-8.08
339	20.00	6.00	35.00	20.54	-6.85
340	13.00	11.00	35.00	0.55	0.03
341	11.00	6.00	29.00	-1.06	-6.68
342	22.00	12.00	47.00	20.86	1.21
343	20.00	6.00	35.00	19.86	-6.85
344	14.00	10.00	32.00	3.35	-1.34
345	16.00	11.00	39.00	8.16	-0.00
346	13.00	14.00	43.00	0.09	4.18
347	13.00	14.00	40.00	0.77	4.23
348	21.00	15.00	44.00	17.47	5.31
349	21.00	15.00	46.00	19.45	5.39
350	12.00	10.00	30.00	-0.95	-1.29

29 JAN 2003 14:06

ID: WIPES

USER: 5 COMMENT: WIPES  
 PRESET TIME : 1.00  
 DATA CALC : DL DPM H# : YES SAMPLE REPEATS: 1 PRINTER : EDIT  
 COUNT BLANK : YES IC# : NO REPLICATES : 1 RS232 : EDIT  
 TWO PHASE : NO AQC : YES CYCLE REPEATS : 1  
 SCINTILLATOR: LIQUID LUMEX: YES LOW SAMPLE REJ: 0  
 LOW LEVEL : NO HALF LIFE CORRECTION DATE: none

ISOTOPE 1: 3H %ERROR: 2.00 FACTOR: 1.0000 BKG. SUB: 0  
 ISOTOPE 2: 14C %ERROR: 2.00 FACTOR: 1.0000 BKG. SUB: 0  
 WIDE OPEN WINDOW %ERROR: 0.00 FACTOR: 1.0000 BKG. SUB: 0

BACKGROUND QUENCH CURVE: Off COLOR QUENCH CORRECTION: Off

Quench Limits Low: 13.688 High: 306.34

SAM NO	3H CPM	14C CPM	WIDE CPM	3H DPM	14C DPM		
B1	12.00	10.00	38.00	21.89	13.28		
	Blank Average		DPM for	3H :	21.89	COEF. OF VAR:	0.000
	Blank Average		DPM for	14C :	13.28	COEF. OF VAR:	0.000
<i>A/31</i>	14.00	14.00	45.00	0.40	5.21		