

Radiological Survey Sheet

Job Location PFIZER INC., GROTON, CT 06340

Page 1 of 19

Survey Purpose DECOMMISSIONING 118W/ W120

Date 10-23-09

Performed by F. GALLER
(Print)

E. Saiter
(Sign)

Instrument (Model/S/N)	Packard Tri-Carb S/N 431521	Packard Tri-Carb S/N 431520	Ludlum 2241-2 163603	Wallac Model 1409 S/N 4061042
Det. (Model/S/N)	Internal	Internal	Ludlum 43-68 PR 149613	Internal
Type Rad.	β	β	β	β
Cal. Due:	04/03/2010	04/03/2010	04/07/2010	04/03/2010
Check Instruments Used	✓		✓	

No.	Time	Locations	See attached LSC printout for Total Activity (cpm/100 cm ²)
1.	0700	BACKGROUND	
2.		UPPER door	
3.		lower door	
4.		WALL UPPER	
5.		" LOWER	
6.		Hood TOP LEFT	
7.		" TOP MIDDLE	
8.		" TOP RIGHT	
9.		" BOTTOM LEFT	✓ (see # 293)
10.		" " MIDDLE	
11.		" " RIGHT	
12.		" LEFT - SIDE	
13.		" RIGHT "	
14.		" INSIDE SASH LEFT	
15.		" " RIGHT	
16.		" OUTSIDE SASH LEFT	
17.		" " RIGHT	
18.		" " LEFT SIDE	

Radiological Survey Continuation Sheet

Page 2 of 19

Date 10-23-08

No.	Time	Locations	See attached LSC printout for Total Activity (cpm/100 cm ²)
19	0730	HOOD OUTSIDE RIGHT SIDE	
20		CAB DOORS & HANDLES	
21		INSIDE CAB	
22		CAB DOORS & HANDLES	
23		INSIDE CAB	
24		SHELF ABOVE SINK	
25		B. BEHIND SINK (WALL)	
26		WALL	
27		SINK AREA	
28		BENCH	
29		BENCH	
30		BENCH	
31		CAB. DOORS & HANDLES	
32		TOP SHELF	
33		2ND "	
34		3RD "	
35		BOTTOM "	
36		CAB. DOORS & HANDLES	
37		TOP SHELF	
38		2ND SHELF	
39		BOTTOM "	
40		CAB. DOORS & HANDLES	
41		TOP SHELF	
42		MIDDLE "	
43		BOTTOM "	
44		TOP SHELF	
45	✓	2ND "	

Radiological Survey Continuation Sheet

Page 3 of 19

Date 10-23-07

No.	Time	Locations	See attached LSC printout for Total Activity (cpm/100 cm ²)
46	0700	2ND SHELF	
47		4TH "	
48		WALL	
49		WALL	
50		WALL	
51		UPPER WALL	
52		LOWER "	
53		SIDE OF CAB	
54		UPPER DOOR	
55		LOWER "	
56		UPPER WALL	
57		LOWER "	
58		CAB DOORS & HANDLS	
59		LEFT SIDE OF CAB	
60		RIGHT " " "	
61		DRAWERS & HANDLS	
62		" TOP DRAWER	
63		2ND "	
64		2ND "	
65		4TH "	
66		DRAWER & HANDLS	
67		"	
68		RIGHT DRAWERS & HANDLS	
69		LEFT " "	
70		TOP RIGHT DRAWER	
71		2ND " "	
72	✓	TOP LEFT DRAWER	

Radiological Survey Continuation Sheet

Page 4 of 19

Date 10-23-09

No.	Time	Locations	See attached LSC printout for Total Activity (cpm/100 cm ²)
73	0700	2ND LEFT DRAWER	
74		1ST BIG "	
75		2ND " "	
76		FLOOR	
77		"	
78		"	
79		"	
80		"	
81		"	
82		UPPER door	
83		LOWER "	
84		UPPER WALL	
85		LOWER "	
86		DESK	
87		"	
88		"	
89		"	
90		UPPER WALL	
91		LOWER "	
92		UPPER door	
93		LOWER "	
94		UPPER WALL	
95		LOWER "	
96		DESK	
97		"	
98		"	
99	✓	"	

Radiological Survey Continuation Sheet

Page 5 of 19

Date 10-23-09

No.	Time	Locations	See attached LSC printout for Total Activity (cpm/100 cm ²)
100	5200	TOP SHELF	
101		2ND "	
102		3RD "	
103		UPPER WALL	
104		LOWER WALL	
105		UPPER "	
106		LOWER "	
107		SIDE WALL	
108		BENCH	
109		SINK AREA	
110		BENCH	
111		"	
112		"	
113		PULL OUT SHELF	
114		TOP ^{END} RIGHT DOORS & HANDLS	
115		TOP DRAWER RIGHT	
116		2ND " "	
117		BOTTOM " "	
118		LEFT DOORS & HANDLS	
119		TOP LEFT DRAWER	
120		2ND " "	
121		2ND " "	
122		CAB DOOR & HANDL	
123		INSIDE CAB	
124		CAB DOORS & HANDLS	
125		TOP SHELF	
126	✓	2ND "	

Radiological Survey Continuation Sheet

Page 6 of 19

Date 10-23-09

No.	Time	Locations	See attached LSC printout for Total Activity (cpm/100 cm ²)
127	0200	BOTTOM SHELF	
128		CAB DOORS & HANDLS	
129		TOP SHELF	
130		2ND "	
131		3RD "	
132		CAB DOORS & HANDLS	
133		TOP SHELF	
134		2ND "	
135		3RD "	
136		CAB DOORS & HANDLS	
137		TOP SHELF	
138		2ND "	
139		3RD "	
140		UPPER WALL	
141		LOWER "	
142		UPPER UPPER "	
143		LOWER "	
144		SHELF	
145		"	
146		"	
147		"	
148		"	
149		BENCH	
150		BENCH	
151		BENCH	
152		BENCH	
153	✓	LEFT DRAWERS & HANDLS	

Radiological Survey Continuation Sheet

Page 7 of 19

Date 10-23-59

No.	Time	Locations	See attached LSC printout for Total Activity (cpm/100 cm ²)
154	0200	RIGHT DRAWERS & HANDLS	
155		RIGHT TOP DRAWER	
156		" 2ND "	
157		LEFT TOP "	
158		" 2ND "	
159		1ST BCG "	
160		2ND " "	
161		RIGHT DRAWERS & HANDLS	
162		LEFT " "	
163		TOP RIGHT DRAWER	
164		2ND " "	
165		TOP LEFT "	
166		2ND " "	
167		TOP LARGE "	
168		BOTTOM " "	
169		DRAWERS & HANDLS	
170		TOP DRAWER	
171		2ND "	
172		2ND "	
173		4TH "	
174		FLOOR	
175		"	
176		"	
177		"	
178		"	
179		SIDE OF BENCH	
180		" " "	

Radiological Survey Continuation Sheet

Page 8 of 19

Date 10-23-09

No.	Time	Locations	See attached LSC printout for Total Activity (cpm/100 cm ²)
181	0200	BENCH TOP	
182		DRAWER & HWDL	
183		DRAWERS & HWDLs	
184		TOP DRAWER	
185		2ND "	
186		3RD "	
187		4TH "	
188		DRAWERS & HWDLs	
189		1ST DRAWER	
190		2ND "	
191		3RD "	
192		4TH "	
193		RIGHT DOORS & HWDLs	
194		LEFT " "	
195		TOP RIGHT DRAWER	
196		2ND " "	
197		3RD " "	
198		TOP LEFT "	
199		2ND " "	
200		1ST BIG "	
201		2ND BIG "	
202		^{es} TOP RIGHT DOORS & HWDLs	
203		LEFT " & "	
204		TOP RIGHT DRAWER	
205		2ND " "	
206		TOP LEFT "	
207	✓	2ND " "	

Radiological Survey Continuation Sheet

Page 9 of 19

Date 10-23-59

No.	Time	Locations	See attached LSC printout for Total Activity (cpm/100 cm ²)
208	0700 208G	3RD LEFT DRAWER	
209		1ST BIG "	
210		2ND " "	
211		CAB DOORS & HANDLS	
212		TOP SHELF	
213		2ND "	
214		BOTTOM "	
215		CAB DOORS & HANDLS	
216		TOP SHELF	
217		2ND "	
218		BOTTOM SHELF	
219		CAB DOORS & HANDLS	
220		TOP SHELF	
221		2ND "	
222		BOTTOM "	
223		CAB DOORS & HANDLS	
224		TOP SHELF	
225		2ND "	
226		3RD "	
227		BENCH	
228		"	
229		"	
230		"	
231		BENCH	
232		UPPER WALL	
233		LOWER "	
234	✓	TOP SHELF	

Radiological Survey Continuation Sheet

Page 10 of 19

Date 10-23-07

No.	Time	Locations	See attached LSC printout for Total Activity (cpm/100 cm ²)
235	0700	BOTTOM SHELF	
236		UPPER WALL	
237		LOWER "	
238		WALL	
239		TABLE TOP	
240		" "	
241		" "	
242		" "	
243		" "	
244		PLASTIC TRAY	
245		BOTTLE	
246		FLOOR	
247		"	
248		"	
249		"	
250		"	
251		WALL	
252		"	
253		"	
254		"	
255		"	
256		UPPER WALL	
257		LOWER "	
258		UPPER DOOR	
259		LOWER DOOR	
260		FLOOR	
261	✓	SHELF	

Radiological Survey Continuation Sheet

Page 11 of 19

Date 10-23-09

No.	Time	Locations	See attached LSC printout for Total Activity (cpm/100 cm ²)
262	0700	BENCH	
263		RIGHT DRAWERS & HANDLES	
264		LEFT " "	
265		TOP RIGHT DRAWER	
266		2ND " "	
267		TOP LEFT "	
268		2ND " "	
		1ST BIG "	
270		2ND " "	
271		UPPER WALL	
272		LOWER " "	
273		UPPER " "	
274		LOWER " "	
275		TOP SHELF	
276		Bottom " "	
277		LEDGE	
278		WALL	
279		UPPER WALL	
280		LOWER " "	
281		FLOOR	
282		FLOOR	
283		" "	
284		" "	
285		" "	
286		" "	
287		" "	
		" "	

Radiological Survey Continuation Sheet

Page 12 of 19

Date 10-23-09

No.	Time	Locations	See attached LSC printout for Total Activity (cpm/100 cm ²)
289	6700	FLOOR	
290	↓	FLOOR	
291		FLOOR	
292		FLOOR	
293	1025	POOR ROOM ↑	
294	↓	" " △	
295			
296			
297			
298			
299			
300			
301			
302			
303			
304			
305			
306			
307			
308			
309			
310			
311			
312			
313			
314			
315			

dubs

Bld.118W W120

Date: 10-23-09

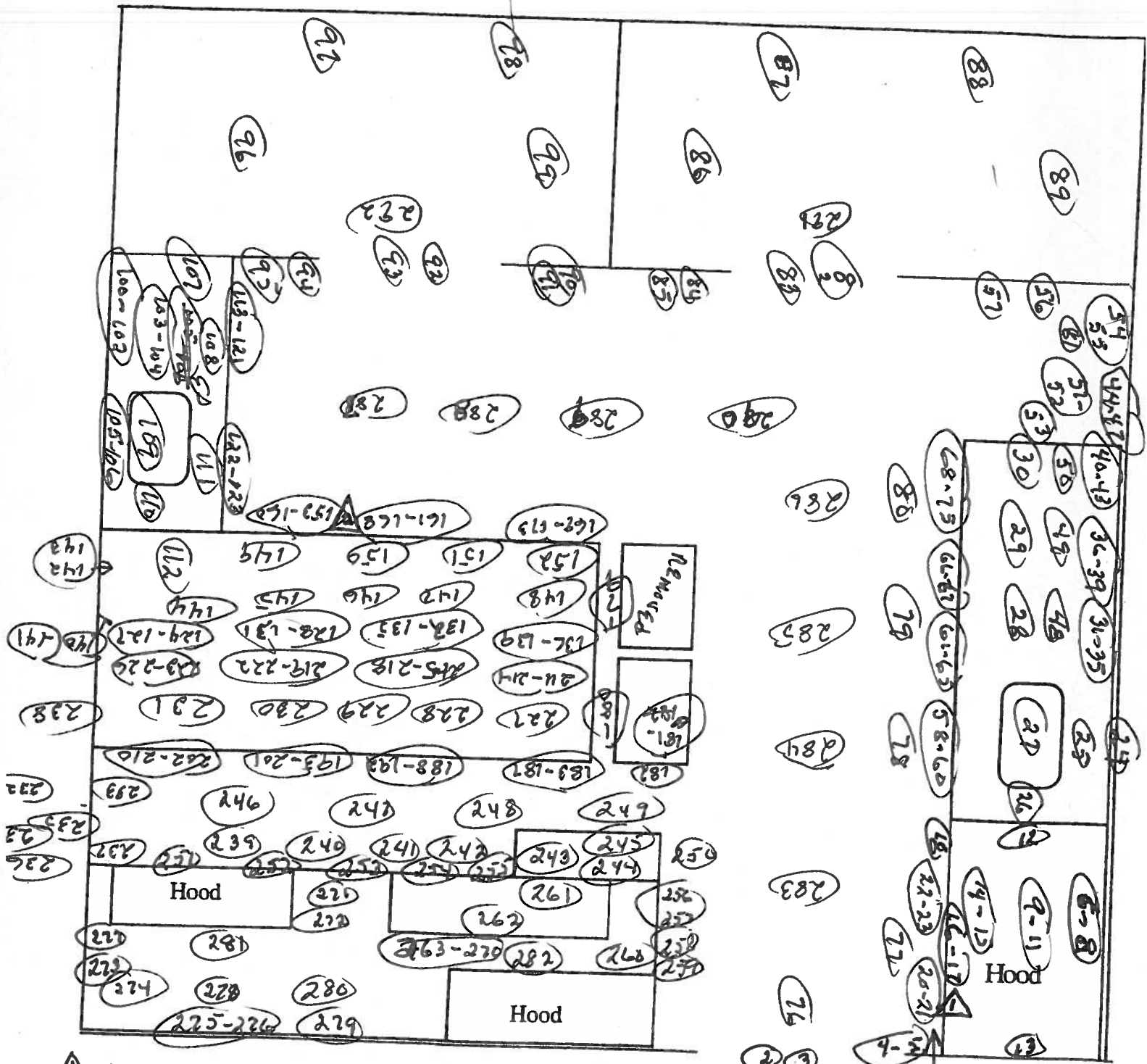

① 62,486 dpm/100cm² small spot on Hood lip. Discarded to ADIRAK
 BACKGROUND level. (C-14)

② Small spot on Floor 5, 357 dpm/100cm². Discarded to ADIRAK BACKGROUND level. (C-14)

Assay Definition-

Assay Description:
Equipment Swipes

Assay Type: CPM
Report Name: Report1
Output Data Path: C:\Packard\Tricarb\Results\Ed Gailor\Eds Monthly Swipes
Raw Results Path: C:\Packard\Tricarb\Results\Ed Gailor\Eds Monthly Swipes\20091023_1257
\20091023_1257.results
RTF File Name: C:\Packard\Tricarb\Results\Ed Gailor\Eds Monthly Swipes\Ed's Monthly Swipes.rtf
Assay File Name: C:\Packard\TriCarb\Assays\Eds Monthly Swipes.lsa

Count Conditions-

Nuclide: Triple
Quench Indicator: tSIE/AEC
External Std Terminator (sec): 0.5 2s%
Pre-Count Delay (min): 0.00
Quench Set: n/a
Count Time (min): 1.00
Count Mode: Normal
Assay Count Cycles: 1 Repeat Sample Count: 1
#Vials/Sample: 1 Calculate % Reference: Off

Background Subtract: On - Manual
Low CPM Threshold: Off
2 Sigma % Terminator: Off

Regions	LL	UL	Bkg Subtract
A	0.0	18.6	0.00
B	18.6	156.0	0.00
C	0.0	2000.0	0.00

Count Corrections-

Static Controller: On Luminescence Correction: On
Colored Samples: n/a Heterogeneity Monitor: n/a
Coincidence Time (nsec): 18 Delay Before Burst (nsec): 75

Half Life-

Half Life Correction: Off

Regions	Half Life	Units	Reference Date	Reference Time
A				
B				
C				

Cycle 1 Results

S#	CPMA	CPMB	CPMC	MESSAGES
1	<i>BL</i> 7	10	22	
2	6	17	26	
3	18	9	33	
4	8	7	20	
5	11	13	31	
6	15	9	34	
7	7	9	20	
8	17	6	25	
9	96	79	182	
10	40	13	60	

150819

Protocol# 4 - Eds Monthly Swipes.lsa

User: Ed Gailor

11	11	9	22
12	16	11	32
13	12	11	27
14	21	7	34
15	11	4	20
16	16	6	28
17	15	7	28
18	13	8	32
19	10	5	22
20	8	6	20
21	7	9	22
22	14	5	23
23	19	7	29
24	16	9	31
25	7	8	27
26	5	5	18
27	10	8	22
28	14	5	22
29	7	6	17
30	6	9	17
31	17	9	30
32	9	4	20
33	8	5	19
34	14	4	20
35	9	9	21
36	10	7	24
37	11	5	24
38	8	4	15
39	10	6	25
40	9	9	25
41	9	4	19
42	6	7	16
43	7	8	21
44	8	9	19
45	11	5	26
46	11	7	21
47	11	6	24
48	0	6	12
49	6	6	18
50	9	10	27
51	3	4	11
52	6	9	25
53	10	9	26
54	14	6	28
55	2	7	13
56	9	9	22
57	11	9	27
58	10	3	19
59	15	6	26
60	6	6	19
61	2	6	13
62	3	5	12
63	20	5	30
64	13	11	31
65	14	11	28
66	5	10	18
67	16	14	34
68	15	4	26
69	10	6	20
70	9	6	23
71	19	6	30
72	27	9	38

73	16	8	31
74	13	5	21
75	13	4	29
76	9	3	15
77	4	3	15
78	18	7	28
79	10	12	26
80	4	9	16
81	10	7	20
82	6	6	19
83	13	6	23
84	4	7	19
85	6	9	21
86	8	5	21
87	15	7	26
88	14	2	21
89	16	8	29
90	8	4	19
91	18	5	24
92	11	2	14
93	9	3	17
94	18	7	27
95	12	8	24
96	0	5	5
97	13	3	20
98	11	8	24
99	13	2	20
100	7	7	19
101	11	5	31
102	2	4	11
103	6	8	20
104	12	4	23
105	6	8	18
106	8	2	16
107	10	8	25
108	11	7	24
109	2	5	15
110	28	13	45
111	15	10	29
112	8	7	19
113	9	6	24
114	19	4	29
115	9	9	26
116	4	3	9
117	8	4	17
118	7	10	22
119	10	5	23
120	7	9	27
121	9	5	19
122	3	8	13
123	0	5	13
124	25	8	37
125	5	10	18
126	12	5	27
127	7	6	22
128	5	13	23
129	14	6	23
130	10	5	22
131	12	6	22
132	8	10	23
133	2	13	22
134	12	8	25
135	9	3	25

136	15	3	20
137	0	10	12
138	10	11	26
139	14	11	31
140	6	13	24
141	10	2	14
142	12	9	23
143	0	11	15
144	8	3	17
145	0	6	10
146	18	8	31
147	18	9	33
148	14	2	21
149	6	4	13
150	13	7	24
151	9	13	26
152	6	5	16
153	2	4	9
154	9	7	19
155	12	8	23
156	11	7	26
157	8	9	25
158	13	9	24
159	15	9	29
160	6	6	16
161	14	3	27
162	21	6	30
163	0	4	3
164	3	3	18
165	6	6	16
166	0	7	10
167	0	6	10
168	8	9	21
169	5	8	20
170	1	9	17
171	1	7	13
172	14	8	26
173	18	2	29
174	17	9	31
175	0	6	4
176	2	6	16
177	16	8	31
178	2	6	18
179	13	7	24
180	5	8	14
181	1	8	12
182	12	5	26
183	19	4	25
184	9	6	18
185	3	11	18
186	6	8	20
187	9	11	26
188	13	7	25
189	20	4	30
190	0	5	5
191	5	11	26
192	14	6	23
193	0	4	0
194	7	8	20
195	0	8	10
196	12	8	26
197	0	6	11
198	3	10	18

199	0	7	7
200	10	7	21
201	8	2	15
202	3	2	14
203	0	8	8
204	26	6	37
205	20	5	30
206	28	14	50
207	17	9	31
208	9	6	25
209	6	8	22
210	29	9	41
211	10	8	23
212	14	4	22
213	28	7	44
214	0	5	0
215	26	3	34
216	5	8	19
217	13	6	28
218	13	10	29
219	8	6	27
220	11	4	17
221	14	4	24
222	13	4	21
223	13	5	24
224	0	11	13
225	13	11	30
226	16	10	32
227	12	11	27
228	4	4	13
229	9	4	20
230	16	9	29
231	0	6	13
232	18	6	32
233	11	5	20
234	3	5	13
235	9	7	19
236	12	5	23
237	20	6	29
238	7	10	21
239	8	4	16
240	4	6	15
241	12	6	26
242	2	10	20
243	13	8	25
244	13	8	28
245	0	7	7
246	1	6	13
247	19	4	26
248	9	4	17
249	14	10	30
250	26	10	44
251	0	7	10
252	8	12	24
253	12	4	22
254	20	6	37
255	10	10	24
256	14	12	31
257	11	3	20
258	22	6	32
259	0	5	9
260	0	7	11
261	14	10	30

262	5	5	15
263	7	5	21
264	7	5	16
265	1	11	22
266	7	4	18
267	14	6	28
268	25	8	39
269	0	3	5
270	0	11	1
271	8	7	19
272	1	6	9
273	12	7	23
274	27	15	45
275	11	6	23
276	0	9	8
277	2	5	12
278	17	2	20
279	28	7	46
280	4	4	10
281	0	7	9
282	0	7	1
283	14	3	24
284	6	5	16
285	0	9	8
286	5	4	13
287	27	9	39
288	22	10	37
289	5	6	19
290	20	14	37
291	6	7	19
292	0	5	12

12	16	13	33	1
13	11	10	27	1
14	10	8	21	1
15	13	8	27	1
16	5	8	18	1
17	8	8	19	1
18	7	5	15	1
19	13	14	29	29
20	9	6	18	29
21	23	15	39	29
22	16	11	37	29
23	5	5	10	29
24	13	7	23	29
25	10	5	20	29
26	9	10	21	29
27	11	9	21	29
28	14	9	29	29
29	10	7	20	29
30	9	6	20	29
31	12	4	21	29

Missing vial 32.

33	16	8	26	29
34	8	6	18	29
35	13	7	26	29

Missing vial 36.

37	8	6	19	9
38	10	6	20	9
39	12	4	19	9
40	9	4	17	9
41	11	3	18	9
42	9	3	13	9
43	9	5	19	9
44	10	1	14	9
45	11	8	25	9
46	8	9	21	9
47	11	3	18	9
48	10	6	21	9
49	7	9	24	9
50	14	9	32	9
51	7	4	14	9
52	18	6	30	9
53	14	5	26	9

Missing vial 54.

55	7	5	18	28
56	19	7	29	28
57	15	6	24	28
58	16	8	29	28
59	20	7	31	28
60	18	1	20	28
61	44	24	72	28
62	19	9	29	28
63	10	3	18	28