

Radiological Survey Sheet

Job Location Pfizer, Inc. Groton, Ct. 06340 118W / W119 Page 1 11
 Survey Purpose ^{EA} Radiologic Survey of Equipment LAB DECSM N Date 12-19-12
 Performed by E. GAILOR E. Gailor
 (Print) (Sign)

| | | | | |
|------------------------|-----------------------------|-----------------------------|------------------------|-------------------------------|
| Instrument (Model/S/N) | Packard Tri-Carb S/N 431521 | Packard Tri-Carb S/N 431520 | Ludlum 2241-2 163603 | Wallac Model 1409 S/N 4061042 |
| Det. (Model/S/N) | Internal | Internal | Ludlum 43-68 PR 149613 | Internal |
| Type Rad. | β | β | β | β |
| Cal. Due: | 03/05/2013 | 03/05/2013 | 04/17/2013 | 09/15/2012 |
| Check Instruments Used | ✓ | | ✓ | |

| No. | Time | Locations | See attached LSC printout for Total Activity (cpm/100 cm ²) |
|-----|------|-----------------|---|
| 1. | 1230 | BACKGROUND | |
| 2. | | door | |
| 3. | | FLOOR | |
| 4. | | UPPER WALL | |
| 5. | | LOWER " | |
| 6. | | Hood RIGHT SIDE | |
| 7. | | " " BACK | |
| 8. | | " LEFT " | |
| 9. | | " " Side | |
| 10. | | " " Bottom | |
| 11. | | " MIDDLE " | |
| 12. | | " RIGHT " & CUP | |
| 13. | | " SASH | |
| 14. | | " RIGHT VENT | |
| 15. | | " LEFT " | |
| 16. | | " LIP | |
| 17. | | " OUTSIDE LEFT | |
| 18. | | " " RIGHT | |

Radiological Survey Continuation Sheet

Page 2 of 11

Date 12-19-12

| No. | Time | Locations | See attached LSC printout for Total Activity (cpm/100 cm ²) |
|-----|------|--------------|---|
| 19 | 1230 | CAD DOORS | |
| 20 | | " | |
| 21 | | INSIDE | |
| 22 | | DOORS | |
| 23 | | INSIDE | |
| 24 | | DOORS | |
| 25 | | TOP SHELF | |
| 26 | | " 2ND " | |
| 27 | | " 3RD " | |
| 28 | | DOORS | |
| 29 | | TOP SHELF | |
| 30 | | " 2ND " | |
| 31 | | " 3RD " | |
| 32 | | SIDE OF HOOD | |
| 33 | | SINK AREA | |
| 34 | | " DRAIN | |
| 35 | | BENCH | |
| 36 | | CAB DOORS | |
| 37 | | INSIDE CAB | |
| 38 | | TOP DRAW | |
| 39 | | 2ND " | |
| 40 | | 3RD " | |
| 41 | | 4TH " | |
| 42 | | CAB DOOR | |
| 43 | | " TOP SHELF | |
| 44 | | " 2ND " | |
| 45 | | " 3RD " | |
| 45 | | CAB DOORS | |

Radiological Survey Continuation Sheet

Page 3 of 11

Date 12-19-12

| No. | Time | Locations | See attached LSC printout for Total Activity (cpm/100 cm ²) |
|-----|------|---------------|---|
| 46 | 1230 | CAD TOP SHELF | |
| 47 | | " 2ND " | |
| 48 | | " 3RD " | |
| 49 | | " DOORS | |
| 50 | | " TOP SHELF | |
| 51 | | " 2ND " | |
| 52 | | " 3RD " | |
| 53 | | " DOORS | |
| 54 | | " TOP SHELF | |
| 55 | | " 2ND " | |
| 56 | | " 3RD " | |
| 57 | | " DOORS | |
| 58 | | " TOP SHELF | |
| 59 | | " 2ND " | |
| 60 | | " 3RD " | |
| 61 | | " DOOR | |
| 62 | | " TOP SHELF | |
| 63 | | " 2ND " | |
| 64 | | " 3RD " | |
| 65 | | " DOORS | |
| 66 | | " TOP SHELF | |
| 67 | | " BOTTOM " | |
| 68 | | WALL | |
| 69 | | CAD DOOR | |
| 70 | | " TOP SHELF | |
| 71 | | " 2ND " | |
| 72 | | " 3RD " | |

Radiological Survey Continuation Sheet

Page 4 of 11

Date 12-19-12

| No. | Time | Locations | See attached LSC printout for Total Activity (cpm/100 cm ²) |
|-----|------|----------------|---|
| 23 | 1230 | BENCH | |
| 24 | | " | |
| 25 | | " | |
| 26 | | " | |
| 77 | | TOP DRAW | |
| 78 | | 2ND " | |
| 79 | | 3RD " | |
| 80 | | 4TH " | |
| 81 | | UPPER WALL | |
| 82 | | LOWER " | |
| 83 | | WINDOW | |
| 84 | | DOOR | |
| 85 | | SHelves | |
| 86 | | " | |
| 87 | | CAB TOP & DRWS | |
| 88 | | " " " " | |
| 89 | | RADIATOR | |
| 90 | | DESK & DRWS | |
| 91 | | " " " | |
| 92 | | FLOOR | |
| 93 | | SHelves | |
| 94 | | " | |
| 95 | | WINDOW | |
| 96 | | UPPER WALL | |
| 97 | | LOWER WALL | |
| 98 | | FLOOR | |
| 99 | ✓ | UPPER WALL | |

Radiological Survey Continuation Sheet

Page 5 of 11

Date 12-19-12

| No. | Time | Locations | See attached LSC printout for Total Activity (cpm/100 cm ²) |
|-----|------|------------|---|
| 100 | 1230 | LOWER WALL | |
| 101 | | UPPER " | |
| 102 | | LOWER " | |
| 103 | | UPPER " | |
| 104 | | LOWER " | |
| 105 | | UPPER " | |
| 106 | | LOWER " | |
| 107 | | UPPER " | |
| 108 | | LOWER " | |
| 109 | | UPPER " | |
| 110 | | LOWER " | |
| 111 | | UPPER door | |
| 112 | | LOWER " | |
| 113 | | UPPER " | |
| 114 | | LOWER " | |
| 115 | | UPPER " | |
| 116 | | LOWER " | |
| 117 | | UPPER " | |
| 118 | | LOWER " | |
| 119 | | FLOOR | |
| 120 | | " | |
| 121 | | " | |
| 122 | | " | |
| 123 | | " | |
| 124 | | " | |
| 125 | | " | |
| 126 | | " | |

Radiological Survey Continuation Sheet

Page 6 of 11

Date 12-19-12

| No. | Time | Locations | See attached LSC printout for Total Activity (cpm/100 cm ²) |
|-----|-------|-----------|---|
| 127 | 1230 | FLOOR | |
| 128 | ↓ | 11 | |
| 129 | | 11 | |
| 130 | | 11 | |
| 131 | | 4 | |
| 132 | | 11 | |
| 133 | | 11 | |
| 134 | | 11 | |
| 135 | | 11 | |
| 136 | | 11 | |
| 137 | | 4 | |
| 138 | | 11 | |
| 139 | | 11 | |
| 140 | | 4 | |
| 141 | | 11 | |
| 142 | | 11 | |
| 143 | | 4 | |
| 144 | | 11 | |
| 145 | | 11 | |
| 146 | | 11 | |
| 147 | | 11 | |
| 148 | 11 | | |
| 149 | 11 | | |
| 150 | 11 | | |
| 151 | 11 | | |
| 152 | 11 | | |
| 153 | 4 | | |

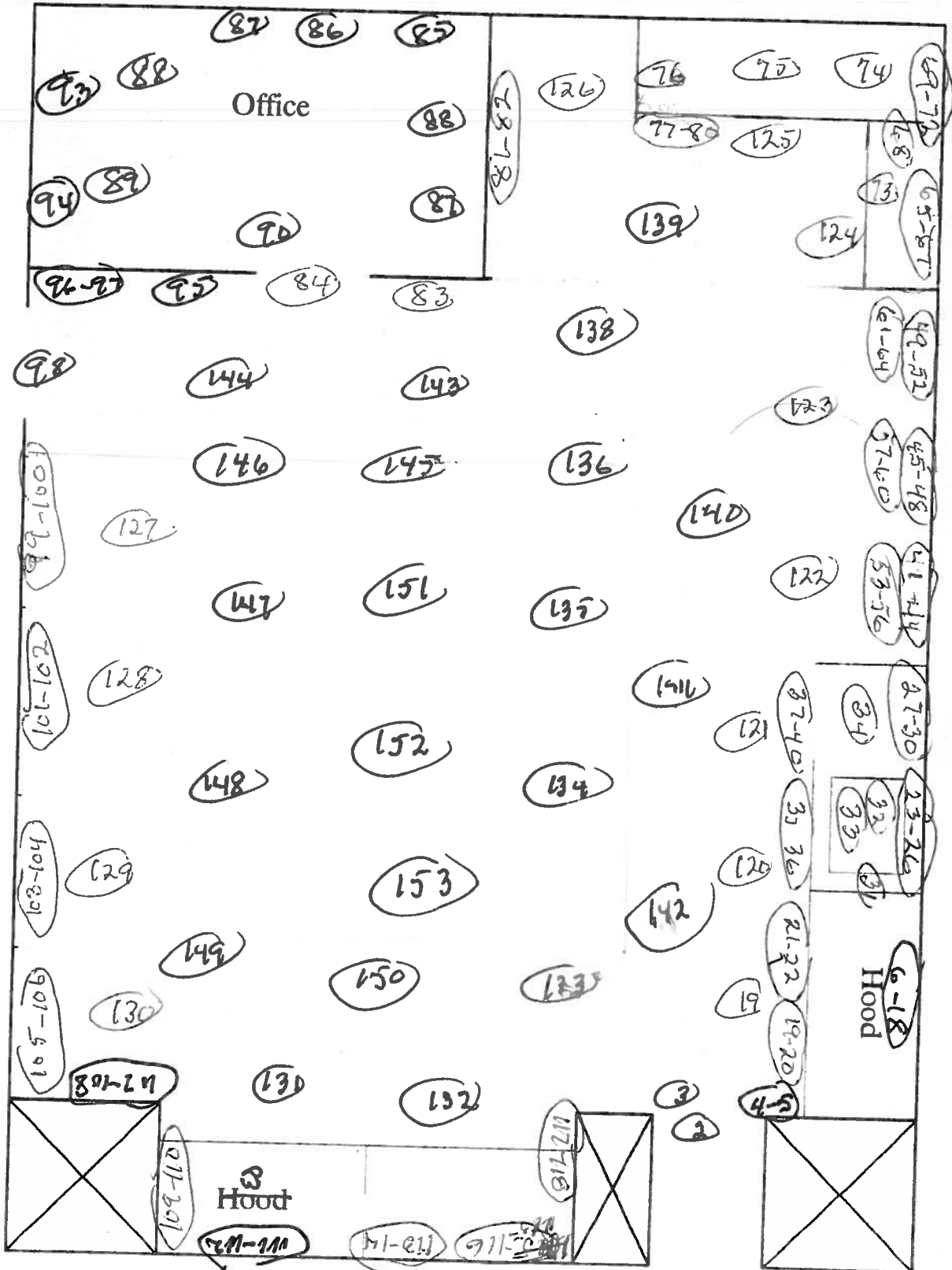

Surveyed 100% of lower surfaces using 4268. NO READINGS IN EX-15 OR NUMERICAL BACKGROUND LEVELS WERE OBSERVED.

O = WPA LOCATION

Assay Definition-

Assay Description:
Equipment Swipes

Assay Type: CPM
Report Name: Report1
Output Data Path: C:\Packard\Tricarb\Results\Ed Gailor\Eds Monthly Swipes
Raw Results Path: C:\Packard\Tricarb\Results\Ed Gailor\Eds Monthly Swipes\20121220_0550
\20121220_0550.results
RTF File Name: C:\Packard\Tricarb\Results\Ed Gailor\Eds Monthly Swipes\Ed's Monthly
Swipes.rtf
Assay File Name: C:\Packard\TriCarb\Assays\Eds Monthly Swipes.lsa

Count Conditions-

Nuclide: Triple
Quench Indicator: tSIE/AEC
External Std Terminator (sec): 5 sec
Pre-Count Delay (min): 0.00
Quench Set: n/a
Count Time (min): 1.00
Count Mode: Normal
Assay Count Cycles: 1 Repeat Sample Count: 1
#Vials/Sample: 1 Calculate % Reference: Off

Background Subtract: On - Manual
Low CPM Threshold: Off
2 Sigma % Terminator: Off

| Regions | LL | UL | Bkg Subtract |
|---------|------|--------|--------------|
| A | 0.0 | 18.6 | 0.00 |
| B | 18.6 | 156.0 | 0.00 |
| C | 0.0 | 2000.0 | 0.00 |

Count Corrections-

Static Controller: On Luminescence Correction: On
Colored Samples: n/a Heterogeneity Monitor: n/a
Coincidence Time (nsec): 18 Delay Before Burst (nsec): 75

Half Life-

Half Life Correction: Off

| Regions | Half Life | Units | Reference Date | Reference Time |
|---------|-----------|-------|----------------|----------------|
| A | | | | |
| B | | | | |
| C | | | | |

Cycle 1 Results

| S# | CPMA | CPMB | CPMC | MESSAGES |
|----|------|------|------|----------|
| 1 | 8 | 6 | 15 | |
| 2 | 10 | 5 | 22 | |
| 3 | 12 | 11 | 28 | |
| 4 | 11 | 8 | 22 | |
| 5 | 6 | 5 | 15 | |
| 6 | 14 | 5 | 26 | |
| 7 | 7 | 4 | 16 | |
| 8 | 7 | 6 | 15 | |
| 9 | 7 | 6 | 18 | |
| 10 | 6 | 7 | 17 | |

| | | | |
|----|----|----|----|
| 11 | 14 | 8 | 25 |
| 12 | 11 | 5 | 20 |
| 13 | 8 | 8 | 17 |
| 14 | 18 | 3 | 24 |
| 15 | 9 | 13 | 26 |
| 16 | 3 | 3 | 8 |
| 17 | 10 | 3 | 13 |
| 18 | 10 | 2 | 13 |
| 19 | 9 | 9 | 23 |
| 20 | 6 | 7 | 17 |
| 21 | 13 | 8 | 30 |
| 22 | 14 | 6 | 26 |
| 23 | 12 | 9 | 23 |
| 24 | 7 | 3 | 13 |
| 25 | 11 | 9 | 22 |
| 26 | 18 | 8 | 29 |
| 27 | 9 | 7 | 20 |
| 28 | 17 | 4 | 23 |
| 29 | 6 | 6 | 18 |
| 30 | 5 | 6 | 19 |
| 31 | 14 | 6 | 28 |
| 32 | 13 | 7 | 27 |
| 33 | 9 | 5 | 22 |
| 34 | 10 | 7 | 22 |
| 35 | 9 | 9 | 22 |
| 36 | 11 | 4 | 19 |
| 37 | 5 | 5 | 17 |
| 38 | 6 | 3 | 11 |
| 39 | 1 | 9 | 18 |
| 40 | 7 | 12 | 26 |
| 41 | 15 | 5 | 26 |
| 42 | 16 | 7 | 30 |
| 43 | 10 | 13 | 26 |
| 44 | 9 | 7 | 18 |
| 45 | 6 | 7 | 18 |
| 46 | 12 | 6 | 25 |
| 47 | 10 | 5 | 18 |
| 48 | 12 | 8 | 27 |
| 49 | 11 | 6 | 27 |
| 50 | 6 | 6 | 17 |
| 51 | 12 | 15 | 34 |
| 52 | 21 | 8 | 33 |
| 53 | 11 | 5 | 17 |
| 54 | 6 | 4 | 15 |
| 55 | 5 | 8 | 20 |
| 56 | 10 | 6 | 19 |
| 57 | 8 | 6 | 22 |
| 58 | 6 | 8 | 18 |
| 59 | 9 | 7 | 19 |
| 60 | 9 | 7 | 24 |
| 61 | 14 | 3 | 20 |
| 62 | 8 | 8 | 20 |
| 63 | 14 | 6 | 25 |
| 64 | 8 | 10 | 20 |
| 65 | 11 | 2 | 16 |
| 66 | 17 | 9 | 33 |
| 67 | 12 | 5 | 23 |
| 68 | 7 | 10 | 24 |
| 69 | 18 | 4 | 27 |
| 70 | 14 | 5 | 22 |
| 71 | 8 | 5 | 13 |
| 72 | 17 | 4 | 25 |
| 73 | 10 | 3 | 22 |

| | | | |
|-----|----|----|----|
| 74 | 19 | 2 | 25 |
| 75 | 12 | 8 | 26 |
| 76 | 8 | 7 | 17 |
| 77 | 8 | 11 | 21 |
| 78 | 8 | 7 | 18 |
| 79 | 11 | 4 | 19 |
| 80 | 12 | 2 | 20 |
| 81 | 15 | 9 | 28 |
| 82 | 11 | 4 | 17 |
| 83 | 11 | 4 | 22 |
| 84 | 15 | 4 | 23 |
| 85 | 8 | 5 | 20 |
| 86 | 9 | 6 | 21 |
| 87 | 9 | 7 | 22 |
| 88 | 12 | 12 | 27 |
| 89 | 12 | 8 | 27 |
| 90 | 12 | 8 | 23 |
| 91 | 11 | 5 | 19 |
| 92 | 10 | 6 | 20 |
| 93 | 11 | 4 | 20 |
| 94 | 8 | 7 | 19 |
| 95 | 6 | 8 | 15 |
| 96 | 15 | 5 | 26 |
| 97 | 10 | 9 | 23 |
| 98 | 19 | 8 | 30 |
| 99 | 8 | 5 | 18 |
| 100 | 11 | 6 | 22 |
| 101 | 14 | 6 | 26 |
| 102 | 11 | 5 | 18 |
| 103 | 8 | 6 | 17 |
| 104 | 8 | 6 | 17 |
| 105 | 6 | 2 | 13 |
| 106 | 11 | 5 | 20 |
| 107 | 12 | 8 | 22 |
| 108 | 6 | 4 | 15 |
| 109 | 14 | 6 | 25 |
| 110 | 11 | 6 | 21 |
| 111 | 13 | 7 | 27 |
| 112 | 7 | 6 | 15 |
| 113 | 17 | 4 | 24 |
| 114 | 10 | 9 | 24 |
| 115 | 15 | 9 | 28 |
| 116 | 14 | 3 | 19 |
| 117 | 13 | 14 | 34 |
| 118 | 6 | 7 | 19 |
| 119 | 7 | 6 | 16 |
| 120 | 12 | 13 | 30 |
| 121 | 7 | 7 | 19 |
| 122 | 9 | 6 | 22 |
| 123 | 11 | 9 | 21 |
| 124 | 8 | 11 | 24 |
| 125 | 11 | 5 | 22 |
| 126 | 10 | 9 | 23 |
| 127 | 14 | 4 | 25 |
| 128 | 4 | 5 | 12 |
| 129 | 8 | 5 | 18 |
| 130 | 6 | 5 | 15 |
| 131 | 9 | 7 | 19 |
| 132 | 14 | 6 | 26 |
| 133 | 12 | 5 | 19 |
| 134 | 8 | 5 | 20 |
| 135 | 8 | 9 | 20 |
| 136 | 13 | 21 | 39 |

Protocol# 4 - Eds Monthly Swipes.lsa

User: Ed Gallor

| | | | |
|-----|----|----|----|
| 137 | 18 | 3 | 24 |
| 138 | 6 | 8 | 23 |
| 139 | 14 | 5 | 24 |
| 140 | 9 | 7 | 18 |
| 141 | 18 | 7 | 29 |
| 142 | 9 | 8 | 20 |
| 143 | 17 | 7 | 30 |
| 144 | 9 | 10 | 27 |
| 145 | 10 | 4 | 19 |
| 146 | 10 | 5 | 19 |
| 147 | 10 | 4 | 20 |
| 148 | 7 | 15 | 31 |
| 149 | 11 | 4 | 20 |
| 150 | 10 | 5 | 17 |
| 151 | 17 | 2 | 24 |
| 152 | 10 | 6 | 22 |
| 153 | 12 | 3 | 16 |