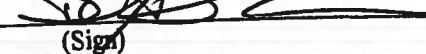

Radiological Survey Sheet

Job Location PFIZER INC GROTON CT. Page 1 of 20

Survey Purpose RADIOLOGICAL ASSESSMENT W117 Date 11/29/99

Performed By DAVID J. DUKET (Print)  (Sign)

Inst.(1) (Model/SN) Packard 2500 TR #405100	Inst.(2) Ludlum # 2241-2 (Model/SN) #157751	Inst.(3) (Model/SN)
Det. Internal (Model/SN)	Det. Ludlum model 43-65 (Model/SN) #140089	Det. (Model/SN)
Eff. H-3 (27% - 47%) C-14/P-32 (78% - 83%)	Eff. \approx 8% C-14	Eff.
Type rad. β	Type rad. β	Type rad.
Bkgd. See #1 below	Bkgd. 250 cpm	Bkgd.
Cal. Due: 2/2000	Cal. Due 4/00	Cal. due

No.	Time	Location	Inst. Used	Total Activity (dpm/100 cm ²)	Comments
1.	1310	BACKGROUN	1	30 cpm	
2.		FRONT OF CABINET	1	18	
3.		TOP shelf	1	0	
4.		Shelf	1	10	
5.		Shelf	1	0	
6.		Bottom shelf	1	8	
7.		front of cabinet	1	27	
8.		Top Shelf	1	2	
9.		shelf	1	0	
10.		shelf	1	12	
11.		Bottom shelf	1	13	
12.		ledge	1	24	
13.		uplink	1	0	
14.		upper wall	1	0	
15.		lower wall	1	0	
16.		Desk top	1	9	
17.		Shelf on floor	1	0	
18.	↓	Desk top	1	0	

Radiological Survey Continuation Sheet

Page 2 of 20

Date 11/29/99

No.	Time	Location	Inst. Used	Total Activity (dpm/100 cm ²)	Comments
19		shelves	1	0	
20		Blue chair	1	0	
21		WALL	1	6	
22		FRONT OF Drawers	1	0	
23		TOP Drawer	1	2	
24		MIDDLE DRAWER	1	0	
25		Bottom drawer	1	0	
26		Drawer	1	0	
27		wooden box	1	9	
28		counter	1	0	
29		counter	1	17	
30		counter	1	22	
31		Bottom shelf	1	0	
32		Shelf	1	0	
33		Top shelf	1	9	
34		Bottom shelf	1	0	
35		Shelf	1	16	
36		top shelf	1	1	
37		Bottom shelf	1	0	
38		Shelf	1	0	
39		top shelf	1	2	
40		white plastic container	1	0	
41		green " "	1	11	
42		Front of drawers	1	0	
43		top drawer	1	4	
44		drawer	1	0	
45		drawer	1	37	
46	✓	bottom drawer	1	0	

Radiological Survey Continuation Sheet

Page 3 of 20

Date 11/29/99

No.	Time	Location	Inst. Used	Total Activity (dpm/100 cm ²)	Comments
47		Denner	1	0	
48		Front of drawers	1	15	
49		top right drawer	1	0	
50		" left drawer	1	0	
51		drawer	1	6	
52		drawer	1	0	
53		bottom drawer	1	0	
54		Front of drawers	1	0	
55		top left drawer	1	12	
56		top right "	1	0	
57		2nd left "	1	0	
58		2nd right "	1	6	
59		drawer	1	12	
60		bottom drawer	1	0	
61		end of cabinets	1	20	
62		wall	1	4	
63		"	1	9	
64		"	1	1	
65		"	1	26	
66		Filing cabinet	1	37	
67		side of cabinet	1	0	
68		counter	1	0	
69		wall	1	5	
70		Front of cabinet	1	18	
71		drawer (top)	1	0	
72		drawer	1	0	
73		cabinet	1	0	
74	✓	ble chair	1	0	

Radiological Survey Continuation Sheet

Page 4 of 20

Date 11/25/99

No.	Time	Location	Inst. Used	Total Activity (dpm/100 cm ²)	Comments
75		metal block	1	28	
76		wall	1	0	
77		door	1	0	
78		Floor	1	0	
79		Floor	1	29	
80		Floor	1	12	
81		Floor	1	0	
82		Floor	1	21	
83		Floor	1	20	
84		Floor	1	0	
85		Floor	1	0	
86		wall	1	0	
87		LEFT FRONT HOOD	1	0	
88		TOP FRONT HOOD	1	0	
89		RIGHT " "	1	0	
90		Hood ledge	1	0	
91		" sash	1	0	
92		counter left	1	16	
93		cup sink	1	2	
94		counter right	1	21	
95		^{left} Right side	1	5	
96		Back top	1	0	
97		Back Bottom	1	18	
98		Right side	1	16	
99		Behind panel	1	0	
100		vent	1	27	
101		Front of cabinet	1	0	
102		inside cabinet	1	0	

Radiological Survey Continuation Sheet

Page 5 of 20

Date 11/21/99

No.	Time	Location	Inst. Used	Total Activity (dpm/100 cm ²)	Comments
103		cabinet door	1	37	
104		inside cabinet	1	0	
105		shelf	1	1	
106		wall unit doors	1	13	
107		Top shelf	1	16	
108		shelf	1	0	
109		shelf	1	0	
110		bottom shelf	1	0	
111		counter	1	0	
112		wall	1	29	
113		Sink	1	2	
114		counter	1	0	
115		wall	1	0	
116		front of cabinet	1	16	
117		inside cabinet	1	17	
118		front of drawers	1	0	
119		top drawer	1	0	
120		drawer	1	0	
121		drawer	1	0	
122		bottom drawer	1	2	
123		foot stool	1	10	
124		freezer shelf	1	0	
125		side of cabinet	1	2	
126		front of cabinet	1	28	
127		inside cabinet	1	12	
128		cabinet counter	1	0	
129		wall	1	2	
130	✓	wall	1	27	

Radiological Survey Continuation Sheet

Page 6 of 20

Date 11/29/99

No.	Time	Location	Inst. Used	Total Activity (dpm/100 cm ²)	Comments
131		Door	1	0	
132		wmi	1	18	
133		plastic tray	1	11	
134		wall	1	35	
135		Floor	1	10	
136		Floor	1	1	
137		Floor	1	1	
138		Floor	1	0	
139		Floor	1	0	
140		Floor	1	0	
141		Floor	1	0	
142		Small Blue chair	1	0	
143		Big Blue chair	1	0	
144		lower wall	1	21	
145		ledge	1	0	
146		cup sink	1	0	
147		upper wall	1	0	
148		wall unit doors	1	10	
149		top shelf	1	20	
150		shelf	1	0	
151		shelf	1	0	
152		Bottom shelf	1	0	
153		wall unit doors	1	2	
154		top shelf	1	0	
155		shelf	1	0	
156		shelf	1	0	
157		Bottom shelf	1	6	
158		wall unit doors	1	0	

Radiological Survey Continuation Sheet

Page 7 of 20Date 11/29/99

No.	Time	Location	Inst. Used	Total Activity (dpm/100 cm ²)	Comments
159		TOP shelf	1	10	
160		Shelf	1	28	
161		Shelf	1	0	
162		Bottom shelf	1	22	
163		Sidles	1	0	
164		Desk	1	0	
165		Front of drawers	1	2	
166		top drawer	1	18	
167		Drawer	1	0	
168		bottom drawer	1	0	
169		drawer	1	1	
170		Desk	1	0	
171		Sidles	1	0	
172		Front of drawers	1	30	
173		Top drawer	1	0	
174		drawer	1	0	
175		Bottom drawer	1	0	
176		drawer	1	0	
177		Front of drawers	1	0	
178		top drawer	1	11	
179		drawer	1	0	
180		drawer	1	9	
181		bottom drawer	1	1	
182		drawer	1	0	
183		Front of drawers	1	6	
184		top left	1	4	
185		top right	1	0	
186	✓	2nd left	1	6	

Radiological Survey Continuation Sheet

Page 8 of 20

Date 11/29/99

No.	Time	Location	Inst. Used	Total Activity (dpm/100 cm ²)	Comments
187		2nd right drawer	1	17	
188		drawer	1	0	
189		bottom drawer	1	6	
190		front of drawers	1	0	
191		top left	1	0	
192		top right	1	0	
193		2nd left	1	28	
194		2nd right	1	0	
195		drawer	1	24	
196		bottom drawer	1	0	
197		cup sink	1	0	
198		" "	1	0	
199		counter	1	0	
200		center	1	0	
201		center	1	10	
202		front of cabinet	1	0	
203		top drawer	1	0	
204		drawer	1	10	
205		drawer	1	16	
206		bottom drawer	1	12	
207		drawer	1	35	
208		front of drawers	1	32	
209		top drawer	1	1	
210		drawer	1	0	
211		drawer	1	0	
212		bottom drawer	1	0	
213		the chair	1	0	
214	↓	front of drawers	1	0	

Radiological Survey Continuation Sheet

Page 9 of 20

Date 11/29/99

No.	Time	Location	Inst. Used	Total Activity (dpm/100 cm ²)	Comments
215		TOP DRAWER	1	17	
216		DRAWER	1	0	
217		DRAWER	1	0	
218		BOTTOM DRAWER	1	17	
219		SIDE OF CABINET	1	17	
220		COUNTER	1	0	
221		"	1	0	
222		"	1	24	
223		QUADRA 96SU	1	0	
224		" "	1	0	
225		" "	1	0	
226		TON TECH	1	0	
227		" "	1	0	
228		MASTERPIEZ	1	10	
229		LAPTOP	1	6	
230		BOTTOM shelf	1	0	
231		MID shelf	1	0	
232		TOP shelf	1	4	
233		Bottom "	1	24	
234		mid "	1	22	
235		TOP "	1	0	
236		Bottom "	1	0	
237		mid "	1	5	
238		TOP "	1	48	(see # 299)
239		Bottom shelf	1	29	
240		mid "	1	0	
241		TOP "	1	0	
242	✓	Blue kb-chest	1	0	

Radiological Survey Continuation Sheet

Page 10 of 20

Date 11/29/99

No.	Time	Location	Inst. Used	Total Activity (dpm/100 cm ²)	Comments
243		Cup Sink	1	0	
244		Counter	1	18	
245		Counter	1	0	
246		Counter	1	0	
247		Cup Sink	1	0	
248		Desk	1	0	
249		Shelves	1	0	
250		Ledge	1	0	
251		wall unit door	1	10	
252		top shelf	1	0	
253		Shelf	1	0	
254		Shelf	1	0	
255		Bottom shelf	1	0	
256		Wall	1	17	
257		Door	1	13	
258		Wall	1	0	
259		Shelves	1	0	
260		Tric Chair	1	35	
261		FRONT OF DRAWERS	1	0	
262		top drawer	1	2	
263		Drawer	1	4	
264		Bottom drawer	1	0	
265		Drawer	1	0	
266		Front of Drawers	1	0	
267		TOP Drawer	1	0	
268		Drawer	1	0	
269		Drawer	1	0	
270	✓	Bottom Drawer	1	0	

Radiological Survey Continuation Sheet

Page 11 of 20

Date 11/29/99

No.	Time	Location	Inst. Used	Total Activity (dpm/100 cm ²)	Comments
271		DEAMER	1	0	
272		FRONT OF DEAMER	1	27	
273		TOP DEAMER	1	13	
274		DEAMER	1	0	
275		DEAMER	1	0	
276		BOTTOM DEAMER	1	5	
277		DEAMER	1	16	
278		FRONT OF DEAMER	1	35	
279		TOP DEAMER	1	15	
280		DEAMER	1	13	
281		DEAMER	1	10	
282		BOTTOM DEAMER	1	0	
283		SIDE OF CABINET	1	11	
284		FLOOR	1	20	
285		"	1	24	
286		"	1	0	
287		"	1	10	
288		Blue lab chair	1	0	
289		Desk	1	18	
290		"	1	29	
291		Floor	1	9	
292		"	1	15	
293		Placemat shield	1	32	
294		Desk	1	0	
295		Floor	1	0	
296		Floor	1	7	
297		Desk	1	20	
298	✓	Stools	1	24	
299	1225	Post Room # 238	1	6	

11/30/99

Bld. 118W Room W117

Date: 1/29/99

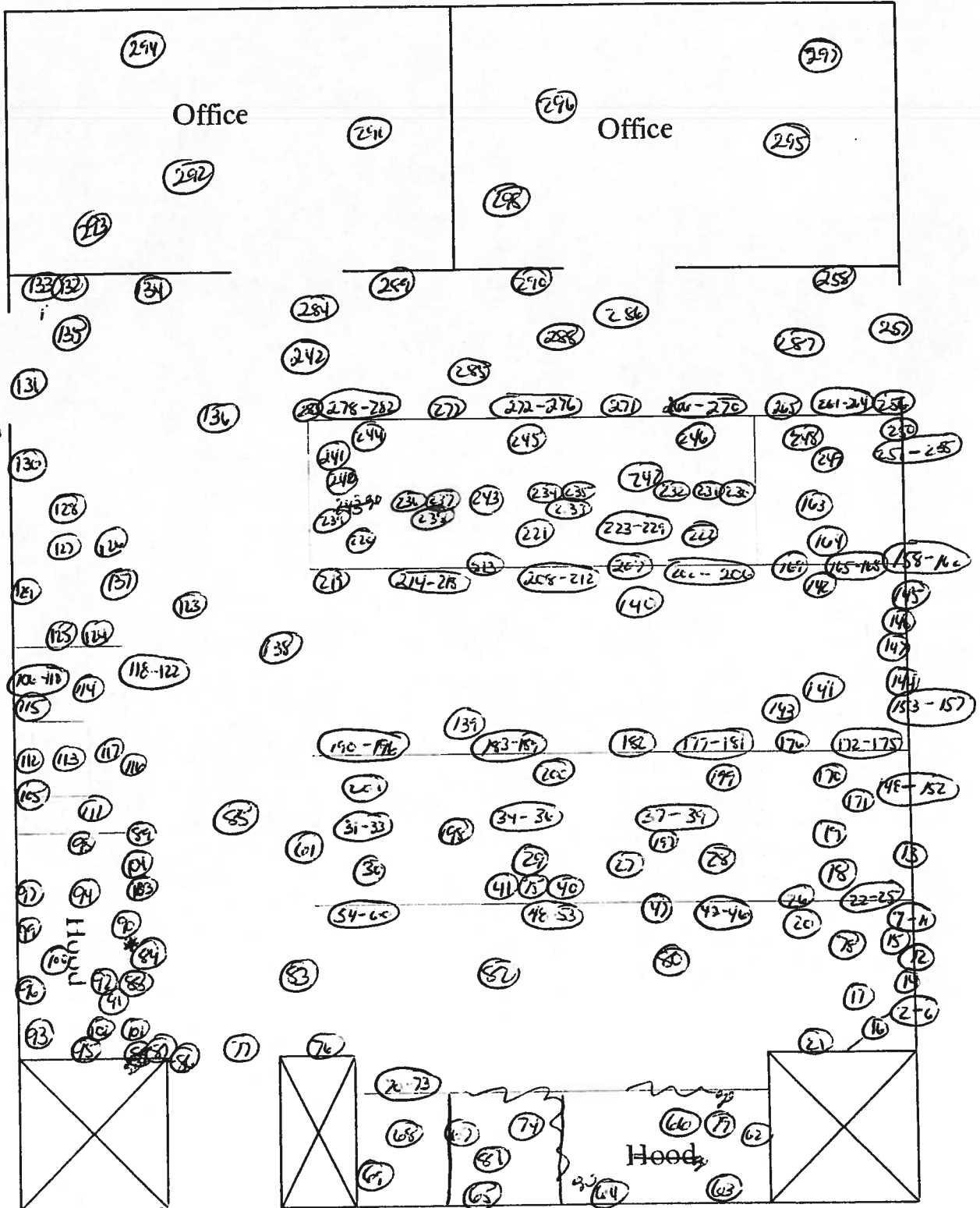

5571 cpm
 136 (old pm/accnt)
 139
 in Lip of Hood:
 Counter. Decoupled
 to normal background
 levels.

Scanned 100% of lower
 surfaces using inst # 2.
 All areas surveyed
 were noted to be at
 normal background
 levels with the ONE
 exception noted HERE.

29 Nov 1999 17:15

TRI-CARB - 1.09

Protocol #:27

rad safety dept

User :

Time: 1.00

Data Mode: CPM

Mode: MANUAL

Background Substrate 1st Vial

	LL	UL	LOF	25%	BKG
Region A:	0.0 - 16.4	0	0.0	16.42	
Region B:	16.4 - 134	0	0.0	7.12	
Region C:	0.0 - 2000	0	0.0	30.10	

Queue Indicator: tSIE/AEC

Ext Std Terminator: Count

Luminescence Correction On

Coincidence Time(ns): 0

Delay Before Burst(ns): 0

S#	TIME	CPMA	CPMB	CPMC	SIS	tSIE	LUM	FLAG
1	10.00	16.48	7.12	30.10	8.988	507.50	84	B
2	1.00	13.52	0.00	13.90	0.000	490.69	78	
3	1.00	0.00	0.00	0.00	0.000	510.53	100	
4	1.00	3.52	1.88	7.90	11.991	514.77	86	
5	1.00	0.00	2.00	0.00	0.000	515.85	100	
6	1.00	7.89	0.00	6.90	20.611	500.61	82	
7	1.00	23.49	0.00	21.90	10.432	518.99	76	
8	1.00	6.52	0.00	1.90	0.000	506.23	90	
9	1.00	0.00	0.00	0.00	0.000	505.46	100	
10	1.00	12.14	0.00	9.90	0.887	508.02	85	
11	1.00	5.52	3.88	10.90	7.951	489.47	84	
12	1.00	18.57	3.88	19.90	4.361	401.50	84	
13	1.00	0.00	0.00	0.00	1.131	474.03	94	
14	1.00	0.00	0.00	0.00	0.000	476.94	92	
15	1.00	0.00	0.39	0.00	2.418	504.15	96	
16	1.00	8.52	0.00	6.90	0.000	484.74	67	
17	1.00	0.00	2.88	0.00	0.000	478.38	99	
18	1.00	0.00	1.21	0.00	7.249	479.90	100	
19	1.00	2.52	0.00	0.00	0.000	480.24	87	
20	1.00	0.00	0.00	0.00	0.000	457.18	97	
21	1.00	12.52	0.00	4.90	5.032	481.05	83	
22	1.00	0.00	0.00	0.00	0.000	506.19	94	
23	1.00	0.00	4.88	1.90	7.939	482.30	89	
24	1.00	0.00	0.00	0.00	3.868	463.42	100	
25	1.00	0.00	0.00	0.00	0.000	498.28	96	
26	1.00	0.00	0.00	0.00	0.000	496.79	100	
27	1.00	16.52	1.88	39.90	7.357	486.87	73	
28	1.00	0.00	0.00	0.00	0.000	481.49	95	
29	1.00	13.52	0.88	13.90	0.000	474.12	73	
30	1.00	18.57	0.00	17.90	1.261	509.43	81	
31	1.00	2.52	0.00	0.00	0.000	507.19	87	
32	1.00	0.00	0.00	0.00	0.546	422.16	95	
33	1.00	8.52	0.00	6.90	2.125	448.84	88	
34	1.00	6.52	0.00	0.00	0.000	495.44	87	
35	1.00	16.52	0.00	12.90	0.000	303.80	82	
36	1.00	0.52	0.00	0.90	3.210	423.68	94	
37	1.00	0.00	3.88	0.00	12.325	461.39	93	
38	1.00	0.00	0.88	0.00	5.243	415.27	93	
39	1.00	0.00	3.86	1.90	2.012	327.57	94	
40	1.00	0.00	3.88	0.00	19.670	493.83	89	

re analyzed

S#	TIME	CPMA	CPMB	CPMC	SIS	tSIE	LUM	FLAG
41	1.00	8.23	0.00	8.90	1.903	481.09	85	
42	1.00	0.00	0.00	0.00	0.000	498.17	100	
43	1.00	0.52	0.00	2.90	0.000	476.85	86	
44	1.00	0.00	0.00	0.00	0.000	470.82	95	
45	1.00	32.25	2.15	30.90	20.538	500.52	70	✓
46	1.00	0.00	0.00	0.00	5.378	483.61	96	
47	1.00	0.00	3.10	0.00	35.181	486.53	96	
48	1.00	12.52	0.88	11.90	0.000	445.45	82	
49	1.00	0.00	0.00	0.00	0.000	483.89	96	
50	1.00	0.00	0.00	0.00	0.000	486.24	92	
51	1.00	7.52	0.32	4.90	13.196	460.47	85	
52	1.00	0.00	5.79	0.00	20.574	433.40	88	
53	1.00	0.00	0.00	0.00	0.000	404.50	100	
54	1.00	0.00	0.88	0.00	1.815	478.91	99	
55	1.00	10.66	4.74	9.90	29.214	493.81	78	
56	1.00	0.00	2.88	0.00	10.065	485.11	89	
57	1.00	2.52	0.00	0.00	2.765	491.15	96	
58	1.00	1.06	2.23	4.90	0.000	476.14	81	
59	1.00	12.52	0.00	9.90	0.000	468.17	82	
60	1.00	0.00	0.00	0.00	0.000	462.39	97	
61	1.00	16.52	0.00	15.90	3.440	481.79	77	
62	1.00	3.52	0.00	2.90	5.436	465.42	89	
63	1.00	7.42	0.98	6.90	19.615	486.67	84	
64	1.00	0.00	0.00	0.90	0.000	477.38	89	
65	1.00	19.52	3.88	20.90	12.412	429.27	78	
66	1.00	31.52	0.00	29.90	3.769	474.37	75	
67	1.00	0.00	0.00	0.00	0.000	473.36	97	
68	1.00	0.00	1.88	0.00	0.000	368.78	100	
69	1.00	9.52	0.00	3.90	0.000	479.15	82	
70	1.00	18.52	0.00	14.90	1.298	492.81	80	
71	1.00	0.00	0.00	0.00	3.683	449.25	100	
72	1.00	34.52	0.00	33.90	4.784	456.32	77	✓ reanalyzed
73	1.00	0.00	0.00	0.00	0.000	480.62	95	
74	1.00	0.00	0.88	0.00	3.976	457.16	92	
75	1.00	21.52	0.00	22.90	0.389	448.02	80	
76	1.00	0.24	0.00	0.00	0.000	481.33	89	
77	1.00	0.00	0.00	0.00	6.663	481.37	100	
78	1.00	0.00	3.70	0.00	9.643	465.57	88	
79	1.00	20.52	1.88	23.90	22.953	463.18	75	
80	1.00	54.52	3.88	61.90	5.365	432.18	76	✓ reanalyzed
81	1.00	0.00	2.07	0.00	0.000	395.39	96	
82	1.00	17.52	1.88	16.90	2.651	424.75	77	
83	1.00	10.52	1.88	15.90	1.863	442.51	80	
84	1.00	4.52	0.00	0.00	0.000	454.14	90	
85	1.00	0.00	2.88	0.00	12.352	438.56	92	
86	1.00	32.52	0.00	31.90	0.000	411.69	72	✓ reanalyzed
87	1.00	0.00	0.00	0.00	5.431	459.14	100	
88	1.00	0.00	0.00	0.00	0.000	468.07	100	
89	1.00	0.00	3.88	0.00	16.746	498.72	95	
90	1.00	0.00	0.00	0.00	0.000	476.56	84	
91	1.00	0.00	0.00	0.00	0.000	488.12	100	
92	1.00	8.52	4.88	12.90	0.000	466.34	73	
93	1.00	0.00	6.88	1.90	0.000	443.26	78	

S#	TIME	CPMA	CPMB	CPMC	SIS	tSIE	LUM	FLAG
94	1.00	10.52	3.88	16.90	0.000	446.24	80	

97	1.00	15.52	0.00	14.90	0.000	462.04	74
98	1.00	8.52	0.00	12.90	0.000	469.27	77
99	1.00	0.00	0.00	0.00	0.000	470.76	90
100	1.00	20.52	1.88	21.90	8.009	398.37	77
101	1.00	0.00	2.88	0.00	5.966	395.10	94
102	1.00	0.00	0.00	0.00	0.000	458.14	100
103	1.00	31.52	1.88	29.90	0.000	481.25	64
104	1.00	0.00	2.88	0.00	6.020	352.80	88
105	1.00	3.52	0.00	0.90	0.000	431.30	87
106	1.00	11.52	1.88	10.90	39.243	469.01	79
107	1.00	11.73	1.67	12.90	0.000	492.74	78
108	1.00	0.00	4.88	0.00	71.361	471.02	100
109	1.00	0.00	0.00	0.00	0.000	488.85	95
110	1.00	0.00	0.00	0.00	0.000	453.28	94
111	1.00	0.00	1.38	0.00	0.000	475.07	82
112	1.00	23.52	0.00	23.90	0.000	486.38	64
113	1.00	0.52	0.00	1.90	0.000	441.79	86
114	1.00	0.00	0.00	0.00	0.000	496.42	100
115	1.00	0.00	0.00	0.00	0.000	483.36	85
116	1.00	7.52	2.88	12.90	0.000	495.53	72
117	1.00	15.04	0.36	13.90	0.000	446.13	74
118	1.00	0.00	0.88	0.00	0.000	492.37	90
119	1.00	0.00	0.88	0.00	0.000	438.59	94
120	1.00	0.00	0.00	0.00	0.000	500.13	90
121	1.00	0.00	2.88	0.00	0.000	467.48	96
122	1.00	4.13	0.00	1.90	0.000	418.97	85
123	1.00	0.52	6.88	7.90	0.000	460.35	79
124	1.00	0.00	0.88	0.00	0.000	490.35	94
125	1.00	4.52	0.00	1.90	0.000	484.41	85
126	1.00	20.52	0.88	22.90	7.709	491.91	80
127	1.00	9.52	0.00	9.90	4.422	478.08	84
128	1.00	0.00	1.88	0.00	0.000	465.58	93
129	1.00	0.00	1.30	1.90	0.000	484.44	84
130	1.00	22.52	0.88	21.90	13.003	477.65	75
131	1.00	0.00	0.00	0.00	8.367	482.31	90
132	1.00	13.75	0.65	14.90	4.768	437.56	77
133	1.00	12.52	0.00	8.90	0.000	455.20	68
134	1.00	16.35	9.05	28.90	0.000	248.39	59
135	1.00	9.52	0.00	7.90	0.000	457.80	78
136	1.00	5.52	0.00	0.90	0.000	461.15	85
137	1.00	0.00	3.88	0.90	0.000	451.65	83
138	1.00	0.00	0.00	0.00	0.000	464.92	100
139	1.00	0.00	0.00	0.00	0.000	473.85	90
140	1.00	0.00	0.00	0.00	14.594	475.03	93
141	1.00	0.00	5.18	0.00	0.000	451.30	84
142	1.00	0.00	1.88	0.00	0.962	455.21	99
143	1.00	0.00	0.00	0.00	0.000	474.25	95
144	1.00	18.52	0.00	16.90	0.694	493.15	84
145	1.00	0.00	0.00	0.00	0.000	475.66	85
146	1.00	1.52	0.00	0.00	0.000	448.30	85

S#	TIME	CPMA	CPMB	CPMC	SIS	tSIS	LUM	FLAG
147	1.00	0.52	0.00	0.00	0.000	405.22	86	
148	1.00	4.52	1.88	7.90	0.000	463.64	75	
149	1.00	13.25	1.15	15.90	0.000	452.28	74	
150	1.00	0.00	0.88	0.00	0.000	486.75	86	
151	1.00	0.00	0.00	0.00	0.000	486.04	100	
152	1.00	0.00	0.73	0.00	0.000	491.95	91	
153	1.00	7.52	0.00	1.90	0.000	508.13	74	
154	1.00	0.00	0.00	0.00	0.000	486.40	88	

156	1.00	0.00	6.88	0.00	0.000	490.89	89
157	1.00	0.00	8.88	4.90	0.000	467.33	80
158	1.00	2.52	0.00	0.00	0.000	485.72	91
159	1.00	12.52	0.88	56.90	25.506	488.41	82
160	1.00	20.52	0.88	22.90	5.830	483.00	79
161	1.00	0.00	0.00	0.00	5.819	487.08	97
162	1.00	8.52	1.88	17.90	6.553	471.23	82
163	1.00	0.00	0.00	0.00	0.000	467.89	84
164	1.00	0.00	0.00	0.00	0.000	477.58	83
165	1.00	1.52	3.88	1.90	0.000	496.74	79
166	1.00	11.52	2.88	14.90	0.338	488.51	79
167	1.00	0.00	0.00	0.00	0.000	504.76	87
168	1.00	0.00	0.00	0.00	0.000	473.78	100
169	1.00	4.52	0.00	0.90	0.000	501.72	82
170	1.00	0.00	0.00	0.00	0.000	490.70	100
171	1.00	0.00	4.88	0.00	0.000	479.66	93
172	1.00	19.52	4.88	24.90	0.000	496.53	65
173	1.00	0.00	0.88	0.00	0.000	494.29	98
174	1.00	0.52	0.00	0.00	0.000	478.79	88
175	1.00	0.00	0.00	0.00	0.000	468.42	99
176	1.00	0.00	3.88	0.00	11.231	468.88	91
177	1.00	0.00	0.00	0.00	6.303	491.51	97
178	1.00	8.52	2.88	8.90	423.36	493.16	79
179	1.00	0.00	0.00	0.00	0.000	482.82	100
180	1.00	5.52	0.00	6.90	7.277	491.03	86
181	1.00	7.99	0.00	0.90	0.000	503.52	85
182	1.00	0.00	3.88	0.00	0.000	507.06	85
183	1.00	10.52	0.00	4.90	0.000	491.07	82
184	1.00	7.52	0.00	2.90	0.000	482.90	84
185	1.00	0.00	0.00	0.00	0.000	496.30	100
186	1.00	4.43	3.97	4.90	0.000	487.08	76
187	1.00	14.85	0.00	13.90	3.205	499.48	80
188	1.00	0.00	0.00	0.00	0.000	455.19	87
189	1.00	1.43	0.97	4.90	0.000	457.49	82
190	1.00	0.00	0.88	0.00	0.000	494.52	98
191	1.00	0.00	0.00	0.00	0.000	448.81	98
192	1.00	0.00	0.00	0.00	0.000	470.68	100
193	1.00	16.52	0.00	22.90	11.903	447.25	78
194	1.00	0.00	2.88	0.00	0.190	423.08	100
195	1.00	14.52	4.88	19.90	17.225	439.70	77
196	1.00	3.20	0.00	0.00	0.000	455.43	85
197	1.00	0.00	0.00	0.00	0.000	414.42	96
198	1.00	0.00	4.88	0.00	8.659	445.24	96
199	1.00	0.00	0.00	0.00	0.000	430.26	87

page 14 of 30

rechecked

S#	TIME	CPMA	CPME	CPMC	SIS	tSIE	LUM	FLAG
200	1.00	0.00	2.88	0.00	0.880	370.76	96	
201	1.00	3.52	2.88	7.90	36.500	497.20	84	
202	1.00	0.00	3.66	0.00	0.000	496.07	96	
203	1.00	0.00	4.88	0.00	0.000	488.42	98	
204	1.00	8.52	0.00	7.90	19.075	482.87	82	
205	1.00	16.52	0.00	12.90	0.000	496.26	79	
206	1.00	15.52	0.00	9.90	0.000	498.22	79	
207	1.00	37.52	0.88	39.90	24.576	484.75	63	
208	1.00	24.52	1.88	25.90	13.205	498.04	73	
209	1.00	6.86	0.00	0.90	0.000	470.24	87	
210	1.00	0.00	0.00	0.00	0.000	490.30	100	
211	1.00	0.00	0.00	0.00	0.000	500.43	98	
212	1.00	0.00	0.88	0.00	8.550	474.95	100	

rechecked

215	1.00	16.46	1.94	13.90	11.380	459.29	77
216	1.00	0.00	0.00	0.00	0.000	445.37	95
217	1.00	0.00	1.88	0.00	11.855	504.47	90
218	1.00	16.52	0.00	13.90	5.229	467.18	82
219	1.00	14.52	0.00	13.90	4.154	486.30	84
220	1.00	0.00	0.00	0.00	0.000	481.47	97
221	1.00	0.00	0.00	0.00	0.000	483.46	94
222	1.00	21.52	1.88	19.90	3.915	474.41	83
223	1.00	0.00	0.00	0.00	0.000	484.61	91
224	1.00	0.00	5.88	0.00	0.000	444.54	90
225	1.00	0.00	3.88	0.00	37.969	477.85	95
226	1.00	0.00	0.00	0.00	4.139	474.95	90
227	1.00	0.00	0.00	0.00	0.000	451.64	100
228	1.00	8.52	0.00	7.90	0.000	463.39	79
229	1.00	1.52	3.88	4.90	0.000	473.49	82
230	1.00	1.52	0.00	0.00	0.000	487.82	89
231	1.00	0.00	3.88	0.00	3.700	298.61	96
232	1.00	8.52	0.00	2.90	0.000	362.13	87
233	1.00	19.52	2.88	19.90	4.156	480.04	79
234	1.00	13.52	0.88	17.90	2.753	395.15	82
235	1.00	0.00	0.88	0.00	3.298	335.41	95
236	1.00	0.00	1.88	0.00	499.23	468.11	91
237	1.00	3.52	0.00	3.90	0.000	440.11	85
238	1.00	34.52	0.00	37.90	1.307	365.04	88
239	1.00	23.52	0.88	23.90	12.528	468.43	75
240	1.00	0.00	5.88	0.00	6.356	381.29	94
241	1.00	0.00	0.00	0.00	0.000	474.94	97
242	1.00	0.00	6.88	0.00	0.000	468.79	100
243	1.00	0.00	2.88	0.00	2.002	394.73	92
244	1.00	16.52	0.00	14.90	0.000	487.18	75
245	1.00	0.00	2.61	0.00	0.000	478.93	99
246	1.00	0.00	1.62	0.00	3.534	497.37	97
247	1.00	0.00	0.00	0.00	0.000	432.93	96
248	1.00	5.52	0.00	0.00	1.516	464.48	85
249	1.00	0.00	3.88	0.00	17.001	471.10	94
250	1.00	0.00	0.58	0.00	1.342	361.18	96
251	1.00	8.52	0.00	7.90	1.903	482.61	84
252	1.00	0.00	0.00	0.00	0.000	485.34	98

reanalyzed

S#	TIME	CPMA	CPMB	CPMC	SIS	εSIE	LUM	FLAG
253	1.00	1.52	0.00	0.00	14.589	464.84	88	
254	1.00	0.00	0.00	0.00	0.000	480.33	93	
255	1.00	3.52	0.00	0.00	35.475	465.26	86	
256	1.00	16.52	0.00	13.90	0.000	472.05	78	
257	1.00	4.52	3.88	10.90	5.581	451.85	87	
258	1.00	0.00	7.88	0.00	5194.6	454.95	90	
259	1.00	0.00	2.67	0.00	6.837	318.66	100	
260	1.00	34.52	0.00	28.90	2.816	483.15	74	
261	1.00	0.00	2.88	0.00	0.000	485.10	88	
262	1.00	0.00	1.88	1.90	27.741	466.00	87	
263	1.00	0.00	0.00	2.90	3.311	476.27	89	
264	1.00	0.00	0.00	0.00	0.414	460.47	100	
265	1.00	0.00	0.00	0.00	0.000	457.45	92	
266	1.00	0.00	0.00	0.00	0.234	473.52	100	
267	1.00	0.00	3.63	0.00	30.955	463.86	89	
268	1.00	0.00	3.88	0.00	43.127	470.04	100	
269	1.00	2.52	0.00	0.00	0.000	485.39	84	
270	1.00	0.00	0.00	0.00	0.000	470.59	92	
271	1.00	0.00	0.00	0.00	0.000	455.12	93	

274	1.00	0.00	0.00	0.00	0.000	463.10	100	
275	1.00	41.52	0.00	41.90	2.701	448.44	66	reanalyzed
276	1.00	3.52	0.88	3.90	0.000	459.86	80	
277	1.00	37.52	0.00	34.90	4.378	454.39	71	reanalyzed
278	1.00	28.52	0.00	28.90	6.211	471.43	76	
279	1.00	10.52	0.88	11.90	3.606	479.68	94	
280	1.00	12.52	0.00	10.90	46.157	462.06	78	
281	1.00	11.52	0.00	7.90	0.000	465.83	77	
282	1.00	0.00	1.88	0.00	8.443	432.47	100	
283	1.00	9.52	0.00	8.90	0.000	415.38	82	
284	1.00	18.52	0.00	15.90	7.249	418.03	77	
285	1.00	14.52	3.88	19.90	26.298	416.47	78	
286	1.00	1.52	0.00	0.00	5.432	460.52	90	
287	1.00	8.52	0.00	7.90	2.854	445.50	86	
288	1.00	0.00	2.88	0.00	0.000	432.25	94	
289	1.00	19.52	0.00	14.90	0.000	476.40	82	
290	1.00	27.20	0.00	23.90	0.000	480.24	75	
291	1.00	10.76	0.00	6.90	0.000	408.28	81	
292	1.00	12.52	2.88	11.90	5082.2	454.74	74	
293	1.00	26.97	2.43	25.90	6.207	443.87	74	
294	1.00	0.00	0.00	0.00	5.177	454.26	93	
295	1.00	0.00	1.88	0.00	0.000	445.84	91	
296	1.00	4.52	0.00	5.90	0.000	412.89	87	
297	1.00	4.52	5.88	15.90	15.604	439.55	85	
298	1.00	24.52	0.00	19.90	8.935	466.68	79	
1 MISSING TUBE(S)								
#27 300	1.00	10.52	0.00	6.90	0.000	441.44	86	

30 Nov 1999 09:10

TRI-CARB - 1.09

Page #170

Protocol #:27

rad safety dept

User :

Time: 1.00

Data Mode: CPM

Nuclide: MANUAL

Background Subtract: 1st Vial

	LL	UL	LCR	25%	BKG
Region A:	0.0 - 18.6		0	0.0	13.91
Region B:	18.6 - 156		0	0.0	7.09
Region C:	0.0 - 2000		0	0.0	27.90

Quench Indicator: tSIE/AEC

Ext Std Terminator: Count

Luminescence Correction On

Coincidence Time(ns): 0

Delay Before Burst(ns): 0

S#	TIME	CPMA	CPMB	CPMC	SIS	tSIE	LUM	FLAG
<i>Dead</i> 1	10.00	13.91	7.09	27.90	12.729	477.66	76	B
72 2	1.00	0.00	0.00	0.00	1.482	433.93	99	
80 3	1.00	9.09	2.91	10.10	5.371	425.18	90	
86 4	1.00	0.00	2.45	0.00	6.238	393.12	100	
159 5	1.00	6.09	4.91	8.10	12.062	478.98	81	
207 6	1.00	30.09	0.00	29.10	1.787	478.27	75	=
238 7	1.00	42.09	0.91	39.10	2.365	355.32	77	
275 8	1.00	0.00	0.66	0.00	1.174	438.21	99	
277 9	1.00	13.09	0.91	13.10	5.665	445.84	84	

Quench Indicator: tSIE/AEC
Ext Std Terminator: Count
Luminescence Correction On
Coincidence Time(ns): 1e
Delay Before Burst(ns): Normal

SH	TIME	CPMA	CPMB	CPMC	SIS	tSIE	FLAG
10.00	11.00	7.40	24.40	33.175	499.13	B	
1.00	5.00	0.00	4.60	0.000	507.47		

PC Data Filename is: C:\drugmet\A2500\A7_215.dat

SYSTEM NORMALIZED

C14 IPA DATA PROCESSED - 30-Nov-99 12:58

C14 Eff (0-156 keV) = 96.65 %

C14 CHI SQUARE IPA DATA PROCESSED - 30-Nov-99 13:09

C14 Chi Square = 19.67

FATAL ERROR:

LOST PIN POS