

Radiological Survey Sheet

Job Location Pfizer, Inc. Groton, Ct. 06340 118W/W111 Page i 17
 Survey Purpose Radologic Survey of Equipment LAB. DECOMM Date 9-28-12
 Performed by E. SAILOR E. Sailor
 (Print) (Sign)

Instrument (Model/S/N)	Packard Tri-Carb S/N 431521	Packard Tri-Carb S/N 431520	Ludlum 2241-2 163603	Wallac Model 1409 S/N 4061042
Def. (Model/SN)	Internal	Internal	Ludlum 43-68 PR 149613	Internal
Type Rad.	β	β	β	β
Cal. Due:	03/05/2013	03/05/2013	04/17/2013	09/15/2012
Check Instruments Used	✓		✓	

No.	Time	Locations	See attached LSC printout for Total Activity (cpm/100 cm ²)
1.	0700	BACKGROUND	
2.		door	
3.		Floor	
4.		WALL	
5.		Hood LEFT SIDE	
6.		" " BACK	
7.		" middle "	
8.		" RIGHT "	
9.		" " SIDE	
10.		" " BOTTOM	
11.		" middle "	
12.		" LEFT " & CUP	
13.		" SASH	
14.		" LIP	
15.		CAP door ^s & CAP	
16.		" " " "	
17.		SIDE OF Hood	
18.		FLOOR	

Radiological Survey Continuation Sheet

Page 2 of 17

Date 9-28-12

No.	Time	Locations	See attached LSC printout for Total Activity (cpm/100 cm ²)
19	0700	PEG BOARD	
20		SINK AREA	
21		CAB DOORS	
22		" TOP SHELF	
23		" 2ND "	
24		" 3RD "	
25		" 4TH "	
26		TOP SHELF	
27		2ND "	
28		3RD "	
29		BENCH	
30		"	
31		CAB DOOR & CAB	
32		FLOOR	
33		BENCH	
34		FLOOR	
35		TOP DWR	
36		2ND "	
37		3RD "	
38		4TH "	
39		LOWER WALL	
40		UPPER WALL	
41		" "	
42		LOWER "	
43		TABLE TOP	
44		" "	
45	✓	FLOOR	

Radiological Survey Continuation Sheet

Page 3 of 17

Date 7-28-12

No.	Time	Locations	See attached LSC printout for Total Activity (cpm/100 cm ²)
46	0700	UPPER WALL	
47		LOWER "	
48		WINDOW	
49		DOOR	
50		WINDOW	
51		SHELVES	
52		"	
53		"	
54		"	
55		DESK	
56		DWRS	
57		DESK	
58		DWRS	
59		CAB & DWRS	
60		" " "	
61		SHELVES	
62		"	
63		CAB & DWRS	
64		" " "	
65		WINDOW & WALL	
66		" " "	
67		FLOOR	
68		"	
69		WINDOW & WALL	
70		SHELVES	
71		"	
72	✓	DESK	

Radiological Survey Continuation Sheet

Page 4 of 17

Date 9-28-12

No.	Time	Locations	See attached LSC printout for Total Activity (cpm/100 cm ²)
73	0700	DESK	
74		FLOOR	
75		UPPER WALL	
76		LOWER "	
77		FLOOR	
78		"	
79		CAB DOOR 3	
80		" TOP SHELF	
81		" 2ND "	
82		" 3RD "	
83		" 4TH "	
84		SHELF	
85		DESK	
86		DWR	
87		"	
88		"	
89		EXTERIOR & BENCH DWR	
90		DOOR & BENCH	
91		" " "	
92		" " "	
93		BENCH	
94		DWR	
95		"	
96		CAB DOOR & CAB	
97		DWR	
98		"	
99	✓	"	

Radiological Survey Continuation Sheet

Page 5 of 17

Date 9-28-12

No.	Time	Locations	See attached LSC printout for Total Activity (cpm/100 cm ²)
100	0700	dwr	
102		FLOOR	
103		"	
104		"	
105		"	
106		SINK AREA	
107		BENCH	
108		CAB & doors	
109		FLOOR	
110		BENCH	
111		"	
112		"	
113		"	
114		DWR	
115		"	
116		"	
117		"	
118		"	
119		"	
120		CAB & door	
121		CAB doors	
122		" TOP SHELF	
123		" 2ND "	
124		" 3RD "	
125		" 4TH "	
126		" DOORS	
127	✓	" TOP SHELF	

Radiological Survey Continuation Sheet

Page 6 of 17

Date 9-28-12
118W/W111

No.	Time	Locations	See attached LSC printout for Total Activity (cpm/100 cm ²)
128	0700	CAB 2ND SHELF	
129		" 3RD "	
130		" 4TH "	
131		WALL	
132		" E LEDGE	
133		" " "	
134		"	
135		CAB DOORS	
136		" TOP SHELF	
137		" 2ND "	
138		" 3RD "	
139		" 4TH "	
140		BENCH	
141		"	
142		"	
143		"	
* 144		"	
145		"	
146		"	
147		dwr	
148		"	
149		CAB door	
150		dwr	
151		TOP LEFT dwr	
152		" RIGHT "	
153		2ND LEFT "	
154		3RD RIGHT "	

* See pgs 16 + 17 for post decont results.
WAC

Radiological Survey Continuation Sheet

Page 7 of 17

Date 9-28-12

No.	Time	Locations	See attached LSC printout for Total Activity (cpm/100 cm ²)
155	0700	1ST LARGE DW 2	
156		2nd " "	
157		FLOOR	
158		"	
159		"	
160		"	
161		"	
162		"	
163		"	
164		"	
165		"	
166		BENCH	
167		"	
168		"	
169		"	
170		"	
171		CAB DOORS	
172		" TOP SHELF	
173		" 2ND "	
* 174		" 3RD "	
175		" 4TH "	
176		" DOORS	
177		" TOP SHELF	
178		" 2ND "	
179		" 3RD "	
180		" 4TH "	
181		WALL	

* See pgs 1647 for the results of past decon swipes.
WTC

Radiological Survey Continuation Sheet

Page 8 of 17

Date 7-28-12

No.	Time	Locations	See attached LSC printout for Total Activity (cpm/100 cm ²)
182	0200	Wall	
183		BENCH	
184		"	
185		TOP LEFT dWR	
186		" RIGHT "	
187		2ND LEFT "	
188		" RIGHT "	
189		1ST LARGE dWR	
190		2ND " "	
191		dWR	
192		"	
193		"	
194		CAB door & CAB	
195		FLOOR	
196		"	
197		"	
198		"	
199		UPPER ^{as} WALL FLOOR	
200		LOWER "	
201		UPPER "	
202		LOWER "	
203		UPPER "	
204		UPPER "	
205		LOWER "	
206		UPPER "	
207		LOWER "	
208		UPPER "	

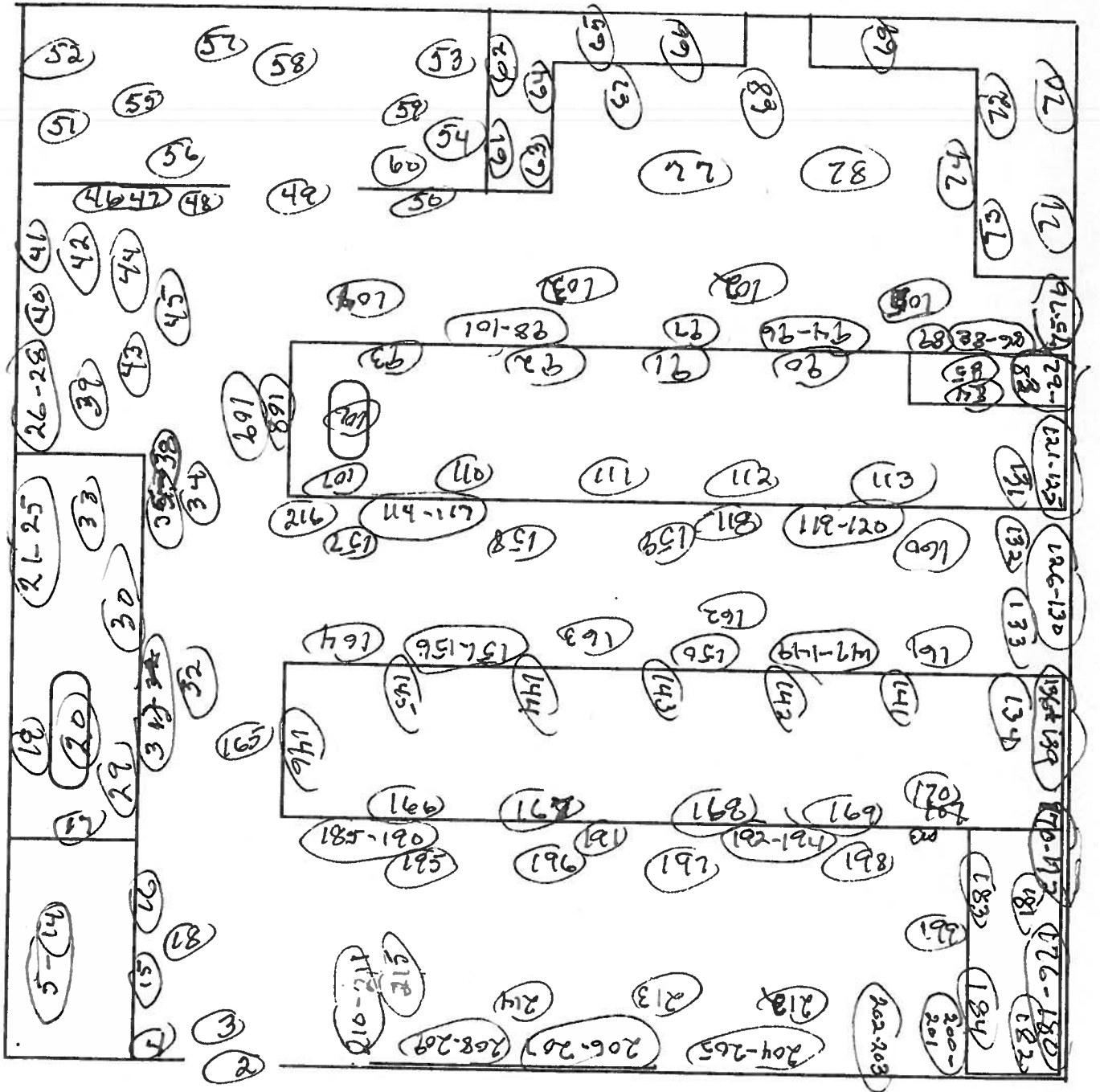

- Selected loop of lower surfaces using 43-68. NO REMAINS IN EXCESS OF NORMAL BACKGROUNDS were noted.

O = water location

Protocol# 4 - Eds Monthly Swipes.lsa

Assay Definition-

Assay Description:
Equipment Swipes

Assay Type: CPM
Report Name: Report1
Output Data Path: C:\Packard\Tricarb\Results\Ed Gailor\Eds Monthly Swipes
Raw Results Path: C:\Packard\Tricarb\Results\Ed Gailor\Eds Monthly Swipes\20120928_1614
\20120928_1614.results
RTF File Name: C:\Packard\Tricarb\Results\Ed Gailor\Eds Monthly Swipes\Ed's Monthly Swipes.rtf
Assay File Name: C:\Packard\TriCarb\Assays\Eds Monthly Swipes.lsa

Count Conditions-

Nuclide: Triple
Quench Indicator: tSIE/AEC
External Std Terminator (sec): 5 sec
Pre-Count Delay (min): 0.00
Quench Set: n/a
Count Time (min): 1.00
Count Mode: Normal
Assay Count Cycles: 1 Repeat Sample Count: 1
#Vials/Sample: 1 Calculate % Reference: Off

Background Subtract: On - Manual
Low CPM Threshold: Off
2 Sigma % Terminator: Off

Regions	LL	UL	Bkg Subtract
A	0.0	18.6	0.00
B	18.6	156.0	0.00
C	0.0	2000.0	0.00

Count Corrections-

Static Controller: On Luminescence Correction: On
Colored Samples: n/a Heterogeneity Monitor: n/a
Coincidence Time (nsec): 18 Delay Before Burst (nsec): 75

Half Life-

Half Life Correction: Off

Regions	Half Life	Units	Reference Date	Reference Time
A				
B				
C				

Cycle 1 Results

S#	CPMA	CPMB	CPMC	MESSAGES
1	1	5	14	
2	0	9	14	
3	15	3	30	
4	17	6	28	
5	5	4	15	
6	6	6	17	
7	8	7	19	
8	7	12	23	
9	14	6	26	
10	13	12	34	

11	13	7	30
12	11	6	21
13	8	12	26
14	15	8	35
15	10	7	23
16	4	13	21
17	9	12	25
18	10	5	23
19	6	11	26
20	14	15	36
21	17	13	36
22	6	8	20
23	13	10	28
24	14	9	31
25	15	9	32
26	12	6	20
27	21	5	31
28	10	5	19
29	13	8	30
30	4	10	21
31	12	5	23
32	16	11	34
33	11	10	25
34	19	7	32
35	6	8	18
36	4	8	16
37	14	7	25
38	16	11	32
39	0	10	12
40	8	8	21
41	7	10	22
42	10	6	22
43	6	7	19
44	11	9	25
45	12	12	31
46	22	28	57
47	7	8	21
48	10	9	22
49	4	6	13
50	15	7	27
51	10	10	25
52	9	7	19
53	12	7	22
54	8	5	18
55	10	9	23
56	8	10	22
57	8	12	30
58	11	5	25
59	10	8	19
60	7	9	22
61	12	6	21
62	6	6	15
63	12	12	28
64	8	10	21
65	19	12	34
66	8	5	17
67	11	3	20
68	13	7	25
69	11	4	20
70	14	10	27
71	6	11	19
72	13	11	28
73	13	4	23

74	6	9	20
75	12	7	31
76	3	11	21
77	15	4	25
78	5	8	16
79	8	14	25
80	12	2	21
81	10	8	27
82	10	14	26
83	10	5	19
84	4	11	20
85	9	10	27
86	7	7	19
87	5	6	17
88	10	13	26
89	15	3	22
90	7	6	21
91	9	9	21
92	10	12	28
93	5	7	18
94	17	12	35
95	9	5	21
96	13	10	26
97	12	5	19
98	14	7	29
99	10	7	26
100	12	5	25
101	11	10	23
102	8	10	24
103	7	6	16
104	14	6	25
105	8	7	22
106	7	4	18
107	11	5	25
108	4	8	16
109	12	8	27
110	9	10	27
111	6	8	22
112	14	8	29
113	10	1	19
114	6	10	22
115	3	11	16
116	10	4	22
117	8	7	26
118	11	12	32
119	11	5	21
120	12	11	26
121	8	3	15
122	9	3	14
123	7	9	22
124	12	7	27
125	13	7	22
126	6	4	14
127	9	4	16
128	12	6	21
129	9	6	20
130	9	11	25
131	9	6	21
132	17	8	30
133	11	6	22
134	4	5	15
135	16	9	29
136	8	13	25

137	14	5	25
138	18	9	34
139	12	16	40
140	6	6	23
141	16	7	26
142	11	6	22
143	7	7	19
* 144	1069	7	1083
145	4	4	11
146	2	4	15
147	10	3	20
148	14	8	27
149	14	19	39
150	5	8	23
151	5	4	14
152	8	6	19
153	11	5	23
154	13	5	24
155	10	8	19
156	12	11	32
157	6	7	20
158	12	9	24
159	15	9	28
160	17	10	31
161	12	6	21
162	11	5	27
163	4	7	18
164	10	10	23
165	12	6	25
166	5	6	18
167	14	6	26
168	12	10	30
169	8	9	25
170	12	10	26
171	17	7	30
172	14	11	28
173	12	10	26
* 174	82	141	230
175	7	2	11
176	11	7	23
177	9	7	21
178	9	7	23
179	12	4	22
180	5	5	12
181	7	8	18
182	9	14	30
183	13	6	25
184	12	11	27
185	7	3	13
186	7	8	17
187	10	5	21
188	14	10	28
189	13	9	25
190	9	7	22
191	14	10	28
192	7	6	20
193	8	9	24
194	9	8	24
195	6	12	23
196	6	11	21
197	10	6	21
198	8	8	22
199	10	14	31

* Note: See pgs 16 + 17 for past decon swipe test results. WHE

200	3	9	21
201	11	6	22
202	11	7	23
203	9	6	16
204	14	4	24
205	8	6	18
206	11	5	18
207	5	7	20
208	12	5	21
209	17	4	28
210	8	8	19
211	28	32	66
212	9	15	35
213	8	3	16
214	17	11	32
215	7	15	29
216	12	6	23
217	11	4	17
218	4	7	18
219	8	5	19
220	11	10	23
221	14	11	37
222	11	9	25
223	10	8	28
224	2	6	17
225	7	11	26
226	9	15	32
227	5	9	18
228	11	7	25
229	2	9	15
230	13	8	26
231	7	7	17
232	9	9	21
233	12	7	28
234	7	8	22
235	7	10	25
236	7	16	28
237	8	10	28

Radiological Survey Sheet

Job Location Pfizer, Inc. Groton, Ct. 06340

118w/W111

16 of 17

Survey Purpose Rad Survey Post Decon Lab

Date 1/9/2013

Performed by William H. Calver
(Print)

William H. Calver
(Sign)

Instrument (Model/S/N)	Packard Tri-Carb S/N 431521	Packard Tri-Carb S/N 431520	Ludlum 2241-2 163603	Ludlum 3 176699
Det. (Model/SN)	Internal	Internal	Ludlum 43-68 PR 149613	Ludlum 44-9 PR 188103
Type Rad.	β	β	β	β
Cal. Due:	03/05/2013	03/05/2013	04/17/2013	04/13/13
Check Instruments Used	✓			✓

No.	Time	Locations	See attached LSC printout for Total Activity (cpm/100 cm ²)
1.	1130 ↓	BACKGROUND	
2.		#174 of RPT dtd	3RD shelf in cabinet
3.			Left
4.			Right
5.			End of bench ^{Top} near door
6.			Left Rear
7.			Right Front
8.		Right Rear	
9.			
10.			
11.			
12.			
13.			
14.			
15.			
16.			
17.			
18.			

Assay Definition-

Assay Description:
Background check for PM Lab (Mikey)

Assay Type: CPM
Report Name: Report1
Output Data Path: C:\Packard\Tricarb\Results\bill\bills swipes
Raw Results Path: C:\Packard\Tricarb\Results\bill\bills swipes\20130109_1434\20130109_1434.results
RTF File Name: C:\Packard\Tricarb\Results\bill\bills swipes\Report1.rtf
Assay File Name: C:\Packard\TriCarb\Assays\bills swipes.lsa

Count Conditions-

Nuclide: TRIPLE
Quench Indicator: tSIE/AEC
External Std Terminator (sec): 0.5 2s%
Pre-Count Delay (min): 0.00
Quench Set: n/a
Count Time (min): 1.00
Count Mode: Normal
Assay Count Cycles: 1 Repeat Sample Count: 1
#Vials/Sample: 1 Calculate % Reference: Off
Background Subtract: Off
Low CPM Threshold: Off
2 Sigma % Terminator: Off

Regions	LL	UL
A	0.0	18.6
B	18.6	156.0
C	0.0	2000.0

Count Corrections-

Static Controller: On Luminescence Correction: On
Colored Samples: n/a Heterogeneity Monitor: n/a
Coincidence Time (nsec): 18 Delay Before Burst (nsec): 75

Half Life-

Half Life Correction: Off

Regions	Half Life	Units	Reference Date	Reference Time
A				
B				
C				

Cycle 1 Results

S#	CPMA	CPMB	CPMC	MESSAGES	PID	Custom1
1	7	6	20		2	
2	13	4	19		2	
3	12	3	20		2	
4	9	6	16		2	
5	9	7	17		2	
6	7	6	16		2	
7	9	3	18		2	